

Alchip™-MVE Series

- Endurance : 1,000 to 2,000 hours at 105°C
- Case size range : ϕ 4x5.2L to ϕ 18x21.5L
- Solvent resistant type except 100 to 450V_{dc} (see PRECAUTIONS AND GUIDELINES)
- RoHS2 Compliant
- AEC-Q200 compliant : Please contact Chemi-Con for more details, test data, information.

MVE → Longer life → MVL MVJ



◆ SPECIFICATIONS

| Items | Characteristics | | | | | | | | | | | | |
|---------------------------------------------------------------|------------------------------------------------------------------------------------------------------------------------------------------------------------------------|-------------------------------------------------------------------------------------------------------------------------------------------------------------------------------------------------------------------------------------------------------------------------------------------------------------------------|-----|-----|-----|-----|-----|---------------------------------------|------|-------------|-------------|---|--|
| Category Temperature Range | -40 to +105°C | | | | | | | | | | | | |
| Rated Voltage Range | 6.3 to 450V _{dc} | | | | | | | | | | | | |
| Capacitance Tolerance | ±20%(M) (at 20°C, 120Hz) | | | | | | | | | | | | |
| Leakage Current | Rated voltage (V _{dc}) | 6.3 to 100V | | | | | | 160 to 450V | | | | | |
| | D55 to JA0 | I=0.01CV or 3μA, whichever is greater (2 minutes) | | | | | | — | | | | | |
| | KE0 to MN0 | I=0.03CV or 4μA, whichever is greater (1 minute) | | | | | | I=0.04CV+100μA (1 minute) | | | | | |
| | Where, I : Max. leakage current (μA), C : Nominal capacitance (μF), V : Rated voltage (V) (at 20°C) | | | | | | | | | | | | |
| Dissipation Factor (tan δ) | See STANDARD RATINGS (at 20°C, 120Hz) | | | | | | | | | | | | |
| Low Temperature Characteristics (Max. Impedance Ratio) | Rated voltage (V _{dc}) | 6.3V | 10V | 16V | 25V | 35V | 50V | 63V | 100V | 160 to 250V | 400 to 450V | | |
| | D55 to JA0 | Z(-25°C)/Z(+20°C) | 4 | 3 | 2 | 2 | 2 | 2 | 2 | 3 | — | — | |
| | | Z(-40°C)/Z(+20°C) | 12 | 8 | 6 | 4 | 3 | 3 | 3 | 4 | — | — | |
| | KE0 to MN0 | Z(-25°C)/Z(+20°C) | 5 | 4 | 3 | 2 | 2 | 2 | 2 | 2 | 3 | 6 | |
| Z(-40°C)/Z(+20°C) | | 10 | 8 | 6 | 4 | 3 | 3 | 3 | 3 | 6 | 10 | | |
| Endurance | The following specifications shall be satisfied when the capacitors are restored to 20°C after the rated voltage is applied for the specified period of time at 105°C. | | | | | | | | | | | | |
| | Size code | D55 to F80 | | | | | | HA0 to MN0 | | | | | |
| | Time | 1,000 hours | | | | | | 2,000 hours | | | | | |
| | Capacitance change | ≤ ±30% of the initial value | | | | | | ≤ ±20% of the initial value | | | | | |
| | D.F. (tan δ) | ≤ 300% of the initial specified value | | | | | | ≤ 200% of the initial specified value | | | | | |
| | Leakage current | ≤ The initial specified value | | | | | | ≤ The initial specified value | | | | | |
| | Shelf Life | The following specifications shall be satisfied when the capacitors are restored to 20°C after exposing them for 1,000 hours (500 hours for B55 to F80 size) at 105°C without voltage applied. Before the measurement, the capacitor shall be preconditioned by applying voltage according to Item 4.1 of JIS C 5101-4. | | | | | | | | | | | |
| Size code | | D55 to F80 | | | | | | HA0 to MN0 | | | | | |
| Capacitance change | | ≤ ±25% of the initial value | | | | | | ≤ ±20% of the initial value | | | | | |
| D.F. (tan δ) | | ≤ 200% of the initial specified value | | | | | | ≤ 200% of the initial specified value | | | | | |
| Leakage current | | ≤ The initial specified value | | | | | | ≤ The initial specified value | | | | | |

◆ DIMENSIONS [mm]

● Terminal Code : A

● Size code : D55 to MN0

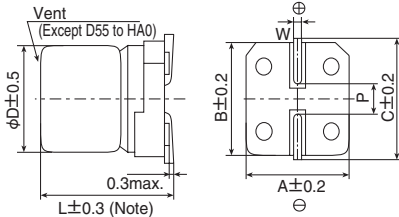

Note : L±0.5 for HA0 to MN0

● Terminal Code : G (Vibration resistant structure)

● Size code : LH0 to MN0

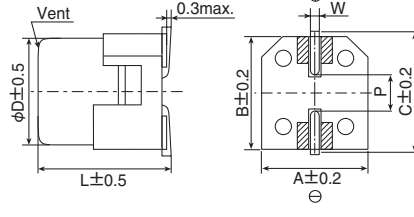

▨ : Dummy terminals

| Size code | D | L | A | B | C | W | P |
|-----------|------|------|------|------|------|------------|-----|
| D55 | 4 | 5.2 | 4.3 | 4.3 | 5.1 | 0.5 to 0.8 | 1.0 |
| E55 | 5 | 5.2 | 5.3 | 5.3 | 5.9 | 0.5 to 0.8 | 1.4 |
| F55 | 6.3 | 5.2 | 6.6 | 6.6 | 7.2 | 0.5 to 0.8 | 1.9 |
| F80 | 6.3 | 7.7 | 6.6 | 6.6 | 7.2 | 0.5 to 0.8 | 1.9 |
| HA0 | 8 | 10.0 | 8.3 | 8.3 | 9.0 | 0.7 to 1.1 | 3.1 |
| JA0 | 10 | 10.0 | 10.3 | 10.3 | 11.0 | 0.7 to 1.1 | 4.5 |
| KE0 | 12.5 | 13.5 | 13.0 | 13.0 | 13.7 | 1.0 to 1.3 | 4.2 |
| KG5 | 12.5 | 16.0 | 13.0 | 13.0 | 13.7 | 1.0 to 1.3 | 4.2 |
| LH0 | 16 | 16.5 | 17.0 | 17.0 | 18.0 | 1.0 to 1.3 | 6.5 |
| LN0 | 16 | 21.5 | 17.0 | 17.0 | 18.0 | 1.0 to 1.3 | 6.5 |
| MH0 | 18 | 16.5 | 19.0 | 19.0 | 20.0 | 1.0 to 1.3 | 6.5 |
| MN0 | 18 | 21.5 | 19.0 | 19.0 | 20.0 | 1.0 to 1.3 | 6.5 |

◆ MARKING

D55 to JA0

Ex) 16V22μF

KE0 to MN0

Ex) 25V1,000μF

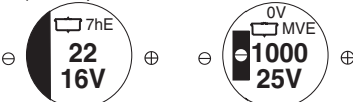

◆ PART NUMBERING SYSTEM

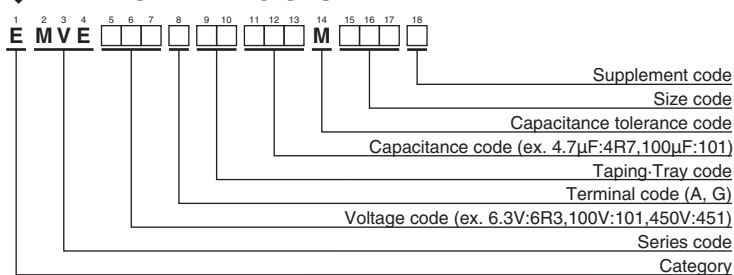

◆ RATED RIPPLE CURRENT MULTIPLIERS

● Frequency Multipliers

| Size code | Capacitance(μF) | Frequency(Hz) | | | |
|------------|-----------------|---------------|------|------|------|
| | | 120 | 1k | 10k | 100k |
| D55 to JA0 | 1.0 | 1.00 | 1.50 | 1.75 | 1.80 |
| | 2.2 to 10 | 1.00 | 1.30 | 1.40 | 1.50 |
| | 22 to 1,500 | 1.00 | 1.05 | 1.08 | 1.08 |
| KE0 to MN0 | 3.3 to 4.7 | 1.00 | 1.75 | 2.30 | 2.50 |
| | 10 to 68 | 1.00 | 1.50 | 1.75 | 1.80 |
| | 100 to 1,000 | 1.00 | 1.30 | 1.40 | 1.50 |
| | 2,200 to 6,800 | 1.00 | 1.05 | 1.08 | 1.08 |

The endurance of capacitors is reduced with internal heating produced by ripple current at the rate of halving the lifetime with every 5°C rise.

When long life performance is required in actual use, the rms ripple current has to be reduced.

Please refer to "Product code guide (surface mount type)"

Alchip™-MVE Series

◆ STANDARD RATINGS

□ is not solvent resistant.

| VV (V _{dc}) | Cap (μF) | Size code | tan δ | Rated ripple current (mA _{rms} /105°C, 120Hz) | Part No. | VV (V _{dc}) | Cap (μF) | Size code | tan δ | Rated ripple current (mA _{rms} /105°C, 120Hz) | Part No. | | | |
|-----------------------|----------|-----------|-------|--------------------------------------------------------|--------------------|-----------------------|----------|-----------|--------------------|--------------------------------------------------------|--------------------|--------------------|--------------------|--------------------|
| 6.3 | 22 | D55 | 0.30 | 22 | EMVE6R3ARA220MD55G | 35 | 330 | JA0 | 0.16 | 450 | EMVE350ARA331MJA0G | | | |
| | 33 | E55 | 0.30 | 34 | EMVE6R3ARA330ME55G | | 470 | KE0 | 0.22 | 520 | EMVE350ARA471MKE0S | | | |
| | 47 | E55 | 0.30 | 38 | EMVE6R3ARA470ME55G | | 470 | LH0 | 0.22 | 650 | EMVE350□RA471MLH0S | | | |
| | 100 | F55 | 0.30 | 69 | EMVE6R3ARA101MF55G | | 1,000 | LH0 | 0.22 | 750 | EMVE350□RA102MLH0S | | | |
| | 220 | F80 | 0.45 | 120 | EMVE6R3ARA221MF80G | | 1,000 | MH0 | 0.22 | 1,000 | EMVE350□RA102MMH0S | | | |
| | 330 | HA0 | 0.40 | 290 | EMVE6R3ARA331MHA0G | | 2,200 | MN0 | 0.24 | 1,450 | EMVE350□RA222MMN0S | | | |
| | 470 | HA0 | 0.45 | 320 | EMVE6R3ARA471MHA0G | | 50 | 1.0 | D55 | 0.12 | 8.0 | EMVE500ARA1R0MD55G | | |
| | 680 | HA0 | 0.45 | 340 | EMVE6R3ARA681MHA0G | | | 2.2 | D55 | 0.12 | 12 | EMVE500ARA2R2MD55G | | |
| | 1,000 | JA0 | 0.40 | 410 | EMVE6R3ARA102MJA0G | | | 3.3 | D55 | 0.12 | 15 | EMVE500ARA3R3MD55G | | |
| | 1,500 | JA0 | 0.45 | 550 | EMVE6R3ARA152MJA0G | | | 4.7 | E55 | 0.12 | 20 | EMVE500ARA4R7ME55G | | |
| | 2,200 | KE0 | 0.40 | 680 | EMVE6R3ARA222MKE0S | | | 10 | F55 | 0.12 | 32 | EMVE500ARA100MF55G | | |
| | 2,200 | LH0 | 0.40 | 840 | EMVE6R3□RA222MLH0S | | | 33 | F80 | 0.14 | 65 | EMVE500ARA330MF80G | | |
| | 3,300 | KG5 | 0.42 | 850 | EMVE6R3ARA332MKG5S | | | 47 | F80 | 0.14 | 80 | EMVE500ARA470MF80G | | |
| | 3,300 | MH0 | 0.42 | 1,000 | EMVE6R3□RA332MMH0S | | | 100 | HA0 | 0.14 | 230 | EMVE500ARA101MHA0G | | |
| | 4,700 | LN0 | 0.44 | 1,200 | EMVE6R3□RA472MLN0S | | | 220 | JA0 | 0.14 | 375 | EMVE500ARA221MJA0G | | |
| 4,700 | MH0 | 0.44 | 1,200 | EMVE6R3□RA472MMH0S | 330 | KE0 | | 0.18 | 500 | EMVE500ARA331MKE0S | | | | |
| 6,800 | LN0 | 0.48 | 1,200 | EMVE6R3□RA682MLN0S | 330 | LH0 | | 0.18 | 600 | EMVE500□RA331MLH0S | | | | |
| 6,800 | MN0 | 0.48 | 1,350 | EMVE6R3□RA682MMN0S | 470 | LH0 | | 0.18 | 700 | EMVE500□RA471MLH0S | | | | |
| 10 | 22 | E55 | 0.24 | 30 | EMVE100ARA220ME55G | 470 | | MH0 | 0.18 | 750 | EMVE500□RA471MMH0S | | | |
| | 33 | E55 | 0.24 | 34 | EMVE100ARA330ME55G | 1,000 | | MN0 | 0.18 | 1,200 | EMVE500□RA102MMN0S | | | |
| | 47 | F55 | 0.24 | 48 | EMVE100ARA470MF55G | 63 | | 1.0 | D55 | 0.12 | 8.0 | EMVE630ARA1R0MD55G | | |
| | 100 | F55 | 0.30 | 69 | EMVE100ARA101MF55G | | 2.2 | D55 | 0.12 | 12 | EMVE630ARA2R2MD55G | | | |
| | 150 | F80 | 0.35 | 100 | EMVE100ARA151MF80G | | 3.3 | E55 | 0.12 | 17 | EMVE630ARA3R3ME55G | | | |
| | 220 | F80 | 0.35 | 120 | EMVE100ARA221MF80G | | 4.7 | F55 | 0.12 | 22 | EMVE630ARA4R7MF55G | | | |
| | 330 | HA0 | 0.35 | 290 | EMVE100ARA331MHA0G | | 10 | F55 | 0.12 | 32 | EMVE630ARA100MF55G | | | |
| | 470 | HA0 | 0.35 | 320 | EMVE100ARA471MHA0G | | 22 | F80 | 0.12 | 58 | EMVE630ARA220MF80G | | | |
| | 1,000 | JA0 | 0.35 | 410 | EMVE100ARA102MJA0G | | 33 | HA0 | 0.12 | 140 | EMVE630ARA330MHA0G | | | |
| | 2,200 | KG5 | 0.36 | 750 | EMVE100ARA222MKG5S | | 47 | HA0 | 0.12 | 170 | EMVE630ARA470MHA0G | | | |
| | 2,200 | LH0 | 0.36 | 850 | EMVE100□RA222MLH0S | | 100 | JA0 | 0.12 | 310 | EMVE630ARA101MJA0G | | | |
| | 3,300 | LH0 | 0.38 | 1,000 | EMVE100□RA332MLH0S | | 220 | KE0 | 0.14 | 470 | EMVE630ARA221MKE0S | | | |
| | 3,300 | MH0 | 0.38 | 1,100 | EMVE100□RA332MMH0S | | 220 | LH0 | 0.14 | 560 | EMVE630□RA221MLH0S | | | |
| | 4,700 | LN0 | 0.40 | 1,300 | EMVE100□RA472MLN0S | | 330 | LH0 | 0.14 | 700 | EMVE630□RA331MLH0S | | | |
| | 4,700 | MN0 | 0.40 | 1,350 | EMVE100□RA472MMN0S | | 330 | MH0 | 0.14 | 750 | EMVE630□RA331MMH0S | | | |
| 16 | 10 | D55 | 0.20 | 17 | EMVE160ARA100MD55G | | 470 | LN0 | 0.14 | 900 | EMVE630□RA471MLN0S | | | |
| | 22 | E55 | 0.20 | 30 | EMVE160ARA220ME55G | | 470 | MH0 | 0.14 | 900 | EMVE630□RA471MMH0S | | | |
| | 33 | F55 | 0.20 | 45 | EMVE160ARA330MF55G | 100 | 22 | HA0 | 0.12 | 100 | EMVE101ARA220MHA0G | | | |
| | 47 | F55 | 0.20 | 48 | EMVE160ARA470MF55G | | 33 | JA0 | 0.12 | 150 | EMVE101ARA330MJA0G | | | |
| | 100 | F55 | 0.26 | 69 | EMVE160ARA101MF55G | | 47 | KE0 | 0.10 | 250 | EMVE101ARA470MKE0S | | | |
| | 150 | F80 | 0.28 | 100 | EMVE160ARA151MF80G | | 68 | KE0 | 0.10 | 300 | EMVE101ARA680MKE0S | | | |
| | 220 | F80 | 0.28 | 120 | EMVE160ARA221MF80G | | 100 | KE0 | 0.10 | 380 | EMVE101ARA101MKE0S | | | |
| | 330 | HA0 | 0.28 | 290 | EMVE160ARA331MHA0G | | 100 | LH0 | 0.10 | 450 | EMVE101□RA101MLH0S | | | |
| | 470 | HA0 | 0.28 | 320 | EMVE160ARA471MHA0G | | 220 | LN0 | 0.10 | 750 | EMVE101□RA221MLN0S | | | |
| | 680 | JA0 | 0.28 | 470 | EMVE160ARA681MJA0G | | 220 | MH0 | 0.10 | 750 | EMVE101□RA221MMH0S | | | |
| | 1,000 | KE0 | 0.30 | 550 | EMVE160ARA102MKE0S | | 330 | MN0 | 0.10 | 980 | EMVE101□RA331MMN0S | | | |
| | 1,000 | LH0 | 0.30 | 650 | EMVE160□RA102MLH0S | | 160 | 33 | KE0 | 0.15 | 95 | EMVE161ARA330MKE0S | | |
| | 2,200 | LH0 | 0.32 | 950 | EMVE160□RA222MLH0S | | | 47 | LH0 | 0.15 | 260 | EMVE161□RA470MLH0S | | |
| | 2,200 | MH0 | 0.32 | 1,000 | EMVE160□RA222MMH0S | | | 68 | LN0 | 0.15 | 320 | EMVE161□RA680MLN0S | | |
| | 3,300 | LN0 | 0.34 | 1,200 | EMVE160□RA332MLN0S | | | 68 | MH0 | 0.15 | 320 | EMVE161□RA680MMH0S | | |
| 3,300 | MH0 | 0.34 | 1,200 | EMVE160□RA332MMH0S | 100 | | | LN0 | 0.15 | 380 | EMVE161□RA101MLN0S | | | |
| 25 | 10 | E55 | 0.16 | 27 | EMVE250ARA100ME55G | | | 200 | 10 | KE0 | 0.15 | 80 | EMVE201ARA100MKE0S | |
| | 22 | F55 | 0.16 | 44 | EMVE250ARA220MF55G | 22 | | | KG5 | 0.15 | 110 | EMVE201ARA220MKG5S | | |
| | 33 | F55 | 0.16 | 50 | EMVE250ARA330MF55G | 33 | | | LH0 | 0.15 | 220 | EMVE201□RA330MLH0S | | |
| | 47 | F55 | 0.16 | 60 | EMVE250ARA470MF55G | 47 | | | LN0 | 0.15 | 270 | EMVE201□RA470MLN0S | | |
| | 100 | F80 | 0.18 | 100 | EMVE250ARA101MF80G | 47 | | | MH0 | 0.15 | 270 | EMVE201□RA470MMH0S | | |
| | 150 | HA0 | 0.18 | 240 | EMVE250ARA151MHA0G | 68 | | | MN0 | 0.15 | 330 | EMVE201□RA680MMN0S | | |
| | 220 | HA0 | 0.18 | 320 | EMVE250ARA221MHA0G | 250 | | | 4.7 | KE0 | 0.15 | 65 | EMVE251ARA4R7MKE0S | |
| | 330 | JA0 | 0.16 | 450 | EMVE250ARA331MJA0G | | | | 10 | KG5 | 0.15 | 105 | EMVE251ARA100MKG5S | |
| | 470 | JA0 | 0.18 | 490 | EMVE250ARA471MJA0G | | | | 22 | LH0 | 0.15 | 180 | EMVE251□RA220MLH0S | |
| | 1,000 | LH0 | 0.26 | 820 | EMVE250□RA102MLH0S | | | | 33 | LN0 | 0.15 | 230 | EMVE251□RA330MLN0S | |
| | 1,000 | MH0 | 0.26 | 880 | EMVE250□RA102MMH0S | | 33 | | MH0 | 0.15 | 230 | EMVE251□RA330MMH0S | | |
| | 2,200 | LN0 | 0.28 | 1,250 | EMVE250□RA222MLN0S | | 47 | | MN0 | 0.15 | 280 | EMVE251□RA470MMN0S | | |
| | 2,200 | MN0 | 0.28 | 1,300 | EMVE250□RA222MMN0S | | 400 | | 4.7 | KG5 | 0.20 | 50 | EMVE401ARA4R7MKG5S | |
| | 35 | 4.7 | D55 | 0.14 | 16 | | | | EMVE350ARA4R7MD55G | 10 | LH0 | 0.20 | 85 | EMVE401□RA100MLH0S |
| | | 10 | E55 | 0.14 | 27 | | | | EMVE350ARA100ME55G | 22 | MN0 | 0.20 | 130 | EMVE401□RA220MMN0S |
| 22 | | F55 | 0.14 | 44 | EMVE350ARA220MF55G | | | 450 | 3.3 | KE0 | 0.20 | 40 | EMVE451ARA3R3MKE0S | |
| 47 | | F80 | 0.16 | 80 | EMVE350ARA470MF80G | | | | 4.7 | KG5 | 0.20 | 50 | EMVE451ARA4R7MKG5S | |
| 100 | | F80 | 0.16 | 100 | EMVE350ARA101MF80G | | | | 10 | LH0 | 0.20 | 85 | EMVE451□RA100MLH0S | |
| 150 | | HA0 | 0.16 | 260 | EMVE350ARA151MHA0G | | | | 22 | MN0 | 0.20 | 130 | EMVE451□RA220MMN0S | |
| 220 | | JA0 | 0.16 | 375 | EMVE350ARA221MJA0G | | | | | | | | | |

□ : Enter the appropriate terminal code.

Mouser Electronics

Authorized Distributor

Click to View Pricing, Inventory, Delivery & Lifecycle Information:

[United Chemi-Con \(UCC\):](#)

[EMVE101ARA680MKE0S](#) [EMVE101ADA330MJA0G](#) [EMVE101ADA101MKE0S](#) [EMVE201ARA220MKG5S](#)
[EMVE350ARA471MKE0S](#) [EMVE500ADA470MF80G](#) [EMVE630ARA221MKE0S](#) [EMVE100ADA102MJA0G](#)
[EMVE101ADA220MHA0G](#) [EMVE101ARA680KEOS](#) [EMVE101ARA680MKD5G](#) [EMVE160ADA220ME55G](#)
[EMVE250ADA221MHA0G](#) [EMVE250ADA331MJA0G](#) [EMVE250ADA471MJA0G](#) [EMVE350ADA101MF80G](#)
[EMVE350ADA221MJA0G](#) [EMVE350ADA470MF80G](#) [EMVE500ADA100MF55G](#) [EMVE500ADA1R0MD55G](#)
[EMVE630ADA100MF55G](#) [EMVE630ADA101MJA0G](#) [EMVE500ADA101MHA0G](#) [EMVE160ADA471MHA0G](#)
[EMVE101GDA221MLN0S](#) [EMVE630ADA4R7MF55G](#) [EMVE630ADA470MHA0G](#) [EMVE630ADA3R3ME55G](#)
[EMVE6R3GDA472MLN0S](#) [EMVE630ADA330MHA0G](#) [EMVE630ADA2R2MD55G](#) [EMVE630ADA220MF80G](#)
[EMVE630ADA1R0MD55G](#) [EMVE6R3ADA101MF55G](#) [EMVE160ADA101MF55G](#) [EMVE630GDA221MLH0S](#)
[EMVE101GDA331MMN0S](#) [EMVE6R3GDA682MLN0S](#) [EMVE6R3GDA682MMN0S](#) [EMVE6R3GDA472MMH0S](#)
[EMVE101GDA101MLH0S](#) [EMVE101GDA221MMH0S](#) [EMVE101ARA470MKE0S](#) [EMVE101ARA101MKE0S](#)
[EMVE100GDA472MMN0S](#) [EMVE6R3ADA470ME55G](#) [EMVE6R3ADA221MF80G](#) [EMVE350ADA220MF55G](#)
[EMVE630GDA471MLN0S](#) [EMVE6R3GDA332MMH0S](#) [EMVE6R3GDA222MLH0S](#) [EMVE6R3ARA332MKG5S](#)
[EMVE6R3ARA222MKE0S](#) [EMVE630ADAR47MD55G](#) [EMVE6R3ADA471MHA0G](#) [EMVE6R3ADA331MHA0G](#)
[EMVE6R3ADA330ME55G](#) [EMVE6R3ADA220MD55G](#) [EMVE6R3ADA102MJA0G](#) [EMVE6R3ADA152MJA0G](#)
[EMVE630GDA471MMH0S](#) [EMVE630GDA331MMH0S](#) [EMVE630GDA331MLH0S](#) [EMVE6R3ADA681MHA0G](#)
[EMVE160ADA470MF55G](#) [EMVE101ADA470MJA0G](#) [EMVE250ADA330MF55G](#) [EMVE250ADA220MF55G](#)
[EMVE250ADA151MHA0G](#) [EMVE160ADA100MD55G](#) [EMVE250ADA100ME55G](#) [EMVE160ADA681MJA0G](#)
[EMVE160ADA221MF80G](#) [EMVE250ADA470MF55G](#) [EMVE160ADA331MHA0G](#) [EMVE250ADA101MF80G](#)
[EMVE160ARA102MKE0S](#) [EMVE160ARA152MKE0S](#) [EMVE160GDA102MLH0S](#) [EMVE160GDA222MLH0S](#)
[EMVE160GDA222MMH0S](#) [EMVE160GDA332MLN0S](#) [EMVE160GDA332MMH0S](#) [EMVE160ADA330MF55G](#)
[EMVE100ADA221MF80G](#) [EMVE350GDA102MLH0S](#) [EMVE160ADA151MF80G](#) [EMVE100GDA472MLN0S](#)
[EMVE100GDA332MMH0S](#) [EMVE100GDA332MLH0S](#) [EMVE100GDA222MLH0S](#) [EMVE100ARA222MKG5S](#)
[EMVE100ADA471MHA0G](#) [EMVE100ADA470MF55G](#) [EMVE100ADA330ME55G](#) [EMVE100ADA220ME55G](#)
[EMVE100ADA151MF80G](#) [EMVE350ADA100ME55G](#) [EMVE250GDA222MMN0S](#) [EMVE250GDA222MLN0S](#)

Компания «Океан Электроники» предлагает заключение долгосрочных отношений при поставках импортных электронных компонентов на взаимовыгодных условиях!

Наши преимущества:

- Поставка оригинальных импортных электронных компонентов напрямую с производств Америки, Европы и Азии, а так же с крупнейших складов мира;
- Широкая линейка поставок активных и пассивных импортных электронных компонентов (более 30 млн. наименований);
- Поставка сложных, дефицитных, либо снятых с производства позиций;
- Оперативные сроки поставки под заказ (от 5 рабочих дней);
- Экспресс доставка в любую точку России;
- Помощь Конструкторского Отдела и консультации квалифицированных инженеров;
- Техническая поддержка проекта, помощь в подборе аналогов, поставка прототипов;
- Поставка электронных компонентов под контролем ВП;
- Система менеджмента качества сертифицирована по Международному стандарту ISO 9001;
- При необходимости вся продукция военного и аэрокосмического назначения проходит испытания и сертификацию в лаборатории (по согласованию с заказчиком);
- Поставка специализированных компонентов военного и аэрокосмического уровня качества (Xilinx, Altera, Analog Devices, Intersil, Interpoint, Microsemi, Actel, Aeroflex, Peregrine, VPT, Syfer, Eurofarad, Texas Instruments, MS Kennedy, Miteq, Cobham, E2V, MA-COM, Hittite, Mini-Circuits, General Dynamics и др.);

Компания «Океан Электроники» является официальным дистрибьютором и эксклюзивным представителем в России одного из крупнейших производителей разъемов военного и аэрокосмического назначения «**JONHON**», а так же официальным дистрибьютором и эксклюзивным представителем в России производителя высокотехнологичных и надежных решений для передачи СВЧ сигналов «**FORSTAR**».



JONHON

«**JONHON**» (основан в 1970 г.)

Разъемы специального, военного и аэрокосмического назначения:

(Применяются в военной, авиационной, аэрокосмической, морской, железнодорожной, горно- и нефтедобывающей отраслях промышленности)

«**FORSTAR**» (основан в 1998 г.)

ВЧ соединители, коаксиальные кабели,
кабельные сборки и микроволновые компоненты:

(Применяются в телекоммуникациях гражданского и специального назначения, в средствах связи, РЛС, а так же военной, авиационной и аэрокосмической отраслях промышленности).



Телефон: 8 (812) 309-75-97 (многоканальный)

Факс: 8 (812) 320-03-32

Электронная почта: ocean@oceanchips.ru

Web: <http://oceanchips.ru/>

Адрес: 198099, г. Санкт-Петербург, ул. Калинина, д. 2, корп. 4, лит. А