

**Alchip™-MVE Series**

- Endurance : 1,000 to 2,000 hours at 105°C
- Case size range : φ 4x5.2L to φ 18x21.5L
- Solvent resistant type except 100 to 450V<sub>dc</sub> (see PRECAUTIONS AND GUIDELINES)
- RoHS2 Compliant
- AEC-Q200 compliant : Please contact Chemi-Con for more details, test data, information.

**MVE** → Longer life → MVL  
MVJ



**◆ SPECIFICATIONS**

| Items   | Characteristics   |   |     |     |     |     |     |                                      |      |             |             |   |  |
|---|---|---|-----|-----|-----|-----|-----|--------------------------------------|------|-------------|-------------|---|--|
| <b>Category Temperature Range</b>                             | -40 to +105°C   |   |     |     |     |     |     |                                      |      |             |             |   |  |
| <b>Rated Voltage Range</b>                                    | 6.3 to 450V <sub>dc</sub>   |   |     |     |     |     |     |                                      |      |             |             |   |  |
| <b>Capacitance Tolerance</b>                                  | ±20%(M) (at 20°C, 120Hz)  |   |     |     |     |     |     |                                      |      |             |             |   |  |
| <b>Leakage Current</b>  | Rated voltage (V <sub>dc</sub> )  | 6.3 to 100V                                       |     |     |     |     |     | 160 to 450V                          |      |             |             |   |  |
|   | D55 to JA0  | I=0.01CV or 3μA, whichever is greater (2 minutes) |     |     |     |     |     | —                                    |      |             |             |   |  |
|   | KE0 to MN0  | I=0.03CV or 4μA, whichever is greater (1 minute)  |     |     |     |     |     | I=0.04CV+100μA (1 minute)            |      |             |             |   |  |
|   | Where, I : Max. leakage current (μA), C : Nominal capacitance (μF), V : Rated voltage (V) (at 20°C)   |   |     |     |     |     |     |                                      |      |             |             |   |  |
| <b>Dissipation Factor (tan δ)</b>                             | See STANDARD RATINGS (at 20°C, 120Hz)   |   |     |     |     |     |     |                                      |      |             |             |   |  |
| <b>Low Temperature Characteristics (Max. Impedance Ratio)</b> | Rated voltage (V <sub>dc</sub> )  | 6.3V  | 10V | 16V | 25V | 35V | 50V | 63V                                  | 100V | 160 to 250V | 400 to 450V |   |  |
|   | D55 to JA0  | Z(-25°C)/Z(+20°C)                                 | 4   | 3   | 2   | 2   | 2   | 2                                    | 2    | 3           | —           | — |  |
|   |   | Z(-40°C)/Z(+20°C)                                 | 12  | 8   | 6   | 4   | 3   | 3                                    | 3    | 4           | —           | — |  |
|   | KE0 to MN0  | Z(-25°C)/Z(+20°C)                                 | 5   | 4   | 3   | 2   | 2   | 2                                    | 2    | 2           | 3           | 6 |  |
| Z(-40°C)/Z(+20°C)   |   | 10  | 8   | 6   | 4   | 3   | 3   | 3                                    | 3    | 6           | 10          |   |  |
| <b>Endurance</b>  | The following specifications shall be satisfied when the capacitors are restored to 20°C after the rated voltage is applied for the specified period of time at 105°C.  |   |     |     |     |     |     |                                      |      |             |             |   |  |
|   | Size code   | D55 to F80  |     |     |     |     |     | HA0 to MN0                           |      |             |             |   |  |
|   | Time  | 1,000 hours                                       |     |     |     |     |     | 2,000 hours                          |      |             |             |   |  |
|   | Capacitance change  | ≤ ±30% of the initial value                       |     |     |     |     |     | ≤ ±20% of the initial value          |      |             |             |   |  |
|   | D.F. (tan δ)  | ≤300% of the initial specified value              |     |     |     |     |     | ≤200% of the initial specified value |      |             |             |   |  |
|   | Leakage current   | ≤The initial specified value                      |     |     |     |     |     | ≤The initial specified value         |      |             |             |   |  |
| <b>Shelf Life</b>   | The following specifications shall be satisfied when the capacitors are restored to 20°C after exposing them for 1,000 hours (500 hours for B55 to F80 size) at 105°C without voltage applied. Before the measurement, the capacitor shall be preconditioned by applying voltage according to Item 4.1 of JIS C 5101-4. |   |     |     |     |     |     |                                      |      |             |             |   |  |
|   | Size code   | D55 to F80  |     |     |     |     |     | HA0 to MN0                           |      |             |             |   |  |
|   | Capacitance change  | ≤ ±25% of the initial value                       |     |     |     |     |     | ≤ ±20% of the initial value          |      |             |             |   |  |
|   | D.F. (tan δ)  | ≤200% of the initial specified value              |     |     |     |     |     | ≤200% of the initial specified value |      |             |             |   |  |
|   | Leakage current   | ≤The initial specified value                      |     |     |     |     |     | ≤The initial specified value         |      |             |             |   |  |

**◆ DIMENSIONS [mm]**

● Terminal Code : A

● Size code : D55 to MN0

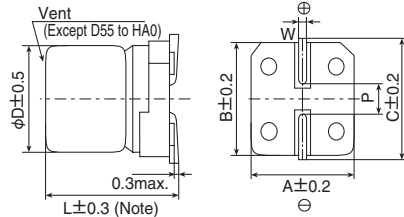

Note : L±0.5 for HA0 to MN0

● Terminal Code : G (Vibration resistant structure)

● Size code : LH0 to MN0

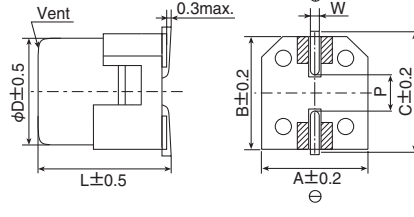

▨ : Dummy terminals

| Size code | D    | L    | A    | B    | C    | W          | P   |
|-----------|------|------|------|------|------|------------|-----|
| D55       | 4    | 5.2  | 4.3  | 4.3  | 5.1  | 0.5 to 0.8 | 1.0 |
| E55       | 5    | 5.2  | 5.3  | 5.3  | 5.9  | 0.5 to 0.8 | 1.4 |
| F55       | 6.3  | 5.2  | 6.6  | 6.6  | 7.2  | 0.5 to 0.8 | 1.9 |
| F80       | 6.3  | 7.7  | 6.6  | 6.6  | 7.2  | 0.5 to 0.8 | 1.9 |
| HA0       | 8    | 10.0 | 8.3  | 8.3  | 9.0  | 0.7 to 1.1 | 3.1 |
| JA0       | 10   | 10.0 | 10.3 | 10.3 | 11.0 | 0.7 to 1.1 | 4.5 |
| KE0       | 12.5 | 13.5 | 13.0 | 13.0 | 13.7 | 1.0 to 1.3 | 4.2 |
| KG5       | 12.5 | 16.0 | 13.0 | 13.0 | 13.7 | 1.0 to 1.3 | 4.2 |
| LH0       | 16   | 16.5 | 17.0 | 17.0 | 18.0 | 1.0 to 1.3 | 6.5 |
| LN0       | 16   | 21.5 | 17.0 | 17.0 | 18.0 | 1.0 to 1.3 | 6.5 |
| MH0       | 18   | 16.5 | 19.0 | 19.0 | 20.0 | 1.0 to 1.3 | 6.5 |
| MN0       | 18   | 21.5 | 19.0 | 19.0 | 20.0 | 1.0 to 1.3 | 6.5 |

**◆ MARKING**

**D55 to JA0**

Ex) 16V22μF



**KE0 to MN0**

Ex) 25V1,000μF



**◆ PART NUMBERING SYSTEM**

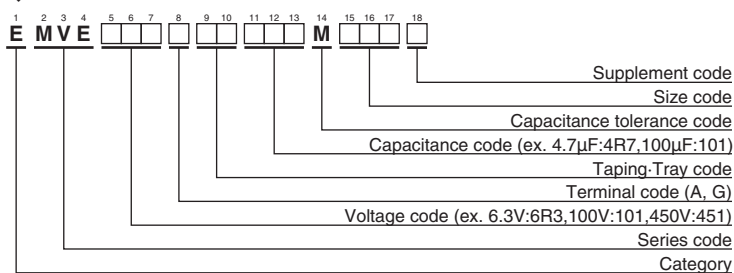

**◆ RATED RIPPLE CURRENT MULTIPLIERS**

● Frequency Multipliers

| Size code  | Capacitance(μF) | Frequency(Hz) |      |      |      |
|------------|-----------------|---------------|------|------|------|
|            |                 | 120           | 1k   | 10k  | 100k |
| D55 to JA0 | 1.0             | 1.00          | 1.50 | 1.75 | 1.80 |
|            | 2.2 to 10       | 1.00          | 1.30 | 1.40 | 1.50 |
|            | 22 to 1,500     | 1.00          | 1.05 | 1.08 | 1.08 |
| KE0 to MN0 | 3.3 to 4.7      | 1.00          | 1.75 | 2.30 | 2.50 |
|            | 10 to 68        | 1.00          | 1.50 | 1.75 | 1.80 |
|            | 100 to 1,000    | 1.00          | 1.30 | 1.40 | 1.50 |
|            | 2,200 to 6,800  | 1.00          | 1.05 | 1.08 | 1.08 |

The endurance of capacitors is reduced with internal heating produced by ripple current at the rate of halving the lifetime with every 5°C rise.

When long life performance is required in actual use, the rms ripple current has to be reduced.

Please refer to "Product code guide (surface mount type)"

◆STANDARD RATINGS

□ is not solvent resistant.

| WV (V <sub>dc</sub> ) | Cap (μF) | Size code | tan δ | Rated ripple current (mA <sub>rms</sub> /105°C, 120Hz) | Part No.           | WV (V <sub>dc</sub> ) | Cap (μF)           | Size code | tan δ              | Rated ripple current (mA <sub>rms</sub> /105°C, 120Hz) | Part No.           |                    |                    |
|-----------------------|----------|-----------|-------|--|--------------------|-----------------------|--------------------|-----------|--------------------|--|--------------------|--------------------|--------------------|
| 6.3                   | 22       | D55       | 0.30  | 22   | EMVE6R3ARA220MD55G | 35                    | 330                | JA0       | 0.16               | 450  | EMVE350ARA331MJA0G |                    |                    |
|                       | 33       | E55       | 0.30  | 34   | EMVE6R3ARA330ME55G |                       | 470                | KE0       | 0.22               | 520  | EMVE350ARA471MKE0S |                    |                    |
|                       | 47       | E55       | 0.30  | 38   | EMVE6R3ARA470ME55G |                       | 470                | LH0       | 0.22               | 650  | EMVE350□RA471MLH0S |                    |                    |
|                       | 100      | F55       | 0.30  | 69   | EMVE6R3ARA101MF55G |                       | 1,000              | LH0       | 0.22               | 750  | EMVE350□RA102MLH0S |                    |                    |
|                       | 220      | F80       | 0.45  | 120  | EMVE6R3ARA221MF80G |                       | 1,000              | MH0       | 0.22               | 1,000  | EMVE350□RA102MMH0S |                    |                    |
|                       | 330      | HA0       | 0.40  | 290  | EMVE6R3ARA331MHA0G |                       | 2,200              | MN0       | 0.24               | 1,450  | EMVE350□RA222MMN0S |                    |                    |
|                       | 470      | HA0       | 0.45  | 320  | EMVE6R3ARA471MHA0G |                       | 50                 | 1.0       | D55                | 0.12   | 8.0                | EMVE500ARA1R0MD55G |                    |
|                       | 680      | HA0       | 0.45  | 340  | EMVE6R3ARA681MHA0G |                       |                    | 2.2       | D55                | 0.12   | 12                 | EMVE500ARA2R2MD55G |                    |
|                       | 1,000    | JA0       | 0.40  | 410  | EMVE6R3ARA102MJA0G |                       |                    | 3.3       | D55                | 0.12   | 15                 | EMVE500ARA3R3MD55G |                    |
|                       | 1,500    | JA0       | 0.45  | 550  | EMVE6R3ARA152MJA0G |                       |                    | 4.7       | E55                | 0.12   | 20                 | EMVE500ARA4R7ME55G |                    |
|                       | 2,200    | KE0       | 0.40  | 680  | EMVE6R3ARA222MKE0S |                       |                    | 10        | F55                | 0.12   | 32                 | EMVE500ARA100MF55G |                    |
|                       | 2,200    | LH0       | 0.40  | 840  | EMVE6R3□RA222MLH0S |                       |                    | 33        | F80                | 0.14   | 65                 | EMVE500ARA330MF80G |                    |
|                       | 3,300    | KG5       | 0.42  | 850  | EMVE6R3ARA332MKG5S |                       |                    | 47        | F80                | 0.14   | 80                 | EMVE500ARA470MF80G |                    |
|                       | 3,300    | MH0       | 0.42  | 1,000  | EMVE6R3□RA332MMH0S |                       |                    | 100       | HA0                | 0.14   | 230                | EMVE500ARA101MHA0G |                    |
|                       | 4,700    | LN0       | 0.44  | 1,200  | EMVE6R3□RA472MLN0S |                       |                    | 220       | JA0                | 0.14   | 375                | EMVE500ARA221MJA0G |                    |
| 4,700                 | MH0      | 0.44      | 1,200 | EMVE6R3□RA472MMH0S                                     | 330                | KE0                   |                    | 0.18      | 500                | EMVE500ARA331MKE0S                                     |                    |                    |                    |
| 6,800                 | LN0      | 0.48      | 1,200 | EMVE6R3□RA682MLN0S                                     | 330                | LH0                   |                    | 0.18      | 600                | EMVE500□RA331MLH0S                                     |                    |                    |                    |
| 6,800                 | MN0      | 0.48      | 1,350 | EMVE6R3□RA682MMN0S                                     | 470                | LH0                   |                    | 0.18      | 700                | EMVE500□RA471MLH0S                                     |                    |                    |                    |
| 10                    | 22       | E55       | 0.24  | 30   | EMVE100ARA220ME55G | 470                   |                    | MH0       | 0.18               | 750  | EMVE500□RA471MMH0S |                    |                    |
|                       | 33       | E55       | 0.24  | 34   | EMVE100ARA330ME55G | 1,000                 |                    | MN0       | 0.18               | 1,200  | EMVE500□RA102MMN0S |                    |                    |
|                       | 47       | F55       | 0.24  | 48   | EMVE100ARA470MF55G | 63                    |                    | 1.0       | D55                | 0.12   | 8.0                | EMVE630ARA1R0MD55G |                    |
|                       | 100      | F55       | 0.30  | 69   | EMVE100ARA101MF55G |                       | 2.2                | D55       | 0.12               | 12   | EMVE630ARA2R2MD55G |                    |                    |
|                       | 150      | F80       | 0.35  | 100  | EMVE100ARA151MF80G |                       | 3.3                | E55       | 0.12               | 17   | EMVE630ARA3R3ME55G |                    |                    |
|                       | 220      | F80       | 0.35  | 120  | EMVE100ARA221MF80G |                       | 4.7                | F55       | 0.12               | 22   | EMVE630ARA4R7MF55G |                    |                    |
|                       | 330      | HA0       | 0.35  | 290  | EMVE100ARA331MHA0G |                       | 10                 | F55       | 0.12               | 32   | EMVE630ARA100MF55G |                    |                    |
|                       | 470      | HA0       | 0.35  | 320  | EMVE100ARA471MHA0G |                       | 22                 | F80       | 0.12               | 58   | EMVE630ARA220MF80G |                    |                    |
|                       | 1,000    | JA0       | 0.35  | 410  | EMVE100ARA102MJA0G |                       | 33                 | HA0       | 0.12               | 140  | EMVE630ARA330MHA0G |                    |                    |
|                       | 2,200    | KG5       | 0.36  | 750  | EMVE100ARA222MKG5S |                       | 47                 | HA0       | 0.12               | 170  | EMVE630ARA470MHA0G |                    |                    |
|                       | 2,200    | LH0       | 0.36  | 850  | EMVE100□RA222MLH0S |                       | 100                | JA0       | 0.12               | 310  | EMVE630ARA101MJA0G |                    |                    |
|                       | 3,300    | LH0       | 0.38  | 1,000  | EMVE100□RA332MLH0S |                       | 220                | KE0       | 0.14               | 470  | EMVE630ARA221MKE0S |                    |                    |
|                       | 3,300    | MH0       | 0.38  | 1,100  | EMVE100□RA332MMH0S |                       | 220                | LH0       | 0.14               | 560  | EMVE630□RA221MLH0S |                    |                    |
|                       | 4,700    | LN0       | 0.40  | 1,300  | EMVE100□RA472MLN0S |                       | 330                | LH0       | 0.14               | 700  | EMVE630□RA331MLH0S |                    |                    |
|                       | 4,700    | MN0       | 0.40  | 1,350  | EMVE100□RA472MMN0S |                       | 330                | MH0       | 0.14               | 750  | EMVE630□RA331MMH0S |                    |                    |
| 16                    | 10       | D55       | 0.20  | 17   | EMVE160ARA100MD55G |                       | 470                | LN0       | 0.14               | 900  | EMVE630□RA471MLN0S |                    |                    |
|                       | 22       | E55       | 0.20  | 30   | EMVE160ARA220ME55G |                       | 470                | MH0       | 0.14               | 900  | EMVE630□RA471MMH0S |                    |                    |
|                       | 33       | F55       | 0.20  | 45   | EMVE160ARA330MF55G | 22                    | HA0                | 0.12      | 100                | EMVE101ARA220MHA0G                                     |                    |                    |                    |
|                       | 47       | F55       | 0.20  | 48   | EMVE160ARA470MF55G | 33                    | JA0                | 0.12      | 150                | EMVE101ARA330MJA0G                                     |                    |                    |                    |
|                       | 100      | F55       | 0.26  | 69   | EMVE160ARA101MF55G | 47                    | KE0                | 0.10      | 250                | EMVE101ARA470MKE0S                                     |                    |                    |                    |
|                       | 150      | F80       | 0.28  | 100  | EMVE160ARA151MF80G | 68                    | KE0                | 0.10      | 300                | EMVE101ARA680MKE0S                                     |                    |                    |                    |
|                       | 220      | F80       | 0.28  | 120  | EMVE160ARA221MF80G | 100                   | KE0                | 0.10      | 380                | EMVE101ARA101MKE0S                                     |                    |                    |                    |
|                       | 330      | HA0       | 0.28  | 290  | EMVE160ARA331MHA0G | 100                   | LH0                | 0.10      | 450                | EMVE101□RA101MLH0S                                     |                    |                    |                    |
|                       | 470      | HA0       | 0.28  | 320  | EMVE160ARA471MHA0G | 220                   | LN0                | 0.10      | 750                | EMVE101□RA221MLN0S                                     |                    |                    |                    |
|                       | 680      | JA0       | 0.28  | 470  | EMVE160ARA681MJA0G | 220                   | MH0                | 0.10      | 750                | EMVE101□RA221MMH0S                                     |                    |                    |                    |
|                       | 1,000    | KE0       | 0.30  | 550  | EMVE160ARA102MKE0S | 330                   | MN0                | 0.10      | 980                | EMVE101□RA331MMN0S                                     |                    |                    |                    |
|                       | 1,000    | LH0       | 0.30  | 650  | EMVE160□RA102MLH0S | 33                    | KE0                | 0.15      | 95                 | EMVE161ARA330MKE0S                                     |                    |                    |                    |
|                       | 2,200    | LH0       | 0.32  | 950  | EMVE160□RA222MLH0S | 47                    | LH0                | 0.15      | 260                | EMVE161□RA470MLH0S                                     |                    |                    |                    |
|                       | 2,200    | MH0       | 0.32  | 1,000  | EMVE160□RA222MMH0S | 68                    | LN0                | 0.15      | 320                | EMVE161□RA680MLN0S                                     |                    |                    |                    |
|                       | 3,300    | LN0       | 0.34  | 1,200  | EMVE160□RA332MLN0S | 68                    | MH0                | 0.15      | 320                | EMVE161□RA680MMH0S                                     |                    |                    |                    |
| 3,300                 | MH0      | 0.34      | 1,200 | EMVE160□RA332MMH0S                                     | 100                | LN0                   | 0.15               | 380       | EMVE161□RA101MLN0S |  |                    |                    |                    |
| 25                    | 10       | E55       | 0.16  | 27   | EMVE250ARA100ME55G | 200                   | 10                 | KE0       | 0.15               | 80   | EMVE201ARA100MKE0S |                    |                    |
|                       | 22       | F55       | 0.16  | 44   | EMVE250ARA220MF55G |                       | 22                 | KG5       | 0.15               | 110  | EMVE201ARA220MKG5S |                    |                    |
|                       | 33       | F55       | 0.16  | 50   | EMVE250ARA330MF55G |                       | 33                 | LH0       | 0.15               | 220  | EMVE201□RA330MLH0S |                    |                    |
|                       | 47       | F55       | 0.16  | 60   | EMVE250ARA470MF55G |                       | 47                 | LN0       | 0.15               | 270  | EMVE201□RA470MLN0S |                    |                    |
|                       | 100      | F80       | 0.18  | 100  | EMVE250ARA101MF80G |                       | 47                 | MH0       | 0.15               | 270  | EMVE201□RA470MMH0S |                    |                    |
|                       | 150      | HA0       | 0.18  | 240  | EMVE250ARA151MHA0G |                       | 68                 | MN0       | 0.15               | 330  | EMVE201□RA680MMN0S |                    |                    |
|                       | 220      | HA0       | 0.18  | 320  | EMVE250ARA221MHA0G |                       | 4.7                | KE0       | 0.15               | 65   | EMVE251ARA4R7MKE0S |                    |                    |
|                       | 330      | JA0       | 0.16  | 450  | EMVE250ARA331MJA0G |                       | 10                 | KG5       | 0.15               | 105  | EMVE251ARA100MKG5S |                    |                    |
|                       | 470      | JA0       | 0.18  | 490  | EMVE250ARA471MJA0G |                       | 22                 | LH0       | 0.15               | 180  | EMVE251□RA220MLH0S |                    |                    |
|                       | 1,000    | LH0       | 0.26  | 820  | EMVE250□RA102MLH0S |                       | 33                 | LN0       | 0.15               | 230  | EMVE251□RA330MLN0S |                    |                    |
|                       | 1,000    | MH0       | 0.26  | 880  | EMVE250□RA102MMH0S |                       | 33                 | MH0       | 0.15               | 230  | EMVE251□RA330MMH0S |                    |                    |
|                       | 2,200    | LN0       | 0.28  | 1,250  | EMVE250□RA222MLN0S |                       | 47                 | MN0       | 0.15               | 280  | EMVE251□RA470MMN0S |                    |                    |
|                       | 2,200    | MN0       | 0.28  | 1,300  | EMVE250□RA222MMN0S |                       | 4.7                | KG5       | 0.20               | 50   | EMVE401ARA4R7MKG5S |                    |                    |
|                       | 35       | 4.7       | D55   | 0.14   | 16                 |                       | EMVE350ARA4R7MD55G | 400       | 10                 | LH0  | 0.20               | 85                 | EMVE401□RA100MLH0S |
|                       |          | 10        | E55   | 0.14   | 27                 |                       | EMVE350ARA100ME55G |           | 22                 | MN0  | 0.20               | 130                | EMVE401□RA220MMN0S |
| 22                    |          | F55       | 0.14  | 44   | EMVE350ARA220MF55G | 450                   | 3.3                |           | KE0                | 0.20   | 40                 | EMVE451ARA3R3MKE0S |                    |
| 47                    |          | F80       | 0.16  | 80   | EMVE350ARA470MF80G |                       | 4.7                |           | KG5                | 0.20   | 50                 | EMVE451ARA4R7MKG5S |                    |
| 100                   |          | F80       | 0.16  | 100  | EMVE350ARA101MF80G |                       | 10                 |           | LH0                | 0.20   | 85                 | EMVE451□RA100MLH0S |                    |
| 150                   |          | HA0       | 0.16  | 260  | EMVE350ARA151MHA0G |                       | 22                 |           | MN0                | 0.20   | 130                | EMVE451□RA220MMN0S |                    |
| 220                   |          | JA0       | 0.16  | 375  | EMVE350ARA221MJA0G |                       |                    |           |                    |  |                    |                    |                    |

□ : Enter the appropriate terminal code.

# Mouser Electronics

Authorized Distributor

Click to View Pricing, Inventory, Delivery & Lifecycle Information:

## [United Chemi-Con \(UCC\):](#)

[EMVE101ARA680MKE0S](#) [EMVE101ADA330MJA0G](#) [EMVE101ADA101MKE0S](#) [EMVE201ARA220MKG5S](#)  
[EMVE350ARA471MKE0S](#) [EMVE500ADA470MF80G](#) [EMVE630ARA221MKE0S](#) [EMVE100ADA102MJA0G](#)  
[EMVE101ADA220MHA0G](#) [EMVE101ARA680KEOS](#) [EMVE101ARA680MKD5G](#) [EMVE160ADA220ME55G](#)  
[EMVE250ADA221MHA0G](#) [EMVE250ADA331MJA0G](#) [EMVE250ADA471MJA0G](#) [EMVE350ADA101MF80G](#)  
[EMVE350ADA221MJA0G](#) [EMVE350ADA470MF80G](#) [EMVE500ADA100MF55G](#) [EMVE500ADA1R0MD55G](#)  
[EMVE630ADA100MF55G](#) [EMVE630ADA101MJA0G](#) [EMVE500ADA101MHA0G](#) [EMVE160ADA471MHA0G](#)  
[EMVE101GDA221MLN0S](#) [EMVE630ADA4R7MF55G](#) [EMVE630ADA470MHA0G](#) [EMVE630ADA3R3ME55G](#)  
[EMVE6R3GDA472MLN0S](#) [EMVE630ADA330MHA0G](#) [EMVE630ADA2R2MD55G](#) [EMVE630ADA220MF80G](#)  
[EMVE630ADA1R0MD55G](#) [EMVE6R3ADA101MF55G](#) [EMVE160ADA101MF55G](#) [EMVE630GDA221MLH0S](#)  
[EMVE101GDA331MMN0S](#) [EMVE6R3GDA682MLN0S](#) [EMVE6R3GDA682MMN0S](#) [EMVE6R3GDA472MMH0S](#)  
[EMVE101GDA101MLH0S](#) [EMVE101GDA221MMH0S](#) [EMVE101ARA470MKE0S](#) [EMVE101ARA101MKE0S](#)  
[EMVE100GDA472MMN0S](#) [EMVE6R3ADA470ME55G](#) [EMVE6R3ADA221MF80G](#) [EMVE350ADA220MF55G](#)  
[EMVE630GDA471MLN0S](#) [EMVE6R3GDA332MMH0S](#) [EMVE6R3GDA222MLH0S](#) [EMVE6R3ARA332MKG5S](#)  
[EMVE6R3ARA222MKE0S](#) [EMVE630ADAR47MD55G](#) [EMVE6R3ADA471MHA0G](#) [EMVE6R3ADA331MHA0G](#)  
[EMVE6R3ADA330ME55G](#) [EMVE6R3ADA220MD55G](#) [EMVE6R3ADA102MJA0G](#) [EMVE6R3ADA152MJA0G](#)  
[EMVE630GDA471MMH0S](#) [EMVE630GDA331MMH0S](#) [EMVE630GDA331MLH0S](#) [EMVE6R3ADA681MHA0G](#)  
[EMVE160ADA470MF55G](#) [EMVE101ADA470MJA0G](#) [EMVE250ADA330MF55G](#) [EMVE250ADA220MF55G](#)  
[EMVE250ADA151MHA0G](#) [EMVE160ADA100MD55G](#) [EMVE250ADA100ME55G](#) [EMVE160ADA681MJA0G](#)  
[EMVE160ADA221MF80G](#) [EMVE250ADA470MF55G](#) [EMVE160ADA331MHA0G](#) [EMVE250ADA101MF80G](#)  
[EMVE160ARA102MKE0S](#) [EMVE160ARA152MKE0S](#) [EMVE160GDA102MLH0S](#) [EMVE160GDA222MLH0S](#)  
[EMVE160GDA222MMH0S](#) [EMVE160GDA332MLN0S](#) [EMVE160GDA332MMH0S](#) [EMVE160ADA330MF55G](#)  
[EMVE100ADA221MF80G](#) [EMVE350GDA102MLH0S](#) [EMVE160ADA151MF80G](#) [EMVE100GDA472MLN0S](#)  
[EMVE100GDA332MMH0S](#) [EMVE100GDA332MLH0S](#) [EMVE100GDA222MLH0S](#) [EMVE100ARA222MKG5S](#)  
[EMVE100ADA471MHA0G](#) [EMVE100ADA470MF55G](#) [EMVE100ADA330ME55G](#) [EMVE100ADA220ME55G](#)  
[EMVE100ADA151MF80G](#) [EMVE350ADA100ME55G](#) [EMVE250GDA222MMN0S](#) [EMVE250GDA222MLN0S](#)

Компания «Океан Электроники» предлагает заключение долгосрочных отношений при поставках импортных электронных компонентов на взаимовыгодных условиях!

Наши преимущества:

- Поставка оригинальных импортных электронных компонентов напрямую с производств Америки, Европы и Азии, а так же с крупнейших складов мира;
- Широкая линейка поставок активных и пассивных импортных электронных компонентов (более 30 млн. наименований);
- Поставка сложных, дефицитных, либо снятых с производства позиций;
- Оперативные сроки поставки под заказ (от 5 рабочих дней);
- Экспресс доставка в любую точку России;
- Помощь Конструкторского Отдела и консультации квалифицированных инженеров;
- Техническая поддержка проекта, помощь в подборе аналогов, поставка прототипов;
- Поставка электронных компонентов под контролем ВП;
- Система менеджмента качества сертифицирована по Международному стандарту ISO 9001;
- При необходимости вся продукция военного и аэрокосмического назначения проходит испытания и сертификацию в лаборатории (по согласованию с заказчиком);
- Поставка специализированных компонентов военного и аэрокосмического уровня качества (Xilinx, Altera, Analog Devices, Intersil, Interpoint, Microsemi, Actel, Aeroflex, Peregrine, VPT, Syfer, Eurofarad, Texas Instruments, MS Kennedy, Miteq, Cobham, E2V, MA-COM, Hittite, Mini-Circuits, General Dynamics и др.);

Компания «Океан Электроники» является официальным дистрибьютором и эксклюзивным представителем в России одного из крупнейших производителей разъемов военного и аэрокосмического назначения «JONHON», а так же официальным дистрибьютором и эксклюзивным представителем в России производителя высокотехнологичных и надежных решений для передачи СВЧ сигналов «FORSTAR».



## JONHON

«JONHON» (основан в 1970 г.)

Разъемы специального, военного и аэрокосмического назначения:

(Применяются в военной, авиационной, аэрокосмической, морской, железнодорожной, горно- и нефтедобывающей отраслях промышленности)

«FORSTAR» (основан в 1998 г.)

ВЧ соединители, коаксиальные кабели,  
кабельные сборки и микроволновые компоненты:

(Применяются в телекоммуникациях гражданского и специального назначения, в средствах связи, РЛС, а так же военной, авиационной и аэрокосмической отраслях промышленности).



Телефон: 8 (812) 309-75-97 (многоканальный)

Факс: 8 (812) 320-03-32

Электронная почта: [ocean@oceanchips.ru](mailto:ocean@oceanchips.ru)

Web: <http://oceanchips.ru/>

Адрес: 198099, г. Санкт-Петербург, ул. Калинина, д. 2, корп. 4, лит. А