

PT65 SERIES ROTARY DIP SWITCHES

Outside the U.S. and the UK,
this series is sold as the CR36
series, with a blue case.

FEATURES

- 3 + 3 terminal layout.
- Completely sealed for process compatibility.
- 4, 6, 8, 10 or 16 positions w/extensive codings.
- Precision designed detent action.
- Compact size.
- High reliability & long life.
- Clockwise or counterclockwise settable.
- Solder coated terminals.



MATERIALS

| | |
|------------------|---|
| Base | UL94V-O, high temperature thermoplastic |
| Cover | UL94V-O, high temperature thermoplastic |
| Actuator | POM |
| Contacts | Gold over nickel plated bronze |
| Terminals | Gold over nickel plated bronze |
| Terminal sealing | Molded-in |
| Actuator seal | 'O'-ring |

GENERAL SPECIFICATIONS

ELECTRICALS

| | |
|----------------------------|----------------|
| Operating voltage | 24 VDC max. |
| Contact rating, static | 400 mA max. |
| Contact rating, dynamic | 150 mA max. |
| Switching capacity | 1.5 VA max. |
| Initial contact resistance | < 80 milliohms |
| Insulation resistance | > 100 megohms |

MECHANICALS, THERMALS

| | |
|-----------------------------|----------------------------------|
| Torque | 7.0 inch-oz. min. (0.7 Ncm min.) |
| Expected life | 10,000 switching operations |
| Contact force | 15 grams min. |
| Operating temperature range | -20°C to 70°C |

SOLDERING RECOMMENDATIONS

| | |
|------------------|--|
| Hand soldering | 340°C max. for 2 seconds max. (40 watt iron max.) |
| Wave soldering | 260°C max. for 10 seconds max. |
| Solvent washing | Freons or alcohol. (Do not use chlorinated solvents) |
| Aqueous cleaning | Deionized water preferred |

SPECIFICATIONS SUBJECT TO CHANGE WITHOUT NOTICE.

| | | | | |
|------------------------------|---|---|---|---|
| CODE 05 GRAY CODE | | | | |
| 16 Positions | | | | |
| Dial No. | 1 | 2 | 4 | 8 |
| 0 | | | | |
| 1 | ● | | | |
| 2 | ● | ● | | |
| 3 | | ● | | |
| 4 | | ● | ● | |
| 5 | ● | ● | ● | |
| 6 | ● | | ● | |
| 7 | | | ● | |
| 8 | | | ● | ● |
| 9 | ● | ● | ● | ● |
| A | ● | ● | ● | ● |
| B | | ● | ● | ● |
| C | | ● | | ● |
| D | ● | ● | ● | ● |
| E | ● | | | ● |
| F | | | | ● |

CODES

NOTE: For each dial position in tables, Common terminal(s) (C) are connected to terminal number(s) indicated - i.e. - none or combinations of 1, 2, 3, 4 or 8. Each model in this series has 2 Common terminals except codes 11 and 24 which have one.

| | |
|---------------------------|---|
| CODE 11 ON/OFF | |
| 4 Positions | |
| Dial No. | 1 |
| 0 | |
| 1 | ● |
| 0 | |
| 1 | ● |

| | | |
|------------------------|---|---|
| CODE 12 BCD | | |
| 4 Positions | | |
| Dial No. | 1 | 2 |
| 0 | | |
| 1 | ● | |
| 2 | | ● |
| 3 | ● | ● |

| | | | | |
|----------------------------|---|---|---|---|
| CODE 21 DECIMAL | | | | |
| 4 Positions | | | | |
| Dial No. | 1 | 2 | 3 | 4 |
| 1 | ● | | | |
| 2 | | ● | | |
| 3 | | | ● | |
| 0 | | | | ● |

| | | | | |
|------------------------------|---|---|---|--|
| CODES 24 & 25 BCD | | | | |
| 6 Positions | | | | |
| Dial No. | 1 | 2 | 4 | |
| 0 | | | | |
| 1 | ● | | | |
| 2 | | ● | | |
| 3 | ● | ● | | |
| 4 | | | ● | |
| 5 | ● | | ● | |

| | | | | |
|--------------------------|---|---|---|--|
| CODE 26 OCTAL | | | | |
| 8 Positions | | | | |
| Dial No. | 1 | 2 | 4 | |
| 0 | | | | |
| 1 | ● | | | |
| 2 | | ● | | |
| 3 | ● | ● | | |
| 4 | | | ● | |
| 5 | ● | | ● | |
| 6 | | ● | ● | |
| 7 | ● | ● | ● | |

| | | | | | |
|-------------------------------------|---|---|---|---|--|
| CODE 27 OCTAL COMPLEMENT | | | | | |
| 8 Positions | | | | | |
| Dial No. | 1 | 2 | 4 | 8 | |
| 0 | ● | ● | ● | ● | |
| 1 | | ● | ● | ● | |
| 2 | ● | | ● | ● | |
| 3 | | | ● | ● | |
| 4 | ● | ● | | ● | |
| 5 | | ● | | ● | |
| 6 | ● | | ● | ● | |
| 7 | | | | ● | |

| | | | | | |
|--------------------------------------|---|---|---|---|--|
| BINARY CODED DECIMAL (01) | | | | | |
| 10 Positions | | | | | |
| Dial No. | 1 | 2 | 4 | 8 | |
| 0 | | | | | |
| 1 | ● | | | | |
| 2 | | ● | | | |
| 3 | ● | ● | | | |
| 4 | | | ● | | |
| 5 | ● | | ● | | |
| 6 | | ● | ● | | |
| 7 | ● | ● | ● | | |
| 8 | | | | ● | |
| 9 | ● | | | ● | |

| | | | | | |
|---|---|---|---|---|--|
| COMP. OF BINARY CODED DECIMAL (02) | | | | | |
| 10 Positions | | | | | |
| Dial No. | 1 | 2 | 4 | 8 | |
| 0 | ● | ● | ● | ● | |
| 1 | | ● | ● | ● | |
| 2 | ● | | ● | ● | |
| 3 | | ● | ● | ● | |
| 4 | ● | ● | | ● | |
| 5 | | ● | ● | ● | |
| 6 | ● | | ● | ● | |
| 7 | | ● | ● | ● | |
| 8 | ● | ● | ● | | |
| 9 | | ● | ● | ● | |

| | | | | | |
|--|---|---|---|---|--|
| BINARY CODED HEXADECIMAL (03) | | | | | |
| 16 Positions | | | | | |
| Dial No. | 1 | 2 | 4 | 8 | |
| 0 | | | | | |
| 1 | ● | | | | |
| 2 | | ● | | | |
| 3 | ● | ● | | | |
| 4 | | | ● | | |
| 5 | ● | | ● | | |
| 6 | | ● | ● | | |
| 7 | ● | ● | ● | | |
| 8 | | | | ● | |
| 9 | ● | | | ● | |
| A | | ● | ● | ● | |
| B | ● | ● | ● | ● | |
| C | | | ● | ● | |
| D | ● | | ● | ● | |
| E | | ● | ● | ● | |
| F | ● | ● | ● | ● | |

| | | | | | |
|--|---|---|---|---|--|
| COMP. OF BINARY CODED HEXADEC. (06) | | | | | |
| 16 Positions | | | | | |
| Dial No. | 1 | 2 | 4 | 8 | |
| 0 | ● | ● | ● | ● | |
| 1 | | ● | ● | ● | |
| 2 | ● | | ● | ● | |
| 3 | | | ● | ● | |
| 4 | ● | ● | | ● | |
| 5 | | ● | | ● | |
| 6 | ● | | ● | ● | |
| 7 | | | | ● | |
| 8 | ● | ● | ● | | |
| 9 | | ● | ● | | |
| A | ● | | ● | | |
| B | | ● | ● | | |
| C | ● | ● | | | |
| D | | ● | | | |
| E | ● | | ● | | |
| F | | | | | |

PT65 SERIES

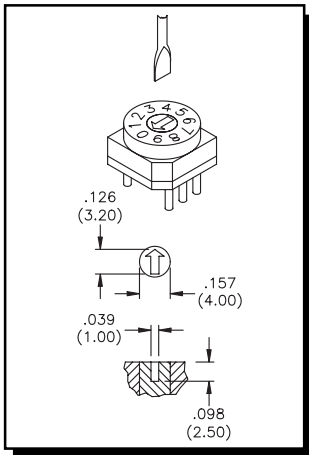

| Arrow shaped slot Actuator Models | | Complete Model No. by Terminal Style | | |
|--------------------------------------|-----------|--------------------------------------|--------------------|--------------------|
| | | Straight | Right Angle | |
| | | | Pitch | |
| Code (see truth tables) | Positions | .100" (2,54) | .200" (5,08) | |
| Binary Coded Decimal | 10 | PT65101 | PT65101L254 | PT65101L508 |
| Comp. of Binary Coded Dec. | 10 | PT65102 | PT65102L254 | PT65102L508 |
| Binary Coded Hexadecimal | 16 | PT65103 | PT65103L254 | PT65103L508 |
| Comp. of Binary Coded Hex. | 16 | PT65106 | PT65106L254 | PT65106L508 |
| Code 12, Binary Coded Dec. | 4 | PT65112 | PT65112L254 | PT65112L508 |
| Code 21, Decimal | 4 | PT65121 | PT65121L254 | PT65121L508 |
| Code 25, Binary Coded Dec. | 6 | PT65125 | PT65125L254 | PT65125L508 |
| Code 26, Octal | 8 | PT65126 | PT65126L254 | PT65126L508 |
| Code 27, Octal complement | 8 | PT65127 | PT65127L254 | PT65127L508 |

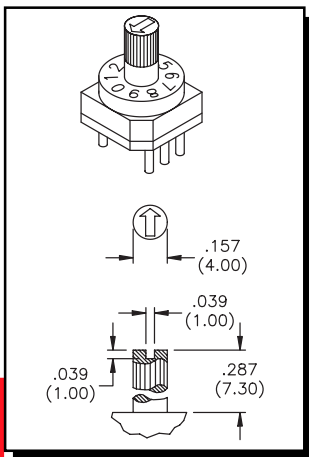

| Spindle Actuator Models | | Complete Model No. by Terminal Style | | |
|----------------------------|-----------|--------------------------------------|--------------------|--------------------|
| | | Straight | Right Angle | |
| | | | Pitch | |
| Code (see truth tables) | Positions | .100" (2,54) | .200" (5,08) | |
| Binary Coded Decimal | 10 | PT65301 | PT65301L254 | PT65301L508 |
| Comp. of Binary Coded Dec. | 10 | PT65302 | PT65302L254 | PT65302L508 |
| Binary Coded Hexadecimal | 16 | PT65303 | PT65303L254 | PT65303L508 |
| Code 12, Binary Coded Dec. | 4 | PT65312 | PT65312L254 | PT65312L508 |
| Code 21, Decimal | 4 | PT65321 | PT65321L254 | PT65321L508 |
| Code 26, Octal | 8 | PT65326 | PT65326L254 | PT65326L508 |
| Code 27, Octal complement | 8 | PT65327 | PT65327L254 | PT65327L508 |

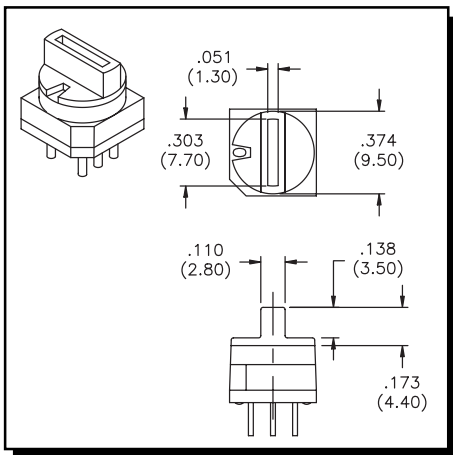

| Segment Wheel Actuator Models | | Complete Model No. by Terminal Style | | |
|----------------------------------|-----------|--------------------------------------|--------------------|--------------------|
| | | Straight | Right Angle | |
| | | | Pitch | |
| Code (see truth tables) | Positions | .100" (2,54) | .200" (5,08) | |
| Binary Coded Decimal | 10 | PT65501 | PT65501L254 | PT65501L508 |
| Comp. of Binary Coded Dec. | 10 | PT65502 | PT65502L254 | PT65502L508 |
| Binary Coded Hexadecimal | 16 | PT65503 | PT65503L254 | PT65503L508 |
| Code 21, Decimal | 4 | PT65521 | PT65521L254 | PT65521L508 |
| Code 26, Octal | 8 | PT65526 | PT65526L254 | PT65526L508 |

All models listed on this page have 2 Common terminals except Code 11 and Code 24 which have one.

Other codes are available - consult factory.

SPECIFICATIONS SUBJECT TO CHANGE WITHOUT NOTICE.

SPECIFICATIONS SUBJECT TO CHANGE WITHOUT NOTICE.

PT65 SERIES

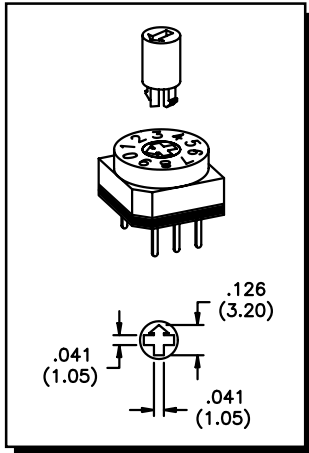

| Cross shaped slot Actuator Models | | Complete Model No. by Terminal Style | | |
|--------------------------------------|-----------|--------------------------------------|--------------------|--------------------|
| | | Straight | Right Angle | |
| | | | Pitch | |
| Code (see truth tables) | Positions | .100" (2,54) | .200"(5,08) | |
| Binary Coded Decimal | 10 | PT65701 | PT65701L254 | PT65701L508 |
| Comp. of Binary Coded Dec. | 10 | PT65702 | PT65702L254 | PT65702L508 |
| Binary Coded Hexadecimal | 16 | PT65703 | PT65703L254 | PT65703L508 |
| Code 05, Gray Code | 16 | PT65705 | PT65705L254 | PT65705L508 |
| Comp. of Binary Coded Hex. | 16 | PT65706 | PT65706L254 | PT65706L508 |
| Code 11, ON/OFF | 4 | PT65711 | PT65711L254 | PT65711L508 |
| Code 12, Hexadecimal | 4 | PT65712 | PT65712L254 | PT65712L508 |
| Code 21, Decimal | 4 | PT65721 | PT65721L254 | PT65721L508 |
| Code 24, Binary Coded Dec. | 6 | PT65724 | PT65724L254 | PT65724L508 |
| Code 25, Binary Coded Dec. | 6 | PT65725 | PT65725L254 | PT65725L508 |
| Code 26, Octal | 8 | PT65726 | PT65726L254 | PT65726L508 |
| Code 27, Octal complement | 8 | PT65727 | PT65727L254 | PT65727L508 |

Operating Elements snap-fit securely into PT65 (& P60A) Series switch models with cross shaped slot actuators. Order separately by Model number shown below and indicate color.



Spindle colors: red, gray or black (consult factory for color codes)

| US Model No. | Dim. A | EU Model No. |
|-------------------|--------|--------------|
| SAPT65473 | .287 | N/A |
| SAPT654116 | .457 | U4820 |
| SAPT654133 | .524 | U4830 |

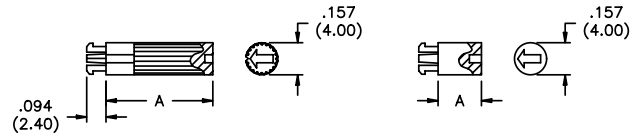

Short spindle above applies to model SAPT65473 only

Segment wheel colors: yellow, red, green, blue, gray or black (consult factory for color codes)

| US Model No. | EU Model No. |
|-------------------|--------------|
| SRPT659544 | U4940 |

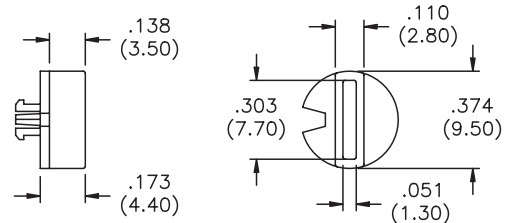

Knob color: red

| US Model No. | Dim. A | EU Model No. |
|---------------------|--------|--------------|
| DKPT6510553 | .209 | U4906 |
| DKPT65105157 | .618 | U4916 |
| DKPT65105291 | 1.146 | N/A |
| DKPT65105344 | 1.354 | N/A |

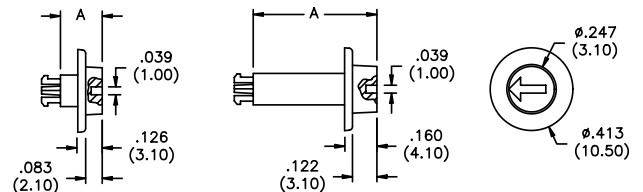

Short knob above applies to model DKPT6510553 only

Wheel color: white

| US Model No. | Dim. A | EU Model No. |
|-------------------|--------|----------------|
| DRPT651772 | .283 | U4847/1 |

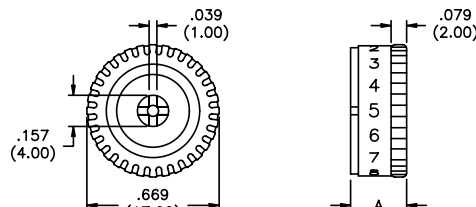

printing on request
(fits PT65 models only)

P

PT65 SERIES

PT65 SERIES STANDARD OPTIONS :

Actuators

- 1 Arrow shaped slot
- 3 Spindle
- 5 Segment wheel
- 7 Cross shaped slot

Codes

- 01 BCD
 - 02 BCD complement
 - 03 Hexadecimal
 - 06 Hexadecimal Comp.
- See other available codes on page G17

Terminals

- None Straight
- V Crimped
- L254 Rt. angle 2.54 (.100")
- L508 Rt. angle 5.08 (.200")

ORDER GUIDE:

Make selections from the above table in sequence to specify a complete model number.

Note that 'None' indicates that no option suffix is required.

Example; **PT65101V**
 Series Actuator Terminals Code

| MECHANICAL OUTLINES | |
|--|--------------------|
| Terminal option suffix*: | Mtg. hole pattern: |
| NONE Straight terminals | |
| V Crimped terminals | |
| L254 Right angle terminals | |
| L508 Right angle terminals | |

* 'None' indicates no option suffix is required.

SPECIFICATIONS SUBJECT TO CHANGE WITHOUT NOTICE.

TERMINAL IDENTIFICATION FOR ALL MODELS (viewed from top of switch inserted into printed circuit board).

Refer to TRUTH TABLES on page G17.

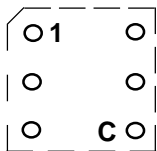

Code 11

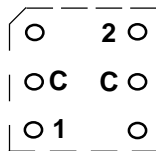

Code 12

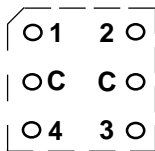

Code 21

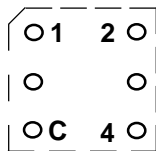

Code 24

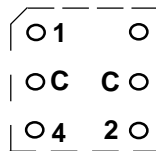

Codes 25 & 26

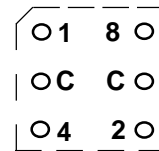

Code 27 and
10 & 16 pos. models

Компания «Океан Электроники» предлагает заключение долгосрочных отношений при поставках импортных электронных компонентов на взаимовыгодных условиях!

Наши преимущества:

- Поставка оригинальных импортных электронных компонентов напрямую с производств Америки, Европы и Азии, а так же с крупнейших складов мира;
- Широкая линейка поставок активных и пассивных импортных электронных компонентов (более 30 млн. наименований);
- Поставка сложных, дефицитных, либо снятых с производства позиций;
- Оперативные сроки поставки под заказ (от 5 рабочих дней);
- Экспресс доставка в любую точку России;
- Помощь Конструкторского Отдела и консультации квалифицированных инженеров;
- Техническая поддержка проекта, помощь в подборе аналогов, поставка прототипов;
- Поставка электронных компонентов под контролем ВП;
- Система менеджмента качества сертифицирована по Международному стандарту ISO 9001;
- При необходимости вся продукция военного и аэрокосмического назначения проходит испытания и сертификацию в лаборатории (по согласованию с заказчиком);
- Поставка специализированных компонентов военного и аэрокосмического уровня качества (Xilinx, Altera, Analog Devices, Intersil, Interpoint, Microsemi, Actel, Aeroflex, Peregrine, VPT, Syfer, Eurofarad, Texas Instruments, MS Kennedy, Miteq, Cobham, E2V, MA-COM, Hittite, Mini-Circuits, General Dynamics и др.);

Компания «Океан Электроники» является официальным дистрибьютором и эксклюзивным представителем в России одного из крупнейших производителей разъемов военного и аэрокосмического назначения «JONHON», а так же официальным дистрибьютором и эксклюзивным представителем в России производителя высокотехнологичных и надежных решений для передачи СВЧ сигналов «FORSTAR».



JONHON

«JONHON» (основан в 1970 г.)

Разъемы специального, военного и аэрокосмического назначения:

(Применяются в военной, авиационной, аэрокосмической, морской, железнодорожной, горно- и нефтедобывающей отраслях промышленности)

«FORSTAR» (основан в 1998 г.)

ВЧ соединители, коаксиальные кабели, кабельные сборки и микроволновые компоненты:

(Применяются в телекоммуникациях гражданского и специального назначения, в средствах связи, РЛС, а так же военной, авиационной и аэрокосмической отраслях промышленности).



Телефон: 8 (812) 309-75-97 (многоканальный)

Факс: 8 (812) 320-03-32

Электронная почта: ocean@oceanchips.ru

Web: <http://oceanchips.ru/>

Адрес: 198099, г. Санкт-Петербург, ул. Калинина, д. 2, корп. 4, лит. А