

THIS DRAWING IS UNPUBLISHED. RELEASED FOR PUBLICATION  
 © COPYRIGHT copyright.d8te- ALL RIGHTS RESERVED.

| REVISIONS |     |                         |           |       |
|-----------|-----|-------------------------|-----------|-------|
| P         | LTR | DESCRIPTION             | DATE      | APVD  |
|           | A   | RELEASED FOR PRODUCTION | 23OCT2017 | RK PO |
|           |     |                         |           |       |
|           |     |                         |           |       |

NOTES:

- 1 LID NOT ASSEMBLED WITH LOWER PART. ENCLOSED LOOSELY
- 2 FLAP NOT ASSEMBLED WITH LOWER PART. ENCLOSED LOOSELY
- 3 PART NUMBER.
- 4 PRODUCTION DATE (YYMMDD)
- 5 MANUFACTURING LOCATION CODE.
- 6 OMEGA CLIP AS LOOSE PIECE IN BOX, PRODUCT SPEC. 108-94176
- 7 MODEL CODE ACCORDING TE-SPEC. 404-74000-1
- 8 CONSECUTIVE SERIAL NUMBER
- 9 TEST EQUIPMENT NUMBER
- 10 DIODES WELDED ON CONTACT RAIL
- 11. MUST COMPLY WITH DIRECTIVE 2002/95/EC (ROHS).
- 12. THIS PRODUCT HAS NOT COMPLETED VALIDATION TESTING.

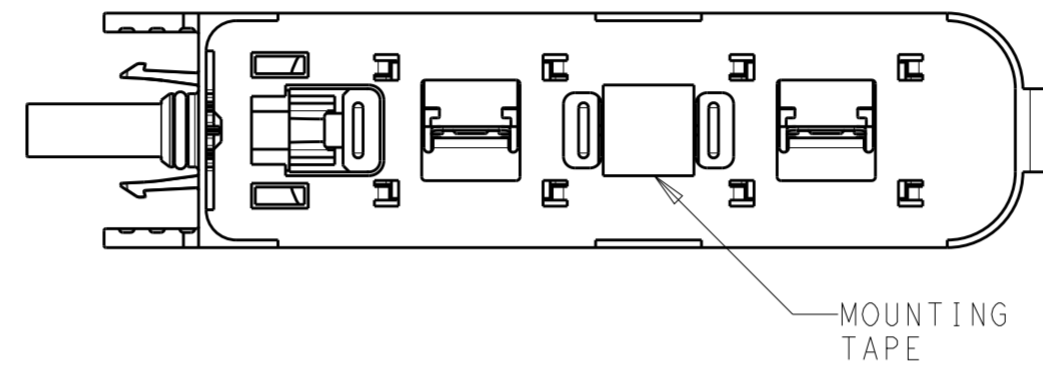

BOTTOM VIEW OF TYPICAL ASSEMBLY WHEN MOUNTING TAPE IS APPLIED

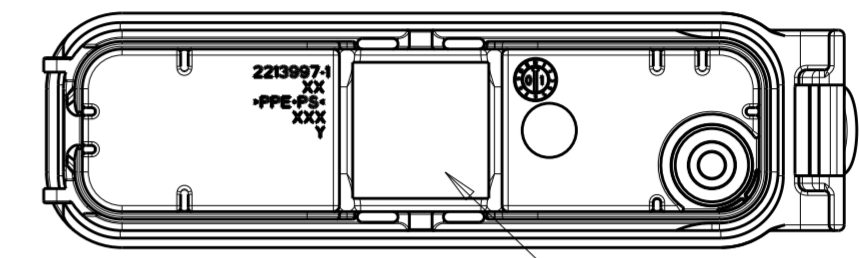

BOTTOM VIEW OF LID SUBASSEMBLY WHEN THERMAL INTERFACE MATERIAL IS APPLIED

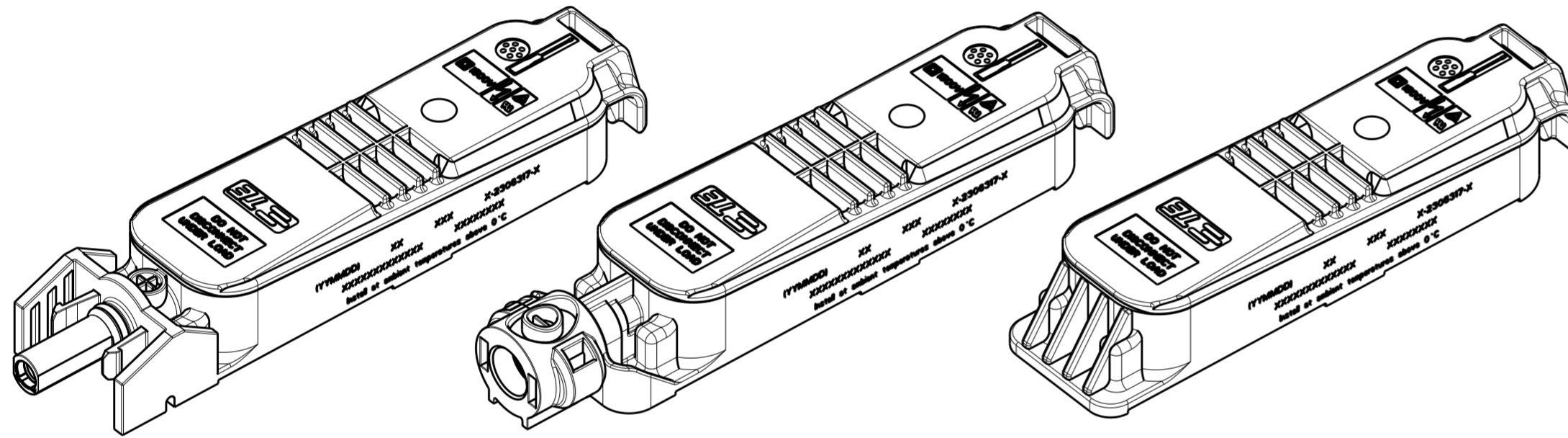

|                |      |             |     |     |             |
|----------------|------|-------------|-----|-----|-------------|
| PVEDGE2GGA1V_2 | 36.0 | EAST/WEST   | YES | YES | 7-2306317-5 |
| PVEDGE2DGA1V_2 | 55.2 | EAST/WEST   | YES | YES | 7-2306317-2 |
| PVEDGE2FGA1V_2 | 58.7 | EAST/WEST   | YES | YES | 7-2306317-1 |
| PVEDGE2GGA1V_2 | 36.0 | EAST/WEST   | NO  | YES | 6-2306317-5 |
| PVEDGE2DGA1V_2 | 55.2 | EAST/WEST   | NO  | YES | 6-2306317-2 |
| PVEDGE2FGA1V_2 | 58.7 | EAST/WEST   | NO  | YES | 6-2306317-1 |
| PVEDGE2GGA1T_2 | 36.0 | EAST/WEST   | YES | NO  | 5-2306317-5 |
| PVEDGE2DGA1T_2 | 55.2 | EAST/WEST   | YES | NO  | 5-2306317-2 |
| PVEDGE2FGA1T_2 | 58.7 | EAST/WEST   | YES | NO  | 5-2306317-1 |
| PVEDGE2GGA1T_2 | 36.0 | EAST/WEST   | NO  | NO  | 4-2306317-5 |
| PVEDGE2DGA1T_2 | 55.2 | EAST/WEST   | NO  | NO  | 4-2306317-2 |
| PVEDGE2FGA1T_2 | 58.7 | EAST/WEST   | NO  | NO  | 4-2306317-1 |
| PVEDGE2GGA1V_2 | 36.0 | NORTH/SOUTH | YES | YES | 3-2306317-5 |
| PVEDGE2DGA1V_2 | 55.2 | NORTH/SOUTH | YES | YES | 3-2306317-2 |
| PVEDGE2FGA1V_2 | 58.7 | NORTH/SOUTH | YES | YES | 3-2306317-1 |
| PVEDGE2GGA1V_2 | 36.0 | NORTH/SOUTH | NO  | YES | 2-2306317-5 |
| PVEDGE2DGA1V_2 | 55.2 | NORTH/SOUTH | NO  | YES | 2-2306317-2 |
| PVEDGE2FGA1V_2 | 58.7 | NORTH/SOUTH | NO  | YES | 2-2306317-1 |
| PVEDGE2GGA1T_2 | 36.0 | NORTH/SOUTH | YES | NO  | 1-2306317-5 |
| PVEDGE2DGA1T_2 | 55.2 | NORTH/SOUTH | YES | NO  | 1-2306317-2 |
| PVEDGE2FGA1T_2 | 58.7 | NORTH/SOUTH | YES | NO  | 1-2306317-1 |
| PVEDGE2GGA1T_2 | 36.0 | NORTH/SOUTH | NO  | NO  | 2306317-5   |
| PVEDGE2DGA1T_2 | 55.2 | NORTH/SOUTH | NO  | NO  | 2306317-2   |
| PVEDGE2FGA1T_2 | 58.7 | NORTH/SOUTH | NO  | NO  | 2306317-1   |

|                 |                 |                            |                |
|-----------------|-----------------|----------------------------|----------------|
| TIN OVER NICKEL | COPPER ALLOY    | INTERFACE CONTACT-SOCKET   | 11             |
| TIN OVER NICKEL | COPPER ALLOY    | INTERFACE CONTACT-PIN      | 10             |
| -               | -               | THERMAL INTERFACE MATERIAL | 9              |
| -               | -               | BYPASS DIODE: TYPE SL2020A | 8              |
| GRAY            | PPE+PS          | MEMBRANE RETAINER          | 7              |
| -               | -               | MEMBRANE VENT              | 6              |
| PLAIN           | STAINLESS STEEL | OMEGA CLIP                 | 5 <sup>6</sup> |
| TIN             | COPPER ALLOY    | CONTACT RAIL               | 4              |
| BLACK           | PPE+PS          | BOX, LOWER HOUSING         | 3              |
| RED             | SILICONE        | O-RING SEAL                | 2              |
| BLACK           | PPE+PS          | BOX, LID                   | 1 <sup>1</sup> |
| COLOR/FINISH    | MATERIAL        | DESCRIPTION                | ITEM NO.       |

|  |       |                              |                |           |
|--|-------|------------------------------|----------------|-----------|
| THIS DRAWING IS A CONTROLLED DOCUMENT. |       | DWN                          | RAVLS          | 13AUG2016 |
| DIMENSIONS: mm                         |       | CHK                          | GINGRICH CHUCK | 13AUG2016 |
| TOLERANCES UNLESS OTHERWISE SPECIFIED: |       | APVD                         | GINGRICH CHUCK | 13AUG2016 |
| 0 PLC                                  | ±0.50 | PRODUCT SPEC                 |                |           |
| 1 PLC                                  | ±0.25 | 108-32122                    |                |           |
| 2 PLC                                  | ±0.13 | APPLICATION SPEC             |                |           |
| 3 PLC                                  | ±     | 114-32157                    |                |           |
| 4 PLC                                  | ±     | WEIGHT                       |                |           |
| ANGLES                                 | ±     | A2                           |                |           |
| FINISH                                 | -     | SCALE 1:1 SHEET 1 OF 4 REV A |                |           |
| MATERIAL                               | 1     | CUSTOMER DRAWING             |                |           |

**STE** TE Connectivity

NAME PV EDGE ASSEMBLY, WITHOUT FLAP, OMEGA CLIP

SIZE CAGE CODE DRAWING NO RESTRICTED TO

C-2306317

THIS DRAWING IS UNPUBLISHED. RELEASED FOR PUBLICATION  
 © COPYRIGHT copyright.d8te- ALL RIGHTS RESERVED.

| REVISIONS |     |             |      |      |
|-----------|-----|-------------|------|------|
| P         | LTR | DESCRIPTION | DATE | APVD |
| -         |     | SEE SHEET 1 | -    | -    |

LID NOT SHOWN FOR REFERENCE ONLY

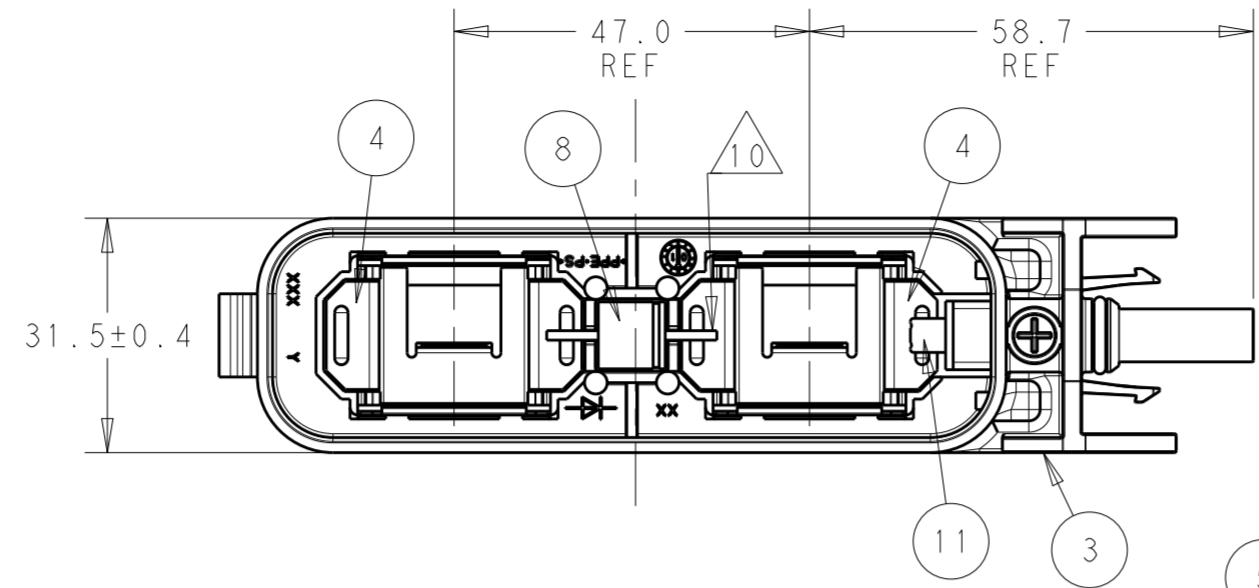

LID NOT SHOWN FOR REFERENCE ONLY

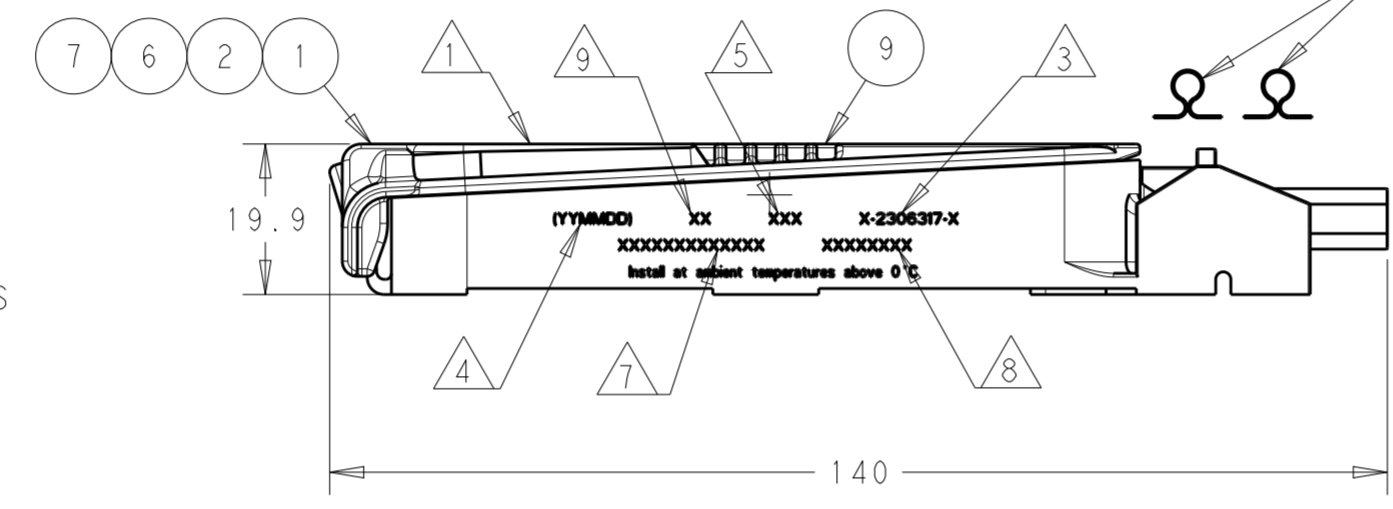
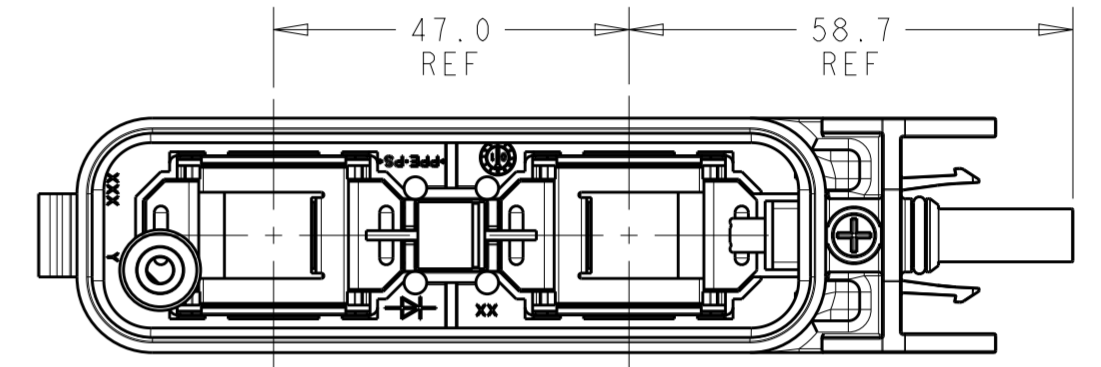

NORTH-SOUTH VERSIONS  
 2306317-1  
 1-2306317-1  
 2-2306317-1  
 3-2306317-1  
 SHOWN

EAST-WEST VERSIONS  
 4-2306317-1  
 5-2306317-1  
 6-2306317-1  
 7-2306317-1  
 SAME AS N-S VERSIONS  
 EXCEPT AS SHOWN

LID NOT SHOWN FOR REFERENCE ONLY

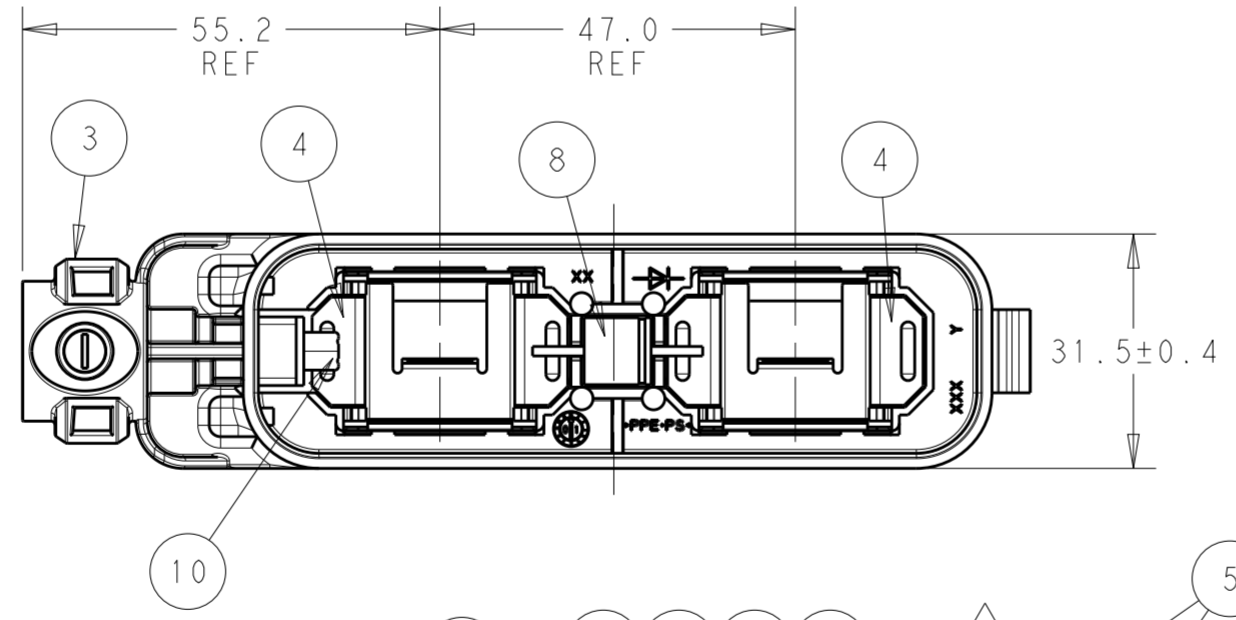

LID NOT SHOWN FOR REFERENCE ONLY

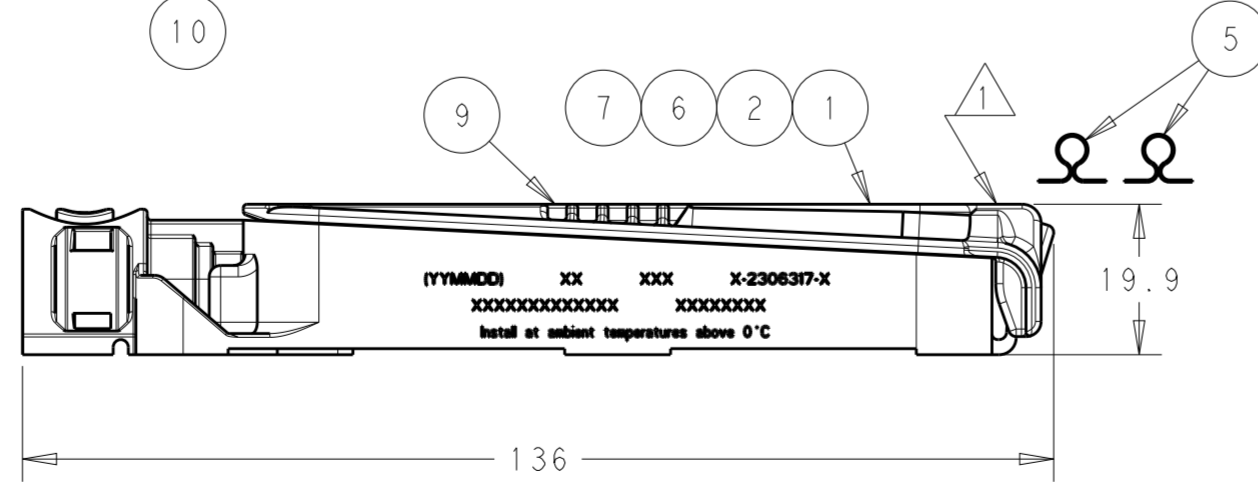
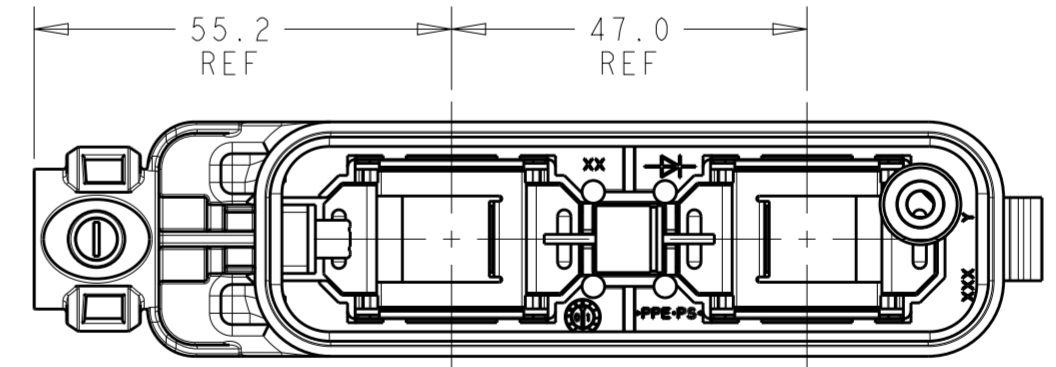

EAST-WEST VERSIONS  
 4-2306317-2  
 5-2306317-2  
 6-2306317-2  
 7-2306317-2  
 SAME AS N-S VERSIONS  
 EXCEPT AS SHOWN

NORTH-SOUTH VERSIONS  
 2306317-2  
 1-2306317-2  
 2-2306317-2  
 3-2306317-2  
 SHOWN

|   |  |                                     |                           |                        |
|---|--|-------------------------------------|---------------------------|------------------------|
| THIS DRAWING IS A CONTROLLED DOCUMENT.  |  | DWN<br>RAVLS<br>13AUG2016           | TE Connectivity           |                        |
| DIMENSIONS:<br>mm   |  | CHK<br>GINGRICH CHUCK<br>13AUG2016  |                           |                        |
| TOLERANCES UNLESS OTHERWISE SPECIFIED:  |  | APVD<br>GINGRICH CHUCK<br>13AUG2016 | PRODUCT SPEC<br>108-32122 | RESTRICTED TO          |
| 0 PLC ±0.50<br>1 PLC ±0.25<br>2 PLC ±0.13<br>3 PLC ±<br>4 PLC ±<br>ANGLES ±<br>FINISH - |  | APPLICATION SPEC<br>114-32157       | SIZE<br>A2                | CAGE CODE<br>C-2306317 |
| MATERIAL  |  | WEIGHT                              | SCALE<br>5:1              | SHEET<br>2 OF 4        |
|   |  | CUSTOMER DRAWING                    | REV<br>A                  |                        |

THIS DRAWING IS UNPUBLISHED. RELEASED FOR PUBLICATION  
 © COPYRIGHT copyright.d8te- ALL RIGHTS RESERVED.

| REVISIONS |     |             |      |      |
|-----------|-----|-------------|------|------|
| P         | LTR | DESCRIPTION | DATE | APVD |
| -         |     | SEE SHEET 1 | -    | -    |
|           |     |             |      |      |
|           |     |             |      |      |

LID NOT SHOWN FOR REFERENCE ONLY

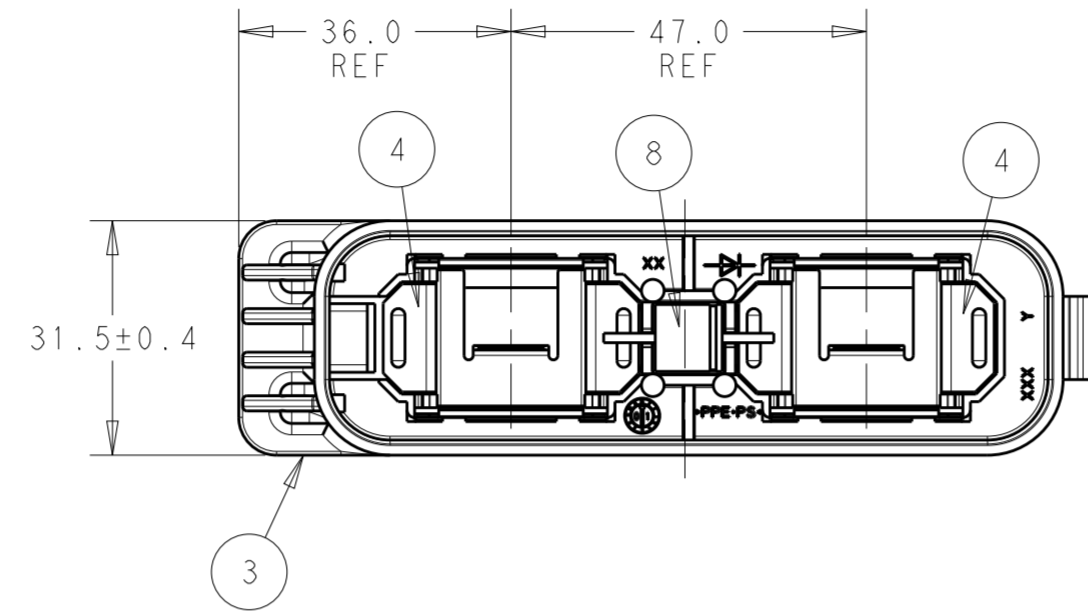

LID NOT SHOWN FOR REFERENCE ONLY

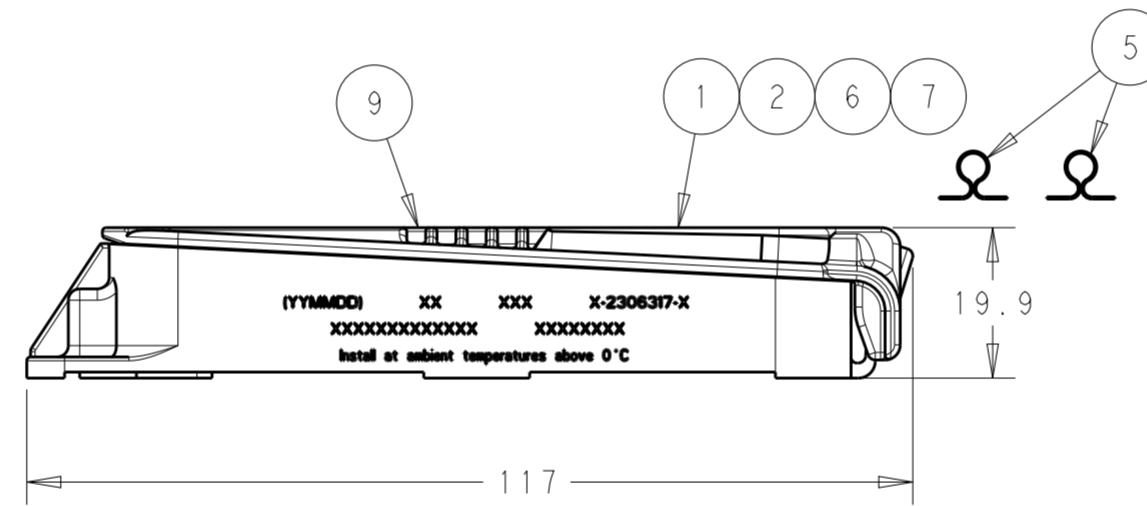
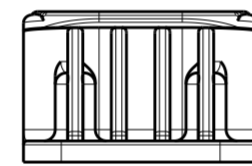
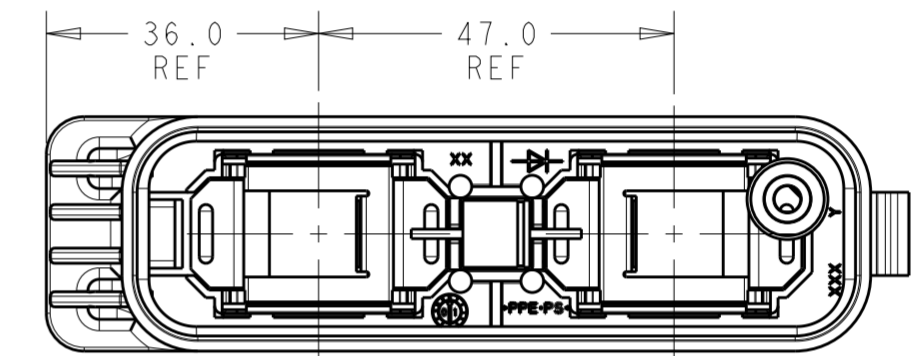

EAST-WEST VERSIONS  
 4-2306317-5  
 5-2306317-5  
 6-2306317-5  
 7-2306317-5  
 SAME AS N-S VERSIONS  
 EXCEPT AS SHOWN

NORTH-SOUTH VERSIONS  
 2306317-5  
 1-2306317-5  
 2-2306317-5  
 3-2306317-5  
 SHOWN

|  |  |                                     |   |  |
|--|--|-------------------------------------|---|--|
| THIS DRAWING IS A CONTROLLED DOCUMENT. |  | DWN<br>RAVLS<br>13AUG2016           | TE Connectivity                                       |  |
| DIMENSIONS:<br>mm                      |  | CHK<br>GINGRICH CHUCK<br>13AUG2016  |   |  |
| TOLERANCES UNLESS OTHERWISE SPECIFIED: |  | APVD<br>GINGRICH CHUCK<br>13AUG2016 | NAME<br>PV EDGE ASSEMBLY, WITHOUT FLAP,<br>OMEGA CLIP |  |
| 0 PLC ±0.50                            |  | PRODUCT SPEC<br>108-32122           | SIZE<br>A2  |  |
| 1 PLC ±0.25                            |  | APPLICATION SPEC<br>114-32157       | CAGE CODE<br>C-2306317                                |  |
| 2 PLC ±0.13                            |  | WEIGHT<br>-                         | DRAWING NO<br>-                                       |  |
| 3 PLC ±                                |  | CUSTOMER DRAWING                    | RESTRICTED TO<br>-                                    |  |
| 4 PLC ±                                |  | SCALE<br>5:1                        | SHEET<br>3 OF 4                                       |  |
| ANGLES ±                               |  | REV<br>A                            |   |  |
| FINISH -                               |  |                                     |   |  |

THIS DRAWING IS UNPUBLISHED. RELEASED FOR PUBLICATION  
 © COPYRIGHT copyright.d8te- ALL RIGHTS RESERVED.

| REVISIONS |     |             |      |      |
|-----------|-----|-------------|------|------|
| P         | LTR | DESCRIPTION | DATE | APVD |
| -         |     | SEE SHEET 1 | -    | -    |
|           |     |             |      |      |
|           |     |             |      |      |

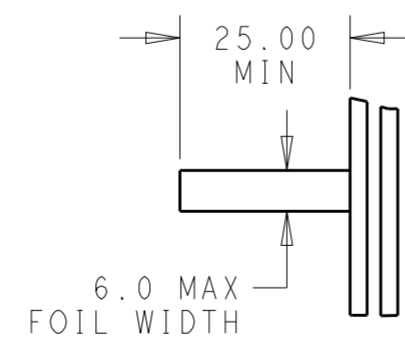
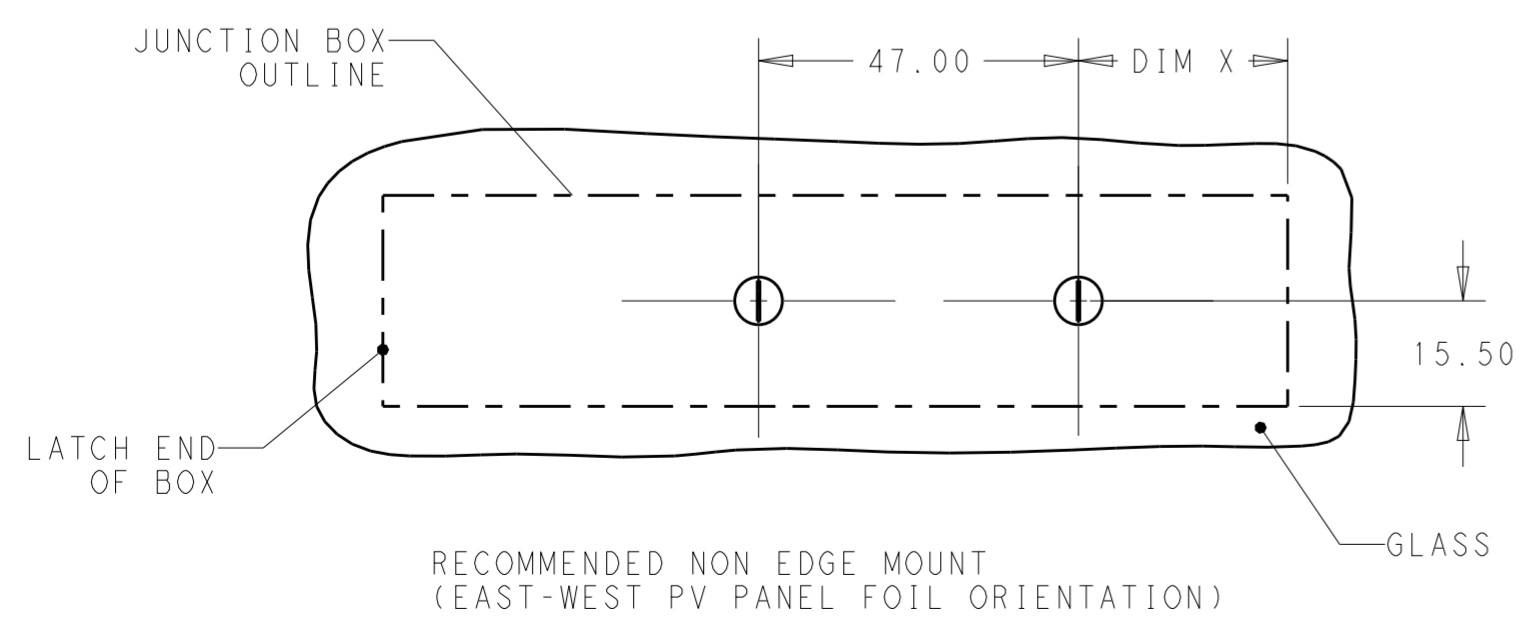
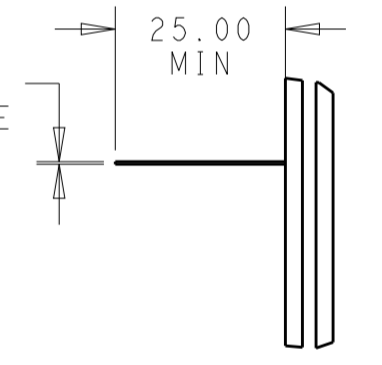
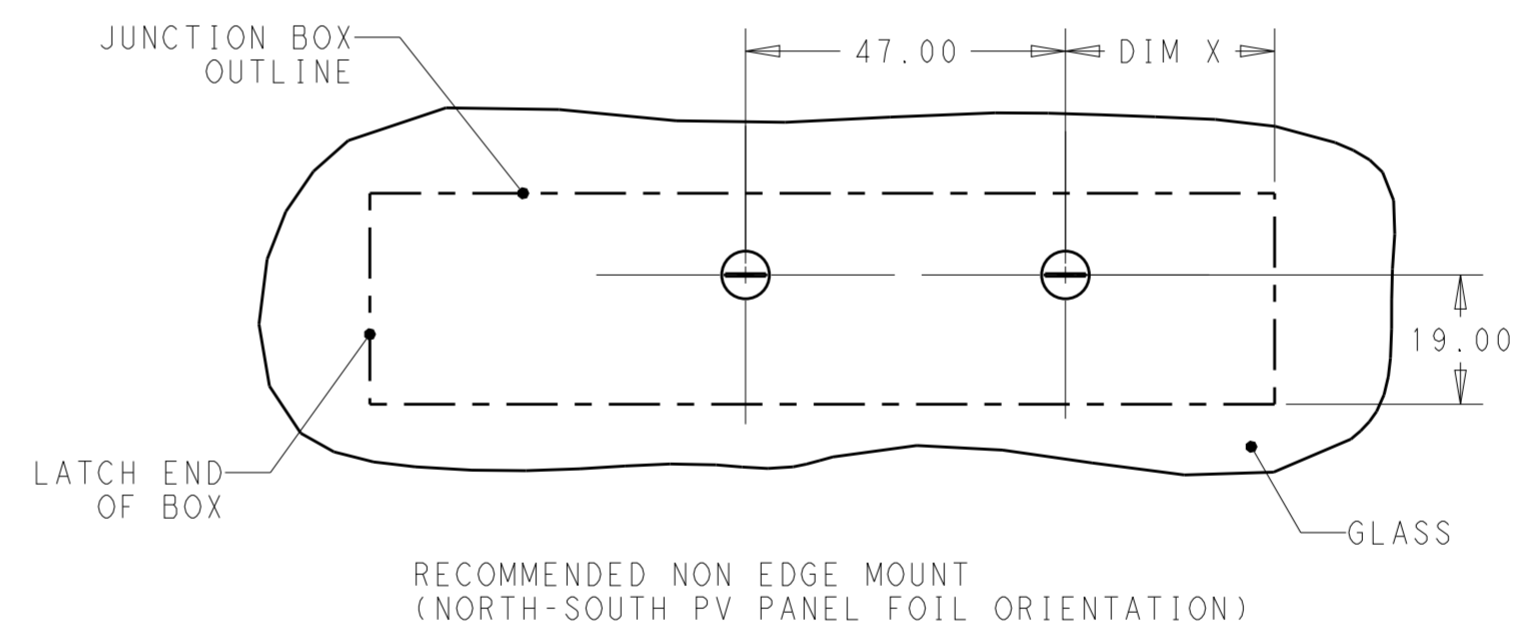
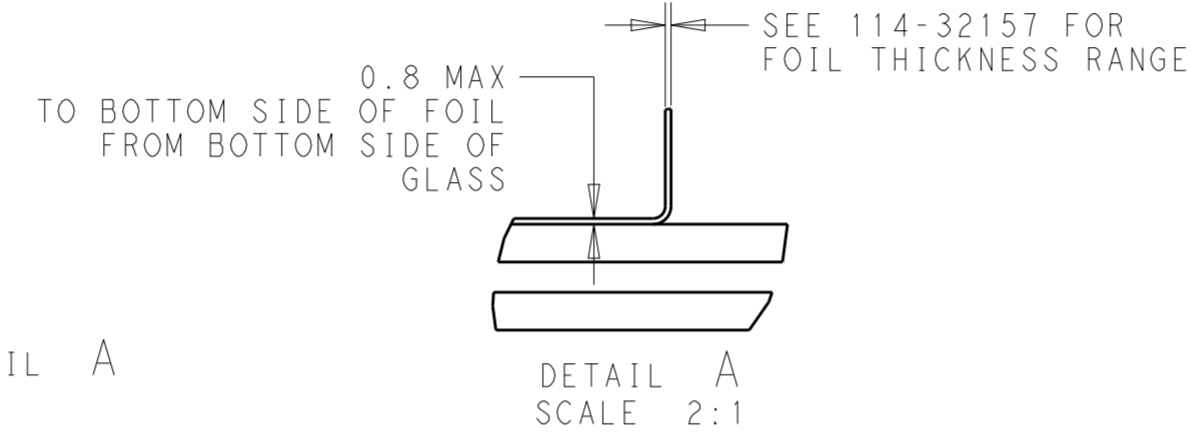
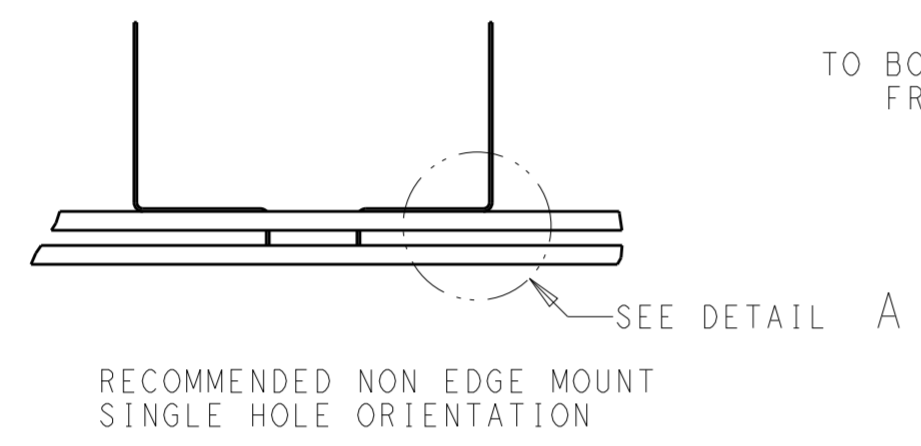
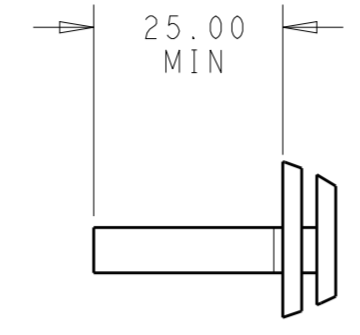
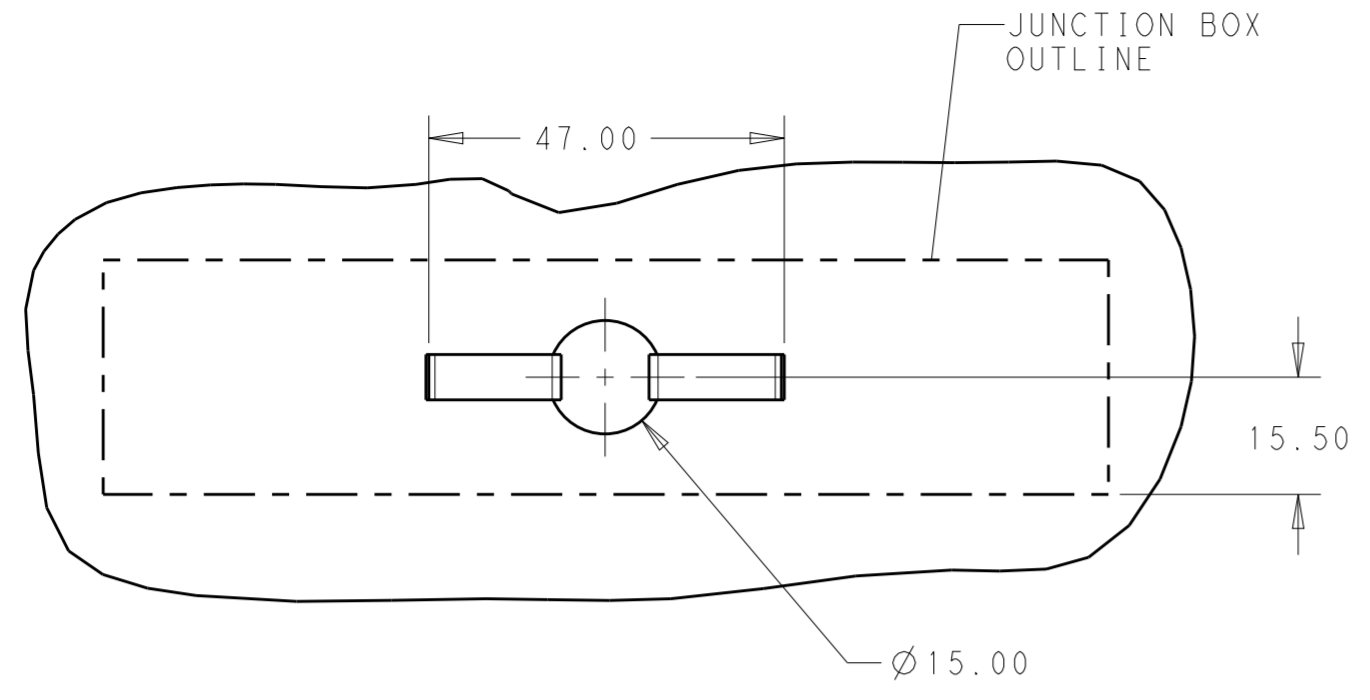

|  |  |                                     |   |  |
|--|--|-------------------------------------|---|--|
| THIS DRAWING IS A CONTROLLED DOCUMENT. |  | DWN<br>RAVLS<br>13AUG2016           | TE Connectivity                                       |  |
| DIMENSIONS:<br>mm                      |  | CHK<br>GINGRICH CHUCK<br>13AUG2016  |   |  |
| TOLERANCES UNLESS OTHERWISE SPECIFIED: |  | APVD<br>GINGRICH CHUCK<br>13AUG2016 | NAME<br>PV EDGE ASSEMBLY, WITHOUT FLAP,<br>OMEGA CLIP |  |
| 0 PLC ±0.50                            |  | PRODUCT SPEC<br>108-32122           | SIZE<br>A2  |  |
| 1 PLC ±0.25                            |  | APPLICATION SPEC<br>114-32157       | CAGE CODE<br>C-2306317                                |  |
| 2 PLC ±0.13                            |  | WEIGHT<br>-                         | DRAWING NO<br>-                                       |  |
| 3 PLC ±                                |  | CUSTOMER DRAWING                    | RESTRICTED TO<br>-                                    |  |
| 4 PLC ±                                |  | SCALE<br>5:1                        | SHEET<br>4 OF 4                                       |  |
| ANGLES ±                               |  |                                     | REV<br>A  |  |
| FINISH -                               |  |                                     |   |  |

Компания «Океан Электроники» предлагает заключение долгосрочных отношений при поставках импортных электронных компонентов на взаимовыгодных условиях!

Наши преимущества:

- Поставка оригинальных импортных электронных компонентов напрямую с производств Америки, Европы и Азии, а так же с крупнейших складов мира;
- Широкая линейка поставок активных и пассивных импортных электронных компонентов (более 30 млн. наименований);
- Поставка сложных, дефицитных, либо снятых с производства позиций;
- Оперативные сроки поставки под заказ (от 5 рабочих дней);
- Экспресс доставка в любую точку России;
- Помощь Конструкторского Отдела и консультации квалифицированных инженеров;
- Техническая поддержка проекта, помощь в подборе аналогов, поставка прототипов;
- Поставка электронных компонентов под контролем ВП;
- Система менеджмента качества сертифицирована по Международному стандарту ISO 9001;
- При необходимости вся продукция военного и аэрокосмического назначения проходит испытания и сертификацию в лаборатории (по согласованию с заказчиком);
- Поставка специализированных компонентов военного и аэрокосмического уровня качества (Xilinx, Altera, Analog Devices, Intersil, Interpoint, Microsemi, Actel, Aeroflex, Peregrine, VPT, Syfer, Eurofarad, Texas Instruments, MS Kennedy, Miteq, Cobham, E2V, MA-COM, Hittite, Mini-Circuits, General Dynamics и др.);

Компания «Океан Электроники» является официальным дистрибьютором и эксклюзивным представителем в России одного из крупнейших производителей разъемов военного и аэрокосмического назначения «JONHON», а так же официальным дистрибьютором и эксклюзивным представителем в России производителя высокотехнологичных и надежных решений для передачи СВЧ сигналов «FORSTAR».



## JONHON

«JONHON» (основан в 1970 г.)

Разъемы специального, военного и аэрокосмического назначения:

(Применяются в военной, авиационной, аэрокосмической, морской, железнодорожной, горно- и нефтедобывающей отраслях промышленности)

«FORSTAR» (основан в 1998 г.)

ВЧ соединители, коаксиальные кабели, кабельные сборки и микроволновые компоненты:

(Применяются в телекоммуникациях гражданского и специального назначения, в средствах связи, РЛС, а так же военной, авиационной и аэрокосмической отраслях промышленности).



Телефон: 8 (812) 309-75-97 (многоканальный)

Факс: 8 (812) 320-03-32

Электронная почта: [ocean@oceanchips.ru](mailto:ocean@oceanchips.ru)

Web: <http://oceanchips.ru/>

Адрес: 198099, г. Санкт-Петербург, ул. Калинина, д. 2, корп. 4, лит. А