

4S1 & 4SS-Series

Sub-Miniature & **Sealed** Sub-Miniature Slide Switches

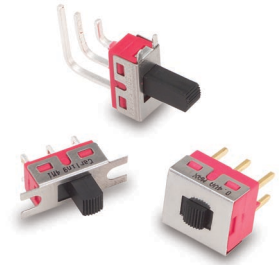

4M1-Series

Miniature Slide Switch

Specifications

Contact Rating refer to ordering scheme
 Electrical Life 30,000 make & break cycles at full load
 Contact Resistance. 10 mΩ max. initial @ 2-4 VDC
 100mA for both silver & gold plated contacts.
 Insulation Resistance 1000 MΩ min.
 Dielectric Strength 1500 Volts RMS @ sea level
 Operating Temperature . . . -30°C to +85°C
 Solder Heat Resistance. . . MIL-STD-202, Method 210
 Actuator Travel 25°

Materials

Case Diallyl phthalate (DAP) (UL 94V-0)
 Slide Handle. Nylon
 Housing. Stainless Steel
 Terminal Seal Epoxy

4S1-Series Ordering Scheme



1 SERIES 4S1 Sub-Miniature Slide Switch			
2 POLES FSP single pole			
3 CIRCUIT			
Switching Position:			
1	2-1	OPEN	2-3
3	ON	NONE	ON
	ON	OFF	ON
4 TERMINATION			
M2 PCB			
M6 PC Mount, 90° horizontal			

5 CONTACT		
	<i>Material</i>	<i>Terminal Plating</i>
G	silver ¹	gold over silver ³
K	gold ²	tin-lead ⁴
P	silver ¹	tin-lead ⁴
Q	silver ¹	silver ¹
R	gold ²	gold ²
<i>Rating</i>		
3A@125VAC or 28VDC; 1.5A @ 250VAC		
0.4VA max. @20V max (AC/DC)		
3A@125VAC or 28VDC; 1.5A @ 250VAC		
3A@125VAC or 28VDC; 1.5A @ 250VAC		
0.4VA max. @20V max (AC/DC)		
NOTE:		
Tin-lead option available with PC type terminations only.		
1 Moveable contact & terminals: copper alloy, silver plate		
2 Moveable contact & terminals: copper alloy with gold plate over nickel plate		
3 Terminals: silver plate with outer layer in gold plating		

6 EPOXY SEAL	
E	epoxy seal

7 PACKAGING	
Switches are bulk packed, unless T/R is specified at the end of the part number.	
T/R tape reel - 500 pieces per reel	

4SS-Series Ordering Scheme



1 SERIES 4SS Sealed Sub-Miniature Slide Switch															
2 POLES FSP single pole															
3 CIRCUIT Switching Position: <table style="width: 100%; border-collapse: collapse;"> <tr> <td style="width: 10%;"></td> <td style="width: 15%;"></td> <td style="width: 15%; text-align: center;"><i>OPEN</i></td> <td style="width: 15%;"></td> <td style="width: 15%; text-align: center;"><i>2-3</i></td> </tr> <tr> <td style="text-align: center;">1</td> <td style="text-align: center;">ON</td> <td style="text-align: center;">NONE</td> <td></td> <td style="text-align: center;">ON</td> </tr> <tr> <td style="text-align: center;">3</td> <td style="text-align: center;">ON</td> <td style="text-align: center;">OFF</td> <td></td> <td style="text-align: center;">ON</td> </tr> </table>			<i>OPEN</i>		<i>2-3</i>	1	ON	NONE		ON	3	ON	OFF		ON
		<i>OPEN</i>		<i>2-3</i>											
1	ON	NONE		ON											
3	ON	OFF		ON											
4 TERMINATION Termination options for switches with brick color actuators M2 PCB M6 PC Mount, 90° horizontal M7 PC Mount, 90° vertical Termination options for switches with white color actuators L6 Surface Mount, 90° flat S6 Surface Mount, 90° horizontal S7 Surface Mount, 90° vertical															

5 CONTACT <table style="width: 100%; border-collapse: collapse;"> <thead> <tr> <th style="text-align: left;">Material</th> <th style="text-align: left;">Terminal Plating</th> <th style="text-align: left;">Rating</th> </tr> </thead> <tbody> <tr> <td>G silver¹</td> <td>gold over silver</td> <td>3A@125VAC or 28VDC; 1.5A @ 250VAC</td> </tr> <tr> <td>K gold²</td> <td>tin-lead⁴</td> <td>0.4VA max. @20V max (AC/DC)</td> </tr> <tr> <td>P silver¹</td> <td>tin-lead</td> <td>3A@125VAC or 28VDC; 1.5A @ 250VAC</td> </tr> <tr> <td>R gold²</td> <td>gold²</td> <td>0.4VA max. @20V max (AC/DC)</td> </tr> </tbody> </table> <p>NOTE: Tin-lead option available with PC type terminations only. 1 Moveable contact & terminals: copper alloy, silver plate 2 Moveable contact & terminals: copper alloy with gold plate over nickel plate 3 Terminals: silver plate with outer layer in gold plating 4 Outer terminals: copper alloy with tin-lead over nickel plate</p>	Material	Terminal Plating	Rating	G silver ¹	gold over silver	3A@125VAC or 28VDC; 1.5A @ 250VAC	K gold ²	tin-lead ⁴	0.4VA max. @20V max (AC/DC)	P silver ¹	tin-lead	3A@125VAC or 28VDC; 1.5A @ 250VAC	R gold ²	gold ²	0.4VA max. @20V max (AC/DC)
Material	Terminal Plating	Rating													
G silver ¹	gold over silver	3A@125VAC or 28VDC; 1.5A @ 250VAC													
K gold ²	tin-lead ⁴	0.4VA max. @20V max (AC/DC)													
P silver ¹	tin-lead	3A@125VAC or 28VDC; 1.5A @ 250VAC													
R gold ²	gold ²	0.4VA max. @20V max (AC/DC)													
6 EPOXY SEAL E epoxy seal															
7 PACKAGING Switches are bulk packed, unless T/R is specified at the end of the part number. T/R tape reel - 500 pieces per reel															

4M1-Series Ordering Scheme

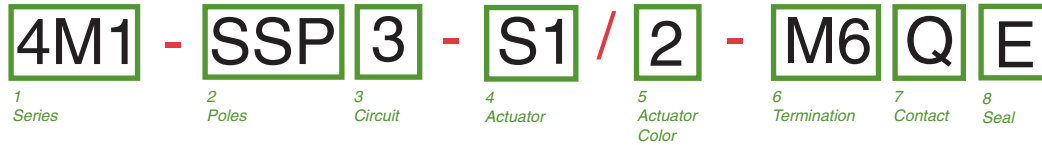

1 SERIES 4M1 Miniature Slide Switch															
2 POLES SSP single pole SDP double pole															
3 CIRCUIT Switching Position <table style="width: 100%; border-collapse: collapse;"> <tr> <td style="width: 10%;"></td> <td style="width: 15%; text-align: center;"><i>2-1, 5-4</i></td> <td style="width: 15%; text-align: center;"><i>OPEN</i></td> <td style="width: 15%;"></td> <td style="width: 15%; text-align: center;"><i>2-3, 5-6</i></td> </tr> <tr> <td style="text-align: center;">1</td> <td style="text-align: center;">ON</td> <td style="text-align: center;">NONE</td> <td></td> <td style="text-align: center;">ON</td> </tr> <tr> <td style="text-align: center;">3</td> <td style="text-align: center;">ON</td> <td style="text-align: center;">OFF</td> <td></td> <td style="text-align: center;">ON</td> </tr> </table>		<i>2-1, 5-4</i>	<i>OPEN</i>		<i>2-3, 5-6</i>	1	ON	NONE		ON	3	ON	OFF		ON
	<i>2-1, 5-4</i>	<i>OPEN</i>		<i>2-3, 5-6</i>											
1	ON	NONE		ON											
3	ON	OFF		ON											
4 ACTUATOR S1 .201 [5.10] high S2 .285 [7.25] high S3 .370 [9.40] high S4 .140 [3.55] high S5 .053 [1.35] high (for DPDT only) S6 .482 [12.25] high S7 .311 [7.90] high T1 .201 [5.10] high (for DPDT only)															
5 ACTUATOR COLOR¹ <table style="width: 100%; border-collapse: collapse;"> <tr> <td style="width: 15%;">1 white</td> <td style="width: 15%;">3 red</td> <td style="width: 15%;">5 yellow</td> <td style="width: 15%;">7 blue</td> <td style="width: 15%;">9 gray</td> </tr> <tr> <td>2 black</td> <td>4 orange</td> <td>6 green</td> <td>8 brown</td> <td></td> </tr> </table> <p><small>1 White, black & red are standard. Other colors available for quantities of 5K or more.</small></p>	1 white	3 red	5 yellow	7 blue	9 gray	2 black	4 orange	6 green	8 brown						
1 white	3 red	5 yellow	7 blue	9 gray											
2 black	4 orange	6 green	8 brown												

6 TERMINATION <table style="width: 100%; border-collapse: collapse;"> <tbody> <tr> <td style="width: 50%;">M1 Solder Lug</td> <td style="width: 50%;">M5-3 Wire Wrap [10.80]</td> </tr> <tr> <td>M2 PCB</td> <td>M5-4 Wire Wrap [26.97]</td> </tr> <tr> <td>M3 Quick Connect</td> <td>M6 PC Mount, 90° horizontal</td> </tr> <tr> <td>M5-1 Wire Wrap .750 [19.05]</td> <td>M7 PC Mount, 90° vertical</td> </tr> <tr> <td>M5-2 Wire Wrap [24.48]</td> <td>VS2 PC Mount, U bracket, .620 mounting x .460 high</td> </tr> </tbody> </table>	M1 Solder Lug	M5-3 Wire Wrap [10.80]	M2 PCB	M5-4 Wire Wrap [26.97]	M3 Quick Connect	M6 PC Mount, 90° horizontal	M5-1 Wire Wrap .750 [19.05]	M7 PC Mount, 90° vertical	M5-2 Wire Wrap [24.48]	VS2 PC Mount, U bracket, .620 mounting x .460 high														
M1 Solder Lug	M5-3 Wire Wrap [10.80]																							
M2 PCB	M5-4 Wire Wrap [26.97]																							
M3 Quick Connect	M6 PC Mount, 90° horizontal																							
M5-1 Wire Wrap .750 [19.05]	M7 PC Mount, 90° vertical																							
M5-2 Wire Wrap [24.48]	VS2 PC Mount, U bracket, .620 mounting x .460 high																							
7 CONTACT <table style="width: 100%; border-collapse: collapse;"> <thead> <tr> <th style="text-align: left;">Material</th> <th style="text-align: left;">Terminal Plating</th> <th style="text-align: left;">Rating</th> <th style="text-align: left;">Approvals</th> </tr> </thead> <tbody> <tr> <td>G silver¹</td> <td>gold over silver²</td> <td>5A@125VAC or 28VDC; 2A @ 250VAC</td> <td>UL, CSA</td> </tr> <tr> <td>K gold²</td> <td>tin-lead⁴</td> <td>0.4VA max. @20V max (AC/DC)</td> <td></td> </tr> <tr> <td>P silver¹</td> <td>tin-lead⁴</td> <td>5A@125VAC or 28VDC; 2A @ 250VAC</td> <td>UL, CSA</td> </tr> <tr> <td>Q silver¹</td> <td>silver¹</td> <td>5A@125VAC or 28VDC; 2A @ 250VAC</td> <td>UL, CSA</td> </tr> <tr> <td>R gold²</td> <td>gold²</td> <td>0.4VA max. @20V max (AC/DC)</td> <td></td> </tr> </tbody> </table> <p>NOTE: Tin-lead option available with PC type terminations only. 1 Moveable contact & terminals: copper alloy, silver plate 2 Moveable contact & terminals: copper alloy with gold plate over nickel plate 3 Terminals: silver plate with outer layer in gold plating 4 Outer terminals: copper alloy with tin-lead over nickel plate</p>	Material	Terminal Plating	Rating	Approvals	G silver ¹	gold over silver ²	5A@125VAC or 28VDC; 2A @ 250VAC	UL, CSA	K gold ²	tin-lead ⁴	0.4VA max. @20V max (AC/DC)		P silver ¹	tin-lead ⁴	5A@125VAC or 28VDC; 2A @ 250VAC	UL, CSA	Q silver ¹	silver ¹	5A@125VAC or 28VDC; 2A @ 250VAC	UL, CSA	R gold ²	gold ²	0.4VA max. @20V max (AC/DC)	
Material	Terminal Plating	Rating	Approvals																					
G silver ¹	gold over silver ²	5A@125VAC or 28VDC; 2A @ 250VAC	UL, CSA																					
K gold ²	tin-lead ⁴	0.4VA max. @20V max (AC/DC)																						
P silver ¹	tin-lead ⁴	5A@125VAC or 28VDC; 2A @ 250VAC	UL, CSA																					
Q silver ¹	silver ¹	5A@125VAC or 28VDC; 2A @ 250VAC	UL, CSA																					
R gold ²	gold ²	0.4VA max. @20V max (AC/DC)																						
8 EPOXY SEAL E epoxy seal																								

4S-Series Dimensional Specifications: in. [mm]

4S1-Series

TERMINATION

PC MOUNTING

M2

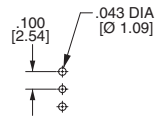
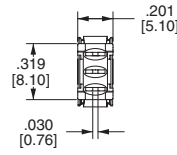
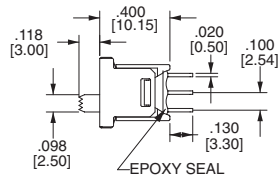
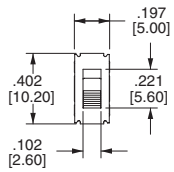

M6

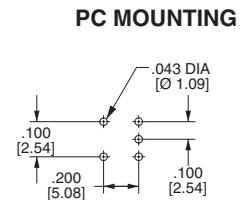
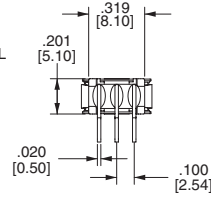
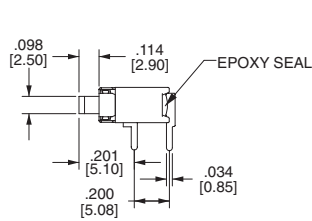
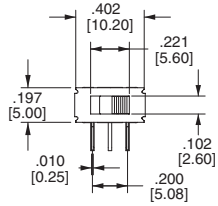

4SS-Series

TERMINATION

PC MOUNTING

M2

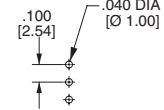
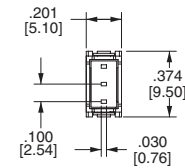
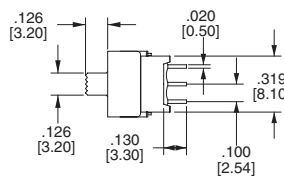
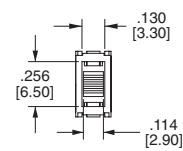

M6

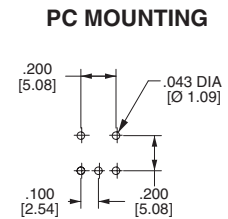
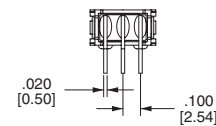
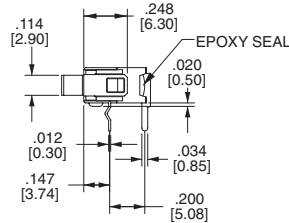
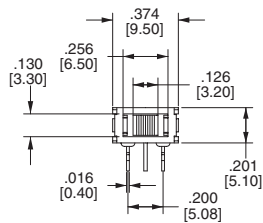

M7

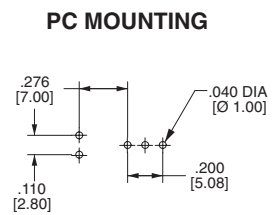
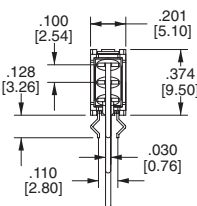
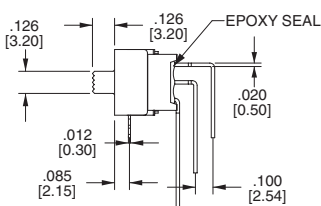
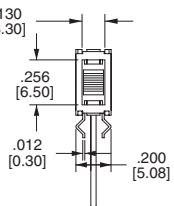

L6

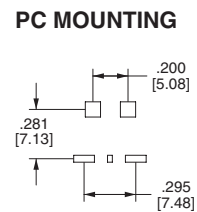
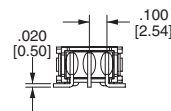
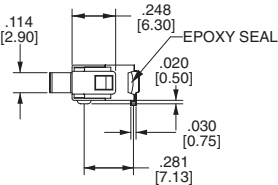
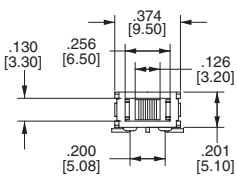

4SS-Series Dimensional Specifications: in. [mm]

TERMINATION

S6

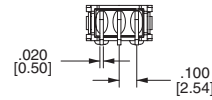
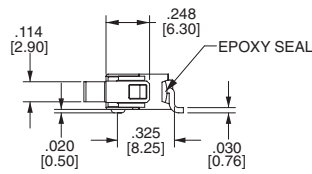
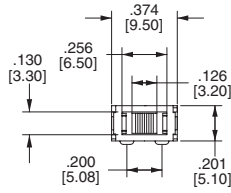

PC MOUNTING

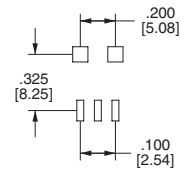

S7

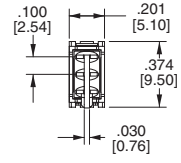
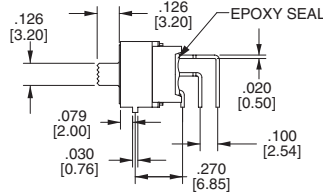
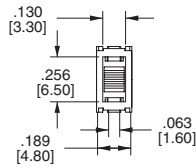

PC MOUNTING

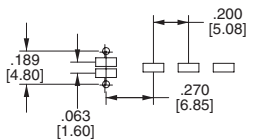

REEL TAPING

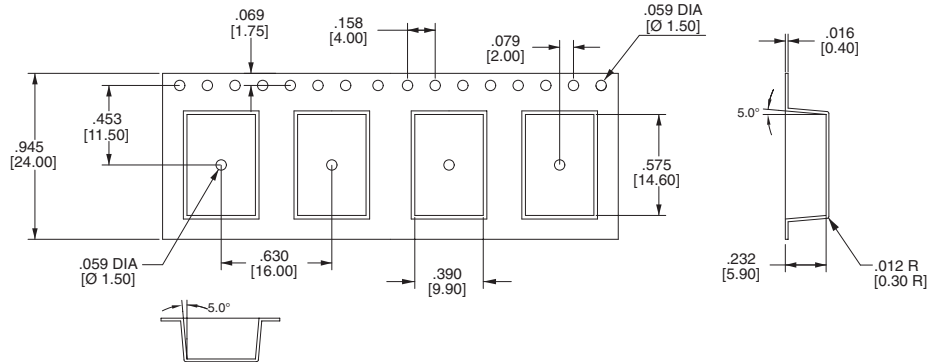

FOR S6, L6 ONLY

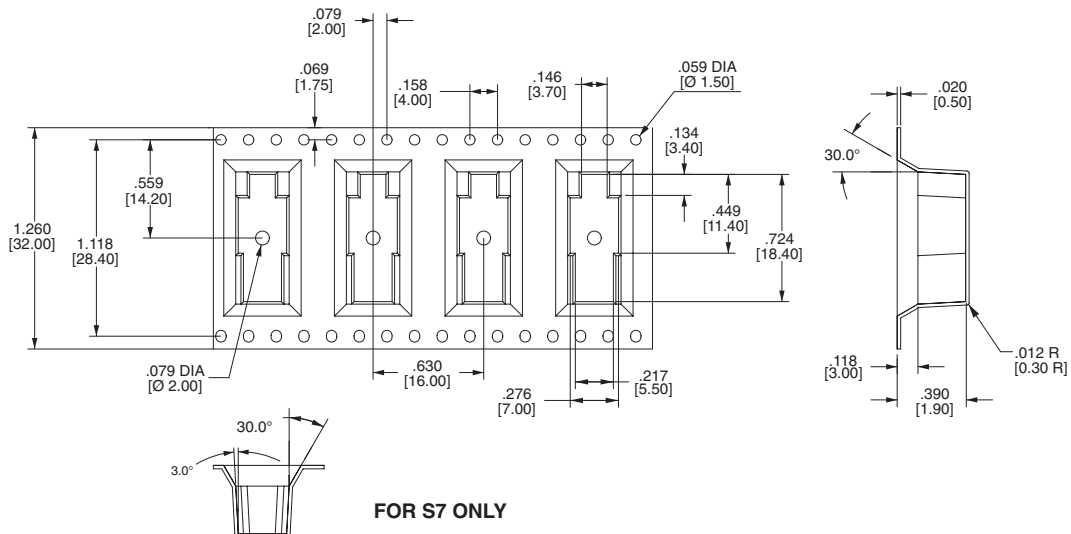

FOR S7 ONLY

4M1-Series Dimensional Specifications: in. [mm]

ACTUATOR

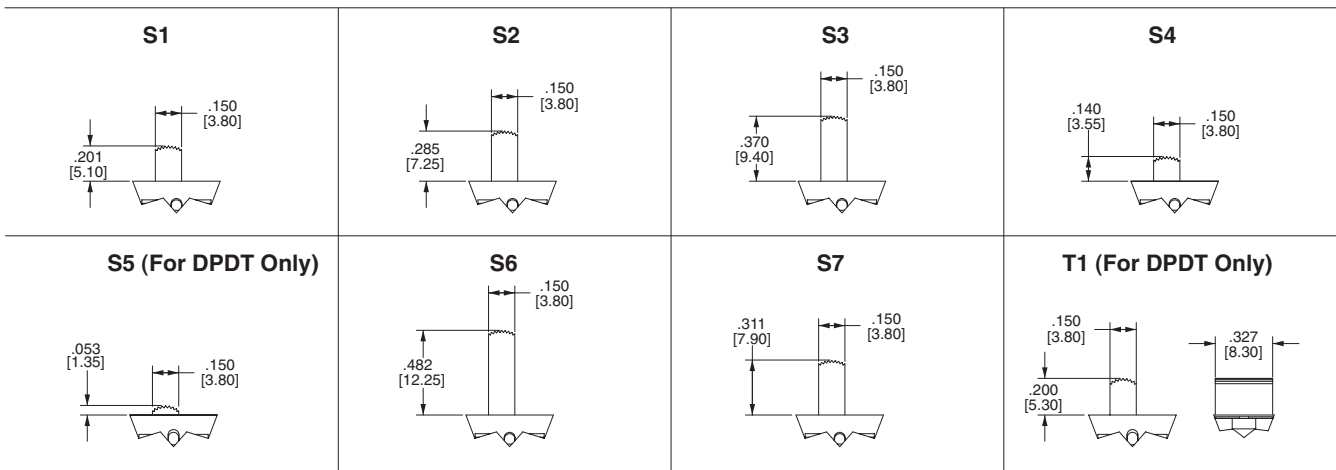

TERMINATION

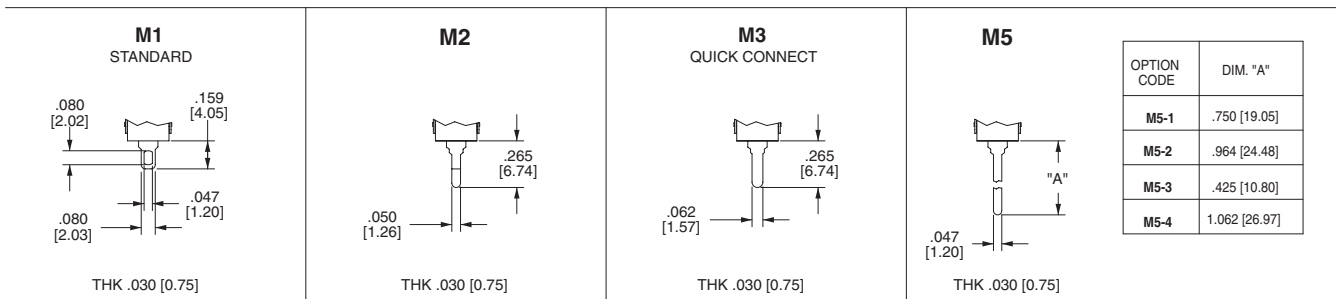

SINGLE POLE

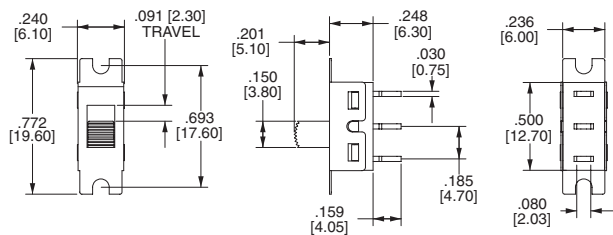

DOUBLE POLE

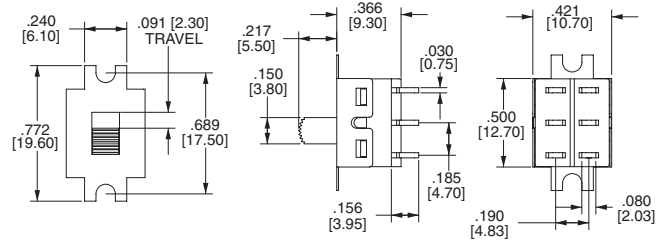

M6

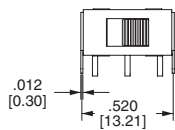

SINGLE POLE

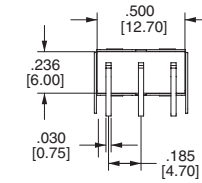
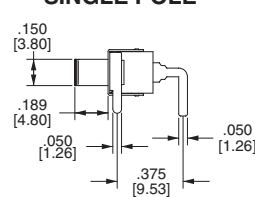

PC MOUNTING

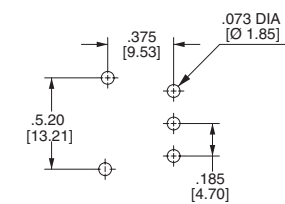

DOUBLE POLE

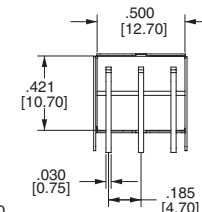
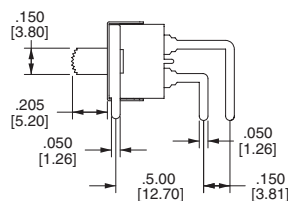
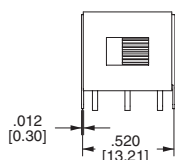

PC MOUNTING

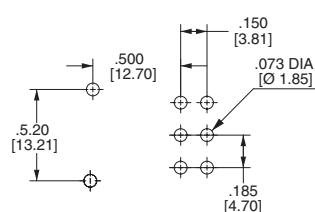

4M1-Series Dimensional Specifications: in. [mm]

TERMINATION

M7

SINGLE POLE

PC MOUNTING

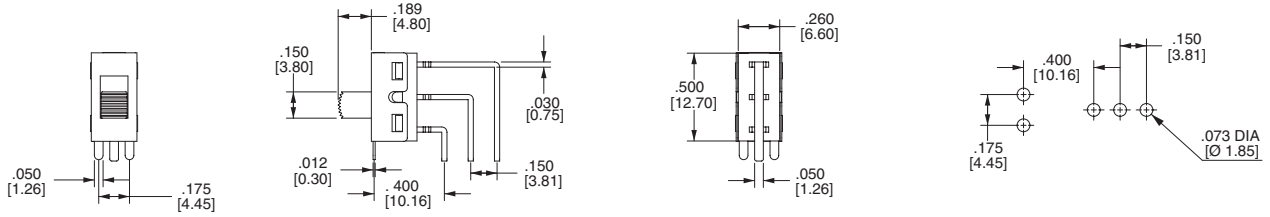

DOUBLE POLE

PC MOUNTING

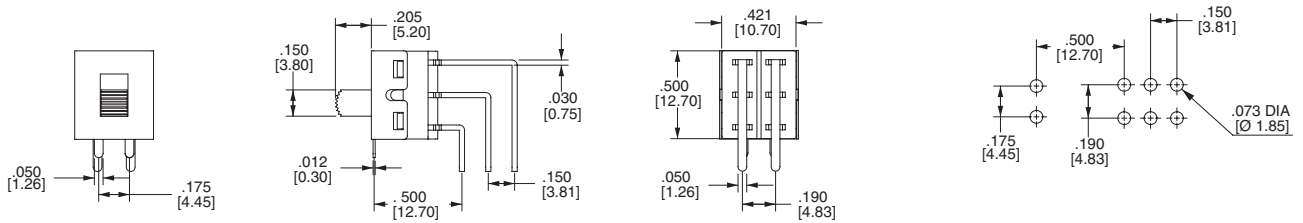

VS2

SINGLE POLE

PC MOUNTING

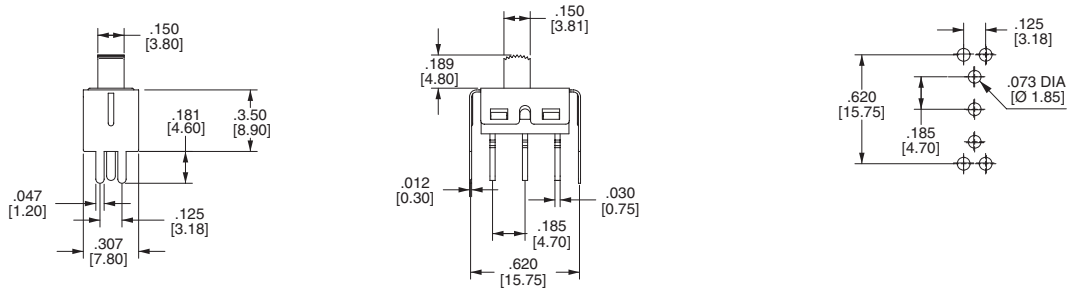

DOUBLE POLE

PC MOUNTING

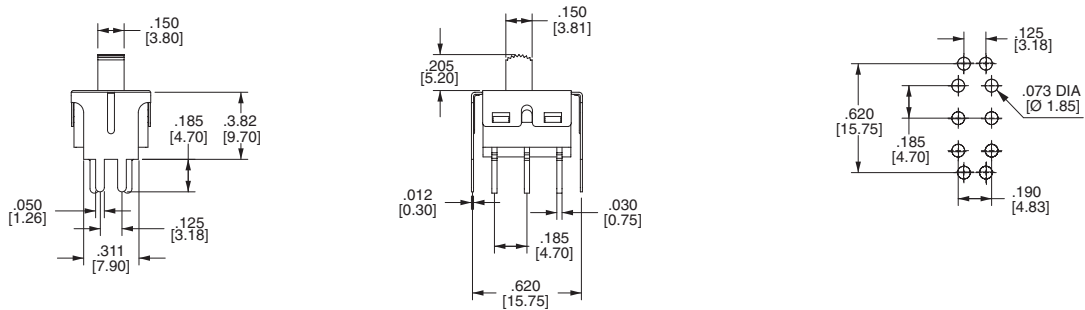

Компания «Океан Электроники» предлагает заключение долгосрочных отношений при поставках импортных электронных компонентов на взаимовыгодных условиях!

Наши преимущества:

- Поставка оригинальных импортных электронных компонентов напрямую с производств Америки, Европы и Азии, а так же с крупнейших складов мира;
- Широкая линейка поставок активных и пассивных импортных электронных компонентов (более 30 млн. наименований);
- Поставка сложных, дефицитных, либо снятых с производства позиций;
- Оперативные сроки поставки под заказ (от 5 рабочих дней);
- Экспресс доставка в любую точку России;
- Помощь Конструкторского Отдела и консультации квалифицированных инженеров;
- Техническая поддержка проекта, помощь в подборе аналогов, поставка прототипов;
- Поставка электронных компонентов под контролем ВП;
- Система менеджмента качества сертифицирована по Международному стандарту ISO 9001;
- При необходимости вся продукция военного и аэрокосмического назначения проходит испытания и сертификацию в лаборатории (по согласованию с заказчиком);
- Поставка специализированных компонентов военного и аэрокосмического уровня качества (Xilinx, Altera, Analog Devices, Intersil, Interpoint, Microsemi, Actel, Aeroflex, Peregrine, VPT, Syfer, Eurofarad, Texas Instruments, MS Kennedy, Miteq, Cobham, E2V, MA-COM, Hittite, Mini-Circuits, General Dynamics и др.);

Компания «Океан Электроники» является официальным дистрибьютором и эксклюзивным представителем в России одного из крупнейших производителей разъемов военного и аэрокосмического назначения «JONHON», а так же официальным дистрибьютором и эксклюзивным представителем в России производителя высокотехнологичных и надежных решений для передачи СВЧ сигналов «FORSTAR».



JONHON

«JONHON» (основан в 1970 г.)

Разъемы специального, военного и аэрокосмического назначения:

(Применяются в военной, авиационной, аэрокосмической, морской, железнодорожной, горно- и нефтедобывающей отраслях промышленности)

«FORSTAR» (основан в 1998 г.)

ВЧ соединители, коаксиальные кабели, кабельные сборки и микроволновые компоненты:

(Применяются в телекоммуникациях гражданского и специального назначения, в средствах связи, РЛС, а так же военной, авиационной и аэрокосмической отраслях промышленности).



Телефон: 8 (812) 309-75-97 (многоканальный)

Факс: 8 (812) 320-03-32

Электронная почта: ocean@oceanchips.ru

Web: <http://oceanchips.ru/>

Адрес: 198099, г. Санкт-Петербург, ул. Калинина, д. 2, корп. 4, лит. А