

For years, *PANDUIT* has supplied its customers with innovative wire harness components, systems and installation tooling. *PANDUIT* offers a broad range of solutions to meet the changing challenges of routing wire in harness assembly production.

The *PANDUIT* Harness Board Accessories System has a unique product offering for all of your wire harness management needs. It provides for the fast routing and forming of wires in harness fabrication. The accessories hold the wires off the harness board at a uniform height for easy application of cable ties. For complete Harness Board System Solutions choose *PANDUIT* Harness Board Accessories, Cable Ties and Installation Tooling.



- One-stop-shopping for all your harnessing needs
- Speeds harness assembly while providing lowest installed cost
- Reduces operator fatigue
- Provides a higher quality finished product
- Makes it easy to install, maintain and modify the wire harness
- Enables greater design flexibility

Contents

Page Number

| | |
|---|----|
| RER Type Replaceable Elastic Wire Retainers..... | 3 |
| ER Type Elastic Wire Retainers | 3 |
| BR Type Bundle Retainer | 4 |
| CPH Type Corner Post | 4 |
| CPL Type Corner Post (low) | 4 |
| WEH Type Wire End Holder | 4 |
| TJF Type T-Junction Fixture..... | 5 |
| Fanning Strip System | 5 |
| Spring Wire Breakout System | 6 |
| Harness Board Nails | 6 |
| Harness Board Platform | 7 |
| Harness Board Standoff Post | 7 |
| Tie Harness Mount Fixtures..... | 8 |
| Harness Board Universal Adapter..... | 8 |
| Tie Harness Anchor Universal Fixture..... | 8 |
| Tie Harness Mounts — Using Two Cable Ties | 9 |
| Installation System — PAT1M/PAT1.5M Reel Fed Systems for Harness Assemblies | 10 |
| <i>PANDUIT®</i> Cable Ties | 10 |

PANDUIT® Harness Board Fixtures

Wire Retainers —

RER Replaceable Elastic Retainers

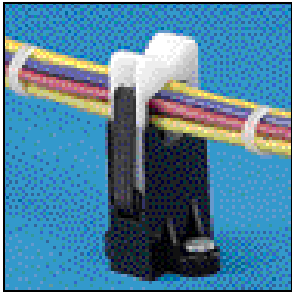

As wires are individually inserted, the bundle is pre-formed. When the harness is complete, it can be easily snapped out. Three sizes available for 1/2" (12.7mm), 3/4" (19.0mm) and 1 1/4" (31.7mm) bundles.

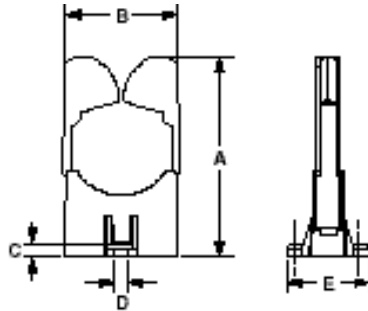

Replacement Elastic
For economy, the elastic band can be replaced in the RER Elastic Retainers without removing the RER base.

| Part Number | Pkg. Qty. |
|-------------|-----------|
| RER.5E-X | 10 |
| RER.75E-X | 10 |
| RER1.25E-X | 10 |

| Part Number | Max. Dia. In (mm) | Dimensions Inches (mm) | | | | | Material & Color | Mounting Method | Std. Pkg. Qty. | Std. Ctn. Qty. |
|--------------|-------------------|------------------------|----------------|--------------|---------------|----------------|------------------------|-----------------|----------------|----------------|
| | | A | B | C | D | E | | | | |
| RER.5-S6-X | .5 (12.7) | 1.82 (46.2) | .84 (21.3) | .18 (4.7) | .141 (3.6) | 1.18 (30.0) | Black Nylon and Acetal | #6 (M3) Screw | 10 | 50 |
| RER.75-S6-X | .75 (19.0) | 2.12 (53.9) | 1.12 (28.4) | | .145 (3.7) | | | | 10 | 50 |
| RER1.25-S6-X | 1.25 (31.8) | 2.75 (69.9) | 1.64 (41.7) | | .145 (3.7) | | | | 10 | 50 |

ER Elastic Retainers

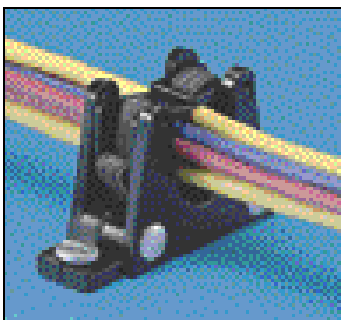

ER Type retainers form wire bundles as wires are inserted. Completed bundles then snap out. Two sizes available for 1/2" (12.7mm) and 1 1/4" (31.7mm) bundles.

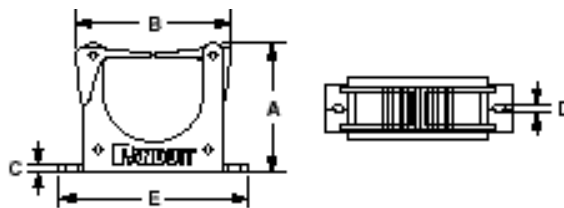

| Part Number | Max. Dia. In (mm) | Dimensions Inches (mm) | | | | | Material & Color | Mounting Method | Std. Pkg. Qty. | Std. Ctn. Qty. |
|-------------|-------------------|------------------------|----------------|--------------|---------------|----------------|---------------------|------------------|----------------|----------------|
| | | A | B | C | D | E | | | | |
| ER.5-E4-X | .5 (12.7) | 1.00 (25.4) | 1.00 (25.4) | .15 (3.8) | .120 (3.0) | 1.90 (48.3) | Black Nylon and ABS | #4 (M2,5) Screws | 10 | 100 |
| ER1.25-E4-X | 1.25 (31.8) | 2.00 (50.8) | 2.40 (61.0) | | .120 (3.0) | | | | 2.90 (73.7) | 10 |

Bundle Retainers

Spring fingers with large lead in, facilitate fast routing of wires and easy removal of completed harness. Three sizes available for 1/2" (12.7mm), 3/4" (19.0mm) and 2.00" (50.8mm) bundles.

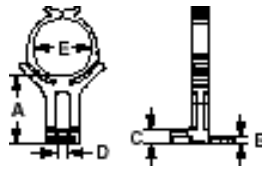
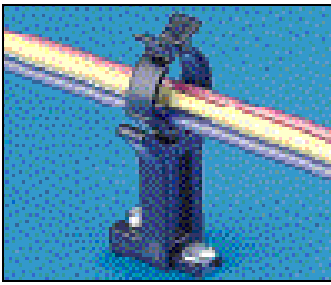

BR.5, BR.75,

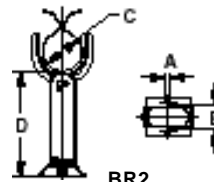

BR2

| Part Number | Max. Dia. In (mm) | Dimensions Inches (mm) | | | | | Material & Color | Mounting Method | Std. Pkg. Qty. | Std. Ctn. Qty. |
|-------------|-------------------|------------------------|----------------|----------------|-----------------|---------------|------------------|---|----------------|----------------|
| | | A | B | C | D | E | | | | |
| BR.5-E6-C | .5 (12.7) | 1.07 (27.2) | .09 (2.3) | .20 (5.1) | .145 (3.7) | .52 (13.2) | Black Acetal | #6 (M3) Screws | 100 | 500 |
| BR.75-E6-C | .75 (19.0) | .95 (24.1) | | | | .76 (19.3) | | | 100 | 500 |
| BR2-1.3-X | 2.00 (50.8) | .27 (6.9) | 1.23 (31.2) | 2.12 (53.8) | 1.30 (33.0) | — | Black Acetal | 1.4" (6MM) Screw | 10 | 100 |
| BR2-1.3-A-X | | | | | 1.30 (33.0) | — | | Rubber Adhesive 2.0 lbs. Static Load | 10 | 100 |
| BR2-1.5-X | 2.00 (50.8) | .26 (6.6) | 1.42 (36.1) | 2.12 (53.8) | 1.62 (41.1) | — | | 1/4-20 (M6) Screws | 10 | 100 |
| BR2-4-X | 2.00 (50.8) | .26 (6.6) | 1.42 (36.1) | 2.12 (53.8) | 4.00 (101.6) | — | | | 10 | 100 |
| BR2-6-X | 2.00 (50.8) | .26 (6.6) | 1.42 (36.1) | 2.12 (53.8) | 6.00 (152.4) | — | | | 10 | 100 |

Corner Posts

Designed to pre-form bundles at harness corners and breakouts. The top arm pivots for easy removal of completed harness.

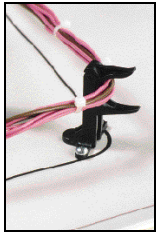

CPH Corner Post, High

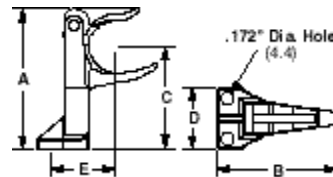

CPL Corner Post, Low

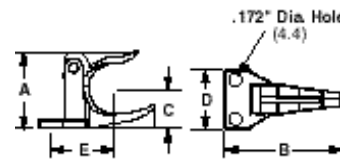

| Part Number | Max. Dia. In (mm) | Dimensions Inches (mm) | | | | | Material & Color | Mounting Method | Std. Pkg. Qty. | Std. Ctn. Qty. |
|-------------|-------------------|------------------------|----------------|----------------|---------------|----------------|------------------|-----------------|----------------|----------------|
| | | A | B | C | D | E | | | | |
| CPH.75-S8-X | .75 (19.0) | 1.78 (45.3) | 1.60 (40.8) | 1.35 (34.4) | .90 (22.9) | 1.18 (30.0) | Black Acetal | #8 (M4) Screws | 10 | 100 |
| CPL.75-S8-X | | 1.08 (27.4) | 1.52 (38.6) | .56 (14.2) | .88 (22.4) | 1.11 (28.2) | | | 10 | 100 |

Wire End Holder

Secures wire ends with or without terminations while harness is being fabricated. Wires can be easily added or removed from the top, but will hold the wire from axial movement. Used with #28 thru #16 AWG wires. Two mounting slots .16" (4.1mm) for #8 (M4) screws.

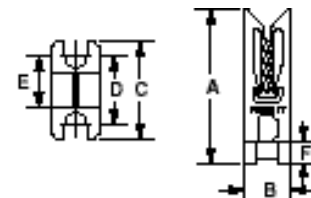

| Part Number | Dimensions Inches (mm) | | | | | | Material & Color | Mounting Method | Std. Pkg. Qty. | Std. Ctn. Qty. |
|-------------|------------------------|--------------|---------------|---------------|--------------|--------------|------------------|-----------------|----------------|----------------|
| | A | B | C | D | E | F | | | | |
| WEH-E8-C | 1.25 (31.8) | .38 (9.7) | .79 (20.0) | .55 (14.0) | .29 (7.4) | .18 (4.6) | Black Acetal | #8 (M4) Screws | 100 | 1000 |

T-Junction Fixture

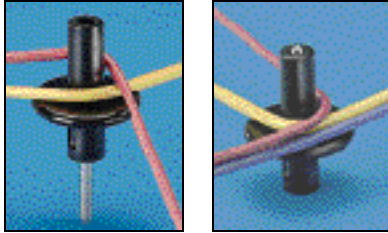

The "up" position allows forming of harness and cable tie installation

The "down" position allows easy harness removal.

Using an integral harness board nail, the fixture moves up and down (see photos) to form "T" junction. Unique design reduces cable tie usage by 1/3 compared to other fixtures.

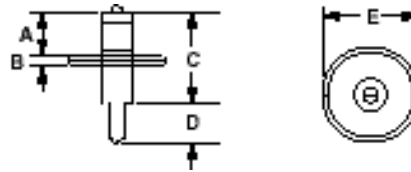

| Part Number | Max. Dia. In (mm) | Dimensions Inches (mm) | | | | | Material & Color | Mounting Method | Std. Pkg. Qty. | Std. Ctn. Qty. |
|-------------|-------------------|------------------------|-----------|-------------|------------|-------------|--------------------------------------|-----------------|----------------|----------------|
| | | A | B | C | D | E | | | | |
| TJF-X | 1.34 (34.0) | .75 (19.1) | .12 (3.0) | 1.39 (35.1) | .70 (17.8) | 1.12 (28.4) | Black Acetal and Nickel Plated Steel | Integral Nail | 10 | 100 |

Fanning Strip System

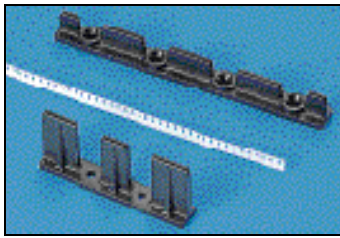

Assures that wires are held in a particular orientation in sophisticated wiring harnesses. Consists of fanning strip and fanning strip holder.

| Part Number | Dimensions Inches (mm) | | | | | | Material & Color | Mounting Method | Std. Pkg. Qty. |
|-------------|------------------------|-------------|------------|-------------|------------|-----------|------------------|----------------------|----------------|
| | A | B | C | D | E | F | | | |
| FS156-C | 12.0 (304.8) | .31 (7.9) | .04 (1.0) | .12 (3.0) | .156 (4.0) | .06 (1.5) | Nylon | Fanning Strip Holder | 100 |
| FSH40-X | 6.0 (152.4) | .62 (15.7) | .56 (14.2) | 1.50 (38.1) | .75 (19.0) | .04 (1.0) | ABS | #8 (M4) Screw | 10 |
| FSHH-X | 3.22 (82) | 1.38 (35.1) | .57 (14.5) | 1.12 (28.4) | .53 (13.5) | .04 (1.0) | ABS | | 10 |

Fanning Strip (FS156)

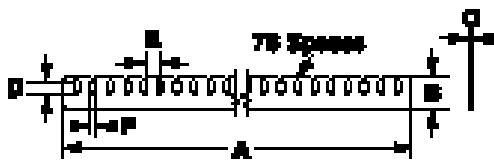

Contains evenly spaced "snap slots" to hold wires in place. No sharp edges to damage wire insulation. Becomes part of the wiring harness. Will accept wires up to 18 AWG. Used with FSH40 or FSHH holders.

Low Holder (FSH40-X)



Designed to hold FS156 Fanning Strip securely in place while wires are inserted into fanning strip.

High Holder (FSHH-X)

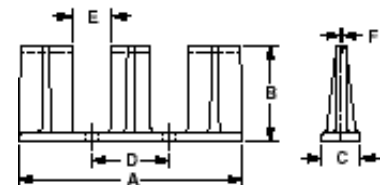

Used in conjunction with RER.75-S6, BR.75-E6 (BR.5-E6) and CPH.75-S8. Ideal for use with PAT cable tie tool. (See Page 10.)

Spring Wire Breakout System

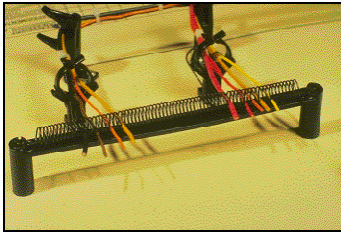

Consists of harness board springs and spring holders to hold wire ends taut. When harness is removed from board, wires simply pull from spring.

PBSC Spring Wire Breakout



SHH Spring Holder

Each SHH Spring Holder is supplied with (1) rigid wire piece to hold the spring laterally and two #8 (M4) 2" (50.8mm) hex head wood screws. Two sizes available for use with PBSC1 and PBSC6.

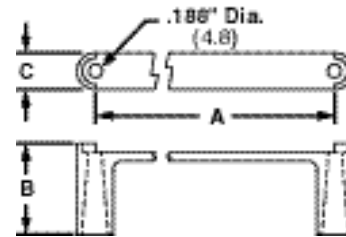

| Part Number | Dimensions Inches (mm) | | | Material & Color | Mounting Method | Packaging | |
|-------------|------------------------|------------|------------|------------------------|--|----------------|----------------|
| | A | B | C | | | Std. Pkg. Qty. | Std. Ctn. Qty. |
| PBSC1-X | 1.00 (25.4) | .44 (11.2) | — | .035" (.9) Thick Steel | Used with SHH1 Spring Holder | 10 | 100 |
| PBSC3-X | 3.00 (76.2) | | — | | — | 10 | 100 |
| PBSC6-X | 6.00 (152.4) | | — | | Used with SHH3 Spring Holder | 10 | 100 |
| PBSC12-X | 12.00 (304.8) | | — | | — | 10 | — |
| SHH1-S8-X | 1.90 (48.3) | 1.30 (33) | .50 (12.7) | Nylon | Two #8 (M4) 2" (50.8) Screws used with PBSC1 | 10 | — |
| SHH3-S8-X | 7.00 (177.8) | | | | Two #8 (M4) 2" (50.8) Screws used with PBSC6 | 10 | — |

Harness Board Nails

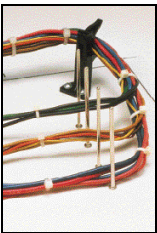

Speeds routing of wires. All have a uniform driving depth insured by collar stop.

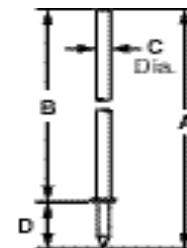

| Part Number | A | B | C | D | Material | Mounting Method | Std. Pkg. Qty. | Std. Ctn. Qty. |
|-------------|--------------|--------------|------------|------------|-------------------------|-----------------------------|----------------|----------------|
| HBN.75-T | 1.40 (35.6) | .78 (19.8) | .073 (1.9) | .62 (15.9) | Hardened Tempered Steel | Hammered into Harness Board | 200 | 1000 |
| HBN1-T | 1.65 (41.9) | 1.03 (26.2) | .073 (1.9) | | | | 200 | 1000 |
| HBN1.5-T | 2.15 (54.6) | 1.53 (38.4) | .082 (2.1) | | | | 200 | 1000 |
| HBN2-T | 2.65 (67.3) | 2.03 (51.6) | .093 (2.4) | | | | 200 | 1000 |
| HNB2.5-T | 3.17 (80.5) | 2.55 (64.8) | .110 (2.8) | | | | 200 | 1000 |
| HBN3-T | 3.67 (93.2) | 3.05 (77.5) | .120 (3.0) | | | | 200 | 1000 |
| HBN4-T | 4.67 (118.6) | 4.03 (102.9) | .144 (3.7) | | | | 200 | 1000 |

Harness Board Platform

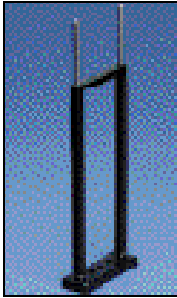

Elevates the bundle of wires from the harness board to allow the installation of Abrasion Protection products and the use of *PANDUIT* automatic cable tie tools. The platform is used as a template to mark the location of the nails. The nails are driven into the board with a hammer. The plastic sleeve slides over each nail.

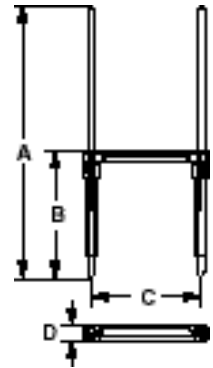

| Part Number | Max. Bundle Dia. In (mm) | Dimensions Inches (mm) | | | | Material | Mounting Method | Packaging | |
|-------------|--------------------------|------------------------|-----------------|----------------|---------------|---|---------------------------------|----------------|----------------|
| | | A | B | C | D | | | Std. Pkg. Qty. | Std. Ctn. Qty. |
| HB1P4-X | 1.00 (25.4) | 5.00 (127.0) | 4.00 (101.6) | 1.32 (33.5) | .375 (9.5) | Nylon platform, vinyl spacer, tempered steel nails | Driven into harness board | 10 | 100 |
| HB1P6-X | | 7.00 (203.2) | 6.00 (152.4) | | | | | 10 | 100 |
| HB2P4-X | 2.00 (51) | 6.00 (152.4) | 4.00 (101.6) | 2.32 (58.9) | | | | 10 | 100 |
| HB2P6-X | | 8.00 (203.2) | 6.00 (152.4) | | | | | 10 | 100 |

Harness Board Standoff Post

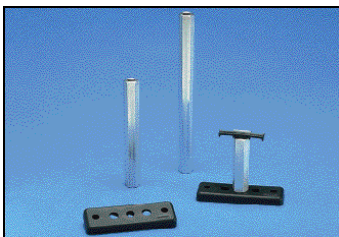

Used to hold a push mount accessory or push mount cable tie at a specific location on a harness board. The Standoff Post is placed over a hole in the harness board, a bolt is then threaded into the bottom of the standoff from the backside of the board and tightened. Push mount accessories are inserted into the top of the Standoff Post prior to assembly. When the assembly is complete, the harness and the attached push mount are removed from the Standoff Post.

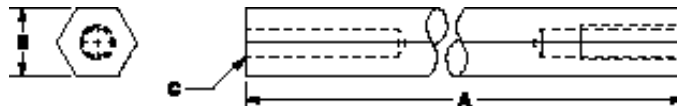

| Part Number | Dimensions Inches (mm) | | | Material | Mounting Method | Std. Pkg. Qty. | Std. Ctn. Qty. | |
|-------------|------------------------|---------------|---------------|---------------------------------------|-----------------|----------------|----------------|-----|
| | A | B | C | | | | | |
| HB2SP19-X | 2.00 (51) | .50 (12.7) | .203 (5.1) | Aluminum | (M6) Screw | 10 | 100 | |
| HB4SP19-X | 4.00 (101.6) | | | | | 10 | 100 | |
| HB6SP19-X | 6.00 (152.4) | | | | | 10 | 100 | |
| HB2SP25-X | 2.00 (51) | | | | | .295 (7.5) | 10 | 100 |
| HB4SP25-X | 4.00 (101.6) | | | | | | 10 | 100 |
| THMSPXX-C | | | | (See Page 9 for Complete Description) | | | | |
| THMSCXX-C | | | | | | | | |

THMSC—Tree Barb Style

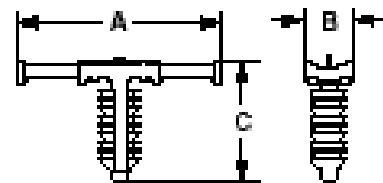

THMSP—Push Barb Style

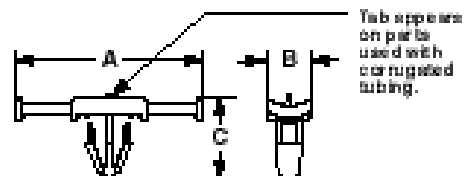

Tie Harness Mount Fixture

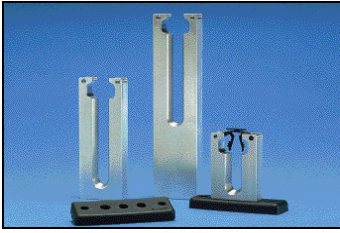

Used to hold and support the THM1SC Harness Mount. The mount is elevated from the harness board so that a cable tie can be installed by Panduit's automatic cable tie installation tools. The mount is pushed into the top of the fixture prior to assembly and pulled out of the fixture when the harness is complete.

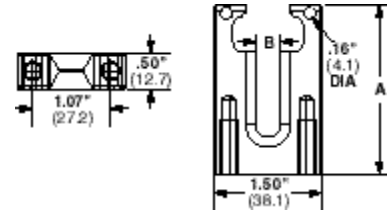

THMF

| Part Number | A | B | C | Material | Mounting Method | Std. Pkg. Qty. | Std. Ctn. Qty. |
|-------------|-----------------|--------------|---------------|-----------------------|-----------------|----------------|----------------|
| THMF2-X | 2.08 (52.8) | .28 (7.1) | — | Aluminum | (M6) Screw | 10 | 50 |
| THMF4-X | 4.08 (103.6) | .34 (8.7) | — | | | 10 | 50 |
| THMF6-X | 6.08 (154.4) | .34 (8.7) | — | | | 10 | 50 |
| THM1SC-C | | | | Nylon (Natural Color) | Push | 100 | 1000 |
| THM1SC-C69 | .98 (24.8) | .38 (9.5) | .75 (19.1) | Black | | | |

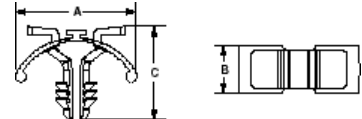

THM1SC

Harness Board Universal Adapter

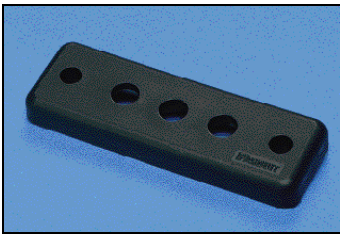

Used with the Harness Board Standoff Post or the Harness Mount Fixture when mounting holes can not be drilled into the harness board. A bolt is inserted from the back side of the adapter and then is turned right side up. The adapter is now ready to be secured to the harness board by using self tapping screws.

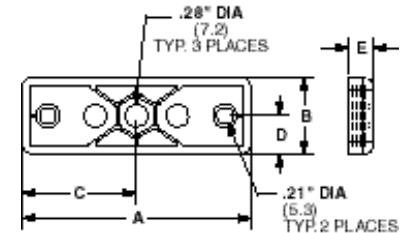

| Part Number | A | B | C | D | E | Material & Color | Mounting Method | Std. Pkg. Qty. | Std. Ctn. Qty. |
|-------------|--------------|----------------|----------------|---------------|--------------|------------------|-----------------|----------------|----------------|
| HBUA-X | 3.00 (77) | 1.00 (25.4) | 1.50 (38.1) | .50 (12.7) | .31 (7.9) | Black Nylon | Wood Screw | 10 | 100 |

Tie Harness Mounts — Using Two Cable Ties



Tie Harness Mounts are designed to be attached to the wire harness during assembly with 2 cable ties. Ties can be installed by hand or, more efficiently, with *PANDUIT* Automatic Cable Tie Tooling. Use with Harness Board Standoff Posts and Tie Harness Mount Fixtures (See pages 7 & 8). Available with or without corrugated tubing location tab.

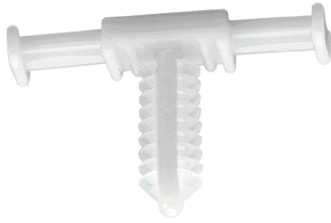

THMSC



THMSP

THMSC—Tree Barb Style

THMSP—Push Barb Style

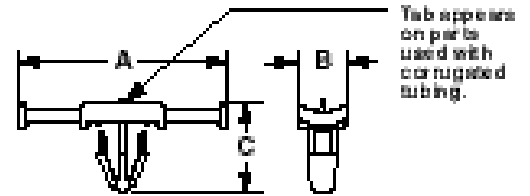
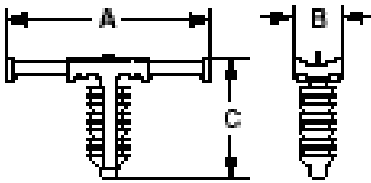

| Part Number | Used With Cable Ties** | Dimensions inches (mm) | | | | Panel Dimensions | | Material | Color | Where Used | Mounting Method | Packaging | | | | | |
|--|------------------------|------------------------|-----------|------------|---|------------------|-------------------------|-----------------------|---------------|---------------------|-----------------|----------------|----------------|----------------|----------------|--|--|
| | | A | B | C | D | Thickness Max. | Hole Diameter | | | | | Std. Pkg. Qty. | Std. Ctn. Qty. | Bulk Pkg. Qty. | Bulk Ctn. Qty. | | |
| TREE MOUNT STYLE FOR CORRUGATED TUBING —A specially designed location tab on the mount shelf aligns with grooves in corrugated tubing ensuring proper mount location during assembly. | | | | | | | | | | | | | | | | | |
| THMSC35-C639 | M, I, S | 1.54 (39.1) | .37 (9.5) | .46 (11.7) | — | .25 (6.4) | .244 - .268 (6.2 - 6.8) | Heat Stabilized Nylon | Natural Black | Indoors/ High Temp. | Tree Barb | 100 | 1000 | 1000 | 5000 | | |
| THMSC35-C630 | | | | | | | | | | | | 100 | 1000 | 1000 | 5000 | | |
| FOR DISCRETE WIRING —There is no location tab for applications not requiring the use of corrugated tubing. | | | | | | | | | | | | | | | | | |
| THMSP20F-C | M, I, S | 1.54 (39.1) | .37 (9.5) | .47 (11.9) | — | .16 (4.1) | .244 - .283 (6.2 - 7.2) | Nylon | Natural | Indoors | Push Barb | 100 | 1000 | 1000 | 5000 | | |
| THMSP20F-C30 | | | | | | | | Heat Stabilized Nylon | Black | Indoors/ High Temp. | | 100 | 1000 | 1000 | 5000 | | |
| THMSP25F-C | | | | .54 (13.7) | — | .23 (5.8) | | Nylon | Natural | Indoors | | 100 | 1000 | 1000 | 5000 | | |
| THMSP25F-C30 | | | | | | | | Heat Stabilized Nylon | Black | Indoors/ High Temp. | | 100 | 1000 | 1000 | 5000 | | |

Cable Tie Cross Section Sizes: M = Miniature, I = Intermediate, S = Standard, LH = Light Heavy and H = Heavy.

PAT1M/PAT1.5M Automatic Cable Tie Installation System

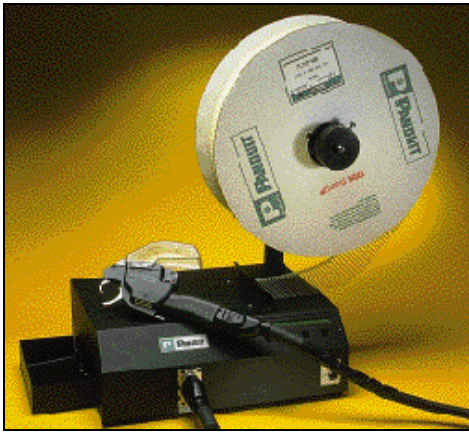

- System consists of a tool head, dispenser, feeder hose and reel of continuously molded cable ties (5000 per reel).
- System installs a cable tie in less than one second
- On-line help menu in English, Spanish, French, German or Italian
- Adjustable tension control
- Ergonomic and lightweight, no counter balance required
- Optional bench mount available

| Part Number | Description | Std. Pkg. Qty. |
|-------------|--|----------------|
| PAT1M | Tool head for cable ties up to .82" (21mm) bundle diameter | 1 |
| PAT1.5M | Tool head for cable ties up to 1.3" (33mm) bundle diameter | |
| PDM | Stationary dispenser | 1 |
| PHM1 | 3.2 ft (1m) feeder hose | 1 |
| PHM2 | 6.5 ft (2m) feeder hose | |
| PHM3 | 9.8 ft (3m) feeder hose | |
| PATMBM | Bench mount and foot pedal for PAT1M/PAT1.5M system | 1 |
| PDH10-37 | Airline | 1 |
| PL283N1 | Filter regulator | 1 |

- Slim, ergonomically designed handle for operator comfort and greater productivity
- Right or left hand operation

PANDUIT® Cable Ties — World Leader in Cable Ties and Harness Board Accessories

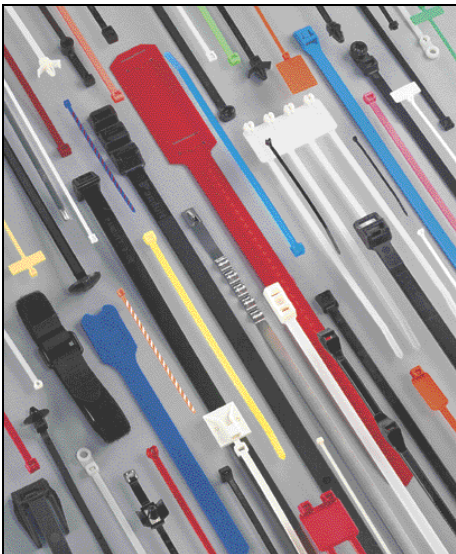

Panduit is the world's largest producer of cable ties and accessories, offering you the most complete selection of sizes, styles and materials. For harness manufacturing applications, *PANDUIT's* complete system of cable ties, harness board accessories and installation tooling provides the highest quality at the lowest installed cost. In addition, *PANDUIT* continually develops new cable tie and harness board accessories to meet your changing application challenges.

PANDUIT Cable Ties, Accessories and Installation Tooling are manufactured in an environment committed to design innovation, high quality and knowledgeable service to our customers. *PANDUIT* Cable Ties, Harness Board Accessories and Tooling provide system solutions for fast routing and forming as well as reliable and economical installations.

For more than 45 years, *PANDUIT* offers you the complete system for successful harness applications.

It's Easy to Obtain **PANDUIT®** Products

Just Call Your Panduit Sales Office Listed Below for the Names of Distributors Near You

| | | |
|--|---|--|
| ALABAMA Birmingham (205)290-2703 Huntsville (888) 506-5400 | MAINE (888) 506-5400 | NORTH CAROLINA Greensboro (336)854-1626 |
| ALASKA Anchorage (907)562-5663 | MARYLAND Eastern Baltimore (888) 506-5400 | NORTH DAKOTA Minneapolis, MN (612)946-9510 |
| ARIZONA Gilbert (888)506-5400 | MARYLAND Western Pittsburgh, PA (412)486-8488 | OHIO Cincinnati (888) 506-5400 Cleveland (888) 506-5400 Columbus (614)888-6224 |
| ARKANSAS Little Rock (501)455-4506 | MASSACHUSETTS Eastern N. Andover (978)681-0451 | OKLAHOMA Oklahoma City (405)842-8371 |
| CALIFORNIA Cupertino (408)342-1200 Santa Fe Springs (562)921-4423 Sacramento (530)885-6591 | MASSACHUSETTS Western (888) 506-5400 | OREGON Portland (888) 506-5400 |
| COLORADO (888) 506-5400 | MICHIGAN Detroit (248)577-5376 Grand Rapids (888) 506-5400 | PENNSYLVANIA Philadelphia (610)941-1155 Pittsburgh (412)486-8488 |
| CONNECTICUT (888) 506-5400 | MINNESOTA Minneapolis (612)946-9510 | PUERTO RICO Caguas (888) 506-5400 |
| DELAWARE Philadelphia, PA (610)941-1155 | MISSISSIPPI Northern Memphis, TN (901)276-0614 | RHODE ISLAND N. Andover, MA (978)681-0451 |
| FLORIDA Orlando (888) 506-5400 | MISSISSIPPI Southern Jackson (888) 506-5400 | SOUTH CAROLINA Greensboro, NC (336)854-1626 |
| FLORIDA Panhandle (888) 506-5400 | MISSOURI St. Louis (314)894-7800 Kansas City (888) 506-5400 | SOUTH DAKOTA Minneapolis, MN (612)946-9510 |
| GEORGIA Atlanta (404)256-5940 | MONTANA Bozeman (406)587-0513 | TENNESSEE Memphis (901)276-0614 Nashville (888) 506-5400 |
| HAWAII (808) 623-2893 | NEBRASKA Omaha (888) 506-5400 | TEXAS Dallas (972)518-0004 Houston (713)686-5600 |
| IDAHO Northern Spokane, WA (888)506-5400 | NEVADA Northern Sacramento, CA (530)885-6591 | UTAH Salt Lake City (801)973-7454 |
| IDAHO Southern Salt Lake City, UT (801)973-7454 | NEVADA Southern Phoenix, AZ (562)921-4423 | VERMONT (888) 506-5400 |
| ILLINOIS Northern Metro Chicago (888) 506-5400 Rockford (888) 506-5400 | NEW HAMPSHIRE N. Andover, MA (978)681-0451 | VIRGINIA Southern Richmond (888) 506-5400 |
| ILLINOIS Southern St. Louis, MO (314)894-7800 | NEW JERSEY Northern Leonia (201)461-7790 | VIRGINIA Northern Baltimore, MD (888) 506-5400 |
| INDIANA Indianapolis (888) 506-5400 | NEW JERSEY Southern Philadelphia, PA (610)941-1155 | WASHINGTON (888) 506-5400 |
| INDIANA Gary & South Bend Chicago, IL (888) 506-5400 | NEW MEXICO (888) 506-5400 | WASHINGTON, D.C. Baltimore, MD (888) 506-5400 |
| IOWA (888) 506-5400 | NEW YORK Albany (888) 506-5400 Buffalo (888) 506-5400 Rochester (888) 506-5400 Syracuse (888) 506-5400 | WEST VIRGINIA (304)562-7058 |
| KANSAS (888) 506-5400 | NEW YORK Metro NYC, L.I. Leonia, NJ (201)461-7790 | WISCONSIN (888) 506-5400 |
| KENTUCKY Louisville (502)491-4215 | | WYOMING (888) 506-5400 |
| LOUISIANA (888) 506-5400 | | |

For Information Call 888-506-5400 Ask for Ext. 7366

PANDUIT Products are available through Worldwide Subsidiaries and Distributors

All Reference Dimensions in This Catalog are Shown in Inches and (Millimeters)
Our products are warranted to be free from defects in material and workmanship at the time of sale but our obligation under this warranty is limited to the replacement of any product proved to be defective within 6 months (for product) or 90 days (for tools) from the date of delivery. Tool warranty is void if Panduit tools are modified, altered or misused in any way. Use of Panduit tooling with any product other than the specified Panduit products for which the tool was designed, constitutes misuse. Before using, user shall determine the suitability of the product for his intended use and user assumes all risk and liability whatsoever in connection therewith.

This warranty is made in lieu of and excludes all other warranties, expressed or implied. THE IMPLIED WARRANTIES OF MERCHANTABILITY AND FITNESS FOR A PARTICULAR USE ARE SPECIFICALLY EXCLUDED. Neither seller nor manufacturer shall be liable for any other injury, loss or damage, whether direct or consequential, arising out of the use of, or the inability to use, the product.

The information contained in this literature is based on our experience to date and is believed to be reliable. It is intended as a guide for use by persons having technical skill at their own discretion and risk. We do not guarantee favorable results or assume any liability in connection with its use. Dimensions contained herein are for reference purposes only. For specific dimensional requirements consult the factory. This publication is not to be taken as a license to operate under, or a recommendation to infringe any existing patents. This

Order number of pieces required in multiples of Std. Pkg. Qty.



Panduit Corp.
17301 Ridgeland Avenue
Tinley Park, IL 60477-3091
Phone: 888-506-5400, Ext. 7366
708-532-1800
FAX: 770-781-9076
Email: info@panduit.com
Website: www.panduit.com

Panduit Canada
Div. of Panduit Corp.
140 Amber Street
Markham, Ontario L3R 3J8
Phone: 800-387-9689
905-475-6922
FAX: 905-475-6998

*For Pricing and Further Information —
Contact your local authorized
PANDUIT Distributor or Sales Office*

Printed in U.S.A.

WORLDWIDE SUBSIDIARIES AND SALES OFFICES

SA101N556-WA

Компания «Океан Электроники» предлагает заключение долгосрочных отношений при поставках импортных электронных компонентов на взаимовыгодных условиях!

Наши преимущества:

- Поставка оригинальных импортных электронных компонентов напрямую с производств Америки, Европы и Азии, а так же с крупнейших складов мира;
- Широкая линейка поставок активных и пассивных импортных электронных компонентов (более 30 млн. наименований);
- Поставка сложных, дефицитных, либо снятых с производства позиций;
- Оперативные сроки поставки под заказ (от 5 рабочих дней);
- Экспресс доставка в любую точку России;
- Помощь Конструкторского Отдела и консультации квалифицированных инженеров;
- Техническая поддержка проекта, помощь в подборе аналогов, поставка прототипов;
- Поставка электронных компонентов под контролем ВП;
- Система менеджмента качества сертифицирована по Международному стандарту ISO 9001;
- При необходимости вся продукция военного и аэрокосмического назначения проходит испытания и сертификацию в лаборатории (по согласованию с заказчиком);
- Поставка специализированных компонентов военного и аэрокосмического уровня качества (Xilinx, Altera, Analog Devices, Intersil, Interpoint, Microsemi, Actel, Aeroflex, Peregrine, VPT, Syfer, Eurofarad, Texas Instruments, MS Kennedy, Miteq, Cobham, E2V, MA-COM, Hittite, Mini-Circuits, General Dynamics и др.);

Компания «Океан Электроники» является официальным дистрибьютором и эксклюзивным представителем в России одного из крупнейших производителей разъемов военного и аэрокосмического назначения «JONHON», а так же официальным дистрибьютором и эксклюзивным представителем в России производителя высокотехнологичных и надежных решений для передачи СВЧ сигналов «FORSTAR».



JONHON

«JONHON» (основан в 1970 г.)

Разъемы специального, военного и аэрокосмического назначения:

(Применяются в военной, авиационной, аэрокосмической, морской, железнодорожной, горно- и нефтедобывающей отраслях промышленности)

«FORSTAR» (основан в 1998 г.)

ВЧ соединители, коаксиальные кабели, кабельные сборки и микроволновые компоненты:

(Применяются в телекоммуникациях гражданского и специального назначения, в средствах связи, РЛС, а так же военной, авиационной и аэрокосмической отраслях промышленности).



Телефон: 8 (812) 309-75-97 (многоканальный)

Факс: 8 (812) 320-03-32

Электронная почта: ocean@oceanchips.ru

Web: <http://oceanchips.ru/>

Адрес: 198099, г. Санкт-Петербург, ул. Калинина, д. 2, корп. 4, лит. А