



Micro Commercial Components



Micro Commercial Components
20736 Marilla Street Chatsworth
CA 91311
Phone: (818) 701-4933
Fax: (818) 701-4939

SMAJ5.0
THRU
SMAJ440CA

Features

- Halogen free available upon request by adding suffix "-HF"
For Surface Mount Applications
Unidirectional And Bidirectional
Low Inductance
High Temp Soldering: 260°C for 10 Seconds At Terminals
For Bidirectional Devices Add "C" To The Suffix of The Part
Number: i.e.SMAJ5.0CA for 5% Tolerance
Lead Free Finish/Rohs Compliant (Note1) ("P"Suffix designates
Compliant. See ordering information)
UL Recognized File # E331408

Mechanical Data

- Epoxy meets UL 94 V-0 flammability rating
Moisture Sensitivity Level 1
Polarity: Indicated by cathode band except bi-directional types

Maximum Rating:

- Operating Temperature: -55°C to +175°C
Storage Temperature: -55°C to +175°C
Typical Thermal Resistance: 100°C/W Junction to Ambient

Table with 4 columns: Parameter, Symbol, Value, Note. Rows include Peak Pulse Current, Peak Pulse Power Dissipation, Steady State Power Dissipation, and Peak Forward Surge Current.

Note: 1. High Temperature Solder Exemptions Applied, see EU Directive Annex 7.

- 2. Non-repetitive current pulse, per Fig.3 and derated above
TA=25°C per Fig.2.
3. Mounted on 5.0mm² copper pads to each terminal.
4. 8.3ms, single half sine wave duty cycle = 4 pulses per
Minutes maximum.
5. Lead temperature at TL = 75°C.
6. Peak pulse power waveform is 10/1000µS.

400 Watt
Transient Voltage
Suppressors
5.0 to 440 Volts

DO-214AC
(SMA)(LEAD FRAME)

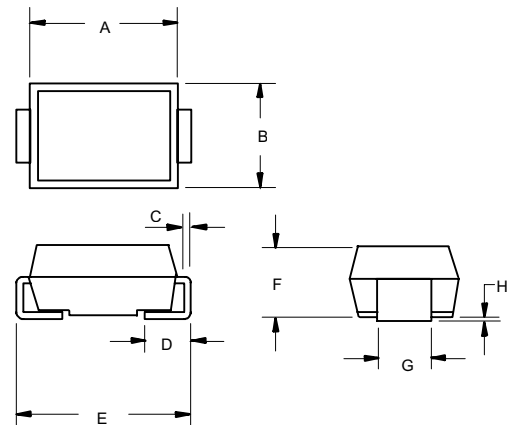

Table with 6 columns: DIM, INCHES (MIN, MAX), MM (MIN, MAX), NOTE. Lists dimensions A through H.

SUGGESTED SOLDER
PAD LAYOUT



# SMAJ5.0 thru SMAJ440CA

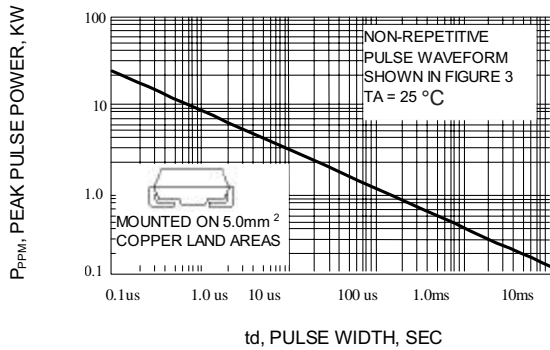

Fig. 1-PEAK PULSE POWER RATING CURVE

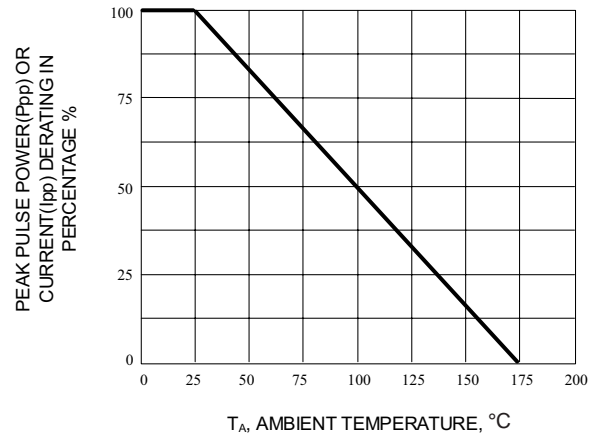

Fig. 2-PULSE RATING CURVE



Fig. 3-PULSE WAVEFORM

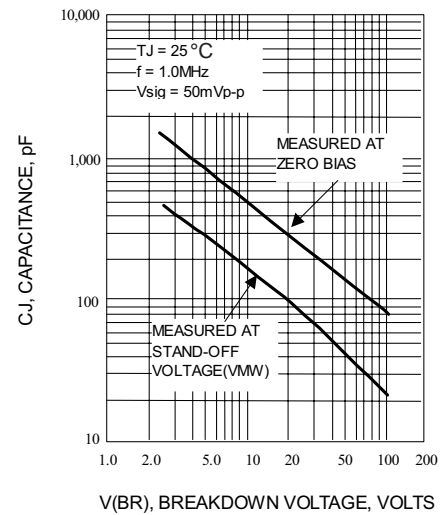

Fig. 4-TYPICAL JUNCTION CAPACITANCE

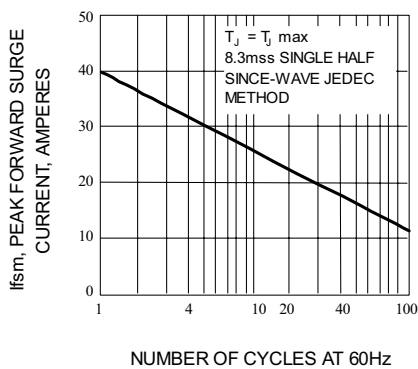

Fig. 5-MAXIMUM NON-REPETITIVE PEAK FORWARD SURGE CURRENT

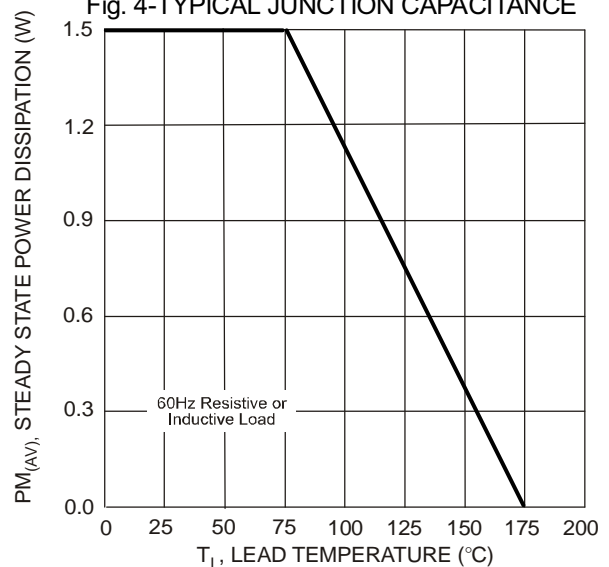

Fig. 6-Steady State Power Derating Curve

# SMAJ5.0 thru SMAJ440CA

## ELECTRICAL CHARACTERISTICS @25°C

| MCC PART NUMBER |           | REVERSE STAND-OFF VOLTAGE $V_{WM}$ | BREAKDOWN VOLTAGE $V_{(BR)} @ I_T$ (VOLTS) |      |            | MAXIMUM CLAMPING VOLTAGE @ $I_{PP}$ | PEAK PULSE CURRENT $I_{PP}$ | MAXIMUM REVERSE LEAKAGE @ $V_{WM}$ $I_D$ | MARKING CODE |    |
|-----------------|-----------|------------------------------------|--|------|------------|-------------------------------------|-----------------------------|--|--------------|----|
| UNI-POLAR       | BI-POLAR  | (VOLTS)                            | MIN  | MAX  | $I_T$ (mA) | (VOLTS)                             | (AMPS)                      | ( $\mu$ A)                               | 1            | 2  |
| SMAJ5.0A        | SMAJ5.0CA | 5.0                                | 6.40                                       | 7.00 | 10         | 9.2                                 | 43.5                        | 800                                      | AE           | WE |
| SMAJ6.0A        | SMAJ6.0CA | 6.0                                | 6.67                                       | 7.37 | 10         | 10.3                                | 38.8                        | 800                                      | AG           | WG |
| SMAJ6.5A        | SMAJ6.5CA | 6.5                                | 7.22                                       | 7.98 | 10         | 11.2                                | 35.7                        | 500                                      | AK           | WK |
| SMAJ7.0A        | SMAJ7.0CA | 7.0                                | 7.78                                       | 8.60 | 10         | 12.0                                | 33.3                        | 200                                      | AM           | WM |
| SMAJ7.5A        | SMAJ7.5CA | 7.5                                | 8.33                                       | 9.21 | 1          | 12.9                                | 31.0                        | 100                                      | AP           | WP |
| SMAJ8.0A        | SMAJ8.0CA | 8.0                                | 8.89                                       | 9.83 | 1          | 13.6                                | 29.4                        | 50                                       | AR           | WR |
| SMAJ8.5A        | SMAJ8.5CA | 8.5                                | 9.44                                       | 10.4 | 1          | 14.4                                | 27.7                        | 20                                       | AT           | WT |
| SMAJ9.0A        | SMAJ9.0CA | 9.0                                | 10.0                                       | 11.1 | 1          | 15.4                                | 26.0                        | 10                                       | AV           | WV |
| SMAJ10A         | SMAJ10CA  | 10                                 | 11.1                                       | 12.3 | 1          | 17.0                                | 23.5                        | 5  | AX           | WX |
| SMAJ11A         | SMAJ11CA  | 11                                 | 12.2                                       | 13.5 | 1          | 18.2                                | 22.0                        | 1  | AZ           | WZ |
| SMAJ12A         | SMAJ12CA  | 12                                 | 13.3                                       | 14.7 | 1          | 19.9                                | 20.1                        | 1  | BE           | XE |
| SMAJ13A         | SMAJ13CA  | 13                                 | 14.4                                       | 15.9 | 1          | 21.5                                | 18.6                        | 1  | BG           | XG |
| SMAJ14A         | SMAJ14CA  | 14                                 | 15.6                                       | 17.2 | 1          | 23.2                                | 17.2                        | 1  | BK           | XK |
| SMAJ15A         | SMAJ15CA  | 15                                 | 16.7                                       | 18.5 | 1          | 24.4                                | 16.4                        | 1  | BM           | XM |
| SMAJ16A         | SMAJ16CA  | 16                                 | 17.8                                       | 19.7 | 1          | 26.0                                | 15.3                        | 1  | BP           | XP |
| SMAJ17A         | SMAJ17CA  | 17                                 | 18.9                                       | 20.9 | 1          | 27.6                                | 14.5                        | 1  | BR           | XR |
| SMAJ18A         | SMAJ18CA  | 18                                 | 20.0                                       | 22.1 | 1          | 29.2                                | 13.7                        | 1  | BT           | XT |
| SMAJ20A         | SMAJ20CA  | 20                                 | 22.2                                       | 24.5 | 1          | 32.4                                | 12.3                        | 1  | BV           | XV |
| SMAJ22A         | SMAJ22CA  | 22                                 | 24.4                                       | 26.9 | 1          | 35.5                                | 11.2                        | 1  | BX           | XX |
| SMAJ24A         | SMAJ24CA  | 24                                 | 26.7                                       | 29.5 | 1          | 38.9                                | 10.3                        | 1  | BZ           | XZ |
| SMAJ26A         | SMAJ26CA  | 26                                 | 28.9                                       | 31.9 | 1          | 42.1                                | 9.5                         | 1  | CE           | YE |
| SMAJ28A         | SMAJ28CA  | 28                                 | 31.1                                       | 34.4 | 1          | 45.4                                | 8.8                         | 1  | CG           | YG |
| SMAJ30A         | SMAJ30CA  | 30                                 | 33.3                                       | 36.8 | 1          | 48.4                                | 8.3                         | 1  | CK           | YK |
| SMAJ33A         | SMAJ33CA  | 33                                 | 36.7                                       | 40.6 | 1          | 53.3                                | 7.5                         | 1  | CM           | YM |
| SMAJ36A         | SMAJ36CA  | 36                                 | 40.0                                       | 44.2 | 1          | 58.1                                | 6.9                         | 1  | CP           | YP |
| SMAJ40A         | SMAJ40CA  | 40                                 | 44.4                                       | 49.1 | 1          | 64.5                                | 6.2                         | 1  | CR           | YR |
| SMAJ43A         | SMAJ43CA  | 43                                 | 47.8                                       | 52.8 | 1          | 69.4                                | 5.7                         | 1  | CT           | YT |
| SMAJ45A         | SMAJ45CA  | 45                                 | 50.0                                       | 55.3 | 1          | 72.7                                | 5.5                         | 1  | CV           | YV |
| SMAJ48A         | SMAJ48CA  | 48                                 | 53.3                                       | 58.9 | 1          | 77.4                                | 5.2                         | 1  | CX           | YX |
| SMAJ51A         | SMAJ51CA  | 51                                 | 56.7                                       | 62.7 | 1          | 82.4                                | 4.9                         | 1  | CZ           | YZ |
| SMAJ54A         | SMAJ54CA  | 54                                 | 60.0                                       | 66.3 | 1          | 87.1                                | 4.6                         | 1  | RE           | ZE |
| SMAJ58A         | SMAJ58CA  | 58                                 | 64.4                                       | 71.2 | 1          | 93.6                                | 4.3                         | 1  | RG           | ZG |
| SMAJ60A         | SMAJ60CA  | 60                                 | 66.7                                       | 73.7 | 1          | 96.8                                | 4.1                         | 1  | RK           | ZK |
| SMAJ64A         | SMAJ64CA  | 64                                 | 71.1                                       | 78.6 | 1          | 103                                 | 3.9                         | 1  | RM           | ZM |
| SMAJ70A         | SMAJ70CA  | 70                                 | 77.8                                       | 86.0 | 1          | 113                                 | 3.5                         | 1  | RP           | ZP |
| SMAJ75A         | SMAJ75CA  | 75                                 | 83.3                                       | 92.1 | 1          | 121                                 | 3.3                         | 1  | RR           | ZR |
| SMAJ78A         | SMAJ78CA  | 78                                 | 86.7                                       | 95.8 | 1          | 126                                 | 2.2                         | 1  | RT           | ZT |
| SMAJ85A         | SMAJ85CA  | 85                                 | 94.4                                       | 104  | 1          | 137                                 | 2.9                         | 1  | RV           | ZV |
| SMAJ90A         | SMAJ90CA  | 90                                 | 100  | 111  | 1          | 146                                 | 2.7                         | 1  | RX           | ZX |
| SMAJ100A        | SMAJ100CA | 100                                | 111  | 123  | 1          | 162                                 | 2.5                         | 1  | RZ           | ZZ |
| SMAJ110A        | SMAJ110CA | 110                                | 122  | 135  | 1          | 177                                 | 2.3                         | 1  | SE           | VE |
| SMAJ120A        | SMAJ120CA | 120                                | 133  | 147  | 1          | 193                                 | 2.1                         | 1  | SG           | VG |
| SMAJ130A        | SMAJ130CA | 130                                | 144  | 159  | 1          | 209                                 | 1.9                         | 1  | SK           | VK |
| SMAJ150A        | SMAJ150CA | 150                                | 167  | 185  | 1          | 243                                 | 1.6                         | 1  | SM           | VM |
| SMAJ160A        | SMAJ160CA | 160                                | 178  | 197  | 1          | 259                                 | 1.5                         | 1  | SP           | VP |
| SMAJ170A        | SMAJ170CA | 170                                | 189  | 209  | 1          | 275                                 | 1.5                         | 1  | SR           | VR |
| SMAJ180A        | SMAJ180CA | 180                                | 201  | 222  | 1          | 292                                 | 1.4                         | 1  | ST           | VT |
| SMAJ200A        | SMAJ200CA | 200                                | 224  | 247  | 1          | 324                                 | 1.2                         | 1  | SV           | VV |
| SMAJ220A        | SMAJ220CA | 220                                | 246  | 272  | 1          | 356                                 | 1.1                         | 1  | SX           | VX |
| SMAJ250A        | SMAJ250CA | 250                                | 279  | 309  | 1          | 405                                 | 1.0                         | 1  | SZ           | VZ |
| SMAJ300A        | SMAJ300CA | 300                                | 335  | 371  | 1          | 486                                 | 0.8                         | 1  | TE           | UE |
| SMAJ350A        | SMAJ350CA | 350                                | 391  | 432  | 1          | 567                                 | 0.7                         | 1  | TG           | UG |
| SMAJ400A        | SMAJ400CA | 400                                | 447  | 494  | 1          | 648                                 | 0.6                         | 1  | TK           | UK |
| SMAJ440A        | SMAJ440CA | 440                                | 492  | 543  | 1          | 713                                 | 0.6                         | 1  | TM           | UM |

For bi-directional type having  $V_{RWM}$  of 10 Volts and less, the  $I_R$  limit is double.  
For parts without A, the  $V_{BR}$  is +10%.



Micro Commercial Components

### Ordering Information :

| Device         | Packing               |
|----------------|-----------------------|
| Part Number-TP | Tape&Reel: 5Kpcs/Reel |

Note : Adding "-HF" suffix for halogen free, eg. Part Number-TP-HF

#### \*\*\*IMPORTANT NOTICE\*\*\*

**Micro Commercial Components Corp.** reserves the right to make changes without further notice to any product herein to make corrections, modifications , enhancements , improvements , or other changes . **Micro Commercial Components Corp .** does not assume any liability arising out of the application or use of any product described herein; neither does it convey any license under its patent rights ,nor the rights of others . The user of products in such applications shall assume all risks of such use and will agree to hold **Micro Commercial Components Corp .** and all the companies whose products are represented on our website, harmless against all damages.

#### \*\*\*LIFE SUPPORT\*\*\*

MCC's products are not authorized for use as critical components in life support devices or systems without the express written approval of Micro Commercial Components Corporation.

#### \*\*\*CUSTOMER AWARENESS\*\*\*

Counterfeiting of semiconductor parts is a growing problem in the industry. Micro Commercial Components (MCC) is taking strong measures to protect ourselves and our customers from the proliferation of counterfeit parts. MCC strongly encourages customers to purchase MCC parts either directly from MCC or from Authorized MCC Distributors who are listed by country on our web page cited below. Products customers buy either from MCC directly or from Authorized MCC Distributors are genuine parts, have full traceability, meet MCC's quality standards for handling and storage. **MCC will not provide any warranty coverage or other assistance for parts bought from Unauthorized Sources.** MCC is committed to combat this global problem and encourage our customers to do their part in stopping this practice by buying direct or from authorized distributors.

Компания «Океан Электроники» предлагает заключение долгосрочных отношений при поставках импортных электронных компонентов на взаимовыгодных условиях!

Наши преимущества:

- Поставка оригинальных импортных электронных компонентов напрямую с производств Америки, Европы и Азии, а так же с крупнейших складов мира;
- Широкая линейка поставок активных и пассивных импортных электронных компонентов (более 30 млн. наименований);
- Поставка сложных, дефицитных, либо снятых с производства позиций;
- Оперативные сроки поставки под заказ (от 5 рабочих дней);
- Экспресс доставка в любую точку России;
- Помощь Конструкторского Отдела и консультации квалифицированных инженеров;
- Техническая поддержка проекта, помощь в подборе аналогов, поставка прототипов;
- Поставка электронных компонентов под контролем ВП;
- Система менеджмента качества сертифицирована по Международному стандарту ISO 9001;
- При необходимости вся продукция военного и аэрокосмического назначения проходит испытания и сертификацию в лаборатории (по согласованию с заказчиком);
- Поставка специализированных компонентов военного и аэрокосмического уровня качества (Xilinx, Altera, Analog Devices, Intersil, Interpoint, Microsemi, Actel, Aeroflex, Peregrine, VPT, Syfer, Eurofarad, Texas Instruments, MS Kennedy, Miteq, Cobham, E2V, MA-COM, Hittite, Mini-Circuits, General Dynamics и др.);

Компания «Океан Электроники» является официальным дистрибьютором и эксклюзивным представителем в России одного из крупнейших производителей разъемов военного и аэрокосмического назначения «JONHON», а так же официальным дистрибьютором и эксклюзивным представителем в России производителя высокотехнологичных и надежных решений для передачи СВЧ сигналов «FORSTAR».



## JONHON

«JONHON» (основан в 1970 г.)

Разъемы специального, военного и аэрокосмического назначения:

(Применяются в военной, авиационной, аэрокосмической, морской, железнодорожной, горно- и нефтедобывающей отраслях промышленности)

«FORSTAR» (основан в 1998 г.)

ВЧ соединители, коаксиальные кабели, кабельные сборки и микроволновые компоненты:

(Применяются в телекоммуникациях гражданского и специального назначения, в средствах связи, РЛС, а так же военной, авиационной и аэрокосмической отраслях промышленности).



Телефон: 8 (812) 309-75-97 (многоканальный)

Факс: 8 (812) 320-03-32

Электронная почта: [ocean@oceanchips.ru](mailto:ocean@oceanchips.ru)

Web: <http://oceanchips.ru/>

Адрес: 198099, г. Санкт-Петербург, ул. Калинина, д. 2, корп. 4, лит. А