



00-9176-00X-7XX-XX6

PREFIX

SERIES

NO. OF WAYS

CODE	NO. OF WAYS
001	1
002	2
003	3

WIRE GAUGE SIZE

CODE	DESCRIPTION	ACCEPTED WIRE GAUGE	WIRE INSULATION
701	CAPPED-IDC CONNECTOR	18 AWG STRANDED	Ø 1.6-2.1
711		20 AWG STRANDED	Ø 1.6-2.1
722		22 AWG STRANDED	Ø 1.1-1.6
732		24 AWG STRANDED	Ø 1.1-1.6

Elco Europe (A Division of AVX Ltd) CONFIDENTIAL PROPRIETY
The document on this print and information therewith are PROPRIETY
to Elco Europe (A Division of AVX Ltd) and shall not be copied
or disclosed in whole or in part without Elco Europe's written consent.

COLOUR OPTION

CODE	INSULATOR COLOUR	AVAILABILITY
0	BLACK	SPECIAL ORDER
1	WHITE	STANDARD

CAP OPTIONS

CODE	CAP OPTION	DESCRIPTION	DETAILS
0	THROUGH WIRE	ALLOWS WIRE TO BE TERMINATED AT ANY POINT	REFER TO SHEETS 2 TO 4
9	WIRE STOP	TERMINATES END OF WIRE END PROTECTED BY STOP FACE	REFER TO SHEETS 5 TO 7

PLATING OPTION

CODE	DESCRIPTION
6	PURE TIN ALL OVER

AVX CONTROLLED RELEASE

ELCO EUROPE (A DIVISION OF AVX LTD.) CONFIDENTIAL PROPRIETARY
THE DRAWING ON THIS PRINT AND INFORMATION THEREWITH ARE PROPRIETARY TO ELCO EUROPE (A DIVISION OF AVX LTD.) AND SHALL NOT BE USED OR DISCLOSED IN WHOLE OR IN PART WITHOUT ELCO EUROPE'S WRITTEN CONSENT.

SHEET 1 OF 8

FORM-106-01-036-6 ISS 7
Release No.
History
102847
04.05.2012
18.05.2012
20.08.2012

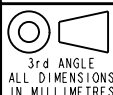

ELCO

© COPYRIGHT ELCO EUROPE
NOT TO BE DISCLOSED OR COPIED
WITHOUT WRITTEN PERMISSION

Drawn
N.C.H.

Size
CV

Description
18-24AWG IDC WIRE TO BOARD CONNECTOR

Part Number
00-9176-01_700S

DATE
04-Apr-12

Issue
C



**18-24 AWG 1 WAY IDC CONNECTOR
THROUGH WIRE CAPPED IDC**

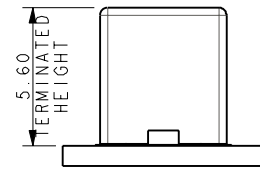
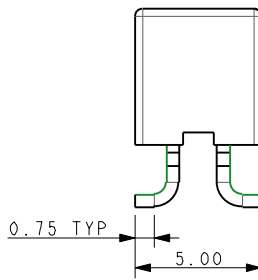
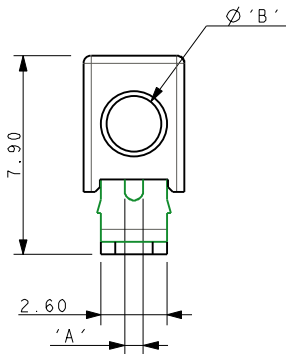
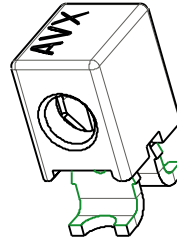
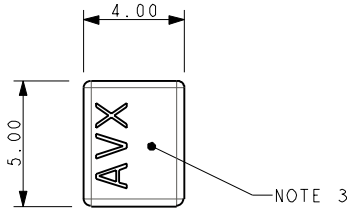

MOUNTED ON PCB

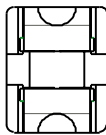

CODE	WIRE GAUGE	'A'	WIRE INSULATION	'B'
701	18AWG STRANDED	0.74	Ø 1.6-2.1	2.1
711	20AWG STRANDED	0.60	Ø 1.6-2.1	2.1
722	22AWG STRANDED	0.47	Ø 1.1-1.6	1.6
732	24AWG STRANDED	0.37	Ø 1.1-1.6	1.6

Elco Europe (A Division of AVX Ltd) CONFIDENTIAL PROPRIETY
The document on this print and information therewith are PROPRIETY
to Elco Europe (A Division of AVX Ltd) and shall not be copied
or disclosed in whole or in part without Elco Europe's written consent.

PACKING NOTES

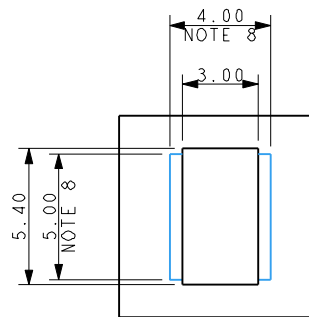
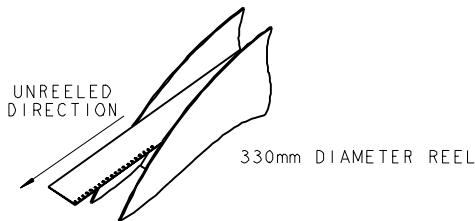

SUGGESTED PCB LAYOUT

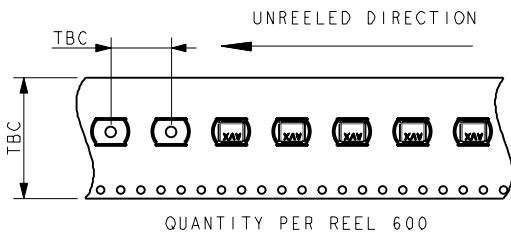

QUANTITY PER REEL 600

NOTES :-

1. 1 WAY CONNECTOR FOR IDC WIRE TO BOARD CONNECTION, PRE ASSEMBLED THROUGH WIRE CAP, CODE REFER TO SHEET 1.
2. CONTACT/CAP TO MATCH 18-24AWG STRANDED WIRE, INSULATION DIAMETER RANGE AS IN TABLE.
3. FLAT FACE ON TOP OF CAP TO AID PICK AND PLACE ASSEMBLY.
4. FOR FULL DETAILS REFER TO ELCO SPECIFICATION 201-01-138.
5. ASSEMBLY PROCEDURE, REFER TO APPLICATION NOTES 201-01-140.
6. GENERAL TOLERANCE ±0.20 UNLESS STATED.
7. PACKED IN TAPE AND REEL, QUANTITY PER REEL 600.
8. CONNECTOR OUTLINE.
9. CONTACT MATERIAL :- TIN PLATED COPPER ALLOY.
10. INSULATION MATERIAL, HIGH TEMPERATURE NYLON, GLASS FILLED. UL94 V-0, COLOUR REFER TO SHEET 1.
11. GENERAL TOLERANCE ±0.20 UNLESS STATED.

FORM-106-01-056-6 ISS 7

ELCO EUROPE (A DIVISION OF AVX LTD.) CONFIDENTIAL PROPRIETY
 THE DRAWING ON THIS PRINT AND INFORMATION THEREWITH ARE PROPRIETARY TO ELCO EUROPE (A DIVISION OF AVX LTD.) AND SHALL NOT BE USED OR DISCLOSED IN WHOLE OR IN PART WITHOUT ELCO EUROPE'S WRITTEN CONSENT.

SHEET 2 OF 8

Release No. 102847	History 04.05.2012 18.05.2012 20.08.2012
-----------------------	---

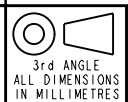

Drawn N.C.H.	Description 18-24AWG IDC WIRE TO BOARD CONNECTOR	DATE 04-Apr-12
Size CV	Part Number 00-9176-01_700S	Issue C

A

B



**18-24 AWG 2 WAY IDC CONNECTOR
THROUGH WIRE CAPPED IDC**

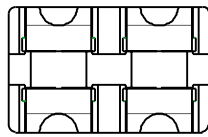
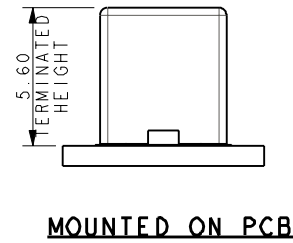
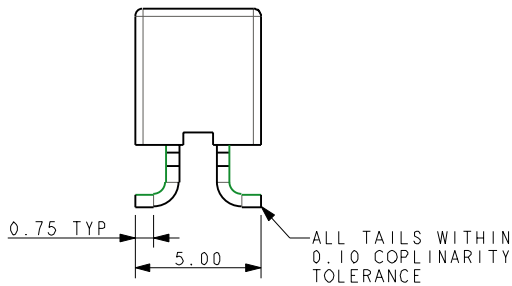
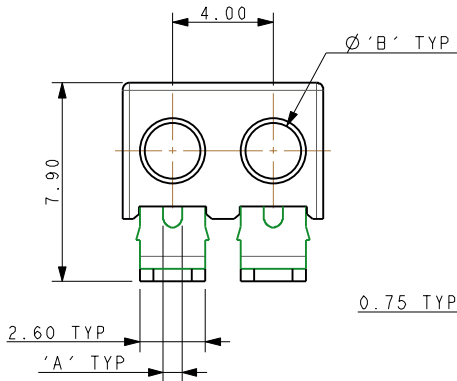
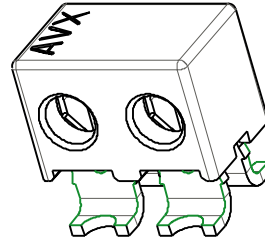
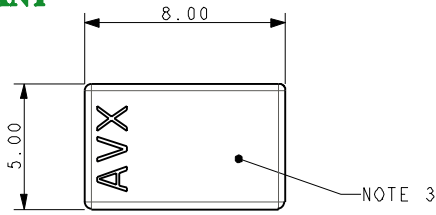

CODE	WIRE GAUGE	'A'	WIRE INSULATION	'B'
701	18AWG STRANDED	0.74	Ø 1.6-2.1	2.1
711	20AWG STRANDED	0.60	Ø 1.6-2.1	2.1
722	22AWG STRANDED	0.47	Ø 1.1-1.6	1.6
732	24AWG STRANDED	0.37	Ø 1.1-1.6	1.6

Elco Europe (A Division of AVX Ltd) CONFIDENTIAL PROPRIETY
The document on this print and information therewith are PROPRIETY to Elco Europe (A Division of AVX Ltd) and shall not be copied or disclosed in whole or in part without Elco Europe's written consent.

PACKING NOTES

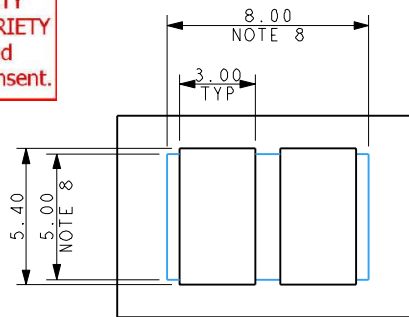
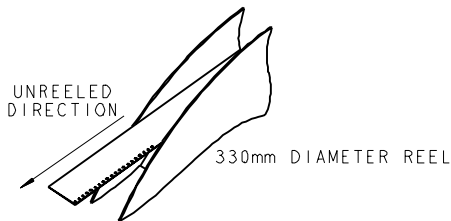

SUGGESTED PCB LAYOUT

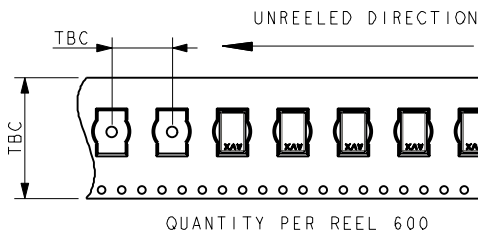

NOTES :-

- 2 WAY CONNECTOR FOR IDC WIRE TO BOARD CONNECTION, PRE ASSEMBLED THROUGH WIRE CAP, CODE REFER TO SHEET 1.
- CONTACT/CAP TO MATCH 18-24AWG STRANDED WIRE, INSULATION DIAMETER RANGE AS IN TABLE.
- FLAT FACE ON TOP OF CAP TO AID PICK AND PLACE ASSEMBLY.
- FOR FULL DETAILS REFER TO ELCO SPECIFICATION 201-01-138.
- ASSEMBLY PROCEDURE, REFER TO APPLICATION NOTES 201-01-140.
- GENERAL TOLERANCE ±0.20 UNLESS STATED.
- PACKED IN TAPE AND REEL, QUANTITY PER REEL 600.
- CONNECTOR OUTLINE.
- CONTACT MATERIAL :- TIN PLATED COPPER ALLOY.
- INSULATION MATERIAL, HIGH TEMPERATURE NYLON, GLASS FILLED. UL94 V-0, COLOUR REFER TO SHEET 1.
- GENERAL TOLERANCE ±0.20 UNLESS STATED.

ELCO EUROPE (A DIVISION OF AVX LTD.) CONFIDENTIAL PROPRIETY
THE DRAWING ON THIS PRINT AND INFORMATION THEREWITH ARE PROPRIETY TO ELCO EUROPE (A DIVISION OF AVX LTD.) AND SHALL NOT BE USED OR DISCLOSED IN WHOLE OR IN PART WITHOUT ELCO EUROPE'S WRITTEN CONSENT.

SHEET 3 OF 8

Release No.
History
102847
04.05.2012
18.05.2012
20.08.2012

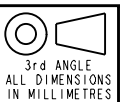

Drawn N.C.H.	Description 18-24AWG IDC WIRE TO BOARD CONNECTOR	DATE 04-Apr-12
Size CV	Part Number 00-9176-01_700S	Issue C

A

B



**18-24 AWG 3 WAY IDC CONNECTOR
THROUGH WIRE CAPPED IDC**

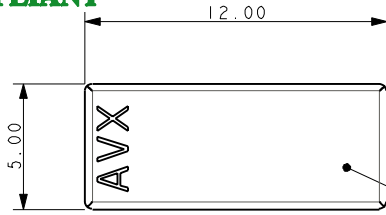

NOTES 3

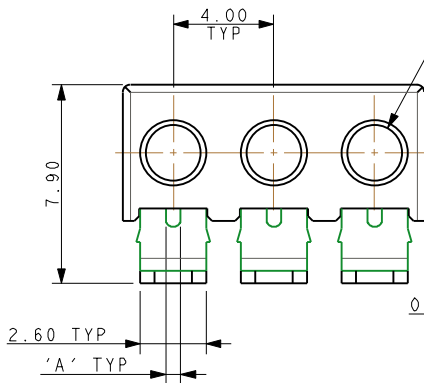
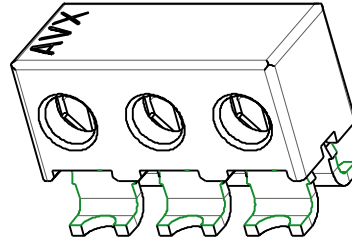

Ø 'B' TYP

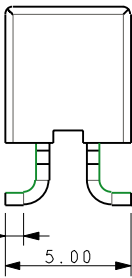

ALL TAILS WITHIN 0.10 COPLANARITY TOLERANCE

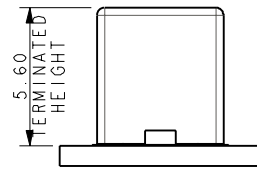

MOUNTED ON PCB

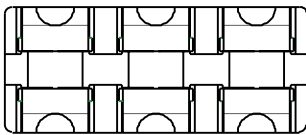

CODE	WIRE GAUGE	'A'	WIRE INSULATION	'B'
701	18AWG STRANDED	0.74	Ø 1.6-2.1	2.1
711	20AWG STRANDED	0.60	Ø 1.6-2.1	2.1
722	22AWG STRANDED	0.47	Ø 1.1-1.6	1.6
732	24AWG STRANDED	0.37	Ø 1.1-1.6	1.6

Elco Europe (A Division of AVX Ltd) CONFIDENTIAL PROPRIETY
The document on this print and information therewith are PROPRIETY
to Elco Europe (A Division of AVX Ltd) and shall not be copied
or disclosed in whole or in part without Elco Europe's written consent.

PACKING NOTES

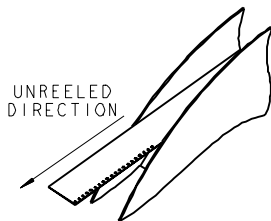

330mm DIAMETER REEL

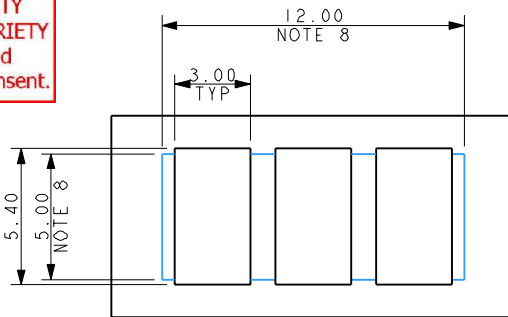

SUGGESTED PCB LAYOUT

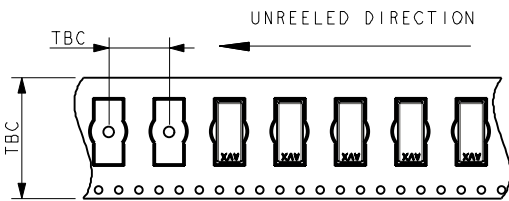

QUANTITY PER REEL 600

NOTES :-

- 3 WAY CONNECTOR FOR IDC WIRE TO BOARD CONNECTION, PRE ASSEMBLED THROUGH WIRE CAP, CODE REFER TO SHEET 1.
- CONTACT/CAP TO MATCH 18-24AWG STRANDED WIRE, INSULATION DIAMETER RANGE AS IN TABLE.
- FLAT FACE ON TOP OF CAP TO AID PICK AND PLACE ASSEMBLY.
- FOR FULL DETAILS REFER TO ELCO SPECIFICATION 201-01-138.
- ASSEMBLY PROCEDURE, REFER TO APPLICATION NOTES 201-01-140.
- GENERAL TOLERANCE ±0.20 UNLESS STATED.
- PACKED IN TAPE AND REEL, QUANTITY PER REEL 600.
- CONNECTOR OUTLINE.
- CONTACT MATERIAL :- TIN PLATED COPPER ALLOY.
- INSULATION MATERIAL, HIGH TEMPERATURE NYLON, GLASS FILLED.
- UL94 V-0, COLOUR REFER TO SHEET 1.
- GENERAL TOLERANCE ±0.20 UNLESS STATED.

ELCO EUROPE (A DIVISION OF AVX LTD.) CONFIDENTIAL PROPRIETY
 THE DRAWING ON THIS PRINT AND INFORMATION THEREWITH ARE PROPRIETY TO ELCO EUROPE (A DIVISION OF AVX LTD.) AND SHALL NOT BE USED OR DISCLOSED IN WHOLE OR IN PART WITHOUT ELCO EUROPE'S WRITTEN CONSENT.

SHEET 4 OF 8

Release No. 102847
 History 04.05.2012
 18.05.2012
 20.08.2012

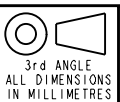

Drawn N.C.H.	Description 18-24AWG IDC WIRE TO BOARD CONNECTOR	DATE 04-Apr-12
Size CV	Part Number 00-9176-01_700S	Issue C

A

B



**18-24 AWG 1 WAY IDC CONNECTOR
WIRE STOP CAPPED-IDC**

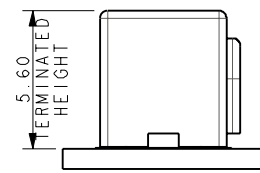
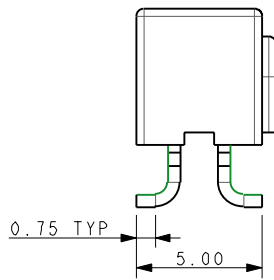
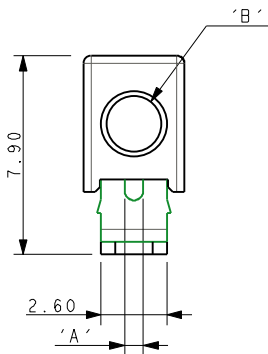
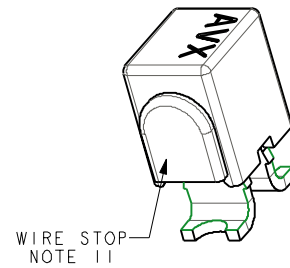
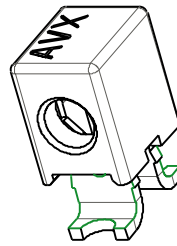
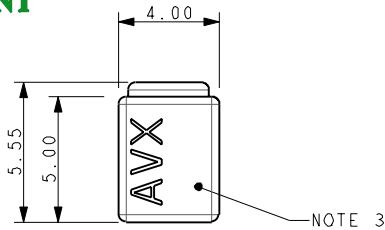

MOUNTED ON PCB

CODE	WIRE GAUGE	'A'	WIRE INSULATION	'B'
701	18AWG STRANDED	0.74	Ø 1.6-2.1	2.1
711	20AWG STRANDED	0.60	Ø 1.6-2.1	2.1
722	22AWG STRANDED	0.47	Ø 1.1-1.6	1.6
732	24AWG STRANDED	0.37	Ø 1.1-1.6	1.6

Elco Europe (A Division of AVX Ltd) CONFIDENTIAL PROPRIETY
The document on this print and information therewith are PROPRIETY
to Elco Europe (A Division of AVX Ltd) and shall not be copied
or disclosed in whole or in part without Elco Europe's written consent.

PACKING NOTES

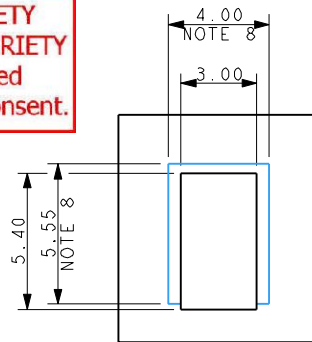
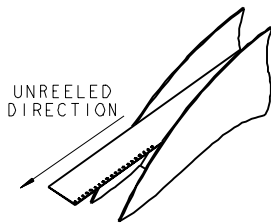

SUGGESTED PCB LAYOUT

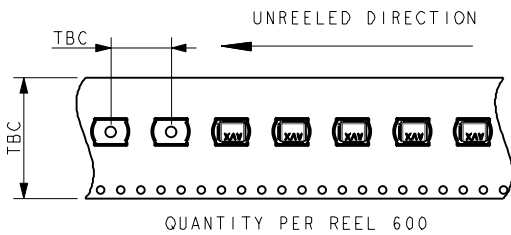

NOTES :-

1. 1 WAY CONNECTOR FOR IDC WIRE TO BOARD CONNECTION, PRE ASSEMBLED WIRE STOP CAP, CODE REFER TO SHEET 1.
2. CONTACT/CAP TO MATCH 18-24AWG STRANDED WIRE, INSULATION DIAMETER RANGE AS IN TABLE.
3. FLAT FACE ON TOP OF CAP TO AID PICK AND PLACE ASSEMBLY.
4. FOR FULL DETAILS REFER TO ELCO SPECIFICATION 201-01-138.
5. ASSEMBLY PROCEDURE, REFER TO APPLICATION NOTES 201-01-140.
6. GENERAL TOLERANCE ±0.20 UNLESS STATED.
7. PACKED IN TAPE AND REEL, QUANTITY PER REEL 600.
8. CONNECTOR OUTLINE.
9. CONTACT MATERIAL :- TIN PLATED COPPER ALLOY.
10. INSULATION MATERIAL, HIGH TEMPERATURE NYLON, GLASS FILLED, UL94 V-0, COLOUR REFER TO SHEET 1.
11. WIRE STOP CAP PROTECTS END OF WIRE.
12. GENERAL TOLERANCE ±0.20 UNLESS STATED.

FORM-106-01-056-6 ISS 7

ELCO EUROPE (A DIVISION OF AVX LTD.) CONFIDENTIAL PROPRIETY
 THE DRAWING ON THIS PRINT AND INFORMATION THERWITH ARE PROPRIETY TO ELCO EUROPE (A DIVISION OF AVX LTD.) AND SHALL NOT BE USED OR DISCLOSED IN WHOLE OR IN PART WITHOUT ELCO EUROPE'S WRITTEN CONSENT.

SHEET 5 OF 8

Release No. 102847	History 04.05.2012 18.05.2012 20.08.2012
-----------------------	---

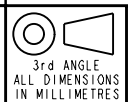

Drawn N.C.H.	Description 18-24AWG IDC WIRE TO BOARD CONNECTOR	DATE 04-Apr-12
Size CV	Part Number 00-9176-01_700S	Issue C

A

B



**18-24 AWG 2 WAY IDC CONNECTOR
WIRE STOP CAPPED IDC**

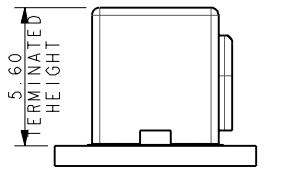
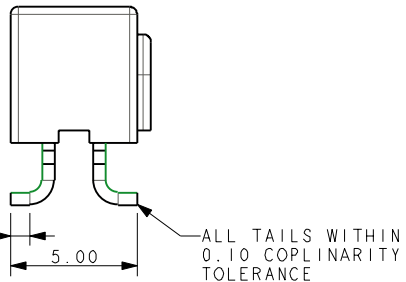
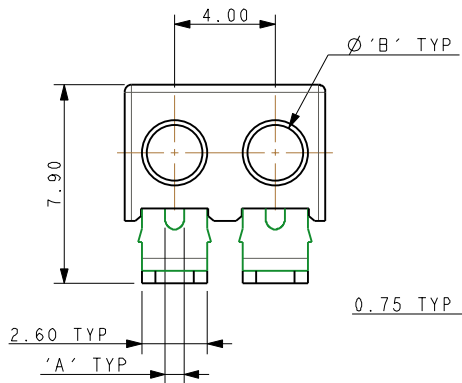
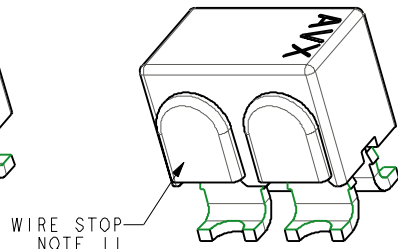
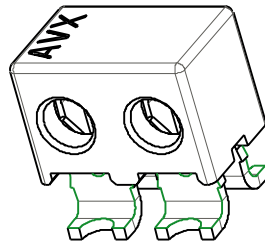
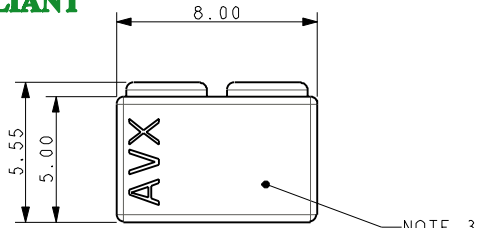

MOUNTED ON PCB

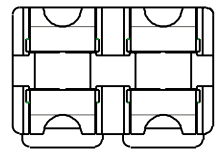

CODE	WIRE GAUGE	'A'	WIRE INSULATION	'B'
701	18AWG STRANDED	0.74	Ø 1.6-2.1	2.1
711	20AWG STRANDED	0.60	Ø 1.6-2.1	2.1
722	22AWG STRANDED	0.47	Ø 1.1-1.6	1.6
732	24AWG STRANDED	0.37	Ø 1.1-1.6	1.6

Elco Europe (A Division of AVX Ltd) CONFIDENTIAL PROPRIETY
The document on this print and information therewith are PROPRIETY to Elco Europe (A Division of AVX Ltd) and shall not be copied or disclosed in whole or in part without Elco Europe's written consent.

PACKING NOTES

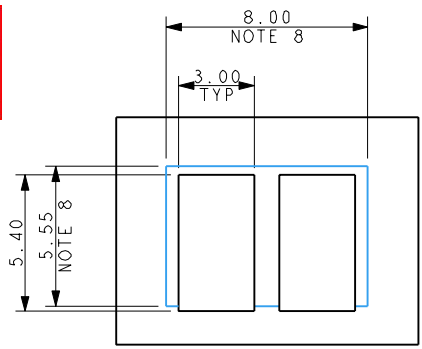
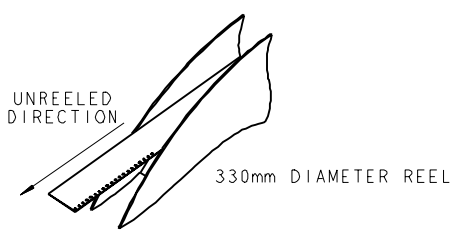

SUGGESTED PCB LAYOUT

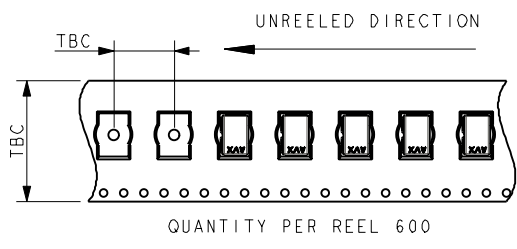

- NOTES :-
- 2 WAY CONNECTOR FOR IDC WIRE TO BOARD CONNECTION, PRE ASSEMBLED WIRE STOP CAP, CODE REFER TO SHEET 1.
 - CONTACT/CAP TO MATCH 18-24AWG STRANDED WIRE, INSULATION DIAMETER RANGE AS IN TABLE.
 - FLAT FACE ON TOP OF CAP TO AID PICK AND PLACE ASSEMBLY.
 - FOR FULL DETAILS REFER TO ELCO SPECIFICATION 201-01-138.
 - ASSEMBLY PROCEDURE, REFER TO APPLICATION NOTES 201-01-140.
 - GENERAL TOLERANCE ±0.20 UNLESS STATED.
 - PACKED IN TAPE AND REEL, QUANTITY PER REEL 600.
 - CONNECTOR OUTLINE.
 - CONTACT MATERIAL :- TIN PLATED COPPER ALLOY.
 - INSULATION MATERIAL, HIGH TEMPERATURE NYLON, GLASS FILLED. UL94 V-0, COLOUR REFER TO SHEET 1.
 - WIRE STOP CAP PROTECTS END OF WIRE.
 - GENERAL TOLERANCE ±0.20 UNLESS STATED.

ELCO EUROPE (A DIVISION OF AVX LTD.) CONFIDENTIAL PROPRIETY
THE DRAWING ON THIS PRINT AND INFORMATION THEREWITH ARE PROPRIETY TO ELCO EUROPE (A DIVISION OF AVX LTD.) AND SHALL NOT BE USED OR DISCLOSED IN WHOLE OR IN PART WITHOUT ELCO EUROPE'S WRITTEN CONSENT.

SHEET 6 OF 8

FORM-106-01-056-6 ISS 7
Release No. 102847
History 04.05.2012
18.05.2012
20.08.2012

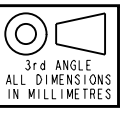

Drawn N.C.H.	Description 18-24AWG IDC WIRE TO BOARD CONNECTOR	DATE 04-Apr-12
Size CV	Part Number 00-9176-01_700S	Issue C

A

B



**18-24 AWG 3 WAY IDC CONNECTOR
WIRE STOP CAPPED IDC**

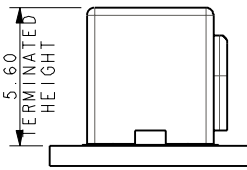
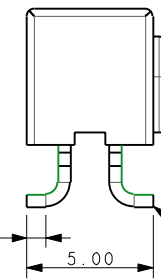
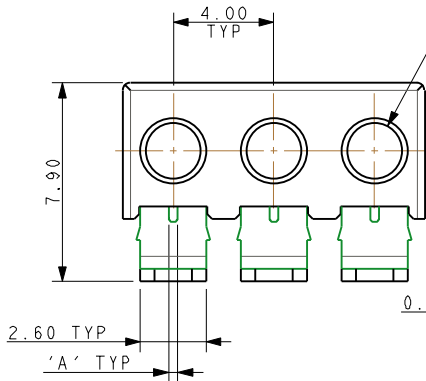
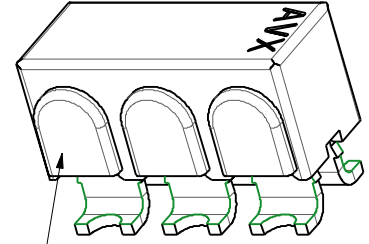
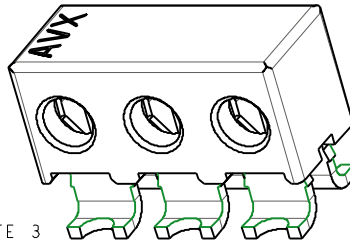
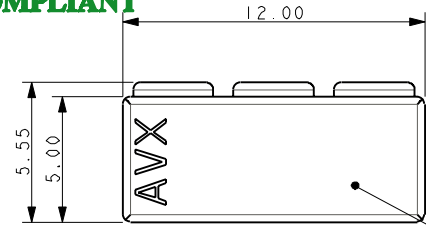

ALL TAILS WITHIN 0.10 COPLANARITY TOLERANCE

MOUNTED ON PCB

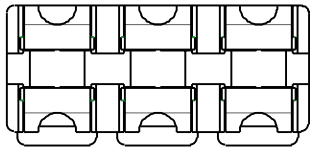

CODE	WIRE GAUGE	'A'	WIRE INSULATION	'B'
701	18AWG STRANDED	0.74	Ø 1.6-2.1	2.1
711	20AWG STRANDED	0.60	Ø 1.6-2.1	2.1
722	22AWG STRANDED	0.47	Ø 1.1-1.6	1.6
732	24AWG STRANDED	0.37	Ø 1.1-1.6	1.6

Elco Europe (A Division of AVX Ltd) CONFIDENTIAL PROPRIETY
The document on this print and information therewith are PROPRIETY to Elco Europe (A Division of AVX Ltd) and shall not be copied or disclosed in whole or in part without Elco Europe's written consent.

PACKING NOTES

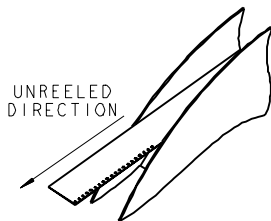

330mm DIAMETER REEL

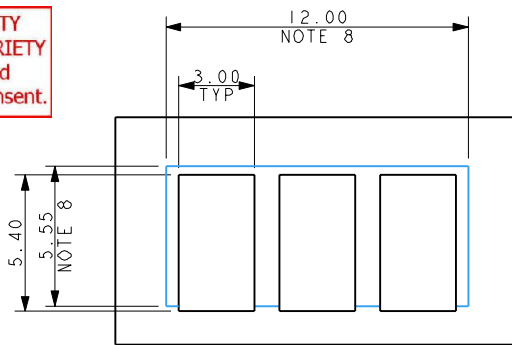

SUGGESTED PCB LAYOUT

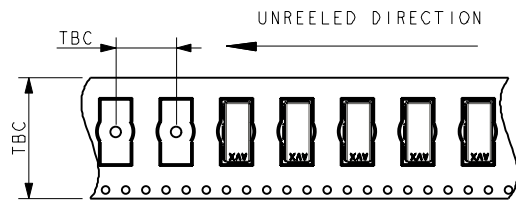

QUANTITY PER REEL 600

NOTES :-

- 3 WAY CONNECTOR FOR IDC WIRE TO BOARD CONNECTION, PRE ASSEMBLED WIRE STOP CAP, CODE REFER TO SHEET 1.
- CONTACT/CAP TO MATCH 18-24AWG STRANDED WIRE, INSULATION DIAMETER RANGE AS IN TABLE.
- FLAT FACE ON TOP OF CAP TO AID PICK AND PLACE ASSEMBLY.
- FOR FULL DETAILS REFER TO ELCO SPECIFICATION 201-01-138.
- ASSEMBLY PROCEDURE, REFER TO APPLICATION NOTES 201-01-140.
- GENERAL TOLERANCE ±0.20 UNLESS STATED.
- PACKED IN TAPE AND REEL, QUANTITY PER REEL 600.
- CONNECTOR OUTLINE.
- CONTACT MATERIAL :- TIN PLATED COPPER ALLOY.
- INSULATION MATERIAL, HIGH TEMPERATURE NYLON, GLASS FILLED. UL94 V-0, COLOUR REFER TO SHEET 1.
- WIRE STOP CAP PROTECTS END OF WIRE.
- GENERAL TOLERANCE ±0.20 UNLESS STATED.

SHEET 7 OF 8

FORM-106-01-056-6 ISS 7

ELCO EUROPE (A DIVISION OF AVX LTD.) CONFIDENTIAL PROPRIETY
THE DRAWING ON THIS PRINT AND INFORMATION THEREWITH ARE PROPRIETY TO ELCO EUROPE (A DIVISION OF AVX LTD.) AND SHALL NOT BE USED OR DISCLOSED IN WHOLE OR IN PART WITHOUT ELCO EUROPE'S WRITTEN CONSENT.

Release No.
History
102847
04.05.2012
18.05.2012
20.08.2012

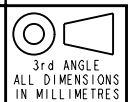

Drawn N.C.H.	Description 18-24AWG IDC WIRE TO BOARD CONNECTOR	DATE 04-Apr-12
Size CV	Part Number 00-9176-01_700S	Issue C

A

B

A

B



18-24 AWG ASSEMBLED CAPPED IDC CONNECTORS

Elco Europe (A Division of AVX Ltd) CONFIDENTIAL PROPRIETY
 The document on this print and information therewith are PROPRIETY
 to Elco Europe (A Division of AVX Ltd) and shall not be copied
 or disclosed in whole or in part without Elco Europe's written consent.

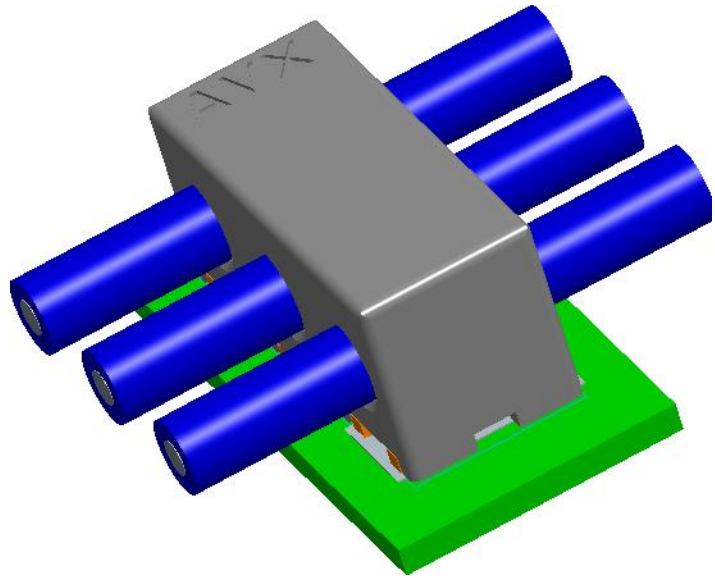
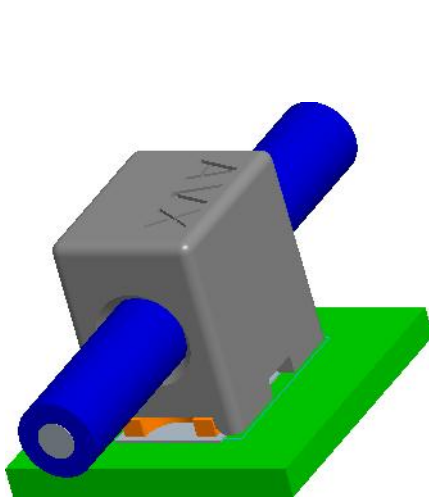

TYPICAL THROUGH WIRE ASSEMBLIES

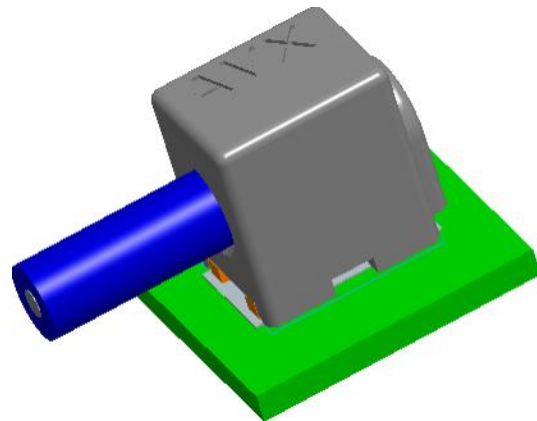
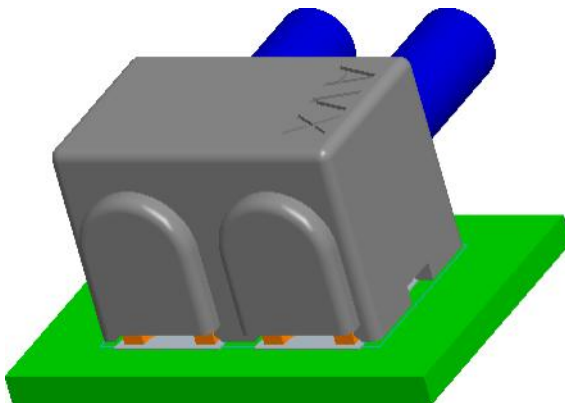

TYPICAL WIRE STOP ASSEMBLIES

FORM-106-01-036-6 ISS 7

ELCO EUROPE (A DIVISION OF AVX LTD.) CONFIDENTIAL PROPRIETY
 THE DRAWING ON THIS PRINT AND INFORMATION THEREWITH ARE
 PROPRIETARY TO ELCO EUROPE (A DIVISION OF AVX LTD.) AND
 SHALL NOT BE USED OR DISCLOSED IN WHOLE OR IN PART
 WITHOUT ELCO EUROPE'S WRITTEN CONSENT.

SHEET 8 OF 8

Release No. 102847	History 04.05.2012 18.05.2012 20.08.2012
-----------------------	---

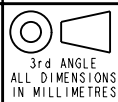

ELCO
 © COPYRIGHT ELCO EUROPE
 NOT TO BE DISCLOSED OR COPIED
 WITHOUT WRITTEN PERMISSION

Drawn N.C.H.	Description 18-24AWG IDC WIRE TO BOARD CONNECTOR
Size CV	Part Number 00-9176-01_700S

DATE 04-Apr-12
Issue C

A

B

Компания «Океан Электроники» предлагает заключение долгосрочных отношений при поставках импортных электронных компонентов на взаимовыгодных условиях!

Наши преимущества:

- Поставка оригинальных импортных электронных компонентов напрямую с производств Америки, Европы и Азии, а так же с крупнейших складов мира;
- Широкая линейка поставок активных и пассивных импортных электронных компонентов (более 30 млн. наименований);
- Поставка сложных, дефицитных, либо снятых с производства позиций;
- Оперативные сроки поставки под заказ (от 5 рабочих дней);
- Экспресс доставка в любую точку России;
- Помощь Конструкторского Отдела и консультации квалифицированных инженеров;
- Техническая поддержка проекта, помощь в подборе аналогов, поставка прототипов;
- Поставка электронных компонентов под контролем ВП;
- Система менеджмента качества сертифицирована по Международному стандарту ISO 9001;
- При необходимости вся продукция военного и аэрокосмического назначения проходит испытания и сертификацию в лаборатории (по согласованию с заказчиком);
- Поставка специализированных компонентов военного и аэрокосмического уровня качества (Xilinx, Altera, Analog Devices, Intersil, Interpoint, Microsemi, Actel, Aeroflex, Peregrine, VPT, Syfer, Eurofarad, Texas Instruments, MS Kennedy, Miteq, Cobham, E2V, MA-COM, Hittite, Mini-Circuits, General Dynamics и др.);

Компания «Океан Электроники» является официальным дистрибьютором и эксклюзивным представителем в России одного из крупнейших производителей разъемов военного и аэрокосмического назначения «JONHON», а так же официальным дистрибьютором и эксклюзивным представителем в России производителя высокотехнологичных и надежных решений для передачи СВЧ сигналов «FORSTAR».



JONHON

«JONHON» (основан в 1970 г.)

Разъемы специального, военного и аэрокосмического назначения:

(Применяются в военной, авиационной, аэрокосмической, морской, железнодорожной, горно- и нефтедобывающей отраслях промышленности)

«FORSTAR» (основан в 1998 г.)

ВЧ соединители, коаксиальные кабели, кабельные сборки и микроволновые компоненты:

(Применяются в телекоммуникациях гражданского и специального назначения, в средствах связи, РЛС, а так же военной, авиационной и аэрокосмической отраслях промышленности).



Телефон: 8 (812) 309-75-97 (многоканальный)

Факс: 8 (812) 320-03-32

Электронная почта: ocean@oceanchips.ru

Web: <http://oceanchips.ru/>

Адрес: 198099, г. Санкт-Петербург, ул. Калинина, д. 2, корп. 4, лит. А