

LOC	DIST	REVISIONS					
		P	LTN	DESCRIPTION	DATE	DWN	APVD
ES	00	F		REVISED 2-2 BY CUSTOMER	09MAR2015	CZ	SZ

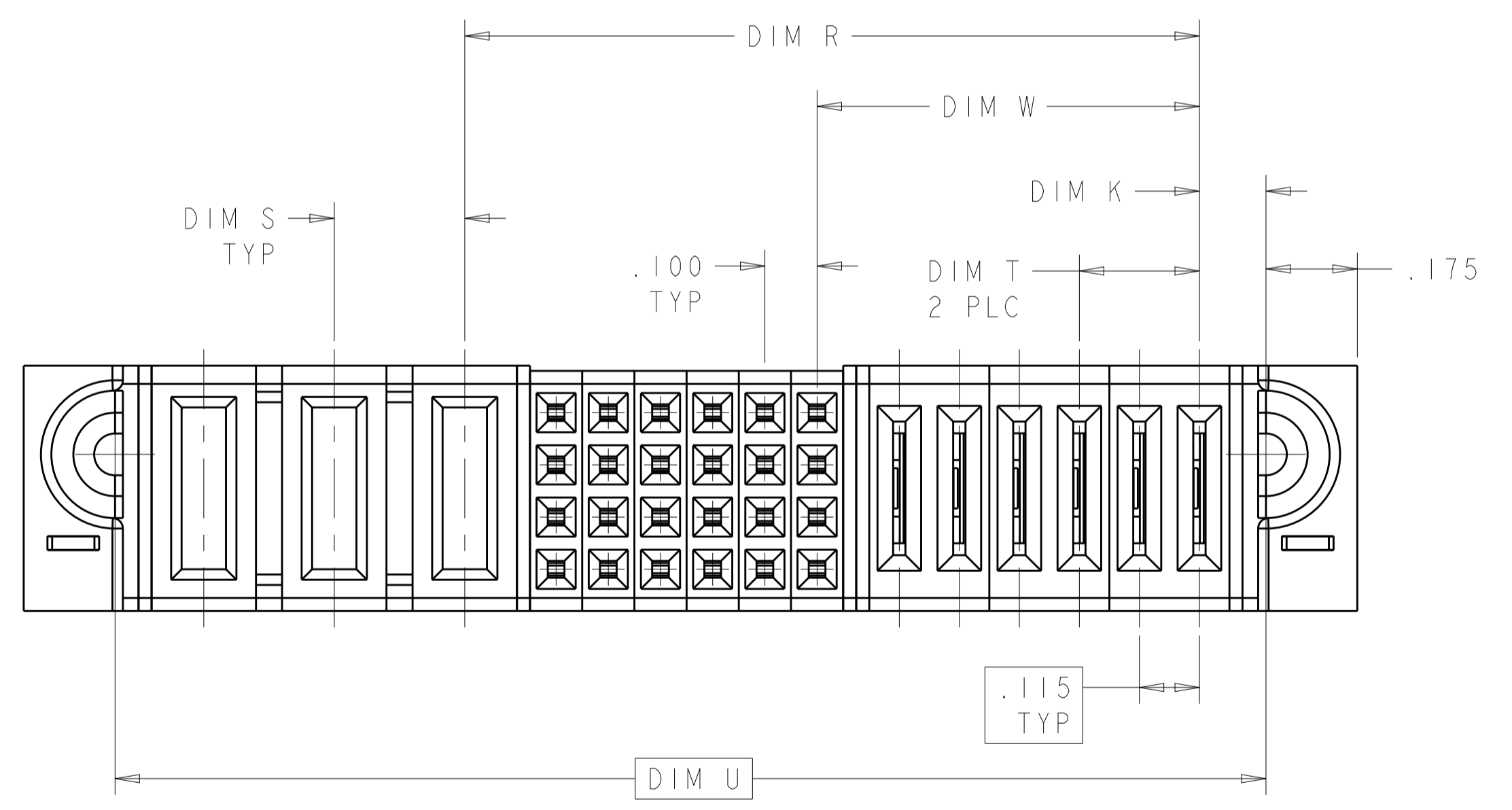

- ① "AMP", TRADEMARK, PART NUMBER AND DATE CODE TO BE MARKED IN AREA SHOWN
- ② MATERIAL: HOUSING - GLASS FILLED HIGH TEMP THERMO PLASTIC, UL94 V-0, BLACK
SIGNAL CONTACT - HIGH CONDUCTIVITY COPPER ALLOY
POWER CONTACT - HIGH CONDUCTIVITY COPPER ALLOY
- ③ CONTACT PLATING: NOBLE METAL PLATING ON CONTACT FUNCTIONAL AREA OF POWER AND SIGNAL CONTACTS
- ④ MECHANICAL CONNECTOR KEEP OUT ZONE
- ⑤ DATUM AND BASIC DIMENSIONS ESTABLISHED BY CUSTOMER
- ⑥ PCB - ALL HOLE DIAMETERS ARE FINISHED HOLE SIZES
- ⑦ PCB - .0453 ± .0010 DRILLED HOLES PLATED WITH .0003 MIN Sn OVER .001 TO .003 CU PLATING TO ACHIEVE A .040 ± .003 DIA HOLE
- ⑧ DIM W & DIM R ARE APPLICABLE TO P+S+P CONFIGURATION.
- ⑨ FOR P/N 6450850-3, -11, THE VARIABLE DIMENSIONS PLEASE SEE SHEET 2.
- ⑩ VARIABLE DIMENSIONS SHOW ON TABLE OR PART VIEW

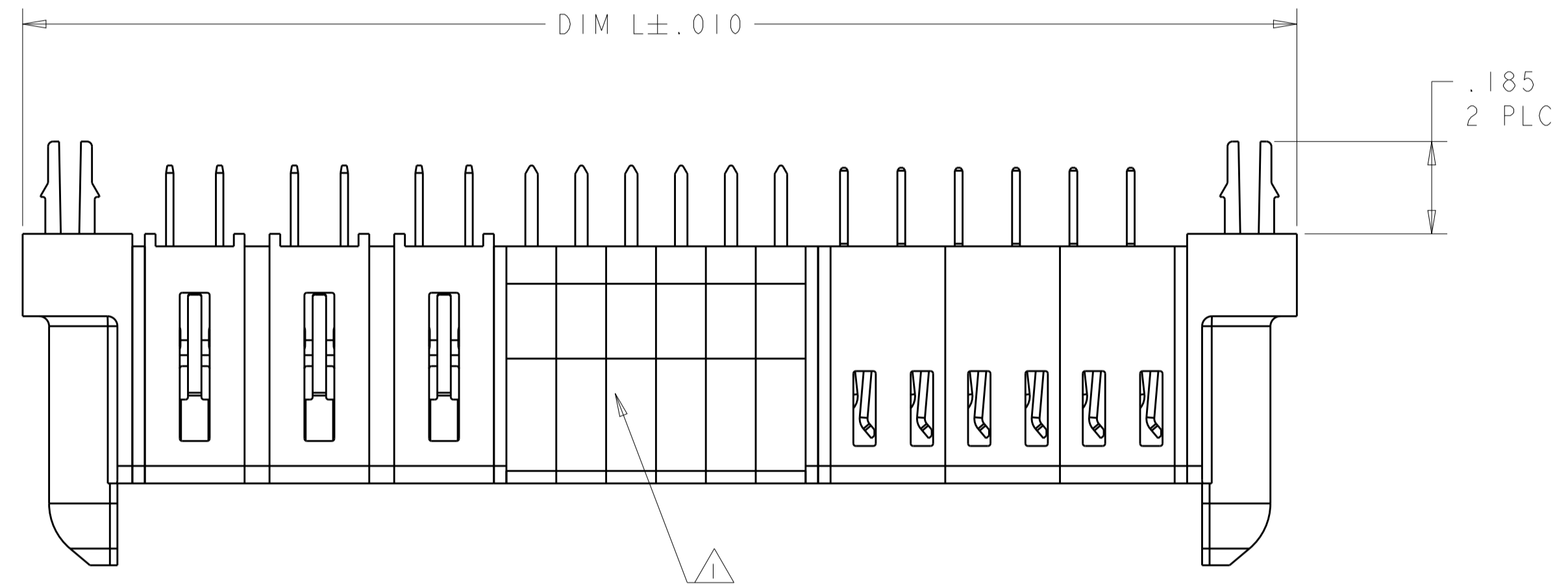
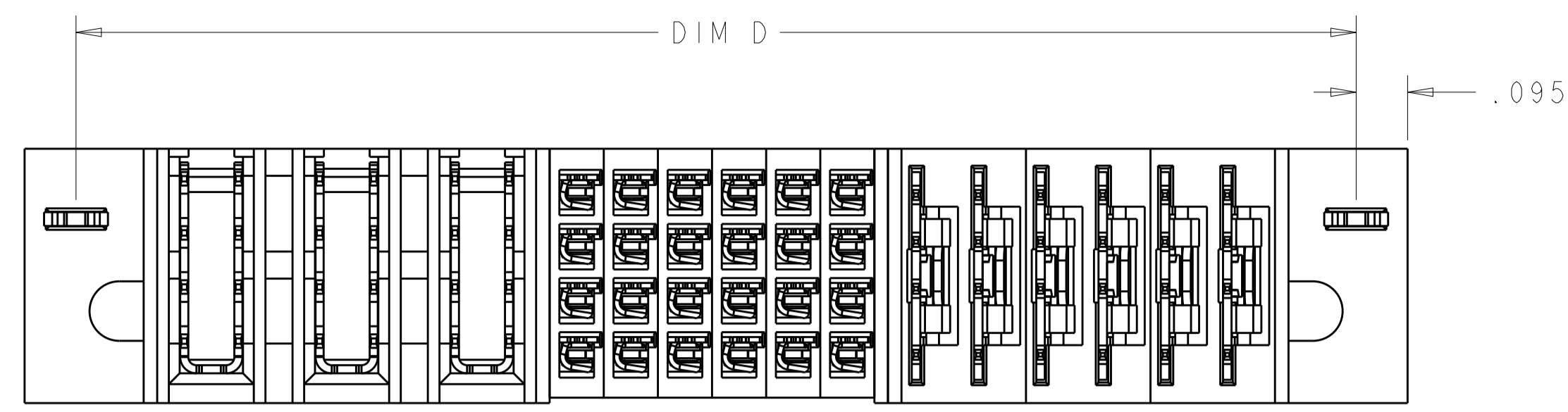
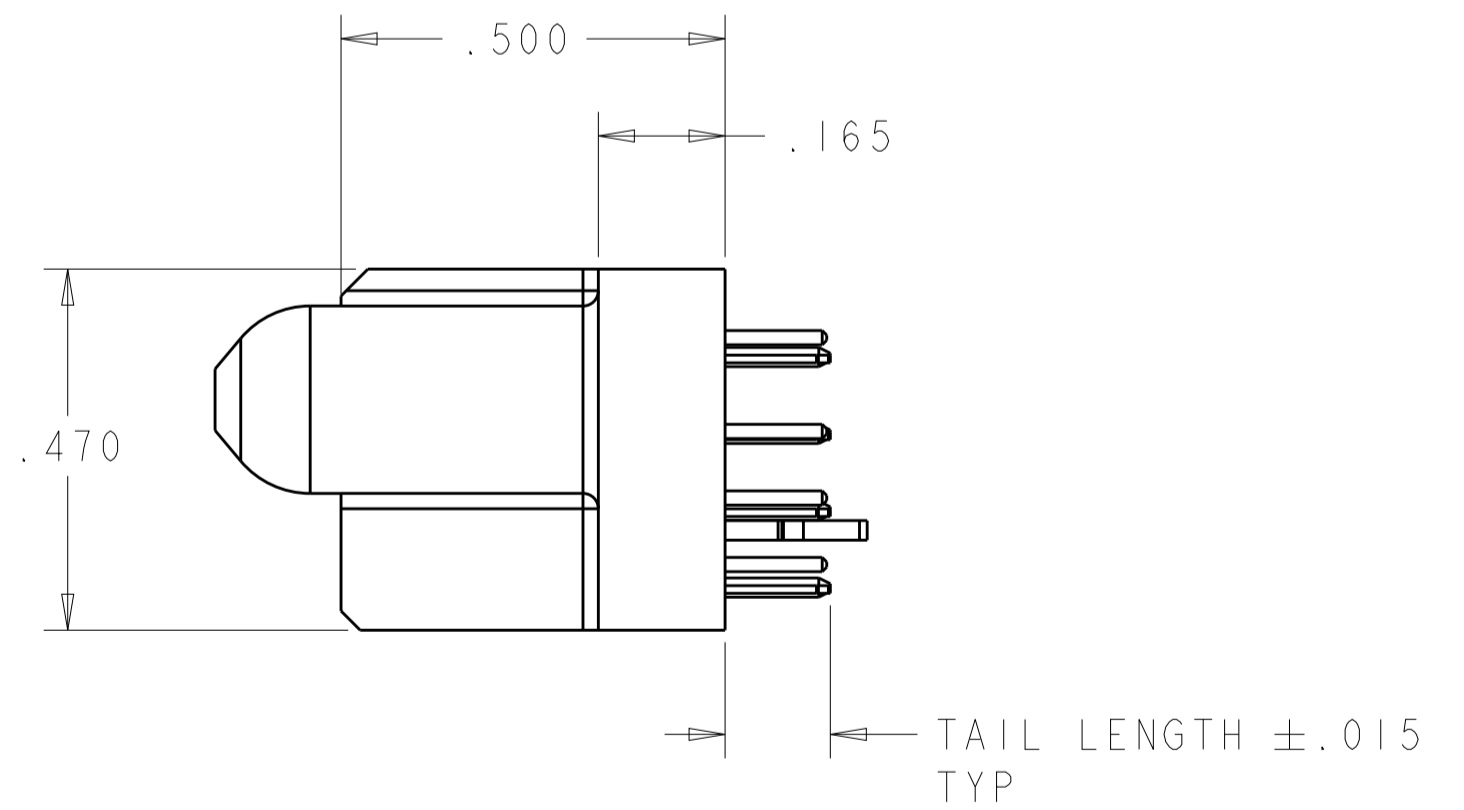

THIS DRAWING IS A CONTROLLED DOCUMENT.		DWN S. ZHAO CHK S. ZHAO	20SEP2007 20SEP2007	TE Connectivity
DIMENSIONS: INCHES		TOLERANCES UNLESS OTHERWISE SPECIFIED: 0 PLC ±. 1 PLC ±.01 2 PLC ±.01 3 PLC ±.005 4 PLC ±.0020 ANGLES ±.7°		
		PRODUCT SPEC 108-1973 APPLICATION SPEC 114-13038		SIZE CAGE CODE DRAWING NO A100779C=6450850
MATERIAL		FINISH		RESTRICTED TO CUSTOMER DRAWING
		SCALE 4:1		SHEET 1 OF 8 REV F

LOC		DIST		REVISIONS				
ES	00	P	LTN	DESCRIPTION	DATE	DMN	APVD	
-	-	-	-	SEE SHEET 1	-	-	-	

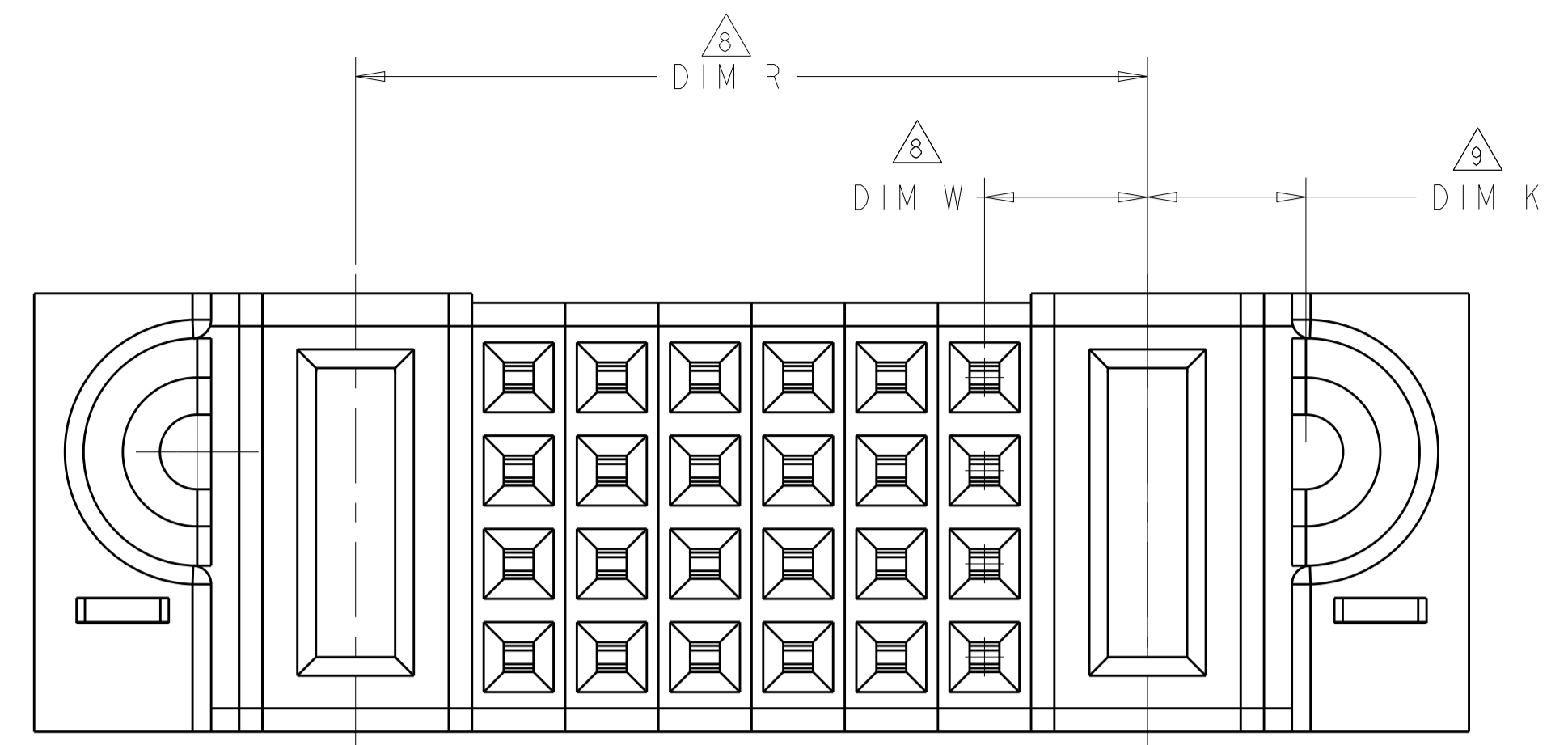

FOR P/N 6450850-3, -11, THE OTHER DIMENSIONS PLEASE SEE THE TABLE OF SHEET 1.

Δ	Δ	2.1275	1.1025	4.590	4.240	4.400	.1025	9LP + 36S + IP + 16LP	2-6450850-2
.300	.250	1.275	.800	2.490	2.140	2.300	.195	3ACP + 16S + 3P	2-6450850-1
.230	.230	1.090	.7825	1.990	1.640	1.800	.1025	3LP + 12S + 4LP	2-6450850-0
.250	.250	1.150	.675	2.340	1.990	2.150	.170	3P + 16S + 3P	1-6450850-9
Δ	Δ	Δ	Δ	3.270	2.920	3.080	.170	5HDP + 24S + IP + 7LP	1-6450850-8
-	-	.500	.200	1.140	.790	.950	.145	IP + 8S + IP	1-6450850-7
.300	.250	1.250	.775	2.940	2.590	2.750	.170	3ACP + 16S + 5P	1-6450850-6
.200	.200	.800	.350	1.840	1.490	1.650	.145	2P + 16S + 3P	1-6450850-4
.250	.250	1.300	.925	2.740	2.390	2.550	.170	4P + 12S + 4P	1-6450850-3
-	-	.850	.175	1.540	1.190	1.350	.170 Δ	IP + 24S + IP	1-6450850-1
-	-	.850	.175	1.540	1.190	1.350	.170 Δ	IP + 24S + IP	6450850-3
.230	.250	1.4075	.7325	2.555	2.205	2.365	.1275	6LP + 24S + 3P	6450850-2
DIM T	DIM S	DIM R Δ	DIM W Δ	DIM L	DIM U	DIM D	DIM K	DESCRIPTION	PART NUMBER

THIS DRAWING IS A CONTROLLED DOCUMENT. DMN S.ZHAO 20SEP2007
 CHK S.ZHAO 20SEP2007

DIMENSIONS: INCHES. TOLERANCES UNLESS OTHERWISE SPECIFIED:
 0 PLC \pm .01
 1 PLC \pm .01
 2 PLC \pm .01
 3 PLC \pm .005
 4 PLC \pm .0020
 ANGLES \pm .020

MATERIAL: FINISH:

APVD S.YAO

PRODUCT SPEC: 108-1973
 APPLICATION SPEC: 114-13038

WEIGHT: CUSTOMER DRAWING

SCALE: 4:1 SHEET 2 OF 8 REV F

RESTRICTED TO: A100779C=6450850

TE Connectivity

VERTICAL RECEPTACLE ASSEMBLY, WITH GUIDES MULTI-BEAM XLE

LOC	DIST	REV	DATE	BY	APPV
ES	00				

REVISIONS			
REV	DATE	BY	DESCRIPTION
-	-	-	SEE SHEET 1

PART NUMBER	ROWS	POWER			SIGNAL					POWER						
		P3	P2	P1	6	5	4	3	2	1	LP6	LP5	LP4	LP3	LP2	LP1
6450850-2	D C B A	VM	VM	VM	E	E	E	E	E	E	E	LM	LM	LM	LM	LM
6LP + 24S + 3P																

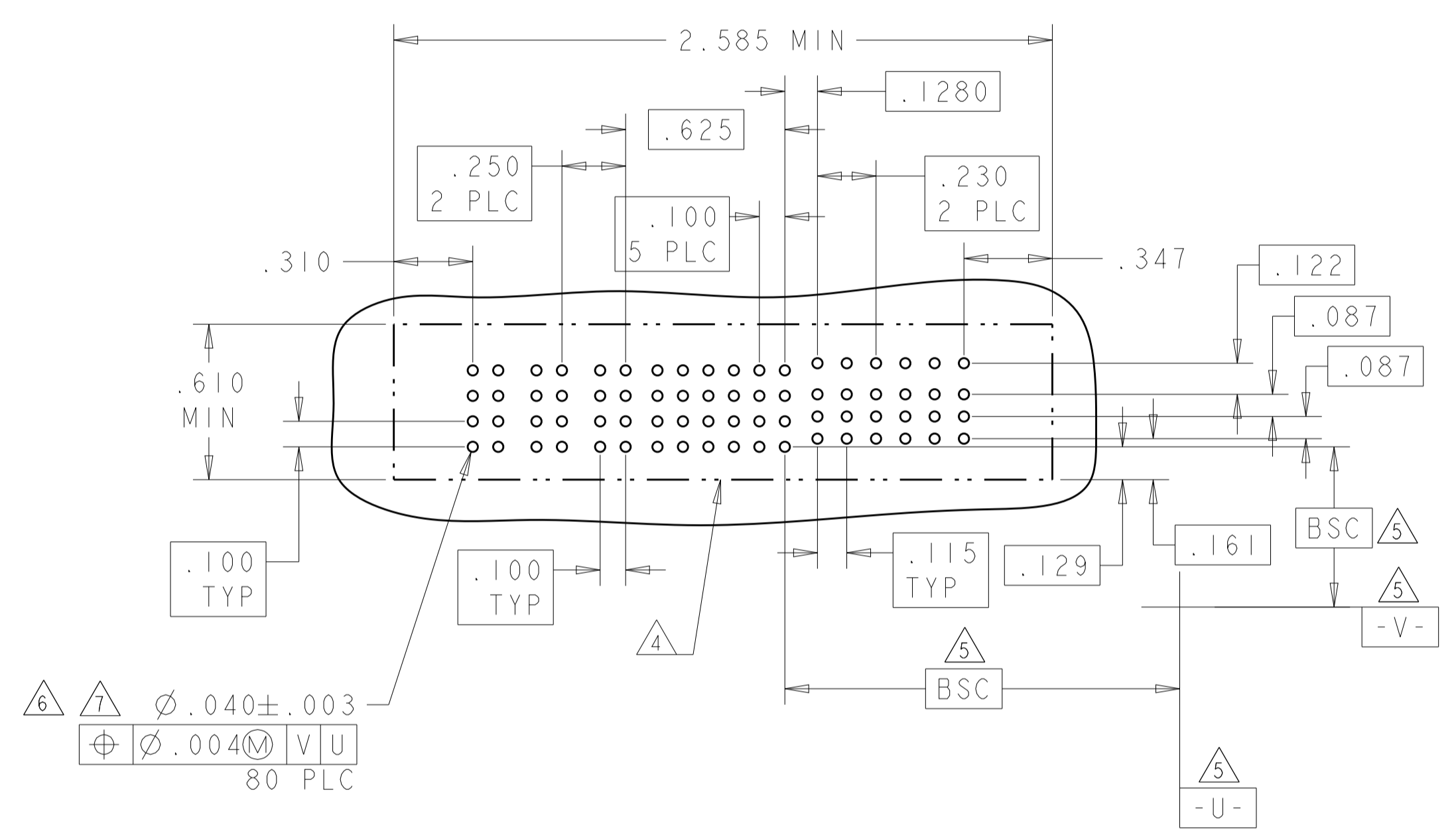

PART NUMBER	ROWS	POWER		SIGNAL					POWER			
		P2	P1	6	5	4	3	2	1	P1	P2	
6450850-3	D C B A	VM	VM	E	E	E	E	E	E	E	VM	VM
IP + 24S + IP												

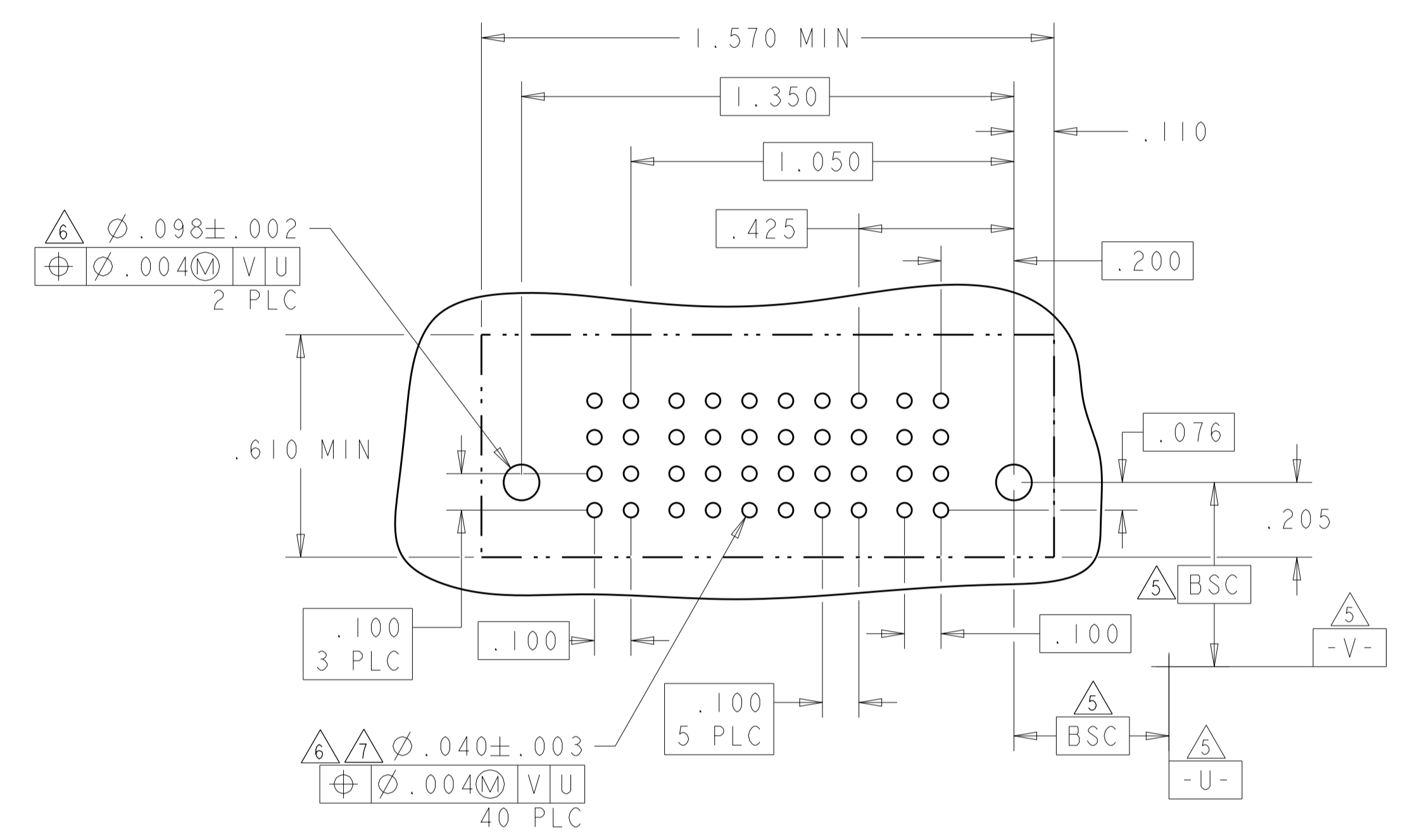

PART NUMBER	ROWS	POWER		SIGNAL					POWER			
		P2	P1	6	5	4	3	2	1	P1	P2	
1-6450850-1	D C B A	VM	VA	E	E	E	E	E	E	E	VA	VA
IP + 24S + IP												

LAYOUT OF 1-6450850-1 IS SAME AS 6450850-3.

LM	LOW POWER CONTACT .135" TAIL LENGTH
M	SIGNAL CONTACT .165" TAIL LENGTH
E	SIGNAL CONTACT .135" TAIL LENGTH
VO	POWER CONTACT, STD.165" TAIL LENGTH
VA	POWER CONTACT, MFBL.135" TAIL LENGTH
VM	POWER CONTACT, STD.135" TAIL LENGTH
CODE	DESCRIPTION
CONTACTS	

THIS DRAWING IS A CONTROLLED DOCUMENT.		DWN	S. ZHAO	20SEP2007
DIMENSIONS: INCHES		CHK	S. ZHAO	20SEP2007
TOLERANCES UNLESS OTHERWISE SPECIFIED:		APVD	S. YAO	
0 PLC	±	PRODUCT SPEC		
2 PLC	±.01	108-1973		
3 PLC	±.005	APPLICATION SPEC		
4 PLC	±.0020	114-13038		
ANGLES	±.2°	WEIGHT		
MATERIAL		CUSTOMER DRAWING		
FINISH		SCALE 4:1 SHEET 3 OF 8 REV F		

TE Connectivity

NAME: VERTICAL RECEPTACLE ASSEMBLY, WITH GUIDES MULTI-BEAM XLE

SIZE: A100779 C=6450850

LOC	DIST	REV	DATE	BY	APPD
ES	00				

REVISIONS			
REV	DATE	BY	APPD
-	-	-	-
SEE SHEET 1			

PART NUMBER	ROWS	POWER				SIGNAL			POWER			
		P8	P7	P6	P5	3	2	1	P4	P3	P2	P1
I-6450850-3	D					E	E	E				
	C					E	E	E				
	B	VM	VM	VM	VM	E	E	E	VM	VM	VM	VM
	A	HD				E	E	E				HD
4P + 12S + 4P												

PART NUMBER	ROWS	POWER			SIGNAL				POWER	
		P5	P4	P3	4	3	2	1	P2	P1
I-6450850-4	D				E	E	E	E		
	C				E	E	E	E		
	B	VM	VM	VM	E	E	E	E	VM	VM
	A	HD			E	E	E	E		HD
2HDP + 16S + 3HDP										

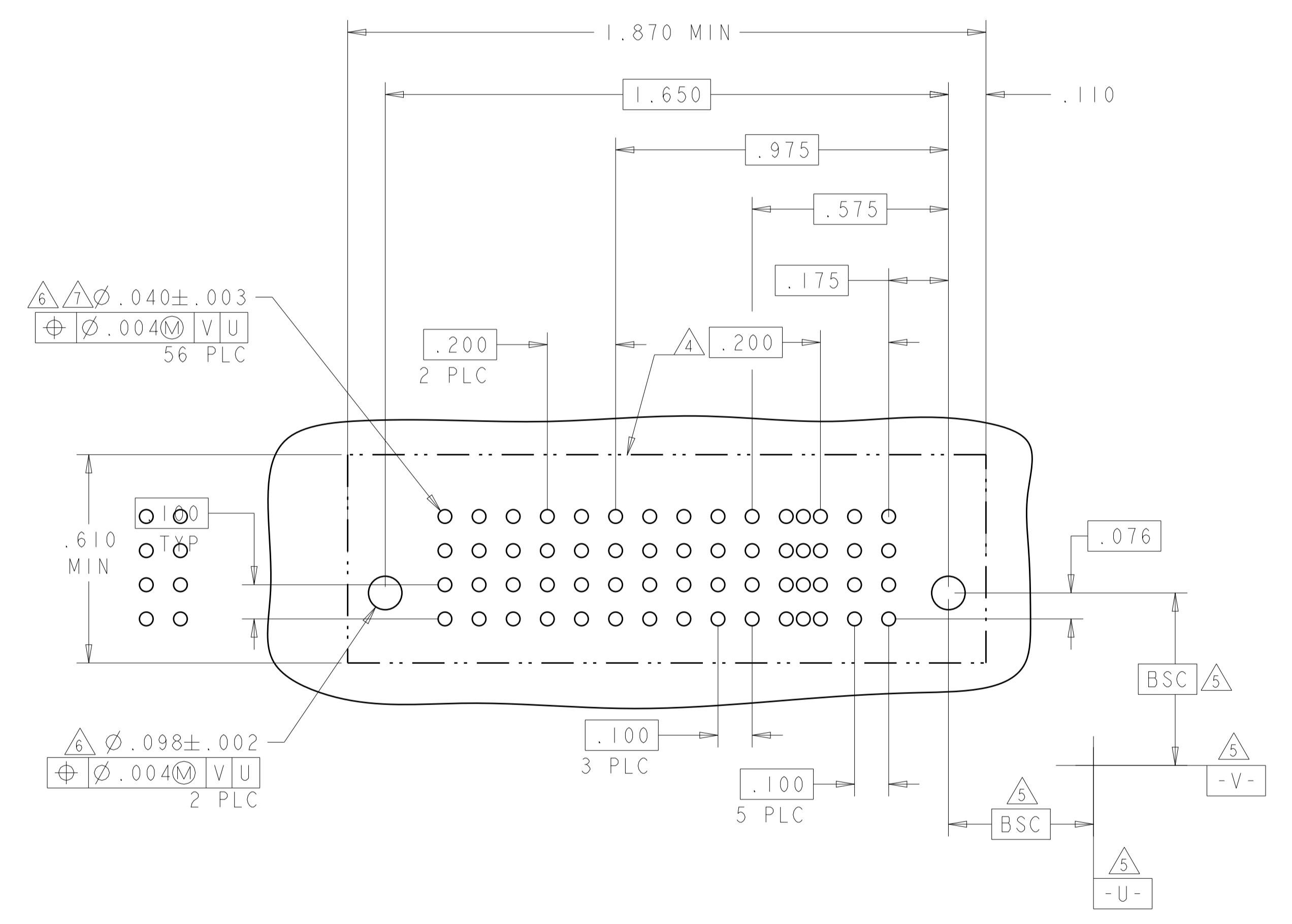
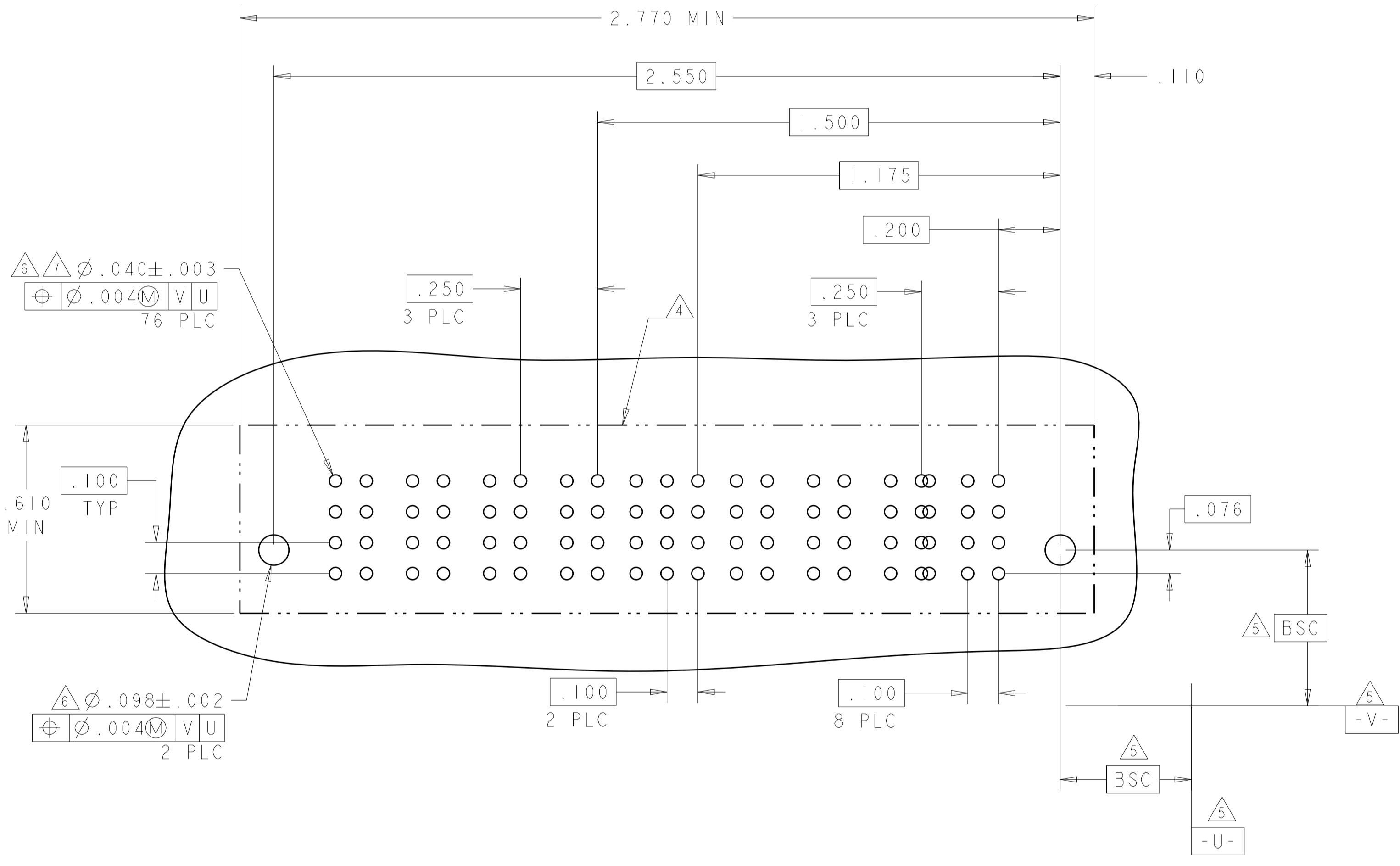

THIS DRAWING IS A CONTROLLED DOCUMENT.		OWN: S. ZHAO 20SEP2007	 TE Connectivity
DIMENSIONS: INCHES		CHK: S. ZHAO 20SEP2007	
TOLERANCES UNLESS OTHERWISE SPECIFIED:		APVD: S. YAO	NAME: VERTICAL RECEPTACLE ASSEMBLY, WITH GUIDES MULTI-BEAM XLE
0 PLC ± .01		PRODUCT SPEC: 108-1973	SIZE: CAGE CODE DRAWING NO: A100779 C=6450850
1 PLC ± .01		APPLICATION SPEC: 114-13038	RESTRICTED TO: -
2 PLC ± .005		WEIGHT: -	SCALE: 4:1 SHEET 4 OF 8 REV F
3 PLC ± .0020		CUSTOMER DRAWING	
ANGLES: ± 0.25°			
FINISH: -			

LOC		DIST		REVISIONS			
ES	00	P	LTN	DESCRIPTION	DATE	DMN	APVD
-	-	-	-	SEE SHEET 1	-	-	-

PART NUMBER	ROWS	POWER				SIGNAL				POWER			
		P8	P7	P6	P5	P4	4	3	2	1	P3	P2	P1
1-6450850-6	D						E	E	E	E			
	C	VA	VM	VM	VM	VA	E	E	E	E	VM	VM	VA
	B						E	E	E	E			
	A	HD					E	E	E	E			HD

3ACP + 16S + 5P

PART NUMBER	ROWS	POWER		SIGNAL		POWER	
		P2	2	1	P1		
1-6450850-7	D						
	C	VM		E	E		
	B			E	E		
	A	HD		E	E		HD

IP + 8S + IP

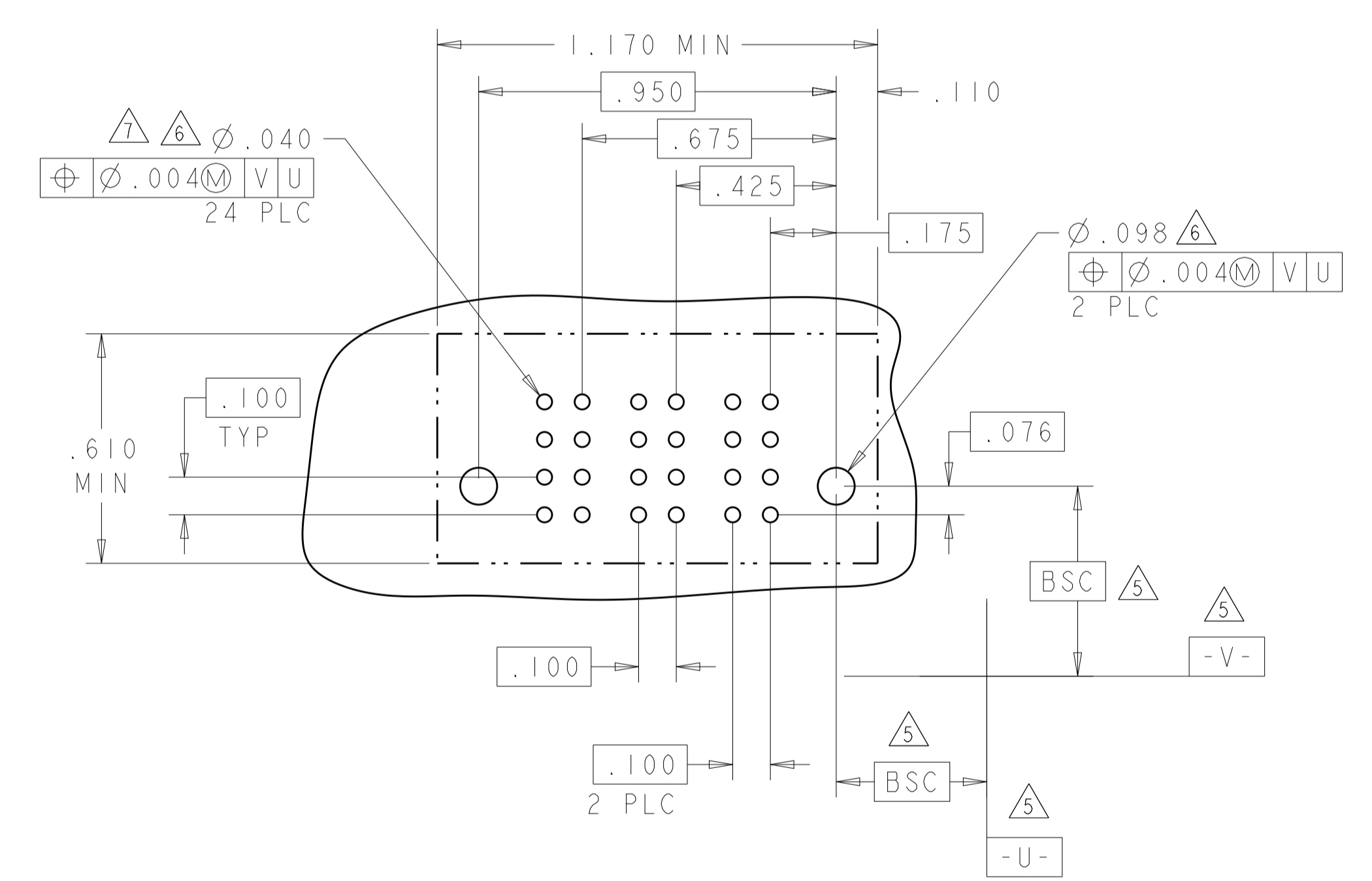
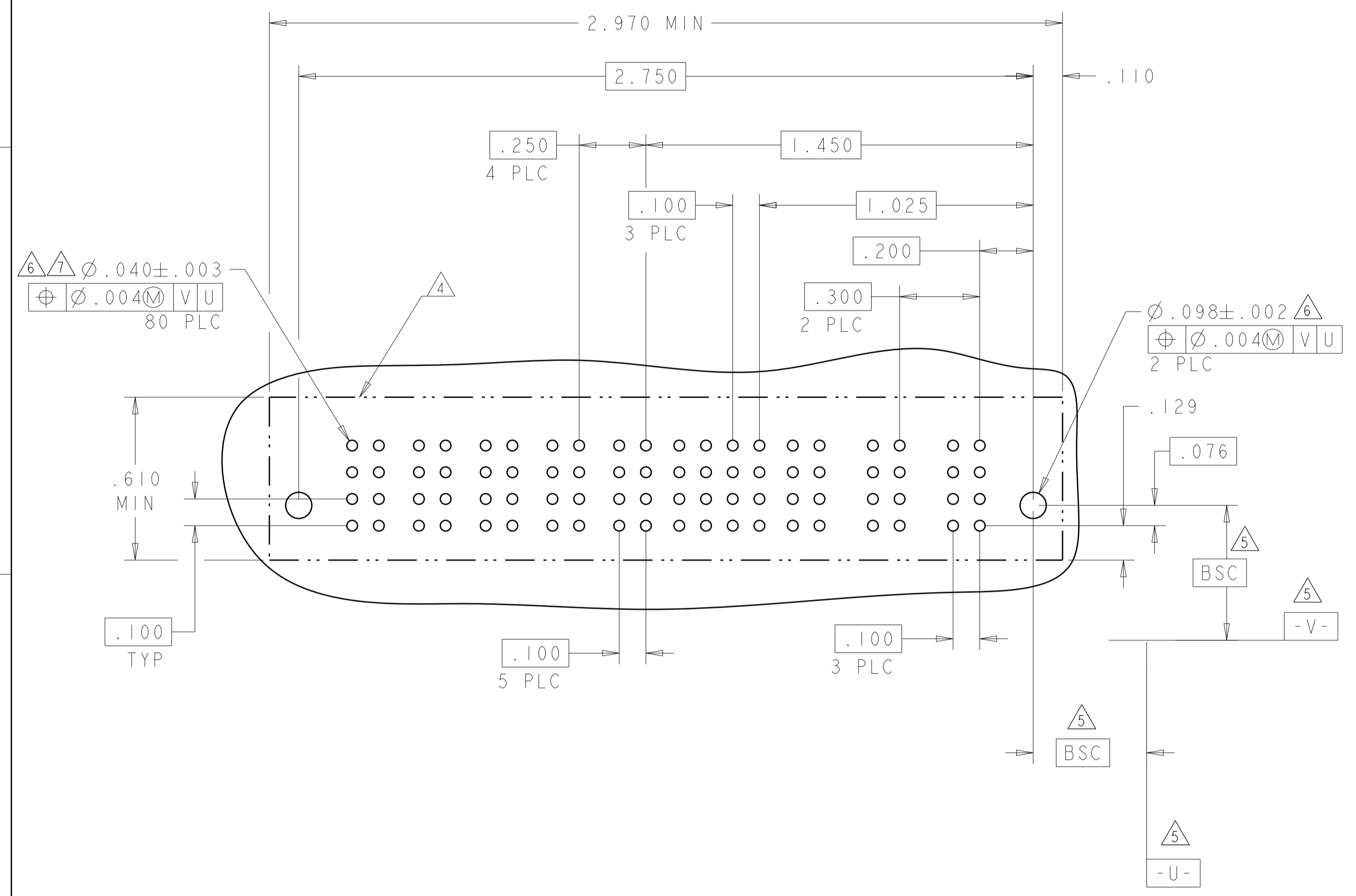

THIS DRAWING IS A CONTROLLED DOCUMENT.		DMN S. ZHAO 20SEP2007	 TE Connectivity
DIMENSIONS: INCHES		CHK S. ZHAO 20SEP2007	
TOLERANCES UNLESS OTHERWISE SPECIFIED:		APVD S. YAO	NAME VERTICAL RECEPTACLE ASSEMBLY, WITH GUIDES MULTI-BEAM XLE
0 PLC ±.01	1 PLC ±.01	PRODUCT SPEC 108-1973	SIZE CAGE CODE DRAWING NO. RESTRICTED TO
2 PLC ±.01	3 PLC ±.005	APPLICATION SPEC 114-13038	A100779C=6450850
4 PLC ±.0020	ANGLES ±.020	WEIGHT	SCALE 4:1 SHEET 5 OF 8 REV F
MATERIAL	FINISH	CUSTOMER DRAWING	

PART NUMBER	ROWS	LOW POWER						POWER	SIGNAL						POWER				
		LP7	LP6	LP5	LP4	LP3	LP2	LP1	P6	6	5	4	3	2	1	P5	P4	P3	P2
1-6450850-8	D								E	E	E	E	E	E					
	C	LM	LM	LM	LM	LM	LM	VA	E	E	E	E	E	E	VM	VM			
	B								E	E	E	E	E	E					
	A	HD							E	E	E	E	E	E					

5HDP + 24S + 1P + 7LP

NO CONTACTS LOADED

PART NUMBER	ROWS	POWER			SIGNAL				POWER		
		P6	P5	P4	4	3	2	1	P3	P2	P1
1-6450850-9	D	VM	VM	VM	E	E	E	E	VM	VM	VM
	C				E	E	E	E			
	B				E	E	E	E			
	A	HD			E	E	E	E			

3P + 16S + 3P

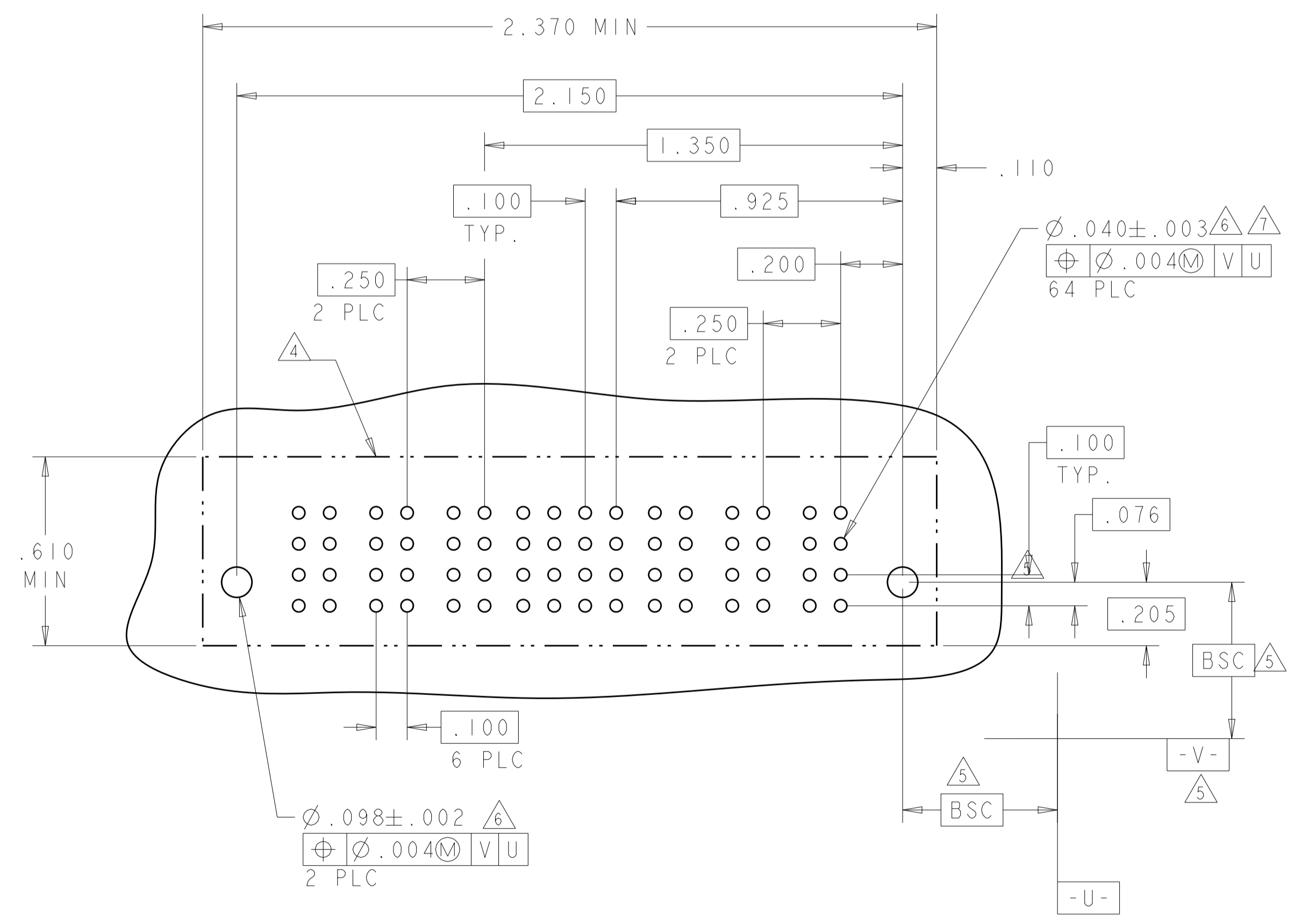
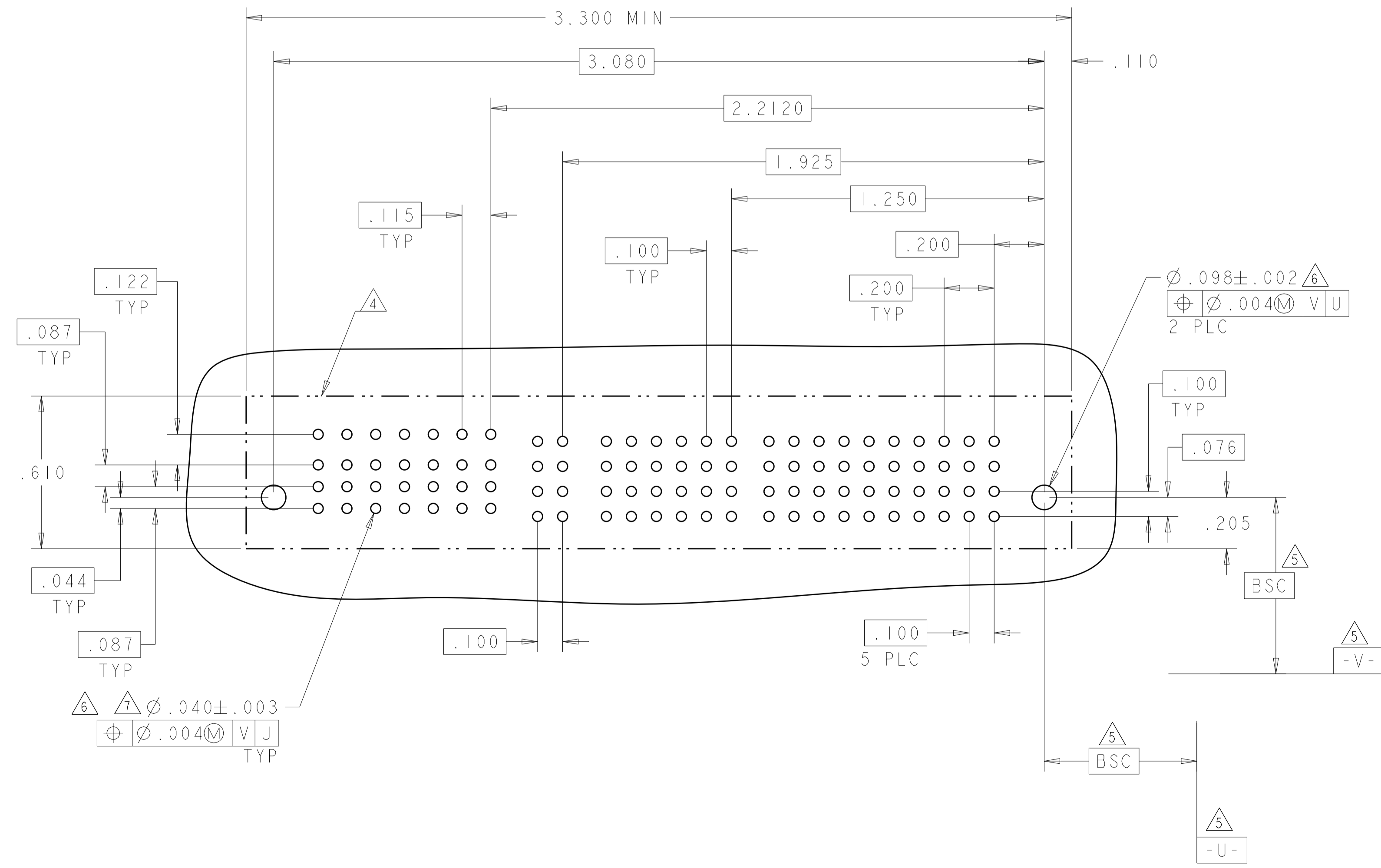
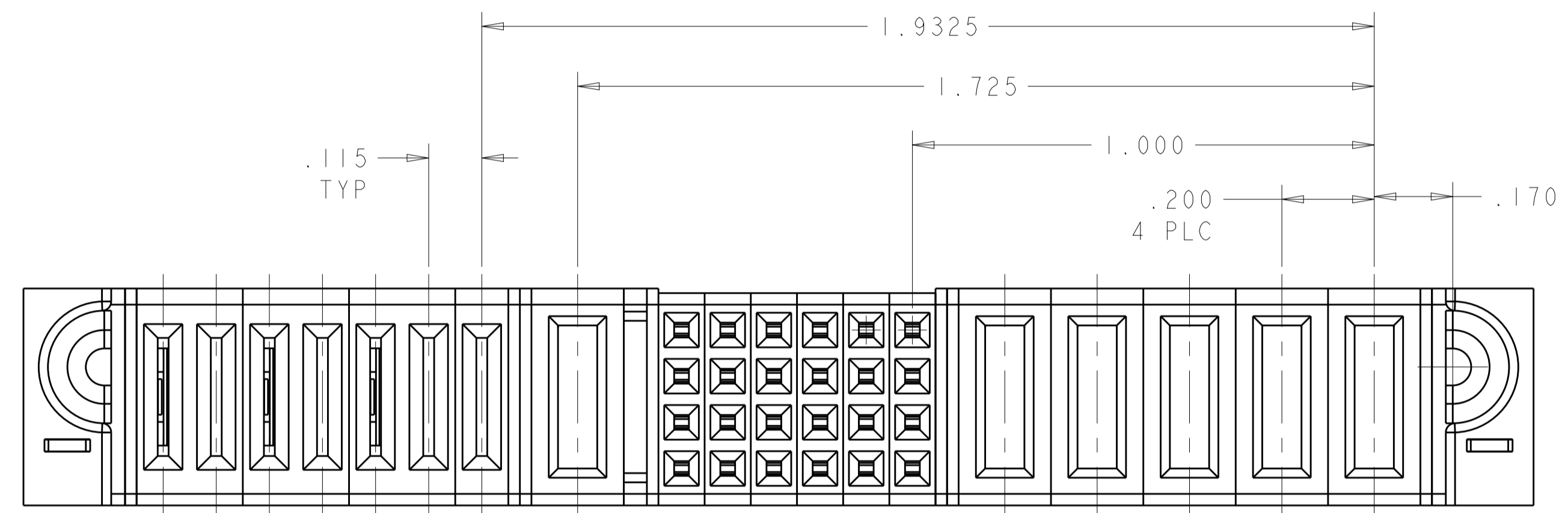

THIS DRAWING IS A CONTROLLED DOCUMENT.

DIMENSIONS: INCHES	TOLERANCES UNLESS OTHERWISE SPECIFIED:	0 PLC ±.01	1 PLC ±.01	2 PLC ±.01	3 PLC ±.005	4 PLC ±.002	ANGLES ±.020	FINISH
--------------------	--	------------	------------	------------	-------------	-------------	--------------	--------

DWN S. ZHAO 20SEP2007	CHK S. ZHAO 20SEP2007	APVD S. YAO	NAME S. YAO
PRODUCT SPEC 108-1973		APPLICATION SPEC 114-13038	WEIGHT
CUSTOMER DRAWING		SCALE 4:1	SHEET 6 OF 8

STE TE Connectivity

VERTICAL RECEPTACLE ASSEMBLY, WITH GUIDES MULTI-BEAM XLE

SIZE A100779 CAGE CODE DRAWING NO. 6450850

LOC		DIST		REVISIONS			
ES	00	P	LTN	DESCRIPTION	DATE	DMN	APVD
				SEE SHEET 1			

PART NUMBER	ROWS	LOW POWER				SIGNAL			LOW POWER		
		LP7	LP6	LP5	LP4	3	2	1	LP3	LP2	LP1
2-6450850-0	D					E	E	E			
	C					E	E	E			
	B					E	E	E			
	A	LM	LM	LM	LM	E	E	E	LM	LM	LM
		HD									HD
3LP + 12S + 4LP											

PART NUMBER	ROWS	POWER			SIGNAL				POWER		
		P6	P5	P4	4	3	2	1	P3	P2	P1
2-6450850-1	D				E	E	E	E			
	C				E	E	E	E			
	B				E	E	E	E			
	A	VA	VM	VA	E	E	E	E	VM	VM	VA
		HD									HD
3ACP + 16S + 3P											

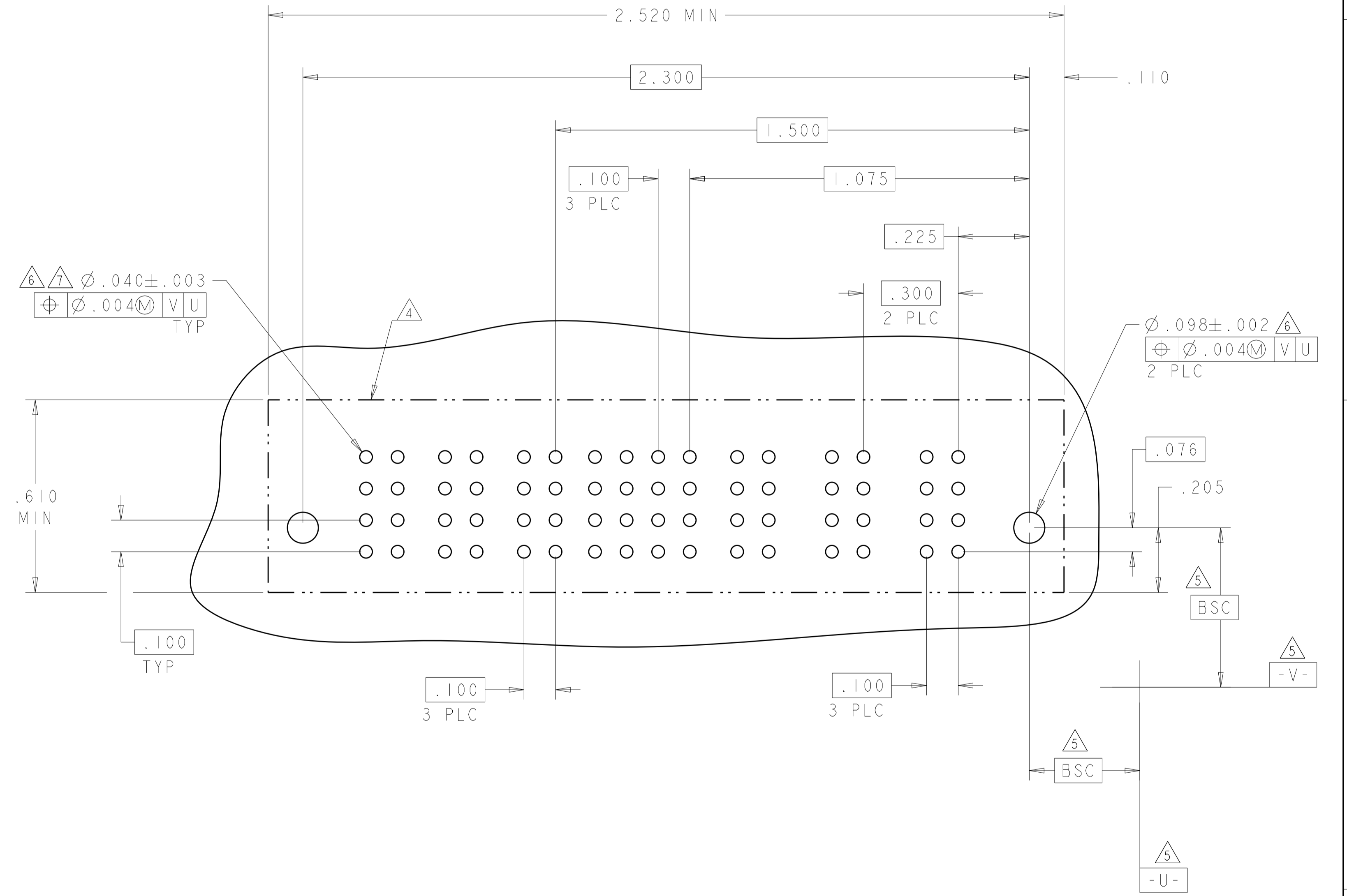
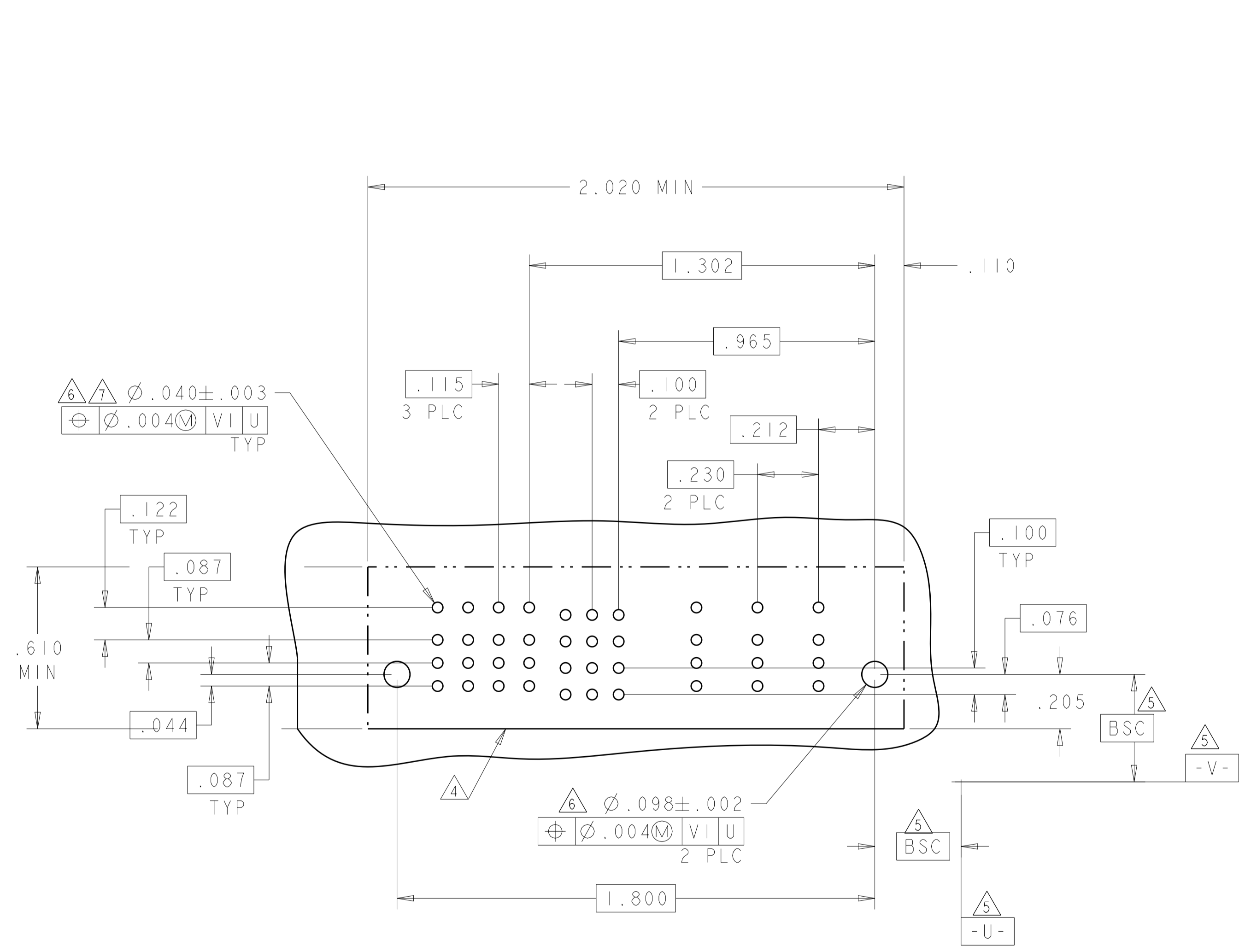

THIS DRAWING IS A CONTROLLED DOCUMENT.		DMN S. ZHAO 20SEP2007	TE Connectivity
DIMENSIONS: INCHES		CHK S. ZHAO 20SEP2007	
TOLERANCES UNLESS OTHERWISE SPECIFIED:		APVD S. YAO	NAME
0 PLC ±		PRODUCT SPEC	VERTICAL RECEPTACLE ASSEMBLY, WITH GUIDES
1 PLC ±.01		APPLICATION SPEC	MULTI-BEAM XLE
2 PLC ±.05		WEIGHT	SIZE CAGE CODE DRAWING NO
3 PLC ±.0020		RESTRICTED TO	A100779C=6450850
4 PLC ±.0020		SCALE	4:1 SHEET 7 OF 8 REV F
ANGLES ±.2°		CUSTOMER DRAWING	
FINISH			

LOC	DIST	REV	DATE	BY	APPV
ES	00				

REVISIONS					
REV	DATE	BY	APPV	DESCRIPTION	DATE
-	-	-	-	SEE SHEET 1	-

PART NUMBER	ROWS	LOW POWER														POWER	SIGNAL								LOW POWER										
		LP25	LP24	LP23	LP22	LP21	LP20	LP19	LP18	LP17	LP16	LP15	LP14	LP13	LP12		LP11	LP10	P1	9	8	7	6	5	4	3	2	1	LP9	LP8	LP7	LP6	LP5	LP4	LP3
2-6450850-2	D																	VA	E	E	E	E	E	E	E	E	E	E							
	C	LM	LM	LM	LM	LM	LM	LM	LM	LM	LM	LM	LM	LM	LM	LM		E	E	E	E	E	E	E	E	E	E	LM	LM	LM	LM	LM	LM	LM	
	B																	E	E	E	E	E	E	E	E	E	E								
	A																	E	E	E	E	E	E	E	E	E	E								

NO CONTACTS LOADED (pointing to LP1-10)
 NO CONTACTS LOADED (pointing to P1)
 NO CONTACT LOADED (pointing to LP11-16)

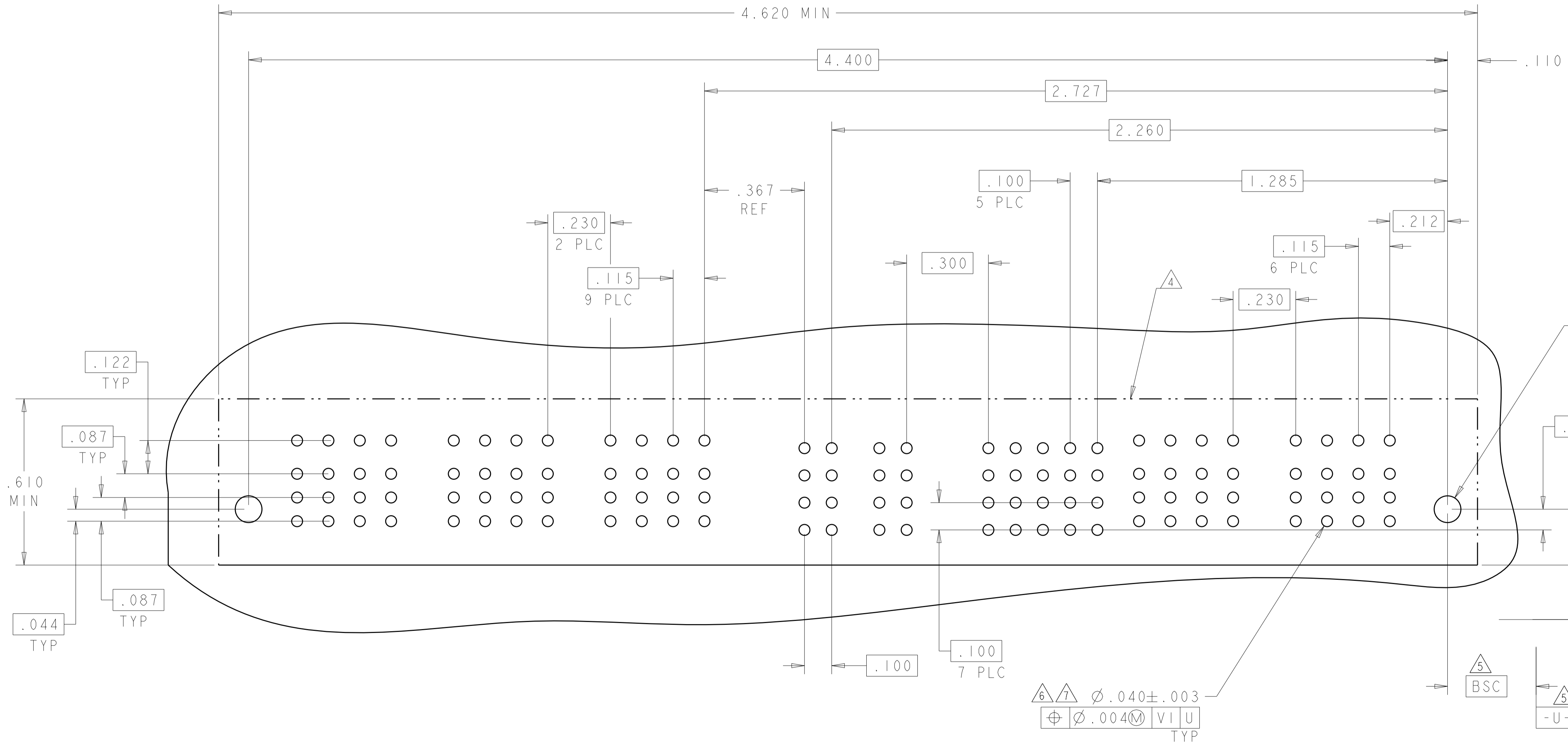
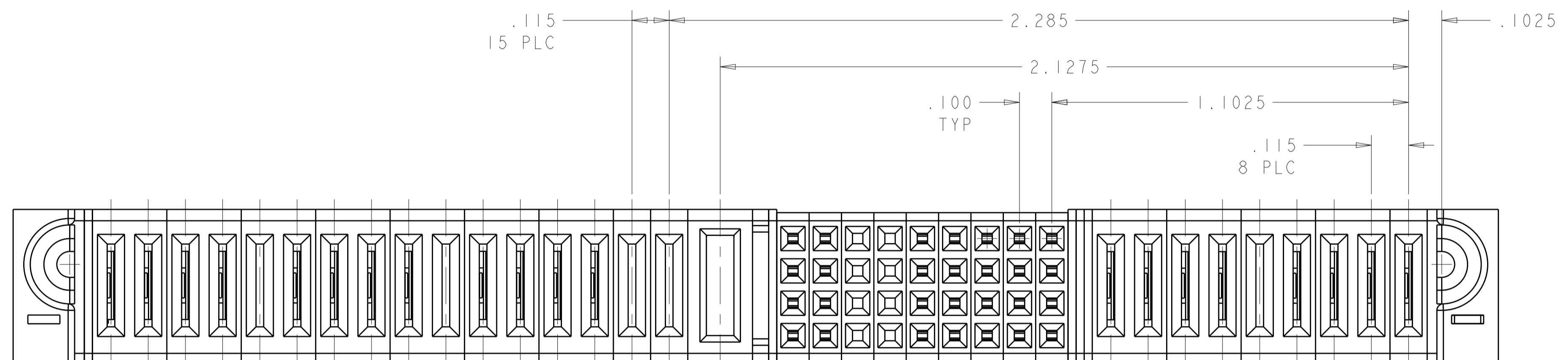

6 7 $\phi .040 \pm .003$
 $\oplus \phi .004 \text{ M VI U}$
 TYP

THIS DRAWING IS A CONTROLLED DOCUMENT.

DWN: S. ZHAO	20SEP2007	TE Connectivity
CHK: S. ZHAO	20SEP2007	
APVD: S. YAO		NAME: VERTICAL RECEPTACLE ASSEMBLY, WITH GUIDES MULTI-BEAM XLE
DIMENSIONS: INCHES		PRODUCT SPEC: 108-1973
TOLERANCES UNLESS OTHERWISE SPECIFIED:		APPLICATION SPEC: 114-13038
0 PLC ±	1 PLC ±.01	SIZE: A100779
2 PLC ±.01	3 PLC ±.005	CAGE CODE: C=6450850
4 PLC ±.0020	ANGLES ±.2°	RESTRICTED TO: -
MATERIAL: -	FINISH: -	WEIGHT: -
CUSTOMER DRAWING		SCALE: 4:1 SHEET 8 OF 8 REV F

Компания «Океан Электроники» предлагает заключение долгосрочных отношений при поставках импортных электронных компонентов на взаимовыгодных условиях!

Наши преимущества:

- Поставка оригинальных импортных электронных компонентов напрямую с производств Америки, Европы и Азии, а так же с крупнейших складов мира;
- Широкая линейка поставок активных и пассивных импортных электронных компонентов (более 30 млн. наименований);
- Поставка сложных, дефицитных, либо снятых с производства позиций;
- Оперативные сроки поставки под заказ (от 5 рабочих дней);
- Экспресс доставка в любую точку России;
- Помощь Конструкторского Отдела и консультации квалифицированных инженеров;
- Техническая поддержка проекта, помощь в подборе аналогов, поставка прототипов;
- Поставка электронных компонентов под контролем ВП;
- Система менеджмента качества сертифицирована по Международному стандарту ISO 9001;
- При необходимости вся продукция военного и аэрокосмического назначения проходит испытания и сертификацию в лаборатории (по согласованию с заказчиком);
- Поставка специализированных компонентов военного и аэрокосмического уровня качества (Xilinx, Altera, Analog Devices, Intersil, Interpoint, Microsemi, Actel, Aeroflex, Peregrine, VPT, Syfer, Eurofarad, Texas Instruments, MS Kennedy, Miteq, Cobham, E2V, MA-COM, Hittite, Mini-Circuits, General Dynamics и др.);

Компания «Океан Электроники» является официальным дистрибьютором и эксклюзивным представителем в России одного из крупнейших производителей разъемов военного и аэрокосмического назначения «**JONHON**», а так же официальным дистрибьютором и эксклюзивным представителем в России производителя высокотехнологичных и надежных решений для передачи СВЧ сигналов «**FORSTAR**».



JONHON

«**JONHON**» (основан в 1970 г.)

Разъемы специального, военного и аэрокосмического назначения:

(Применяются в военной, авиационной, аэрокосмической, морской, железнодорожной, горно- и нефтедобывающей отраслях промышленности)

«**FORSTAR**» (основан в 1998 г.)

ВЧ соединители, коаксиальные кабели,
кабельные сборки и микроволновые компоненты:

(Применяются в телекоммуникациях гражданского и специального назначения, в средствах связи, РЛС, а так же военной, авиационной и аэрокосмической отраслях промышленности).



Телефон: 8 (812) 309-75-97 (многоканальный)

Факс: 8 (812) 320-03-32

Электронная почта: ocean@oceanchips.ru

Web: <http://oceanchips.ru/>

Адрес: 198099, г. Санкт-Петербург, ул. Калинина, д. 2, корп. 4, лит. А