

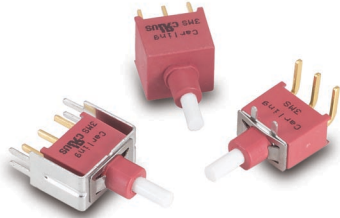

3MN-Series
Snap-Action Miniature Pushbutton Switch

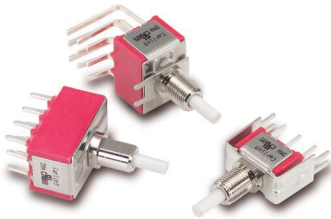

3MS-Series
Sealed Snap-Action Miniature Pushbutton Switch



3MA-Series
Alternate Action Miniature Pushbutton Switch

Specifications

| | |
|-------------------------------|--|
| Contact Rating | refer to ordering scheme |
| Electrical Life | 50,000 make & break cycles @ full load |
| Contact Resistance. | <i>3MN & 3MA-Series:</i> 10 mΩ max. initial @ 2-4 VDC 100mA for both silver & gold plated contacts. <i>3MS-Series:</i> 50 mΩ max. initial @ 2-4 VDC 100mA for both silver & gold plated contacts. |
| Insulation Resistance . . . | 1000 MΩ min. |
| Dielectric Strength | 1500 Volts RMS @ sea level |
| Operating Temperature . . . | -30°C to +85°C |
| Index of Protection | <i>3MS -Series:</i> IP68 |
| Cap Installation Support . . | <i>3MS-Series:</i> 10 lbs. max. |
| Solder Heat Resistance. . . | MIL-STD-202, Method 210 |
| Actuator Travel | .25° |

Materials

| | |
|-----------------------------|---|
| Case | <i>3MN & 3MA-Series:</i> Diallyl phthalate (DAP) (UL 94V-0) <i>3MS-Series:</i> Glass filled nylon 6/6, flame retardant, heat stabilized (UL 94V-0) |
| Plunger. | <i>3MN-Series:</i> Thermoplastic polyester, black <i>3MS & 3MA-Series:</i> Glass filled nylon or glass filled polyester (UL 94V-0) |
| Bushing | <i>3MN-Series:</i> Brass, nickel plated <i>3MA-Series:</i> Zinc, nickel plated |
| Housing. | <i>3MN & 3MA-Series:</i> Stainless Steel |
| Switch Support Retainer . . | <i>3MS-Series:</i> Stainless Steel |
| Terminal Seal | Epoxy |

3M-Series Optional Cap

To order a cap assembled on a switch, specify the switch number followed by the cap part number and the word "assembled".

Ex: 3MN-SP-7-P2-B6-M6QE-C13ASSEMBLED

To order caps in bulk, specify the Series, followed by the cap. Ex.) 3MN-C13



| | | | |
|---|----------------------|-----------|--|
| 1 SERIES OR SWITCH CATALOG NUMBER 3MN, 3MS or 3MA | | | |
| 2 CAP SIZE | | | |
| C1 | round 7.6mm dia. | C5 | round 14.5mm dia. |
| C2 | round 9.35 mm dia. | C6 | (for 3MA w/ PL bushing) brass chrome plated |
| C3 | square 11.7 x 11.7mm | C6 | (for 3MA w/ PD bushing) |
| C4 | round 5mm dia. | | |

| | | | |
|--|--------|----------|--------|
| 3 CAP COLOR | | | |
| 1 | white | 5 | yellow |
| 2 | black | 6 | green |
| 3 | red | 7 | blue |
| 4 | orange | | |
| <small>1 Black, white & red standard. Other colors available. Consult factory.</small> | | | |

3MS-Series Ordering Scheme

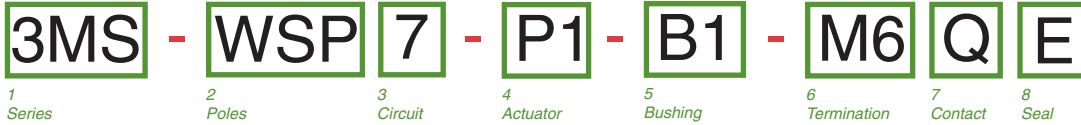

| <p>1 SERIES 3MS Sealed Snap-Action Miniature Pushbutton Switch</p> | <p>6 TERMINATION</p> <table> <tr> <td>M1 Solder Lug</td> <td>VS21 Snap-In, U bracket, .620 mounting x .460 high</td> </tr> <tr> <td>M2 PCB</td> <td>VS3 PC Mount, U bracket, .620 mounting x .630 high</td> </tr> <tr> <td>M6 PC Mount, 90° horizontal</td> <td>VS4 PC Mount, U bracket, .750 mounting x .460 high</td> </tr> <tr> <td>M61 Snap-In, 90° horizontal</td> <td>VS5 PC Mount, U bracket, .750 mounting x .630 high</td> </tr> <tr> <td>M7 PC Mount, 90° vertical</td> <td></td> </tr> <tr> <td>M71 Snap-In, 90° vertical</td> <td></td> </tr> <tr> <td>VS2 PC Mount, U bracket, .620 mounting x .460 high</td> <td></td> </tr> </table> | M1 Solder Lug | VS21 Snap-In, U bracket, .620 mounting x .460 high | M2 PCB | VS3 PC Mount, U bracket, .620 mounting x .630 high | M6 PC Mount, 90° horizontal | VS4 PC Mount, U bracket, .750 mounting x .460 high | M61 Snap-In, 90° horizontal | VS5 PC Mount, U bracket, .750 mounting x .630 high | M7 PC Mount, 90° vertical | | M71 Snap-In, 90° vertical | | VS2 PC Mount, U bracket, .620 mounting x .460 high | | | |
|--|--|-----------------------------|---|---------------|---|------------------------------------|---|------------------------------------|---|----------------------------------|---------------------|----------------------------------|--------------|---|-------------------|-----------------------------|------|
| M1 Solder Lug | VS21 Snap-In, U bracket, .620 mounting x .460 high | | | | | | | | | | | | | | | | |
| M2 PCB | VS3 PC Mount, U bracket, .620 mounting x .630 high | | | | | | | | | | | | | | | | |
| M6 PC Mount, 90° horizontal | VS4 PC Mount, U bracket, .750 mounting x .460 high | | | | | | | | | | | | | | | | |
| M61 Snap-In, 90° horizontal | VS5 PC Mount, U bracket, .750 mounting x .630 high | | | | | | | | | | | | | | | | |
| M7 PC Mount, 90° vertical | | | | | | | | | | | | | | | | | |
| M71 Snap-In, 90° vertical | | | | | | | | | | | | | | | | | |
| VS2 PC Mount, U bracket, .620 mounting x .460 high | | | | | | | | | | | | | | | | | |
| <p>2 POLES WSP single pole WDP double pole</p> | <p>7 CONTACT</p> <table> <thead> <tr> <th>Material</th> <th>Terminal Plating</th> <th>Rating</th> <th>Approvals</th> </tr> </thead> <tbody> <tr> <td>G silver¹</td> <td>gold over silver³</td> <td>1A@120VAC or 28VDC</td> <td>UL, CUL IP68</td> </tr> <tr> <td>Q silver¹</td> <td>silver¹</td> <td>1A@120VAC or 28VDC</td> <td>UL, CUL IP68</td> </tr> <tr> <td>R gold²</td> <td>gold²</td> <td>0.4VA max. @20V max (AC/DC)</td> <td>IP68</td> </tr> </tbody> </table> <p>NOTE: Tin-lead option available with PC type terminations only.</p> <p>1 Moveable contact & terminals: copper alloy, silver plate 2 Moveable contact & terminals: copper alloy with gold plate over nickel plate 3 Terminals: silver plate with outer layer in gold plating</p> | Material | Terminal Plating | Rating | Approvals | G silver ¹ | gold over silver ³ | 1A@120VAC or 28VDC | UL, CUL IP68 | Q silver ¹ | silver ¹ | 1A@120VAC or 28VDC | UL, CUL IP68 | R gold ² | gold ² | 0.4VA max. @20V max (AC/DC) | IP68 |
| Material | Terminal Plating | Rating | Approvals | | | | | | | | | | | | | | |
| G silver ¹ | gold over silver ³ | 1A@120VAC or 28VDC | UL, CUL IP68 | | | | | | | | | | | | | | |
| Q silver ¹ | silver ¹ | 1A@120VAC or 28VDC | UL, CUL IP68 | | | | | | | | | | | | | | |
| R gold ² | gold ² | 0.4VA max. @20V max (AC/DC) | IP68 | | | | | | | | | | | | | | |
| <p>3 CIRCUIT () - momentary</p> <p>7 ON (ON)</p> | <p>7 EPOXY SEAL E epoxy seal</p> | | | | | | | | | | | | | | | | |
| <p>4 ACTUATOR</p> <p>P1 .173" plunger (for B1 bushing); .276" (for B4 bushing) P2 .220" plunger (for B1 bushing); .327" (for B4 bushing) P3 .087" plunger (for B1 bushing); .193" (for B4 bushing)</p> | | | | | | | | | | | | | | | | | |
| <p>5 BUSHING</p> <p>B1 Threaded B4 Unthreaded</p> | | | | | | | | | | | | | | | | | |

3MA-Series Ordering Scheme

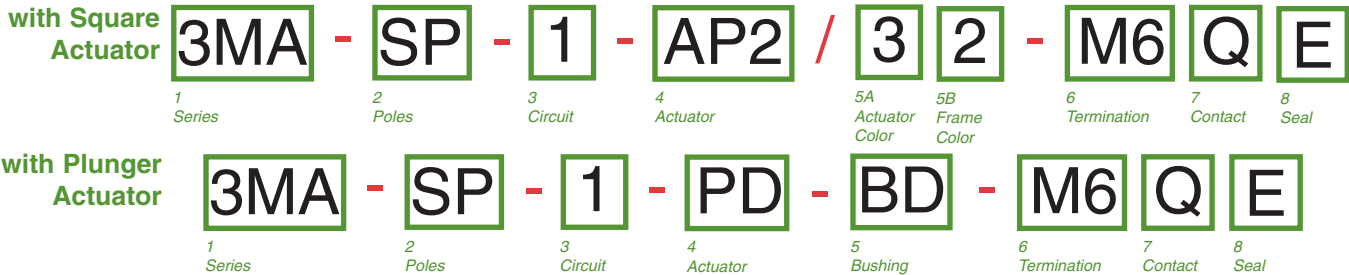

| <p>1 SERIES 3MA Alternate-Action Miniature Pushbutton Switch</p> | <p>6 TERMINATION</p> <table> <tr> <td>M1 Solder Lug</td> <td>VS2 PC Mount, U bracket, .620 mounting x .460 high</td> </tr> <tr> <td>M2 PCB</td> <td>VS3 PC Mount, U bracket, .620 mounting x .630 high</td> </tr> <tr> <td>M5-1 Wire Wrap .750 [19.05]</td> <td>VS4 PC Mount, U bracket, .750 mounting x .460 high</td> </tr> <tr> <td>M5-2 Wire Wrap .964 [24.48]</td> <td>VS5 PC Mount, U bracket, .750 mounting x .630 high</td> </tr> <tr> <td>M5-3 Wire Wrap .425 [10.80]</td> <td></td> </tr> <tr> <td>M5-4 Wire Wrap 1.062 [26.87]</td> <td></td> </tr> <tr> <td>M6 PC Mount, 90° horizontal</td> <td></td> </tr> <tr> <td>M7 PC Mount, 90° vertical</td> <td></td> </tr> </table> | M1 Solder Lug | VS2 PC Mount, U bracket, .620 mounting x .460 high | M2 PCB | VS3 PC Mount, U bracket, .620 mounting x .630 high | M5-1 Wire Wrap .750 [19.05] | VS4 PC Mount, U bracket, .750 mounting x .460 high | M5-2 Wire Wrap .964 [24.48] | VS5 PC Mount, U bracket, .750 mounting x .630 high | M5-3 Wire Wrap .425 [10.80] | | M5-4 Wire Wrap 1.062 [26.87] | | M6 PC Mount, 90° horizontal | | M7 PC Mount, 90° vertical | | | | | | | | | |
|---|--|-------------------------------|---|---------------|---|------------------------------------|---|------------------------------------|---|------------------------------------|-----------------------|-------------------------------------|---------|------------------------------------|-----------------------|----------------------------------|---------|------------------------------|---------------------|-------------------------------|---------|----------------------------|-------------------|-----------------------------|--|
| M1 Solder Lug | VS2 PC Mount, U bracket, .620 mounting x .460 high | | | | | | | | | | | | | | | | | | | | | | | | |
| M2 PCB | VS3 PC Mount, U bracket, .620 mounting x .630 high | | | | | | | | | | | | | | | | | | | | | | | | |
| M5-1 Wire Wrap .750 [19.05] | VS4 PC Mount, U bracket, .750 mounting x .460 high | | | | | | | | | | | | | | | | | | | | | | | | |
| M5-2 Wire Wrap .964 [24.48] | VS5 PC Mount, U bracket, .750 mounting x .630 high | | | | | | | | | | | | | | | | | | | | | | | | |
| M5-3 Wire Wrap .425 [10.80] | | | | | | | | | | | | | | | | | | | | | | | | | |
| M5-4 Wire Wrap 1.062 [26.87] | | | | | | | | | | | | | | | | | | | | | | | | | |
| M6 PC Mount, 90° horizontal | | | | | | | | | | | | | | | | | | | | | | | | | |
| M7 PC Mount, 90° vertical | | | | | | | | | | | | | | | | | | | | | | | | | |
| <p>2 POLES SP single pole DP double pole 3P three pole 4P four pole</p> | <p>7 CONTACT</p> <table> <thead> <tr> <th>Material</th> <th>Terminal Plating</th> <th>Rating</th> <th>Approvals</th> </tr> </thead> <tbody> <tr> <td>G silver¹</td> <td>gold over silver³</td> <td>6A@125VAC or 28VDC, 3A@250VAC</td> <td>UL, CUL</td> </tr> <tr> <td>K gold²</td> <td>tin-lead⁴</td> <td>6A@125VAC or 28VDC, 3A@250VAC</td> <td>UL, CUL</td> </tr> <tr> <td>P silver¹</td> <td>tin-lead⁴</td> <td>6A@125VAC or 28VDC, 3A@250VAC</td> <td>UL, CUL</td> </tr> <tr> <td>Q silver¹</td> <td>silver¹</td> <td>6A@125VAC or 28VDC, 3A@250VAC</td> <td>UL, CUL</td> </tr> <tr> <td>R gold²</td> <td>gold²</td> <td>0.4VA max. @20V max (AC/DC)</td> <td></td> </tr> </tbody> </table> <p>NOTE: Tin-lead option available with PC type terminations only.</p> <p>1 Moveable contact & terminals: copper alloy, silver plate 2 Moveable contact & terminals: copper alloy with gold plate over nickel plate 3 Terminals: silver plate with outer layer in gold plating 4 Outer terminals: copper alloy with tin-lead over nickel plate</p> | Material | Terminal Plating | Rating | Approvals | G silver ¹ | gold over silver ³ | 6A@125VAC or 28VDC, 3A@250VAC | UL, CUL | K gold ² | tin-lead ⁴ | 6A@125VAC or 28VDC, 3A@250VAC | UL, CUL | P silver ¹ | tin-lead ⁴ | 6A@125VAC or 28VDC, 3A@250VAC | UL, CUL | Q silver ¹ | silver ¹ | 6A@125VAC or 28VDC, 3A@250VAC | UL, CUL | R gold ² | gold ² | 0.4VA max. @20V max (AC/DC) | |
| Material | Terminal Plating | Rating | Approvals | | | | | | | | | | | | | | | | | | | | | | |
| G silver ¹ | gold over silver ³ | 6A@125VAC or 28VDC, 3A@250VAC | UL, CUL | | | | | | | | | | | | | | | | | | | | | | |
| K gold ² | tin-lead ⁴ | 6A@125VAC or 28VDC, 3A@250VAC | UL, CUL | | | | | | | | | | | | | | | | | | | | | | |
| P silver ¹ | tin-lead ⁴ | 6A@125VAC or 28VDC, 3A@250VAC | UL, CUL | | | | | | | | | | | | | | | | | | | | | | |
| Q silver ¹ | silver ¹ | 6A@125VAC or 28VDC, 3A@250VAC | UL, CUL | | | | | | | | | | | | | | | | | | | | | | |
| R gold ² | gold ² | 0.4VA max. @20V max (AC/DC) | | | | | | | | | | | | | | | | | | | | | | | |
| <p>3 CIRCUIT () - momentary</p> <p>Switching Position: 2-3, 5-6, 8-9, 11-12 OPEN 2-1, 5-4, 8-7, 11-10</p> <p>1 ON NONE ON 2 ON NONE (ON)</p> | <p>7 EPOXY SEAL E epoxy seal</p> | | | | | | | | | | | | | | | | | | | | | | | | |
| <p>4 ACTUATOR</p> <p>SQUARE ACTUATOR (use with Color Options in Selection 5A & 5B.) AP1 square with no frame AP2 square raised above frame</p> <p>PLUNGER ACTUATOR (use with Bushing Options in Selection 5) PA .118 dia. x .299" plunger length PI .118 dia. x .244" plunger length PL .118 dia. x .327" plunger length PC .315" dia. brass chrome plated plunger (for BD bushing only) PD .242" dia. brass chrome plated plunger (for BD bushing only)</p> | | | | | | | | | | | | | | | | | | | | | | | | | |
| <p>5A ACTUATOR COLOR & 5B FRAME COLOR^{1,2}</p> <table> <tr> <td>1 white</td> <td>4 orange</td> <td>7 blue</td> </tr> <tr> <td>2 black</td> <td>5 yellow</td> <td>8 brown</td> </tr> <tr> <td>3 red</td> <td>6 green</td> <td>9 gray</td> </tr> </table> <p>1 Black, red and white are standard. Other colors available, consult factory for details. 2 Selection 5B is blank if actuator style AP1 (no frame)</p> <p>OR</p> <p>5 BUSHING</p> <p>BD Big bushing for PC, PD actuator 15/32" B10 Threaded 1/4 - 40 B20 Unthreaded B21 Unthreaded with flat</p> <p>NOTE: For CAP options, see ordering scheme on page 35.</p> | 1 white | 4 orange | 7 blue | 2 black | 5 yellow | 8 brown | 3 red | 6 green | 9 gray | | | | | | | | | | | | | | | | |
| 1 white | 4 orange | 7 blue | | | | | | | | | | | | | | | | | | | | | | | |
| 2 black | 5 yellow | 8 brown | | | | | | | | | | | | | | | | | | | | | | | |
| 3 red | 6 green | 9 gray | | | | | | | | | | | | | | | | | | | | | | | |

3MN-Series Dimensional Specifications: in. [mm]

PLUNGER

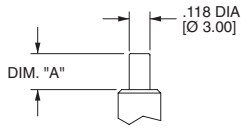

| OPTION CODE | DIM. "A" |
|-------------|-------------|
| P0 | .000 [0.00] |
| P1 | .205 [5.20] |
| P2 | .079 [2.00] |

FOR B10,B11,B20,B21 ONLY

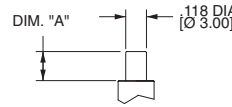

| OPTION CODE | DIM. "A" |
|-------------|-------------|
| P0 | .098 [2.50] |
| P1 | .295 [7.50] |
| P2 | .165 [4.20] |

FOR B6 ONLY

ACTUATOR

AP1

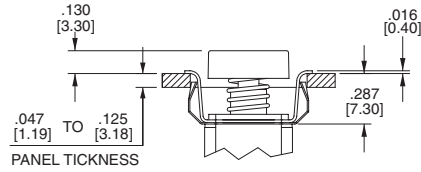
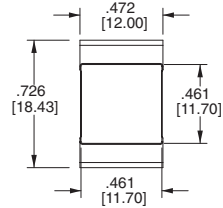

PANEL MOUNTING

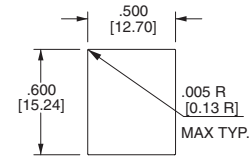

AP2

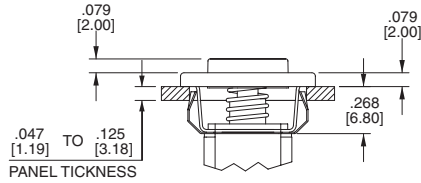
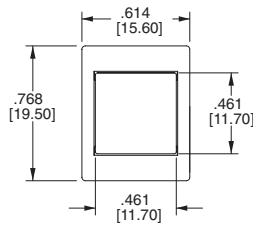

PANEL MOUNTING

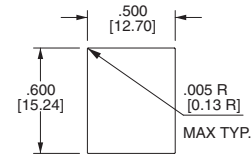

AP3

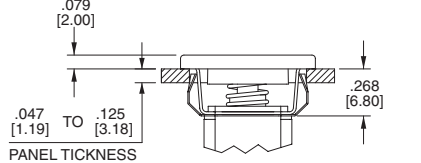
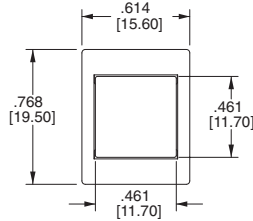

BUSHING

B10 STANDARD KEYWAY THREADED SHOWN

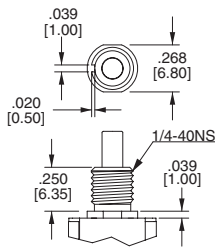

B20 STANDARD KEYWAY NON-THREADED

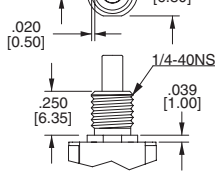

B11 THREADED SHOWN WITH FLAT

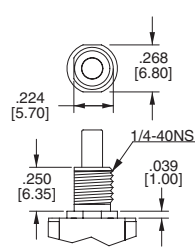

B21 NON-THREADED WITH FLAT

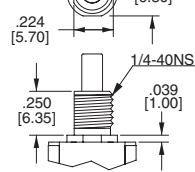

B6 NON-THREADED (FOR TERMINATION OPTIONS VS6-VS9 ONLY)

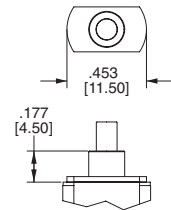

CAP

C1

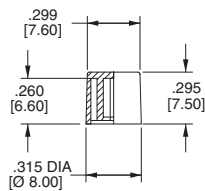

C2

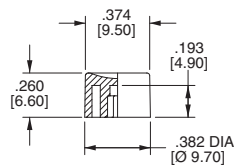

C3

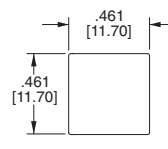

C4

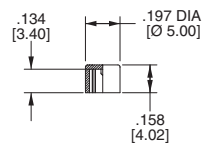

3MN-Series Dimensional Specifications: in. [mm]

TERMINATION

M1

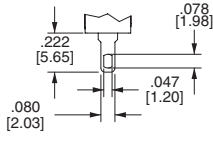

THK .030 [0.75]

M2

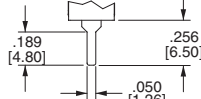

THK .030 [0.75]

M5

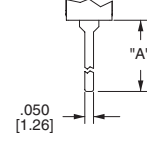

THK .030 [0.75]

| OPTION CODE | DIM. "A" |
|-------------|--------------|
| M5-1 | .750 [19.05] |
| M5-3 | .425 [10.80] |

SINGLE POLE

DOUBLE POLE

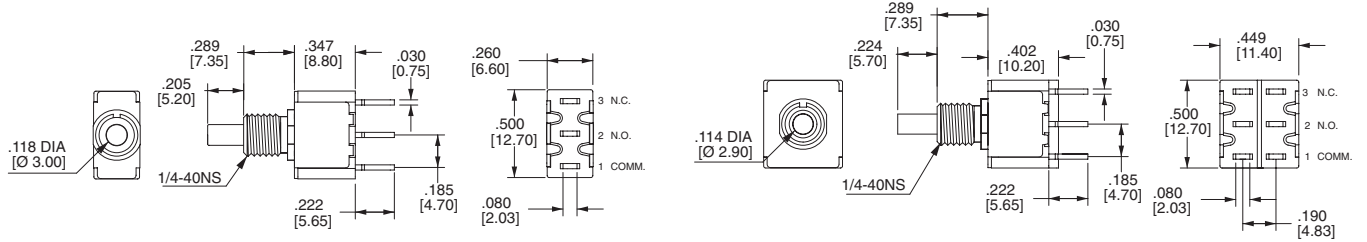

M6

SINGLE POLE

PC MOUNTING

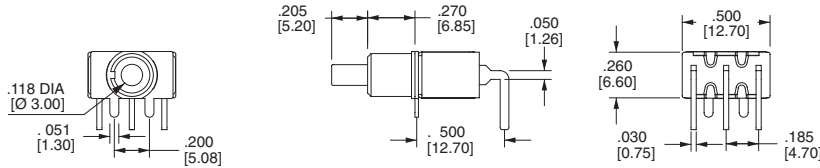

DOUBLE POLE

PC MOUNTING

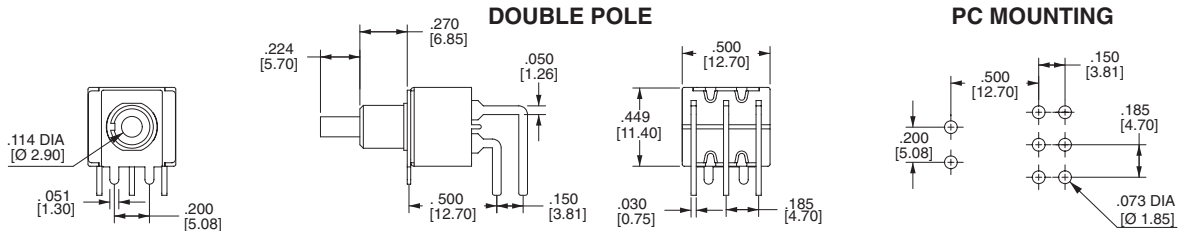

M7

SINGLE POLE

PC MOUNTING

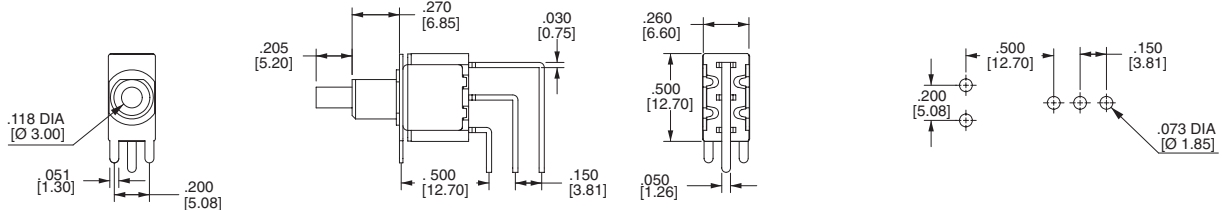

DOUBLE POLE

PC MOUNTING

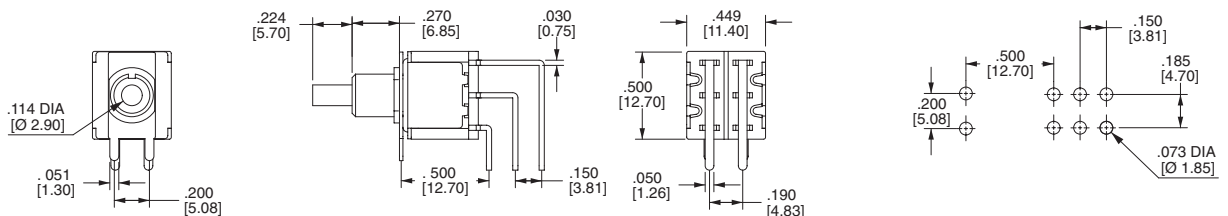

3MN-Series Dimensional Specifications: in. [mm]

TERMINATION

SINGLE POLE

| OPTION CODE | DIM. "A" |
|-------------|--------------|
| VS2 | .460 [11.68] |
| VS3 | .630 [16.00] |
| VS7 | [16.00] |

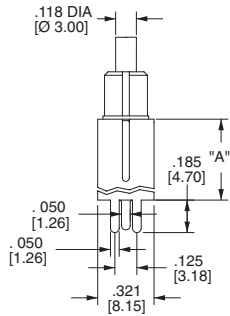

PC MOUNTING

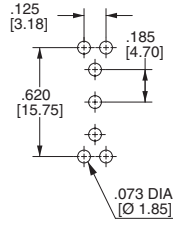

VS2-VS3

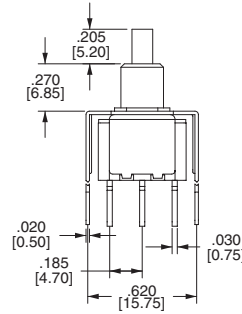

VS6-VS7 (For B6 Bushing Only)

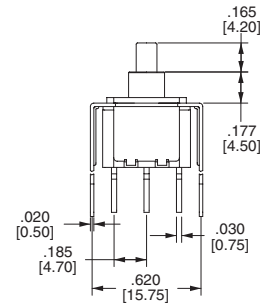

DOUBLE POLE

| OPTION CODE | DIM. "A" |
|-------------|--------------|
| VS2 | .460 [11.68] |
| VS3 | .630 [16.00] |
| VS7 | [16.00] |

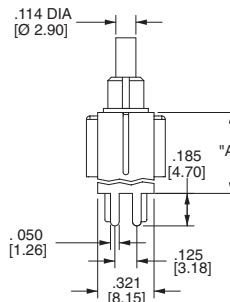

PC MOUNTING

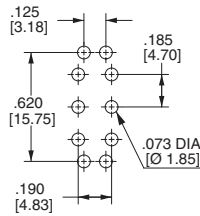

VS2-VS3

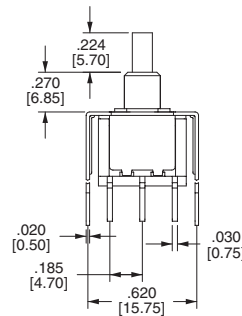

VS6-VS7 (For B6 Bushing Only)

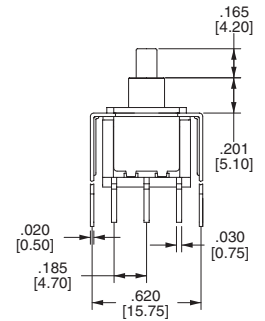

SINGLE POLE

| OPTION CODE | DIM. "A" |
|-------------|--------------|
| VS4 | .460 [11.68] |
| VS5 | .630 [16.00] |
| VS9 | [16.00] |

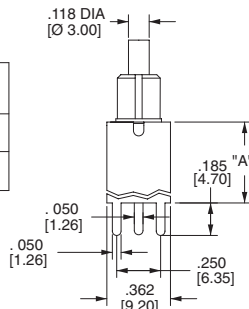

PC MOUNTING

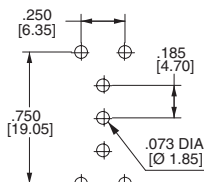

VS4-VS5

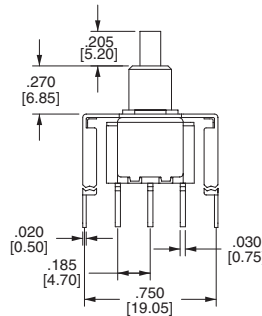

VS8-VS9 (For B6 Bushing Only)

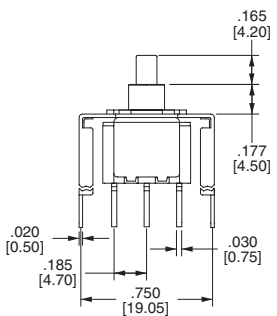

DOUBLE POLE

| OPTION CODE | DIM. "A" |
|-------------|--------------|
| VS4 | .460 [11.68] |
| VS5 | .630 [16.00] |
| VS9 | [16.00] |

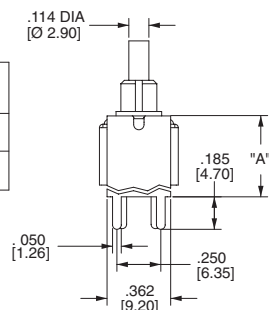

PC MOUNTING

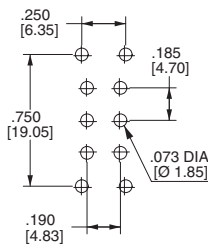

VS4-VS5

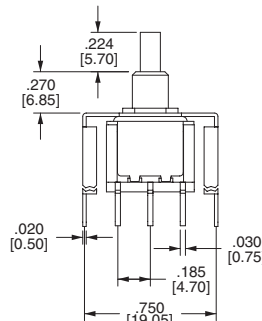

VS8-VS9 (For B6 Bushing Only)

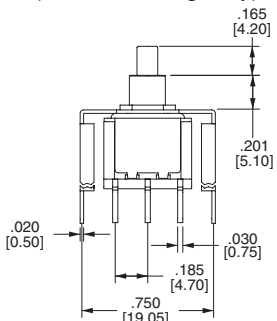

3MS-Series Dimensional Specifications: in. [mm]

PLUNGER

| OPTION CODE | DIM. "A" |
|-------------|-------------|
| P1 | .173 [4.40] |
| P2 | .220 [5.60] |
| P3 | .087 [2.20] |

FOR B1 BUSHING

| OPTION CODE | DIM. "A" |
|-------------|-------------|
| P1 | .276 [7.00] |
| P2 | .327 [8.30] |
| P3 | .193 [4.90] |

FOR B4 BUSHING

BUSHING

B1

1/4-40NS
.350 [8.90]

B4

.250 [6.35]

TERMINATION

M1

EPOXY SEAL
THK .030 [0.75]

M2

EPOXY SEAL
THK .030 [0.75]

SINGLE POLE

EPOXY SEAL

DOUBLE POLE

EPOXY SEAL

M6

.236 DIA [Ø 6.00]
.200 [5.08]
.050 [1.26]

SINGLE POLE

EPOXY SEAL

PC MOUNTING

.185 [4.70]
.500 [12.70]
.073 DIA [Ø 1.85]
.200 [5.08]

.205 DIA [Ø 5.20]
.200 [5.08]
.050 [1.26]

DOUBLE POLE

EPOXY SEAL

PC MOUNTING

.185 [4.70]
.150 [3.81]
.500 [12.70]
.073 DIA [Ø 1.85]
.200 [5.08]

3MS-Series Dimensional Specifications: in. [mm]

TERMINATION

M7

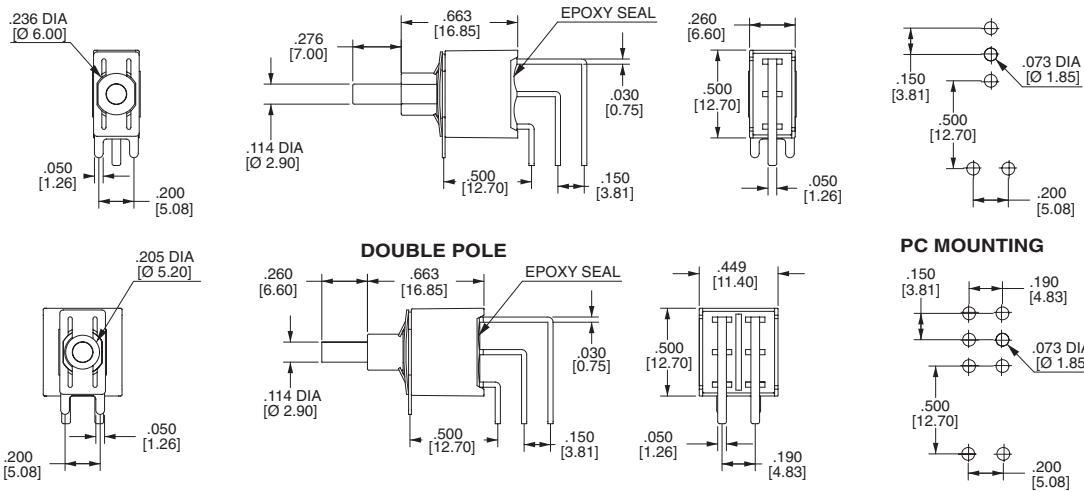

VS2-VS3

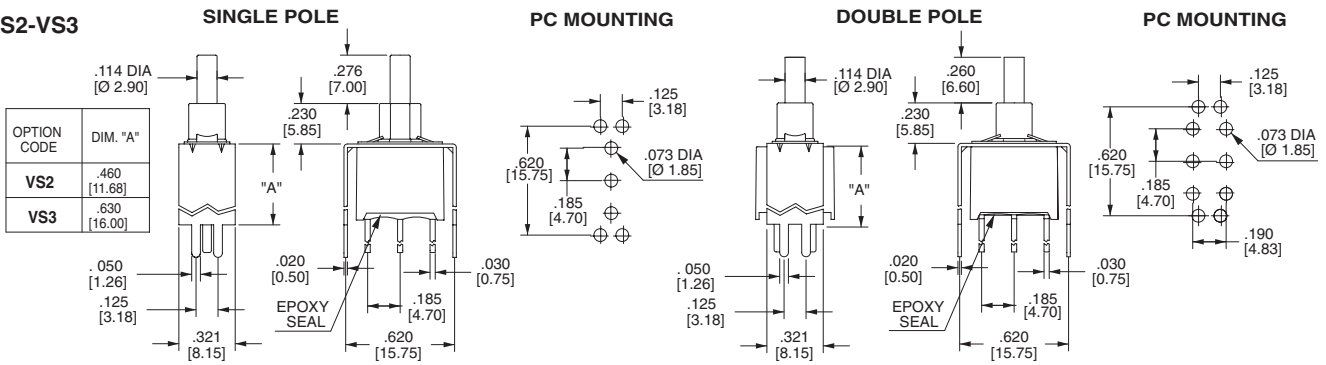

VS4-VS5

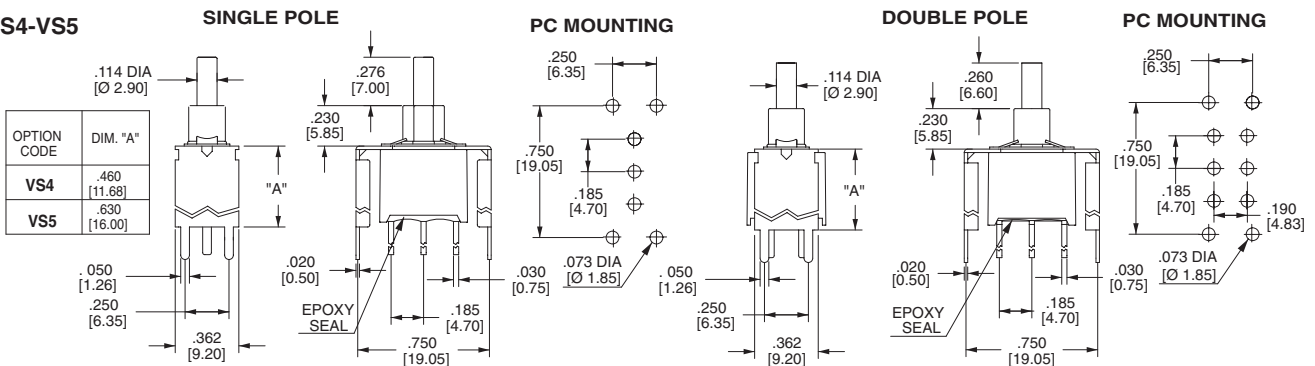

SNAP-IN TERMINATION OPTIONS

M61



M71

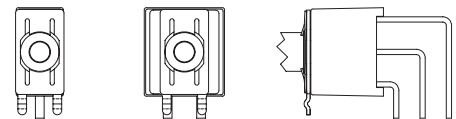

VS21, VS31

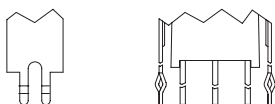

VS41, VS51



M61, M71, VS21, VS31, VS41, VS51 have the same P.C. mounting but with snap-in bracket.

3MA-Series Dimensional Specifications: in. [mm]

ACTUATOR

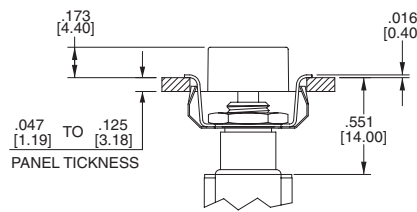
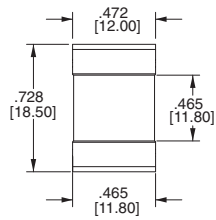
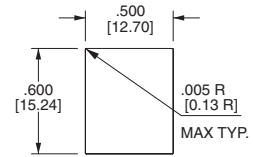
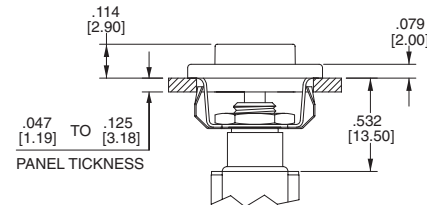
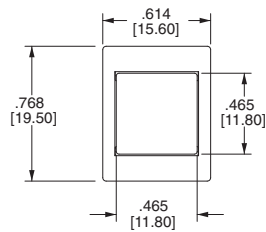
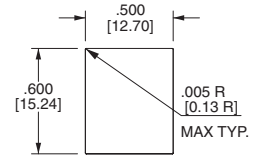
AP1

PANEL MOUNTING

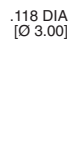
AP2

PANEL MOUNTING

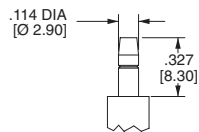
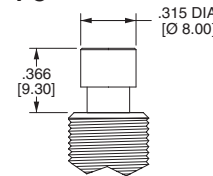
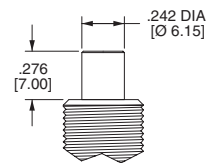
PLUNGER

PA,PI

| OPTION CODE | DIM. "A" |
|-------------|-------------|
| PA | .299 [7.60] |
| PI | .244 [6.20] |

PL

PC

PD

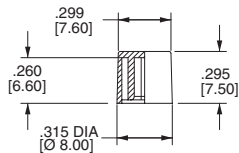
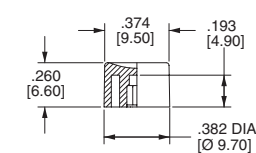
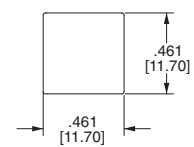
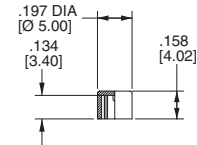
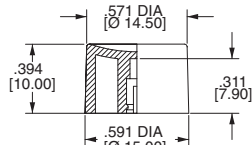
PC, PD Plunger must fit with BD bushing

CAP

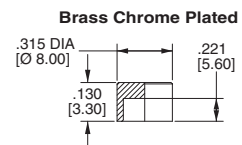
C1

C2

C3

C4

C5

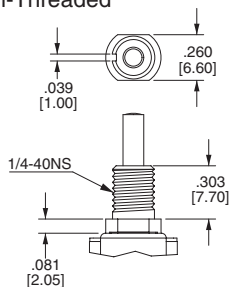
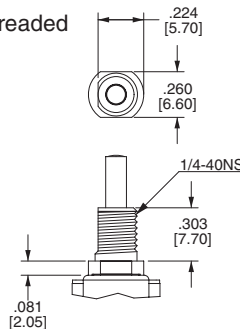
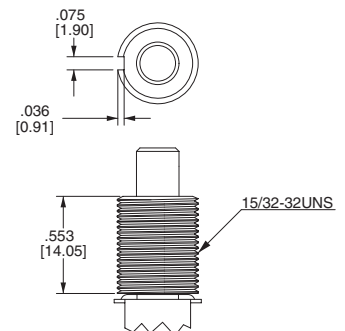
For PL Bushing Only

C6

For PD Bushing Only

BUSHING

**B10 Threaded
B20 Non-Threaded**

B21 Non-Threaded

BD

3MA-Series Dimensional Specifications: in. [mm]

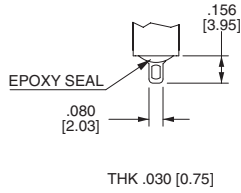
TERMINATION

M1



M2

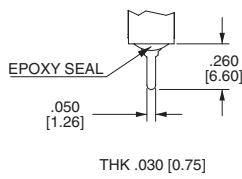

M5

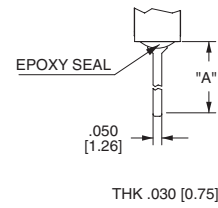

| OPTION CODE | DIM. "A" |
|-------------|---------------|
| M5-1 | .750 [19.05] |
| M5-2 | .964 [24.48] |
| M5-3 | .425 [10.80] |
| M5-4 | 1.062 [26.97] |

SINGLE POLE

DOUBLE POLE

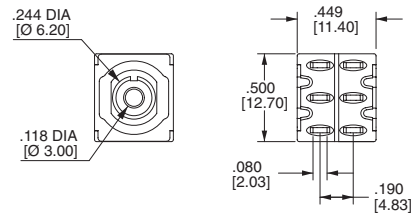
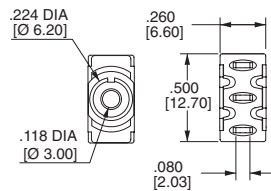
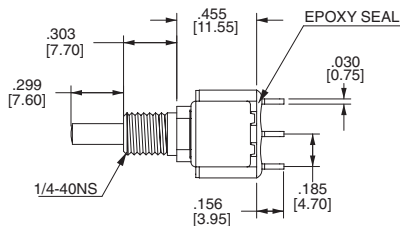

3 POLE

4 POLE

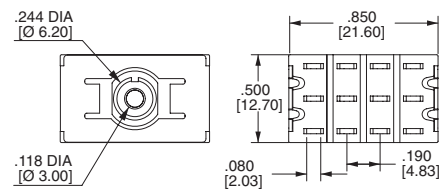
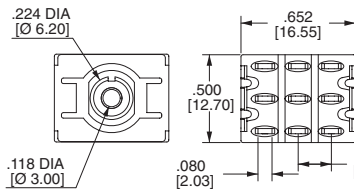
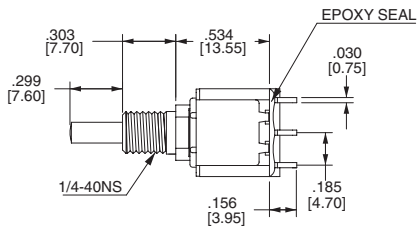

M6

SINGLE POLE

PC MOUNTING

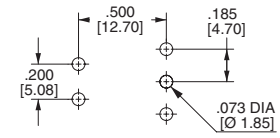
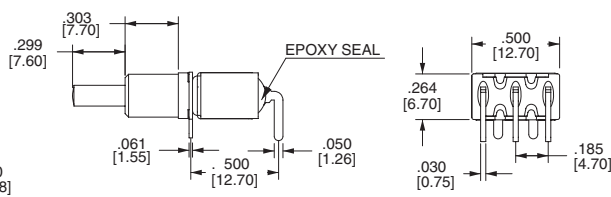
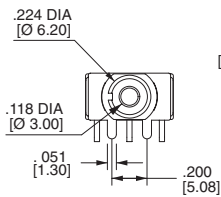

DOUBLE POLE

PC MOUNTING

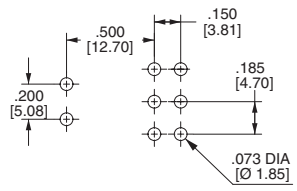
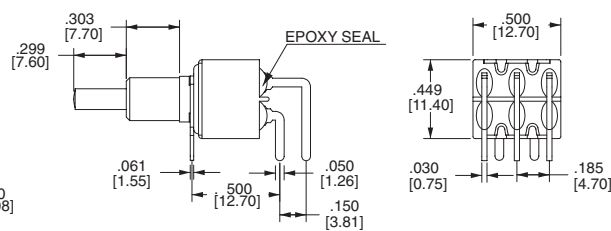
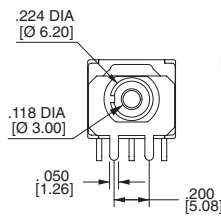

3MA-Series Dimensional Specifications: in. [mm]

TERMINATION

M7

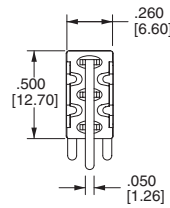
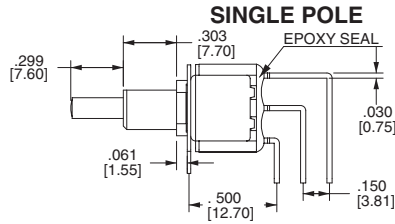
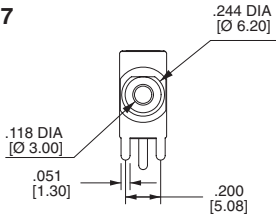

PC MOUNTING

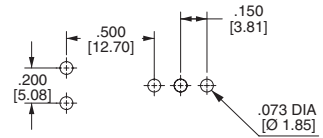

DOUBLE POLE

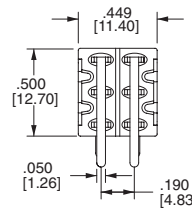
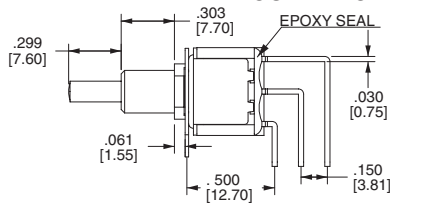
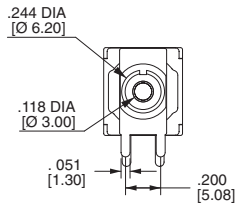

PC MOUNTING

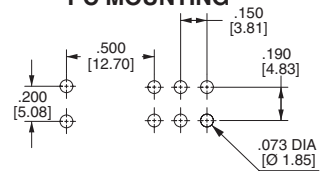

THREE POLE

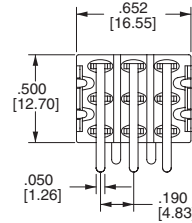
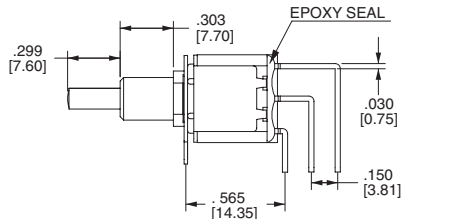
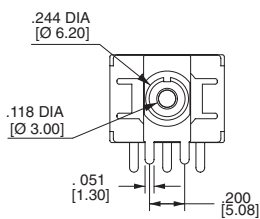

PC MOUNTING

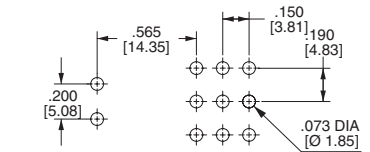

FOUR POLE

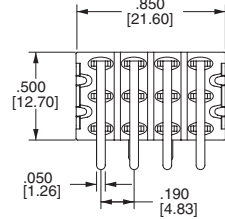
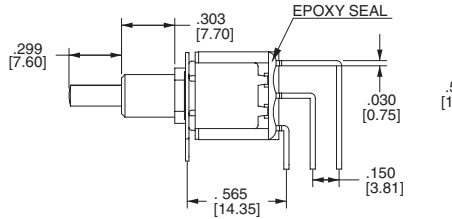
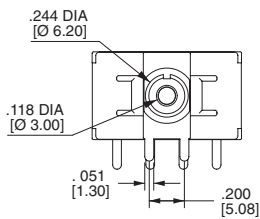

PC MOUNTING

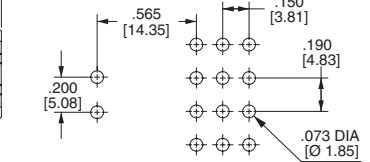

VS2-VS3

| OPTION CODE | DIM. "A" |
|-------------|--------------|
| VS2 | .460 [11.68] |
| VS3 | .630 [16.00] |

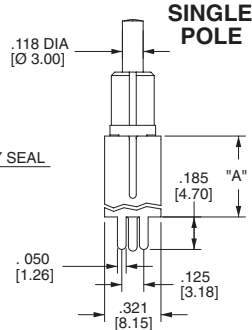
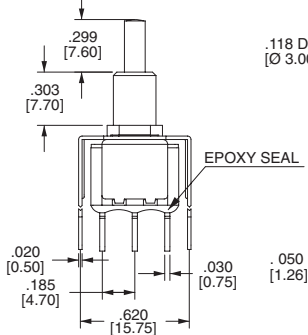

PC MOUNTING

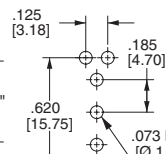

DOUBLE POLE

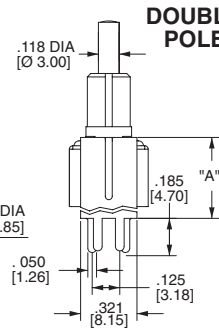

PC MOUNTING

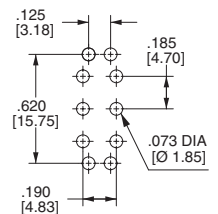

VS4-VS5

| OPTION CODE | DIM. "A" |
|-------------|--------------|
| VS4 | .460 [11.68] |
| VS5 | .630 [16.00] |

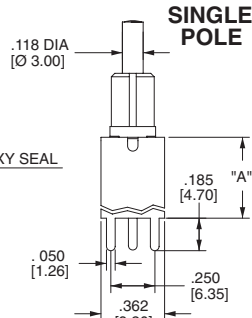
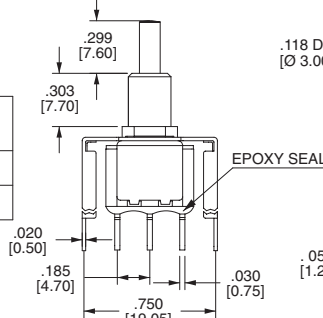

PC MOUNTING

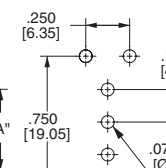

DOUBLE POLE

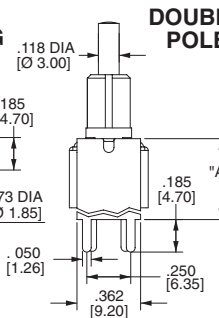

PC MOUNTING

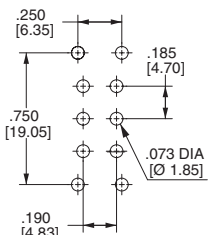

Компания «Океан Электроники» предлагает заключение долгосрочных отношений при поставках импортных электронных компонентов на взаимовыгодных условиях!

Наши преимущества:

- Поставка оригинальных импортных электронных компонентов напрямую с производств Америки, Европы и Азии, а так же с крупнейших складов мира;
- Широкая линейка поставок активных и пассивных импортных электронных компонентов (более 30 млн. наименований);
- Поставка сложных, дефицитных, либо снятых с производства позиций;
- Оперативные сроки поставки под заказ (от 5 рабочих дней);
- Экспресс доставка в любую точку России;
- Помощь Конструкторского Отдела и консультации квалифицированных инженеров;
- Техническая поддержка проекта, помощь в подборе аналогов, поставка прототипов;
- Поставка электронных компонентов под контролем ВП;
- Система менеджмента качества сертифицирована по Международному стандарту ISO 9001;
- При необходимости вся продукция военного и аэрокосмического назначения проходит испытания и сертификацию в лаборатории (по согласованию с заказчиком);
- Поставка специализированных компонентов военного и аэрокосмического уровня качества (Xilinx, Altera, Analog Devices, Intersil, Interpoint, Microsemi, Actel, Aeroflex, Peregrine, VPT, Syfer, Eurofarad, Texas Instruments, MS Kennedy, Miteq, Cobham, E2V, MA-COM, Hittite, Mini-Circuits, General Dynamics и др.);

Компания «Океан Электроники» является официальным дистрибьютором и эксклюзивным представителем в России одного из крупнейших производителей разъемов военного и аэрокосмического назначения «JONHON», а так же официальным дистрибьютором и эксклюзивным представителем в России производителя высокотехнологичных и надежных решений для передачи СВЧ сигналов «FORSTAR».



JONHON

«JONHON» (основан в 1970 г.)

Разъемы специального, военного и аэрокосмического назначения:

(Применяются в военной, авиационной, аэрокосмической, морской, железнодорожной, горно- и нефтедобывающей отраслях промышленности)

«FORSTAR» (основан в 1998 г.)

ВЧ соединители, коаксиальные кабели, кабельные сборки и микроволновые компоненты:

(Применяются в телекоммуникациях гражданского и специального назначения, в средствах связи, РЛС, а так же военной, авиационной и аэрокосмической отраслях промышленности).



Телефон: 8 (812) 309-75-97 (многоканальный)

Факс: 8 (812) 320-03-32

Электронная почта: ocean@oceanchips.ru

Web: <http://oceanchips.ru/>

Адрес: 198099, г. Санкт-Петербург, ул. Калинина, д. 2, корп. 4, лит. А