

## COMBICON compact Screw Compact Terminal Blocks PT(A) 1,5/... with a 3.5 mm Pitch

---

The terminal blocks of the new PT series have the proven screw connection and highly flexible conductor protection. The practical and compact outer dimensions and the generous clamping space make them particularly versatile.

With the 3.5 mm pitch, the PT 1,5 is not only available as a PCB terminal block but also as plug-in version. The plugs of the PT 1,5 family can be plugged on the PST 1,0-3,5 pin strip which is also available and reflow-solderable.

The PT 1,5-PH-3,5 can only be plugged in horizontally, but its extremely compact dimensions permit the use of a plug-in solution, even under conditions in which space is critical.

In contrast, the two integrated plug-in directions of the PT 1,5-PVH-3,5 offer maximum flexibility for the end user and reduce inventory and handling by 50 %. In addition, this plug type can also be coded if desired. Customized labeling of all versions is possible.

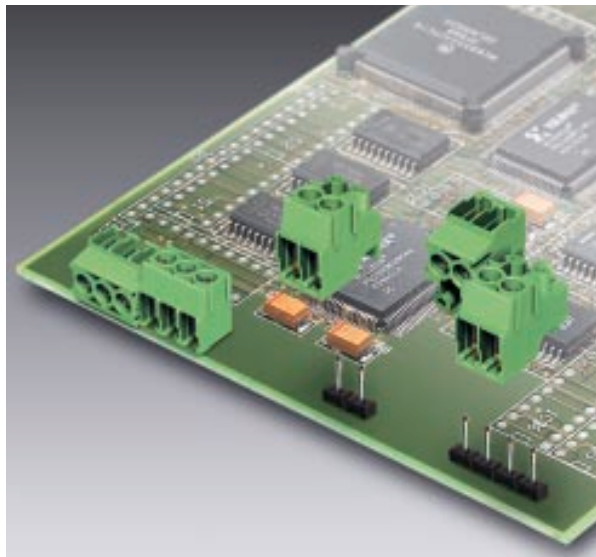

### COMBICON Select

The COMBICON search engine with CAD downloading



COMBICON Select – the printed circuit board connection software supports your workflow from the PCB and housing layout to the ordering process with:

- Systematic and fast selection of products
- Universal Internet aided engineering with extensive CAD downloading
- Easy-to-use e-shopping functions.

<http://select.phoenixcontact.com>

**Printed Circuit  
Screw Termination Blocks  
PT 1,5/...-3,5-H  
3.5 mm Pitch**

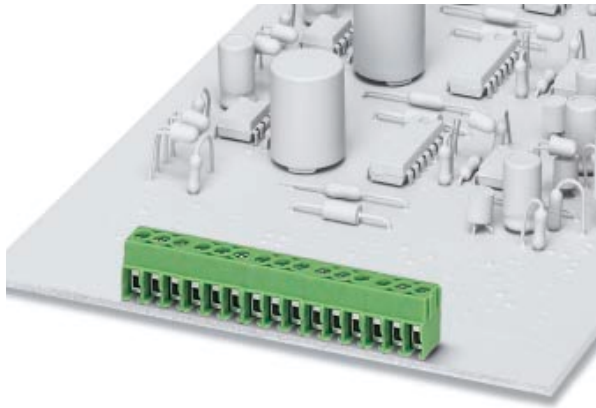

Description	No. of pos.	Dim. a [mm]	Type	Order No.	Pcs./Pkt.
<b>Printed circuit screw termination blocks with housing interlocking, 3.5 mm pitch, color: green</b>	2	3.5	PT 1,5/2-3,5-H	19 84 61 7	250
	3	7	PT 1,5/3-3,5-H	19 84 62 0	250
	4	10.5	PT 1,5/4-3,5-H	19 84 63 3	250
	5	14	PT 1,5/5-3,5-H	19 84 64 6	100
	6	17.5	PT 1,5/6-3,5-H	19 84 65 9	100
	7	21	PT 1,5/7-3,5-H	19 84 66 2	100
	8	24.5	PT 1,5/8-3,5-H	19 84 67 5	100
	9	28	PT 1,5/9-3,5-H	19 84 68 8	100
	10	31.5	PT 1,5/10-3,5-H	19 84 69 1	100
	11	35	PT 1,5/11-3,5-H	19 84 70 1	50
	12	38.5	PT 1,5/12-3,5-H	19 84 71 4	50
	13	42	PT 1,5/13-3,5-H	19 84 72 7	50
	14	45.5	PT 1,5/14-3,5-H	19 84 73 0	50
	15	49	PT 1,5/15-3,5-H	19 84 74 3	50
	16	52.5	PT 1,5/16-3,5-H	19 84 75 6	50

(1) Screwdriver



<b>SZS 0,4 x 2,5</b>	<b>12 05 03 7</b>	10
----------------------	-------------------	----

**Technical data**

<b>Dimensions</b>	see description		
Pitch	[mm]	3.5	
Hole diameter	[mm]	1.2	
Pin dimensions	[mm]x[mm]	∅ 0.9	
<b>Technical data in accordance with IEC/ DIN VDE</b>			
Insulating material group	-	I	
Surge voltage category / contamination class	-/-	III / 3	III / 2
Rated voltage	[V]	160	200
Rated surge voltage	[kV]	2.5	2.5
Nominal current / cross section	[A]/[mm²]	17.5 / 1.5	
Maximum load current / cross section	[A]/[mm²]	17.5 / 1.5	
<b>Connection capacity</b>			
Solid / stranded / conductor sizes	[mm²]/[mm²]/AWG	0.2 - 1.5 / 0.2 - 1.5 / 26 - 16	
Stranded with ferrule without / with plastic sleeve	[mm²]	- / 0.75 <sup>1)</sup>	
<b>Multiple connection (2 conductors with same cross section)</b>			
Solid / stranded	[mm²]	0.2 - 0.34 / 0.2 - 0.5	
Stranded with ferrule without plastic sleeve	[mm²]	-	
Stranded with TWIN ferrule with plastic sleeve	[mm²]	-	
<b>Stripping length</b>	[mm]	5	
<b>Internal cylindrical gauge (IEC 60 947-1)</b>		-	
<b>Thread</b>		M 2	
<b>Torque</b>	[Nm]	0.25	
<b>Insulating material</b>		PA	
Inflammability class in acc. with UL 94		V0	
<b>Approval data (UL/CUL and CSA)</b>			
Nominal voltage / current / conductor sizes	UL/CUL: [V]/[A]/AWG CSA: [V]/[A]/AWG	300 / 10 / 26 - 16	

<sup>1)</sup> When using ferrules with a plastic sleeve, 125 V max. can be achieved in connection with surge voltage category / contamination class II/2.

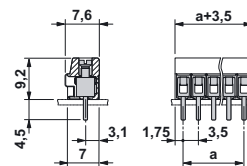
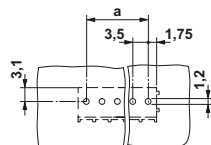

**Printed Circuit  
Screw Termination Blocks  
PT 1,5/...-3,5-V  
3.5 mm Pitch**

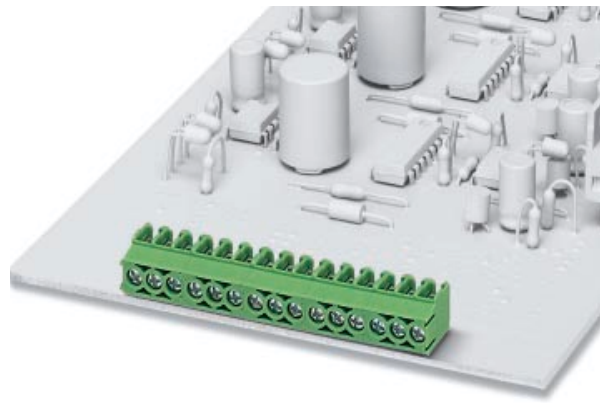

Description	No. of pos.	Dim. a [mm]	Type	Order No.	Pcs./Pkt.
<b>Printed circuit screw termination blocks with housing interlocking, 3.5 mm pitch, color: green</b>	2	3.5	PT 1,5/2-3,5-V	19 84 76 9	250
	3	7	PT 1,5/3-3,5-V	19 84 77 2	250
	4	10.5	PT 1,5/4-3,5-V	19 84 78 5	250
	5	14	PT 1,5/5-3,5-V	19 84 79 8	100
	6	17.5	PT 1,5/6-3,5-V	19 84 80 8	100
	7	21	PT 1,5/7-3,5-V	19 84 81 1	100
	8	24.5	PT 1,5/8-3,5-V	19 84 82 4	100
	9	28	PT 1,5/9-3,5-V	19 84 83 7	100
	10	31.5	PT 1,5/10-3,5-V	19 84 84 0	100
	11	35	PT 1,5/11-3,5-V	19 84 85 3	50
	12	38.5	PT 1,5/12-3,5-V	19 84 86 6	50
	13	42	PT 1,5/13-3,5-V	19 84 87 9	50
	14	45.5	PT 1,5/14-3,5-V	19 84 88 2	50
	15	49	PT 1,5/15-3,5-V	19 84 89 5	50
	16	52.5	PT 1,5/16-3,5-V	19 84 90 5	50

(1) Screwdriver



<b>SZS 0,4 x 2,5</b>	<b>12 05 03 7</b>	10
----------------------	-------------------	----

**Technical data**

<b>Dimensions</b>	
Pitch	[mm]
Hole diameter	[mm]
Pin dimensions	[mm]x[mm]

see description

3.5  
1.2  
∅ 0.9

**Technical data in accordance with IEC/ DIN VDE**

Insulating material group	-
Surge voltage category / contamination class	-/-
Rated voltage	[V]
Rated surge voltage	[kV]
Nominal current / cross section	[A]/[mm <sup>2</sup> ]
Maximum load current / cross section	[A]/[mm <sup>2</sup> ]

	I	II / 2
III / 3	III / 2	II / 2
160	200	400
2.5	2.5	2.5
	17.5 / 1.5	
	17.5 / 1.5	

**Connection capacity**

Solid / stranded / conductor sizes	[mm <sup>2</sup> ]/[mm <sup>2</sup> ]/AWG
Stranded with ferrule without / with plastic sleeve	[mm <sup>2</sup> ]

0.2 - 1.5 / 0.2 - 1.5 / 26 - 16  
- / 0.75<sup>1)</sup>

**Multiple connection (2 conductors with same cross section)**

Solid / stranded	[mm <sup>2</sup> ]
Stranded with ferrule without plastic sleeve	[mm <sup>2</sup> ]
Stranded with TWIN ferrule with plastic sleeve	[mm <sup>2</sup> ]

0.2 - 0.34 / 0.2 - 0.5

**Stripping length** [mm]

5

**Internal cylindrical gauge (IEC 60 947-1)**

-

**Thread**

M 2

**Torque** [Nm]

0.25

**Insulating material**

Inflammability class in acc. with UL 94

PA

**Approval data (UL/CUL and CSA)**

Nominal voltage / current / conductor sizes  
UL/CUL: [V]/[A]/AWG  
CSA: [V]/[A]/AWG

300 / 10 / 26 - 16

<sup>1)</sup> When using ferrules with a plastic sleeve, 125 V max. can be achieved in connection with surge voltage category / contamination class II/2.

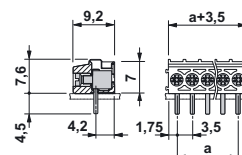
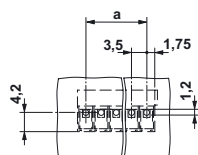

**Printed Circuit  
Screw Termination Blocks  
PTA 1,5/...-3,5  
3.5 mm Pitch**

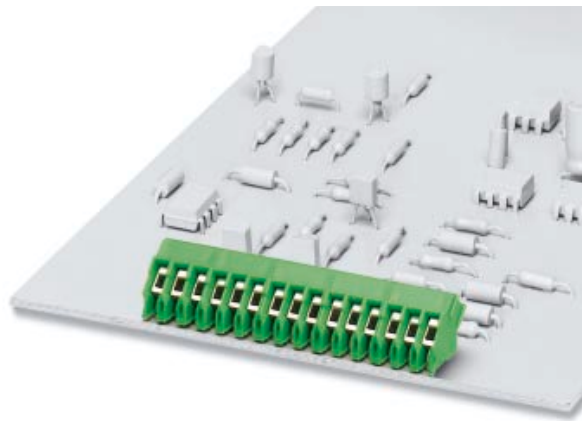

Description	No. of pos.	Dim. a [mm]	Type	Order No.	Pcs./Pkt.
<b>Printed circuit screw termination blocks with housing interlocking, 3.5 mm pitch, color: green</b>	2	3.5	PTA 1,5/2-3,5	19 88 95 6	250
	3	7	PTA 1,5/3-3,5	19 88 96 9	250
	4	10.5	PTA 1,5/4-3,5	19 88 97 2	250
	5	14	PTA 1,5/5-3,5	19 88 98 5	100
	6	17.5	PTA 1,5/6-3,5	19 88 99 8	100
	7	21	PTA 1,5/7-3,5	19 89 00 7	100
	8	24.5	PTA 1,5/8-3,5	19 89 01 0	100
	9	28	PTA 1,5/9-3,5	19 89 02 3	100
	10	31.5	PTA 1,5/10-3,5	19 89 03 6	100
	11	35	PTA 1,5/11-3,5	19 89 04 9	50
	12	38.5	PTA 1,5/12-3,5	19 89 05 2	50
	13	42	PTA 1,5/13-3,5	19 89 06 5	50
	14	45.5	PTA 1,5/14-3,5	19 89 07 8	50
	15	49	PTA 1,5/15-3,5	19 89 08 1	50
	16	52.5	PTA 1,5/16-3,5	19 89 09 4	50
	<b>(1) Screwdriver</b>			<b>SZS 0,4 x 2,5</b>	<b>12 05 03 7</b>

Technical data	
Dimensions	
Pitch	[mm] 3.5
Hole diameter	[mm] 1.2
Pin dimensions	[mm]x[mm] Ø 0.9
<b>Technical data in accordance with IEC/ DIN VDE</b>	
Insulating material group	-
Surge voltage category / contamination class	-/- III / 3 III / 2 II / 2
Rated voltage	[V] 160 200 400
Rated surge voltage	[kV] 2.5 2.5 2.5
Nominal current / cross section	[A]/[mm²] 17.5 / 1.5
Maximum load current / cross section	[A]/[mm²] 17.5 / 1.5
<b>Connection capacity</b>	
Solid / stranded / conductor sizes	[mm²]/[mm²]/AWG 0.2 - 1.5 / 0.2 - 1.5 / 26 - 16
Stranded with ferrule without / with plastic sleeve	[mm²] - / (0.75 <sup>1)</sup> )
<b>Multiple connection (2 conductors with same cross section)</b>	
Solid / stranded	[mm²] 0.2 - 0.34 / 0.2 - 0.5
Stranded with ferrule without plastic sleeve	[mm²] -
Stranded with TWIN ferrule with plastic sleeve	[mm²] -
<b>Stripping length</b>	[mm] 5
<b>Internal cylindrical gauge (IEC 60 947-1)</b>	-
<b>Thread</b>	- M 2
<b>Torque</b>	[Nm] 0.25
<b>Insulating material</b>	PA
Inflammability class in acc. with UL 94	V0
<b>Approval data (UL/CUL and CSA)</b>	
Nominal voltage / current / conductor sizes	UL/CUL: [V]/[A]/AWG CSA: [V]/[A]/AWG

<sup>1)</sup> When using ferrules with a plastic sleeve, 125 V max. can be achieved in connection with surge voltage category / contamination class II/2.

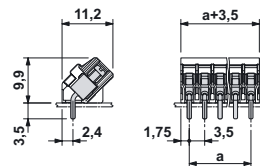
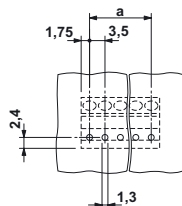

# Pluggable Screw Termination Blocks

## PT 1,5/...-PVH-3,5

### 3.5 mm Pitch

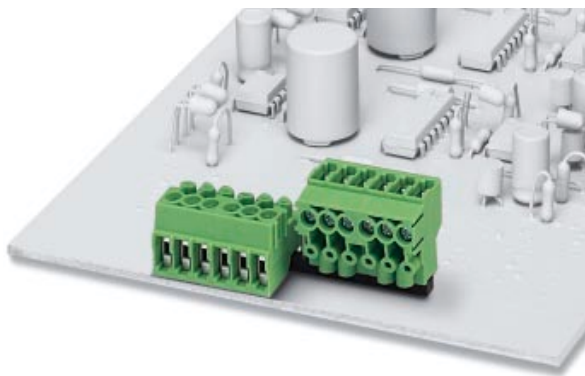

Description	No. of pos.	Dim. a [mm]	Type	Order No.	Pcs./Pkt.
<b>Printed circuit screw termination blocks with housing interlocking, 3.5 mm pitch, color: green</b>	2	3.5	PT 1,5/2-PVH-3,5	19 84 01 5	250
	3	7	PT 1,5/3-PVH-3,5	19 84 02 8	250
	4	10.5	PT 1,5/4-PVH-3,5	19 84 03 1	250
	5	14	PT 1,5/5-PVH-3,5	19 84 04 4	100
	6	17.5	PT 1,5/6-PVH-3,5	19 84 05 7	100
	7	21	PT 1,5/7-PVH-3,5	19 84 06 0	100
	8	24.5	PT 1,5/8-PVH-3,5	19 84 07 3	100
	9	28	PT 1,5/9-PVH-3,5	19 84 08 6	100
	10	31.5	PT 1,5/10-PVH-3,5	19 84 09 9	100
	11	35	PT 1,5/11-PVH-3,5	19 84 10 9	50
	12	38.5	PT 1,5/12-PVH-3,5	19 84 11 2	50
	13	42	PT 1,5/13-PVH-3,5	19 84 12 5	50
	14	45.5	PT 1,5/14-PVH-3,5	19 84 13 8	50
	15	49	PT 1,5/15-PVH-3,5	19 84 14 1	50
	16	52.5	PT 1,5/16-PVH-3,5	19 84 15 4	50

(1) **Coding profile**, is inserted into the hole on the plug, insulating material: red

(2) **Screwdriver**



#### Technical data

Dimensions	
Pitch	[mm]
Hole diameter	[mm]
Pin dimensions	[mm]x[mm]

#### Technical data in accordance with IEC/ DIN VDE

Insulating material group	-
Surge voltage category / contamination class	-/-
Rated voltage	[V]
Rated surge voltage	[kV]
Nominal current / cross section	[A]/[mm²]
Maximum load current / cross section	[A]/[mm²]

#### Connection capacity

Solid / stranded / conductor sizes	[mm²]/[mm²]/AWG
Stranded with ferrule without / with plastic sleeve	[mm²]

#### Multiple connection (2 conductors with same cross section)

Solid / stranded	[mm²]
Stranded with ferrule without plastic sleeve	[mm²]
Stranded with TWIN ferrule with plastic sleeve	[mm²]

#### Stripping length

Internal cylindrical gauge (IEC 60 947-1)	-
Thread	-
Torque	[Nm]

#### Insulating material

Inflammability class in acc. with UL 94

#### Approval data (UL/CUL and CSA)

Nominal voltage / current / conductor sizes	UL/CUL: [V]/[A]/AWG CSA: [V]/[A]/AWG
---	---

Type	Order No.	Pcs./Pkt.
CP-PT 1,5	19 85 56 4	100
SZS 0,4 x 2,5	12 05 03 7	10

see description

3.5

dependent on the pin strip used  
dependent on the pin strip used

	I	II / 2	III / 3
Rated voltage	200	400	160
Rated surge voltage	2.5	2.5	2.5
Nominal current / cross section	8 / 1.5	8 / 1.5	8 / 1.5
Maximum load current / cross section	8 / 1.5	8 / 1.5	8 / 1.5
Stripping length	0.2 - 1.5 / 0.2 - 1.5 / 26 - 16 - / (0.75')		
Multiple connection (2 conductors with same cross section)	0.2 - 0.34 / 0.2 - 0.5		
Stranded with ferrule without plastic sleeve	-		
Stranded with TWIN ferrule with plastic sleeve	-		
Stripping length	5		
Internal cylindrical gauge (IEC 60 947-1)	-		
Thread	M 2		
Torque	0.25		
Insulating material	PA		
Inflammability class in acc. with UL 94	V0		
Approval data (UL/CUL and CSA)	300 / 10 / 26 - 16		

\*) When using ferrules with a plastic sleeve, 125 V max. can be achieved in connection with surge voltage category / contamination class II/2.

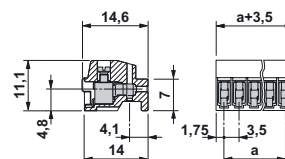

# Pluggable Screw Termination Blocks PT 1,5/...-PH-3,5 3.5 mm Pitch

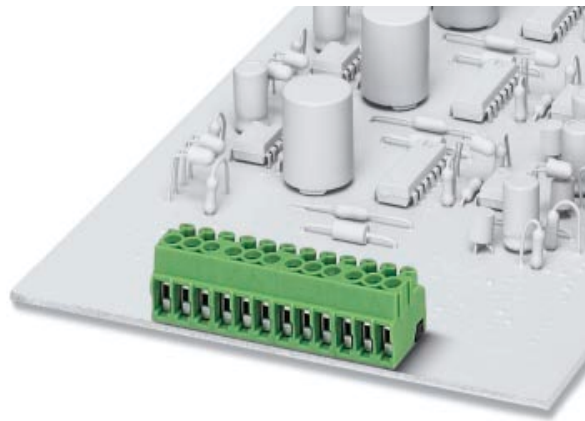

Description	No. of pos.	Dim. a [mm]	Type	Order No.	Pcs./Pkt.
<b>Pluggable screw termination blocks with housing interlocking, 3.5 mm pitch, color: green</b>					
	2	3.5	PT 1,5/2-PH-3,5	19 84 31 6	250
	3	7	PT 1,5/3-PH-3,5	19 84 32 9	250
	4	10.5	PT 1,5/4-PH-3,5	19 84 33 2	250
	5	14	PT 1,5/5-PH-3,5	19 84 34 5	100
	6	17.5	PT 1,5/6-PH-3,5	19 84 35 8	100
	7	21	PT 1,5/7-PH-3,5	19 84 36 1	100
	8	24.5	PT 1,5/8-PH-3,5	19 84 37 4	100
	9	28	PT 1,5/9-PH-3,5	19 84 38 7	100
	10	31.5	PT 1,5/10-PH-3,5	19 84 39 0	100
	11	35	PT 1,5/11-PH-3,5	19 84 40 0	50
	12	38.5	PT 1,5/12-PH-3,5	19 84 41 3	50
	13	42	PT 1,5/13-PH-3,5	19 84 42 6	50
	14	45.5	PT 1,5/14-PH-3,5	19 84 43 9	50
	15	49	PT 1,5/15-PH-3,5	19 84 44 2	50
	16	52.5	PT 1,5/16-PH-3,5	19 84 45 5	50
<b>(1) Screwdriver</b>				<b>SZS 0,4 x 2,5</b>	<b>12 05 03 7</b>
<b>Technical data</b>			see description		
Dimensions			3.5		
Pitch			dependent on the pin strip used		
Hole diameter			dependent on the pin strip used		
Pin dimensions			dependent on the pin strip used		
<b>Technical data in accordance with IEC/ DIN VDE</b>					
Insulating material group			I		
Surge voltage category / contamination class			III / 3 III / 2 II / 2		
Rated voltage			160 200 400		
Rated surge voltage			2.5 2.5 2.5		
Nominal current / cross section			8 / 1.5		
Maximum load current / cross section			8 / 1.5		
<b>Connection capacity</b>					
Solid / stranded / conductor sizes			0.2 - 1.5 / 0.2 - 1.5 / 26 - 16		
Stranded with ferrule without / with plastic sleeve			- / 0.75 <sup>1)</sup>		
<b>Multiple connection (2 conductors with same cross section)</b>					
Solid / stranded			0.2 - 0.34 / 0.2 - 0.5		
Stranded with ferrule without plastic sleeve			-		
Stranded with TWIN ferrule with plastic sleeve			-		
<b>Stripping length</b>			5		
<b>Internal cylindrical gauge (IEC 60 947-1)</b>			-		
<b>Thread</b>			M 2		
<b>Torque</b>			0.25		
<b>Insulating material</b>			PA		
Inflammability class in acc. with UL 94			V0		
<b>Approval data (UL/CUL and CSA)</b>					
Nominal voltage / current / conductor sizes			300 / 10 / 26 - 16		
UL/CUL: [V]/[A]/AWG			-		
CSA: [V]/[A]/AWG			-		

<sup>1)</sup> When using ferrules with a plastic sleeve, 125 V max. can be achieved in connection with surge voltage category / contamination class II/2.

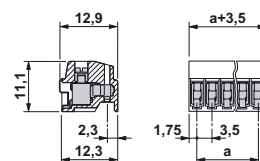

# Pin Strips

## PST 1,0/...-3,5

### 3.5 mm Pitch

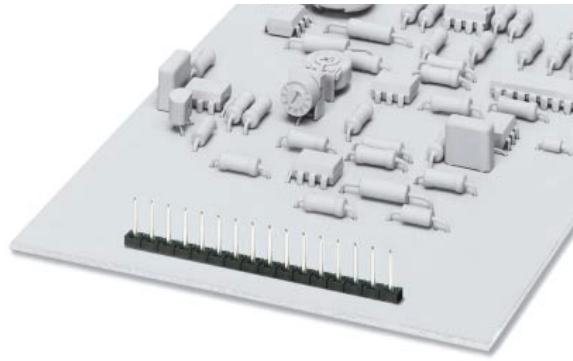

Description	No. of pos.	Dim. a [mm]	Type	Order No.	Pcs./Pkt.
<b>Pin strip, 3.5 mm pitch, color: black</b>					
	2	3.5	PST 1,0/2-3,5	19 45 09 6	50 <sup>1)</sup>
	3	7	PST 1,0/3-3,5	19 45 10 6	
	4	10.5	PST 1,0/4-3,5	19 45 11 9	
	5	14	PST 1,0/5-3,5	19 45 12 2	
	6	17.5	PST 1,0/6-3,5	19 45 13 5	
	7	21	PST 1,0/7-3,5	19 45 14 8	
	8	24.5	PST 1,0/8-3,5	19 45 15 1	
	9	28	PST 1,0/9-3,5	19 45 16 4	
	10	31.5	PST 1,0/10-3,5	19 45 17 7	
	11	35	PST 1,0/11-3,5	19 45 18 0	
	12	38.5	PST 1,0/12-3,5	19 45 19 3	
	13	42	PST 1,0/13-3,5	19 45 20 3	
	14	45.5	PST 1,0/14-3,5	19 45 21 6	
	15	49	PST 1,0/15-3,5	19 45 22 9	
	16	52.5	PST 1,0/16-3,5	19 45 23 2	

#### Technical data

Dimensions		see description		
Pitch	[mm]	3.5		
Hole diameter	[mm]	1.2		
Pin dimensions	[mm]x[mm]	∅ 1		
<b>Technical data in accordance with IEC/ DIN VDE</b>				
Insulating material group	-	III / 3	IIIa	II / 2
Surge voltage category / contamination class	-/-	160	250	250
Rated voltage	[V]	2.5	2.5	2.5
Rated surge voltage	[kV]			
Nominal current / cross section	[A]/[mm <sup>2</sup> ]		8 <sup>2)</sup>	
Maximum load current / cross section	[A]/[mm <sup>2</sup> ]		8 <sup>2)</sup>	
<b>Insulating material</b>				
Inflammability class in acc. with UL 94		PA		
<b>Approval data (UL/CUL and CSA)</b>				
Nominal voltage / current / conductor sizes	UL/CUL: [V]/[A]/AWG CSA: [V]/[A]/AWG	300 / 10 / --		
		--		

<sup>1)</sup> Larger packing units are available on request.

<sup>2)</sup> The maximum current depends on the plug used. The lower value of the two for plug and pin strip is the deciding factor.

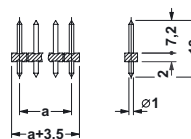
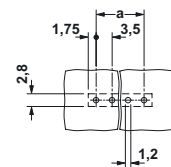

Компания «Океан Электроники» предлагает заключение долгосрочных отношений при поставках импортных электронных компонентов на взаимовыгодных условиях!

Наши преимущества:

- Поставка оригинальных импортных электронных компонентов напрямую с производств Америки, Европы и Азии, а так же с крупнейших складов мира;
- Широкая линейка поставок активных и пассивных импортных электронных компонентов (более 30 млн. наименований);
- Поставка сложных, дефицитных, либо снятых с производства позиций;
- Оперативные сроки поставки под заказ (от 5 рабочих дней);
- Экспресс доставка в любую точку России;
- Помощь Конструкторского Отдела и консультации квалифицированных инженеров;
- Техническая поддержка проекта, помощь в подборе аналогов, поставка прототипов;
- Поставка электронных компонентов под контролем ВП;
- Система менеджмента качества сертифицирована по Международному стандарту ISO 9001;
- При необходимости вся продукция военного и аэрокосмического назначения проходит испытания и сертификацию в лаборатории (по согласованию с заказчиком);
- Поставка специализированных компонентов военного и аэрокосмического уровня качества (Xilinx, Altera, Analog Devices, Intersil, Interpoint, Microsemi, Actel, Aeroflex, Peregrine, VPT, Syfer, Eurofarad, Texas Instruments, MS Kennedy, Miteq, Cobham, E2V, MA-COM, Hittite, Mini-Circuits, General Dynamics и др.);

Компания «Океан Электроники» является официальным дистрибьютором и эксклюзивным представителем в России одного из крупнейших производителей разъемов военного и аэрокосмического назначения «JONHON», а так же официальным дистрибьютором и эксклюзивным представителем в России производителя высокотехнологичных и надежных решений для передачи СВЧ сигналов «FORSTAR».



## JONHON

«JONHON» (основан в 1970 г.)

Разъемы специального, военного и аэрокосмического назначения:

(Применяются в военной, авиационной, аэрокосмической, морской, железнодорожной, горно- и нефтедобывающей отраслях промышленности)

«FORSTAR» (основан в 1998 г.)

ВЧ соединители, коаксиальные кабели,  
кабельные сборки и микроволновые компоненты:

(Применяются в телекоммуникациях гражданского и специального назначения, в средствах связи, РЛС, а так же военной, авиационной и аэрокосмической отраслях промышленности).



Телефон: 8 (812) 309-75-97 (многоканальный)

Факс: 8 (812) 320-03-32

Электронная почта: [ocean@oceanchips.ru](mailto:ocean@oceanchips.ru)

Web: <http://oceanchips.ru/>

Адрес: 198099, г. Санкт-Петербург, ул. Калинина, д. 2, корп. 4, лит. А