

TYPICAL INDICATOR ORDERING EXAMPLE

KB **02** **K** **W01** — **12** — **FF**

Shapes

| Bushing Mounting | |
|------------------|-------------|
| 01 | Square |
| 02 | Round |
| 03 | Rectangular |
| Snap-in Mounting | |
| 04 | Square |
| 05 | Round |
| 06 | Rectangular |

| Housing | |
|---------|------------|
| K | Black only |

| Terminals | |
|-----------|--------------------|
| W01 | Silver Solder Lug* |

* Wire harness & cable assemblies offered only in Americas

Lamps

| Incandescent Lamp Used with Solid Cap | |
|---------------------------------------|---------|
| 05 | 5-volt |
| 12 | 12-volt |

| Incandescent or Neon Lamp Used with Insert Cap | |
|--|---------------|
| 05 | 5-volt |
| 12 | 12-volt |
| 01 | 110-volt Neon |

Bright LED Used with Cap for LED

| Colors | Resistor | |
|----------|----------|-------------|
| 5C Red | No Code | No Resistor |
| 5D Amber | 05 | 5-volt |
| | 12 | 12-volt |
| 5F Green | 24 | 24-volt |

Super Bright LED Used with Cap for LED

| | |
|----|-------|
| 6B | White |
| 6F | Green |
| 6G | Blue |

Cap Types & Colors

| Solid Cap: Lens/Filter Colors | | | |
|-------------------------------|--------------|----|-------------|
| BB | White/White | FB | Green/White |
| CB | Red/White | FF | Green/Green |
| CC | Red/Red | GB | Blue/White |
| EB | Yellow/White | GG | Blue/Blue |

| Insert Cap: Lens/Filter Colors | |
|--------------------------------|--------------|
| JB | Clear/White |
| JC | Clear/Red |
| JE | Clear/Yellow |
| *JF | Clear/Green |
| *JG | Clear/Blue |

* JF & JG not suitable with neon.

LED Cap: Lens/Diffuser Colors

| | |
|----|--|
| AB | Square Spot Illuminated Black Cap/White Window |
| JB | Clear/White |
| JC | Clear/Red |
| JD | Clear/Amber |
| JF | Clear/Green |

LED Cap: Lens/Diffuser Colors

| | |
|----|-------------|
| JB | Clear/White |
|----|-------------|

DESCRIPTION FOR TYPICAL ORDERING EXAMPLE

KB02KW01-12-FF



12-volt Incandescent Lamp Solid Cap with Green Lens and Green Filter

Black Housing Round with Bushing Mounting

Silver Solder Lug Terminals

SHAPES & MOUNTING TYPES

Bushing Mounting

01 .551" (14mm)
Square

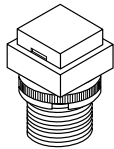

02 .551" (14mm)
Round

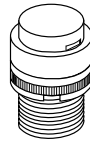

03 .551" x .728" (14mm x 18.5mm)
Rectangular



Snap-in Mounting

04 .551" (14mm)
Square

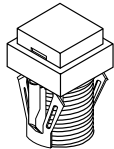

05 .551" (14mm)
Round



06 .551" x .728" (14mm x 18.5mm)
Rectangular



The bezel is an integral part of the indicator body.

Bushing Mounting

Without
Keyway



Panel Thickness:
.020" ~ .315"
(0.5 ~ 8mm)



With
Keyway

Snap-in Mounting

Panel Thickness:
.039" ~ .138"
(1.0 ~ 3.5mm)



TERMINALS

W01

Silver Solder Lug





LAMP COLORS & SPECIFICATIONS

The electrical specifications shown are determined at a basic temperature of 25°C.
If the source voltage exceeds the rated voltage, a ballast resistor is required.
The ballast resistor calculation and more lamp detail are shown in the Supplement section.

Incandescent & Neon Lamps

| AT611 Incandescent | AT615 Neon | | 05 | 12 | 01 | Recommended Resistors for Neon: 33K ohms for 110V AC; 100K ohms for 220V AC | |
|---|---|-----------|-----------|---------------|-----------|--|---------|
|  |  | Voltage | V | 5V AC | 12V AC | | 110V AC |
| | | Current | I | 115mA | 60mA | | 1.5mA |
| | | Endurance | Hours | 7,000 average | | | 10,000 |

Bright LED without Resistor

| AT635 | Red | Amber | Green | No Code No Resistor | | |
|---|-----------|-----------|--------------|----------------------------|-----------|-----------|
| | 5C | 5D | 5F | Red | Amber | Green |
| LEDs are colored in OFF state. | | | | | | |
|  | | | | | | |
|  | | | | | | |
| T-1 1/2 Bi-pin | | | | | | |
| Color Codes | 5C | 5D | 5F | | | |
| Forward Peak Current | | | I_{FM} | 30mA | 30mA | 30mA |
| Continuous Forward Current | | | I_F | 20mA | 20mA | 20mA |
| Forward Voltage | | | V_F | 1.9V | 2.0V | 2.1V |
| Reverse Peak Voltage | | | V_{RM} | 5V | 5V | 5V |
| Current Reduction Rate Above 25°C | | | ΔI_F | 0.42mA/°C | 0.29mA/°C | 0.42mA/°C |
| Ambient Temperature Range | | | | -25° ~ +50°C | | |

LAMP COLORS & SPECIFICATIONS

The electrical specifications shown are determined at a basic temperature of 25°C.
 If the source voltage exceeds the rated voltage, a ballast resistor is required.
 The ballast resistor calculation and more lamp detail are shown in the Supplement section.

Bright LED with Resistor

| | | | | | | | | |
|---|-----------------------------------|------------------|--------------------|--------------------|----------------|-----------|-----------|------|
| AT634 LEDs are colored in OFF state.  T-1 1/4 Bi-pin | Color Codes: | Red 5C | Amber 5D | Green 5F | Resistor Codes | | | |
| | | | | | 05 | 12 | 24 | |
| | Forward Peak Current | | | | I_{FM} | — | — | — |
| | Continuous Forward Current | | | | I_F | 25mA | 20mA | 10mA |
| | Forward Voltage | | | | V_F | 5V | 12V | 24V |
| | Reverse Peak Voltage | | | | V_{RM} | 4V | 8V | 16V |
| | Current Reduction Rate Above 25°C | | | | ΔI_F | — | — | — |
| Ambient Temperature Range | | | | | -25° ~ +50°C | | | |

AT634
5-volt
2-element
with 1 Resistor



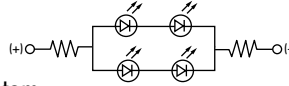

AT634
12-volt
4-element
with 2 Resistors

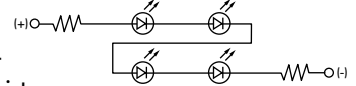

AT634
24-volt
4-element
with 2 Resistors



Super Bright Single Element LED

| | | | | | | | | |
|---|--|--|--|-----------|--------------|-----------|-----------|-----------|
| AT625G Blue AT631B White AT632F Green  T-1 Bi-pin |  | | | 6B | 6F | 6G | | |
| | Color | | | | White | Green | Blue | |
| | Forward Peak Current | | | | I_{FM} | 30mA | 30mA | 30mA |
| | Continuous Forward Current | | | | I_F | 20mA | 20mA | 20mA |
| | Forward Voltage | | | | V_F | 3.6V | 3.5V | 3.6V |
| | Reverse Peak Voltage | | | | V_{RM} | 5V | 5V | 5V |
| | Current Reduction Rate Above 25°C | | | | ΔI_F | 0.50mA/°C | 0.50mA/°C | 0.50mA/°C |
| Ambient Temperature Range | | | | | -25° ~ +50°C | | | |

CAP TYPES & COLOR COMBINATIONS

Color Codes: B White C Red E Yellow F Green G Blue J Clear

Solid Cap for Incandescent Lamp

Lens/Filter Colors Available:

- BB**
- FB**
- CB**
- FF**
- CC**
- GB**
- EB**
- GG**

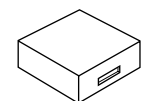
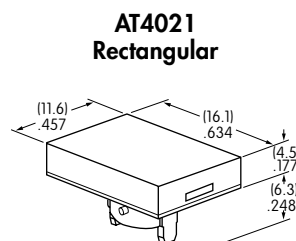
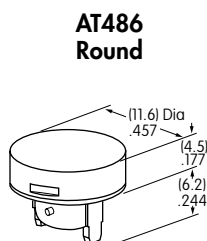
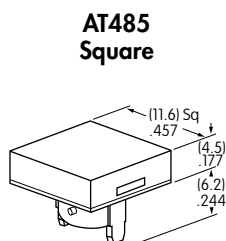

Translucent Colored Lens



Translucent Colored Filter



Lamp AT611

Material: Polycarbonate Finish: Glossy

Toggles
 Rockers
 Pushbuttons
 Illuminated PB
 Programmable
 Keylocks
 Rotaries
 Slides
 Tactiles
 Tilt
 Touch
 Accessories
 Supplement

CAP TYPES & COLOR COMBINATIONS

Color Codes: A Black B White C Red D Amber E Yellow F Green G Blue J Clear

Insert Cap for Incandescent or Neon Lamp

Lens/Filter Colors Available:

JB

AT487
Square

AT488
Round

AT4022
Rectangular



Transparent Clear Lens

JC

JE

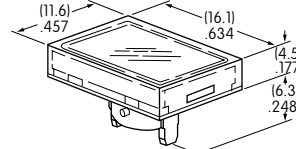

Translucent Colored Filter

JF

JG



Lamp AT611 Lamp AT615

JF and JG not suitable with neon lamp.

Material: Polycarbonate Finish: Glossy

Spot Illuminated Cap for Bright LED without Resistor or with Resistor

Cap/Window Colors Available:

AB

Opaque Black Cap with Translucent White Window for Spot Illumination

AT4051
Square

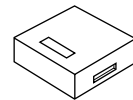
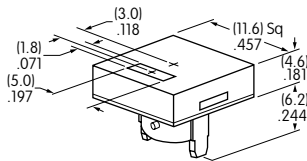

Bright LED AT635

Bright LED AT634

Material: Polycarbonate Finish: Matte

Cap for Bright LED without Resistor or LED with Resistor

Lens/Diffuser Colors Available: (AT4133, 4132, 4134 white diffusers; AT4158, 4160, 4159 colored diffusers)

JB

AT4133

AT4132

AT4134



Transparent Clear Lens

Square

Round

Rectangular

JC

AT4158

AT4160

AT4159



Translucent Diffuser

JD

JF

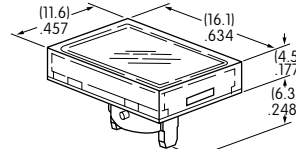

Bright LED AT635

Bright LED AT634

Material: Polycarbonate Finish: Glossy

CAP TYPES & COLOR COMBINATIONS

Cap for Super Bright LED

Lens/Diffuser
Colors Available:



Clear Lens
White Diffuser

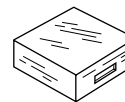
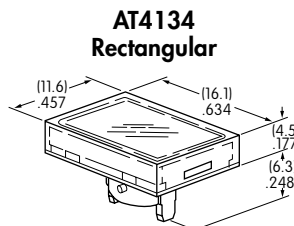
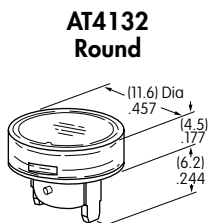

Translucent Clear Lens



Translucent White Diffuser



Super Bright LEDs
AT625, AT631, AT632

Material: Polycarbonate Finish: Glossy

TYPICAL INDICATOR DIMENSIONS

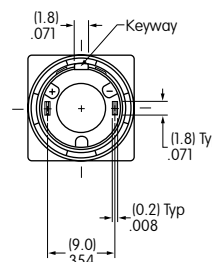
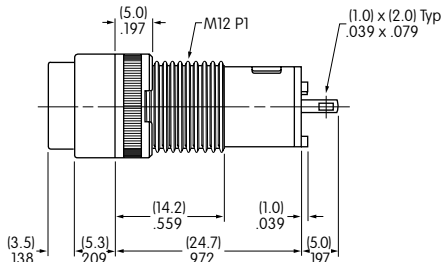
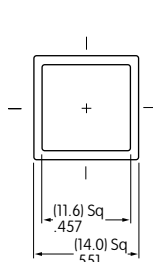
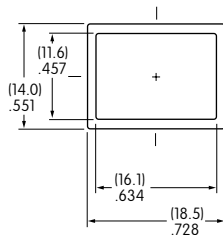
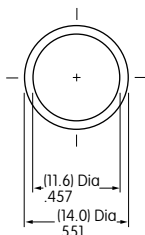

Bushing Mount



KB01KW01-05-GG

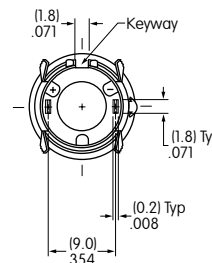
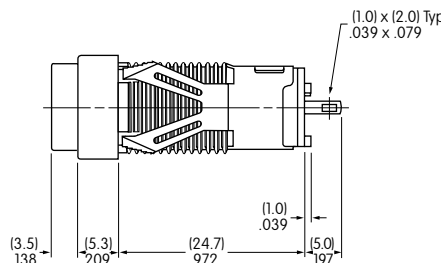
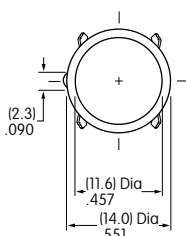
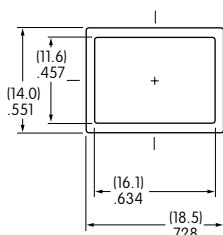
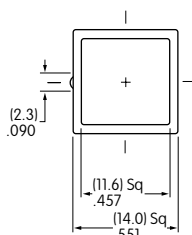

Snap-in Mount



KB05KW01-05-FF

Toggles
Rockers
Pushbuttons
Illuminated PB
Programmable
Keylocks
Rotaries
Slides
Tactiles
Tilt
Touch
Accessories
Supplement



Компания «Океан Электроники» предлагает заключение долгосрочных отношений при поставках импортных электронных компонентов на взаимовыгодных условиях!

Наши преимущества:

- Поставка оригинальных импортных электронных компонентов напрямую с производств Америки, Европы и Азии, а так же с крупнейших складов мира;
- Широкая линейка поставок активных и пассивных импортных электронных компонентов (более 30 млн. наименований);
- Поставка сложных, дефицитных, либо снятых с производства позиций;
- Оперативные сроки поставки под заказ (от 5 рабочих дней);
- Экспресс доставка в любую точку России;
- Помощь Конструкторского Отдела и консультации квалифицированных инженеров;
- Техническая поддержка проекта, помощь в подборе аналогов, поставка прототипов;
- Поставка электронных компонентов под контролем ВП;
- Система менеджмента качества сертифицирована по Международному стандарту ISO 9001;
- При необходимости вся продукция военного и аэрокосмического назначения проходит испытания и сертификацию в лаборатории (по согласованию с заказчиком);
- Поставка специализированных компонентов военного и аэрокосмического уровня качества (Xilinx, Altera, Analog Devices, Intersil, Interpoint, Microsemi, Actel, Aeroflex, Peregrine, VPT, Syfer, Eurofarad, Texas Instruments, MS Kennedy, Miteq, Cobham, E2V, MA-COM, Hittite, Mini-Circuits, General Dynamics и др.);

Компания «Океан Электроники» является официальным дистрибьютором и эксклюзивным представителем в России одного из крупнейших производителей разъемов военного и аэрокосмического назначения «JONHON», а так же официальным дистрибьютором и эксклюзивным представителем в России производителя высокотехнологичных и надежных решений для передачи СВЧ сигналов «FORSTAR».



JONHON

«JONHON» (основан в 1970 г.)

Разъемы специального, военного и аэрокосмического назначения:

(Применяются в военной, авиационной, аэрокосмической, морской, железнодорожной, горно- и нефтедобывающей отраслях промышленности)

«FORSTAR» (основан в 1998 г.)

ВЧ соединители, коаксиальные кабели, кабельные сборки и микроволновые компоненты:

(Применяются в телекоммуникациях гражданского и специального назначения, в средствах связи, РЛС, а так же военной, авиационной и аэрокосмической отраслях промышленности).



Телефон: 8 (812) 309-75-97 (многоканальный)

Факс: 8 (812) 320-03-32

Электронная почта: ocean@oceanchips.ru

Web: <http://oceanchips.ru/>

Адрес: 198099, г. Санкт-Петербург, ул. Калинина, д. 2, корп. 4, лит. А