

## Features/Benefits

- **D\*Sub Connector Type**
- **Contacts installed in factory**
- **Multiple contacts configuration: Solder Cup, 90° bent, Straight PC, Wire-wrap**
- **From 9 to 50 ways**

## Typical Applications

- **Payloads PCB**
- **Launchers**
- **PCB Test**

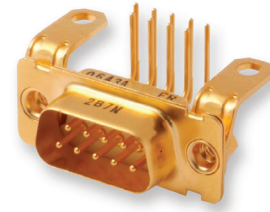

Connectors with solder type or wire-wrap type termination contacts size 20 inserted into one-piece insulators.

Termination types available:

- Solder Bucket terminations
- Straight PCB solder terminations
- 90° bent PCB solder terminations
- Wire-wrap terminations

Combination arrangements available for size 8 snap-in coaxial, power, or high voltage contacts

**Connectors supplied without coaxial power or high voltage contacts. Power and coaxial contacts have to be ordered separately but signal contacts are installed in factory.**

**Signal contact are solder bucket type. Other type could be asked under request.**

Packaging unit: 1 piece (plastic bag)

Dust cap supplied with each connector, only for quality level ESA/ESCC

## How to order – ESA/ESCC Quality Level

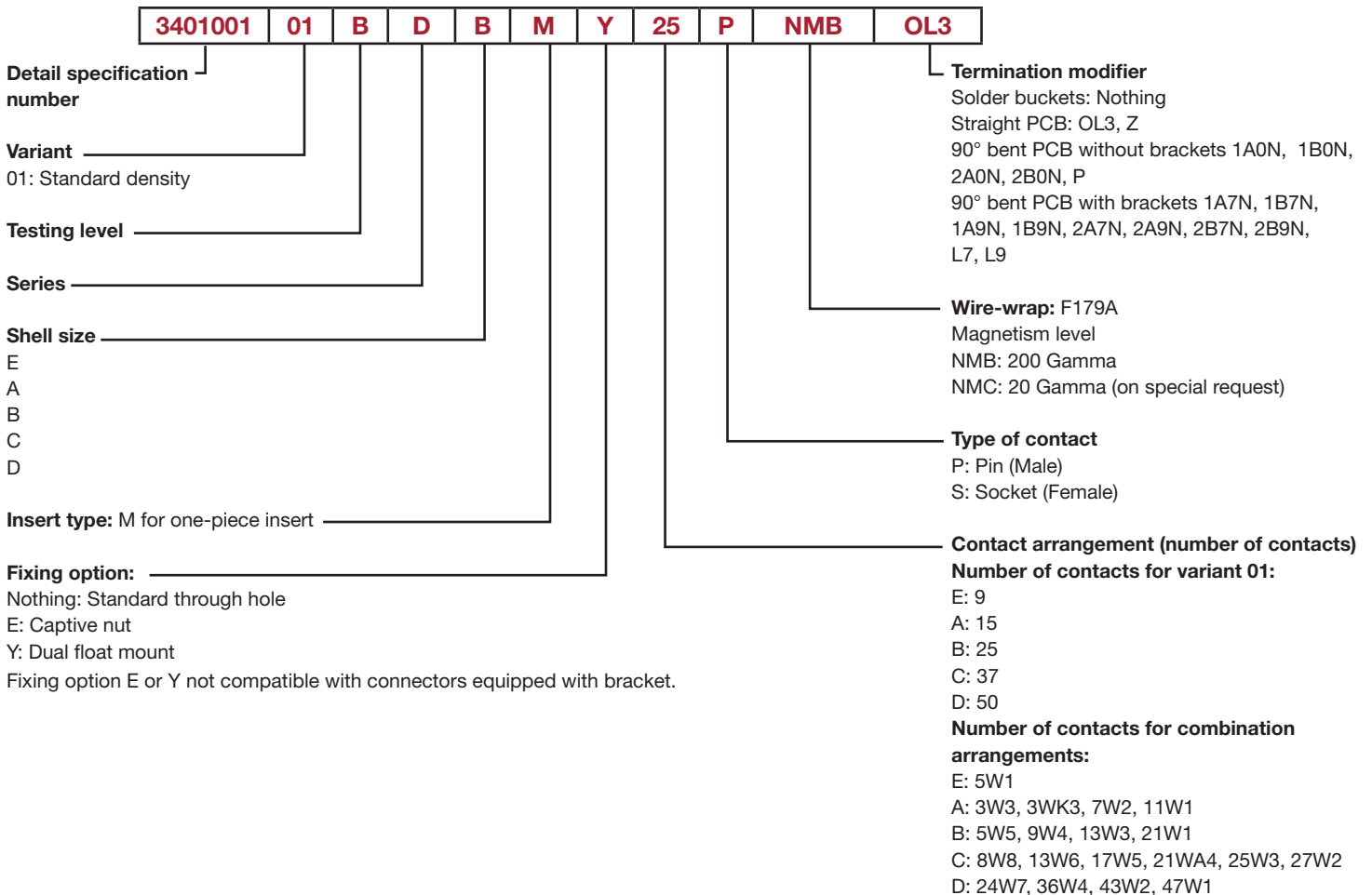

# 3401-001 D\*M Standard Density

## How to order – FR022 Quality Level

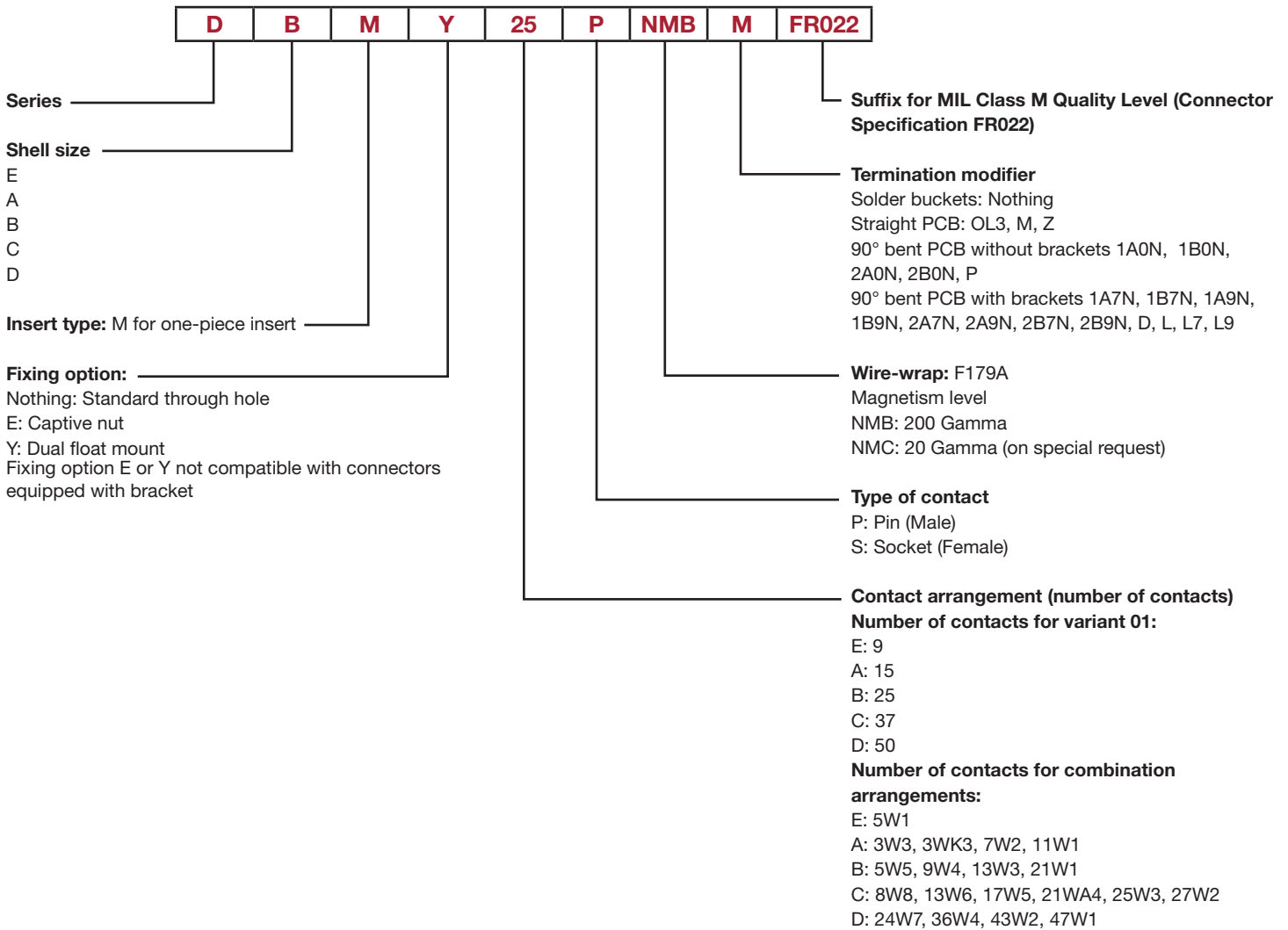

# 3401-001 D\*M Standard Density

## Specific Dimensions

## Termination Types

Solder Bucket

Straight PCB Solder

90° Bent PCB Solder / Without Bracket / European Footprint

90° Bent PCB Solder / With Brackets / European Footprint

90° Bent PCB Solder / Without Brackets / U.S. Footprint

90° Bent PCB Solder / With Brackets / U.S. Footprint

Wire-Wrap

### Male Connector

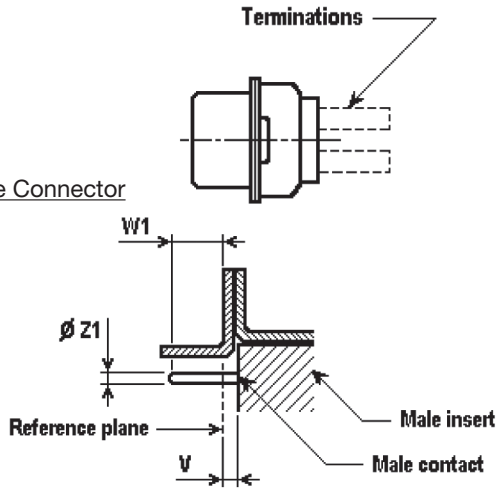

### Female Connector

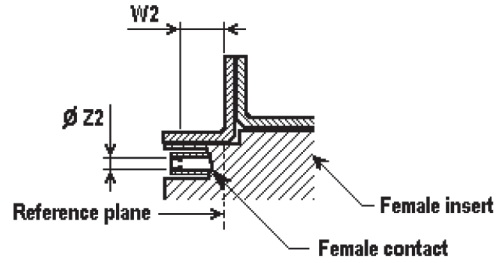

Ø Z2: to accommodate a 0,99 (.039) / 1,04 (.041) diameter pin

| Shell Size | V max       | W1 min<br>(Full pin diameter) | W1 max<br>(Full pin length) | ØZ1 min     | ØZ1 max     | W2 min<br>(Square ended pin) |
|------------|-------------|-------------------------------|-----------------------------|-------------|-------------|------------------------------|
| E          | 0,40 (.016) | 4,47 (.176)                   | 5,33 (.210)                 | 0,99 (.039) | 1,04 (.041) | 4,36 (.172)                  |
| A          | 0,40 (.016) | 4,47 (.176)                   | 5,33 (.210)                 | 0,99 (.039) | 1,04 (.041) | 4,36 (.172)                  |
| B          | 0,60 (.024) | 4,47 (.176)                   | 5,33 (.210)                 | 0,99 (.039) | 1,04 (.041) | 4,36 (.172)                  |
| C          | 0,60 (.024) | 4,47 (.176)                   | 5,33 (.210)                 | 0,99 (.039) | 1,04 (.041) | 4,36 (.172)                  |
| D          | 0,60 (.024) | 4,47 (.176)                   | 5,33 (.210)                 | 0,99 (.039) | 1,04 (.041) | 4,36 (.172)                  |

## Weights

| Max Weight (grams) without contacts or accessories | Shell Size | Weight (Grams) |        |
|--|------------|----------------|--------|
|  |            | Male           | Female |
|  | E          | 4,5            | 5,0    |
|  | A          | 5,5            | 7,0    |
|  | B          | 9,0            | 10,0   |
|  | C          | 12,5           | 13,5   |
|  | D          | 13,5           | 15,0   |

For the total connector weight, add the weight of the contacts and of the eventual accessories.\*

\* For the weight of the contacts, refer to the tables on the following pages.  
For dual-float amount (Y) weight (if applicable), added 0,60 grams.  
For captive-nut, (E) weight (if applicable), added 0,65 grams.

# 3401-001 D\*M Standard Density

## Solder Bucket Terminations:

### Specific Dimensions

Sizes E, A, B, C

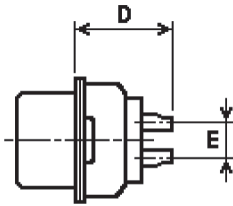

Size D

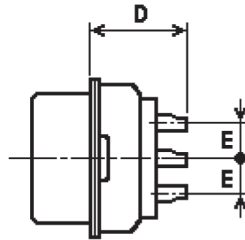

Termination

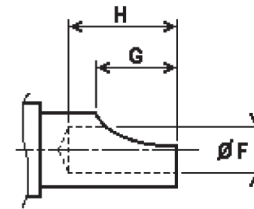

| Contacts | Shell Size | D ± 0,60 (.024) | E Typical   | ØF + 0,05 (.002) / 0 | G ± 0,55 (.022) | H min       | Pitch between contacts |
|----------|------------|-----------------|-------------|----------------------|-----------------|-------------|------------------------|
| Male     | E          | 9,60 (.378)     | 2,84 (.112) | 1,10 (.043)          | 1,95 (.077)     | 2,40 (.094) | 2,74 (.108)            |
|          | A          | 9,60 (.378)     | 2,84 (.112) | 1,10 (.043)          | 1,95 (.077)     | 2,40 (.094) | 2,74 (.108)            |
|          | B          | 9,80 (.386)     | 2,84 (.112) | 1,10 (.043)          | 1,95 (.077)     | 2,40 (.094) | 2,76 (.109)            |
|          | C          | 9,80 (.386)     | 2,84 (.112) | 1,10 (.043)          | 1,95 (.077)     | 2,40 (.094) | 2,76 (.109)            |
|          | D          | 9,80 (.386)     | 2,84 (.112) | 1,10 (.043)          | 1,95 (.077)     | 2,40 (.094) | 2,76 (.109)            |
| Female   | E          | 9,60 (.378)     | 2,84 (.112) | 1,10 (.043)          | 1,95 (.077)     | 2,40 (.094) | 2,74 (.108)            |
|          | A          | 9,60 (.378)     | 2,84 (.112) | 1,10 (.043)          | 1,95 (.077)     | 2,40 (.094) | 2,74 (.108)            |
|          | B          | 9,60 (.378)     | 2,84 (.112) | 1,10 (.043)          | 1,95 (.077)     | 2,40 (.094) | 2,76 (.109)            |
|          | C          | 9,60 (.378)     | 2,84 (.112) | 1,10 (.043)          | 1,95 (.077)     | 2,40 (.094) | 2,76 (.109)            |
|          | D          | 9,60 (.378)     | 2,84 (.112) | 1,10 (.043)          | 1,95 (.077)     | 2,40 (.094) | 2,76 (.109)            |

Termination Modifier: Nothing

### Weights

|  | Shell Size | Male Contact | Female Contact |
|--|------------|--------------|----------------|
| <b>Max Weight (grams) per contact</b>              |            | 0,19         | 0,22           |
| <b>Max Weight (grams) of all contacts per size</b> | E          | 1,71         | 1,98           |
|  | A          | 2,85         | 3,30           |
|  | B          | 4,75         | 5,50           |
|  | C          | 7,03         | 8,14           |
|  | D          | 9,50         | 11,00          |

### Recommended instruction for wire stripping:

Cut wires to length and strip insulation per illustration.  
Check for broken or frayed wires.  
Accepted wire sizes: insulated AWG20, AWG22, AWG24

#### Recommended wire trim length

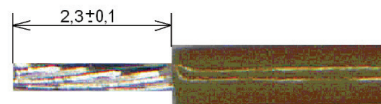

# 3401-001 D\*M Standard Density

## Cross References

Solder bucket

### Standard

| Description ESA/ESCC   | Part Number  |
|------------------------|--------------|
| 340100101B DEM 9P NMB  | C115371-5000 |
| 340100101B DEM 9S NMB  | C115371-5001 |
| 340100101B DAM 15P NMB | C115371-5004 |
| 340100101B DAM 15S NMB | C115371-5005 |
| 340100101B DBM 25P NMB | C115371-5014 |
| 340100101B DBM 25S NMB | C115371-5015 |
| 340100101B DCM 37P NMB | C115371-5026 |
| 340100101B DCM 37S NMB | C115371-5027 |
| 340100101B DDM 50P NMB | C115371-5040 |
| 340100101B DDM 50S NMB | C115371-5041 |

| Description FR022 | Part Number  |
|-------------------|--------------|
| DEM 9P NMB-FR022  | C115371-3000 |
| DEM 9S NMB-FR022  | C115371-3001 |
| DAM 15P NMB-FR022 | C115371-3004 |
| DAM 15S NMB-FR022 | C115371-3005 |
| DBM 25P NMB-FR022 | C115371-3014 |
| DBM 25S NMB-FR022 | C115371-3015 |
| DCM 37P NMB-FR022 | C115371-3026 |
| DCM 37S NMB-FR022 | C115371-3027 |
| DDM 50P NMB-FR022 | C115371-3040 |
| DDM 50S NMB-FR022 | C115371-3041 |

### Option Y

| Description ESA/ESCC    | Part Number  |
|-------------------------|--------------|
| 340100101B DEMY 9P NMB  | C115371-5050 |
| 340100101B DEMY 9S NMB  | C115371-5051 |
| 340100101B DAMY 15P NMB | C115371-5054 |
| 340100101B DAMY 15S NMB | C115371-5055 |
| 340100101B DBMY 25P NMB | C115371-5064 |
| 340100101B DBMY 25S NMB | C115371-5065 |
| 340100101B DCMY 37P NMB | C115371-5076 |
| 340100101B DCMY 37S NMB | C115371-5077 |
| 340100101B DDMY 50P NMB | C115371-5090 |
| 340100101B DDMY 50S NMB | C115371-5091 |

| Description FR022  | Part Number  |
|--------------------|--------------|
| DEMY 9P NMB-FR022  | C115371-3050 |
| DEMY 9S NMB-FR022  | C115371-3051 |
| DAMY 15P NMB-FR022 | C115371-3054 |
| DAMY 15S NMB-FR022 | C115371-3055 |
| DBMY 25P NMB-FR022 | C115371-3064 |
| DBMY 25S NMB-FR022 | C115371-3065 |
| DCMY 37P NMB-FR022 | C115371-3076 |
| DCMY 37S NMB-FR022 | C115371-3077 |
| DDMY 50P NMB-FR022 | C115371-3090 |
| DDMY 50S NMB-FR022 | C115371-3091 |

### Option E

| Description ESA/ESCC    | Part Number  |
|-------------------------|--------------|
| 340100101B DEME 9P NMB  | C115371-5100 |
| 340100101B DEME 9S NMB  | C115371-5101 |
| 340100101B DAME 15P NMB | C115371-5104 |
| 340100101B DAME 15S NMB | C115371-5105 |
| 340100101B DBME 25P NMB | C115371-5114 |
| 340100101B DBME 25S NMB | C115371-5115 |
| 340100101B DCME 37P NMB | C115371-5126 |
| 340100101B DCME 37S NMB | C115371-5127 |
| 340100101B DDME 50P NMB | C115371-5140 |
| 340100101B DDME 50S NMB | C115371-5141 |

| Description FR022  | Part Number  |
|--------------------|--------------|
| DEME 9P NMB-FR022  | C115371-3100 |
| DEME 9S NMB-FR022  | C115371-3101 |
| DAME 15P NMB-FR022 | C115371-3104 |
| DAME 15S NMB-FR022 | C115371-3105 |
| DBME 25P NMB-FR022 | C115371-3114 |
| DBME 25S NMB-FR022 | C115371-3115 |
| DCME 37P NMB-FR022 | C115371-3126 |
| DCME 37S NMB-FR022 | C115371-3127 |
| DDME 50P NMB-FR022 | C115371-3140 |
| DDME 50S NMB-FR022 | C115371-3141 |



Dimensions are shown in mm (inch)  
Dimensions subject to change

# 3401-001 D\*M Standard Density

## Straight PCB solder Terminations type OL3, M, Z

### Specific Dimensions

Sizes E, A, B, C

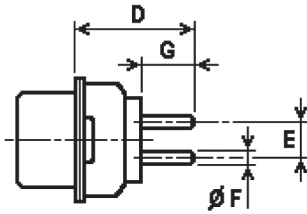

Size D

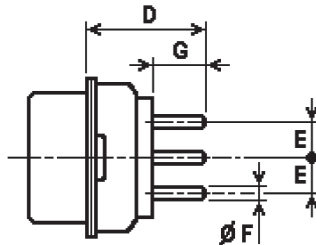

| Termination Modifier | $\pm 0,05$ ( $.002$ )<br>$\varnothing F$ | $\pm 0,20$ ( $.008$ )<br>G |
|----------------------|--|----------------------------|
| OL3                  | 0,60 (.024)                              | 4,15 (.163)                |
| M*                   | 0,76 (.030)                              | 3,65 (.144)                |
| Z                    | 0,76 (.030)                              | 4,65 (.183)                |

| Contacts | Shell Size | D min        | D max        | E Typical   | Pitch between contacts |
|----------|------------|--------------|--------------|-------------|------------------------|
| Male     | E          | 10,00 (.394) | 11,20 (.441) | 2,84 (.112) | 2,74 (.108)            |
|          | A          | 10,00 (.394) | 11,20 (.441) | 2,84 (.112) | 2,74 (.108)            |
|          | B          | 10,20 (.402) | 11,40 (.449) | 2,84 (.112) | 2,76 (.109)            |
|          | C          | 10,20 (.402) | 11,40 (.449) | 2,84 (.112) | 2,76 (.109)            |
|          | D          | 10,20 (.402) | 11,40 (.449) | 2,84 (.112) | 2,76 (.109)            |
| Female   | E          | 10,00 (.394) | 11,20 (.441) | 2,84 (.112) | 2,74 (.108)            |
|          | A          | 10,00 (.394) | 11,20 (.441) | 2,84 (.112) | 2,74 (.108)            |
|          | B          | 10,00 (.394) | 11,20 (.441) | 2,84 (.112) | 2,76 (.109)            |
|          | C          | 10,00 (.394) | 11,20 (.441) | 2,84 (.112) | 2,76 (.109)            |
|          | D          | 10,00 (.394) | 11,20 (.441) | 2,84 (.112) | 2,76 (.109)            |

Termination Modifier: OL3, M, Z

For other termination modifier, consult factory

### Weights

|  | Shell Size | Male Contact | Female Contact |
|--|------------|--------------|----------------|
| <b>Max Weight (grams) per contact</b>              |            | 0,17         | 0,20           |
| <b>Max Weight (grams) of all contacts per size</b> | E          | 1,53         | 1,80           |
|  | A          | 2,55         | 3,00           |
|  | B          | 4,25         | 5,00           |
|  | C          | 6,29         | 7,40           |
|  | D          | 8,50         | 10,00          |

# 3401-001 D\*M Standard Density

## Cross References

Solder bucket

### Standard

| Description ESA/ESCC       | Part Number  |
|----------------------------|--------------|
| 340100101B DEM 9P NMB OL3  | C115371-5150 |
| 340100101B DEM 9S NMB OL3  | C115371-5151 |
| 340100101B DAM 15P NMB OL3 | C115371-5154 |
| 340100101B DAM 15S NMB OL3 | C115371-5155 |
| 340100101B DBM 25P NMB OL3 | C115371-5160 |
| 340100101B DBM 25S NMB OL3 | C115371-5161 |
| 340100101B DCM 37P NMB OL3 | C115371-5170 |
| 340100101B DCM 37S NMB OL3 | C115371-5171 |
| 340100101B DDM 50P NMB OL3 | C115371-5182 |
| 340100101B DDM 50S NMB OL3 | C115371-5183 |
| 340100101B DEM 9P NMB Z    | C115371-5300 |
| 340100101B DEM 9S NMB Z    | C115371-5301 |
| 340100101B DAM 15P NMB Z   | C115371-5304 |
| 340100101B DAM 15S NMB Z   | C115371-5305 |
| 340100101B DBM 25P NMB Z   | C115371-5310 |
| 340100101B DBM 25S NMB Z   | C115371-5311 |
| 340100101B DCM 37P NMB Z   | C115371-5320 |
| 340100101B DCM 37S NMB Z   | C115371-5321 |
| 340100101B DDM 50P NMB Z   | C115371-5332 |
| 340100101B DDM 50S NMB Z   | C115371-5333 |

| Description FR022     | Part Number  |
|-----------------------|--------------|
| DEM 9P NMB OL3-FR022  | C115371-3150 |
| DEM 9S NMB OL3-FR022  | C115371-3151 |
| DAM 15P NMB OL3-FR022 | C115371-3154 |
| DAM 15S NMB OL3-FR022 | C115371-3155 |
| DBM 25P NMB OL3-FR022 | C115371-3160 |
| DBM 25S NMB OL3-FR022 | C115371-3161 |
| DCM 37P NMB OL3-FR022 | C115371-3170 |
| DCM 37S NMB OL3-FR022 | C115371-3171 |
| DDM 50P NMB OL3-FR022 | C115371-3182 |
| DDM 50S NMB OL3-FR022 | C115371-3183 |
| DEM 9P NMBZ-FR022     | C115371-3300 |
| DEM 9S NMBZ-FR022     | C115371-3301 |
| DAM 15P NMBZ-FR022    | 115371-3304  |
| DAM 15S NMBZ-FR022    | 115371-3305  |
| DBM 25P NMBZ-FR022    | 115371-3310  |
| DBM 25S NMBZ-FR022    | 115371-3311  |
| DCM 37P NMBZ-FR022    | 115371-3320  |
| DCM 37S NMBZ-FR022    | 115371-3321  |
| DDM 50P NMBZ-FR022    | 115371-3332  |
| DDM 50S NMBZ-FR022    | 115371-3333  |

### Option Y

| Description ESA/ESCC        | Part Number  |
|-----------------------------|--------------|
| 340100101B DEMY 9P NMB OL3  | C115371-5200 |
| 340100101B DEMY 9S NMB OL3  | C115371-5201 |
| 340100101B DAMY 15P NMB OL3 | C115371-5204 |
| 340100101B DAMY 15S NMB OL3 | C115371-5205 |
| 340100101B DBMY 25P NMB OL3 | C115371-5210 |
| 340100101B DBMY 25S NMB OL3 | C115371-5211 |
| 340100101B DCMY 37P NMB OL3 | C115371-5220 |
| 340100101B DCMY 37S NMB OL3 | C115371-5221 |
| 340100101B DDMY 50P NMB OL3 | C115371-5232 |
| 340100101B DDMY 50S NMB OL3 | C115371-5233 |
| 340100101B DEMY 9P NMB Z    | C115371-5350 |
| 340100101B DEMY 9S NMB Z    | C115371-5351 |
| 340100101B DAMY 15P NMB Z   | C115371-5354 |
| 340100101B DAMY 15S NMB Z   | C115371-5355 |
| 340100101B DBMY 25P NMB Z   | C115371-5360 |
| 340100101B DBMY 25S NMB Z   | C115371-5361 |
| 340100101B DCMY 37P NMB Z   | C115371-5370 |
| 340100101B DCMY 37S NMB Z   | C115371-5371 |
| 340100101B DDMY 50P NMB Z   | C115371-5382 |
| 340100101B DDMY 50S NMB Z   | C115371-5383 |

| Description FR022      | Part Number  |
|------------------------|--------------|
| DEMY 9P NMB OL3-FR022  | C115371-3200 |
| DEMY 9S NMB OL3-FR022  | C115371-3201 |
| DAMY 15P NMB OL3-FR022 | C115371-3204 |
| DAMY 15S NMB OL3-FR022 | C115371-3205 |
| DBMY 25P NMB OL3-FR022 | C115371-3210 |
| DBMY 25S NMB OL3-FR022 | C115371-3211 |
| DCMY 37P NMB OL3-FR022 | C115371-3220 |
| DCMY 37S NMB OL3-FR022 | C115371-3221 |
| DDMY 50P NMB OL3-FR022 | C115371-3232 |
| DDMY 50S NMB OL3-FR022 | C115371-3233 |
| DEMY 9P NMBZ-FR022     | C115371-3350 |
| DEMY 9S NMBZ-FR022     | C115371-3351 |
| DAMY 15P NMBZ-FR022    | C115371-3354 |
| DAMY 15S NMBZ-FR022    | C115371-3355 |
| DBMY 25P NMBZ-FR022    | C115371-3360 |
| DBMY 25S NMBZ-FR022    | C115371-3361 |
| DCMY 37P NMBZ-FR022    | C115371-3370 |
| DCMY 37S NMBZ-FR022    | C115371-3371 |
| DDMY 50P NMBZ-FR022    | C115371-3382 |
| DDMY 50S NMBZ-FR022    | C115371-3383 |



Dimensions are shown in mm (inch)  
Dimensions subject to change

# 3401-001 D\*M Standard Density

## Option E

| Description ESA/ESCC        | Part Number  |
|-----------------------------|--------------|
| 340100101B DEME 9P NMB OL3  | C115371-5250 |
| 340100101B DEME 9S NMB OL3  | C115371-5251 |
| 340100101B DAME 15P NMB OL3 | C115371-5254 |
| 340100101B DAME 15S NMB OL3 | C115371-5255 |
| 340100101B DBME 25P NMB OL3 | C115371-5260 |
| 340100101B DBME 25S NMB OL3 | C115371-5261 |
| 340100101B DCME 37P NMB OL3 | C115371-5270 |
| 340100101B DCME 37S NMB OL3 | C115371-5271 |
| 340100101B DDME 50P NMB OL3 | C115371-5282 |
| 340100101B DDME 50S NMB OL3 | C115371-5283 |
| 340100101B DEME 9P NMB Z    | C115371-5400 |
| 340100101B DEME 9S NMB Z    | C115371-5401 |
| 340100101B DAME 15P NMB Z   | C115371-5404 |
| 340100101B DAME 15S NMB Z   | C115371-5405 |
| 340100101B DBME 25P NMB Z   | C115371-5410 |
| 340100101B DBME 25S NMB Z   | C115371-5411 |
| 340100101B DCME 37P NMB Z   | C115371-5420 |
| 340100101B DCME 37S NMB Z   | C115371-5421 |
| 340100101B DDME 50P NMB Z   | C115371-5432 |
| 340100101B DDME 50S NMB Z   | C115371-5433 |

| Description FR022      | Part Number  |
|------------------------|--------------|
| DEME 9P NMB OL3-FR022  | C115371-3250 |
| DEME 9S NMB OL3-FR022  | C115371-3251 |
| DAME 15P NMB OL3-FR022 | C115371-3254 |
| DAME 15S NMB OL3-FR022 | C115371-3255 |
| DBME 25P NMB OL3-FR022 | C115371-3260 |
| DBME 25S NMB OL3-FR022 | C115371-3261 |
| DCME 37P NMB OL3-FR022 | C115371-3270 |
| DCME 37S NMB OL3-FR022 | C115371-3271 |
| DDME 50P NMB OL3-FR022 | C115371-3282 |
| DDME 50S NMB OL3-FR022 | C115371-3283 |
| DEME 9P NMBZ-FR022     | C115371-3400 |
| DEME 9S NMBZ-FR022     | C115371-3401 |
| DAME 15P NMBZ-FR022    | C115371-3404 |
| DAME 15S NMBZ-FR022    | C115371-3405 |
| DBME 25P NMBZ-FR022    | C115371-3410 |
| DBME 25S NMBZ-FR022    | C115371-3411 |
| DCME 37P NMBZ-FR022    | C115371-3420 |
| DCME 37S NMBZ-FR022    | C115371-3421 |
| DDME 50P NMBZ-FR022    | C115371-3432 |
| DDME 50S NMBZ-FR022    | C115371-3433 |



# 3401-001 D\*M Standard Density

90° Bent PCB solder Terminations / Without Brackets / US Footprint type P.

## Specific Dimensions

Sizes E, A, B, C

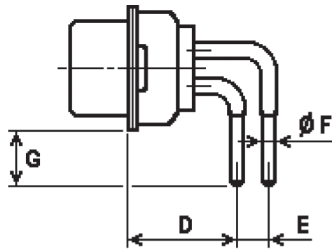

Size D

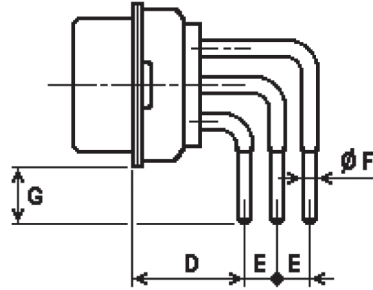

| Termination Modifier | ØF<br>± 0,05 (.002) | E<br>Typical |
|----------------------|---------------------|--------------|
| P                    | 0,76 (.030)         | 2,84 (.112)  |

| Contacts | Shell Size | D min       | D max       | G ± 0.37 (.015) | Pitch between contacts |
|----------|------------|-------------|-------------|-----------------|------------------------|
| Male     | E          | 6,94 (.273) | 7,44 (.293) | 4,33 (.170)     | 2,74 (.108)            |
|          | A          | 6,94 (.273) | 7,44 (.293) | 4,33 (.170)     | 2,74 (.108)            |
|          | B          | 6,94 (.273) | 7,44 (.293) | 4,33 (.170)     | 2,76 (.109)            |
|          | C          | 6,94 (.273) | 7,44 (.293) | 4,33 (.170)     | 2,76 (.109)            |
|          | D          | 6,94 (.273) | 7,44 (.293) | 4,33 (.170)     | 2,76 (.109)            |
| Female   | E          | 6,94 (.273) | 7,44 (.293) | 4,33 (.170)     | 2,74 (.108)            |
|          | A          | 6,94 (.273) | 7,44 (.293) | 4,33 (.170)     | 2,74 (.108)            |
|          | B          | 6,94 (.273) | 7,44 (.293) | 4,33 (.170)     | 2,76 (.109)            |
|          | C          | 6,94 (.273) | 7,44 (.293) | 4,33 (.170)     | 2,76 (.109)            |
|          | D          | 6,94 (.273) | 7,44 (.293) | 4,33 (.170)     | 2,76 (.109)            |

Termination Modifier: P

For other termination modifier, consult factory

## Weights

|  | Shell Size | Male Contact       | Female Contact     |
|--|------------|--------------------|--------------------|
| <b>Max Weight (grams) per contact</b>              |            | 0,22 / 0,26 / 0,30 | 0,27 / 0,32 / 0,35 |
| <b>Max Weight (grams) of all contacts per size</b> | E          | 2,18               | 2,68               |
|  | A          | 3,62               | 4,45               |
|  | B          | 6,02               | 7,40               |
|  | C          | 8,90               | 10,94              |
|  | D          | 13,00              | 15,66              |

# 3401-001 D\*M Standard Density

## Cross References

90° bent PCB (without brackets)

### Standard

| Description ESA/ESCC     | Part Number  |
|--------------------------|--------------|
| 340100101B DEM 9P NMB P  | C115331-9016 |
| 340100101B DEM 9S NMB P  | C115331-9017 |
| 340100101B DAM 15P NMB P | C115371-9020 |
| 340100101B DAM 15S NMB P | C115371-9021 |
| 340100101B DBM 25P NMB P | C115371-9026 |
| 340100101B DBM 25S NMB P | C115371-9027 |
| 340100101B DCM 37P NMB P | C115371-9036 |
| 340100101B DCM 37S NMB P | C115371-9037 |
| 340100101B DDM 50P NMB P | C115371-9048 |
| 340100101B DDM 50S NMB P | C115371-9049 |

| Description FR022  | Part Number  |
|--------------------|--------------|
| DEM 9P NMBP-FR022  | C115371-0000 |
| DEM 9S NMBP-FR022  | C115371-0001 |
| DAM 15P NMBP-FR022 | C115371-0004 |
| DAM 15S NMBP-FR022 | C115371-0005 |
| DBM 25P NMBP-FR022 | C115371-0010 |
| DBM 25S NMBP-FR022 | C115371-0011 |
| DCM 37P NMBP-FR022 | C115371-0020 |
| DCM 37S NMBP-FR022 | C115371-0021 |
| DDM 50P NMBP-FR022 | C115371-0032 |
| DDM 50S NMBP-FR022 | C115371-0033 |

### Option Y

| Description ESA/ESCC      | Part Number  |
|---------------------------|--------------|
| 340100101B DEMY 9P NMB P  | C115331-9058 |
| 340100101B DEMY 9S NMB P  | C115331-9059 |
| 340100101B DAMY 15P NMB P | C115371-9062 |
| 340100101B DAMY 15S NMB P | C115371-9063 |
| 340100101B DBMY 25P NMB P | C115371-9068 |
| 340100101B DBMY 25S NMB P | C115371-9069 |
| 340100101B DCMY 37P NMB P | C115371-9078 |
| 340100101B DCMY 37S NMB P | C115371-9079 |
| 340100101B DDMY 50P NMB P | C115371-9090 |
| 340100101B DDMY 50S NMB P | C115371-9091 |

| Description FR022   | Part Number  |
|---------------------|--------------|
| DEMY 9P NMBP-FR022  | C115371-0042 |
| DEMY 9S NMBP-FR022  | C115371-0043 |
| DAMY 15P NMBP-FR022 | C115371-0046 |
| DAMY 15S NMBP-FR022 | C115371-0047 |
| DBMY 25P NMBP-FR022 | C115371-0052 |
| DBMY 25S NMBP-FR022 | C115371-0053 |
| DCMY 37P NMBP-FR022 | C115371-0062 |
| DCMY 37S NMBP-FR022 | C115371-0063 |
| DDMY 50P NMBP-FR022 | C115371-0074 |
| DDMY 50S NMBP-FR022 | C115371-0075 |

### Option E

| Description ESA/ESCC      | Part Number  |
|---------------------------|--------------|
| 340100101B DEME 9P NMB P  | C115331-9100 |
| 340100101B DEME 9S NMB P  | C115331-9101 |
| 340100101B DAME 15P NMB P | C115371-9104 |
| 340100101B DAME 15S NMB P | C115371-9105 |
| 340100101B DBME 25P NMB P | C115371-9110 |
| 340100101B DBME 25S NMB P | C115371-9111 |
| 340100101B DCME 37P NMB P | C115371-9120 |
| 340100101B DCME 37S NMB P | C115371-9121 |
| 340100101B DDME 50P NMB P | C115371-9132 |
| 340100101B DDME 50S NMB P | C115371-9133 |

| Description FR022   | Part Number  |
|---------------------|--------------|
| DEME 9P NMBP-FR022  | C115371-0084 |
| DEME 9S NMBP-FR022  | C115371-0085 |
| DAME 15P NMBP-FR022 | C115371-0088 |
| DAME 15S NMBP-FR022 | C115371-0089 |
| DBME 25P NMBP-FR022 | C115371-0094 |
| DBME 25S NMBP-FR022 | C115371-0095 |
| DCME 37P NMBP-FR022 | C115371-0104 |
| DCME 37S NMBP-FR022 | C115371-0105 |
| DDME 50P NMBP-FR022 | C115371-0116 |
| DDME 50S NMBP-FR022 | C115371-0117 |



Dimensions are shown in mm (inch)  
Dimensions subject to change

# 3401-001 D\*M Standard Density

90° Bent PCB solder Terminations / Without Brackets / European Footprint type 1A0N – 1B0N – 2A0N – 2B0N

## Specific Dimensions

Sizes E, A, B, C

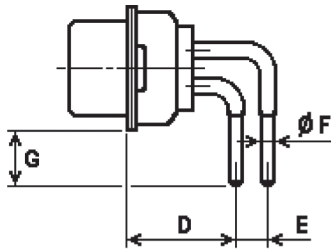

Size D

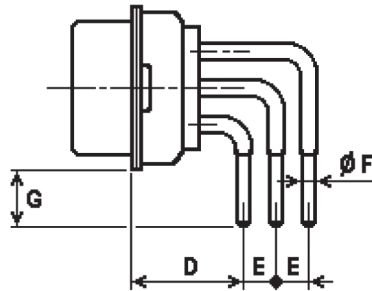

| Termination Modifier | ØF<br>± 0,05 (.002) | E<br>Typical |
|----------------------|---------------------|--------------|
| 1A0N                 | 0,60 (.024)         | 2,54 (.100)  |
| 1B0N                 | 0,60 (.024)         | 2,84 (.112)  |
| 2A0N                 | 0,76 (.030)         | 2,54 (.100)  |
| 2B0N                 | 0,76 (.030)         | 2,84 (.112)  |

| Contacts | Shell Size | D min        | D max        | G ± 0.30 (.012) | Pitch between contacts |
|----------|------------|--------------|--------------|-----------------|------------------------|
| Male     | E          | 10,10 (.398) | 10,30 (.406) | 5,00 (.197)     | 2,74 (.108)            |
|          | A          | 10,10 (.398) | 10,30 (.406) | 5,00 (.197)     | 2,74 (.108)            |
|          | B          | 10,30 (.406) | 10,50 (.413) | 5,00 (.197)     | 2,76 (.109)            |
|          | C          | 10,30 (.406) | 10,50 (.413) | 5,00 (.197)     | 2,76 (.109)            |
|          | D          | 10,30 (.406) | 10,50 (.413) | 5,00 (.197)     | 2,76 (.109)            |
| Female   | E          | 10,10 (.398) | 10,30 (.406) | 5,00 (.197)     | 2,74 (.108)            |
|          | A          | 10,10 (.398) | 10,30 (.406) | 5,00 (.197)     | 2,74 (.108)            |
|          | B          | 10,10 (.398) | 10,30 (.406) | 5,00 (.197)     | 2,76 (.109)            |
|          | C          | 10,10 (.398) | 10,30 (.406) | 5,00 (.197)     | 2,76 (.109)            |
|          | D          | 10,10 (.398) | 10,30 (.406) | 5,00 (.197)     | 2,76 (.109)            |

Termination Modifier: 1A0N, 1B0N, 2A0N, 2B0N  
For other termination modifier, consult factory

## Weights

|  | Shell Size | Male Contact       | Female Contact     |
|--|------------|--------------------|--------------------|
| <b>Max Weight (grams) per contact</b>              |            | 0,24 / 0,28 / 0,32 | 0,29 / 0,34 / 0,37 |
| <b>Max Weight (grams) of all contacts per size</b> | E          | 2,36               | 2,86               |
|  | A          | 3,92               | 4,75               |
|  | B          | 6,52               | 7,90               |
|  | C          | 9,64               | 11,68              |
|  | D          | 14,00              | 16,66              |

# 3401-001 D\*M Standard Density

## Cross References

90° bent PCB (without brackets)

### Standard

| Description ESA/ESCC        | Part Number  |
|-----------------------------|--------------|
| 340100101B DEM 9P NMB 1AON  | C115371-5600 |
| 340100101B DEM 9S NMB 1AON  | C115371-5601 |
| 340100101B DAM 15P NMB 1AON | C115371-5604 |
| 340100101B DAM 15S NMB 1AON | C115371-5605 |
| 340100101B DBM 25P NMB 1AON | C115371-5610 |
| 340100101B DBM 25S NMB 1AON | C115371-5611 |
| 340100101B DCM 37P NMB 1AON | C115371-5620 |
| 340100101B DCM 37S NMB 1AON | C115371-5621 |
| 340100101B DDM 50P NMB 1AON | C115371-5632 |
| 340100101B DDM 50S NMB 1AON | C115371-5633 |
| 340100101B DEM 9P NMB 1BON  | C115371-5750 |
| 340100101B DEM 9S NMB 1BON  | C115371-5751 |
| 340100101B DAM 15P NMB 1BON | C115371-5754 |
| 340100101B DAM 15S NMB 1BON | C115371-5755 |
| 340100101B DBM 25P NMB 1BON | C115371-5760 |
| 340100101B DBM 25S NMB 1BON | C115371-5761 |
| 340100101B DCM 37P NMB 1BON | C115371-5770 |
| 340100101B DCM 37S NMB 1BON | C115371-5771 |
| 340100101B DDM 50P NMB 1BON | C115371-5782 |
| 340100101B DDM 50S NMB 1BON | C115371-5783 |
| 340100101B DEM 9P NMB 2AON  | C115371-5900 |
| 340100101B DEM 9S NMB 2AON  | C115371-5901 |
| 340100101B DAM 15P NMB 2AON | C115371-5904 |
| 340100101B DAM 15S NMB 2AON | C115371-5905 |
| 340100101B DBM 25P NMB 2AON | C115371-5910 |
| 340100101B DBM 25S NMB 2AON | C115371-5911 |
| 340100101B DCM 37P NMB 2AON | C115371-5920 |
| 340100101B DCM 37S NMB 2AON | C115371-5921 |
| 340100101B DDM 50P NMB 2AON | C115371-5932 |
| 340100101B DDM 50S NMB 2AON | C115371-5933 |
| 340100101B DEM 9P NMB 2BON  | C115371-6050 |
| 340100101B DEM 9S NMB 2BON  | C115371-6051 |
| 340100101B DAM 15P NMB 2BON | C115371-6054 |
| 340100101B DAM 15S NMB 2BON | C115371-6055 |
| 340100101B DBM 25P NMB 2BON | C115371-6060 |
| 340100101B DBM 25S NMB 2BON | C115371-6061 |
| 340100101B DCM 37P NMB 2BON | C115371-6070 |
| 340100101B DCM 37S NMB 2BON | C115371-6071 |
| 340100101B DDM 50P NMB 2BON | C115371-6082 |
| 340100101B DDM 50S NMB 2BON | C115371-6083 |

| Description FR022      | Part Number  |
|------------------------|--------------|
| DEM 9P NMB 1AON-FR022  | C115371-3600 |
| DEM 9S NMB 1AON-FR022  | C115371-3601 |
| DAM 15P NMB 1AON-FR022 | C115371-3604 |
| DAM 15S NMB 1AON-FR022 | C115371-3605 |
| DBM 25P NMB 1AON-FR022 | C115371-3610 |
| DBM 25S NMB 1AON-FR022 | C115371-3611 |
| DCM 37P NMB 1AON-FR022 | C115371-3620 |
| DCM 37S NMB 1AON-FR022 | C115371-3621 |
| DDM 50P NMB 1AON-FR022 | C115371-3632 |
| DDM 50S NMB 1AON-FR022 | C115371-3633 |
| DEM 9P NMB 1BON-FR022  | C115371-3750 |
| DEM 9S NMB 1BON-FR022  | C115371-3751 |
| DAM 15P NMB 1BON-FR022 | C115371-3754 |
| DAM 15S NMB 1BON-FR022 | C115371-3755 |
| DBM 25P NMB 1BON-FR022 | C115371-3760 |
| DBM 25S NMB 1BON-FR022 | C115371-3761 |
| DCM 37P NMB 1BON-FR022 | C115371-3770 |
| DCM 37S NMB 1BON-FR022 | C115371-3771 |
| DDM 50P NMB 1BON-FR022 | C115371-3782 |
| DDM 50S NMB 1BON-FR022 | C115371-3783 |
| DEM 9P NMB 2AON-FR022  | C115371-3900 |
| DEM 9S NMB 2AON-FR022  | C115371-3901 |
| DAM 15P NMB 2AON-FR022 | C115371-3904 |
| DAM 15S NMB 2AON-FR022 | C115371-3905 |
| DBM 25P NMB 2AON-FR022 | C115371-3910 |
| DBM 25S NMB 2AON-FR022 | C115371-3911 |
| DCM 37P NMB 2AON-FR022 | C115371-3920 |
| DCM 37S NMB 2AON-FR022 | C115371-3921 |
| DDM 50P NMB 2AON-FR022 | C115371-3932 |
| DDM 50S NMB 2AON-FR022 | C115371-3933 |
| DEM 9P NMB 2BON-FR022  | C115371-4050 |
| DEM 9S NMB 2BON-FR022  | C115371-4051 |
| DAM 15P NMB 2BON-FR022 | C115371-4054 |
| DAM 15S NMB 2BON-FR022 | C115371-4055 |
| DBM 25P NMB 2BON-FR022 | C115371-4060 |
| DBM 25S NMB 2BON-FR022 | C115371-4061 |
| DCM 37P NMB 2BON-FR022 | C115371-4070 |
| DCM 37S NMB 2BON-FR022 | C115371-4071 |
| DDM 50P NMB 2BON-FR022 | C115371-4082 |
| DDM 50S NMB 2BON-FR022 | C115371-4083 |



Dimensions are shown in mm (inch)  
Dimensions subject to change

# 3401-001 D\*M Standard Density

## Option Y

| Description ESA/ESCC |                   | Part Number  |
|----------------------|-------------------|--------------|
| 340100101B           | DEMY 9P NMB 1AON  | C115371-5650 |
| 340100101B           | DEMY 9S NMB 1AON  | C115371-5651 |
| 340100101B           | DAMY 15P NMB 1AON | C115371-5654 |
| 340100101B           | DAMY 15S NMB 1AON | C115371-5655 |
| 340100101B           | DBMY 25P NMB 1AON | C115371-5660 |
| 340100101B           | DBMY 25S NMB 1AON | C115371-5661 |
| 340100101B           | DCMY 37P NMB 1AON | C115371-5670 |
| 340100101B           | DCMY 37S NMB 1AON | C115371-5671 |
| 340100101B           | DDMY 50P NMB 1AON | C115371-5682 |
| 340100101B           | DDMY 50S NMB 1AON | C115371-5683 |
| 340100101B           | DEMY 9P NMB 1BON  | C115371-5800 |
| 340100101B           | DEMY 9S NMB 1BON  | C115371-5801 |
| 340100101B           | DAMY 15P NMB 1BON | C115371-5804 |
| 340100101B           | DAMY 15S NMB 1BON | C115371-5805 |
| 340100101B           | DBMY 25P NMB 1BON | C115371-5810 |
| 340100101B           | DBMY 25S NMB 1BON | C115371-5811 |
| 340100101B           | DCMY 37P NMB 1BON | C115371-5820 |
| 340100101B           | DCMY 37S NMB 1BON | C115371-5821 |
| 340100101B           | DDMY 50P NMB 1BON | C115371-5832 |
| 340100101B           | DDMY 50S NMB 1BON | C115371-5833 |
| 340100101B           | DEMY 9P NMB 2AON  | C115371-5950 |
| 340100101B           | DEMY 9S NMB 2AON  | C115371-5951 |
| 340100101B           | DAMY 15P NMB 2AON | C115371-5954 |
| 340100101B           | DAMY 15S NMB 2AON | C115371-5955 |
| 340100101B           | DBMY 25P NMB 2AON | C115371-5960 |
| 340100101B           | DBMY 25S NMB 2AON | C115371-5961 |
| 340100101B           | DCMY 37P NMB 2AON | C115371-5970 |
| 340100101B           | DCMY 37S NMB 2AON | C115371-5971 |
| 340100101B           | DDMY 50P NMB 2AON | C115371-5982 |
| 340100101B           | DDMY 50S NMB 2AON | C115371-5983 |
| 340100101B           | DEMY 9P NMB 2BON  | C115371-6100 |
| 340100101B           | DEMY 9S NMB 2BON  | C115371-6101 |
| 340100101B           | DAMY 15P NMB 2BON | C115371-6104 |
| 340100101B           | DAMY 15S NMB 2BON | C115371-6105 |
| 340100101B           | DBMY 25P NMB 2BON | C115371-6110 |
| 340100101B           | DBMY 25S NMB 2BON | C115371-6111 |
| 340100101B           | DCMY 37P NMB 2BON | C115371-6120 |
| 340100101B           | DCMY 37S NMB 2BON | C115371-6121 |
| 340100101B           | DDMY 50P NMB 2BON | C115371-6132 |
| 340100101B           | DDMY 50S NMB 2BON | C115371-6133 |

| Description FR022       |  | Part Number  |
|-------------------------|--|--------------|
| DEMY 9P NMB 1AON-FR022  |  | C115371-3650 |
| DEMY 9S NMB 1AON-FR022  |  | C115371-3651 |
| DAMY 15P NMB 1AON-FR022 |  | C115371-3654 |
| DAMY 15S NMB 1AON-FR022 |  | C115371-3655 |
| DBMY 25P NMB 1AON-FR022 |  | C115371-3660 |
| DBMY 25S NMB 1AON-FR022 |  | C115371-3661 |
| DCMY 37P NMB 1AON-FR022 |  | C115371-3670 |
| DCMY 37S NMB 1AON-FR022 |  | C115371-3671 |
| DDMY 50P NMB 1AON-FR022 |  | C115371-3682 |
| DDMY 50S NMB 1AON-FR022 |  | C115371-3683 |
| DEMY 9P NMB 1BON-FR022  |  | C115371-3800 |
| DEMY 9S NMB 1BON-FR022  |  | C115371-3801 |
| DAMY 15P NMB 1BON-FR022 |  | C115371-3804 |
| DAMY 15S NMB 1BON-FR022 |  | C115371-3805 |
| DBMY 25P NMB 1BON-FR022 |  | C115371-3810 |
| DBMY 25S NMB 1BON-FR022 |  | C115371-3811 |
| DCMY 37P NMB 1BON-FR022 |  | C115371-3820 |
| DCMY 37S NMB 1BON-FR022 |  | C115371-3821 |
| DDMY 50P NMB 1BON-FR022 |  | C115371-3832 |
| DDMY 50S NMB 1BON-FR022 |  | C115371-3833 |
| DEMY 9P NMB 2AON-FR022  |  | C115371-3950 |
| DEMY 9S NMB 2AON-FR022  |  | C115371-3951 |
| DAMY 15P NMB 2AON-FR022 |  | C115371-3954 |
| DAMY 15S NMB 2AON-FR022 |  | C115371-3955 |
| DBMY 25P NMB 2AON-FR022 |  | C115371-3960 |
| DBMY 25S NMB 2AON-FR022 |  | C115371-3961 |
| DCMY 37P NMB 2AON-FR022 |  | C115371-3970 |
| DCMY 37S NMB 2AON-FR022 |  | C115371-3971 |
| DDMY 50P NMB 2AON-FR022 |  | C115371-3982 |
| DDMY 50S NMB 2AON-FR022 |  | C115371-3983 |
| DEMY 9P NMB 2BON-FR022  |  | C115371-4100 |
| DEMY 9S NMB 2BON-FR022  |  | C115371-4101 |
| DAMY 15P NMB 2BON-FR022 |  | C115371-4104 |
| DAMY 15S NMB 2BON-FR022 |  | C115371-4105 |
| DBMY 25P NMB 2BON-FR022 |  | C115371-4110 |
| DBMY 25S NMB 2BON-FR022 |  | C115371-4111 |
| DCMY 37P NMB 2BON-FR022 |  | C115371-4120 |
| DCMY 37S NMB 2BON-FR022 |  | C115371-4121 |
| DDMY 50P NMB 2BON-FR022 |  | C115371-4132 |
| DDMY 50S NMB 2BON-FR022 |  | C115371-4133 |



Dimensions are shown in mm (inch)  
Dimensions subject to change

# 3401-001 D\*M Standard Density

## Option E

| Description ESA/ESCC |                   | Part Number  |
|----------------------|-------------------|--------------|
| 340100101B           | DEME 9P NMB 1AON  | C115371-5700 |
| 340100101B           | DEME 9S NMB 1AON  | C115371-5701 |
| 340100101B           | DAME 15P NMB 1AON | C115371-5704 |
| 340100101B           | DAME 15S NMB 1AON | C115371-5705 |
| 340100101B           | DBME 25P NMB 1AON | C115371-5710 |
| 340100101B           | DBME 25S NMB 1AON | C115371-5711 |
| 340100101B           | DCME 37P NMB 1AON | C115371-5720 |
| 340100101B           | DCME 37S NMB 1AON | C115371-5721 |
| 340100101B           | DDME 50P NMB 1AON | C115371-5732 |
| 340100101B           | DDME 50S NMB 1AON | C115371-5733 |
| 340100101B           | DEME 9P NMB 1BON  | C115371-5850 |
| 340100101B           | DEME 9S NMB 1BON  | C115371-5851 |
| 340100101B           | DAME 15P NMB 1BON | C115371-5854 |
| 340100101B           | DAME 15S NMB 1BON | C115371-5855 |
| 340100101B           | DBME 25P NMB 1BON | C115371-5860 |
| 340100101B           | DBME 25S NMB 1BON | C115371-5861 |
| 340100101B           | DCME 37P NMB 1BON | C115371-5870 |
| 340100101B           | DCME 37S NMB 1BON | C115371-5871 |
| 340100101B           | DDME 50P NMB 1BON | C115371-5882 |
| 340100101B           | DDME 50S NMB 1BON | C115371-5883 |
| 340100101B           | DEME 9P NMB 2AON  | C115371-6000 |
| 340100101B           | DEME 9S NMB 2AON  | C115371-6001 |
| 340100101B           | DAME 15P NMB 2AON | C115371-6004 |
| 340100101B           | DAME 15S NMB 2AON | C115371-6005 |
| 340100101B           | DBME 25P NMB 2AON | C115371-6010 |
| 340100101B           | DBME 25S NMB 2AON | C115371-6011 |
| 340100101B           | DCME 37P NMB 2AON | C115371-6020 |
| 340100101B           | DCME 37S NMB 2AON | C115371-6021 |
| 340100101B           | DDME 50P NMB 2AON | C115371-6032 |
| 340100101B           | DDME 50S NMB 2AON | C115371-6033 |
| 340100101B           | DEME 9P NMB 2BON  | C115371-6150 |
| 340100101B           | DEME 9S NMB 2BON  | C115371-6151 |
| 340100101B           | DAME 15P NMB 2BON | C115371-6154 |
| 340100101B           | DAME 15S NMB 2BON | C115371-6155 |
| 340100101B           | DBME 25P NMB 2BON | C115371-6160 |
| 340100101B           | DBME 25S NMB 2BON | C115371-6161 |
| 340100101B           | DCME 37P NMB 2BON | C115371-6170 |
| 340100101B           | DCME 37S NMB 2BON | C115371-6171 |
| 340100101B           | DDME 50P NMB 2BON | C115371-6182 |
| 340100101B           | DDME 50S NMB 2BON | C115371-6183 |

| Description FR022       |  | Part Number  |
|-------------------------|--|--------------|
| DEME 9P NMB 1AON-FR022  |  | C115371-3700 |
| DEME 9S NMB 1AON-FR022  |  | C115371-3701 |
| DAME 15P NMB 1AON-FR022 |  | C115371-3704 |
| DAME 15S NMB 1AON-FR022 |  | C115371-3705 |
| DBME 25P NMB 1AON-FR022 |  | C115371-3710 |
| DBME 25S NMB 1AON-FR022 |  | C115371-3711 |
| DCME 37P NMB 1AON-FR022 |  | C115371-3720 |
| DCME 37S NMB 1AON-FR022 |  | C115371-3721 |
| DDME 50P NMB 1AON-FR022 |  | C115371-3732 |
| DDME 50S NMB 1AON-FR022 |  | C115371-3733 |
| DEME 9P NMB 1BON-FR022  |  | C115371-3850 |
| DEME 9S NMB 1BON-FR022  |  | C115371-3851 |
| DAME 15P NMB 1BON-FR022 |  | C115371-3854 |
| DAME 15S NMB 1BON-FR022 |  | C115371-3855 |
| DBME 25P NMB 1BON-FR022 |  | C115371-3860 |
| DBME 25S NMB 1BON-FR022 |  | C115371-3861 |
| DCME 37P NMB 1BON-FR022 |  | C115371-3870 |
| DCME 37S NMB 1BON-FR022 |  | C115371-3871 |
| DDME 50P NMB 1BON-FR022 |  | C115371-3882 |
| DDME 50S NMB 1BON-FR022 |  | C115371-3883 |
| DEME 9P NMB 2AON-FR022  |  | C115371-4000 |
| DEME 9S NMB 2AON-FR022  |  | C115371-4001 |
| DAME 15P NMB 2AON-FR022 |  | C115371-4004 |
| DAME 15S NMB 2AON-FR022 |  | C115371-4005 |
| DBME 25P NMB 2AON-FR022 |  | C115371-4010 |
| DBME 25S NMB 2AON-FR022 |  | C115371-4011 |
| DCME 37P NMB 2AON-FR022 |  | C115371-4020 |
| DCME 37S NMB 2AON-FR022 |  | C115371-4021 |
| DDME 50P NMB 2AON-FR022 |  | C115371-4032 |
| DDME 50S NMB 2AON-FR022 |  | C115371-4033 |
| DEME 9P NMB 2BON-FR022  |  | C115371-4150 |
| DEME 9S NMB 2BON-FR022  |  | C115371-4151 |
| DAME 15P NMB 2BON-FR022 |  | C115371-4154 |
| DAME 15S NMB 2BON-FR022 |  | C115371-4155 |
| DBME 25P NMB 2BON-FR022 |  | C115371-4160 |
| DBME 25S NMB 2BON-FR022 |  | C115371-4161 |
| DCME 37P NMB 2BON-FR022 |  | C115371-4170 |
| DCME 37S NMB 2BON-FR022 |  | C115371-4171 |
| DDME 50P NMB 2BON-FR022 |  | C115371-4182 |
| DDME 50S NMB 2BON-FR022 |  | C115371-4183 |



Dimensions are shown in mm (inch)  
Dimensions subject to change

# 3401-001 D\*M Standard Density

90° Bent PCB solder Terminations / With Brackets / European Footprint Type 1A7N – 1A9N – 1B7N – 1B9N – 2A7N – 2A9N – 2B7N – 2B9N

## Specific Dimensions

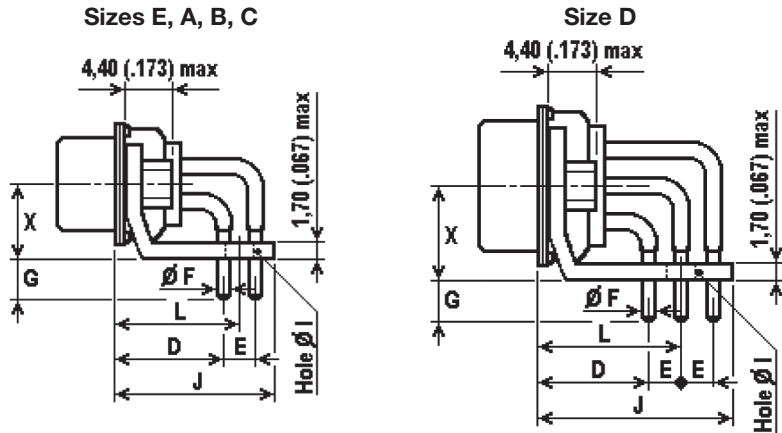

| Termination Modifier | ØF<br>± 0,05 (.002) | E<br>Typical |
|----------------------|---------------------|--------------|
| 1A7N / 1A9N          | 0,60 (.024)         | 2,54 (.100)  |
| 1B7N / 1B9N          | 0,60 (.024)         | 2,84 (.112)  |
| 2A7N / 2A9N          | 0,76 (.030)         | 2,54 (.100)  |
| 2B7N / 2B9N          | 0,76 (.030)         | 2,84 (.112)  |

2 pieces metal brackets:

«7N»: fixed with captive nuts 4-40 UNC-2B

«9N»: fixed with captive nuts M3

Hole Ø I: 3,22 (.127) ± 0,10 (.004)

Bracket width (onto PCB):

Shell sizes E, A, B, C: 6,10 (.240) max

Shell size D: 5,50 (.217) max

| Contacts | Shell Size | D min        | D max        | G ± 0,40 (.016) | J max        | L Typical    | X ± 0,15 (.006) | Pitch<br>between<br>contacts |
|----------|------------|--------------|--------------|-----------------|--------------|--------------|-----------------|------------------------------|
| Male     | E          | 10,10 (.398) | 10,30 (.406) | 4,00 (.157)     | 15,60 (.614) | 11,52 (.454) | 7,35 (.289)     | 2,74 (.108)                  |
|          | A          | 10,10 (.398) | 10,30 (.406) | 4,00 (.157)     | 15,60 (.614) | 11,52 (.454) | 7,35 (.289)     | 2,74 (.108)                  |
|          | B          | 10,30 (.406) | 10,50 (.413) | 4,00 (.157)     | 15,80 (.622) | 11,74 (.462) | 7,35 (.289)     | 2,76 (.109)                  |
|          | C          | 10,30 (.406) | 10,50 (.413) | 4,00 (.157)     | 15,80 (.622) | 11,74 (.462) | 7,35 (.289)     | 2,76 (.109)                  |
|          | D          | 10,30 (.406) | 10,50 (.413) | 4,00 (.157)     | 17,70 (.697) | 13,16 (.518) | 8,70 (.343)     | 2,76 (.109)                  |
| Female   | E          | 10,10 (.398) | 10,30 (.406) | 4,00 (.157)     | 15,60 (.614) | 11,52 (.454) | 7,35 (.289)     | 2,74 (.108)                  |
|          | A          | 10,10 (.398) | 10,30 (.406) | 4,00 (.157)     | 15,60 (.614) | 11,52 (.454) | 7,35 (.289)     | 2,74 (.108)                  |
|          | B          | 10,10 (.398) | 10,30 (.406) | 4,00 (.157)     | 15,60 (.614) | 11,52 (.454) | 7,35 (.289)     | 2,76 (.109)                  |
|          | C          | 10,10 (.398) | 10,30 (.406) | 4,00 (.157)     | 15,60 (.614) | 11,52 (.454) | 7,35 (.289)     | 2,76 (.109)                  |
|          | D          | 10,10 (.398) | 10,30 (.406) | 4,00 (.157)     | 17,50 (.689) | 12,94 (.509) | 8,70 (.343)     | 2,76 (.109)                  |

Termination Modifier: 1A7N, 1B7N, 1A9N, 1B9N, 2A7N, 2B7N, 2A9N, 2B9N

For other termination modifier, consult factory

## Weights

|  | Shell Size       | Male Contact       | Female Contact     |
|--|------------------|--------------------|--------------------|
| <b>Max Weight (grams) per contact</b>              |                  | 0,24 / 0,28 / 0,32 | 0,29 / 0,34 / 0,37 |
| <b>Max Weight (grams) of all contacts per size</b> | E                | 2,36               | 2,86               |
|  | A                | 3,92               | 4,75               |
|  | B                | 6,52               | 7,90               |
|  | C                | 9,64               | 11,68              |
|  | D                | 14,00              | 16,66              |
| <b>Max Weight (grams) of Brackets &amp; Nuts</b>   | Sizes E, A, B, C | 3,10               | 3,10               |
|  | Size D           | 3,80               | 3,80               |

# 3401-001 D\*M Standard Density

## Cross references

90° bent PCB (with brackets)

### Standard

| Description ESA/ESCC        | Part Number  |
|-----------------------------|--------------|
| 340100101B DEM 9P NMB 1A7N  | C115371-6200 |
| 340100101B DEM 9S NMB 1A7N  | C115371-6201 |
| 340100101B DAM 15P NMB 1A7N | C115371-6204 |
| 340100101B DAM 15S NMB 1A7N | C115371-6205 |
| 340100101B DBM 25P NMB 1A7N | C115371-6210 |
| 340100101B DBM 25S NMB 1A7N | C115371-6211 |
| 340100101B DCM 37P NMB 1A7N | C115371-6220 |
| 340100101B DCM 37S NMB 1A7N | C115371-6221 |
| 340100101B DDM 50P NMB 1A7N | C115371-6232 |
| 340100101B DDM 50S NMB 1A7N | C115371-6233 |
| 340100101B DEM 9P NMB 1B7N  | C115371-6250 |
| 340100101B DEM 9S NMB 1B7N  | C115371-6251 |
| 340100101B DAM 15P NMB 1B7N | C115371-6254 |
| 340100101B DAM 15S NMB 1B7N | C115371-6255 |
| 340100101B DBM 25P NMB 1B7N | C115371-6260 |
| 340100101B DBM 25S NMB 1B7N | C115371-6261 |
| 340100101B DCM 37P NMB 1B7N | C115371-6270 |
| 340100101B DCM 37S NMB 1B7N | C115371-6271 |
| 340100101B DDM 50P NMB 1B7N | C115371-6282 |
| 340100101B DDM 50S NMB 1B7N | C115371-6283 |
| 340100101B DEM 9P NMB 1A9N  | C115371-6300 |
| 340100101B DEM 9S NMB 1A9N  | C115371-6301 |
| 340100101B DAM 15P NMB 1A9N | C115371-6304 |
| 340100101B DAM 15S NMB 1A9N | C115371-6305 |
| 340100101B DBM 25P NMB 1A9N | C115371-6310 |
| 340100101B DBM 25S NMB 1A9N | C115371-6311 |
| 340100101B DCM 37P NMB 1A9N | C115371-6320 |
| 340100101B DCM 37S NMB 1A9N | C115371-6321 |
| 340100101B DDM 50P NMB 1A9N | C115371-6332 |
| 340100101B DDM 50S NMB 1A9N | C115371-6333 |
| 340100101B DEM 9P NMB 1B9N  | C115371-6350 |
| 340100101B DEM 9S NMB 1B9N  | C115371-6351 |
| 340100101B DAM 15P NMB 1B9N | C115371-6354 |
| 340100101B DAM 15S NMB 1B9N | C115371-6355 |
| 340100101B DBM 25P NMB 1B9N | C115371-6360 |
| 340100101B DBM 25S NMB 1B9N | C115371-6361 |
| 340100101B DCM 37P NMB 1B9N | C115371-6370 |
| 340100101B DCM 37S NMB 1B9N | C115371-6371 |
| 340100101B DDM 50P NMB 1B9N | C115371-6382 |
| 340100101B DDM 50S NMB 1B9N | C115371-6383 |
| 340100101B DEM 9P NMB 2A7N  | C115371-6400 |
| 340100101B DEM 9S NMB 2A7N  | C115371-6401 |
| 340100101B DAM 15P NMB 2A7N | C115371-6404 |
| 340100101B DAM 15S NMB 2A7N | C115371-6405 |
| 340100101B DBM 25P NMB 2A7N | C115371-6410 |
| 340100101B DBM 25S NMB 2A7N | C115371-6411 |
| 340100101B DCM 37P NMB 2A7N | C115371-6420 |

| Description FR022      | Part Number  |
|------------------------|--------------|
| DEM 9P NMB 1A7N-FR022  | C115371-4200 |
| DEM 9S NMB 1A7N-FR022  | C115371-4201 |
| DAM 15P NMB 1A7N-FR022 | C115371-4204 |
| DAM 15S NMB 1A7N-FR022 | C115371-4205 |
| DBM 25P NMB 1A7N-FR022 | C115371-4210 |
| DBM 25S NMB 1A7N-FR022 | C115371-4211 |
| DCM 37P NMB 1A7N-FR022 | C115371-4220 |
| DCM 37S NMB 1A7N-FR022 | C115371-4221 |
| DDM 50P NMB 1A7N-FR022 | C115371-4232 |
| DDM 50S NMB 1A7N-FR022 | C115371-4233 |
| DEM 9P NMB 1B7N-FR022  | C115371-4250 |
| DEM 9S NMB 1B7N-FR022  | C115371-4251 |
| DAM 15P NMB 1B7N-FR022 | C115371-4254 |
| DAM 15S NMB 1B7N-FR022 | C115371-4255 |
| DBM 25P NMB 1B7N-FR022 | C115371-4260 |
| DBM 25S NMB 1B7N-FR022 | C115371-4261 |
| DCM 37P NMB 1B7N-FR022 | C115371-4270 |
| DCM 37S NMB 1B7N-FR022 | C115371-4271 |
| DDM 50P NMB 1B7N-FR022 | C115371-4282 |
| DDM 50S NMB 1B7N-FR022 | C115371-4283 |
| DEM 9P NMB 1A9N-FR022  | C115371-4300 |
| DEM 9S NMB 1A9N-FR022  | C115371-4301 |
| DAM 15P NMB 1A9N-FR022 | C115371-4304 |
| DAM 15S NMB 1A9N-FR022 | C115371-4305 |
| DBM 25P NMB 1A9N-FR022 | C115371-4310 |
| DBM 25S NMB 1A9N-FR022 | C115371-4311 |
| DCM 37P NMB 1A9N-FR022 | C115371-4320 |
| DCM 37S NMB 1A9N-FR022 | C115371-4321 |
| DDM 50P NMB 1A9N-FR022 | C115371-4332 |
| DDM 50S NMB 1A9N-FR022 | C115371-4333 |
| DEM 9P NMB 1B9N-FR022  | C115371-4350 |
| DEM 9S NMB 1B9N-FR022  | C115371-4351 |
| DAM 15P NMB 1B9N-FR022 | C115371-4354 |
| DAM 15S NMB 1B9N-FR022 | C115371-4355 |
| DBM 25P NMB 1B9N-FR022 | C115371-4360 |
| DBM 25S NMB 1B9N-FR022 | C115371-4361 |
| DCM 37P NMB 1B9N-FR022 | C115371-4370 |
| DCM 37S NMB 1B9N-FR022 | C115371-4371 |
| DDM 50P NMB 1B9N-FR022 | C115371-4382 |
| DDM 50S NMB 1B9N-FR022 | C115371-4383 |
| DEM 9P NMB 2A7N-FR022  | C115371-4400 |
| DEM 9S NMB 2A7N-FR022  | C115371-4401 |
| DAM 15P NMB 2A7N-FR022 | C115371-4404 |
| DAM 15S NMB 2A7N-FR022 | C115371-4405 |
| DBM 25P NMB 2A7N-FR022 | C115371-4410 |
| DBM 25S NMB 2A7N-FR022 | C115371-4411 |
| DCM 37P NMB 2A7N-FR022 | C115371-4420 |



Dimensions are shown in mm (inch)  
Dimensions subject to change



## 3401-001 D\*M Standard Density

| Description ESA/ESCC |                  | Part Number  |
|----------------------|------------------|--------------|
| 340100101B           | DCM 37S NMB 2A7N | C115371-6421 |
| 340100101B           | DDM 50P NMB 2A7N | C115371-6432 |
| 340100101B           | DDM 50S NMB 2A7N | C115371-6433 |
| 340100101B           | DEM 9P NMB 2B7N  | C115371-6450 |
| 340100101B           | DEM 9S NMB 2B7N  | C115371-6451 |
| 340100101B           | DAM 15P NMB 2B7N | C115371-6454 |
| 340100101B           | DAM 15S NMB 2B7N | C115371-6455 |
| 340100101B           | DBM 25P NMB 2B7N | C115371-6460 |
| 340100101B           | DBM 25S NMB 2B7N | C115371-6461 |
| 340100101B           | DCM 37P NMB 2B7N | C115371-6470 |
| 340100101B           | DCM 37S NMB 2B7N | C115371-6471 |
| 340100101B           | DDM 50P NMB 2B7N | C115371-6482 |
| 340100101B           | DDM 50S NMB 2B7N | C115371-6483 |
| 340100101B           | DEM 9P NMB 2A9N  | C115371-6500 |
| 340100101B           | DEM 9S NMB 2A9N  | C115371-6501 |
| 340100101B           | DAM 15P NMB 2A9N | C115371-6504 |
| 340100101B           | DAM 15S NMB 2A9N | C115371-6505 |
| 340100101B           | DBM 25P NMB 2A9N | C115371-6510 |
| 340100101B           | DBM 25S NMB 2A9N | C115371-6511 |
| 340100101B           | DCM 37P NMB 2A9N | C115371-6520 |
| 340100101B           | DCM 37S NMB 2A9N | C115371-6521 |
| 340100101B           | DDM 50P NMB 2A9N | C115371-6532 |
| 340100101B           | DDM 50S NMB 2A9N | C115371-6533 |
| 340100101B           | DEM 9P NMB 2B9N  | C115371-6550 |
| 340100101B           | DEM 9S NMB 2B9N  | C115371-6551 |
| 340100101B           | DAM 15P NMB 2B9N | C115371-6554 |
| 340100101B           | DAM 15S NMB 2B9N | C115371-6555 |
| 340100101B           | DBM 25P NMB 2B9N | C115371-6560 |
| 340100101B           | DBM 25S NMB 2B9N | C115371-6561 |
| 340100101B           | DCM 37P NMB 2B9N | C115371-6570 |
| 340100101B           | DCM 37S NMB 2B9N | C115371-6571 |
| 340100101B           | DDM 50P NMB 2B9N | C115371-6582 |
| 340100101B           | DDM 50S NMB 2B9N | C115371-6583 |

| Description FR022      |  | Part Number  |
|------------------------|--|--------------|
| DCM 37S NMB 2A7N-FR022 |  | C115371-4421 |
| DDM 50P NMB 2A7N-FR022 |  | C115371-4432 |
| DDM 50S NMB 2A7N-FR022 |  | C115371-4433 |
| DEM 9P NMB 2B7N-FR022  |  | C115371-4450 |
| DEM 9S NMB 2B7N-FR022  |  | C115371-4451 |
| DAM 15P NMB 2B7N-FR022 |  | C115371-4454 |
| DAM 15S NMB 2B7N-FR022 |  | C115371-4455 |
| DBM 25P NMB 2B7N-FR022 |  | C115371-4460 |
| DBM 25S NMB 2B7N-FR022 |  | C115371-4461 |
| DCM 37P NMB 2B7N-FR022 |  | C115371-4470 |
| DCM 37S NMB 2B7N-FR022 |  | C115371-4471 |
| DDM 50P NMB 2B7N-FR022 |  | C115371-4482 |
| DDM 50S NMB 2B7N-FR022 |  | C115371-4483 |
| DEM 9P NMB 2A9N-FR022  |  | C115371-4500 |
| DEM 9S NMB 2A9N-FR022  |  | C115371-4501 |
| DAM 15P NMB 2A9N-FR022 |  | C115371-4504 |
| DAM 15S NMB 2A9N-FR022 |  | C115371-4505 |
| DBM 25P NMB 2A9N-FR022 |  | C115371-4510 |
| DBM 25S NMB 2A9N-FR022 |  | C115371-4511 |
| DCM 37P NMB 2A9N-FR022 |  | C115371-4520 |
| DCM 37S NMB 2A9N-FR022 |  | C115371-4521 |
| DDM 50P NMB 2A9N-FR022 |  | C115371-4532 |
| DDM 50S NMB 2A9N-FR022 |  | C115371-4533 |
| DEM 9P NMB 2B9N-FR022  |  | C115371-4550 |
| DEM 9S NMB 2B9N-FR022  |  | C115371-4551 |
| DAM 15P NMB 2B9N-FR022 |  | C115371-4554 |
| DAM 15S NMB 2B9N-FR022 |  | C115371-4555 |
| DBM 25P NMB 2B9N-FR022 |  | C115371-4560 |
| DBM 25S NMB 2B9N-FR022 |  | C115371-4561 |
| DCM 37P NMB 2B9N-FR022 |  | C115371-4570 |
| DCM 37S NMB 2B9N-FR022 |  | C115371-4571 |
| DDM 50P NMB 2B9N-FR022 |  | C115371-4582 |
| DDM 50S NMB 2B9N-FR022 |  | C115371-4583 |



*Dimensions are shown in mm (inch)  
Dimensions subject to change*

# 3401-001 D\*M Standard Density

90° Bent PCB solder Terminations / With Monoblock Plastic Brackets / U.S. Footprint type D and L

## Specific Dimensions

Sizes E, A, B, C

Size D

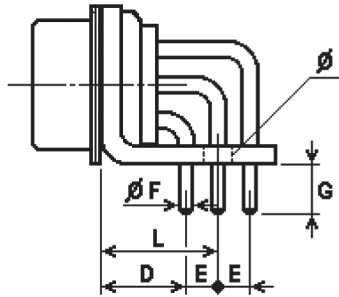
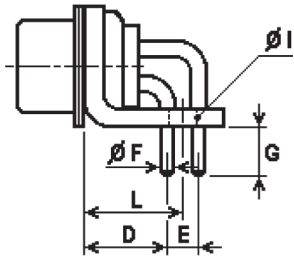

| Termination Modifier | ØF<br>± 0,05 (.002) | G<br>± 0,37 (.015) |
|----------------------|---------------------|--------------------|
| D                    | 0,76 (.030)         | 3,21 (.126)        |
| L                    | 0,76 (.030)         | 4,33 (.170)        |

1 piece plastic bracket  
Hole Ø I: 3,05 (.120) ± 0,13 (.005)

| Contacts | Shell Size | D min       | D max       | E Typical   | L ± 0,25 (.010) | Pitch between contacts |
|----------|------------|-------------|-------------|-------------|-----------------|------------------------|
| Male     | E          | 6,94 (.273) | 7,44 (.293) | 2,84 (.112) | 8,60 (.339)     | 2,74 (.108)            |
|          | A          | 6,94 (.273) | 7,44 (.293) | 2,84 (.112) | 8,60 (.339)     | 2,74 (.108)            |
|          | B          | 6,94 (.273) | 7,44 (.293) | 2,84 (.112) | 8,60 (.339)     | 2,76 (.109)            |
|          | C          | 6,94 (.273) | 7,44 (.293) | 2,84 (.112) | 8,60 (.339)     | 2,76 (.109)            |
| Female   | D          | 6,94 (.273) | 7,44 (.293) | 2,84 (.112) | 10.02 (.394)    | 2,76 (.109)            |
|          | E          | 6,94 (.273) | 7,44 (.293) | 2,84 (.112) | 8,60 (.339)     | 2,74 (.108)            |
|          | A          | 6,94 (.273) | 7,44 (.293) | 2,84 (.112) | 8,60 (.339)     | 2,74 (.108)            |
|          | B          | 6,94 (.273) | 7,44 (.293) | 2,84 (.112) | 8,60 (.339)     | 2,76 (.109)            |
|          | C          | 6,94 (.273) | 7,44 (.293) | 2,84 (.112) | 8,60 (.339)     | 2,76 (.109)            |
|          | D          | 6,94 (.273) | 7,44 (.293) | 2,84 (.112) | 10.02 (.394)    | 2,76 (.109)            |

Termination Modifier: D, L

For other termination modifier, consult factory

## Weights

|  | Shell Size | Male Contact       | Female Contact     | Plastic Bracket |
|--|------------|--------------------|--------------------|-----------------|
| <b>Max Weight (grams) per contact</b>              |            | 0,22 / 0,96 / 0,30 | 0,27 / 0,32 / 0,35 |                 |
| <b>Max Weight (grams) of all contacts per size</b> | E          | 2,18               | 2,68               | 1,49            |
|  | A          | 3,62               | 4,45               | 1,72            |
|  | B          | 6,02               | 7,40               | 2,05            |
|  | C          | 8,90               | 10,94              | 2,41            |
|  | D          | 13,00              | 15,66              | 3,22            |

# 3401-001 D\*M Standard Density

## 90° Bent PCB solder Terminations / With Brackets / US Footprint Type L7 – L9

### Specific Dimensions

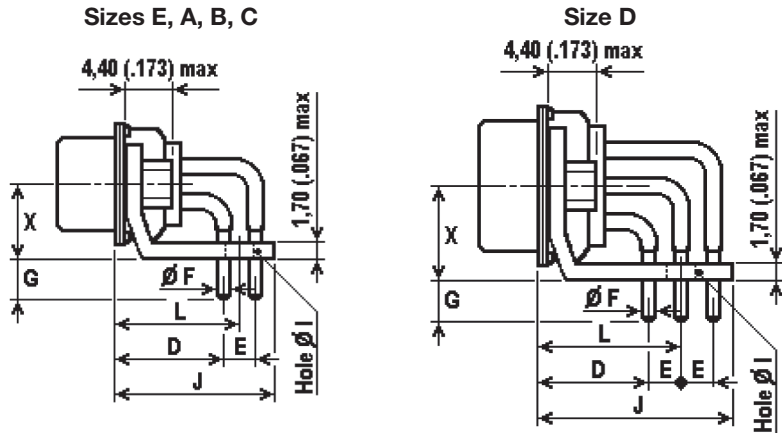

| Termination Modifier | ØF<br>± 0,05 (.002) | E<br>Typical |
|----------------------|---------------------|--------------|
| L7                   | 0,76 (.030)         | 2,84 (.112)  |
| L9                   | 0,76 (.030)         | 2,84 (.112)  |

2 pieces metal brackets:

“L7”: fixed with captive nuts 4-40 UNC-2B

“L9”: fixed with captive nuts M3

Hole Ø I: 3,22 (.127) ± 0,10 (.004)

Bracket width (onto PCB):

Shell sizes E, A, B, C, D: 5,70 (.224) max

| Contacts | Shell Size | D min       | D max       | G ± 0.37 (.015) | J max        | L Typical    | X ± 0,15 (.006) | Pitch between contacts |
|----------|------------|-------------|-------------|-----------------|--------------|--------------|-----------------|------------------------|
| Male     | E          | 6,94 (.273) | 7,44 (.293) | 4,33 (.170)     | 11,80 (.464) | 8,60 (.339)  | 6,35 (.250)     | 2,74 (.108)            |
|          | A          | 6,94 (.273) | 7,44 (.293) | 4,33 (.170)     | 11,80 (.464) | 8,60 (.339)  | 6,35 (.250)     | 2,74 (.108)            |
|          | B          | 6,94 (.273) | 7,44 (.293) | 4,33 (.170)     | 11,80 (.464) | 8,60 (.339)  | 6,35 (.250)     | 2,76 (.109)            |
|          | C          | 6,94 (.273) | 7,44 (.293) | 4,33 (.170)     | 11,80 (.464) | 8,60 (.339)  | 6,35 (.250)     | 2,76 (.109)            |
|          | D          | 6,94 (.273) | 7,44 (.293) | 4,33 (.170)     | 11,80 (.464) | 10,05 (.396) | 7,75 (.305)     | 2,76 (.109)            |
| Female   | E          | 6,94 (.273) | 7,44 (.293) | 4,33 (.170)     | 11,80 (.464) | 8,60 (.339)  | 6,35 (.250)     | 2,74 (.108)            |
|          | A          | 6,94 (.273) | 7,44 (.293) | 4,33 (.170)     | 11,80 (.464) | 8,60 (.339)  | 6,35 (.250)     | 2,74 (.108)            |
|          | B          | 6,94 (.273) | 7,44 (.293) | 4,33 (.170)     | 11,80 (.464) | 8,60 (.339)  | 6,35 (.250)     | 2,76 (.109)            |
|          | C          | 6,94 (.273) | 7,44 (.293) | 4,33 (.170)     | 11,80 (.464) | 8,60 (.339)  | 6,35 (.250)     | 2,76 (.109)            |
|          | D          | 6,94 (.273) | 7,44 (.293) | 4,33 (.170)     | 11,80 (.464) | 10,05 (.396) | 7,75 (.305)     | 2,76 (.109)            |

Termination Modifier: L7 / L9

For other termination modifier, consult factory

### Weights

|  | Shell Size | Male Contact       | Female Contact     |
|--|------------|--------------------|--------------------|
| <b>Max Weight (grams) per contact</b>              |            | 0,24 / 0,28 / 0,32 | 0,29 / 0,34 / 0,37 |
| <b>Max Weight (grams) of all contacts per size</b> | E          | 2,36               | 2,86               |
|  | A          | 3,92               | 4,75               |
|  | B          | 6,52               | 7,90               |
|  | C          | 9,64               | 11,68              |
|  | D          | 14,00              | 16,66              |
| <b>Max Weight (grams) of Brackets &amp; Nuts</b>   | E, A, B, C | 3,00               | 3,00               |
|  | D          | 3,60               | 3,60               |

# 3401-001 D\*M Standard Density

## Cross references

90° bent PCB (with brackets)

## Standard

### L7

| Description ESA/ESCC |                | Part Number  | Description FR022   |              | Part Number |
|----------------------|----------------|--------------|---------------------|--------------|-------------|
| 340100101B           | DEM 9P NMB L7  | C115331-9142 | DEM 9P NMBL7-FR022  | C115371-0126 |             |
| 340100101B           | DEM 9S NMB L7  | C115331-9143 | DEM 9S NMBL7-FR022  | C115371-0127 |             |
| 340100101B           | DAM 15P NMB L7 | C115371-9146 | DAM 15P NMBL7-FR022 | C115371-0130 |             |
| 340100101B           | DAM 15S NMB L7 | C115371-9147 | DAM 15S NMBL7-FR022 | C115371-0131 |             |
| 340100101B           | DBM 25P NMB L7 | C115371-9156 | DBM 25P NMBL7-FR022 | C115371-0140 |             |
| 340100101B           | DBM 25S NMB L7 | C115371-9157 | DBM 25S NMBL7-FR022 | C115371-0141 |             |
| 340100101B           | DCM 37P NMB L7 | C115371-9168 | DCM 37P NMBL7-FR022 | C115371-0152 |             |
| 340100101B           | DCM 37S NMB L7 | C115371-9169 | DCM 37S NMBL7-FR022 | C115371-0153 |             |
| 340100101B           | DDM 50P NMB L7 | C115371-9182 | DDM 50P NMBL7-FR022 | C115371-0166 |             |
| 340100101B           | DDM 50S NMB L7 | C115371-9183 | DDM 50S NMBL7-FR022 | C115371-0167 |             |

### L9

| Description ESA/ESCC |                | Part Number  | Description FR022   |              | Part Number |
|----------------------|----------------|--------------|---------------------|--------------|-------------|
| 340100101B           | DEM 9P NMB L9  | C115331-9192 | DEM 9P NMBL9-FR022  | C115371-0176 |             |
| 340100101B           | DEM 9S NMB L9  | C115331-9193 | DEM 9S NMBL9-FR022  | C115371-0177 |             |
| 340100101B           | DAM 15P NMB L9 | C115371-9196 | DAM 15P NMBL9-FR022 | C115371-0180 |             |
| 340100101B           | DAM 15S NMB L9 | C115371-9197 | DAM 15S NMBL9-FR022 | C115371-0181 |             |
| 340100101B           | DBM 25P NMB L9 | C115371-9206 | DBM 25P NMBL9-FR022 | C115371-0190 |             |
| 340100101B           | DBM 25S NMB L9 | C115371-9207 | DBM 25S NMBL9-FR022 | C115371-0191 |             |
| 340100101B           | DCM 37P NMB L9 | C115371-9218 | DCM 37P NMBL9-FR022 | C115371-0202 |             |
| 340100101B           | DCM 37S NMB L9 | C115371-9219 | DCM 37S NMBL9-FR022 | C115371-0203 |             |
| 340100101B           | DDM 50P NMB L9 | C115371-9232 | DDM 50P NMBL9-FR022 | C115371-0216 |             |
| 340100101B           | DDM 50S NMB L9 | C115371-9233 | DDM 50S NMBL9-FR022 | C115371-0217 |             |

# 3401-001 D\*M Standard Density

## Wire-Wrap Terminations type F179A.

### Specific Dimensions

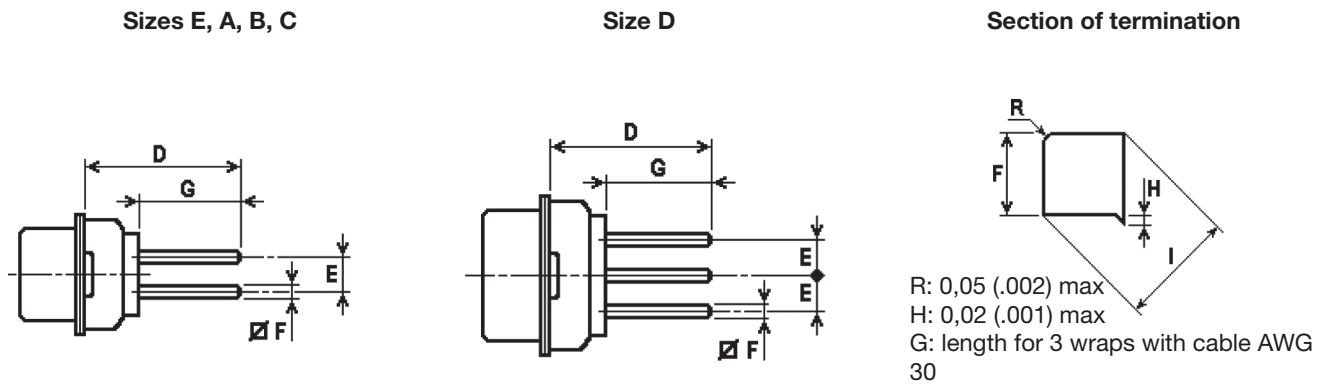

| Contacts | Shell Size | D max        | G ± 0,10 (.004) | E Typical   | F ± 0,01 (.0004) | I ± 0,038 (.0015) | Pitch between contacts |
|----------|------------|--------------|-----------------|-------------|------------------|-------------------|------------------------|
| Male     | E          | 20,10 (.791) | 12,70 (.500)    | 2,84 (.112) | 0,60 (.024)      | 0,826 (.0325)     | 2,74 (.108)            |
|          | A          | 20,10 (.791) | 12,70 (.500)    | 2,84 (.112) | 0,60 (.024)      | 0,826 (.0325)     | 2,74 (.108)            |
|          | B          | 20,30 (.799) | 12,70 (.500)    | 2,84 (.112) | 0,60 (.024)      | 0,826 (.0325)     | 2,76 (.109)            |
|          | C          | 20,30 (.799) | 12,70 (.500)    | 2,84 (.112) | 0,60 (.024)      | 0,826 (.0325)     | 2,76 (.109)            |
|          | D          | 20,30 (.799) | 12,70 (.500)    | 2,84 (.112) | 0,60 (.024)      | 0,826 (.0325)     | 2,76 (.109)            |
| Female   | E          | 20,10 (.791) | 12,70 (.500)    | 2,84 (.112) | 0,60 (.024)      | 0,826 (.0325)     | 2,74 (.108)            |
|          | A          | 20,10 (.791) | 12,70 (.500)    | 2,84 (.112) | 0,60 (.024)      | 0,826 (.0325)     | 2,74 (.108)            |
|          | B          | 20,10 (.791) | 12,70 (.500)    | 2,84 (.112) | 0,60 (.024)      | 0,826 (.0325)     | 2,76 (.109)            |
|          | C          | 20,10 (.791) | 12,70 (.500)    | 2,84 (.112) | 0,60 (.024)      | 0,826 (.0325)     | 2,76 (.109)            |
|          | D          | 20,10 (.791) | 12,70 (.500)    | 2,84 (.112) | 0,60 (.024)      | 0,826 (.0325)     | 2,76 (.109)            |

Termination Modifier: F179A  
For other termination modifier, consult factory

### Weights

|  | Shell Size | Male Contact | Female Contact |
|--|------------|--------------|----------------|
| <b>Max Weight (grams) per contact</b>              |            | 0,28         | 0,34           |
| <b>Max Weight (grams) of all contacts per size</b> | E          | 2,52         | 3,06           |
|  | A          | 4,20         | 5,10           |
|  | B          | 7,00         | 8,50           |
|  | C          | 10,36        | 12,58          |
|  | D          | 14,00        | 17,00          |

# 3401-001 D\*M Standard Density

## Cross references

Solder bucket

## Standard

| Description ESA/ESCC         | Part Number  |
|------------------------------|--------------|
| 340100101B DEM 9P NMB F179A  | C115371-5450 |
| 340100101B DEM 9S NMB F179A  | C115371-5451 |
| 340100101B DAM 15P NMB F179A | C115371-5454 |
| 340100101B DAM 15S NMB F179A | C115371-5455 |
| 340100101B DBM 25P NMB F179A | C115371-5460 |
| 340100101B DBM 25S NMB F179A | C115371-5461 |
| 340100101B DCM 37P NMB F179A | C115371-5470 |
| 340100101B DCM 37S NMB F179A | C115371-5471 |
| 340100101B DDM 50P NMB F179A | C115371-5482 |
| 340100101B DDM 50S NMB F179A | C115371-5483 |

| Description FR022       | Part Number  |
|-------------------------|--------------|
| DEM 9P NMB F179A-FR022  | C115371-3450 |
| DEM 9S NMB F179A-FR022  | C115371-3451 |
| DAM 15P NMB F179A-FR022 | C115371-3454 |
| DAM 15S NMB F179A-FR022 | C115371-3455 |
| DBM 25P NMB F179A-FR022 | C115371-3460 |
| DBM 25S NMB F179A-FR022 | C115371-3461 |
| DCM 37P NMB F179A-FR022 | C115371-3470 |
| DCM 37S NMB F179A-FR022 | C115371-3471 |
| DDM 50P NMB F179A-FR022 | C115371-3482 |
| DDM 50S NMB F179A-FR022 | C115371-3483 |

## Option Y

| Description ESA/ESCC          | Part Number  |
|-------------------------------|--------------|
| 340100101B DEMY 9P NMB F179A  | C115371-5500 |
| 340100101B DEMY 9S NMB F179A  | C115371-5501 |
| 340100101B DAMY 15P NMB F179A | C115371-5504 |
| 340100101B DAMY 15S NMB F179A | C115371-5505 |
| 340100101B DBMY 25P NMB F179A | C115371-5510 |
| 340100101B DBMY 25S NMB F179A | C115371-5511 |
| 340100101B DCMY 37P NMB F179A | C115371-5520 |
| 340100101B DCMY 37S NMB F179A | C115371-5521 |
| 340100101B DDMY 50P NMB F179A | C115371-5532 |
| 340100101B DDMY 50S NMB F179A | C115371-5533 |

| Description FR022        | Part Number  |
|--------------------------|--------------|
| DEMY 9P NMB F179A-FR022  | C115371-3500 |
| DEMY 9S NMB F179A-FR022  | C115371-3501 |
| DAMY 15P NMB F179A-FR022 | C115371-3504 |
| DAMY 15S NMB F179A-FR022 | C115371-3505 |
| DBMY 25P NMB F179A-FR022 | C115371-3510 |
| DBMY 25S NMB F179A-FR022 | C115371-3511 |
| DCMY 37P NMB F179A-FR022 | C115371-3520 |
| DCMY 37S NMB F179A-FR022 | C115371-3521 |
| DDMY 50P NMB F179A-FR022 | C115371-3532 |
| DDMY 50S NMB F179A-FR022 | C115371-3533 |

## Option E

| Description ESA/ESCC          | Part Number  |
|-------------------------------|--------------|
| 340100101B DEME 9P NMB F179A  | C115371-5550 |
| 340100101B DEME 9S NMB F179A  | C115371-5551 |
| 340100101B DAME 15P NMB F179A | C115371-5554 |
| 340100101B DAME 15S NMB F179A | C115371-5555 |
| 340100101B DBME 25P NMB F179A | C115371-5560 |
| 340100101B DBME 25S NMB F179A | C115371-5561 |
| 340100101B DCME 37P NMB F179A | C115371-5570 |
| 340100101B DCME 37S NMB F179A | C115371-5571 |
| 340100101B DDME 50P NMB F179A | C115371-5582 |
| 340100101B DDME 50S NMB F179A | C115371-5583 |

| Description FR022        | Part Number  |
|--------------------------|--------------|
| DEME 9P NMB F179A-FR022  | C115371-3550 |
| DEME 9S NMB F179A-FR022  | C115371-3551 |
| DAME 15P NMB F179A-FR022 | C115371-3554 |
| DAME 15S NMB F179A-FR022 | C115371-3555 |
| DBME 25P NMB F179A-FR022 | C115371-3560 |
| DBME 25S NMB F179A-FR022 | C115371-3561 |
| DCME 37P NMB F179A-FR022 | C115371-3570 |
| DCME 37S NMB F179A-FR022 | C115371-3571 |
| DDME 50P NMB F179A-FR022 | C115371-3582 |
| DDME 50S NMB F179A-FR022 | C115371-3583 |

## Combination Arrangements

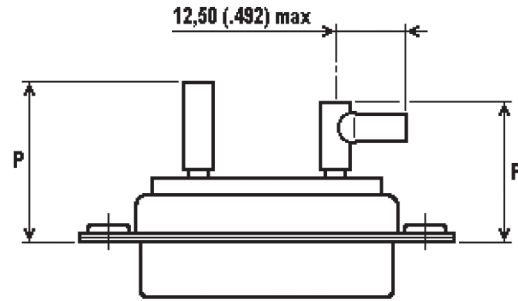
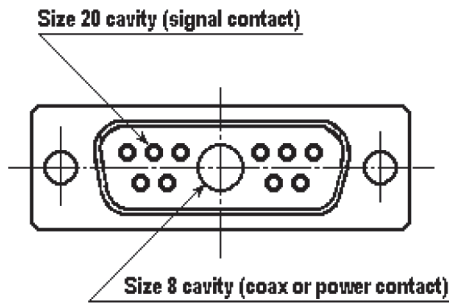

**P max (Coaxial Contacts)**

| Contacts | Shell Size | Note 1       | Note 2       | Note 3       | Note 4       |
|----------|------------|--------------|--------------|--------------|--------------|
| Male     | E          | 19,60 (.772) | 22,30 (.878) | 14,30 (.563) | 14,40 (.567) |
|          | A          | 19,60 (.772) | 22,30 (.878) | 14,30 (.563) | 14,40 (.567) |
|          | B          | 19,80 (.780) | 22,50 (.886) | 14,50 (.571) | 14,60 (.575) |
|          | C          | 19,80 (.780) | 22,50 (.886) | 14,50 (.571) | 14,60 (.575) |
|          | D          | 19,80 (.780) | 22,50 (.886) | 14,50 (.571) | 14,60 (.575) |
| Female   | E          | 19,60 (.772) | 22,30 (.878) | 14,30 (.563) | 14,40 (.567) |
|          | A          | 19,60 (.772) | 22,30 (.878) | 14,30 (.563) | 14,40 (.567) |
|          | B          | 19,60 (.772) | 22,30 (.878) | 14,30 (.563) | 14,40 (.567) |
|          | C          | 19,60 (.772) | 22,30 (.878) | 14,30 (.563) | 14,40 (.567) |
|          | D          | 19,60 (.772) | 22,30 (.878) | 14,30 (.563) | 14,40 (.567) |

**P max (Power Contacts)**

| Note 5       | Note 6       | Note 7       | Note 8       |
|--------------|--------------|--------------|--------------|
| 17,70 (.697) | 19,80 (.780) | 16,90 (.665) | 14,60 (.575) |
| 17,70 (.697) | 19,80 (.780) | 16,90 (.665) | 14,60 (.575) |
| 17,90 (.705) | 20,00 (.787) | 17,10 (.673) | 14,80 (.583) |
| 17,90 (.705) | 20,00 (.787) | 17,10 (.673) | 14,80 (.583) |
| 17,90 (.705) | 20,00 (.787) | 17,10 (.673) | 14,80 (.583) |
| 17,70 (.697) | 19,80 (.780) | 16,90 (.665) | 14,60 (.575) |
| 17,70 (.697) | 19,80 (.780) | 16,90 (.665) | 14,60 (.575) |
| 17,70 (.697) | 19,80 (.780) | 16,90 (.665) | 14,60 (.575) |
| 17,70 (.697) | 19,80 (.780) | 16,90 (.665) | 14,60 (.575) |
| 17,70 (.697) | 19,80 (.780) | 16,90 (.665) | 14,60 (.575) |

Note 1: ESA/ESCC 3401/004 variants 01 / 02 / 05 / 06 / 11 / 12 / 15 / 16

Note 2: ESA/ESCC 3401/004 variants 09 / 10 / 19 / 20

Note 3: ESA/ESCC 3401/004 variants 03 / 04 / 07 / 08

Note 4: ESA/ESCC 3401/004 variants 13 / 14 / 17 / 18

Note 5: ESA/ESCC 3401/040 variants 01 / 02 / 03 / 04 / 05 / 06

Note 6: ESA/ESCC 3401/040 variants 07 / 08

Note 7: ESA/ESCC 3401/040 variants 09 / 10

Note 8: ESA/ESCC 3401/040 variants 11 / 12

## Combination Arrangements

| Shell Size |      |      |      |       |      |      |
|------------|------|------|------|-------|------|------|
| E          | 5W1  |      |      |       |      |      |
| A          | 3W3  | 3WK3 | 7W2  | 11W1  |      |      |
| B          | 5W5  | 9W4  | 13W3 | 17W2  | 21W1 |      |
| C          | 8W8  | 13W6 | 17W5 | 21WA4 | 25W3 | 27W2 |
| D          | 24W7 | 36W4 | 43W2 | 47W1  |      |      |

# 3401-001 D\*M Standard Density

## PCB Hole Pattern

Face view, pin insert

### Size E

9 contacts

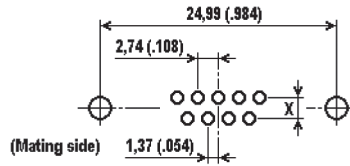

### Size A

15 contacts

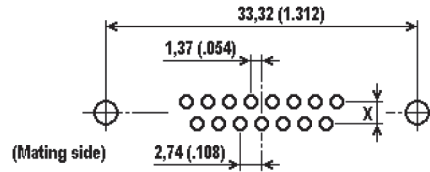

### Size B

25 contacts

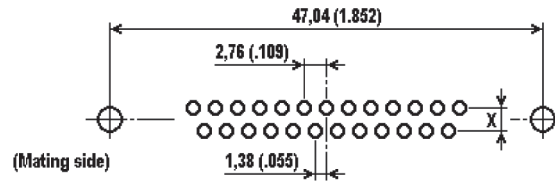

### Size C

37 contacts

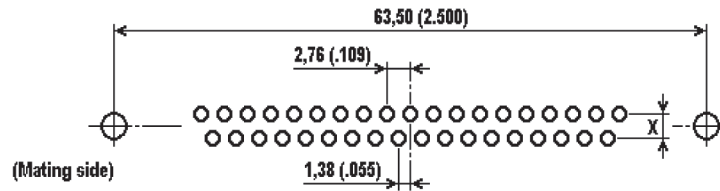

### Size D

50 contacts

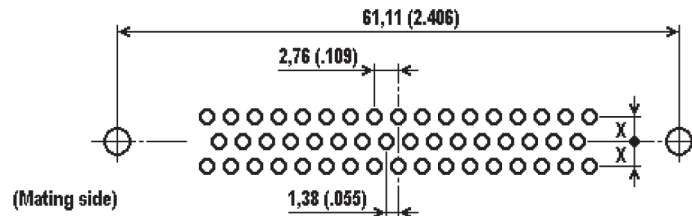

### Dimension X

- 2,54 (.100) for "90° bent PCB / European Footprint Type 1AxN and 2AxN"
- 2,84 (.112) for "Straight PCB", "90° bent PCB / European Footprint Type 1BxN and 2BxN", and "90° bent PCB / U.S. Footprint"

### Recommended PCB hole for signal contacts

- $\varnothing$  1,00 (.040) min for terminations  $\varnothing$  0,60 (.024)
- $\varnothing$  1,15 (.045) min for terminations  $\varnothing$  0,76 (.030)





*Dimensions are shown in mm (inch)  
Dimensions subject to change*



*Dimensions are shown in mm (inch)  
Dimensions subject to change*



*Dimensions are shown in mm (inch)  
Dimensions subject to change*

Компания «Океан Электроники» предлагает заключение долгосрочных отношений при поставках импортных электронных компонентов на взаимовыгодных условиях!

Наши преимущества:

- Поставка оригинальных импортных электронных компонентов напрямую с производств Америки, Европы и Азии, а так же с крупнейших складов мира;
- Широкая линейка поставок активных и пассивных импортных электронных компонентов (более 30 млн. наименований);
- Поставка сложных, дефицитных, либо снятых с производства позиций;
- Оперативные сроки поставки под заказ (от 5 рабочих дней);
- Экспресс доставка в любую точку России;
- Помощь Конструкторского Отдела и консультации квалифицированных инженеров;
- Техническая поддержка проекта, помощь в подборе аналогов, поставка прототипов;
- Поставка электронных компонентов под контролем ВП;
- Система менеджмента качества сертифицирована по Международному стандарту ISO 9001;
- При необходимости вся продукция военного и аэрокосмического назначения проходит испытания и сертификацию в лаборатории (по согласованию с заказчиком);
- Поставка специализированных компонентов военного и аэрокосмического уровня качества (Xilinx, Altera, Analog Devices, Intersil, Interpoint, Microsemi, Actel, Aeroflex, Peregrine, VPT, Syfer, Eurofarad, Texas Instruments, MS Kennedy, Miteq, Cobham, E2V, MA-COM, Hittite, Mini-Circuits, General Dynamics и др.);

Компания «Океан Электроники» является официальным дистрибьютором и эксклюзивным представителем в России одного из крупнейших производителей разъемов военного и аэрокосмического назначения «JONHON», а так же официальным дистрибьютором и эксклюзивным представителем в России производителя высокотехнологичных и надежных решений для передачи СВЧ сигналов «FORSTAR».



## JONHON

«JONHON» (основан в 1970 г.)

Разъемы специального, военного и аэрокосмического назначения:

(Применяются в военной, авиационной, аэрокосмической, морской, железнодорожной, горно- и нефтедобывающей отраслях промышленности)

«FORSTAR» (основан в 1998 г.)

ВЧ соединители, коаксиальные кабели, кабельные сборки и микроволновые компоненты:

(Применяются в телекоммуникациях гражданского и специального назначения, в средствах связи, РЛС, а так же военной, авиационной и аэрокосмической отраслях промышленности).



Телефон: 8 (812) 309-75-97 (многоканальный)

Факс: 8 (812) 320-03-32

Электронная почта: [ocean@oceanchips.ru](mailto:ocean@oceanchips.ru)

Web: <http://oceanchips.ru/>

Адрес: 198099, г. Санкт-Петербург, ул. Калинина, д. 2, корп. 4, лит. А