

# FOR BOARD-TO-CABLE CONNECTION

## 240R SERIES

### ■ FEATURES

- 1.27 mm (0.050 in.) pitch contact arrangement enables high-density mounting.
- Bellows contacts ensure stable contact preventing pins from bending. The bellows contacts also have excellent stability with repeated insertion and extraction.
- Cables and connectors are assembled by discrete wire IDC.
- Connectors on the cable side provide superb EMI shielding/ESD protection with an inner-metal and outer-plastic dual cover.
- Conforms to IEEE 1284.C Interface
- Tails are spaced in a four-row staggered arrangement (2.54 mm × 1.905 mm) (0.100 in. × 0.075 in.) for easy PC board design.



### ■ SPECIFICATIONS

| Item                         | Specifications   |
|------------------------------|--|
| Operating temperature range  | -55°C to +85°C   |
| Current rating               | DC 1 A   |
| Voltage rating               | AC 240 V   |
| Contact resistance           | 50 mΩ max. (DC 20 mV, 10 mA)   |
| Insulation resistance        | 1,000 MΩ min. (DC 500 V)   |
| Dielectric withstand voltage | AC 750 V for 1 minute  |
| Applicable wire              | AWG #28 and #30 stranded wires with φ0.5 to 0.65 mm (0.020 to 0.026 in.) insulation diameter |

### ■ MATERIALS

| Item      | Materials           |                   |
|-----------|---------------------|-------------------|
| Insulator | Polyester (UL94V-0) |                   |
| Conductor | Copper alloy        |                   |
| Plating   | Contact             | Gold plating      |
|           | Terminal            | Palladium plating |

### ■ ORDERING CODE

FCN-24 5 D 050-G / E

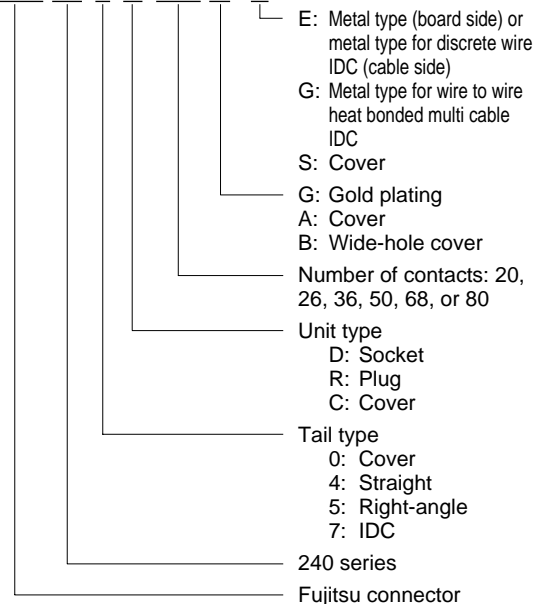

## STRAIGHT SOCKET

### ■ DIMENSIONS

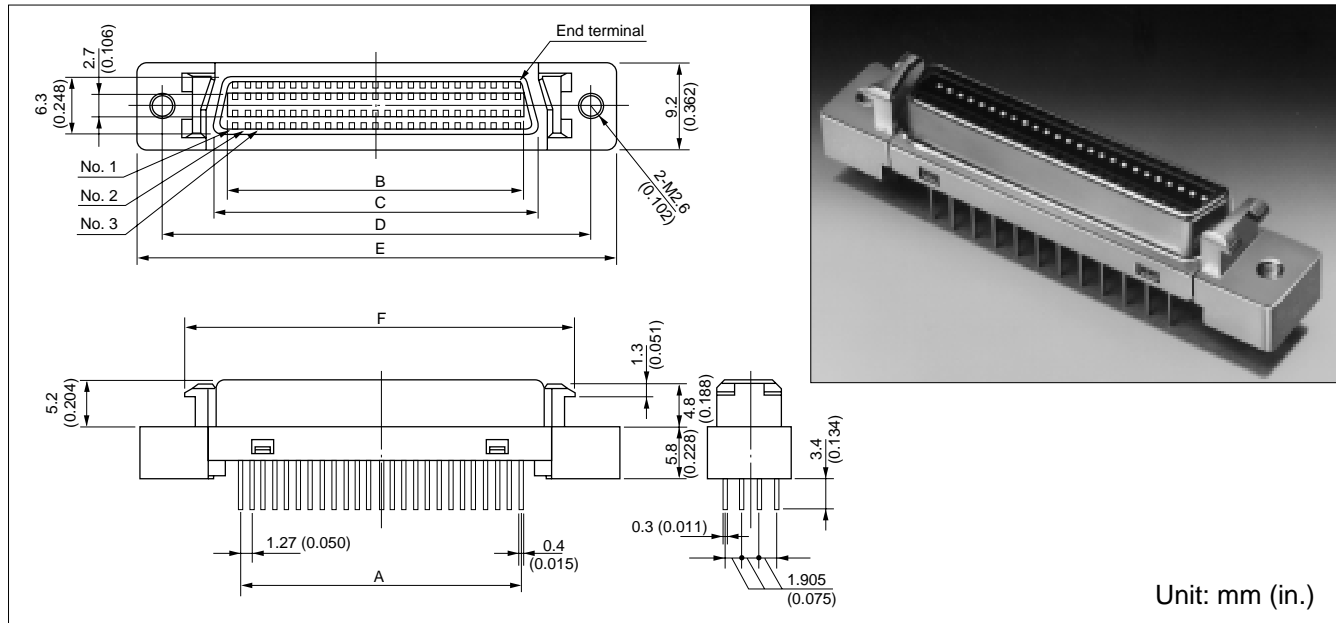

### ■ MOUNTING HOLE LAYOUT (COMPONENT SIDE)

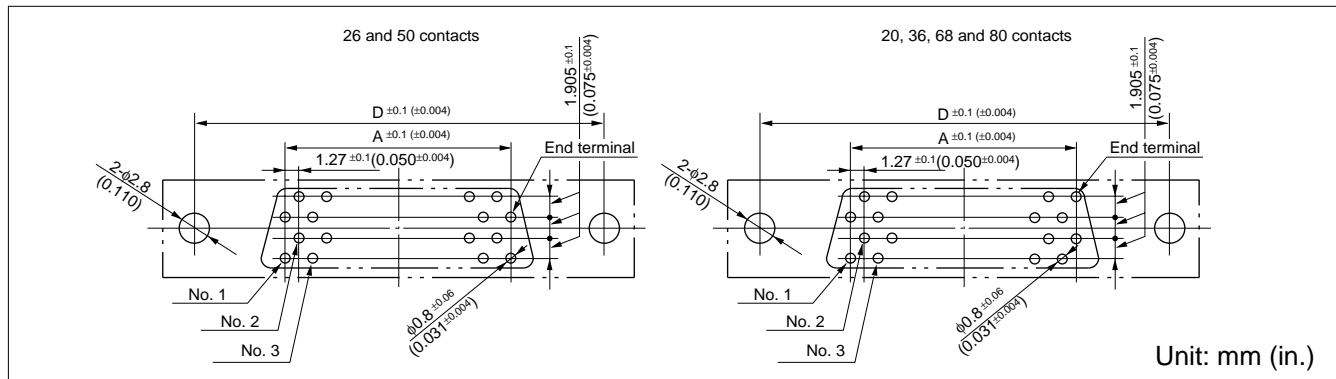

### ■ PATTERN INHIBITED AREAS

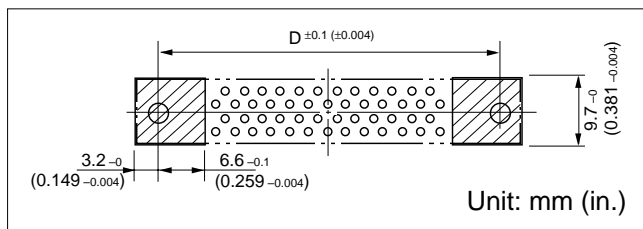

### ■ RECOMMENDED PANEL DIMENSIONS

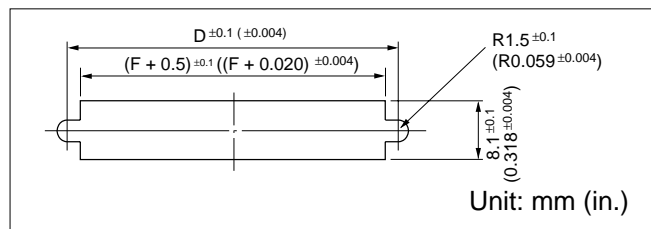

### ■ PART NUMBERS AND DIMENSIONS

Unit: mm (in.)

| Number of contacts | Part number     | A             | B             | C             | D             | E             | F             |
|--------------------|-----------------|---------------|---------------|---------------|---------------|---------------|---------------|
| 20                 | FCN-244D020-G/E | 11.43 (0.450) | 13.45 (0.529) | 16.45 (0.647) | 27.45 (1.080) | 33.35 (1.312) | 23.30 (0.917) |
| 26                 | FCN-244D026-G/E | 15.24 (0.600) | 17.26 (0.679) | 20.26 (0.797) | 31.26 (1.231) | 37.16 (1.462) | 27.11 (1.067) |
| 36                 | FCN-244D036-G/E | 21.59 (0.850) | 23.61 (0.929) | 26.61 (1.047) | 37.61 (1.480) | 43.51 (1.712) | 33.46 (1.317) |
| 50                 | FCN-244D050-G/E | 30.48 (1.200) | 32.50 (1.279) | 35.50 (1.397) | 46.50 (1.830) | 52.40 (2.062) | 42.35 (1.667) |
| 68                 | FCN-244D068-G/E | 41.91 (1.650) | 43.93 (1.729) | 46.93 (1.847) | 57.93 (2.280) | 63.83 (2.512) | 53.78 (2.117) |
| 80                 | FCN-244D080-G/E | 49.53 (1.950) | 51.55 (2.029) | 54.55 (2.147) | 65.55 (2.580) | 71.45 (2.812) | 61.40 (2.417) |

## RIGHT-ANGLE SOCKET [METAL SHELL]

### ■ DIMENSIONS

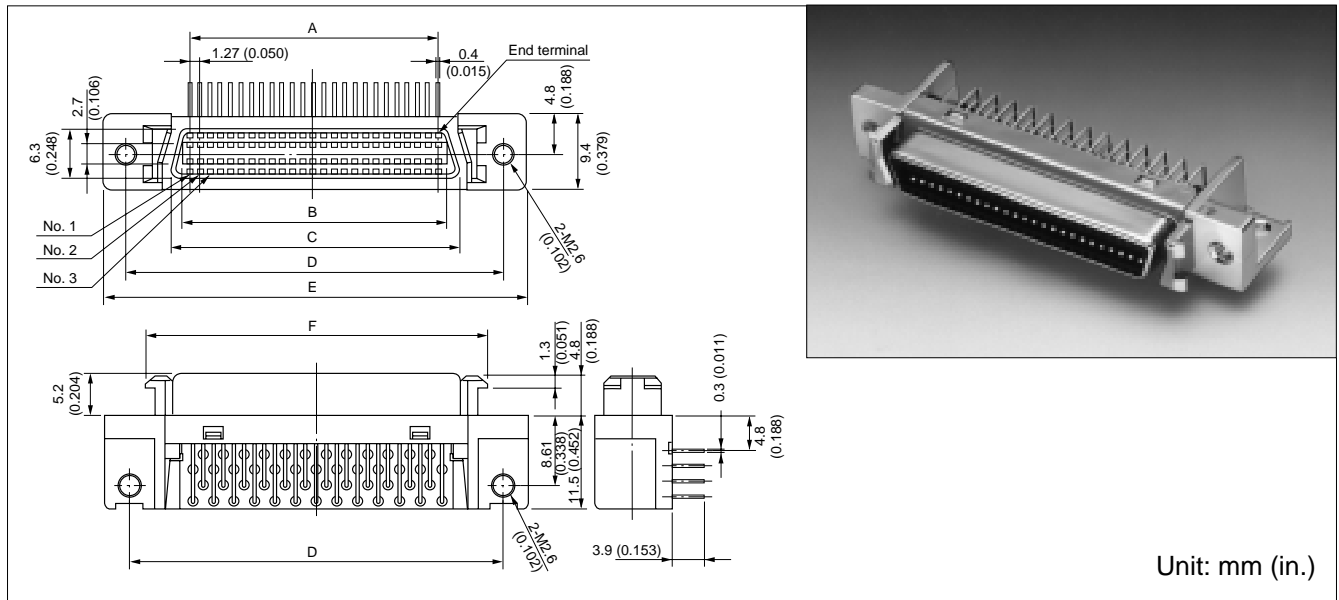

### ■ MOUNTING HOLE LAYOUT (COMPONENT SIDE)

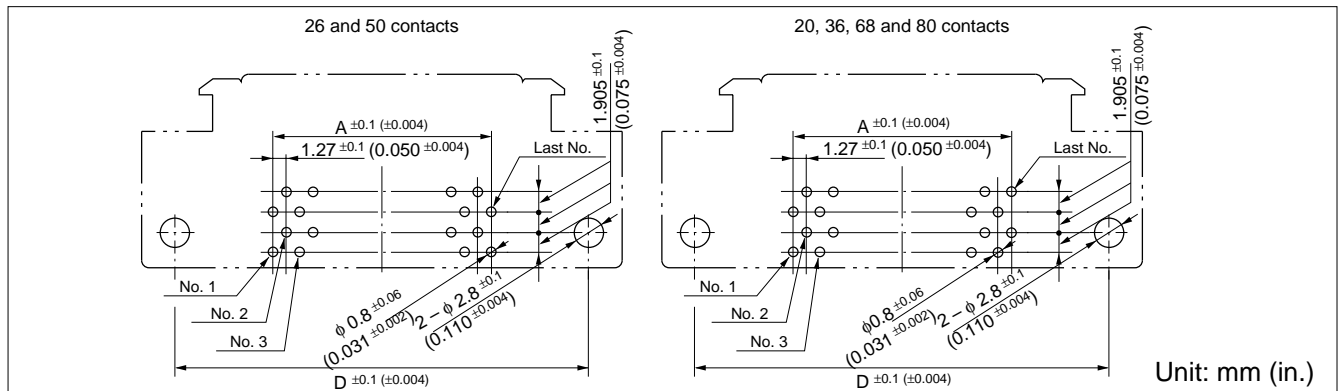

### ■ PATTERN INHIBITED AREAS

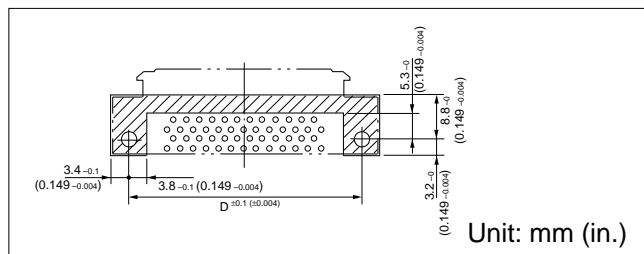

### ■ RECOMMENDED PANEL DIMENSIONS

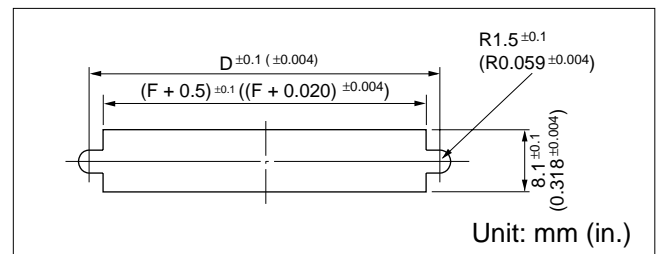

### ■ PART NUMBERS AND DIMENSIONS

Unit: mm (in.)

| Number of contacts | Part number     | A             | B             | C             | D             | E             | F             |
|--------------------|-----------------|---------------|---------------|---------------|---------------|---------------|---------------|
| 20                 | FCN-245D020-G/E | 11.43 (0.450) | 13.45 (0.529) | 16.45 (0.647) | 27.45 (1.080) | 33.35 (1.312) | 23.30 (0.917) |
| 26                 | FCN-245D026-G/E | 15.24 (0.600) | 17.26 (0.679) | 20.26 (0.797) | 31.26 (1.231) | 37.16 (1.462) | 27.11 (1.067) |
| 36                 | FCN-245D036-G/E | 21.59 (0.850) | 23.61 (0.929) | 26.61 (1.047) | 37.61 (1.480) | 43.51 (1.712) | 33.46 (1.317) |
| 50                 | FCN-245D050-G/E | 30.48 (1.200) | 32.50 (1.279) | 35.50 (1.397) | 46.50 (1.830) | 52.40 (2.062) | 42.35 (1.667) |
| 68                 | FCN-245D068-G/E | 41.91 (1.650) | 43.93 (1.729) | 46.93 (1.847) | 57.93 (2.280) | 63.83 (2.512) | 53.78 (2.117) |
| 80                 | FCN-245D080-G/E | 49.53 (1.950) | 51.55 (2.029) | 54.55 (2.147) | 65.55 (2.580) | 71.45 (2.812) | 61.40 (2.417) |

## RIGHT-ANGLE SOCKET [METAL SHELL] (WITH BOARDLOCKS)

### ■ DIMENSIONS

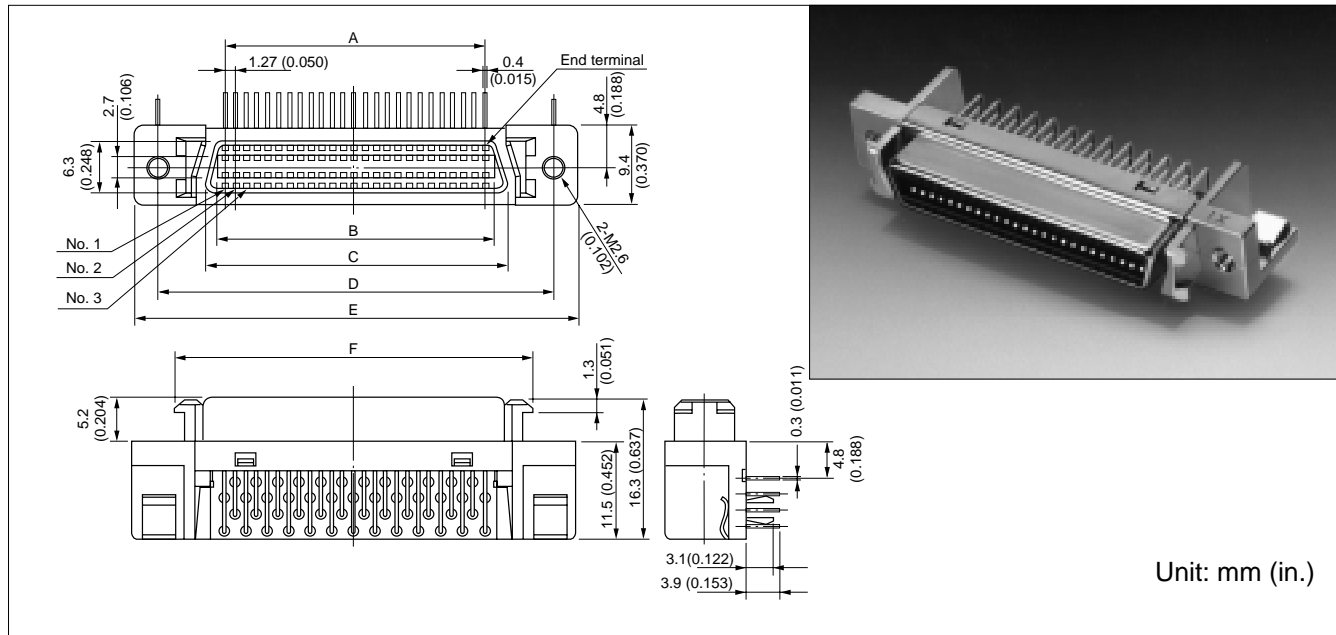

### ■ MOUNTING HOLE LAYOUT (COMPONENT SIDE)

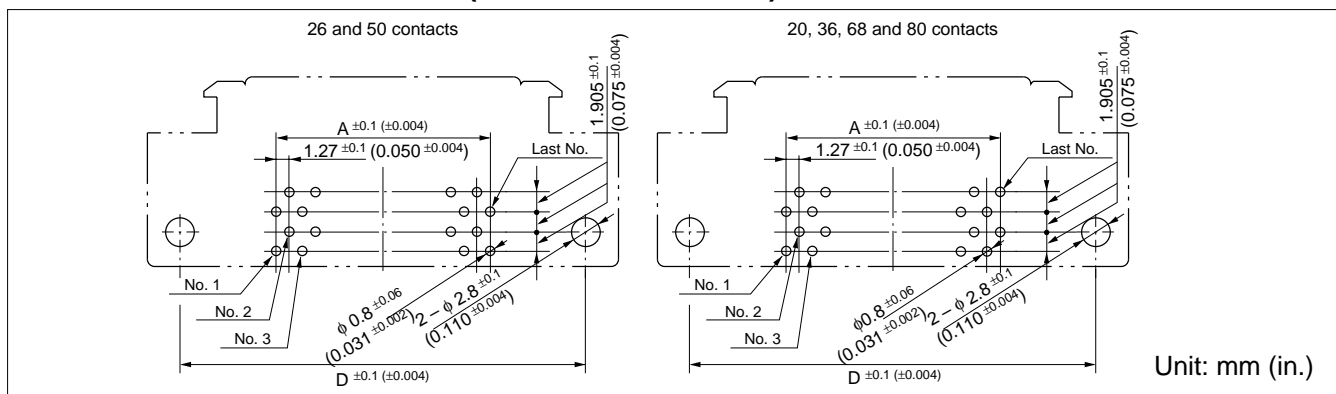

### ■ PATTERN INHIBITED AREAS

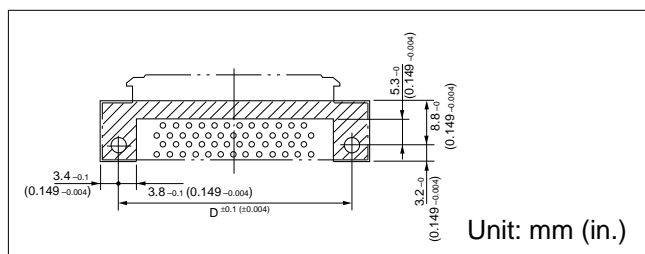

### ■ RECOMMENDED PANEL DIMENSIONS

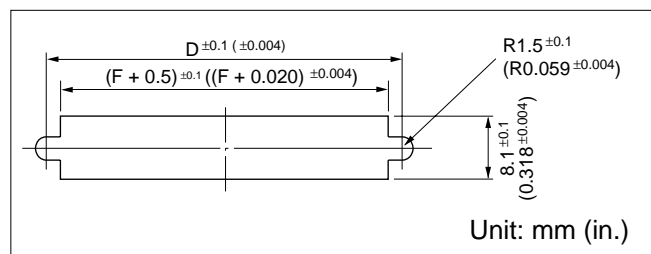

### ■ PART NUMBERS AND DIMENSIONS

Unit: mm (in.)

| Number of contacts | Part number     | A             | B             | C             | D             | E             | F             |
|--------------------|-----------------|---------------|---------------|---------------|---------------|---------------|---------------|
| 20                 | FCN-245D020-G/H | 11.43 (0.450) | 13.45 (0.529) | 16.45 (0.647) | 27.45 (1.080) | 33.35 (1.312) | 23.30 (0.917) |
| 26                 | FCN-245D026-G/H | 15.24 (0.600) | 17.26 (0.679) | 20.26 (0.797) | 31.26 (1.231) | 37.16 (1.462) | 27.11 (1.067) |
| 36                 | FCN-245D036-G/H | 21.59 (0.850) | 23.61 (0.929) | 26.61 (1.047) | 37.61 (1.480) | 43.51 (1.712) | 33.46 (1.317) |
| 50                 | FCN-245D050-G/H | 30.48 (1.200) | 32.50 (1.279) | 35.50 (1.397) | 46.50 (1.830) | 52.40 (2.062) | 42.35 (1.667) |
| 68                 | FCN-245D068-G/H | 41.91 (1.650) | 43.93 (1.729) | 46.93 (1.847) | 57.93 (2.280) | 63.83 (2.512) | 53.78 (2.117) |
| 80                 | FCN-245D080-G/H | 49.53 (1.950) | 51.55 (2.029) | 54.55 (2.147) | 65.55 (2.580) | 71.45 (2.812) | 61.40 (2.417) |

## INSULATION DISPLACEMENT CONNECTION (IDC) PLUG

### ■ DIMENSIONS

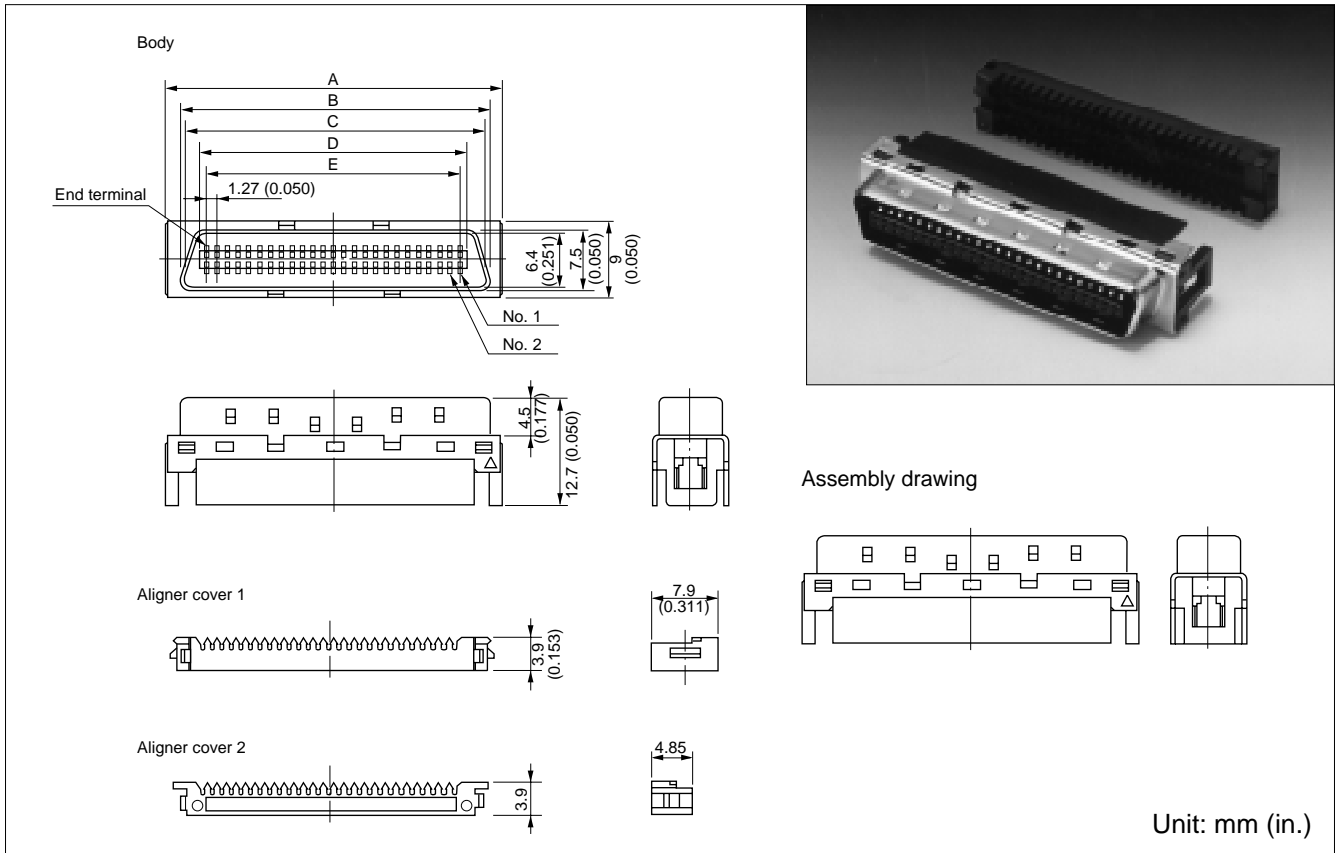

### ■ PART NUMBERS AND DIMENSIONS

Unit: mm (in.)

| Number of contacts | Insulation diameter of applicable wire | Part number     | A             | B             | C             | D             | E             |
|--------------------|--|-----------------|---------------|---------------|---------------|---------------|---------------|
| 20                 | φ0.5 to 0.65 mm                        | FCN-247R020-G/E | 21.24 (0.836) | 17.55 (0.690) | 16.55 (0.651) | 13.25 (0.521) | 11.43 (0.450) |
| 26                 | φ0.5 to 0.65 mm                        | FCN-247R026-G/E | 25.05 (0.986) | 21.36 (0.840) | 20.36 (0.801) | 17.06 (0.671) | 15.24 (0.600) |
| 36                 | φ0.5 to 0.65 mm                        | FCN-247R036-G/E | 31.40 (1.236) | 27.71 (1.090) | 26.71 (1.051) | 23.41 (0.921) | 21.59 (0.850) |
| 50                 | φ0.5 to 0.65 mm                        | FCN-247R050-G/E | 40.29 (1.586) | 36.60 (1.440) | 35.60 (1.401) | 32.30 (1.271) | 30.48 (1.200) |
| 68                 | φ0.5 to 0.65 mm                        | FCN-247R068-G/E | 51.72 (2.036) | 48.03 (1.890) | 47.03 (1.851) | 43.73 (1.721) | 41.91 (1.650) |
| 80                 | φ0.5 to 0.65 mm                        | FCN-247R080-G/E | 59.34 (2.336) | 55.65 (2.190) | 54.65 (2.151) | 51.35 (2.021) | 49.53 (1.950) |

50-contact connectors for IDC of wires with φ0.8 mm (0.031 in.) to φ0.88 mm (0.035 in.) insulation diameter are also available. Specify a part number by replacing -G/E at the end with -G/F.

## RIGHT-ANGLE SOCKET [LIGHTWEIGHT TYPE]

### ■ DIMENSIONS

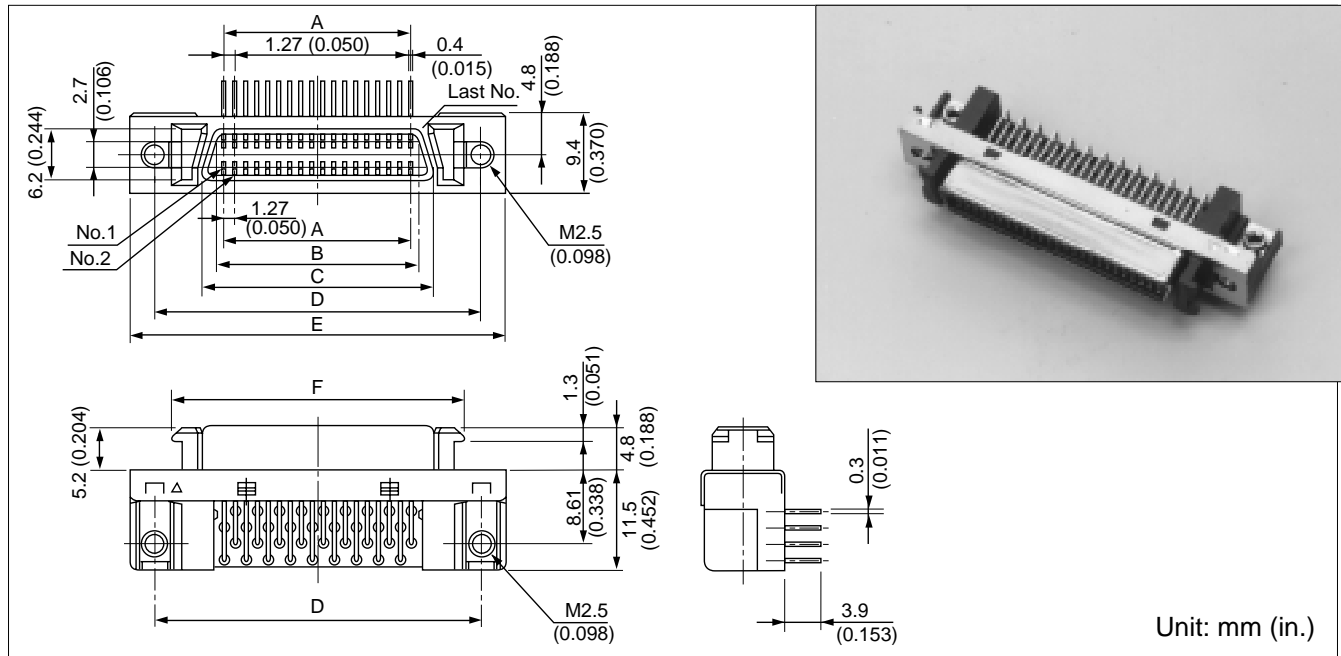

### ■ MOUNTING HOLE LAYOUT (COMPONENT SIDE)

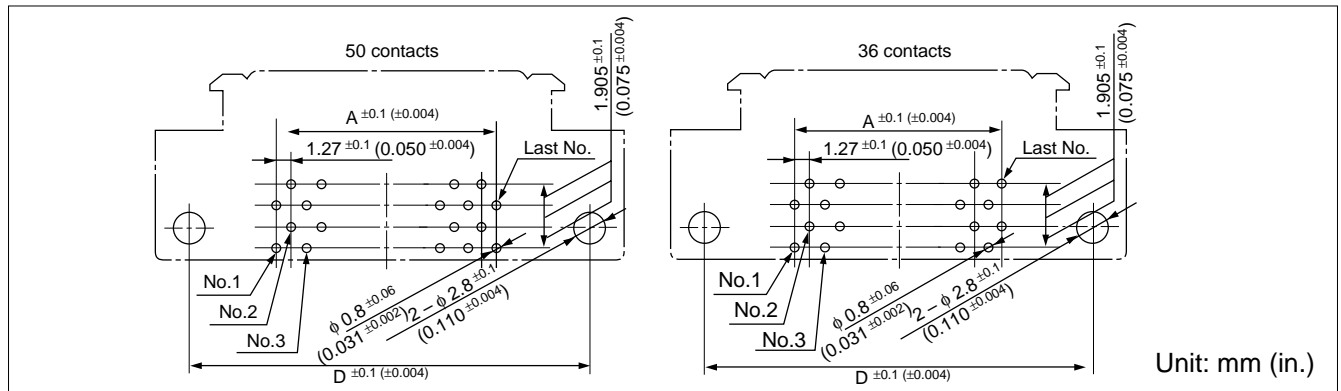

### ■ PATTERN INHIBITED AREAS

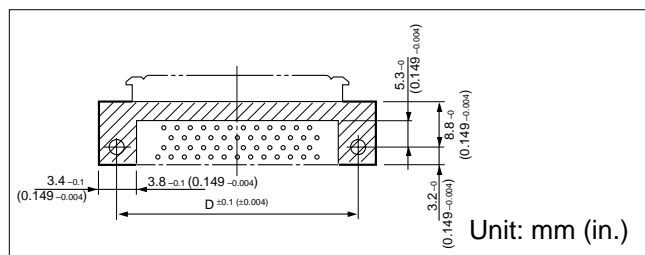

### ■ RECOMMENDED PANEL DIMENSIONS

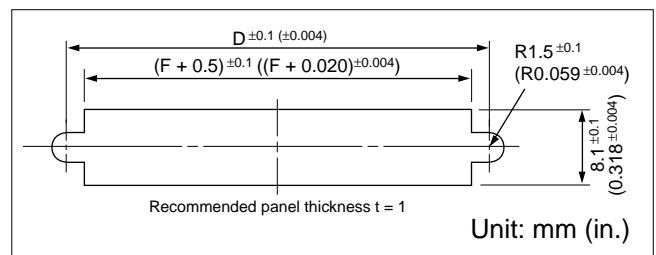

### ■ PART NUMBERS AND DIMENSIONS

Unit: mm (in.)

| Number of contacts | Part number     | A             | B             | C             | D             | E             | F             |
|--------------------|-----------------|---------------|---------------|---------------|---------------|---------------|---------------|
| 36                 | FCN-245D036-L/L | 21.59 (0.850) | 23.61 (0.929) | 26.61 (1.047) | 37.61 (1.480) | 43.51 (1.712) | 33.46 (1.317) |
| 50                 | FCN-245D050-L/L | 30.48 (1.200) | 32.50 (1.279) | 35.50 (1.397) | 46.50 (1.830) | 52.40 (2.062) | 42.35 (1.667) |

\* This socket is 40% lighter than a socket with die cast shell.

## EMI/ESD RESISTANT COVER

### ■ DIMENSIONS

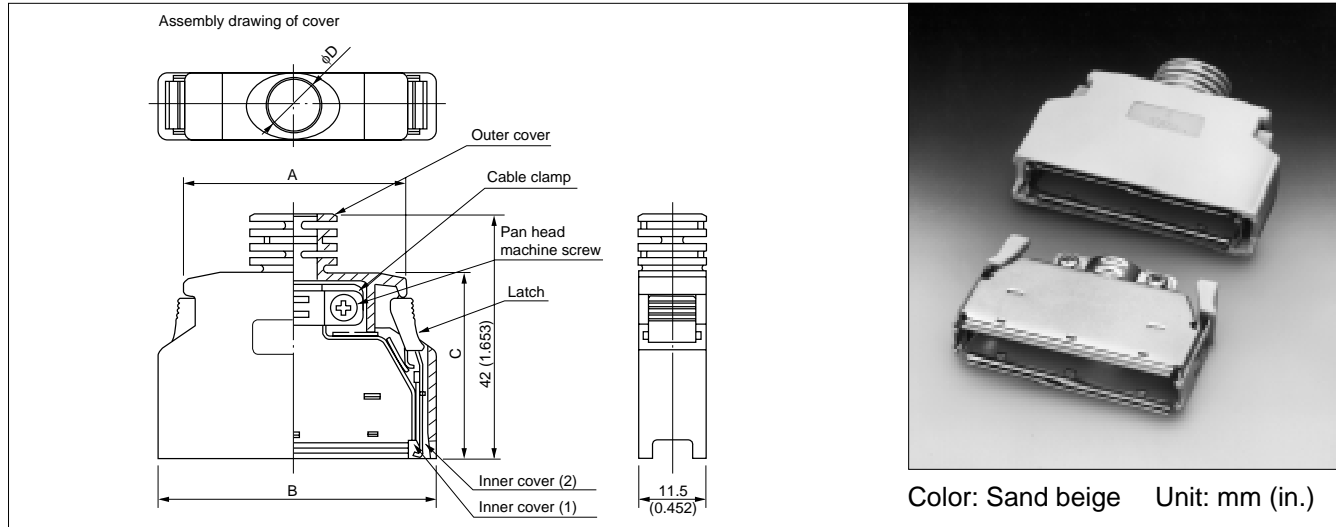

### ■ PART NUMBERS AND DIMENSIONS

Unit: mm (in.)

| Number of contacts | Part number     | A             | B             | C             | D           |
|--------------------|-----------------|---------------|---------------|---------------|-------------|
| 20                 | FCN-240C020-A/S | 19.95 (0.785) | 29.65 (1.167) | 34.50 (1.358) | 6.8 (0.268) |
| 26                 | FCN-240C026-A/S | 23.76 (0.935) | 33.46 (1.317) | 38.31 (1.508) | 7.1 (0.280) |
| 36                 | FCN-240C036-A/S | 30.11 (1.185) | 39.81 (1.507) | 32.00 (1.259) | 8.2 (0.323) |
| 50                 | FCN-240C050-A/S | 39.00 (1.535) | 48.70 (1.917) | 32.00 (1.259) | 9.0 (0.354) |
|                    | FCN-240C050-E/S |               |               |               | 9.8 (0.386) |
| 68                 | FCN-240C068-A/S | 50.43 (1.985) | 60.13 (2.367) | 32.00 (1.259) | 9.1 (0.358) |
| 80                 | FCN-240C080-A/S | 58.05 (2.285) | 67.75 (2.667) | 32.00 (1.259) | 9.7 (0.382) |

\*: The standard color of the EMI/ESD resistant covers is sand beige, but black, ivory, and art gray are also available. Specify a part number as follows:

Black: FCN-240C□□□-Δ/S-K0. Ivory: FCN-240C□□□-Δ/S-C0. Art gray: FCN-240C□□□-Δ/S-A0.

□□□: Number of contacts. Δ: Cover type.

## WIDE-HOLE COVER FOR SCSI CABLES

### ■ DIMENSIONS

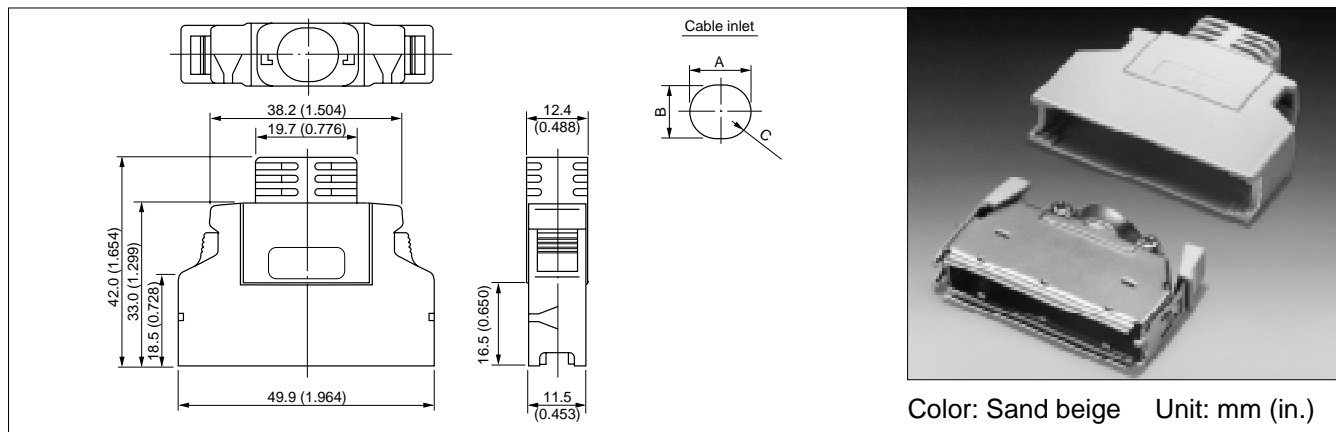

### ■ PART NUMBERS AND DIMENSIONS

| Part number     | Cable inlet   |      |
|-----------------|---------------|------|
|                 | A × B         | C    |
| FCN-240C050-B/S | 12.45 × 11.00 | R5.5 |
| FCN-240C050-D/S | 11.05 × 9.40  | R4.7 |

\*: The standard color of the EMI/ESD resistant covers is sand beige, but black, ivory, and art gray are also available. Specify a part number as follows:

Black: FCN-240C□□□-Δ/S-K0. Ivory: FCN-240C□□□-Δ/S-C0.

Art gray: FCN-240C□□□-Δ/S-A0.

□□□: Number of contacts. Δ: Cover type.

# 240R Series

## EMI/ESD RESISTANT COVER, LATCH-ON-HOOD TYPE

### ■ DIMENSIONS

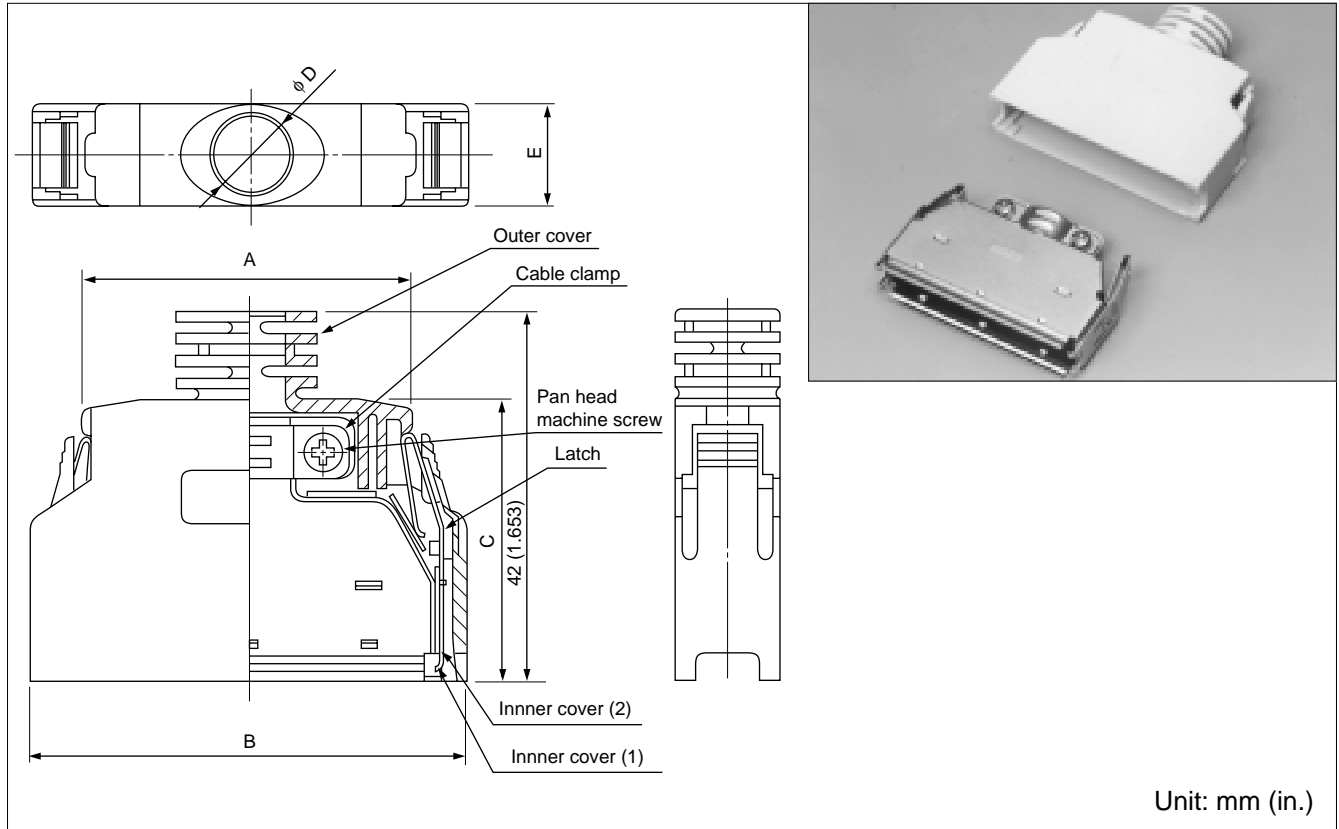

### ■ PART NUMBERS AND DIMENSIONS

Unit: mm (in.)

| Number of contacts | Part number      | A             | B             | C             | D           | E            |
|--------------------|------------------|---------------|---------------|---------------|-------------|--------------|
| 36                 | FCN-240C036-A/SC | 29.11 (1.146) | 39.81 (1.567) | 32.00 (1.259) | 8.2 (0.223) | 11.5 (0.223) |
| 50                 | FCN-240C050-A/SC | 38.00 (1.496) | 48.70 (1.917) | 32.00 (1.259) | 9.0 (0.223) | 11.5 (0.223) |
|                    | FCN-240C050-E/SC |               |               |               | 9.8 (0.223) | 11.4 (0.223) |



## ACCESSORY (DUST CAP FOR SOCKET) (230R SERIES AND 240R SERIES)

Used to prevent dust from entering the contact section of a plug connector.

### ■ DIMENSIONS

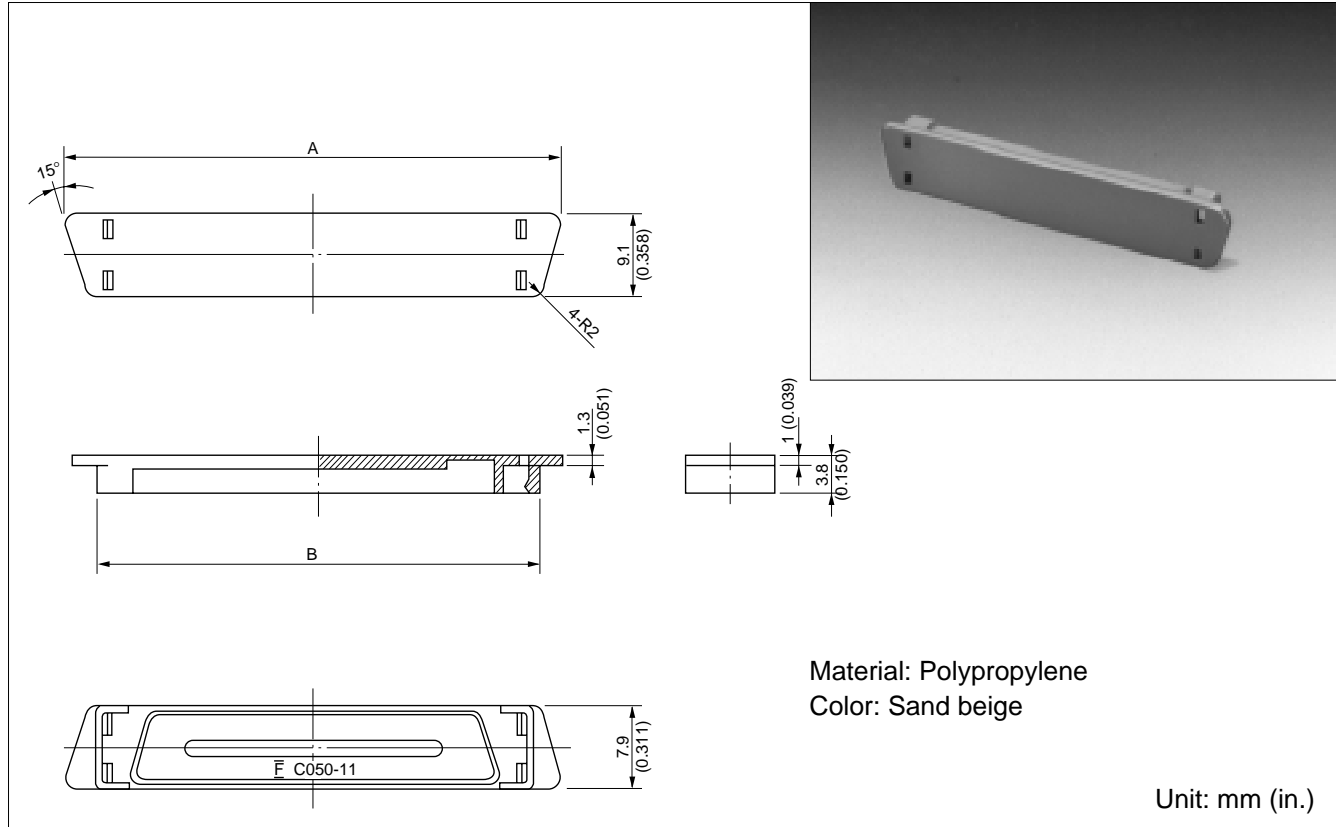

### ■ PART NUMBERS AND DIMENSIONS

Unit: mm (in.)

| Number of contacts | Part number    | A            | B            |
|--------------------|----------------|--------------|--------------|
| 28                 | FCN-230C028-11 | 35.7 (1.406) | 30.1 (1.185) |
| 36                 | FCN-230C036-11 | 40.8 (1.606) | 35.2 (1.386) |
| 50                 | FCN-230C050-11 | 49.7 (1.957) | 44.1 (1.736) |
| 68                 | FCN-230C068-11 | 61.1 (2.406) | 55.5 (2.185) |

### ■ APPLICATIONS

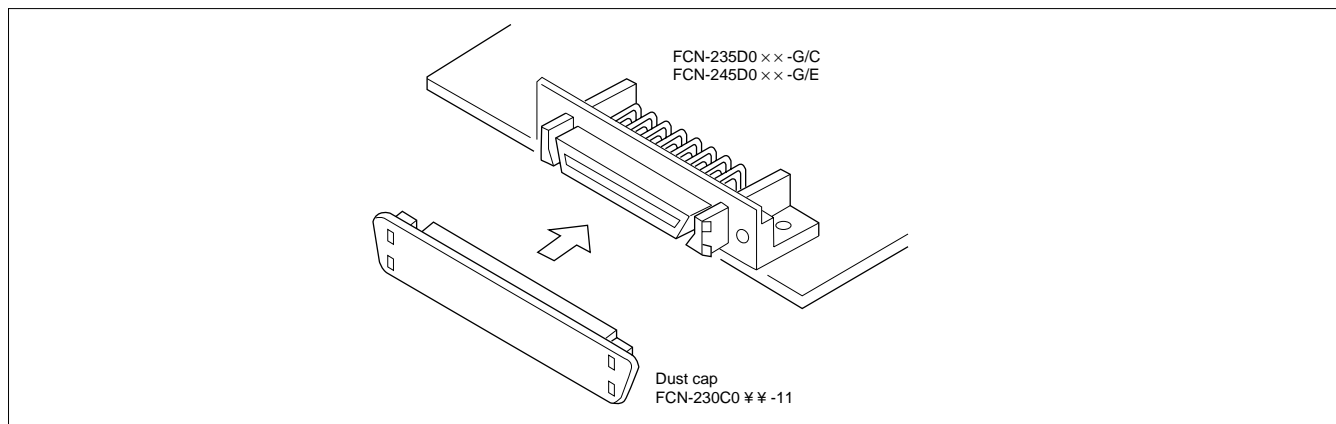

## CABLE ASSEMBLY TOOLS

The following tools are needed to assemble FCN-230/230R/240/240R series connectors.

- Cable aligner (semiautomatic cable aligner or hand tool)
- IDC tool

### 1. Cable Aligner

| Item     | Semiautomatic cable aligner |              |                | Hand tool       |
|----------|-----------------------------|--------------|----------------|-----------------|
|          | Body/Controller             | Bed          | Adaptor        |                 |
| FCN-237J | FCN-M561-A/C                | FCN-P560-2/A | FCN-K560-A-xxx | FCN-237T-T062/H |
| FCN-237R |                             |              | FCN-K560-R-xxx |                 |
| FCN-247J |                             |              | FCN-K560-K-xxx |                 |
| FCN-247R |                             | FCN-P560-2/J | FCN-K560-J-xxx | FCN-247T-T061/H |

xxx indicates the number of contacts.

### 2. Insulation Displacement Connection (IDC) tool

| Item     | Hand press      | Head/Table      |
|----------|-----------------|-----------------|
| FCN-237J | FCN-237T-T109/H | FCN-237T-T064/H |
| FCN-237R |                 | FCN-237T-T067/H |
| FCN-237D |                 | FCN-237T-T075/H |
| FCN-247J |                 | FCN-247T-T066/H |
| FCN-247R |                 | FCN-247T-T068/H |
| FCN-247D |                 | FCN-247T-T077/H |

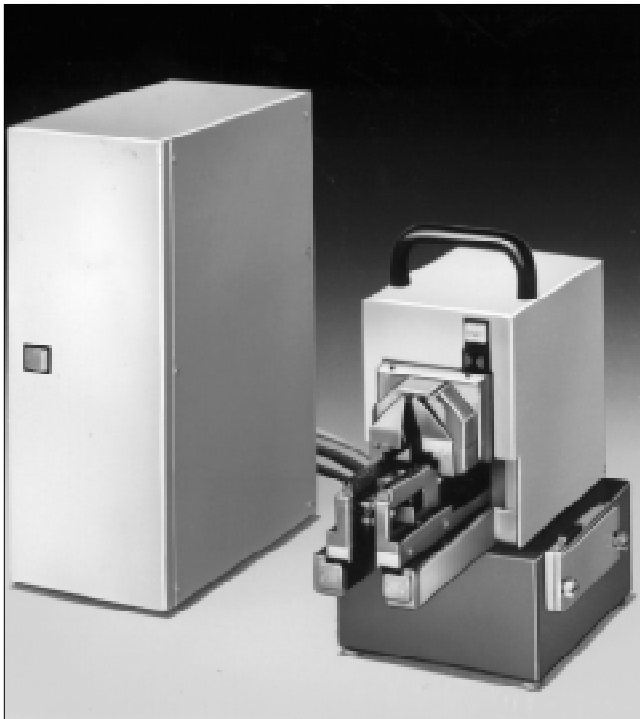

• Cable aligner

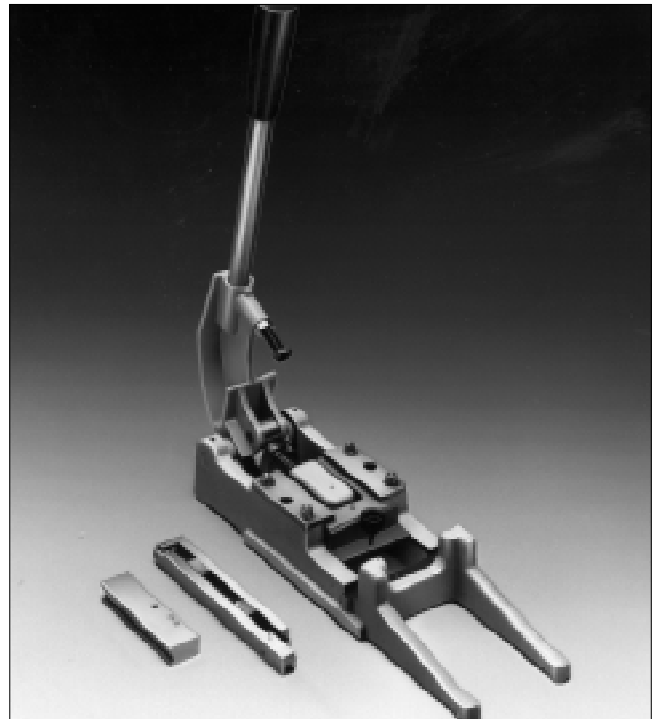

• Insulation displacement connection (IDC) tool

# 240R Series

**Semi-Automatic Tools  
Cable Aligning Machine  
Main Body (FCN-M551-120, FCN-M551-220)**

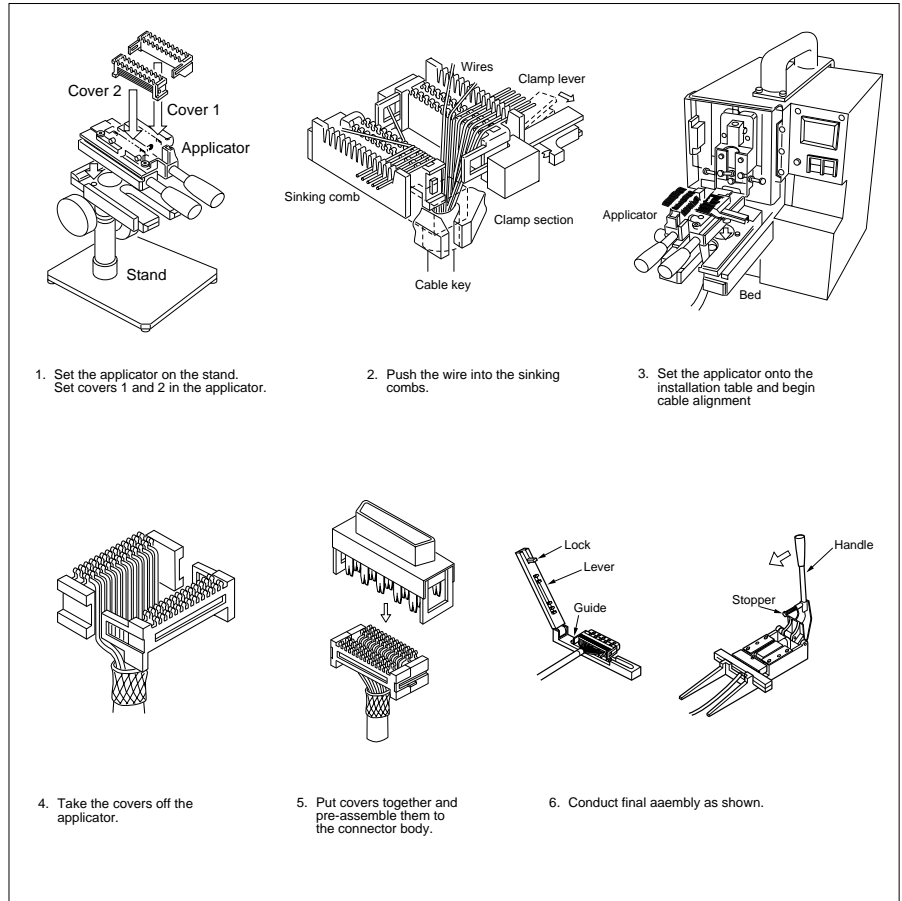

Head (FCN-H550-1/A)



Stand (FCN-D550)



Applicator (FCN-A550-1/A-xxx)



IDC Tool (FCN-237T-T109/H,  
FCN-237T-T067/H locator)

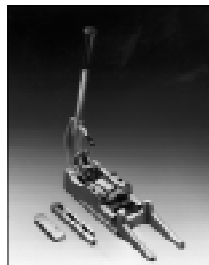

## FCN-240R SERIES IDC ROUND-CABLE CONNECTORS

SOCKET: FCN-247R\*\*\*-G/E (\*\*\*: 020, 026, 036, 050, 068, 080)

| Pos No.       | Applied Wire<br>(wire Dia.: mm) | Connector Part<br>number                | Cable Aligner   |              | IDC Tool   |
|---------------|---------------------------------|---|-----------------|--------------|--|
|               |                                 |   | Hand Tool       | Semi-Auto    |  |
| 20<br> <br>68 | #28 to #30<br>(0.5 to 0.65)     | FCN-247R020-G/E<br> <br>FCN-247R080-G/E | FCN-247T-T061/H | (See below*) | HAND PRESS:<br>FCN-237T-T109/H<br>HEAD & Locator:<br>FCN-237T-T067/H |

Semi-automatic-Medium Level  
 Body: :FCN-M551-120  
 Head Assembly: :FCN-H550  
 Applicator: :FCN-A550-1/J-\*\*\*(\*\*\*: 020, 028, 036, 050, 068, 080)  
 Stand: :FCN-D550

## Fujitsu Components International Headquarter Offices

### Japan

Fujitsu Component Limited  
Gotanda-Chuo Building  
3-5, Higashigotanda 2-chome, Shinagawa-ku  
Tokyo 141-0022, Japan  
Tel: (81-3) 5449-7010  
Fax: (81-3) 5449-2626  
Email: [promothq@fcl.fujitsu.com](mailto:promothq@fcl.fujitsu.com)  
Web: [www.fcl.fujitsu.com](http://www.fcl.fujitsu.com)

### North and South America

Fujitsu Components America, Inc.  
250 E. Caribbean Drive  
Sunnyvale, CA 94089 U.S.A.  
Tel: (1-408) 745-4900  
Fax: (1-408) 745-4970  
Email: [components@us.fujitsu.com](mailto:components@us.fujitsu.com)  
Web: <http://us.fujitsu.com/components>

### Europe

Fujitsu Components Europe B.V.  
Diamantlaan 25  
2132 WV Hoofddorp  
Netherlands  
Tel: (31-23) 5560910  
Fax: (31-23) 5560950  
Email: [info@fceu.fujitsu.com](mailto:info@fceu.fujitsu.com)  
Web: [emea.fujitsu.com/components](http://emea.fujitsu.com/components)

### Asia Pacific

Fujitsu Components Asia Ltd.  
102E Pasir Panjang Road  
#01-01 Citilink Warehouse Complex  
Singapore 118529  
Tel: (65) 6375-8560  
Fax: (65) 6273-3021  
Email: [fcal@fcal.fujitsu.com](mailto:fcal@fcal.fujitsu.com)  
[www.fcal.fujitsu.com](http://www.fcal.fujitsu.com)

© 2007 Fujitsu Components America, Inc. All rights reserved. All trademarks or registered trademarks are the property of their respective owners. Fujitsu Components America, Inc. or its affiliates do not warrant that the content of the datasheet is error free. In a continuing effort to improve our products, Fujitsu Components America, Inc. or its affiliates reserve the right to change specifications/datasheets without prior notice. Rev. November 2, 2007.

Компания «Океан Электроники» предлагает заключение долгосрочных отношений при поставках импортных электронных компонентов на взаимовыгодных условиях!

Наши преимущества:

- Поставка оригинальных импортных электронных компонентов напрямую с производств Америки, Европы и Азии, а так же с крупнейших складов мира;
- Широкая линейка поставок активных и пассивных импортных электронных компонентов (более 30 млн. наименований);
- Поставка сложных, дефицитных, либо снятых с производства позиций;
- Оперативные сроки поставки под заказ (от 5 рабочих дней);
- Экспресс доставка в любую точку России;
- Помощь Конструкторского Отдела и консультации квалифицированных инженеров;
- Техническая поддержка проекта, помощь в подборе аналогов, поставка прототипов;
- Поставка электронных компонентов под контролем ВП;
- Система менеджмента качества сертифицирована по Международному стандарту ISO 9001;
- При необходимости вся продукция военного и аэрокосмического назначения проходит испытания и сертификацию в лаборатории (по согласованию с заказчиком);
- Поставка специализированных компонентов военного и аэрокосмического уровня качества (Xilinx, Altera, Analog Devices, Intersil, Interpoint, Microsemi, Actel, Aeroflex, Peregrine, VPT, Syfer, Eurofarad, Texas Instruments, MS Kennedy, Miteq, Cobham, E2V, MA-COM, Hittite, Mini-Circuits, General Dynamics и др.);

Компания «Океан Электроники» является официальным дистрибьютором и эксклюзивным представителем в России одного из крупнейших производителей разъемов военного и аэрокосмического назначения «JONHON», а так же официальным дистрибьютором и эксклюзивным представителем в России производителя высокотехнологичных и надежных решений для передачи СВЧ сигналов «FORSTAR».



## JONHON

«JONHON» (основан в 1970 г.)

Разъемы специального, военного и аэрокосмического назначения:

(Применяются в военной, авиационной, аэрокосмической, морской, железнодорожной, горно- и нефтедобывающей отраслях промышленности)

«FORSTAR» (основан в 1998 г.)

ВЧ соединители, коаксиальные кабели,  
кабельные сборки и микроволновые компоненты:

(Применяются в телекоммуникациях гражданского и специального назначения, в средствах связи, РЛС, а так же военной, авиационной и аэрокосмической отраслях промышленности).



Телефон: 8 (812) 309-75-97 (многоканальный)

Факс: 8 (812) 320-03-32

Электронная почта: [ocean@oceanchips.ru](mailto:ocean@oceanchips.ru)

Web: <http://oceanchips.ru/>

Адрес: 198099, г. Санкт-Петербург, ул. Калинина, д. 2, корп. 4, лит. А