

OPTIONAL
PICK AND PLACE CAP
SEE NOTES 4 & 9.

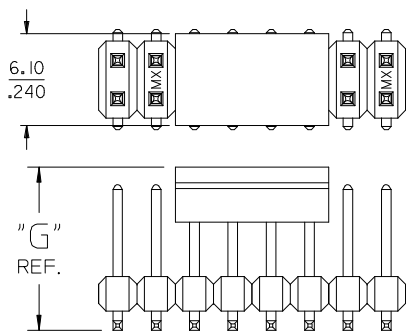

DIM. "M"	DIM. "G"
6.10 .240	10.67 .420
8.13 .320	12.70 .500

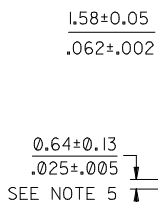

P.C. BOARD PAD LAYOUT
AT ENDS FOR NO PEG VERSION.

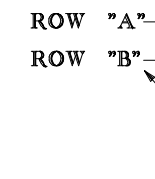

RECOMMENDED P.C. BOARD PAD LAYOUT

⊕0.50/.020[U]X FOR PARTS WITH PEGS
⊕0.50/.020[U]Y FOR PARTS WITHOUT PEGS

ROW "A"
ROW "B"

"A" ±0.38
±.015
CUTOFF

USED TO LOCATE VOIDED CIRCUITS

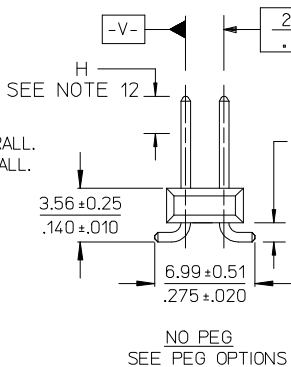

NO PEG
SEE PEG OPTIONS

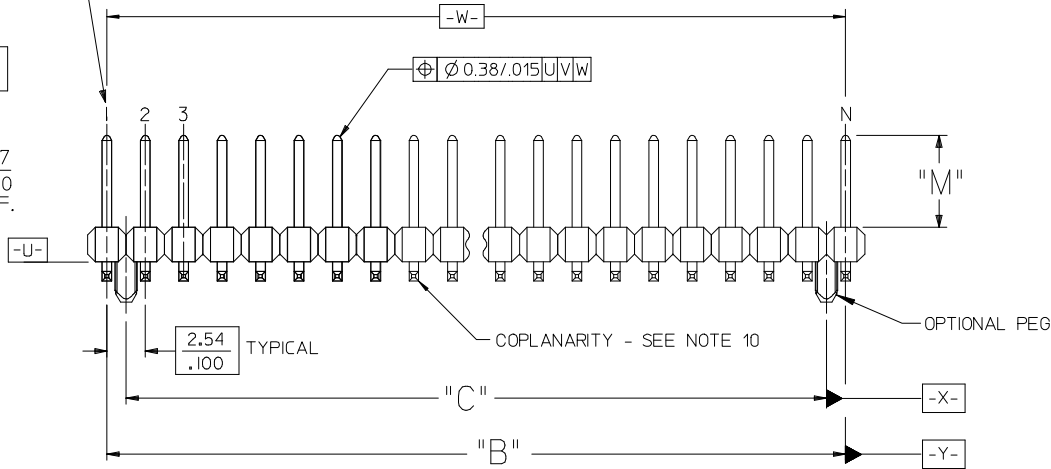

PEG OPTIONS

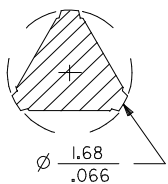
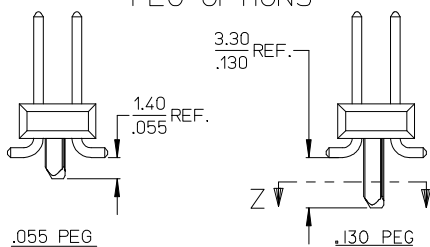

SECTION Z-Z

NOTES:

- MATERIALS: INSULATOR: GLASS FILLED LIQUID CRYSTAL POLYMER (LCP), UL94 V-0, COLOR: BLACK
TERMINAL: COPPER ALLOY
- FINISH:
59 TIN - 0.00150/0.00059 MINIMUM BRIGHT TIN OVER NICKEL OVERALL.
150 TIN - 0.00381/0.00150 MINIMUM BRIGHT TIN OVER NICKEL OVERALL.
15 GOLD - 0.000381/0.00015 MINIMUM GOLD IN SELECT AREA OVER 0.00191/0.00075 MINIMUM TIN IN SELECT AREA OVER NICKEL OVERALL.
30 GOLD - 0.00076/0.00030 MINIMUM GOLD IN SELECT AREA OVER 0.00191/0.00075 MINIMUM TIN IN SELECT AREA OVER NICKEL OVERALL.
50 GOLD - 0.00127/0.00050 MINIMUM GOLD IN SELECT AREA OVER 0.00254/0.00100 MINIMUM TIN IN SELECT AREA OVER NICKEL OVERALL.
- PART TO CONFORM TO PS-71308.
- PACKAGING (SEE CHARTS): BULK: PER PK-70873-0353
TUBES: PER PK-70873-0041.
71308-82** IN TUBES: PER PK-70873-042.
TUBES W/ VAC CAPS: PER PK-70873-0691
TAPE AND REEL W/ VAC CAPS: PER PK-70873-0805.
SEE SHEET 3 FOR TAPE & REEL PRODUCT WITH SHALLOW POCKET REQUIREMENTS.
- TYP. DIMENSIONS FOR LANDS SURROUNDING HOLES FOR RETENTION PEGS.
- PIN SOLERABILITY PER MOLEX SPEC. SMES-152.
- SEE SHEETS 2-5 FOR CHARTED DIMS., PART/EDP NO'S, AND VOIDED CIRCUITS.
- PIN PUSHOUT FORCE: 3 LBS. MINIMUM.
- PICK-N-PLACE CAPS WILL BE PLACED SO THAT VACUUM PICK UP AREA WILL BE IN CENTER OF PART.
- COPLANARITY FOR CIRCUIT SIZES UP TO 40 IS 0.15 MM/0.006 INCH.
FOR CIRCUIT SIZES 42 AND LARGER, CONTACT MOLEX SALES DEPARTMENT.
- THIS PART CONFORMS TO CLASS B REQUIREMENTS OF COSMETIC SPECIFICATION PS-45499-002.
- MEASURE POINT FOR PLATING THICKNESS.

REVISION	DESCRIPTION	QUALITY SYMBOLS
K7	REMOVE 15-91-6407 EC NO: UCP2015-0081 DRWIN/KIPPER 2014/05/22 CHKD:NGUYEN 2014/11/26 APPR:FSMITH 2015/01/08	▽=0 ▽=0 ▽=0

GENERAL TOLERANCES (UNLESS SPECIFIED)	
mm	INCH
4 PLACES ± ---	± ---
3 PLACES ± ---	±.005
2 PLACES ± 0.13	±.010
1 PLACE ± 0.25	± ---
0 PLACE ± ---	± ---
ANGULAR ±1/2°	
DRAFT WHERE APPLICABLE MUST REMAIN WITHIN DIMENSIONS	

DIMENSION STYLE MM/IN	
DRAWN BY	DATE
KMS	1999/10/15
CHECKED BY	DATE
KMS	1999/10/15
APPROVED BY	DATE
KMS	1999/10/15
MATERIAL NO.	SEE TABLES
SIZE	C

SCALE	DESIGN UNITS	THIRD ANGLE PROJECTION
	INCH	
TITLE		
SALES ASSY INSULATOR DUAL ROW SMT W/BREAK-OFF .025SQ PIN GULLWING .100		
molex		
DOCUMENT NO.	SD-71308-001	SHEET NO. 1 OF 6
THIS DRAWING CONTAINS INFORMATION THAT IS PROPRIETARY TO MOLEX INCORPORATED AND SHOULD NOT BE USED WITHOUT WRITTEN PERMISSION		

IN TAPE AND REEL WITH SHALLOW POCKET TAPE													BULK / IN TUBES		
PACKAGING SEE NOTE 4. SHT 1		4-8 CKT	TAPE-N-REEL W/ VAC CAPS	TAPE-N-REEL W/ VAC CAPS									BULK	BULK	
		10-100 CKT	TAPE-N-REEL W/ VAC CAPS	TAPE-N-REEL W/ VAC CAPS									TUBES	TUBES	
DIM. M±0.25 MM			6.10 (.240)	6.10 (.240)									8.13 (.320)	13.59 (.535)	
PLATING			30 GOLD	15 GOLD									150 TIN	150 TIN	
DIM. H			2.54 (.100)	2.54 (.100)									4.57 (.180)	4.57 (.180)	
I	CKTS	DIM. A		DIM. B		EDP NUMBER	EDP NUMBER						EDP NUMBER	EDP NUMBER	CKTS
		MM	IN	MM	IN										
04	5.08	.200	2.54	.100											04
06	7.62	.300	5.08	.200		015-91-6068									06
08	10.16	.400	7.62	.300		015-91-6088									08
10	12.70	.500	10.16	.400		015-91-6108						713088010	71308-8210		10
12	15.24	.600	12.70	.500											12
14	17.78	.700	15.24	.600	015-91-6148										14
16	20.32	.800	17.78	.700								713088016			16
18	22.86	.900	20.32	.800											18
20	25.40	1.000	22.86	.900											20
22	27.94	1.100	25.40	1.000											22
24	30.48	1.200	27.94	1.100											24
26	33.02	1.300	30.48	1.200											26
28	35.56	1.400	33.02	1.300											28
30	38.10	1.500	35.56	1.400											30
32	40.64	1.600	38.10	1.500											32
34	43.18	1.700	40.64	1.600											34
36	45.72	1.800	43.18	1.700											36
38	48.26	1.900	45.72	1.800											38
40	50.80	2.000	48.26	1.900											40
42	53.34	2.100	50.80	2.000											42
44	55.88	2.200	53.34	2.100											44
46	58.42	2.300	55.88	2.200											46
48	60.96	2.400	58.42	2.300											48
50	63.50	2.500	60.96	2.400											50
52	66.04	2.600	63.50	2.500											52
54	68.58	2.700	66.04	2.600											54
56	71.12	2.800	68.58	2.700											56
58	73.66	2.900	71.12	2.800											58
60	76.20	3.000	73.66	2.900											60
62	78.74	3.100	76.20	3.000											62
64	81.28	3.200	78.74	3.100											64
66	83.82	3.300	81.28	3.200											66
68	86.36	3.400	83.82	3.300											68
70	88.90	3.500	86.36	3.400											70
72	91.44	3.600	88.90	3.500											72
74	93.98	3.700	91.44	3.600											74
76	96.52	3.800	93.98	3.700											76
78	99.06	3.900	96.52	3.800											78
80	101.60	4.000	99.06	3.900											80
82	104.14	4.100	101.60	4.000											82
84	106.68	4.200	104.14	4.100											84
86	109.22	4.300	106.68	4.200											86
88	111.76	4.400	109.22	4.300											88
90	114.30	4.500	111.76	4.400											90
92	116.84	4.600	114.30	4.500											92
94	119.38	4.700	116.84	4.600											94
96	121.92	4.800	119.38	4.700											96
98	124.46	4.900	121.92	4.800											98
100	127.00	5.000	124.46	4.900											100

NO PEG VERSION

(ALSO SEE SHEET 2)

SEE SHEET 1 EC NO: UCP2015-0081 DRW:MKIPPER 2014/05/22 CHKD:NGUYEN 2014/11/26 APPR:FSMLTH 2015/01/08	QUALITY SYMBOLS	$\nabla = 0$ $\nabla = 0$ $\nabla = 0$	GENERAL TOLERANCES (UNLESS SPECIFIED)	DIMENSION STYLE	SCALE	DESIGN UNITS	THIRD ANGLE PROJECTION																											
				MM/IN	INCH																													
				<table border="1" style="width: 100%; border-collapse: collapse;"> <tr><td>4 PLACES</td><td>± ---</td><td>± ---</td></tr> <tr><td>3 PLACES</td><td>± ---</td><td>± .005</td></tr> <tr><td>2 PLACES</td><td>± 0.13</td><td>± .010</td></tr> <tr><td>1 PLACE</td><td>± 0.25</td><td>± ---</td></tr> <tr><td>0 PLACE</td><td>± ---</td><td>± ---</td></tr> </table>	4 PLACES	± ---	± ---	3 PLACES	± ---	± .005	2 PLACES	± 0.13	± .010	1 PLACE	± 0.25	± ---	0 PLACE	± ---	± ---	<table border="1" style="width: 100%; border-collapse: collapse;"> <tr><td>DRAWN BY</td><td>DATE</td></tr> <tr><td>KMS</td><td>1999/10/15</td></tr> <tr><td>CHECKED BY</td><td>DATE</td></tr> <tr><td>KMS</td><td>1999/10/15</td></tr> <tr><td>APPROVED BY</td><td>DATE</td></tr> <tr><td>KMS</td><td>1999/10/15</td></tr> </table>	DRAWN BY	DATE	KMS	1999/10/15	CHECKED BY	DATE	KMS	1999/10/15	APPROVED BY	DATE	KMS	1999/10/15	TITLE	
	4 PLACES	± ---	± ---																															
3 PLACES	± ---	± .005																																
2 PLACES	± 0.13	± .010																																
1 PLACE	± 0.25	± ---																																
0 PLACE	± ---	± ---																																
DRAWN BY	DATE																																	
KMS	1999/10/15																																	
CHECKED BY	DATE																																	
KMS	1999/10/15																																	
APPROVED BY	DATE																																	
KMS	1999/10/15																																	
			ANGULAR ±1/2°	MATERIAL NO.	DOCUMENT NO.		SHEET NO.																											

SALES ASSY INSULATOR
DUAL ROW SMT W/BREAK-OFF
.025SQ PIN GULLWING .100

molex

SD-71308-001

3 OF 6

DRAFT WHERE APPLICABLE MUST REMAIN WITHIN DIMENSIONS

THIS DRAWING CONTAINS INFORMATION THAT IS PROPRIETARY TO MOLEX INCORPORATED AND SHOULD NOT BE USED WITHOUT WRITTEN PERMISSION

13	12	11	10	9	8	7	6	5	4	3	2	1
		PACKAGING SEE NOTE 4 SHT 1	4-8 CKT	BULK	TAPE-N-REEL W/ VAC CAPS	BULK	TAPE-N-REEL W/ VAC CAPS	TAPE-N-REEL W/ VAC CAPS				
			10-100 CKT	TUBES	TAPE-N-REEL W/ VAC CAPS	TUBES	TAPE-N-REEL W/ VAC CAPS	TAPE-N-REEL W/ VAC CAPS				
		DIM. M±0.25 MM		6.10 (.240)		6.10 (.240)		8.13 (.320)				
		PLATING		30 GOLD		150 TIN		150 TIN				
		DIM. H		2.54 (.100)		2.54 (.100)		4.57 (.180)				

I	CKTS	DIM. A		DIM. B		DIM. C		EDP NUMBER		EDP NUMBER	EDP NUMBER	EDP NUMBER	EDP NUMBER	EDP NUMBER	EDP NUMBER	CKTS
		MM	IN	MM	IN	MM	IN	EDP NUMBER	EDP NUMBER							
	04	5.08	.200	2.54	.100	----	----	015-91-1048	015-91-6047							04
	06	7.62	.300	5.08	.200	2.54	.100	015-91-1068	015-91-6067	71308-6106	71308-6206					06
	08	10.16	.400	7.62	.300	5.08	.200	015-91-1088	015-91-6087	71308-6108	71308-6208					08
	10	12.70	.500	10.16	.400	7.62	.300	015-91-1108	015-91-6107	71308-6110	71308-6210					10
	12	15.24	.600	12.70	.500	10.16	.400	015-91-1128								12
	14	17.78	.700	15.24	.600	12.70	.500	015-91-1148	015-91-6147							14
	16	20.32	.800	17.78	.700	15.24	.600	015-91-1168	015-91-6167							16
	18	22.86	.900	20.32	.800	17.78	.700	015-91-1188								18
	20	25.40	1.000	22.86	.900	20.32	.800	015-91-1208	015-91-6207							20
	22	27.94	1.100	25.40	1.000	22.86	.900	015-91-1228								22
	24	30.48	1.200	27.94	1.100	25.40	1.000	015-91-1248								24
	26	33.02	1.300	30.48	1.200	27.94	1.100	015-91-1268		71308-6126		71308-8426				26
	28	35.56	1.400	33.02	1.300	30.48	1.200	015-91-1288								28
	30	38.10	1.500	35.56	1.400	33.02	1.300	015-91-1308								30
	32	40.64	1.600	38.10	1.500	35.56	1.400	015-91-1328								32
	34	43.18	1.700	40.64	1.600	38.10	1.500	015-91-1348								34
	36	45.72	1.800	43.18	1.700	40.64	1.600	015-91-1368								36
	38	48.26	1.900	45.72	1.800	43.18	1.700	015-91-1388								38
	40	50.80	2.000	48.26	1.900	45.72	1.800	015-91-1408								40
	42	53.34	2.100	50.80	2.000	48.26	1.900	015-91-1428								42
	44	55.88	2.200	53.34	2.100	50.80	2.000	015-91-1448								44
	46	58.42	2.300	55.88	2.200	53.34	2.100	015-91-1468								46
	48	60.96	2.400	58.42	2.300	55.88	2.200	015-91-1488								48
	50	63.50	2.500	60.96	2.400	58.42	2.300	015-91-1508	015-91-6507							50
	52	66.04	2.600	63.50	2.500	60.96	2.400	015-91-1528								52
	54	68.58	2.700	66.04	2.600	63.50	2.500	015-91-1548								54
	56	71.12	2.800	68.58	2.700	66.04	2.600	015-91-1568								56
	58	73.66	2.900	71.12	2.800	68.58	2.700	015-91-1588								58
	60	76.20	3.000	73.66	2.900	71.12	2.800	015-91-1608								60
	62	78.74	3.100	76.20	3.000	73.66	2.900	015-91-1628								62
	64	81.28	3.200	78.74	3.100	76.20	3.000	015-91-1648								64
	66	83.82	3.300	81.28	3.200	78.74	3.100	015-91-1668								66
	68	86.36	3.400	83.82	3.300	81.28	3.200	015-91-1688								68
	70	88.90	3.500	86.36	3.400	83.82	3.300	015-91-1708								70
	72	91.44	3.600	88.90	3.500	86.36	3.400	015-91-1728								72
	74	93.98	3.700	91.44	3.600	88.90	3.500	015-91-1748								74
	76	96.52	3.800	93.98	3.700	91.44	3.600	015-91-1768								76
	78	99.06	3.900	96.52	3.800	93.98	3.700	015-91-1788								78
	80	101.60	4.000	99.06	3.900	96.52	3.800	015-91-1808								80
	82	104.14	4.100	101.60	4.000	99.06	3.900	71308-6082								82
	84	106.68	4.200	104.14	4.100	101.60	4.000	71308-6084								84
	86	109.22	4.300	106.68	4.200	104.14	4.100	71308-6086								86
	88	111.76	4.400	109.22	4.300	106.68	4.200	71308-6088								88
	90	114.30	4.500	111.76	4.400	109.22	4.300	71308-6090								90
	92	116.84	4.600	114.30	4.500	111.76	4.400	71308-6092								92
	94	119.38	4.700	116.84	4.600	114.30	4.500	71308-6094								94
	96	121.92	4.800	119.38	4.700	116.84	4.600	71308-6096								96
	98	124.46	4.900	121.92	4.800	119.38	4.700	71308-6098								98
	100	127.00	5.000	124.46	4.900	121.92	4.800	71308-6100								100

REMOVE 15-91-6407 IEC NO: UCP2015-0081 DR/IN/CHK/PPR: 2014/05/22 CHK/DANGUYEN: 2014/11/26 APPR./FSM/ITH: 2015/01/08 REV: K7		QUALITY SYMBOLS	GENERAL TOLERANCES (UNLESS SPECIFIED)	DIMENSION STYLE	SCALE	DESIGN UNITS	THIRD ANGLE PROJECTION
		$\nabla = 0$ $\nabla = 0$ $\nabla = 0$	mm INCH	MM/IN	INCH	TITLE	
		4 PLACES ± --- ± --- 3 PLACES ± --- ± .005 2 PLACES ± 0.13 ± .010 1 PLACE ± 0.25 ± --- 0 PLACE ± --- ± ---	DRAWN BY DATE KMS 1999/10/15 CHECKED BY DATE KMS 1999/10/15 APPROVED BY DATE KMS 1999/10/15 MATERIAL NO. SEE TABLE DRAFT WHERE APPLICABLE MUST REMAIN WITHIN DIMENSIONS	SALES ASSY INSULATOR DUAL ROW SMT W/BREAK-OFF .025SQ PIN GULLWING .100 	SHEET NO. 5 OF 6		

SHORT PEG VERSION (.055")

PEG OPTION

NO PEG VERSION

NO PEG VERSION

LONG PEG VERSION (.130")

SHORT PEG VERSION (.055")

Table with columns for PACKAGING, DIM, PLATING, and various reel configurations (BULK, TAPE-N-REEL, etc.)

Main table with columns for CKTS, DIM. A, DIM. B, DIM. C, EDP NUMBER, and various part numbers (e.g., 71308-5404, 71308-5504, etc.)

59 TIN PLATE ASSEMBLIES

Revision table with columns for REV, DESCRIPTION, and dates (e.g., 2014/05/22, 2014/11/26, 2015/01/08)

Technical specifications including QUALITY SYMBOLS, GENERAL TOLERANCES, DIMENSION STYLE (MM/IN), SCALE, DESIGN UNITS, THIRD ANGLE PROJECTION, TITLE (SALES ASSY INSULATOR), and MATERIAL NO. (SEE TABLE)

Компания «Океан Электроники» предлагает заключение долгосрочных отношений при поставках импортных электронных компонентов на взаимовыгодных условиях!

Наши преимущества:

- Поставка оригинальных импортных электронных компонентов напрямую с производств Америки, Европы и Азии, а так же с крупнейших складов мира;
- Широкая линейка поставок активных и пассивных импортных электронных компонентов (более 30 млн. наименований);
- Поставка сложных, дефицитных, либо снятых с производства позиций;
- Оперативные сроки поставки под заказ (от 5 рабочих дней);
- Экспресс доставка в любую точку России;
- Помощь Конструкторского Отдела и консультации квалифицированных инженеров;
- Техническая поддержка проекта, помощь в подборе аналогов, поставка прототипов;
- Поставка электронных компонентов под контролем ВП;
- Система менеджмента качества сертифицирована по Международному стандарту ISO 9001;
- При необходимости вся продукция военного и аэрокосмического назначения проходит испытания и сертификацию в лаборатории (по согласованию с заказчиком);
- Поставка специализированных компонентов военного и аэрокосмического уровня качества (Xilinx, Altera, Analog Devices, Intersil, Interpoint, Microsemi, Actel, Aeroflex, Peregrine, VPT, Syfer, Eurofarad, Texas Instruments, MS Kennedy, Miteq, Cobham, E2V, MA-COM, Hittite, Mini-Circuits, General Dynamics и др.);

Компания «Океан Электроники» является официальным дистрибьютором и эксклюзивным представителем в России одного из крупнейших производителей разъемов военного и аэрокосмического назначения «JONHON», а так же официальным дистрибьютором и эксклюзивным представителем в России производителя высокотехнологичных и надежных решений для передачи СВЧ сигналов «FORSTAR».



JONHON

«JONHON» (основан в 1970 г.)

Разъемы специального, военного и аэрокосмического назначения:

(Применяются в военной, авиационной, аэрокосмической, морской, железнодорожной, горно- и нефтедобывающей отраслях промышленности)

«FORSTAR» (основан в 1998 г.)

ВЧ соединители, коаксиальные кабели,
кабельные сборки и микроволновые компоненты:

(Применяются в телекоммуникациях гражданского и специального назначения, в средствах связи, РЛС, а так же военной, авиационной и аэрокосмической отраслях промышленности).



Телефон: 8 (812) 309-75-97 (многоканальный)

Факс: 8 (812) 320-03-32

Электронная почта: ocean@oceanchips.ru

Web: <http://oceanchips.ru/>

Адрес: 198099, г. Санкт-Петербург, ул. Калинина, д. 2, корп. 4, лит. А