

STAMPED AND FORMED CONTACTS, PG 1 of 2

Click on [blue underlined part numbers](#) to be taken to their spec sheets.

OPTIONS

PART NUMBER: [AT62-14-01XX](#)
DESCRIPTION: CONTACT, SOCKET, STAMPED, SIZE 16

MATERIAL:
 CONTACT BODY: COPPER ALLOY
 HOOD: STAINLESS STEEL
PLATING SUFFIX CODE:
 XX=22 NICKEL PLATING
 XX=44 GOLD PLATING
CONTACT GENERAL DATA SPECIFICATION: S2-15217
AVAILABLE CRIMPERS: ATT-16-00, MFX-3950 & MFX-3953
CRIMPER SPECIFICATIONS: S2-15223 & S2-15224
CRIMP INFORMATION DRAWING: S2-15221 & S2-15222
CONTACTS PER REEL: APPROX. 4000 (PARTIAL REELS AVAILABLE)



PART NUMBER: [AT62-16-01XX](#)
DESCRIPTION: CONTACT, SOCKET, STAMPED, SIZE 16

MATERIAL:
 CONTACT BODY: COPPER ALLOY
 HOOD: STAINLESS STEEL
PLATING SUFFIX CODE:
 XX=22 NICKEL PLATING
 XX=44 GOLD PLATING
CONTACT GENERAL DATA SPECIFICATION: S2-15217
AVAILABLE CRIMPERS: ATT-16-00, ATT-16-01, MFX-3950 & MFX-3953
CRIMPER SPECIFICATIONS: S2-15223 & S2-15224
CRIMP INFORMATION DRAWING: S2-15221 & S2-15222
CONTACTS PER REEL: APPROX. 4000 (PARTIAL REELS AVAILABLE)



PART NUMBER: [AT62-16-06XX](#)
DESCRIPTION: CONTACT, SOCKET, STAMPED, SIZE 16

MATERIAL:
 CONTACT BODY: COPPER ALLOY
 HOOD: STAINLESS STEEL
PLATING SUFFIX CODE:
 XX=22 NICKEL PLATING
 XX=44 GOLD PLATING
CONTACT GENERAL DATA SPECIFICATION: S2-15217
AVAILABLE CRIMPERS: ATT-16-01, MFX-3950 & MFX-3953
CRIMPER SPECIFICATIONS: S2-15223 & S2-15224
CRIMP INFORMATION DRAWING: S2-15221 & S2-15222
CONTACTS PER REEL: APPROX. 4000 (PARTIAL REELS AVAILABLE)



PART NUMBER: [AT60-14-01XX](#)
DESCRIPTION: CONTACT, PIN, STAMPED, SIZE 16

MATERIAL: COPPER ALLOY
PLATING SUFFIX CODE:
 XX=22 NICKEL PLATING
 XX=44 GOLD PLATING
CONTACT GENERAL DATA SPECIFICATION: S2-15217
AVAILABLE CRIMPERS: ATT-16-00, MFX-3950 & MFX-3953
CRIMPER SPECIFICATIONS: S2-15223 & S2-15224
CRIMP INFORMATION DRAWING: S2-15221 & S2-15222
CONTACTS PER REEL: APPROX. 4000 (PARTIAL REELS AVAILABLE)



STAMPED AND FORMED CONTACTS, PG 2 of 2

Click on [blue underlined part numbers](#) to be taken to their spec sheets.

OPTIONS

PART NUMBER: [AT60-16-01XX](#)
DESCRIPTION: CONTACT, PIN, STAMPED, SIZE 16
MATERIAL: COPPER ALLOY
PLATING SUFFIX CODE:
 XX=22 NICKEL PLATING
 XX=44 GOLD PLATING
CONTACT GENERAL DATA SPECIFICATION: S2-15217
AVAILABLE CRIMPERS: ATT-16-00, ATT-16-01, MFX-3950 & MFX-3953
CRIMPER SPECIFICATIONS: S2-15223 & S2-15224
CRIMP INFORMATION DRAWING: S2-15221 & S2-15222
CONTACTS PER REEL: APPROX. 4000 (PARTIAL REELS AVAILABLE)

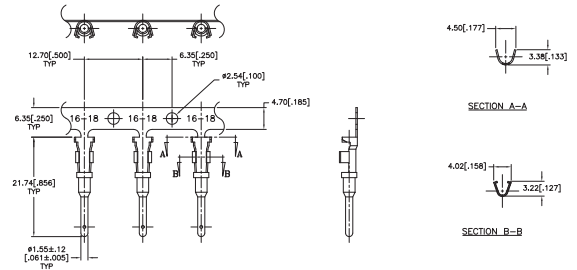

PART NUMBER: [AT60-16-06XX](#)
DESCRIPTION: CONTACT, PIN, STAMPED, SIZE 16
MATERIAL: COPPER ALLOY
PLATING SUFFIX CODE:
 XX=22 NICKEL PLATING
 XX=44 GOLD PLATING
CONTACT GENERAL DATA SPECIFICATION: S2-15217
AVAILABLE CRIMPERS: ATT-16-01, MFX-3950 & MFX-3953
CRIMPER SPECIFICATIONS: S2-15223 & S2-15224
CRIMP INFORMATION DRAWING: S2-15221 & S2-15222
CONTACTS PER REEL: APPROX. 4000 (PARTIAL REELS AVAILABLE)

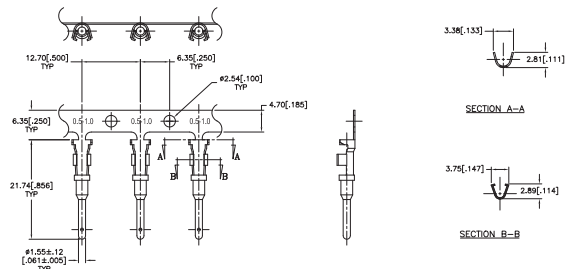

SOLID/MACHINED CONTACTS

Click on [blue underlined part numbers](#) to be taken to their spec sheets.

OPTIONS

MILITARY-STYLE

PART NUMBER: [AT60-202-16XX](#)
DESCRIPTION: CONTACT, PIN, SOLID MACHINED, SIZE 16
MATERIAL: COPPER ALLOY
PLATING SUFFIX CODE:
 XX=141 NICKEL PLATING
 XX=31 GOLD PLATING
CONTACT GENERAL DATA SPECIFICATION: S2-15217
AVAILABLE CRIMPERS: CA-5D12 & CA-5E12
CRIMPER SPECIFICATIONS: S2-15219 & S2-15220
CRIMP INFORMATION DRAWING: S2-15218



PART NUMBER: [AT62-201-16XX](#)
DESCRIPTION: CONTACT, SOCKET, SOLID MACHINED, SIZE 16
MATERIAL:
 CONTACT BODY: COPPER ALLOY
 HOOD: STAINLESS STEEL
PLATING SUFFIX CODE:
 XX=141 NICKEL PLATING
 XX=31 GOLD PLATING
CONTACT GENERAL DATA SPECIFICATION: S2-15217
AVAILABLE CRIMPERS: CA-5D12 & CA-5E12
CRIMPER SPECIFICATIONS: S2-15219 & S2-15220
CRIMP INFORMATION DRAWING: S2-15218



ROCKSOLID™ CONTACTS

PART NUMBER: [65-54942-14](#)
DESCRIPTION: CONTACT, SOCKET, ROCKSOLID, SIZE 16
AWG RANGE: 14AWG
MATERIAL: COPPER ALLOY
PLATING: GOLD
CONTACT GENERAL DATA SPECIFICATION: S2-15217
AVAILABLE CRIMPERS: CA-5D12 & CA-5E12
CRIMPER SPECIFICATIONS: S2-15219 & S2-15220
CRIMP INFORMATION DRAWING: S2-15218

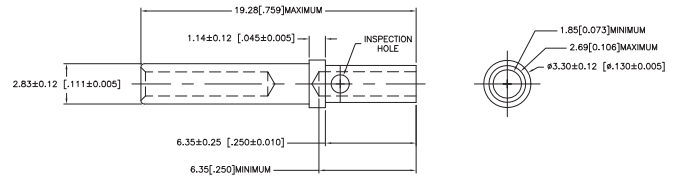

PART NUMBER: [65-54942-16](#)
DESCRIPTION: CONTACT, SOCKET, ROCKSOLID, SIZE 16
AWG RANGE: 16AWG
MATERIAL: COPPER ALLOY
PLATING: GOLD
CONTACT GENERAL DATA SPECIFICATION: S2-15217
AVAILABLE CRIMPERS: CA-5D12 & CA-5E12
CRIMPER SPECIFICATIONS: S2-15219 & S2-15220
CRIMP INFORMATION DRAWING: S2-15218



PART NUMBER: [65-54942-20](#)
DESCRIPTION: CONTACT, SOCKET, ROCKSOLID, SIZE 16
AWG RANGE: 20AWG
MATERIAL: COPPER ALLOY
PLATING: GOLD
CONTACT GENERAL DATA SPECIFICATION: S2-15217
AVAILABLE CRIMPERS: CA-5D12 & CA-5E12
CRIMPER SPECIFICATIONS: S2-15219 & S2-15220
CRIMP INFORMATION DRAWING: S2-15218

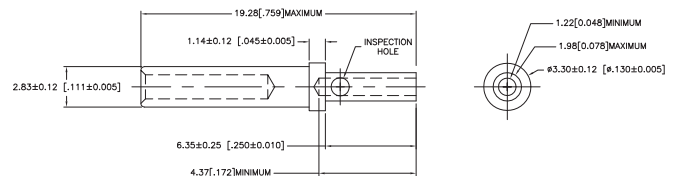

REVISIONS					
REV	ECO	DESCRIPTION	DATE	BY	APPR
A1	-	RELEASE NUMBER 016571	6/12/09	B.D.B.	M.R.F.

USE CRIMPER NUMBER:
ATT-16-00 WITH CAVITY A & B

CONTACT P/N:	INSULATION ϕ	CAVITY	WIRE SIZE
AT60-16-01**	.075 - .140	B	1.5mm ²
AT62-16-01**	[1.91 - 3.56]	A	16AWG
		A	1.0mm ²
AT60-14-01**	.095 - .150	B	14AWG
AT62-14-01**	[2.41 - 3.81]	B	2.0mm ²
		B	1.5mm ²
		A	1.5mm ²
		A	16AWG
		A	1.0mm ²
AT60-16-06**	.055 - .100	A	16AWG
AT62-16-06**	[1.40 - 2.54]	A	1.0mm ²

USE CRIMPER NUMBER:
ATT-16-01 WITH CAVITY C & D

CONTACT P/N:	INSULATION ϕ	CAVITY	WIRE SIZE
AT60-16-01**	.075 - .140	D	18AWG
AT62-16-01**	[1.91 - 3.56]	D	.75mm ²
AT60-16-06**	.055 - .100	D	18AWG
AT62-16-06**	[1.40 - 2.54]	D	.75mm ²
		C	.50mm ²

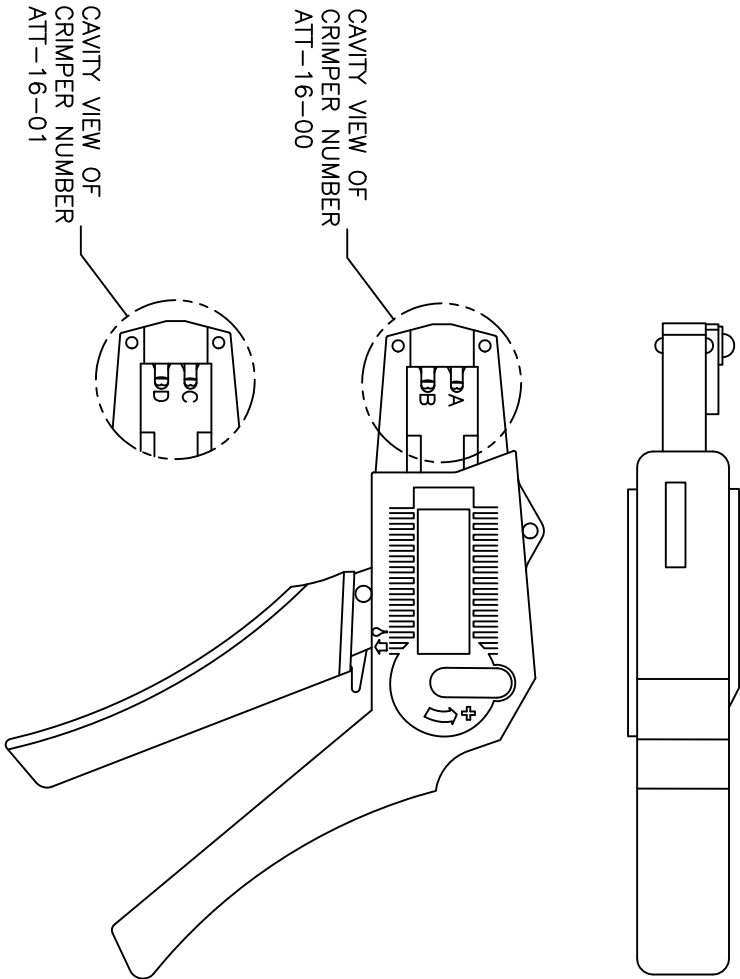

ALL REFERENCES TO DEUTSCH PRODUCTS OR SPECIFICATIONS ARE FOR COMPARISON PURPOSES ONLY, AND REFER TO DEUTSCH INDUSTRIAL PRODUCTS.

- NOTES (UNLESS OTHERWISE SPECIFIED):
- ALL DIMENSIONS IN INCHES [MILLIMETERS]
 - FOR PLATING CODES ** SEE CONTACT DATA DRAWINGS.
 - THIS TOOL IS FOR CRIMPING SIZE 16 CONTACTS ONLY TO WIRES LISTED IN THE CHARTS.
 - DEUTSCH IPD CROSS REFERENCE PART NUMBERS ARE DTT-16-00 AND DTT-16-01.

QUANTITY	PART NUMBER	DESCRIPTION	ITER#
MATERIALS LIST			
<p>UNLESS OTHERWISE SPECIFIED</p> <p>1) All dimensions are in inches.</p> <p>2) Tolerances are as follows:</p> <p>3) Fin. DEC .0008 Taper .0015 .015</p> <p>4) Hole Reference = A</p> <p>5) Finish: SM .00020</p> <p>6) Material Specifications: N/A</p> <p>7) Process Specifications: N/A</p> <p>8) Next Asst:</p>			
SIGNATURES		DATE	
DESIGNED: BERNUW	6/8/09		
CHECKED: FORCE	6/8/09		
ENGINEER: BERNUW			
APPROVAL: BERNUW	6/8/09		
CUSTOMER:			
THE USE OF THIS DOCUMENT IS UNLIMITED DESIGN FEATURES. SPECIAL DATA SHEETS ARE THE PROPERTY OF AMPHENOL CORP. ALL DIMENSIONS AND TOLERANCES ARE UNLESS OTHERWISE SPECIFIED. DOCUMENTS REFERENCED HEREON MAY CONTAIN UNLIMITED VARIATIONS. DEUTSCH INDUSTRIAL PROPERTY DIV.		SIZE: PCD# NOT DIMS NO:	REVISION
A Subsidiary of Amphenol Corporation 44724 Morley Drive Clinton Township, MI 48036		B 16K44	A1
INSTRUCTIONS: ATT-16-00 & 01 CRIMPER, HAND, STAMPED CONTACTS		S2-15223	
		S2-15223	
		SHEET 1 OF 1	

REV ZONE		ECO	DESCRIPTION	DATE	BY	APP
AT	-	-	RELEASE NUMBER 016871	6/12/09	B.D.B.	M.F.F.

STAMPED CONTACT PART NUMBER 106=PIN 106=SOCKET	SIZE	CONDUCTOR WIRE SIZE	CRIMP HEIGHT	CRIMP WIDTH	CONDUCTOR PUNCH NUMBER	CONDUCTOR ANVIL NUMBER	CRIMP TENSILE REFERENCE
AT80-14-011x AT82-14-011x INSULATION RANGE 0.095-0.150(2.41-3.81)	16	14 AWG 2.00mm ² 1.50mm ² 16 AWG 1.00mm ² 18 AWG 0.75mm ²	0.055(1.40) 0.055(1.40) 0.055(1.39) 0.050(1.27) 0.049(1.24) 0.048(1.22)	±0.003 INCH [±0.08 mm]	AT17-002-0200	AT17-101-0200	28(111)
AT60-16-011x AT62-16-011x INSULATION RANGE 0.075-0.140(1.91-3.56)	16	16 AWG 1.00mm ² 18 AWG 0.75mm ²	0.050(1.27) 0.051(1.30) 0.050(1.27) 0.049(1.24)	0.094(2.39) 0.094(2.39) 0.094(2.39) 0.094(2.39)	AT17-002-0200	AT17-101-0200	28(111)
AT60-16-066x INSULATION RANGE 0.055-0.100(1.40-2.54)	16	16 AWG 1.00mm ² 20 AWG 0.50mm ²	0.050(1.27) 0.049(1.24) 0.048(1.22) 0.045(1.14)	0.079(2.01) 0.079(2.01) 0.079(2.01) 0.079(2.01)	AT17-003-0200	AT17-103-0200	28(111) 15(67)

CROSS REFERENCE

SINE PART NUMBER	DEUTSCH PART NUMBER
MX-3950	DC116-02-00
AT17-002-0200	1017-002-0200
AT17-003-0200	1017-003-0200
AT17-101-0200	1017-101-0200
AT17-103-0200	1017-103-0200
AT17-210-0200	1017-210-0200
AT17-211-0200	1017-211-0200
AT17-213-0200	1017-213-0200
AT17-214-0200	1017-214-0200
AT17-217-0200	1017-217-0200
AT17-218-0200	1017-218-0200
AT17-310-0200	1017-310-0200
AT17-311-0200	1017-311-0200
AT17-313-0200	1017-313-0200
AT17-304-0200	1017-304-0200
AT17-317-0200	1017-317-0200

NOTES: UNLESS OTHERWISE SPECIFIED

1. ALL DIMENSIONS ARE IN INCHES(mm).
2. FORCES ARE IN POUNDS(LBS) AND NEWTONS(N).
3. "X"= PLATING SUFFIX. SEE INDIVIDUAL CONTACT DRAWING.
4. WIRE STRIP LENGTH: 0.175±0.029(4.43±0.74). BROKEN OR MISSING CONDUCTOR STRANDS ARE NOT ACCEPTABLE.
5. USE A BLADE MICROMETER (0.100(2.54) MIN SPACING AND 0.060(0.010(1.50)(0.040) ANVIL) TO MEASURE THE CONDUCTOR CRIMP. SEE SECTION AA.
6. CRIMP TENSILE STRENGTH IS DETERMINED AT A PULL RATE SPEED OF 1.00 INCH(25.4) PER MINUTE. INSULATION WINGS ARE REMOVED FOR TEST. ACTUAL CRIMP TENSILE STRENGTH DEPENDS ON WIRE/CONDUCTOR SIZE. VALUES ON THIS SPECIFICATION ARE FOR REFERENCE ONLY.
7. INSULATION DIAMETER RANGE IS DETERMINED BY CONNECTOR AND ITS WIRE SEAL SIZE. SEE CONNECTOR DRAWING FOR INSULATION RANGE.
8. INSULATION CRIMP DIAMETER SHOULD BE THE EQUAL OR LESS THAN THE DIAMETER OF THE WIRE INSULATION (HARD OR TEFION INSULATION MAY BE AN EXCEPTION). INSULATION CRIMP SHALL NOT AFFECT REMOVAL TOOL PERFORMANCE AND SHALL NOT DAMAGE CONNECTOR GROMMET SEAL.
9. CONDUCTOR TYPE ARE PER SAE J1128(AWG) AND ISO 6122(METRIC)
10. FOR CONTACT MATERIAL AND PERFORMANCE DATA, SEE DRAWING S2-15217.
11. REFER TO S2-15223 AND S2-15224 AND CROSS REFERENCE CHARTS FOR CRIMP TOOL DATA.

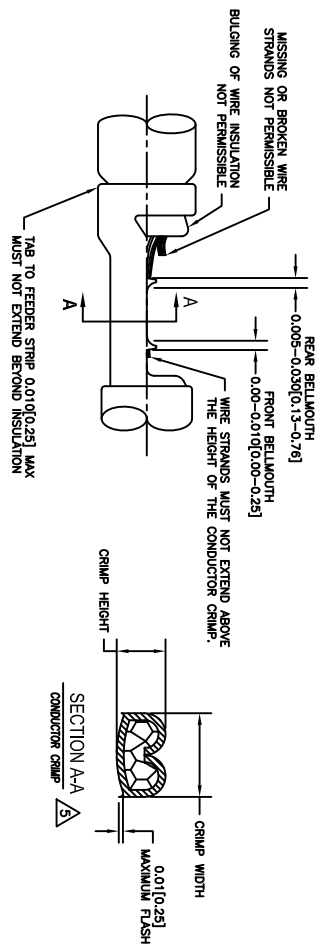
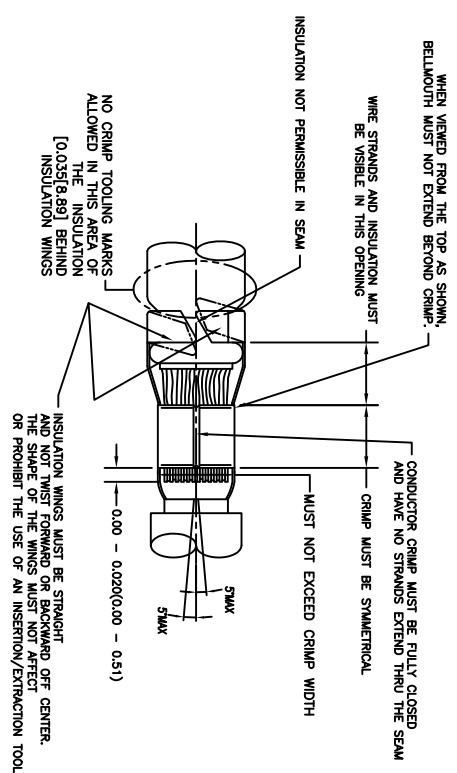

ALL REFERENCES TO DEUTSCH PRODUCTS OR SPECIFICATIONS ARE FOR COMPARISON PURPOSES ONLY, AND REFER TO DEUTSCH INDUSTRIAL PRODUCTS.

QUANTITY	PART NUMBER	MATERIALS LIST	DESCRIPTION	ITEM
UNLESS OTHERWISE SPECIFIED				
1) All dimensions are in inches.				
2) Plating is as shown.				
3) Plating is as shown.				
4) Plating is as shown.				
5) Reduction Standards Per:				
a) MIL-STD-20020				
b) MIL-STD-20020				
c) MIL-STD-20020				
d) MIL-STD-20020				
APPROVAL SIGNATURES				
DESIGNED BY	ROTOR	DATE	4/7/09	
CHECKED BY	ROTOR	DATE	6/8/09	
ENGINEER	BERNIM	DATE	6/8/09	
APPROVAL	BERNIM	DATE	6/8/09	
CUSTOMER: NA				
THE USE OF THIS DRAWING IS SPECIFIC TO THE PART AND PERFORMANCE DATA. ANY OTHER USE WITHOUT THE WRITTEN PERMISSION OF AMPHENOL CORP. ALL DIMENSIONS ARE SUBJECT TO REMOVAL DOCUMENTS REFERENCED HEREON UNLESS OTHERWISE NOTED.				
CRIMP DATA, STAMPED CONTACTS FOR CRIMPER MFX-3950				
SIZE	10K44	SCALE	NONE	
REV	A1	SHEET	1	OF 1

A

B

C

D

REVOLUTIONS		DESCRIPTION	DATE	BY	APP
REV	ZONE	ECO	RELEASE NUMBER	B.D.B.	M.F.F.
A1	-	-	016971	6/12/09	

STAMPED CONTACT PART NUMBER (1009=PIN 1009=SOCKET)	SIZE	CONDUCTOR WIRE SIZE	CRIMP HEIGHT (+0.001/-0.002 INCH / +0.025/-0.05 mm)	CRIMP WIDTH (±0.013 INCH / ±0.08 mm)	CONDUCTOR PUNCH NUMBER	CONDUCTOR ANVIL NUMBER	CRIMP TENSILE REFERENCE (LBS/IN)
A160-14-011x A162-14-011x INSULATION RANGE 0.095-0.150(2.41-3.81)	16	14 AWG	0.055(1.40)	0.094(2.39)			
		2.00mm ²	0.055(1.40)	0.094(2.39)			
		1.50mm ²	0.053(1.33)	0.094(2.39)			
A160-16-011x A162-16-011x INSULATION RANGE 0.075-0.140(1.91-3.56)	16	16 AWG	0.050(1.27)	0.094(2.39)	A117-083-0200	A117-183-0200	29(111)
		1.00mm ²	0.050(1.27)	0.094(2.39)			
		18 AWG	0.048(1.24)	0.094(2.39)			
		0.75mm ²	0.048(1.24)	0.094(2.39)			
		16 AWG	0.050(1.27)	0.092(2.01)			
		1.00mm ²	0.048(1.24)	0.092(2.01)			
A160-16-069x A162-16-069x INSULATION RANGE 0.055-0.100(1.40-2.54)	16	18 AWG	0.048(1.24)	0.079(2.01)	A117-082-0200	A117-182-0200	29(111)
		0.75mm ²	0.048(1.24)	0.079(2.01)			
		20 AWG	0.048(1.24)	0.079(2.01)			

CROSS REFERENCE

INSULATION DIAMETER RANGE	INSULATION PUNCH NUMBER	INSULATION ANVIL NUMBER	SINE PART NUMBER	DEUTSCH PART NUMBER
0.120-0.150 [3.05-3.81]	A117-225-0200	A117-325-0200	MPX-3953	DCH1620-02-00
0.105-0.125 [2.67-3.18]	A117-226-0200	A117-326-0200	A117-083-0200	1017-083-0200
0.085-0.111 [2.16-2.82]	A117-227-0200	A117-327-0200	A117-082-0200	1017-082-0200
0.075-0.105 [1.91-2.67]	A117-228-0200	A117-328-0200	A117-183-0200	1017-183-0200
0.063-0.094 [1.62-2.39]	A117-229-0200	A117-329-0200	A117-182-0200	1017-182-0200
0.050-0.075 [1.27-1.91]	A117-230-0200	A117-330-0200	A117-225-0200	1017-225-0200
	A117-230-0200	A117-330-0200	A117-226-0200	1017-226-0200
	A117-230-0200	A117-330-0200	A117-227-0200	1017-227-0200
	A117-230-0200	A117-330-0200	A117-228-0200	1017-228-0200
	A117-230-0200	A117-330-0200	A117-229-0200	1017-229-0200
	A117-230-0200	A117-330-0200	A117-230-0200	1017-230-0200
	A117-230-0200	A117-330-0200	A117-325-0200	1017-325-0200
	A117-230-0200	A117-330-0200	A117-326-0200	1017-326-0200
	A117-230-0200	A117-330-0200	A117-327-0200	1017-327-0200
	A117-230-0200	A117-330-0200	A117-328-0200	1017-328-0200
	A117-230-0200	A117-330-0200	A117-329-0200	1017-329-0200
	A117-230-0200	A117-330-0200	A117-330-0200	1017-330-0200

NOTES: UNLESS OTHERWISE SPECIFIED

- ALL DIMENSIONS ARE IN INCHES(mm).
- FORCES ARE IN POUNDS(LBS) AND NEWTONS(N).
- "X"= PLATING SUFFIX. SEE INDIVIDUAL CONTACT DRAWING.
- WIRE STRIP LENGTH: 0.175±0.02(4.43±0.54). BROKEN OR MISSING CONDUCTOR STRANDS ARE NOT ACCEPTABLE. USE A BLADE MICROMETER (0.100(2.54) MIN SPINDLE AND 0.060(0.010(1.50)(0.040) ANVIL) TO MEASURE THE CONDUCTOR CRIMP. SEE SECTION AA.
- CRIMP TENSILE STRENGTH IS DETERMINED AT A PULL RATE SPEED OF 1.00 INCH(2.54) PER MINUTE. INSULATION WINGS ARE REMOVED FOR TEST. ACTUAL CRIMP TENSILE STRENGTH DEPENDS ON WIRE/CONDUCTOR SIZE. VALUES ON THIS SPECIFICATION ARE FOR REFERENCE ONLY.
- INSULATION DIAMETER RANGE IS DETERMINED BY CONNECTOR AND ITS WIRE SEAL SIZE. SEE CONNECTOR DRAWING FOR INSULATION RANGE.
- INSULATION CRIMP DIAMETER SHOULD BE THE EQUAL OR LESS THAN THE DIAMETER OF THE WIRE INSULATION (HARD OR TEFLON INSULATION MAY BE AN EXCEPTION). INSULATION CRIMP SHALL NOT AFFECT REMOVAL TOOL PERFORMANCE AND SHALL NOT DAMAGE CONNECTOR GROMMET SEAL.
- CONDUCTOR TYPE ARE PER SAE J1128(AWG) AND ISO 6122(METRIC)
- FOR CONTACT MATERIAL AND PERFORMANCE DATA. SEE DRAWING S2-15217.
- REFER TO S2-15223 AND S2-15224 AND CROSS REFERENCE CHARTS FOR CRIMP TOOL DATA.

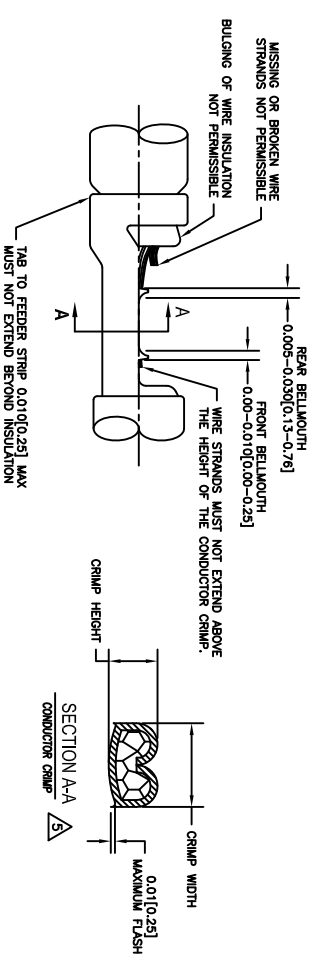
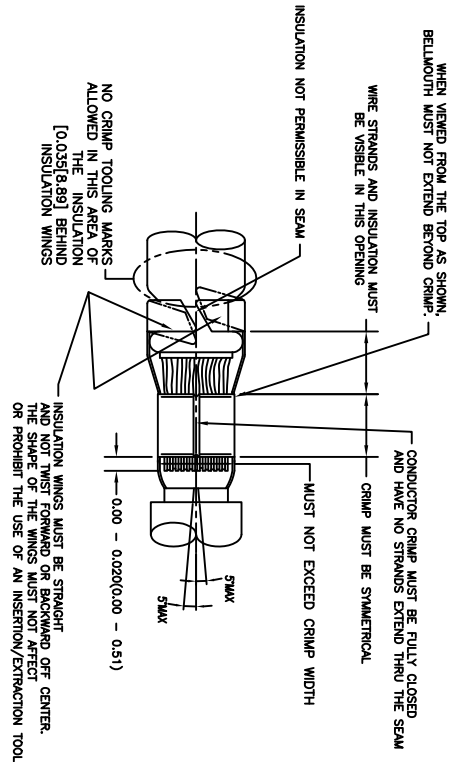

ALL REFERENCES TO DEUTSCH PRODUCTS OR SPECIFICATIONS ARE FOR COMPARISON PURPOSES ONLY, AND REFER TO DEUTSCH INDUSTRIAL PRODUCTS.

QUANTITY	PART NUMBER	DESCRIPTION	ITEM
MATERIALS LIST			
SINE SYSTEMS CORPORATION			
A Subsidiary of Amphenol Corporation			
44724 Moley Drive			
Clinton Township, MI 48036			
CRIMP DATA, STAMPED CONTACTS FOR CRIMPER MPX-3953			

UNLESS OTHERWISE SPECIFIED	SIGNATURES	DATE
1) All dimensions are in inches.	DATE	4/7/09
2) 1 Pt. DEC 30.00	OWNER	6/8/09
3) 1 Pt. DEC 30.00	ENGINEER	6/8/09
4) 1 Pt. DEC 30.00	APPROVAL	6/8/09
5) Reduction Standard Per: S2-20020	CUSTOMER	
6) Material Specification: NA		

PROCESS SPECIFICATIONS	THE USE OF THIS DRAWING IS SPECIFIC TO THE DESIGN AND PERFORMANCE OF THE PRODUCT. ANY MODIFICATION OR ALTERATION TO THE ORIGINAL DESIGN SHALL BE APPROVED BY THE DESIGN ENGINEER. ALL DIMENSIONS ARE SUBJECT TO NORMAL TOLERANCES UNLESS OTHERWISE SPECIFIED. DIMENSIONS REFERRED HEREON MAY BE OBTAINED FROM THE DRAWING.
SIZE: F304 1/2	SCALE: NONE
10K44	S2-15221
SHEET 1 OF 1	

REVOLUTIONS		DESCRIPTION	DATE	BY	APPR
REV	ZONE	ECO	RELEASE NUMBER 016571	B.D.B.	M.R.F.
1	-	-	6/12/09		

CONTACT LOCATOR "TURRET"
THREE POSITION FOR SIZE
12, 16 & 20 MALE AND
FEMALE CONTACTS

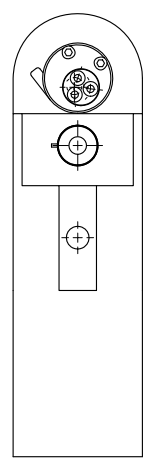

"TURRET"
RELEASE LATCH

SELECTOR FOR
CRIMP SETTING

THREADED HOLE FOR
ATTACHMENT OF
BENCH MOUNT FIXTURE

THREADED OPENING
FOR COMPRESSED
AIR FITTING

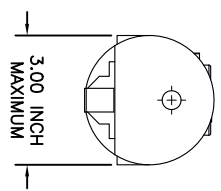
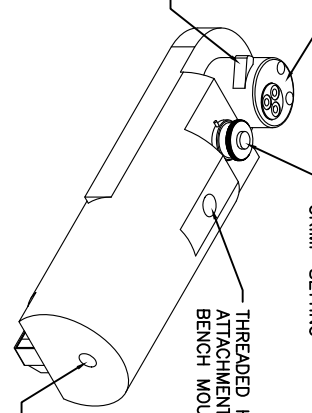

10.00 INCH
MAXIMUM

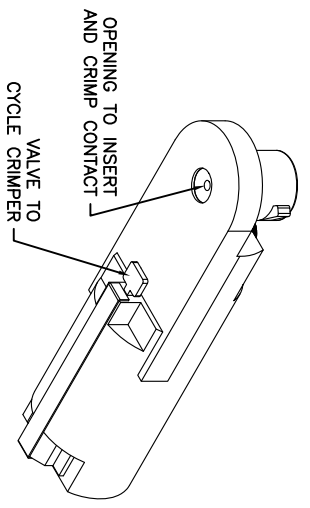
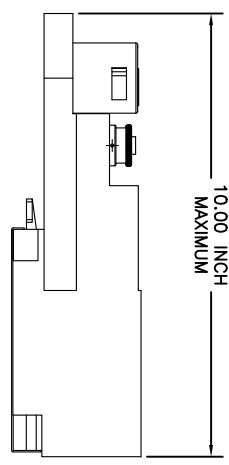

GAGE PART NO.	A GO DIA.	B NO-GO DIA.	SELECTOR NUMBER
G125	.0390	.0440	4

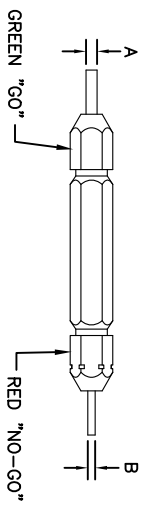

GAGING INSTRUCTIONS

CAUTION!
DO NOT CRIMP GAGE!

"GO" GAGING: OPERATE TOOL TO FULLY CLOSED POSITION. INSERT "GO" GAGE END AS SHOWN. GAGE MUST PASS FREELY BETWEEN INDENTER TIPS.

"NO-GO" GAGING: OPERATE TOOL TO FULLY CLOSED POSITION. INSERT "NO-GO" GAGE END AS SHOWN. THE "NO-GO" MAY PARTIALLY ENTER THE INDENTER OPENING, BUT MUST NOT PASS COMPLETELY THROUGH THE OPENING.

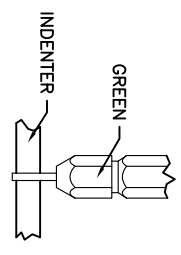

SELECTOR NUMBER	A GO DIA.	B NO-GO DIA.
1	.0280	.0330
2	.0320	.0370
3	.0360	.0410
4	.0390	.0440
5	.0450	.0500
6	.0520	.0570
7	.0590	.0640
8	.0880	.0730

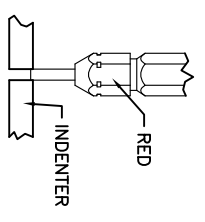

- THE CA-5E12 IS A COMPRESSED AIR OPERATED HAND CRIMPER FOR ELECTRICAL CONTACTS. IT IS ADJUSTABLE TO 3 CONTACT SIZES (12, 16 & 20) AND 8 INDENTER CRIMP POSITIONS FOR DIFFERENT WIRE SIZES (12AWG THRU 26 AWG).
- 80-120 PSI COMPRESSED AIR.
- WEIGHT: 3.1 LBS
- SELECTING CONTACT SIZE: PRESS THE RELEASE LATCH ON SIDE OF THE CONTACT LOCATOR "TURRET". ROTATE TO THE DESIRED CONTACT SIZE. THE TOP OF THE "TURRET" IS EMBOSSED WITH THE CONTACT SIZES.
- SELECTING WIRE SIZE: GRASP THE SELECTOR AND ROTATE TO THE DESIRED NUMBER.

CONTACT SIZE	LOCATOR "TURRET" POSITION	WIRE COLOR	SELECTOR NUMBER
20-20	RED	1	2
16-22	BLUE	4	5
16-20	BLUE	1	2
16-16	BLUE	4	5
12-16	YELLOW	4	5
12-12	YELLOW		7
			8

QUANTITY	PART NUMBER	DESCRIPTION	ITEM
		MATERIALS LIST	

SINE Systems Corporation
A Subsidiary of Amphipol Corporation
44724 Mowley Drive
Canton Township, MI 48036

INSTRUCTIONS FOR CA-5E12 CRIMPER, PNEUMATIC

SIZE: 10K44
SCALE: NONE
S2-15220
SHEET 1 OF 1

UNLESS OTHERWISE SPECIFIED	SIGNATURES	DATE
1) All dimensions are in inches.	DESIGN: BERNIM	6/2/09
2) Pl. DEC 2000 1 Position 31/4"	CHECKER: NONE	6/3/09
3) Pl. DEC 2000 1 Position 31/4"	ENGINEER: BERNIM	
4) Pl. DEC 2000 1 Position 31/4"	APPROVAL: BERNIM	6/3/09

REV ZONE		ECO		REVISIONS		DESCRIPTION		DATE	BY	APPR
AI	-	-	-	RELEASE NUMBER	016571	6/12/09	B.D.B.	M.R.F.		

CONTACT LOCATOR
"TURRET"
THREE POSITIONS FOR
SIZE 12, 16 & 20 MALE
AND FEMALE CONTACTS

"TURRET" RELEASE LATCH

6.25 INCH
MAXIMUM
OPEN

2.30 INCH
MAXIMUM
CLOSED

SELECTOR FOR CRIMP
SETTING

1.125 INCH MAX.

9.75 INCH MAXIMUM

1.00 INCH MAX.

- NOTES:
- THE CA-5D12 IS A HAND OPERATED CRIMPER FOR ELECTRICAL CONTACTS. IT IS ADJUSTABLE TO 3 CONTACT SIZES (12, 16 & 20) AND 8 INDENTER CRIMP POSITIONS FOR DIFFERENT WIRE SIZES (12AWG THRU 26 AWG).
 - WEIGHT: 1.64 LBS
 - SELECTING CONTACT SIZE: PRESS THE RELEASE LATCH ON SIDE OF THE CONTACT LOCATOR "TURRET". ROTATE TO THE DESIRED CONTACT SIZE. THE TOP OF THE "TURRET" IS EMBOSSED WITH THE CONTACT SIZES.
 - SELECTING WIRE SIZE: REMOVE THE LOCKING CLIP. GRASP THE SELECTOR AND ROTATE TO THE DESIRED NUMBER.

GAGE PART NO.	A GO DIA.	B NO-GO DIA.	SELECTOR NUMBER
G125	.0390	.0440	4

GAGING INSTRUCTIONS

CAUTION!
DO NOT CRIMP GAGE!

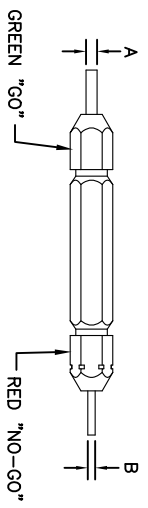

"GO" GAGING: OPERATE TOOL TO FULLY CLOSED POSITION. INSERT "GO" GAGE END AS SHOWN. GAGE MUST PASS FREELY BETWEEN INDENTER TIPS.

"NO-GO" GAGING: OPERATE TOOL TO FULLY CLOSED POSITION. INSERT "NO-GO" GAGE END AS SHOWN. THE "NO-GO" MAY PARTIALLY ENTER THE INDENTER OPENING, BUT MUST NOT PASS COMPLETELY THROUGH THE OPENING.

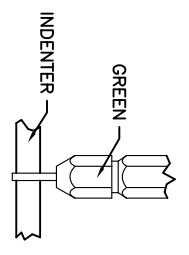

SELECTOR NUMBER	A GO DIA.	B NO-GO DIA.
1	.0280	.0330
2	.0320	.0370
3	.0360	.0410
4	.0390	.0440
5	.0450	.0500
6	.0520	.0570
7	.0590	.0640
8	.0880	.0730

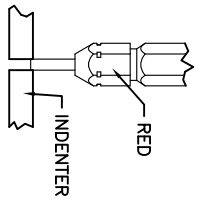

CONTACT SIZE	LOCATOR "TURRET" POSITION	WIRE COLOR	1	2	3	4	5	6	7	8
20-20	RED	1	2	3	4					
16-22	BLUE	4	5	6						
16-20	BLUE	1	2	3	4					
16-16	BLUE	4	5	6						
12-16	YELLOW	4	5	6						
12-12	YELLOW									8

QUANTITY	PART NUMBER	DESCRIPTION	ITEM

MATERIALS LIST		DESCRIPTION	
UNLESS OTHERWISE SPECIFIED	1) All dimensions are in inches.		
	2) Pl. 505 30.00 1 Precision 31/4"		
	3) Pl. 505 30.00 1 Precision 31/4"		
	4) Pl. 505 30.00 1 Precision 31/4"		
	5) Pl. 505 30.00 1 Precision 31/4"		
	6) Pl. 505 30.00 1 Precision 31/4"		
	7) Pl. 505 30.00 1 Precision 31/4"		
	8) Pl. 505 30.00 1 Precision 31/4"		
	9) Pl. 505 30.00 1 Precision 31/4"		
	10) Pl. 505 30.00 1 Precision 31/4"		
	11) Pl. 505 30.00 1 Precision 31/4"		
	12) Pl. 505 30.00 1 Precision 31/4"		
	13) Pl. 505 30.00 1 Precision 31/4"		
	14) Pl. 505 30.00 1 Precision 31/4"		
	15) Pl. 505 30.00 1 Precision 31/4"		
	16) Pl. 505 30.00 1 Precision 31/4"		
	17) Pl. 505 30.00 1 Precision 31/4"		
	18) Pl. 505 30.00 1 Precision 31/4"		
	19) Pl. 505 30.00 1 Precision 31/4"		
	20) Pl. 505 30.00 1 Precision 31/4"		
	21) Pl. 505 30.00 1 Precision 31/4"		
	22) Pl. 505 30.00 1 Precision 31/4"		
	23) Pl. 505 30.00 1 Precision 31/4"		
	24) Pl. 505 30.00 1 Precision 31/4"		
	25) Pl. 505 30.00 1 Precision 31/4"		
	26) Pl. 505 30.00 1 Precision 31/4"		
	27) Pl. 505 30.00 1 Precision 31/4"		
	28) Pl. 505 30.00 1 Precision 31/4"		
	29) Pl. 505 30.00 1 Precision 31/4"		
	30) Pl. 505 30.00 1 Precision 31/4"		
	31) Pl. 505 30.00 1 Precision 31/4"		
	32) Pl. 505 30.00 1 Precision 31/4"		
	33) Pl. 505 30.00 1 Precision 31/4"		
	34) Pl. 505 30.00 1 Precision 31/4"		
	35) Pl. 505 30.00 1 Precision 31/4"		
	36) Pl. 505 30.00 1 Precision 31/4"		
	37) Pl. 505 30.00 1 Precision 31/4"		
	38) Pl. 505 30.00 1 Precision 31/4"		
	39) Pl. 505 30.00 1 Precision 31/4"		
	40) Pl. 505 30.00 1 Precision 31/4"		
	41) Pl. 505 30.00 1 Precision 31/4"		
	42) Pl. 505 30.00 1 Precision 31/4"		
	43) Pl. 505 30.00 1 Precision 31/4"		
	44) Pl. 505 30.00 1 Precision 31/4"		
	45) Pl. 505 30.00 1 Precision 31/4"		
	46) Pl. 505 30.00 1 Precision 31/4"		
	47) Pl. 505 30.00 1 Precision 31/4"		
	48) Pl. 505 30.00 1 Precision 31/4"		
	49) Pl. 505 30.00 1 Precision 31/4"		
	50) Pl. 505 30.00 1 Precision 31/4"		
	51) Pl. 505 30.00 1 Precision 31/4"		
	52) Pl. 505 30.00 1 Precision 31/4"		
	53) Pl. 505 30.00 1 Precision 31/4"		
	54) Pl. 505 30.00 1 Precision 31/4"		
	55) Pl. 505 30.00 1 Precision 31/4"		
	56) Pl. 505 30.00 1 Precision 31/4"		
	57) Pl. 505 30.00 1 Precision 31/4"		
	58) Pl. 505 30.00 1 Precision 31/4"		
	59) Pl. 505 30.00 1 Precision 31/4"		
	60) Pl. 505 30.00 1 Precision 31/4"		
	61) Pl. 505 30.00 1 Precision 31/4"		
	62) Pl. 505 30.00 1 Precision 31/4"		
	63) Pl. 505 30.00 1 Precision 31/4"		
	64) Pl. 505 30.00 1 Precision 31/4"		
	65) Pl. 505 30.00 1 Precision 31/4"		
	66) Pl. 505 30.00 1 Precision 31/4"		
	67) Pl. 505 30.00 1 Precision 31/4"		
	68) Pl. 505 30.00 1 Precision 31/4"		
	69) Pl. 505 30.00 1 Precision 31/4"		
	70) Pl. 505 30.00 1 Precision 31/4"		
	71) Pl. 505 30.00 1 Precision 31/4"		
	72) Pl. 505 30.00 1 Precision 31/4"		
	73) Pl. 505 30.00 1 Precision 31/4"		
	74) Pl. 505 30.00 1 Precision 31/4"		
	75) Pl. 505 30.00 1 Precision 31/4"		
	76) Pl. 505 30.00 1 Precision 31/4"		
	77) Pl. 505 30.00 1 Precision 31/4"		
	78) Pl. 505 30.00 1 Precision 31/4"		
	79) Pl. 505 30.00 1 Precision 31/4"		
	80) Pl. 505 30.00 1 Precision 31/4"		
	81) Pl. 505 30.00 1 Precision 31/4"		
	82) Pl. 505 30.00 1 Precision 31/4"		
	83) Pl. 505 30.00 1 Precision 31/4"		
	84) Pl. 505 30.00 1 Precision 31/4"		
	85) Pl. 505 30.00 1 Precision 31/4"		
	86) Pl. 505 30.00 1 Precision 31/4"		
	87) Pl. 505 30.00 1 Precision 31/4"		
	88) Pl. 505 30.00 1 Precision 31/4"		
	89) Pl. 505 30.00 1 Precision 31/4"		
	90) Pl. 505 30.00 1 Precision 31/4"		
	91) Pl. 505 30.00 1 Precision 31/4"		
	92) Pl. 505 30.00 1 Precision 31/4"		
	93) Pl. 505 30.00 1 Precision 31/4"		
	94) Pl. 505 30.00 1 Precision 31/4"		
	95) Pl. 505 30.00 1 Precision 31/4"		
	96) Pl. 505 30.00 1 Precision 31/4"		
	97) Pl. 505 30.00 1 Precision 31/4"		
	98) Pl. 505 30.00 1 Precision 31/4"		
	99) Pl. 505 30.00 1 Precision 31/4"		
	100) Pl. 505 30.00 1 Precision 31/4"		

INSTRUCTIONS FOR CA-5D12
CRIMPER, HAND, MACHINED CONTACTS

SINE Systems Corporation
A Subsidiary of Amphenol Corporation
44724 Moley Drive
Canton Township, MI 48036

PROCESS SPECIFICATIONS:
M/A

THE USE OF THIS DRAWING IS
RESTRICTED TO THE ORIGINAL
PURPOSE AND ANY REPRODUCTION
HEREOF WITHOUT THE WRITTEN
CONSENT OF SINE SYSTEMS CORPORATION
IS PROHIBITED. ALL RIGHTS ARE
RESERVED.

SIZE: F304
SCALE: NONE
C 10K44
S2-15219
SHEET 1 OF 1

REVOLUTIONS		DESCRIPTION		DATE	BY	APPR
REV	ZONE	ECO	RELEASE NUMBER		B.D.B.	M.R.F.
A1	-	-	016571	6/12/09		

CONTACT P/N	SIZE TYPE	WIRE SIZE	REF. ONLY TENSILE LBS[N]
AT60-202-16XX	16PIN	1.5mm ² 16AWG	35[156]
AT62-201-16XX	16SOC	1.0mm ² 18AWG 0.75mm ² 20AWG	25[111]
		0.50mm ²	20[89]

RECOMMENDED STRIP LENGTH	
CONTACT SIZE	STRIP LENGTH INCH[MM]
16	0.250-0.312[6.35-7.92]

CRIMP TOOLING						
CONTACT SIZE	CRIMP TOOL PART NUMBER	CONTACT LOCATOR "TURRET" POSITION	WIRE SELECTOR NUMBER	GO GAGE INCH[MM]	"NOGO" GAGE INCH[MM]	REMARKS
16	CA-5D12 CA-5E12	BLUE	6	0.052[1.32]	0.057[1.45]	
16	CA-5D12 CA-5E12	BLUE	4	0.039[.991]	0.044[1.12]	SIZE 16 WITH 20 AWG WIRE

- NOTES: UNLESS OTHERWISE SPECIFIED
- 1. MINIMUM +/-0.0005 [0.013] TOLERANCE STEEL GAGE PINS. DO NOT CRIMP GAGE PINS. CLOSE DIE, THEN USE GAGE PINS.
 - 2. WHEN XX=31, CONTACT PLATING IS GOLD WHEN XX=141, CONTACT PLATING IS NICKEL
 - 3. PULL RATE OF 1.0 IN [25.4] PER MINUTE. ACTUAL STRENGTH DEPENDS ON WIRE SIZE.
 - 4. FOR CONTACT PERFORMANCE, MATERIAL SPECIFICATIONS AND APPLICATION DETAILS, SEE DRAWING S2-15217.
 - 5. CONDUCTOR STRANDS MUST BE VISIBLE THRU THE INSPECTION HOLE PRIOR TO CRIMP.
 - 6. PROPER CRIMP TOOLING WILL PRODUCE A CRIMP CENTERED BETWEEN THE INSPECTION HOLE AND CRIMP BARREL END.
 - 7. WIRE SIZES PER SAE J1128 AND J1560 [DIN 72551-6] REFERENCE INSTRUCTION MANUALS S2-15219 AND S2-15220 FOR CA-5D12 AND CA-5E12 HAND AND PNEUMATIC CRIMPER.
 - 8. THE CRIMP HEIGHT DIMENSION AFTER CRIMPING MAY VARY FROM THE VALUES LISTED FOR THE "GO-NOGO" PINS.

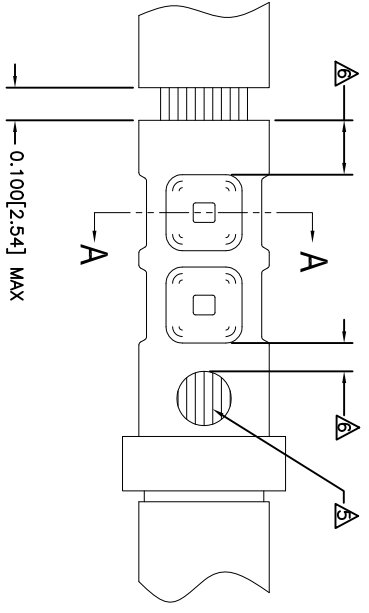
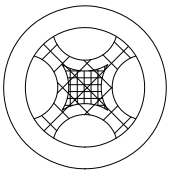

SECTION A-A
CRIMP CROSS-SECTION

QUANTITY	PART NUMBER	DESCRIPTION	ITEM
UNLESS OTHERWISE SPECIFIED			
1) All dimensions are in inches.			
2) For tolerances see ASME Y14.5-2009.			
3) Pl. SEE 30.011 Provisions 31/14			
4) Pl. SEE 30.011 Provisions 31/14			
5) Fabrication Standards Per:			
a) ASME SS-20020			
b) ASME SS-20020			
c) ASME SS-20020			
d) ASME SS-20020			
MATERIAL SPECIFICATIONS:			
MA			
PROCESS SPECIFICATIONS:			
NEXT ASSY:			
SIGNATURES		DATE	
DESIGNER: BERNIM	6/3/09		
CHECKER: TONCE	6/3/09		
ENGINEER: BERNIM			
APPROVAL: BERNIM	6/3/09		
CUSTOMER:			
THE USE OF THIS DRAWING IS LIMITED TO THE SPECIFIC APPLICATIONS AND PERFORMANCE SPECIFICATIONS AND PERFORMANCE PRESENTED ON THIS DRAWING. ANY OTHER USE WITHOUT THE WRITTEN PERMISSION OF AMPHENOL CORP. ALL DIMENSIONS ARE SUBJECT TO NORMAL DOCUMENT REVISIONS UNLESS OTHERWISE SPECIFIED.			
SIZE [PSD NOT DIMS]			
C [0K44]			
SCALE NONE		S2-15218	SHEET 1 OF 1
CRIMP INFORMATION			
SOLID MACHINED CONTACTS			
SINE Systems Corporation			
A Subsidiary of Amphenol Corporation			
44724 Moley Drive			
Clinton Township, MI 48036			
DWG NO: S2-15218			
CRIMP INFORMATION SOLID CONTACTS			
REV: A1			
DATE: 6/3/09			
BY: A1			
APP: A1			

REVOLUTIONS		DESCRIPTION	DATE	BY	APPR
REV	ZONE	ECO	6/12/08	B.D.B.	M.R.F.
AT	-	-	RELEASE NUMBER 016871		

SOLID CONTACT SIZE	SOLID CONTACT PART NUMBERS		WIRE SIZE AVG (mm ²)	RECOMMENDED STRIP LENGTH INCH (mm)	MIN CONTACT RETENTION LBS (N)	REF CRIMP TENSILE LBS (N)	MAX RATED AMPS @ 125°C CONTINUOUS
	PN	SOCKET					
16	AT60-202-16**	AT62-201-16**	16-20 [1.5-0.5]	0.25-0.31 [6.35-7.92]	25 [1111]	35-20 [156-89]	13

S&P CONTACT SIZE	STAMPED CONTACT PART NUMBERS		WIRE SIZE AVG (mm ²)	WIRE INSULATION O.D. RANGE	RECOMMENDED STRIP LENGTH INCH (mm)	MIN CONTACT RETENTION LBS (N)	REF CRIMP TENSILE LBS (N)	MAX RATED AMPS @ 125°C CONTINUOUS
	PN	SOCKET						
16	AT60-14-01**	AT62-14-01**	14-16 [2.0-1.0]	.100 - .150 [2.54 - 3.81]	0.150-0.200 [3.81-5.08]	25 [1111]	25 [1111]	13
16	AT60-16-01**	AT62-16-01**	16-18 [1.0-0.75]	.075 - .100 [1.90 - 2.54]	0.150-0.200 [3.81-5.08]	25 [1111]	25 [1111]	13
16	AT60-16-06**	AT62-16-06**	18-20 [0.75-0.50]	.055 - .095 [1.40 - 2.41]	0.150-0.200 [3.81-5.08]	25 [1111]	25-15 [111+67]	13

CONTACT RESISTANCE STRENGTH (LESS DROP THROUGH WIRE)			
WIRE AWG	TEST CURRENT	MILLIVOLT DROP SOLID	MILLIVOLT DROP S&P
14	18	60	100
16	13	60	100
18	10	60	100
20	7.5	60	100

MATERIAL SPECIFICATION AND PLATING ** CODES

PN: COPPER ALLOY
 SOCKET: COPPER ALLOY WITH STAINLESS STEEL SLEEVE

SOLID MACHINED CONTACT PLATING OPTIONS: **A**
 31= GOLD*
 141= NICKEL

STAMPED CONTACT PLATING OPTIONS: **A**
 22= NICKEL
 44= GOLD*
 89= SELECTIVE GOLD*

GOLD* PLATING IS AVAILABLE (RECOMMENDED) FOR ONLY (<5V) CIRCUIT APPLICATIONS
 MATERIALS AND PLATINGS ARE ROHS COMPLIANT

NOTES: UNLESS OTHERWISE SPECIFIED

- ALL DIMENSIONS ARE INCHES (MM).
 - ALL FORCES ARE IN LBS (POUNDS) AND "N" (NEWTONS).
 - CONTACT RETENTION TEST PULL RATE SHALL BE 1.0 INCH/25.4 PER MINUTE MAXIMUM. WIRE SIZE WILL AFFECT THE TRUE STRENGTH OF THE CRIMP.
 - WIRE SIZES AND INSULATION RANGES ARE FOR REFERENCE ONLY. THE ACTUAL INSULATION RANGE DEPENDS ON CONNECTOR GROMMET SEALING SIZE.
- SEE SPECIFICATIONS LISTED BELOW FOR INDIVIDUAL CRIMP INFORMATION:
- | | | | |
|------------------|----------|--------------------|-------|
| *SOLID* CONTACTS | SIZE | *STAMPED* CONTACTS | SIZE |
| | S2-15218 | S2-15222 | 16 |
| | | S2-15221 | 16/20 |
- MAXIMUM RATED CURRENT IN CHART DEPENDS ON CONTACT SIZE. ACTUAL RATED CURRENT DEPENDS ON WIRE SIZE.
 CONTACT FACTORY FOR ALL AVAILABLE PLATING ON SPECIFIC CONTACTS.
 AMPHENOL SINE PERFORMANCE SPECIFICATIONS REQUIRE THE USE OF AMPHENOL SINE APPROVED TOOLING.

QUANTITY	PART NUMBER	DESCRIPTION	ITEM
MATERIALS LIST			
UNLESS OTHERWISE SPECIFIED			
1) All dimensions are in inches.	SIGNATURES	DATE	
2) Pl. SEE 30.00	DATE	4/5/09	
3) Pl. SEE 30.00	ORDERED BY	6/3/09	
4) Pl. SEE 30.00	ENGINEER	BERNIM	
5) Fabrication Standards Per:	APPROVAL	BERNIM	6/3/09
6) Pl. SEE 30.00	CUSTOMER		
7) Pl. SEE 30.00	APPROVAL		
8) Pl. SEE 30.00	CUSTOMER		
9) Pl. SEE 30.00	APPROVAL		
10) Pl. SEE 30.00	CUSTOMER		
11) Pl. SEE 30.00	APPROVAL		
12) Pl. SEE 30.00	CUSTOMER		
13) Pl. SEE 30.00	APPROVAL		
14) Pl. SEE 30.00	CUSTOMER		
15) Pl. SEE 30.00	APPROVAL		
16) Pl. SEE 30.00	CUSTOMER		
17) Pl. SEE 30.00	APPROVAL		
18) Pl. SEE 30.00	CUSTOMER		
19) Pl. SEE 30.00	APPROVAL		
20) Pl. SEE 30.00	CUSTOMER		
21) Pl. SEE 30.00	APPROVAL		
22) Pl. SEE 30.00	CUSTOMER		
23) Pl. SEE 30.00	APPROVAL		
24) Pl. SEE 30.00	CUSTOMER		
25) Pl. SEE 30.00	APPROVAL		
26) Pl. SEE 30.00	CUSTOMER		
27) Pl. SEE 30.00	APPROVAL		
28) Pl. SEE 30.00	CUSTOMER		
29) Pl. SEE 30.00	APPROVAL		
30) Pl. SEE 30.00	CUSTOMER		
31) Pl. SEE 30.00	APPROVAL		
32) Pl. SEE 30.00	CUSTOMER		
33) Pl. SEE 30.00	APPROVAL		
34) Pl. SEE 30.00	CUSTOMER		
35) Pl. SEE 30.00	APPROVAL		
36) Pl. SEE 30.00	CUSTOMER		
37) Pl. SEE 30.00	APPROVAL		
38) Pl. SEE 30.00	CUSTOMER		
39) Pl. SEE 30.00	APPROVAL		
40) Pl. SEE 30.00	CUSTOMER		
41) Pl. SEE 30.00	APPROVAL		
42) Pl. SEE 30.00	CUSTOMER		
43) Pl. SEE 30.00	APPROVAL		
44) Pl. SEE 30.00	CUSTOMER		
45) Pl. SEE 30.00	APPROVAL		
46) Pl. SEE 30.00	CUSTOMER		
47) Pl. SEE 30.00	APPROVAL		
48) Pl. SEE 30.00	CUSTOMER		
49) Pl. SEE 30.00	APPROVAL		
50) Pl. SEE 30.00	CUSTOMER		
51) Pl. SEE 30.00	APPROVAL		
52) Pl. SEE 30.00	CUSTOMER		
53) Pl. SEE 30.00	APPROVAL		
54) Pl. SEE 30.00	CUSTOMER		
55) Pl. SEE 30.00	APPROVAL		
56) Pl. SEE 30.00	CUSTOMER		
57) Pl. SEE 30.00	APPROVAL		
58) Pl. SEE 30.00	CUSTOMER		
59) Pl. SEE 30.00	APPROVAL		
60) Pl. SEE 30.00	CUSTOMER		
61) Pl. SEE 30.00	APPROVAL		
62) Pl. SEE 30.00	CUSTOMER		
63) Pl. SEE 30.00	APPROVAL		
64) Pl. SEE 30.00	CUSTOMER		
65) Pl. SEE 30.00	APPROVAL		
66) Pl. SEE 30.00	CUSTOMER		
67) Pl. SEE 30.00	APPROVAL		
68) Pl. SEE 30.00	CUSTOMER		
69) Pl. SEE 30.00	APPROVAL		
70) Pl. SEE 30.00	CUSTOMER		
71) Pl. SEE 30.00	APPROVAL		
72) Pl. SEE 30.00	CUSTOMER		
73) Pl. SEE 30.00	APPROVAL		
74) Pl. SEE 30.00	CUSTOMER		
75) Pl. SEE 30.00	APPROVAL		
76) Pl. SEE 30.00	CUSTOMER		
77) Pl. SEE 30.00	APPROVAL		
78) Pl. SEE 30.00	CUSTOMER		
79) Pl. SEE 30.00	APPROVAL		
80) Pl. SEE 30.00	CUSTOMER		
81) Pl. SEE 30.00	APPROVAL		
82) Pl. SEE 30.00	CUSTOMER		
83) Pl. SEE 30.00	APPROVAL		
84) Pl. SEE 30.00	CUSTOMER		
85) Pl. SEE 30.00	APPROVAL		
86) Pl. SEE 30.00	CUSTOMER		
87) Pl. SEE 30.00	APPROVAL		
88) Pl. SEE 30.00	CUSTOMER		
89) Pl. SEE 30.00	APPROVAL		
90) Pl. SEE 30.00	CUSTOMER		
91) Pl. SEE 30.00	APPROVAL		
92) Pl. SEE 30.00	CUSTOMER		
93) Pl. SEE 30.00	APPROVAL		
94) Pl. SEE 30.00	CUSTOMER		
95) Pl. SEE 30.00	APPROVAL		
96) Pl. SEE 30.00	CUSTOMER		
97) Pl. SEE 30.00	APPROVAL		
98) Pl. SEE 30.00	CUSTOMER		
99) Pl. SEE 30.00	APPROVAL		
100) Pl. SEE 30.00	CUSTOMER		

Компания «Океан Электроники» предлагает заключение долгосрочных отношений при поставках импортных электронных компонентов на взаимовыгодных условиях!

Наши преимущества:

- Поставка оригинальных импортных электронных компонентов напрямую с производств Америки, Европы и Азии, а так же с крупнейших складов мира;
- Широкая линейка поставок активных и пассивных импортных электронных компонентов (более 30 млн. наименований);
- Поставка сложных, дефицитных, либо снятых с производства позиций;
- Оперативные сроки поставки под заказ (от 5 рабочих дней);
- Экспресс доставка в любую точку России;
- Помощь Конструкторского Отдела и консультации квалифицированных инженеров;
- Техническая поддержка проекта, помощь в подборе аналогов, поставка прототипов;
- Поставка электронных компонентов под контролем ВП;
- Система менеджмента качества сертифицирована по Международному стандарту ISO 9001;
- При необходимости вся продукция военного и аэрокосмического назначения проходит испытания и сертификацию в лаборатории (по согласованию с заказчиком);
- Поставка специализированных компонентов военного и аэрокосмического уровня качества (Xilinx, Altera, Analog Devices, Intersil, Interpoint, Microsemi, Actel, Aeroflex, Peregrine, VPT, Syfer, Eurofarad, Texas Instruments, MS Kennedy, Miteq, Cobham, E2V, MA-COM, Hittite, Mini-Circuits, General Dynamics и др.);

Компания «Океан Электроники» является официальным дистрибьютором и эксклюзивным представителем в России одного из крупнейших производителей разъемов военного и аэрокосмического назначения «JONHON», а так же официальным дистрибьютором и эксклюзивным представителем в России производителя высокотехнологичных и надежных решений для передачи СВЧ сигналов «FORSTAR».



JONHON

«JONHON» (основан в 1970 г.)

Разъемы специального, военного и аэрокосмического назначения:

(Применяются в военной, авиационной, аэрокосмической, морской, железнодорожной, горно- и нефтедобывающей отраслях промышленности)

«FORSTAR» (основан в 1998 г.)

ВЧ соединители, коаксиальные кабели, кабельные сборки и микроволновые компоненты:

(Применяются в телекоммуникациях гражданского и специального назначения, в средствах связи, РЛС, а так же военной, авиационной и аэрокосмической отраслях промышленности).



Телефон: 8 (812) 309-75-97 (многоканальный)

Факс: 8 (812) 320-03-32

Электронная почта: ocean@oceanchips.ru

Web: <http://oceanchips.ru/>

Адрес: 198099, г. Санкт-Петербург, ул. Калинина, д. 2, корп. 4, лит. А