

**Toggle Switches, A Series, Part Number Matrix**

**"A" SERIES DESIGN FEATURES**

- Toggle – Machined brass, heavy nickel plated.
- Bushing & Frame – Rigid one-piece die cast, copper flashed, heavy nickel plated.
- Fixed Contact – Welded construction.
- Terminal Seal – Epoxy sealing of terminals is standard.

**MATERIAL SPECIFICATIONS:**

Contacts .....Gold/gold flash  
   Silver/tin lead  
 Case Material .....Thermoset  
 Terminal Seal .....Epoxy

**TYPICAL PERFORMANCE CHARACTERISTICS:**

Contact Rating .....Silver: 2 A @ 250 VAC or 5 A @ 125 VAC  
   Silver: 2 A @ 30 VDC  
   Gold: 0.4 VA @ 20 VAC/DC max.  
 Insulation Resistance .....1,000 Megohms min. @ 500 VDC.  
 Dielectric Strength .....1,000 Volts RMS @ sea level initial  
 Electrical Life .....Up to 30,000 Cycles

**ENVIRONMENTAL SPECIFICATIONS**

Operating Temperature.....-4°F to + 185°F (-20°C to + 85°C)  
 Storage Temperature.....-49°F to + 212°F (-45°C to + 100°C)  
 Note: Hardware included with switch

**DESIGN**

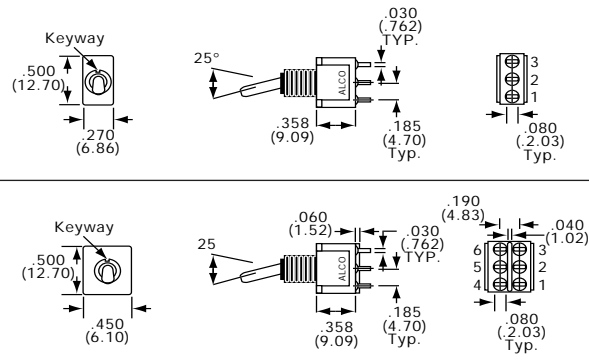
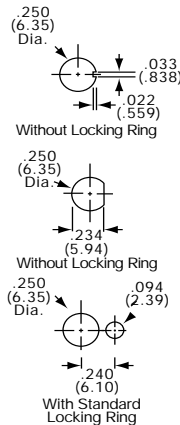
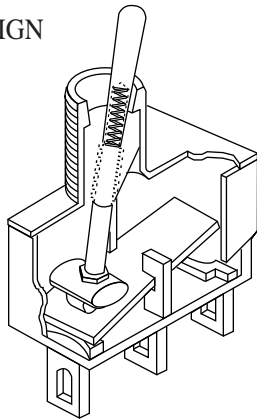

**PART NUMBERING**

Model	Function	Toggle	Bushing	Terminal	Contact	K, K1: Cap Color	Option																						
<b>A1</b> Single Pole	<table border="0"> <tr><td><b>S</b> Bat. Long</td></tr> <tr><td><b>K</b> Locking</td></tr> <tr><td><b>K1</b> Locking</td></tr> <tr><td><b>M</b> Bat. Short</td></tr> <tr><td><b>P3</b> Flatted (with <b>Y</b> only)</td></tr> <tr><td><b>P4</b> Flatted (with <b>Y</b> only)</td></tr> <tr><td><b>T</b> Large Toggle &amp; Bushing (15/32)</td></tr> <tr><td><b>T1</b> Large Toggle &amp; Bushing (15/32)</td></tr> <tr><td><b>T2P</b> Large Flatted Toggle and Bushing (15/32)</td></tr> </table>	<b>S</b> Bat. Long	<b>K</b> Locking	<b>K1</b> Locking	<b>M</b> Bat. Short	<b>P3</b> Flatted (with <b>Y</b> only)	<b>P4</b> Flatted (with <b>Y</b> only)	<b>T</b> Large Toggle & Bushing (15/32)	<b>T1</b> Large Toggle & Bushing (15/32)	<b>T2P</b> Large Flatted Toggle and Bushing (15/32)			<table border="0"> <tr><td><b>Z</b> Wire Lug</td></tr> <tr><td><b>A</b> Right Angle</td></tr> <tr><td><b>AV2</b> Vertical Right Angle</td></tr> <tr><td><b>C</b> Printed Circuit</td></tr> <tr><td><b>V30</b> <b>V40</b> <b>V90</b> Vertical Support</td></tr> <tr><td><b>W</b> Wire Wrap</td></tr> <tr><td><b>Z3</b> Quick Connect</td></tr> </table>	<b>Z</b> Wire Lug	<b>A</b> Right Angle	<b>AV2</b> Vertical Right Angle	<b>C</b> Printed Circuit	<b>V30</b> <b>V40</b> <b>V90</b> Vertical Support	<b>W</b> Wire Wrap	<b>Z3</b> Quick Connect	<table border="0"> <tr><td><b>Q</b> Silver</td></tr> <tr><td><b>B</b> Gold</td></tr> <tr><td><b>G</b> Gold over Silver</td></tr> </table>	<b>Q</b> Silver	<b>B</b> Gold	<b>G</b> Gold over Silver	<table border="0"> <tr><td>(Nickel Standard)</td></tr> <tr><td><b>0</b> Black</td></tr> <tr><td><b>2</b> Red</td></tr> </table>	(Nickel Standard)	<b>0</b> Black	<b>2</b> Red	<p>U.L.(Q or G contact only)</p> <p>Note: For surface mount termination, use the "TST" series, Page C7</p> <div style="border: 1px solid black; padding: 5px;"> <p><b>Other Options</b></p> <p><b>N</b> Black finish toggle, bushing and hardware. Add "N" to end of part number, but before U.L. option.</p> <p><b>O</b> Internal O-ring environmental actuator seal. Add letter after toggle option: S &amp; M.</p> <p><b>P</b> Anti-Push-In/Anti rotate. Add letter after toggle S &amp; M.</p> </div>
<b>S</b> Bat. Long																													
<b>K</b> Locking																													
<b>K1</b> Locking																													
<b>M</b> Bat. Short																													
<b>P3</b> Flatted (with <b>Y</b> only)																													
<b>P4</b> Flatted (with <b>Y</b> only)																													
<b>T</b> Large Toggle & Bushing (15/32)																													
<b>T1</b> Large Toggle & Bushing (15/32)																													
<b>T2P</b> Large Flatted Toggle and Bushing (15/32)																													
<b>Z</b> Wire Lug																													
<b>A</b> Right Angle																													
<b>AV2</b> Vertical Right Angle																													
<b>C</b> Printed Circuit																													
<b>V30</b> <b>V40</b> <b>V90</b> Vertical Support																													
<b>W</b> Wire Wrap																													
<b>Z3</b> Quick Connect																													
<b>Q</b> Silver																													
<b>B</b> Gold																													
<b>G</b> Gold over Silver																													
(Nickel Standard)																													
<b>0</b> Black																													
<b>2</b> Red																													
<b>A2</b> Double Pole																													
<b>01</b> On-On																													
<b>03</b> On-Off-On																													
<b>05</b> (On)-Off-(On)																													
<b>07</b> On-Off-(On)																													
<b>08</b> On-(On)																													
<b>11</b> On-On-On																													
<b>13</b> On-On-(On)																													
<b>15</b> (On)-On-(On)																													
	double pole case only																												
			<b>Y</b> 1/4-40 threaded, .35" long, slotted																										
			<b>Y9</b> unthreaded, .35" long																										
			<b>CW</b> 1/4-40 threaded, .37" long, actuator & bushing flange environmental seals S & M Toggles only																										
			<b>D</b> 1/4-40 threaded, .28" long, slotted																										
			<b>D9</b> Unthreaded, .28" long																										
			<b>H</b> 1/4-40 threaded, flanged, .30" long																										

See page C23 for SP3T wiring diagram.

**Toggle Switches, A Series, Options**

FUNCTIONS

The following functions available in SP or DP.



<p><b>TOGGLES</b></p> <p><b>S</b> Standard</p>		<p><b>M</b> Short</p>		<p><b>P3</b> <b>P4</b></p>		<p><b>T2P</b> Flatted</p>	
<b>Dimension "L"</b>	<b>Bushing</b>	<b>Dimension "L"</b>	<b>Bushing Type</b>	<b>Actuator</b>	<b>Dimension "B"</b>		
.410 (10.41)	"Y", "H", "CW"	.200 (5.08)	"Y", "H", "CW"	P3	.450 (11.43)	.200 (5.08)	
.480 (12.19)	"D", "D9"	.270 (6.86)	"D", "D9"	P4	.250 (6.35)	.165 (4.19)	
<p><b>T</b> Large Toggle/ Bushing</p>		<p><b>T1</b> Large Toggle/ Bushing</p>		<p><b>K</b> Locking</p>		<p><b>K1</b> Locking</p>	
<p>No bushing option needed for "T" or T1".</p>				<p>No bushing option needed for "K" or K1" "K" locking levers are used to prevent accidental switching and must be lifted up prior to actuation. Standard nickel finish.</p>			

**Toggle Switches, A Series, Options**

**BUSHINGS**

**Y**

1/4-40 Thread  
.35" long, slotted  
(Standard)

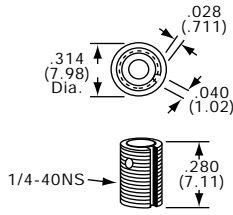

**D9**

Unthreaded  
.28" long

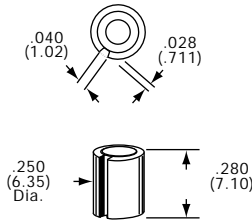

Used with  
**Z, C & W**  
terminations

**H**

1/4-40 Thread  
Flanged, .30" long

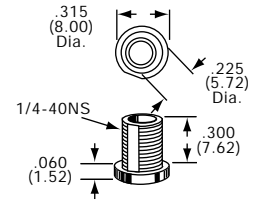

**D**

1/4-40 Thread  
.28" long, slotted

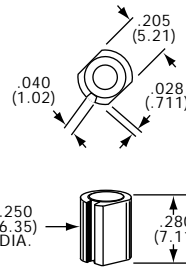
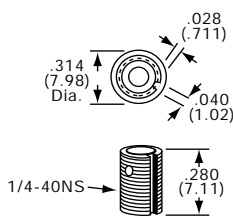

Used with  
**A, AV2, V30**  
**V80 & V90**  
terminations

**CW**

Threaded  
Splashproof

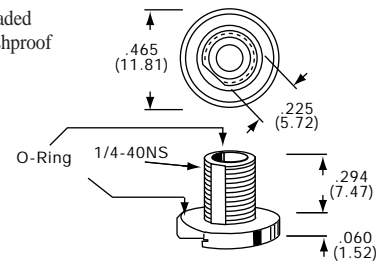

For S & M Toggles

**TERMINALS**

**Z**

Wire Lug

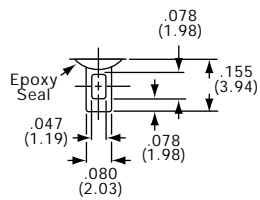

**Z3**

Quick Connect

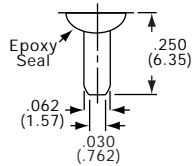

Mates with Tyco  
61454 or 60900.

**W**

Wire Wrap

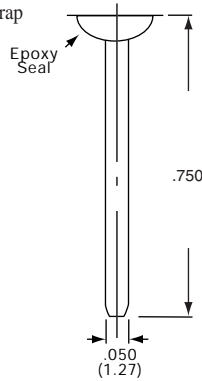

**C**

Printed Circuit

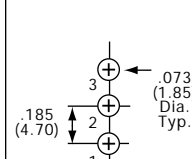
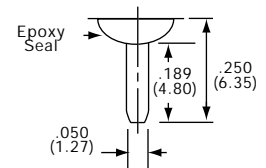

Single pole

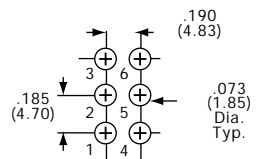

Double pole

Gemini Series

**Toggle Switches, A Series, Options**

TERMINALS



**Right Angle**  
Single Pole



Gemini Series

Note: Terminal numbers viewed from top of P.C. boards.

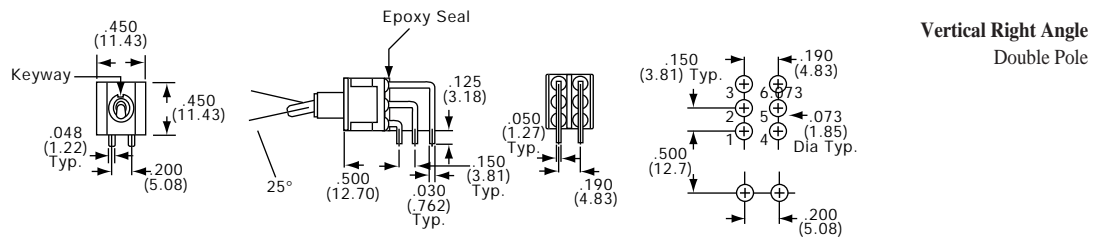

Note: Terminal numbers viewed from top of P.C. boards.



**Toggle Switches, A Series, Vertical, Wire Lug, Long Bat Actuator**

SPDT

Tyco Electronics	Alcoswitch	Type	Act. Code P.M5			
<b>Silver Contacts</b>						
5-1437554-0	A101SYZQ	SPDT	1	On	None	On
7-1437554-7	A103SYZQ	SPDT	5	On	Off	On
9-1437554-6	A105SYZQ	SPDT	5	(On)	Off	(On)
1437555-9	A107SYZQ	SPDT	5	On	Off	(On)
2-1437555-0	A108SYZQ	SPDT	1	On	None	(On)
<b>Gold Contacts</b>						
4-1437554-9	A101SYZB	SPDT	1	On	None	On
7-1437554-6	A103SYZB	SPDT	5	On	Off	On
9-1437554-5	A105SYZB	SPDT	5	(On)	Off	(On)
	A107SYZB	SPDT	5	On	Off	(On)

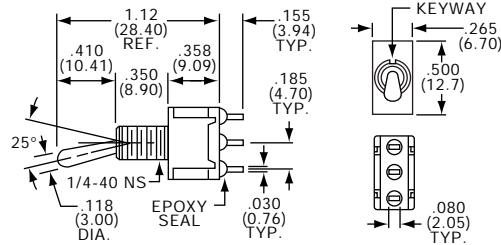

A101SYZQ

**Gemini Series**

DPDT

Tyco Electronics	Alcoswitch	Type	Act. Code P.M5			
<b>Silver Contacts</b>						
4-1437555-9	A201SYZQ	DPDT	2	On	None	On
6-1437555-2	A203SYZQ	DPDT	6	On	Off	On
7-1437555-0	A205SYZQ	DPDT	6	(On)	Off	(On)
7-1437555-6	A207SYZQ	DPDT	6	On	Off	(On)
8-1437555-5	A208SYZQ	DPDT	2	On	None	(On)
1437556-1	A211SYZQ	SP3T	11	On	On	On
1437556-4	A213SYZQ	SP3T	11	On	On	(On)
1437556-7	A215SYZQ	SP3T	11	(On)	On	(On)

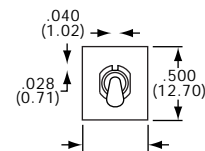
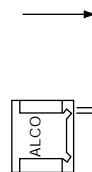

A201SYZQ

**Toggle Switches, A Series, PC Terminals, Long Bat Actuators**

\* Refer to Pages C22-C26 for Additional Options \*

SEE PAGE C22 FOR PRODUCT SPECIFICATIONS

SPDT/DPDT



A101SYAB  
Horizontal Actuation

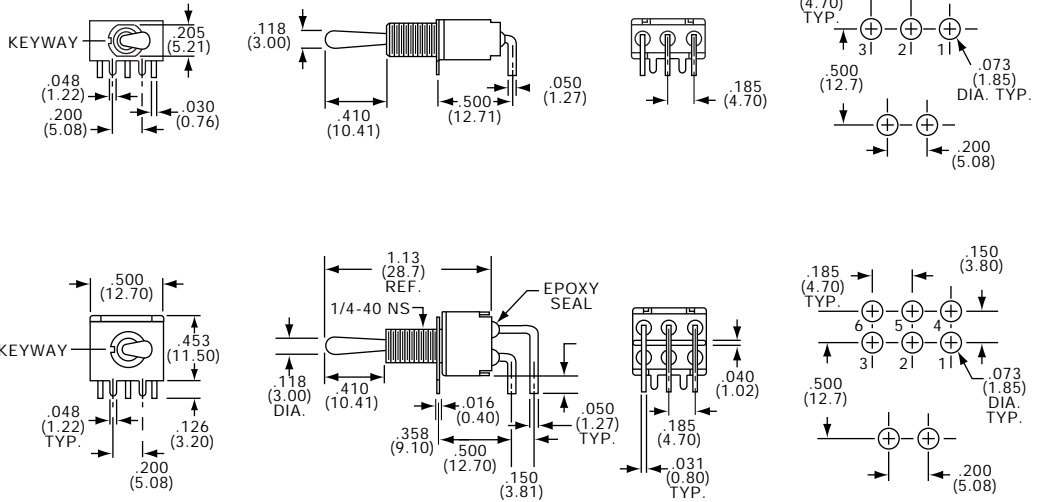

Tyco Electronics	Alcoswitch	Type	Act. Code	P.M5	↘	↓	↙
<b>Gold Contacts</b>							
4-1437554-3	A101SYAB	SPDT	1		On	None	On
	A103SYAB	SPDT	5		On	Off	On
4-1437555-3	A201SYAB	DPDT	2		On	None	On
	A208SYAB	DPDT	2		On	None	(On)

SPDT/DPDT



A101SYCB



A201SYCB

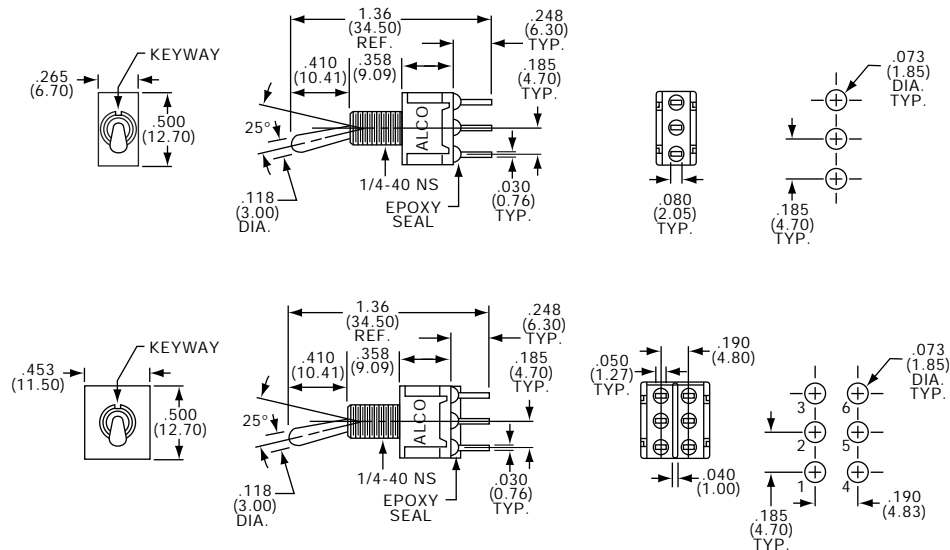

Tyco Electronics	Alcoswitch	Type	Act. Code	P.M5	↘	↓	↙
<b>Gold Contacts</b>							
4-1437554-5	A101SYCB	SPDT	1		On	None	On
7-1437554-2	A103SYCB	SPDT	5		On	Off	On
1-1437555-8	A108SYCB	SPDT	1		On	None	(On)
4-1437555-5	A201SYCB	DPDT	2		On	None	On
6-1437555-0	A203SYCB	DPDT	6		On	Off	On
8-1437555-3	A208SYCB	DPDT	2		On	None	(On)

**Toggle Switches, A Series, Wire Wrap or Wire Lug, Long Bat Actuators**

\* Refer to Pages C22-C26 for Additional Options \*

SEE PAGE C22 FOR PRODUCT SPECIFICATIONS

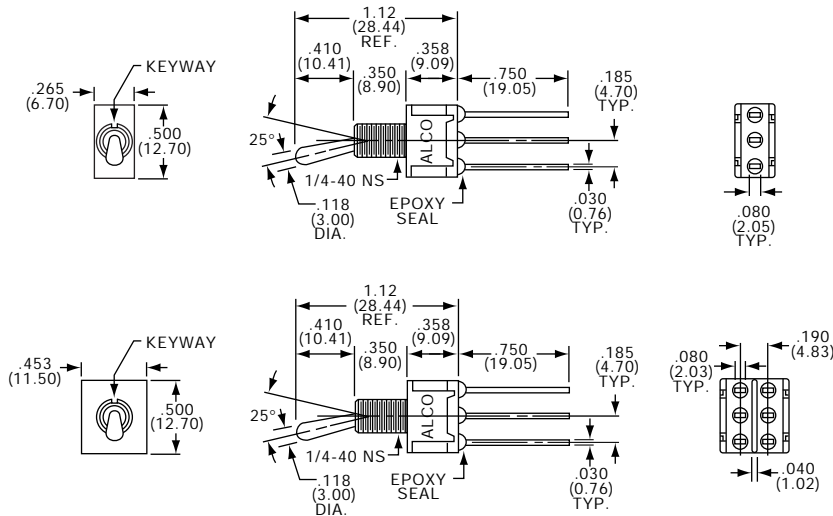

SPDT/DPDT



A101SYWQ

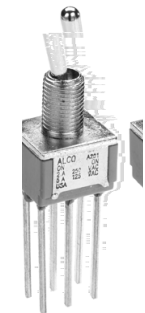

A201SYWQ

Tyco Electronics	Alcoswitch	Type	Act. Code	P.M5			
<b>Silver Contacts</b>							
4-1437554-8	A101SYWQ	SPDT	1	On	None	On	
7-1437554-5	A103SYWQ	SPDT	5	On	Off	On	
4-1437555-7	A201SYWQ	DPDT	2	On	None	On	
	A203SYWQ	DPDT	6	On	Off	On	

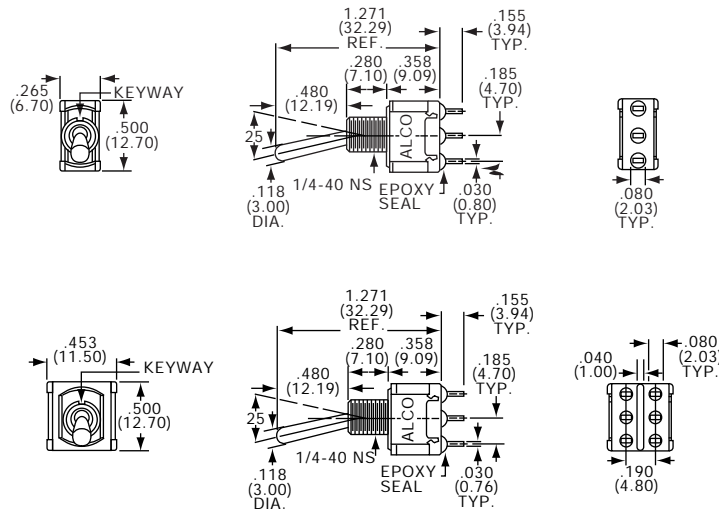

SPDT/DPDT



A101SDZQ



A201SDZQ

Tyco Electronics	Alcoswitch	Type	Act. Code	P.M5			
<b>Silver Contacts</b>							
4-1437554-0	A101SDZQ	SPDT	1	On	None	On	
6-1437554-9	A103SDZQ	SPDT	5	On	Off	On	
4-1437555-1	A201SDZQ	DPDT	2	On	None	On	
5-1437555-9	A203SDZQ	DPDT	6	On	Off	On	



**Toggle Switches, A Series, PC Tail, Straight or Right Angle, Long Bat Actuator**

\* Refer to Pages C22-C26 for Additional Options \*

SEE PAGE C22 FOR PRODUCT SPECIFICATIONS

SPDT



A101SDCQ

DPDT



A201SDCQ

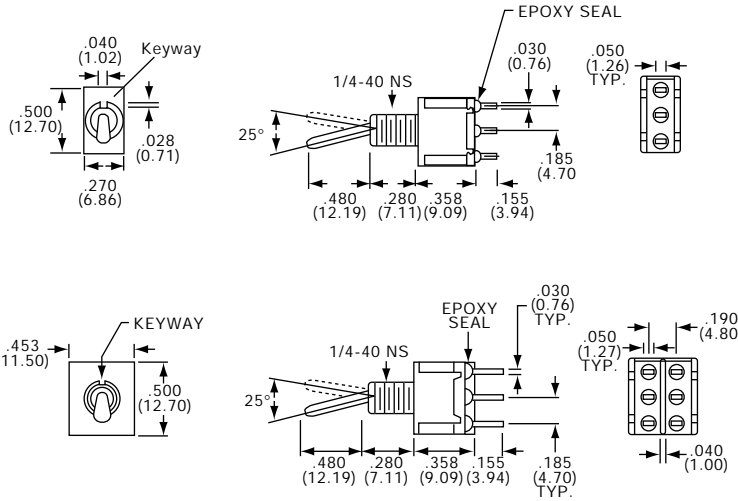

Tyco Electronics	Alcoswitch	Type	Act. Code	P.M5	↖	↓	↗
<b>Silver Contacts</b>							
3-1437554-9	A101SDCQ	SPDT	1		On	None	On
6-1437554-8	A103SDCQ	SPDT	5		On	Off	On
1571670-1	A201SDCQ	DPDT	2		On	None	On
	A203SDCQ	DPDT	6		On	Off	On
	A208SDCQ	DPDT	2		On	None	(On)

SPDT/DPDT

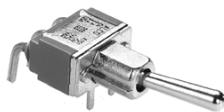

A101SD9AQ

Horizontal Actuation

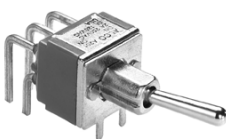
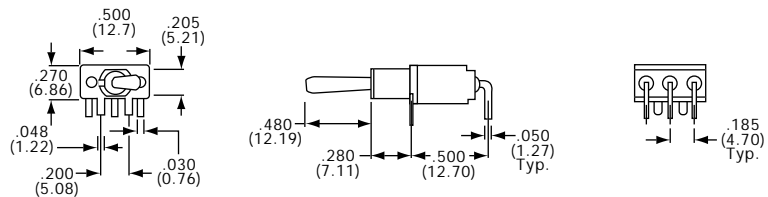

A201SD9AQ

Horizontal Actuation

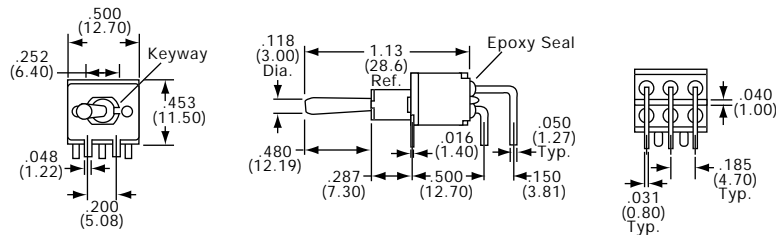

Tyco Electronics	Alcoswitch	Tyco Electronics	Alcoswitch	Type	Act. Code	P. M5	↖	↓	↗	
<b>Silver Contacts</b>										
3-1437554-4	A101SD9AQ	<b>Gold Contacts</b>		3-1437554-3	A101SD9AB	SPDT	1	On	None	On
6-1437554-4	A103SD9AQ		A103SD9AB	SPDT	5		On	Off	On	
1-1437555-6	A108SD9AQ		A108SD9AB	SPDT	1		On	None	(On)	
3-1437555-8	A201SD9AQ		A201SD9AB	DPDT	2		On	None	On	
8-1437555-1	A208SD9AQ		A208SD9AB	DPDT	2		On	None	(On)	

**Toggle Switches, A Series, Vertical, Right Angle, Long Bat Actuator**

\* Refer to Pages C22-C26 for Additional Options \*

SEE PAGE C22 FOR PRODUCT SPECIFICATIONS

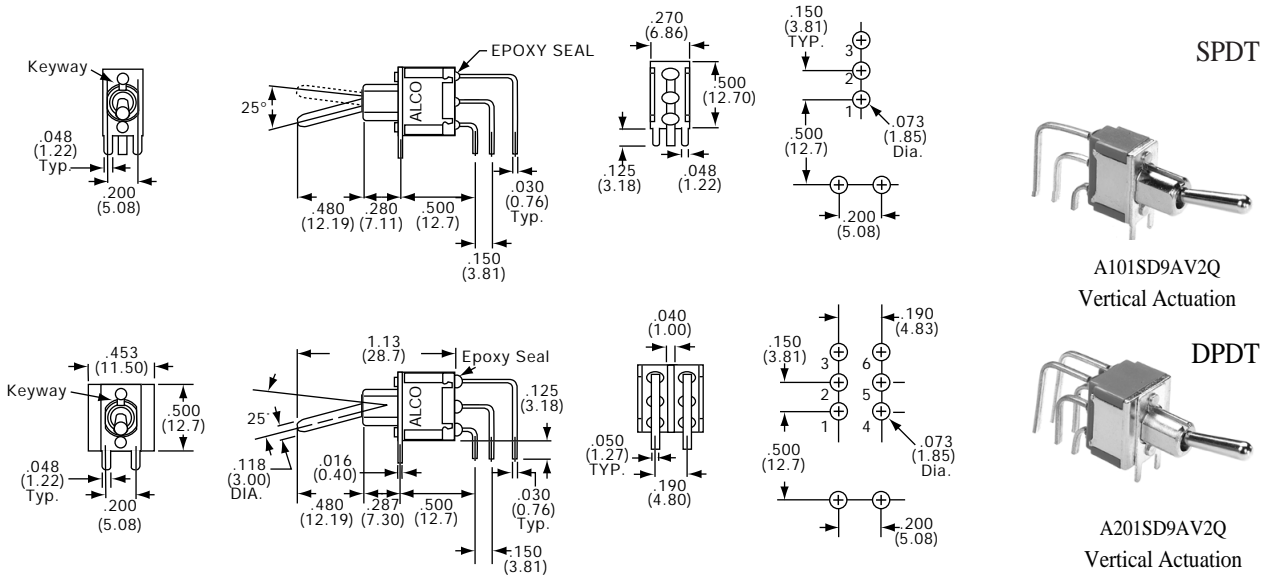

Tyco Electronics	Alcoswitch	Type	Act. Code	P.M5				Tyco Electronics	Alcoswitch	Type	Act. Code	P.M5			
<b>Silver Contacts</b>															
3-1437554-6	A101SD9AV2Q	SPDT	1		On	None	On	3-1437555-9	A201SD9AV2Q	DPDT	2		On	None	On
6-1437554-6	A103SD9AV2Q	SPDT	5		On	Off	On	5-1437555-8	A203SD9AV2Q	DPDT	6		On	Off	On
								8-1437555-2	A208SD9AV2Q	DPDT	2		On	None	(On)

**Toggle Switches, A Series, Wire Lug, Locking Toggle**

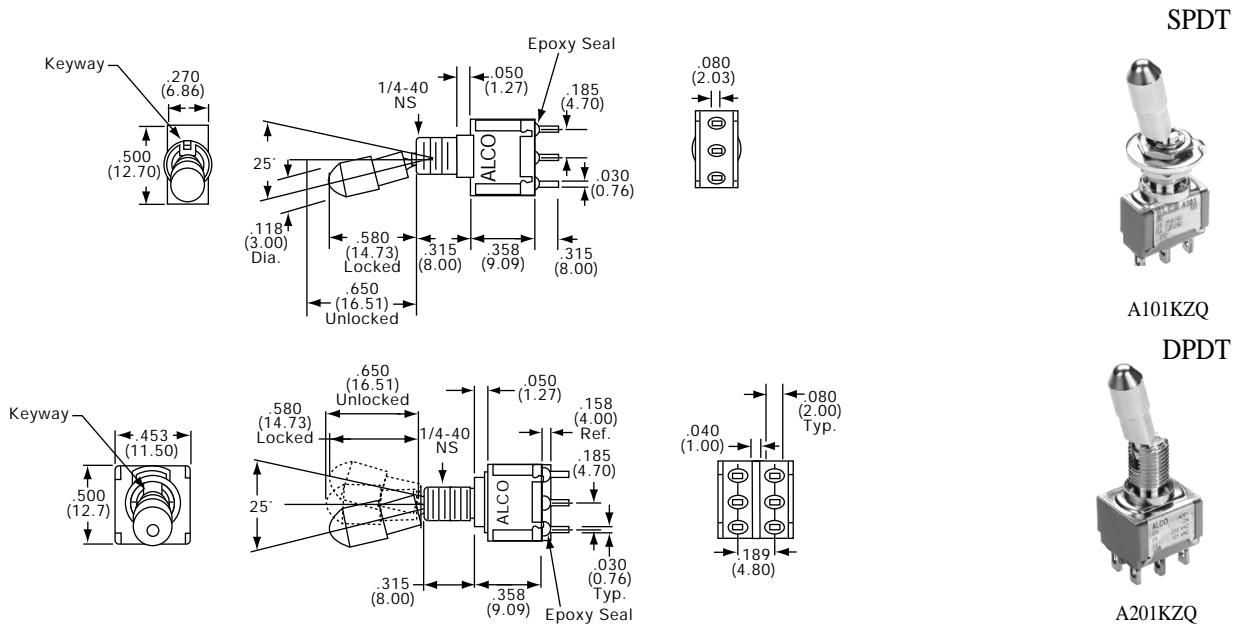

Tyco Electronics	Alcoswitch	Type	Act. Code	P.M5				Tyco Electronics	Alcoswitch	Tyco Electronics	Alcoswitch	Type	Act. Code	P.M5				
<b>Silver Contacts</b>																		
1437554-9	A101KZQ	SPDT	1		On	None	On	<b>Gold Contacts</b>		<b>Silver Contacts</b>		2-1437555-5	A201KZQ	DPDT	2	On	None	On
5-1437554-8	A103KZQ	SPDT	5		On	Off	On	A203KZB	A203KZB	5-1437555-3	A203KZQ	DPDT	6		On	Off	On	
								6-1437555-5	A205KZB		A205KZQ	DPDT	6		(On)	Off	(On)	
								8-1437555-8	A211KZB		A211KZQ	SP3T	11		On	On	On	

\* Refer to Pages C22-C26 for Additional Options \*

**Toggle Switches, A Series, Right Angle, Short Bat Actuators**

SEE PAGE C22 FOR PRODUCT SPECIFICATIONS

**SPDT**



**A101MD9AQ**  
Horizontal Actuation

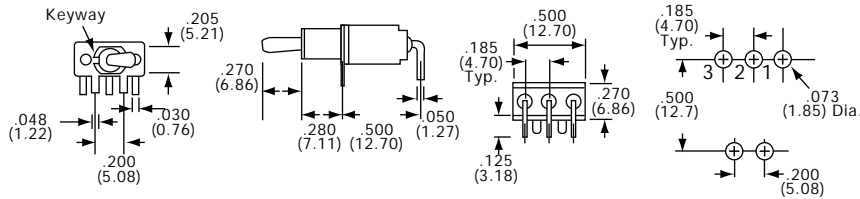

Tyco Electronics	Alcoswitch	Tyco Electronics	Alcoswitch	Type	Act. Code	P. M5	↖	↓	↗
<b>Silver Contacts</b>		<b>Gold Contacts</b>							
1-1437554-6	A101MD9AQ	1-1437554-4	A101MD9AB	SPDT	1		On	None	On
6-1437554-1	A103MD9AQ	5-1437554-9	A103MD9AB	SPDT	5		On	Off	On
	A108MD9AQ	1-1437555-2	A108MD9AB	SPDT	1		On	None	(On)

**DPDT**



**A201MD9AQ**  
Horizontal Actuation

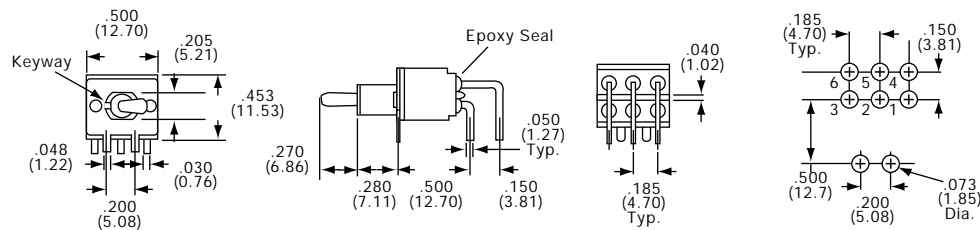

Tyco Electronics	Alcoswitch	Tyco Electronics	Alcoswitch	Type	Act. Code	P. M5	↖	↓	↗
<b>Silver Contacts</b>		<b>Gold Contacts</b>							
2-1437555-8	A201MD9AQ	2-1437555-7	A201MD9AB	DPDT	2		On	None	On
		5-1437555-4	A203MD9AB	DPDT	6		On	Off	On

**SPDT**



**A101MD9AV2Q**  
Vertical Actuation

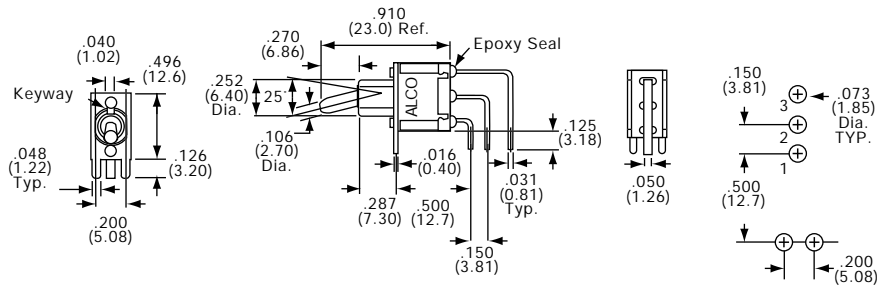

Tyco Electronics	Alcoswitch	Tyco Electronics	Alcoswitch	Type	Act. Code	P. M5	↖	↓	↗
<b>Silver Contacts</b>		<b>Gold Contacts</b>							
1-1437554-9	A101MD9AV2Q	1-1437554-7	A101MD9AV2B	SPDT	1		On	None	On
	A103MD9AV2Q	6-1437554-2	A103MD9AV2B	SPDT	5		On	Off	On
	A108MD9AV2Q			SPDT	1		On	None	(On)

**DPDT**

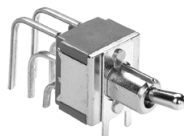

**A201MD9AV2AQ**  
Vertical Actuation

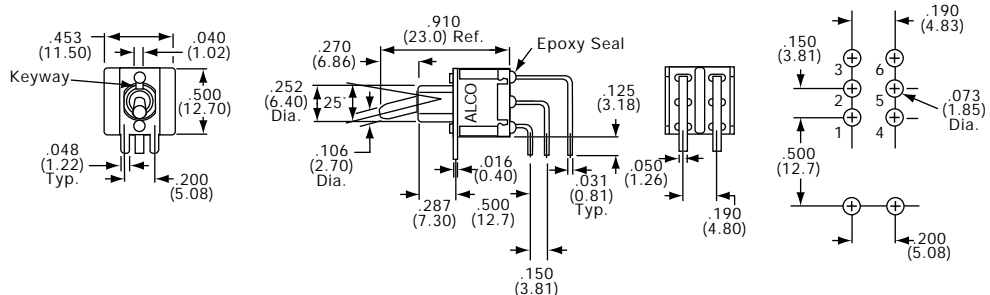

Tyco Electronics	Alcoswitch	Tyco Electronics	Alcoswitch	Type	Act. Code	P. M5	↖	↓	↗
<b>Silver Contacts</b>		<b>Gold Contacts</b>							
3-1437555-0	A201MD9AV2Q	2-1437555-9	A201MD9AV2B	DPDT	2		On	None	On
	A203MD9AV2Q		A203MD9AV2B	DPDT	6		On	Off	On
	A208MD9AV2Q		A208MD9AV2B	DPDT	2		On	None	(On)

**Toggle Switches, A Series, Vertical, Wire Lug, Flat or Long Bat Actuator**

SEE PAGE C22 FOR PRODUCT SPECIFICATIONS

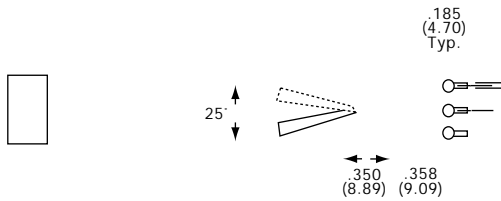

SPDT



A101P3YZQ

Tyco Electronics	Alcoswitch	Type	Act. Code	P.M5
<b>Silver Contacts</b>				
2-1437554-9	A101P3YZQ	SPDT	1	On None On
6-1437554-3	A103P3YZQ	SPDT	5	On Off On
8-1437554-7	A105P3YZQ	SPDT	5	(On) Off (On)
1437555-5	A107P3YZQ	SPDT	5	On Off (On)
1-1437555-5	A108P3YZQ	SPDT	1	On None (On)

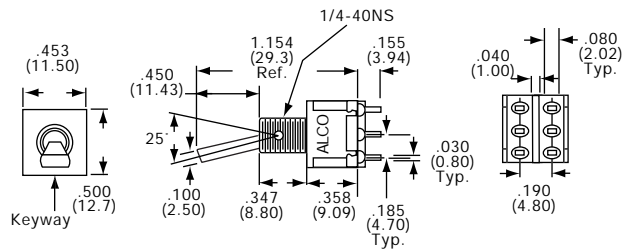

DPDT



A201P3YZQ

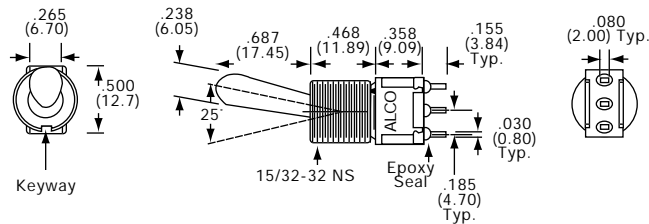

SPDT



A101TZQ

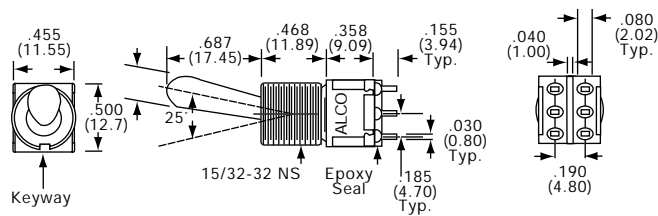

DPDT



A201TZQ

**C**  
Gemini Series

**Toggle Switches, A Series, Wire Lug, 15/32 Bushing, Short Bat Actuator**

\* Refer to Pages C22-C26 for Additional Options \*

SEE PAGE C22 FOR PRODUCT SPECIFICATIONS

SPDT



A103T1ZQ

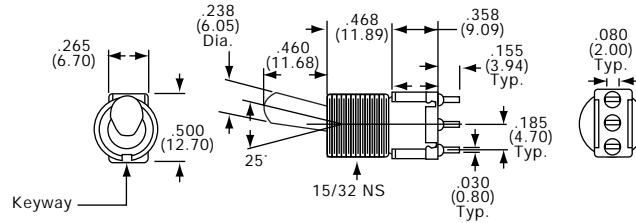

Tyco Electronics	Alcoswitch	Type	Act. Code	P.M5	↘	↓	↙
<b>Silver Contacts</b>							
5-1437554-4	A101T1ZQ	SPDT	1		On	None	On
7-1437554-9	A103T1ZQ	SPDT	5		On	Off	On
9-1437554-8	A105T1ZQ	SPDT	5		(On)	Off	(On)
	A108T1ZQ	SPDT	1		On	None	(On)

DPDT



A201T1ZQ

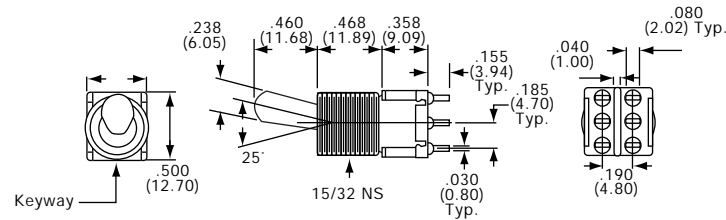

Tyco Electronics	Alcoswitch	Type	Act. Code	P.M5	↘	↓	↙
<b>Silver Contacts</b>							
5-1437555-0	A201T1ZQ	DPDT	2		On	None	On
6-1437555-3	A203T1ZQ	DPDT	6		On	Off	On
7-1437555-1	A205T1ZQ	DPDT	6		(On)	Off	(On)
7-1437555-7	A207T1ZQ	DPDT	6		On	Off	(On)
8-1437555-6	A208T1ZQ	DPDT	2		On	None	(On)
1437556-2	A211T1ZQ	SP3T	11		On	On	On

Компания «Океан Электроники» предлагает заключение долгосрочных отношений при поставках импортных электронных компонентов на взаимовыгодных условиях!

Наши преимущества:

- Поставка оригинальных импортных электронных компонентов напрямую с производств Америки, Европы и Азии, а так же с крупнейших складов мира;
- Широкая линейка поставок активных и пассивных импортных электронных компонентов (более 30 млн. наименований);
- Поставка сложных, дефицитных, либо снятых с производства позиций;
- Оперативные сроки поставки под заказ (от 5 рабочих дней);
- Экспресс доставка в любую точку России;
- Помощь Конструкторского Отдела и консультации квалифицированных инженеров;
- Техническая поддержка проекта, помощь в подборе аналогов, поставка прототипов;
- Поставка электронных компонентов под контролем ВП;
- Система менеджмента качества сертифицирована по Международному стандарту ISO 9001;
- При необходимости вся продукция военного и аэрокосмического назначения проходит испытания и сертификацию в лаборатории (по согласованию с заказчиком);
- Поставка специализированных компонентов военного и аэрокосмического уровня качества (Xilinx, Altera, Analog Devices, Intersil, Interpoint, Microsemi, Actel, Aeroflex, Peregrine, VPT, Syfer, Eurofarad, Texas Instruments, MS Kennedy, Miteq, Cobham, E2V, MA-COM, Hittite, Mini-Circuits, General Dynamics и др.);

Компания «Океан Электроники» является официальным дистрибьютором и эксклюзивным представителем в России одного из крупнейших производителей разъемов военного и аэрокосмического назначения «JONHON», а так же официальным дистрибьютором и эксклюзивным представителем в России производителя высокотехнологичных и надежных решений для передачи СВЧ сигналов «FORSTAR».



## JONHON

«JONHON» (основан в 1970 г.)

Разъемы специального, военного и аэрокосмического назначения:

(Применяются в военной, авиационной, аэрокосмической, морской, железнодорожной, горно- и нефтедобывающей отраслях промышленности)

«FORSTAR» (основан в 1998 г.)

ВЧ соединители, коаксиальные кабели,  
кабельные сборки и микроволновые компоненты:

(Применяются в телекоммуникациях гражданского и специального назначения, в средствах связи, РЛС, а так же военной, авиационной и аэрокосмической отраслях промышленности).



Телефон: 8 (812) 309-75-97 (многоканальный)

Факс: 8 (812) 320-03-32

Электронная почта: [ocean@oceanchips.ru](mailto:ocean@oceanchips.ru)

Web: <http://oceanchips.ru/>

Адрес: 198099, г. Санкт-Петербург, ул. Калинина, д. 2, корп. 4, лит. А