

| REVISIONS | | | | | |
|-----------|-----|---------------------------|-----------|-----|------|
| # | LY# | DESCRIPTION | DATE | OWN | APVD |
| F34 | | REVISED PER ECO-17-007768 | 30MAY2017 | DLD | DCM |
| F35 | | REVISED PER ECO-17-014872 | 24OCT2017 | JMS | CM |
| F36 | | REVISED PER ECO-18-005691 | 16APR2018 | JMS | CM |
| F37 | | ECO-18-013134 | 13SEP2018 | KP | CM |

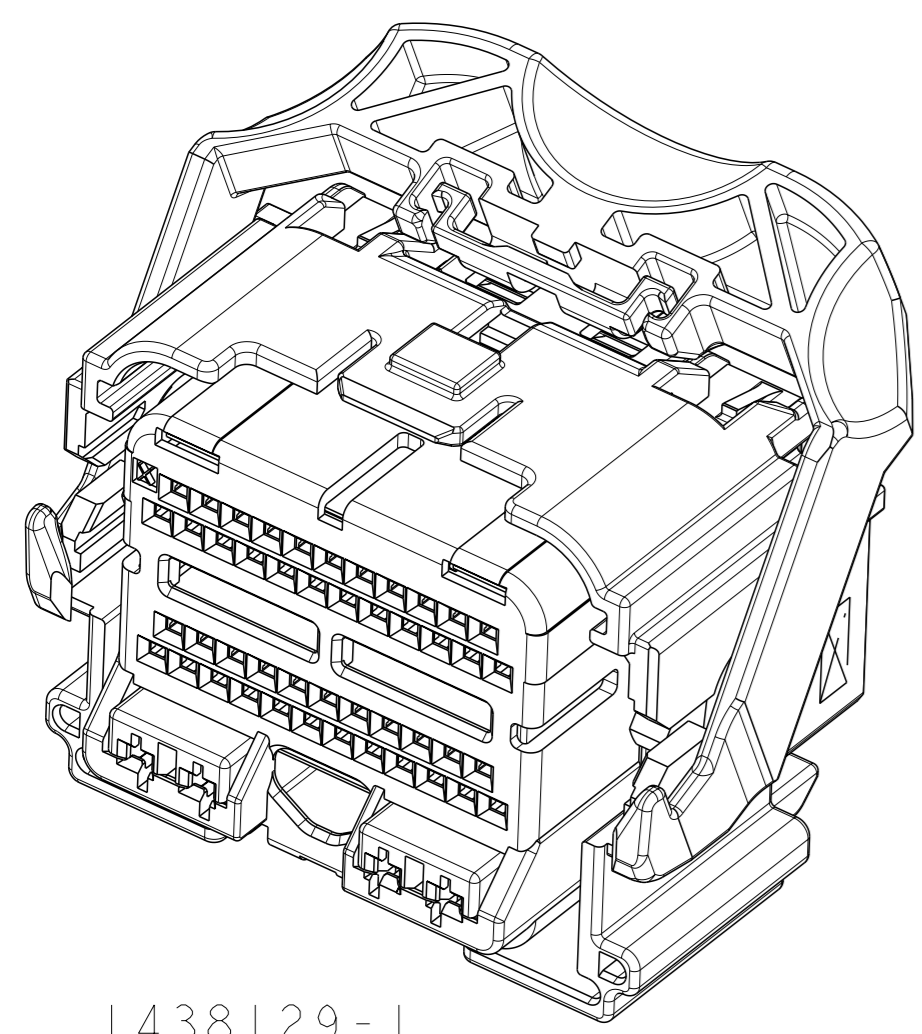

1438129-1
 SHOWN WITH SPACER
 IN SEATED POSITION

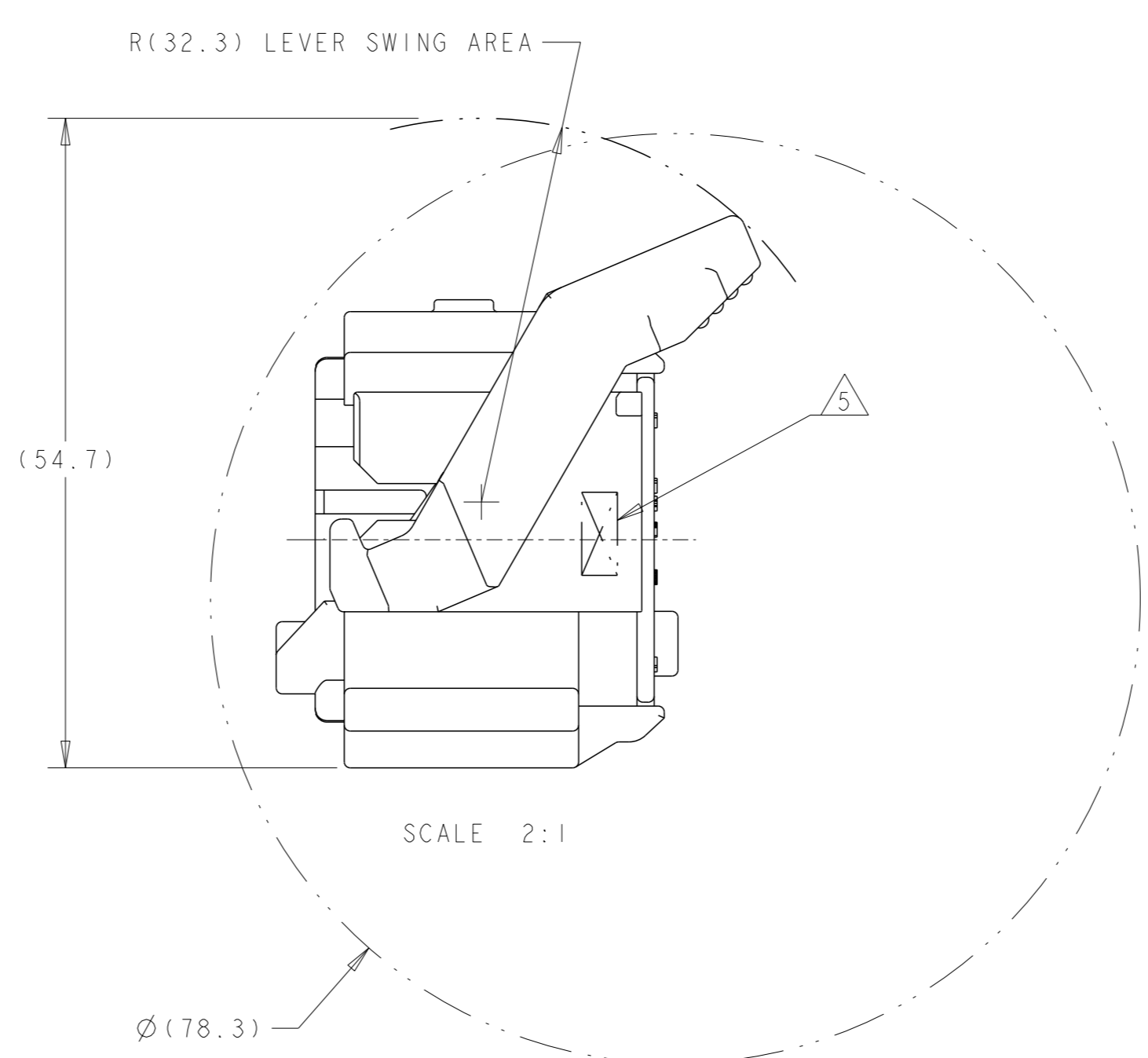
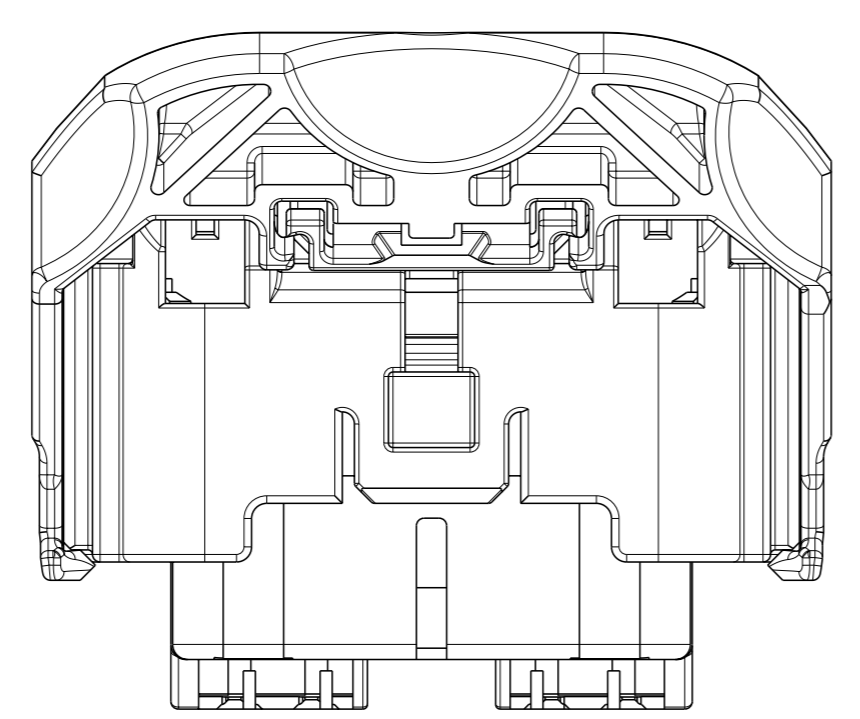

- 1. PRINT PART NUMBER (5S4T-14A464-L*-***, 5S4T-14A464-M*-***, 5S4T-14A464-N*-***) AND TRACEABILITY (YY : 2 DIGIT YEAR, JJJ = JULIAN DATE, HH = 2 DIGIT MILITARY HOUR CODE IN THE LOCATION AT ASSEMBLY. SEE SHEET 3 THRU 7 (-*) PART NUMBERS.
- 2. APPLICABLE MOLEX (1.5) POWER TERMINAL PART NUMBERS:
 33012-0002 TIN 0.50-1.50mm²
- 3. CAM LEVER AND SPACER ARE SHIPPED IN THEIR PRE-ASSEMBLED POSITIONS.
- 4. REFERENCE TE CONNECTIVITY INSTRUCTION SHEET 408-8893.
- 5. COMPANY LOGO.

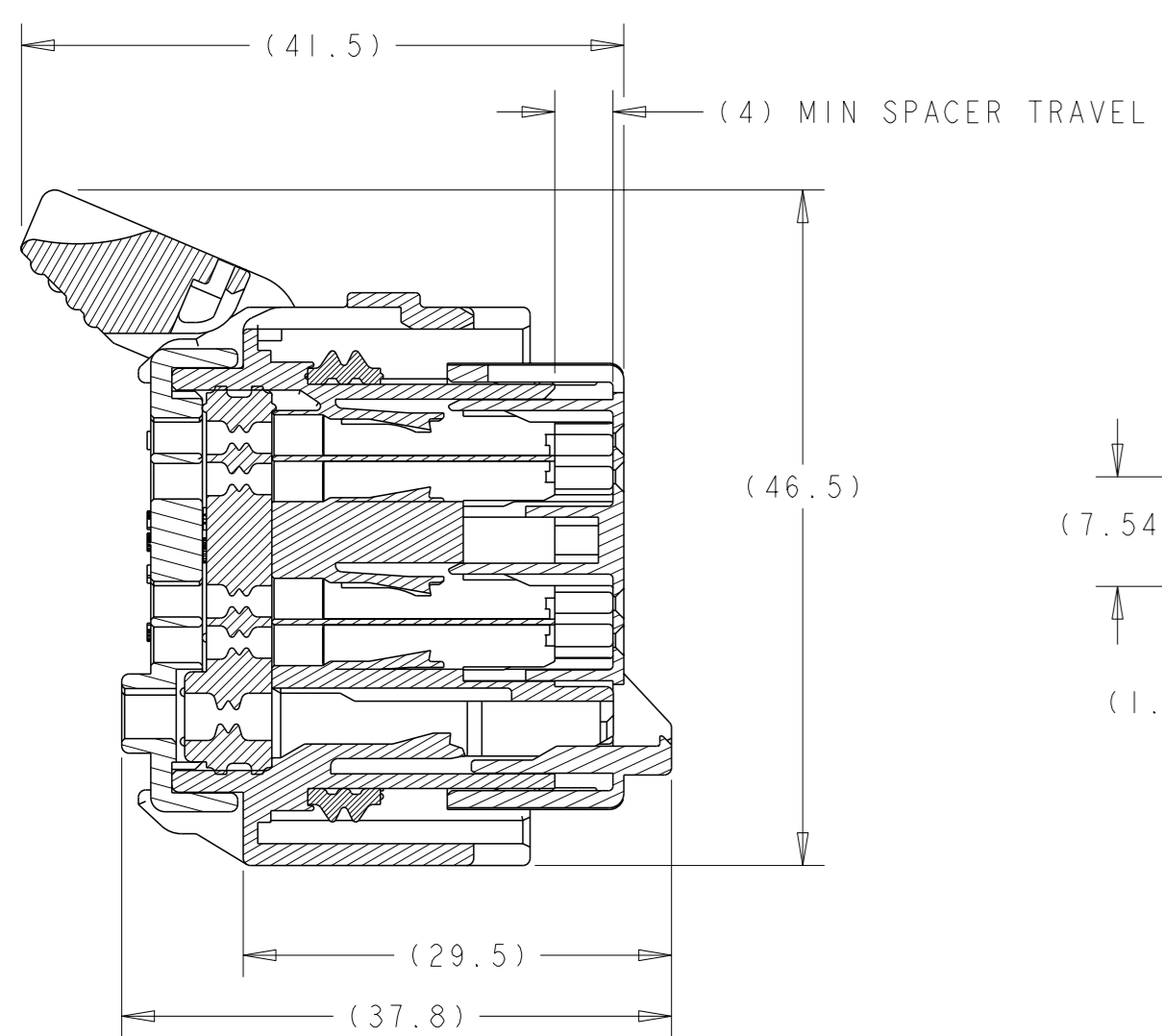

SECTION A-A
 SPACER AND LEVER IN
 PRE-SEATED POSITION
 (DELIVERY CONDITION)

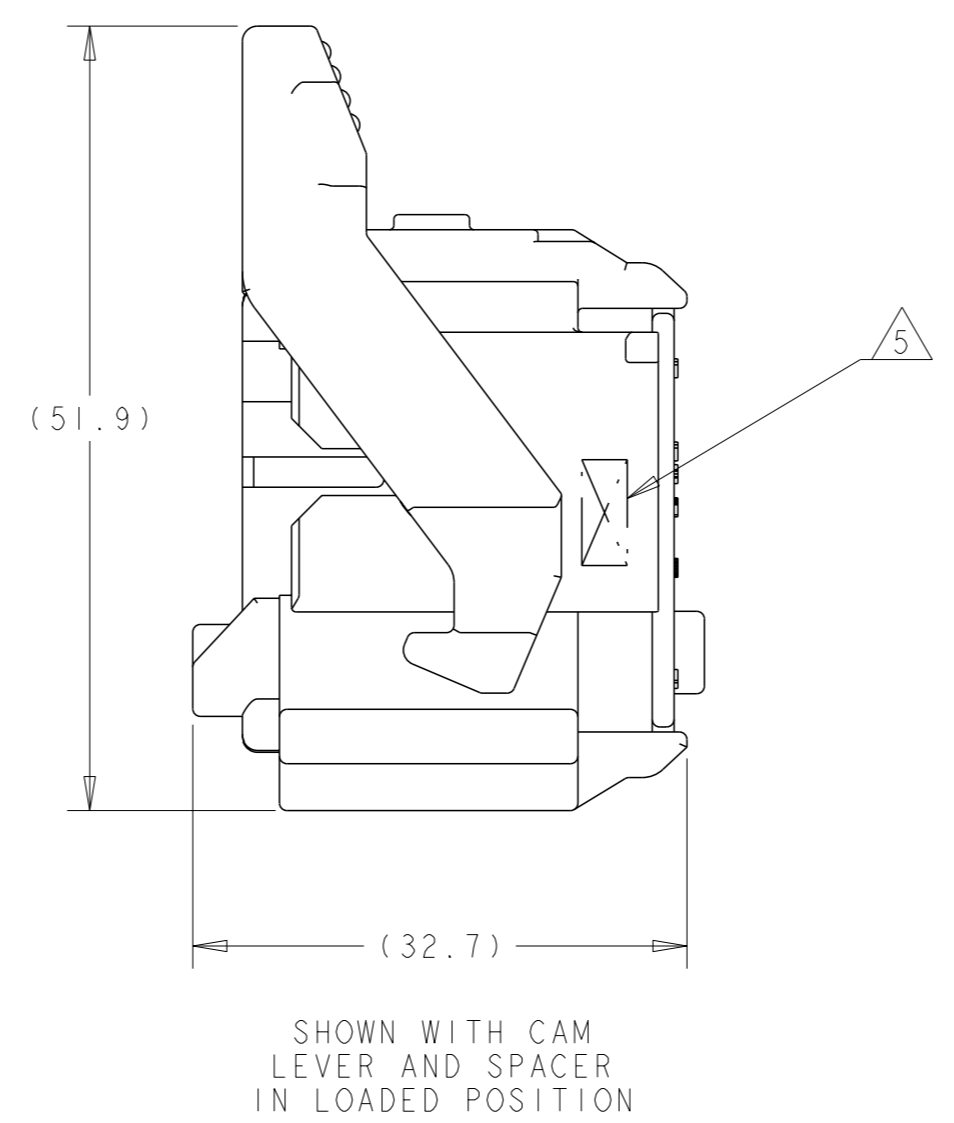
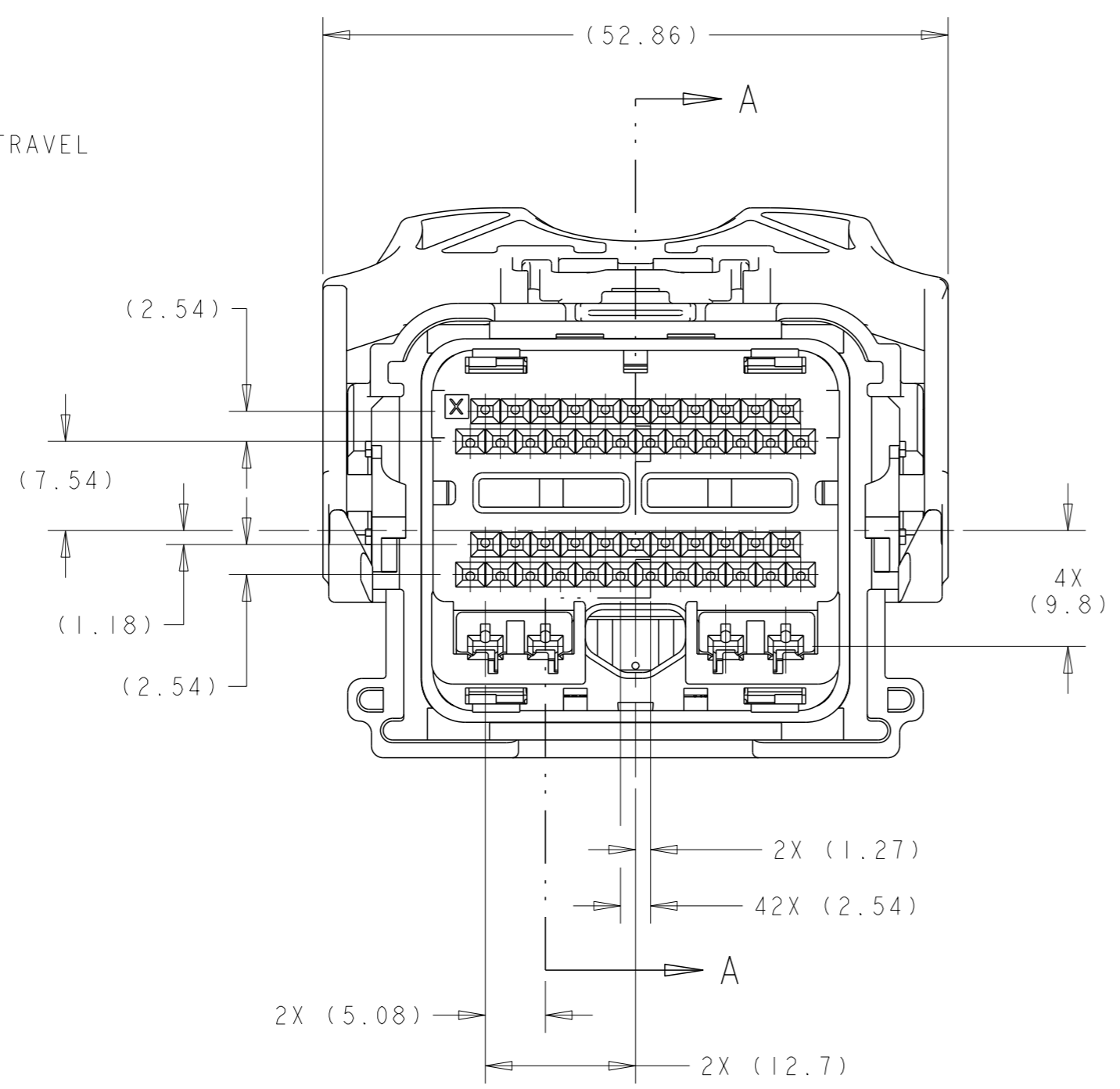

SHOWN WITH CAM
 LEVER AND SPACER
 IN LOADED POSITION

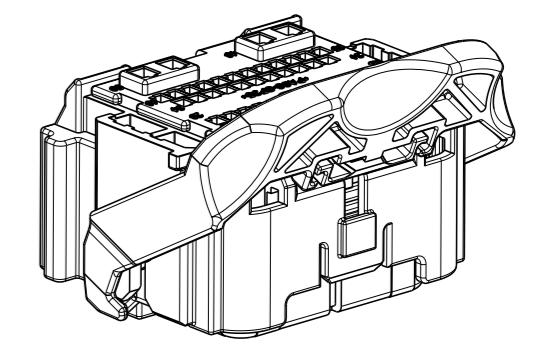
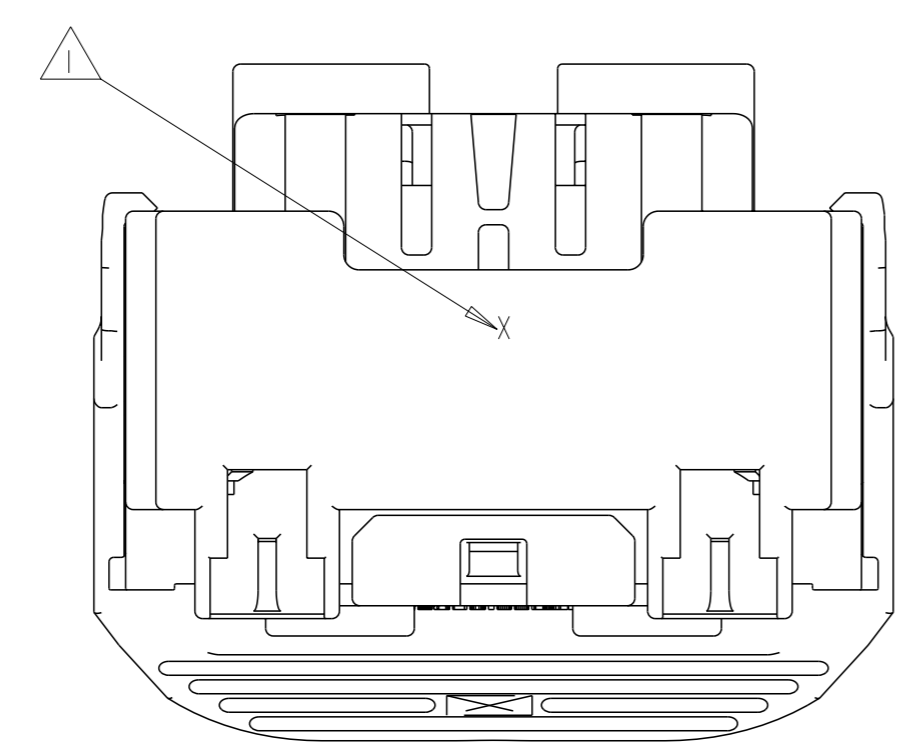

SCALE 1:1

| APPLICABLE COMPONENTS (FOR REFERENCE ONLY) | | | | | | |
|--------------------------------------------|-----------------------|----------------|----------------------------|----------------------|-------------------------------|---------------|
| DESCRIPTION | NOMINAL TERMINAL SIZE | COLOR/ PLATING | FORD COMPONENT PART NUMBER | SUPPLIER PART NUMBER | MATERIAL/SPECIFICATION NUMBER | SAE WIRE SIZE |
| TERMINAL - FEMALE (Ag) | 0.64 (CAT. 0) | SILVER | 7S4T-14474-AA | I393366-2 | COPPER ALLOY/SILVER PLATE | 20AWG |
| TERMINAL - FEMALE (Ag) | 0.64 (CAT. 0) | SILVER | 7S4T-14474-BA | I393367-2 | COPPER ALLOY/SILVER PLATE | 18AWG |
| TERMINAL - FEMALE (Sn) | 0.64 (CAT. 0) | TIN | 1L2T-14474-AA | I393366-1 | COPPER ALLOY/TIN PLATE | 20AWG |
| TERMINAL - FEMALE (Sn) | 0.64 (CAT. 0) | TIN | 1L2T-14474-BA | I393367-1 | COPPER ALLOY/TIN PLATE | 18AWG |
| TERMINAL - FEMALE (Au) | 0.64 (CAT. 0) | GOLD | 1L2T-14474-CA | I393365-1 | COPPER ALLOY/GOLD PLATE | 20AWG |
| TERMINAL - FEMALE (Au) | 0.64 (CAT. 0) | GOLD | 1L2T-14474-DA | I393364-1 | COPPER ALLOY/GOLD PLATE | 18AWG |
| TERMINAL - FEMALE (Au) | 0.64 (CAT. 0) | GOLD | 1L2T-14474-DA | I393364-1 | COPPER ALLOY/GOLD PLATE | 22AWG |

ANY DESIGN CHANGES ON THIS ASSEMBLY MAY
 ALSO BE REQUIRED ON ASSEMBLY DRAWING 1438691

SEE TABLES
 SHEETS 3 THRU 7
 PART NUMBER

| | | | | |
|----------------------------------------|--|----------------------------|-------------------|------------------------------------|
| THIS DRAWING IS A CONTROLLED DOCUMENT. | | OWN: R. VESTAL 15APR2005 | | TE Connectivity |
| DIMENSIONS: mm | | CHK: T. VALASEK 15APR2005 | | NAME: 50-WAY HARNESS ASSEMBLY, PCM |
| TOLERANCES UNLESS OTHERWISE SPECIFIED: | | APVD: T. VALASEK 15APR2005 | PRODUCT SPEC: - | APPLICATION SPEC: - |
| MATERIAL: - | | FINISH: - | WEIGHT: - | RESTRICTED TO: - |
| CUSTOMER DRAWING | | SIZE: A1 | CAGE CODE: 100779 | DRAWING NO: C=1438129 |
| SCALE: 1:1 | | SHEET 1 OF 10 | | REV: F37 |

| REVISIONS | | | | |
|-----------|-----|-------------|------|----------|
| P | LY# | DESCRIPTION | DATE | OWN APVD |
| - | - | SEE SHEET 1 | - | - |

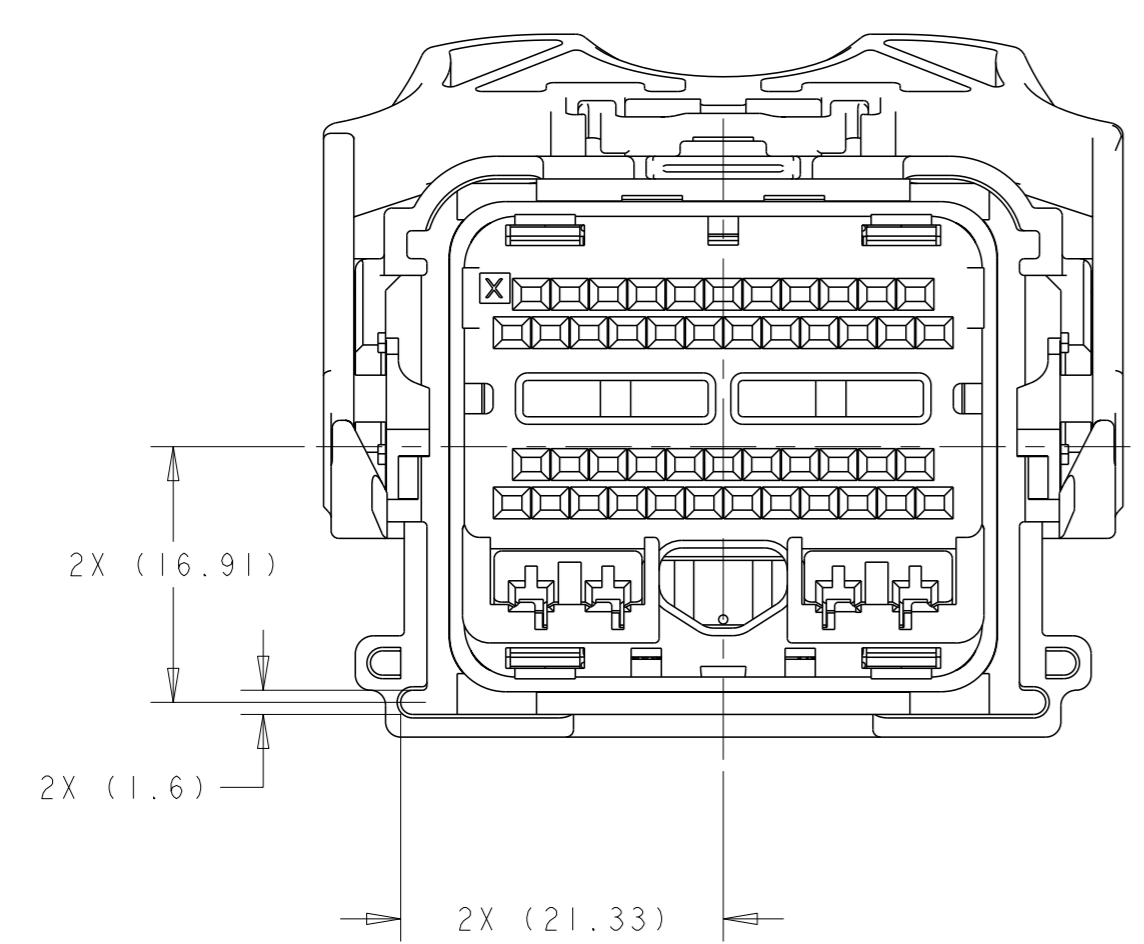
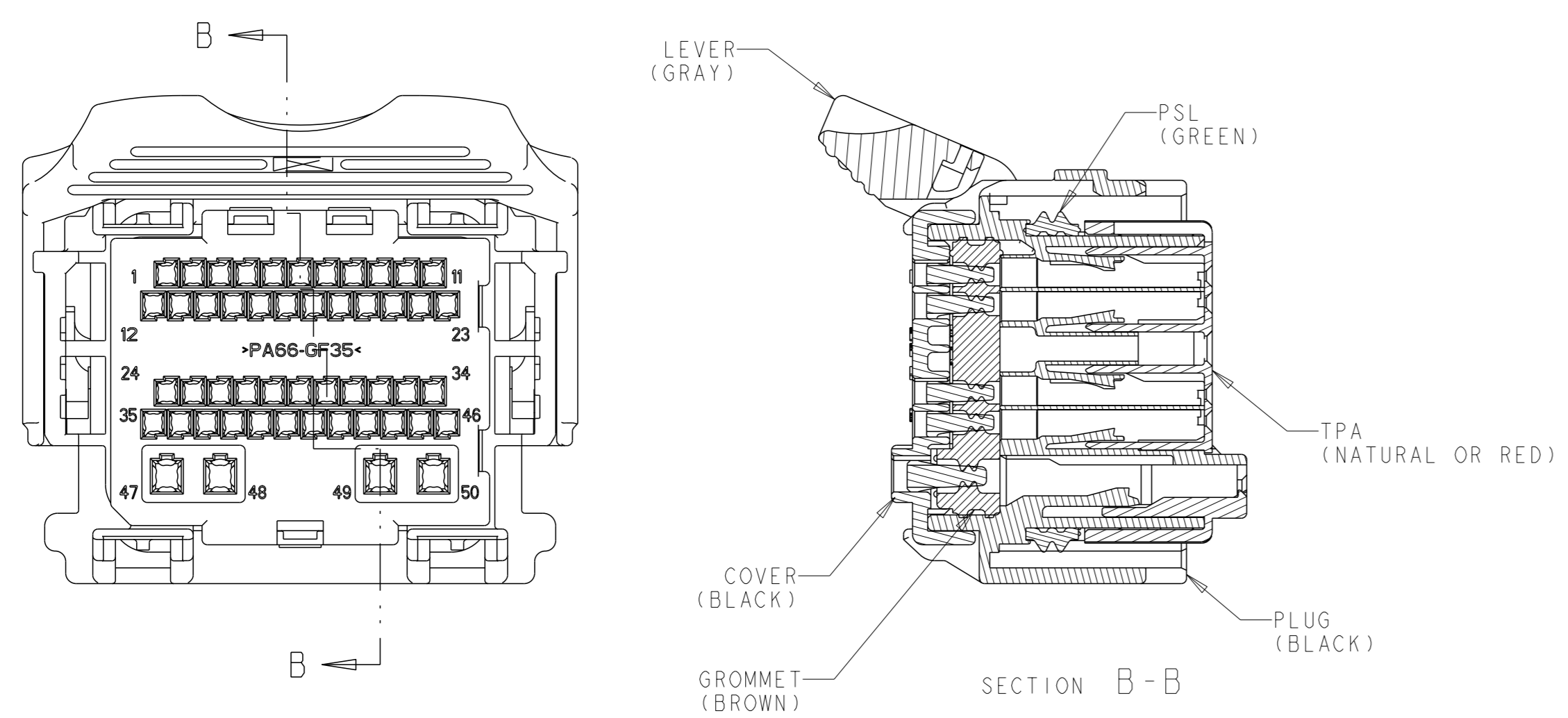

1438129-1
KEYING OPTION "A"

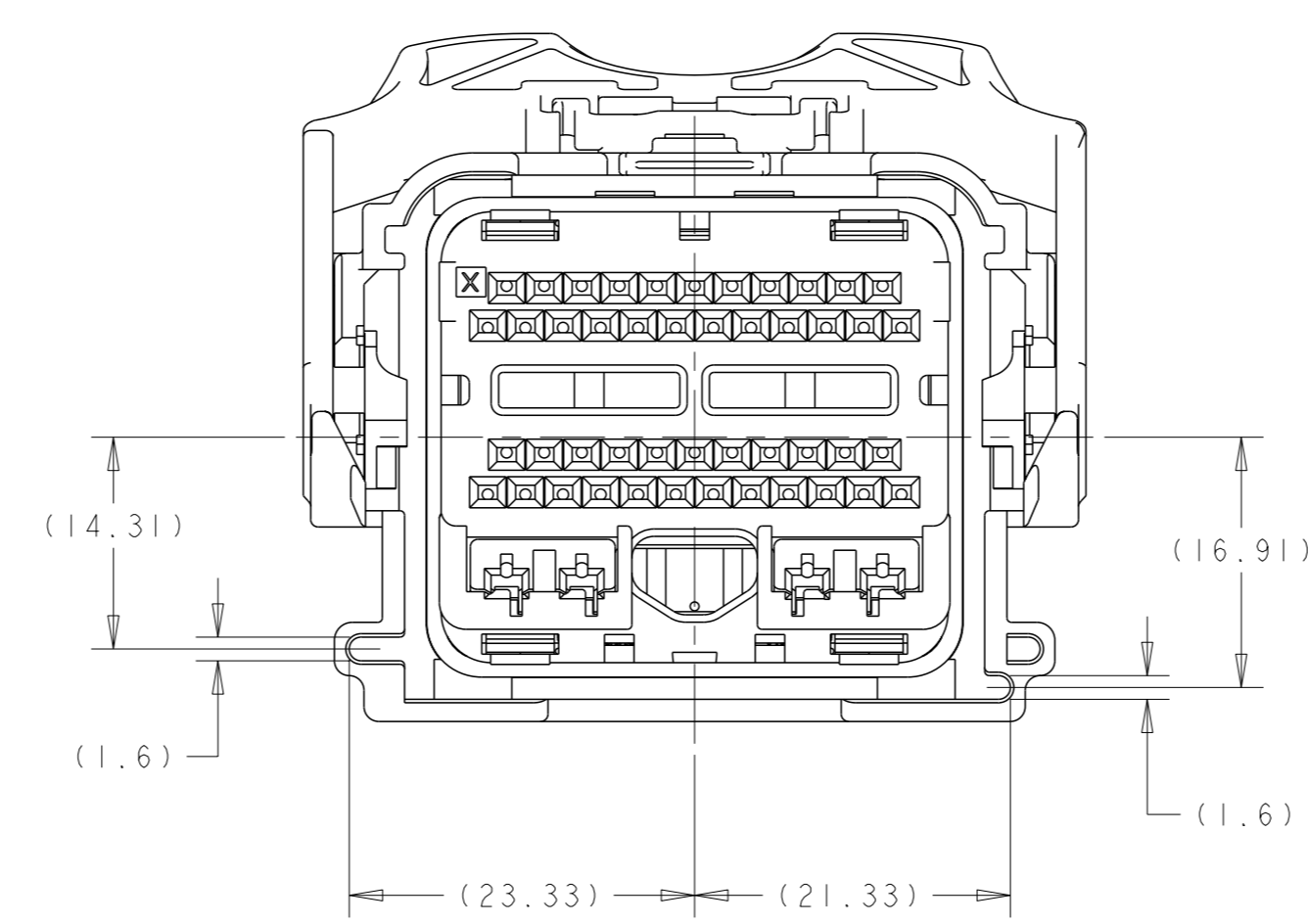

1438129-2
KEYING OPTION "B"

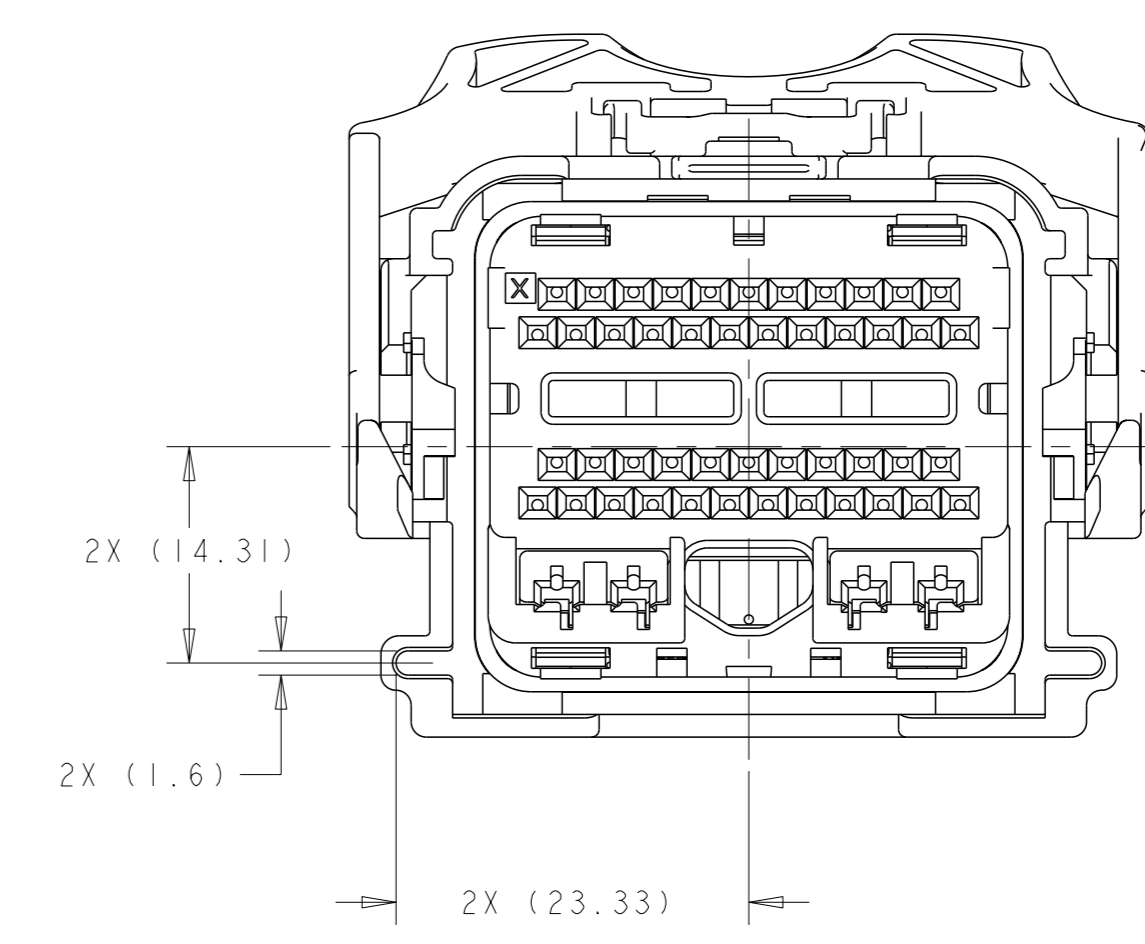

1438129-3
KEYING OPTION "C"

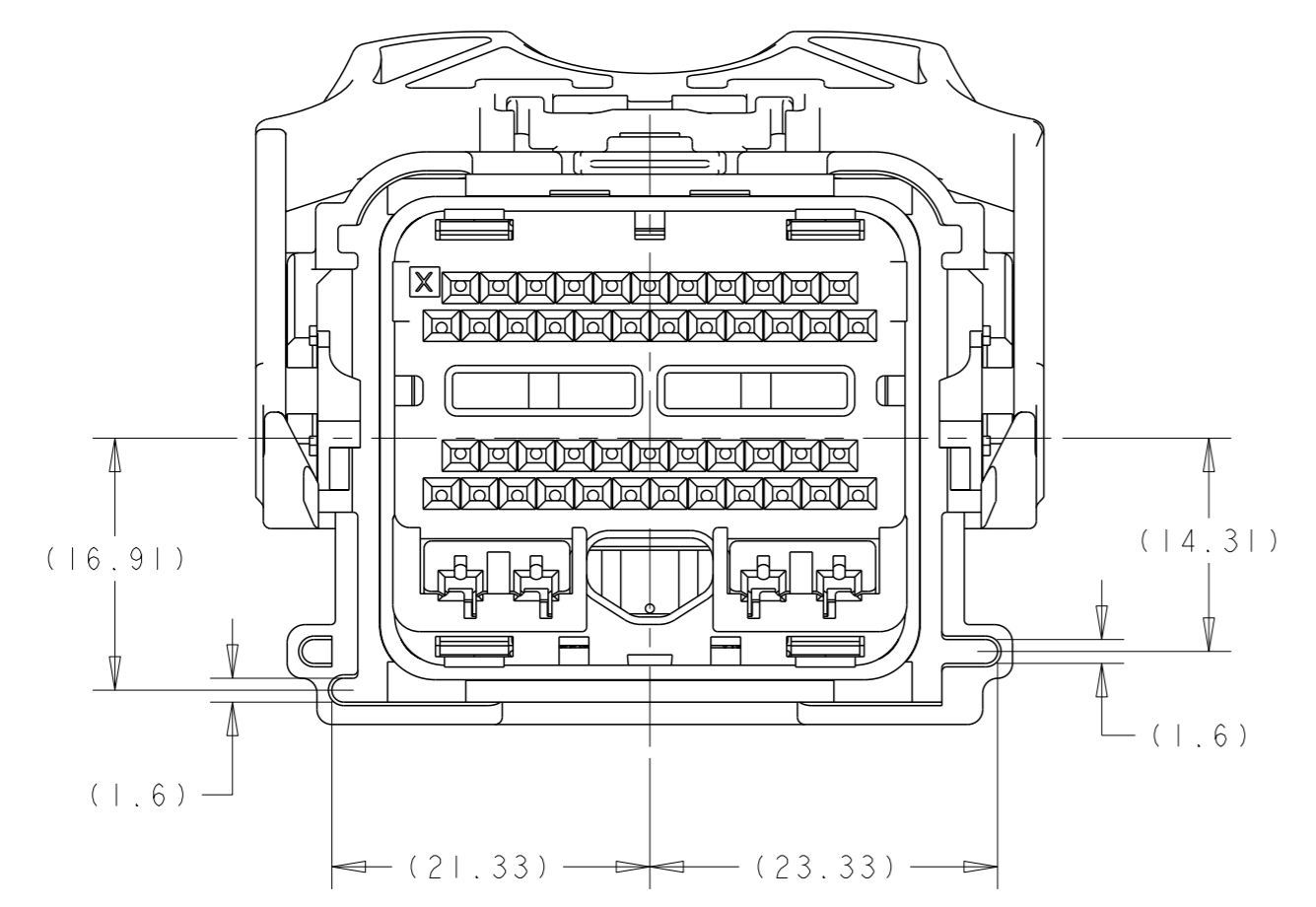

1438129-4
KEYING OPTION "D"

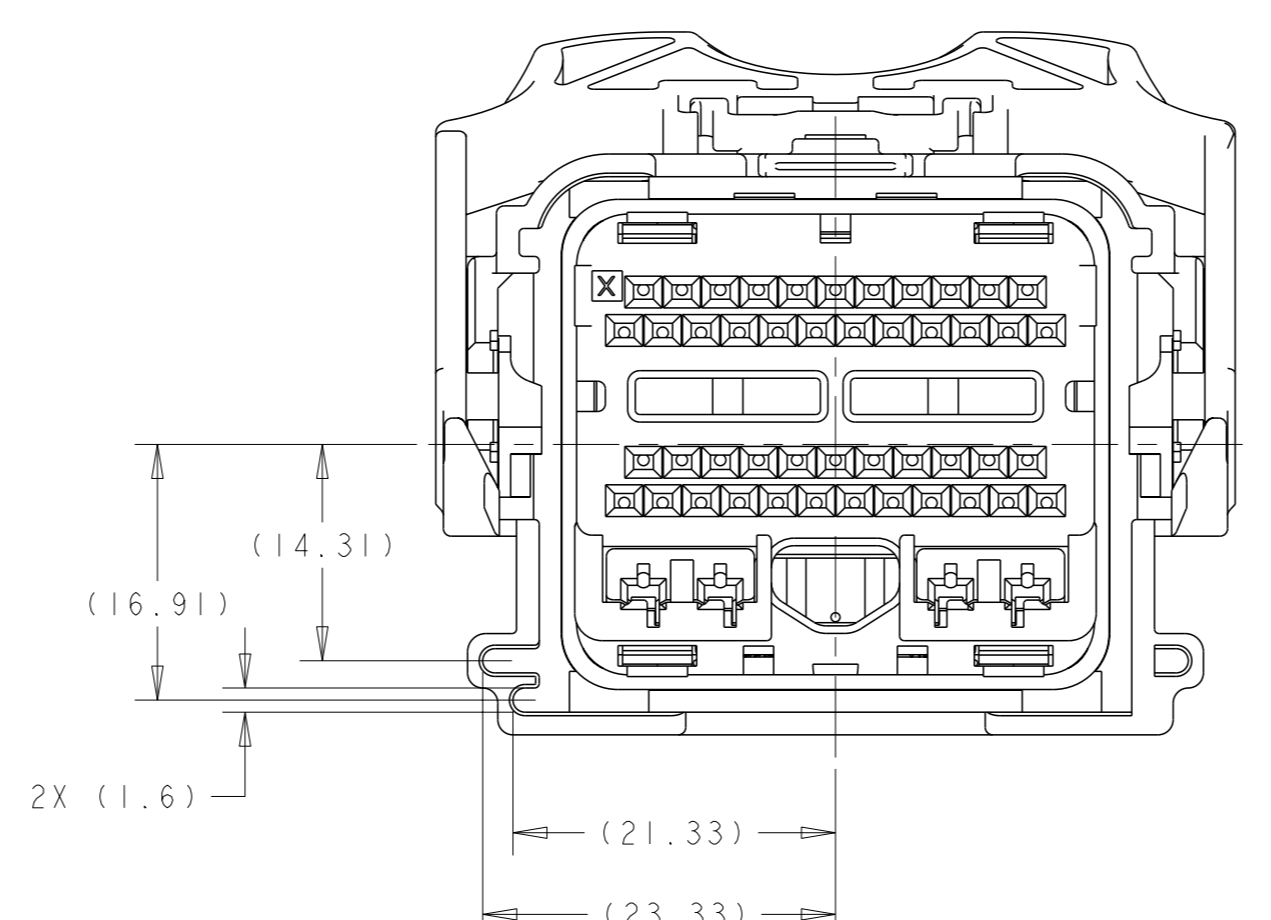

1438129-5
KEYING OPTION "E"

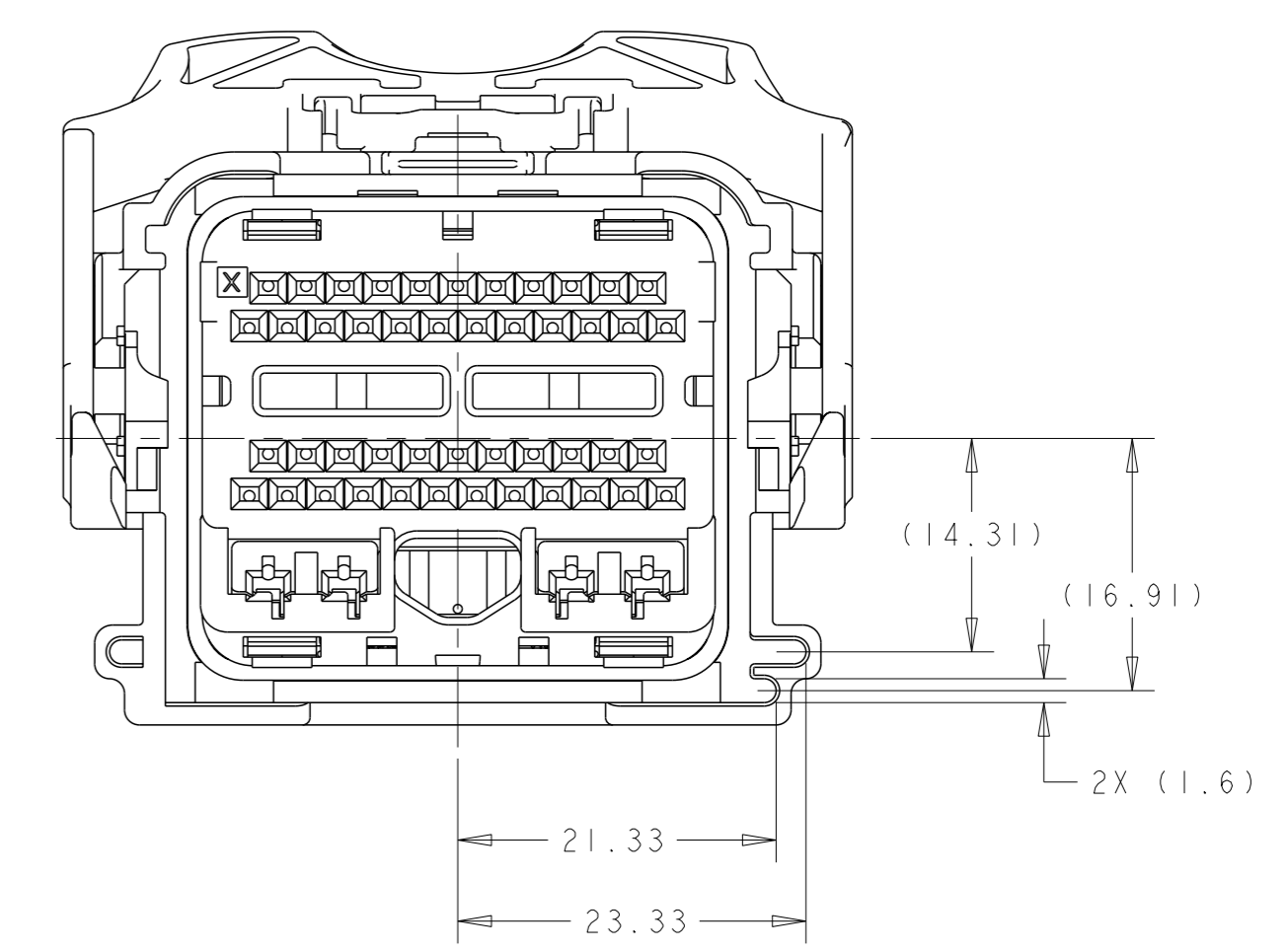

1438129-6
KEYING OPTION "F"

| | | | |
|----------------------------------------|------------------------------------------------------------|---------------------------------|-----------------------------------------|
| THIS DRAWING IS A CONTROLLED DOCUMENT. | | OWN R. VESTAL 15APR2005 | |
| DIMENSIONS: | | CHK T. VALASEK 15APR2005 | |
| mm | 0 PLC ± 1 PLC ±0.3 2 PLC ±0.10 3 PLC ± 4 PLC ± | APVD T. VALASEK 15APR2005 | NAME 50-WAY HARNESS ASSEMBLY, PCM |
| TOLERANCES UNLESS OTHERWISE SPECIFIED: | | PRODUCT SPEC | SIZE CAGE CODE DRAWING NO |
| MATERIAL | | APPLICATION SPEC | A100779C=1438129 |
| FINISH | | WEIGHT | RESTRICTED TO |
| CUSTOMER DRAWING | | SCALE 2:1 | SHEET 2 OF 10 REV F37 |

| REVISIONS | | | | |
|-----------|------|-------------|------|-------|
| # | DATE | DESCRIPTION | DATE | APP'D |
| - | | SEE SHEET 1 | - | - |
| | | | | |
| | | | | |

| | | | | | | | | | | | | | | | | | | | | | | | | | | | | | | | | | | | | | | | | | | | | | | | | | | | | | |
|-----------------|--------------------------------------------------------------------|------------------------------|----|----|----|----|----|----|----|----|----|----|----|----|-------------|--------------------|--------------------|--------------------|----|----|----|----|----|----|----|----|----|----|----|----|----|----------------------|------------------|----|----|----|----|----|----|----|----|----|---|---|---|---|---|---|---|---|---|-------------|--------------------|
| KEYING OPTION C | CAVITIES WITH A NUMERIC SYMBOL INDICATES CLOSED TERMINAL LOCATIONS | 39 | 38 | 37 | 36 | 29 | 28 | 23 | 20 | 19 | 10 | 9 | 8 | 7 | 6 | 5 | 7-1924783-8 | 5S4T-14A464-NA-135 | | | | | | | | | | | | | | | | | | | | | | | | | | | | | | | | | | | |
| | BLANK CAVITIES INDICATES OPEN TERMINAL HOLE LOCATIONS | 39 | 38 | 37 | 36 | 29 | 28 | 23 | 20 | 19 | 10 | 9 | 8 | 7 | 7-1924783-4 | 5S4T-14A464-NA-134 | | | | | | | | | | | | | | | | | | | | | | | | | | | | | | | | | | | | | |
| | TERMINAL HOLE POSITION | 50 | 49 | 48 | 47 | 46 | 45 | 44 | 43 | 42 | 41 | 40 | 39 | 38 | 37 | 36 | 35 | 34 | 33 | 32 | 31 | 30 | 29 | 28 | 27 | 26 | 25 | 24 | 23 | 22 | 21 | 20 | 19 | 18 | 17 | 16 | 15 | 14 | 13 | 12 | 11 | 10 | 9 | 8 | 7 | 6 | 5 | 4 | 3 | 2 | 1 | 7-1924783-2 | 5S4T-14A464-NA-133 |
| | | 39 | 38 | 37 | 36 | 28 | 26 | 25 | 23 | 20 | 11 | 10 | 8 | 6 | 5 | 7-1924783-0 | 5S4T-14A464-NA-132 | | | | | | | | | | | | | | | | | | | | | | | | | | | | | | | | | | | | |
| | | 5S4T-14A464-N* PIN-OUT CHART | | | | | | | | | | | | | | | | | | | | | | | | | | | | | | ASSEMBLY PART NUMBER | FORD PART NUMBER | | | | | | | | | | | | | | | | | | | | |

| | | | | |
|----------------------------------------|--|-----------------------------|---------------------------------------------------------------------------------------|------------------------------------|
| THIS DRAWING IS A CONTROLLED DOCUMENT. | | OWN: R. VESTAL 15APR2005 |  | TE Connectivity |
| | | CHK: T. VALASEK 15APR2005 | | NAME: 50-WAY HARNESS ASSEMBLY, PCM |
| | | APP'D: T. VALASEK 15APR2005 | PRODUCT SPEC: - | RESTRICTED TO: - |
| | | APPLICATION SPEC: - | SIZE: A1 | CAGE CODE: 100779 |
| | | WEIGHT: - | DRAWING NO: C=1438129 | SCALE: 1:1 |
| | | CUSTOMER DRAWING | SHEET: 8 | OF 10 |

| REVISIONS | | | | |
|-----------|-----|-------------|------|------|
| P | LY# | DESCRIPTION | DATE | APPV |
| - | - | SEE SHEET 1 | - | - |

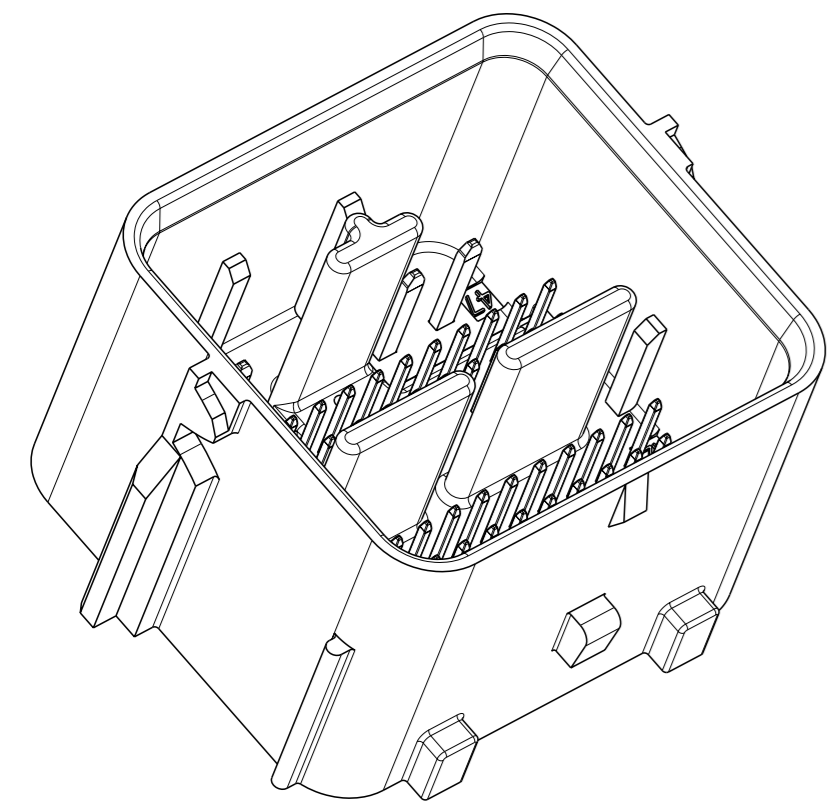

SCALE 2:1

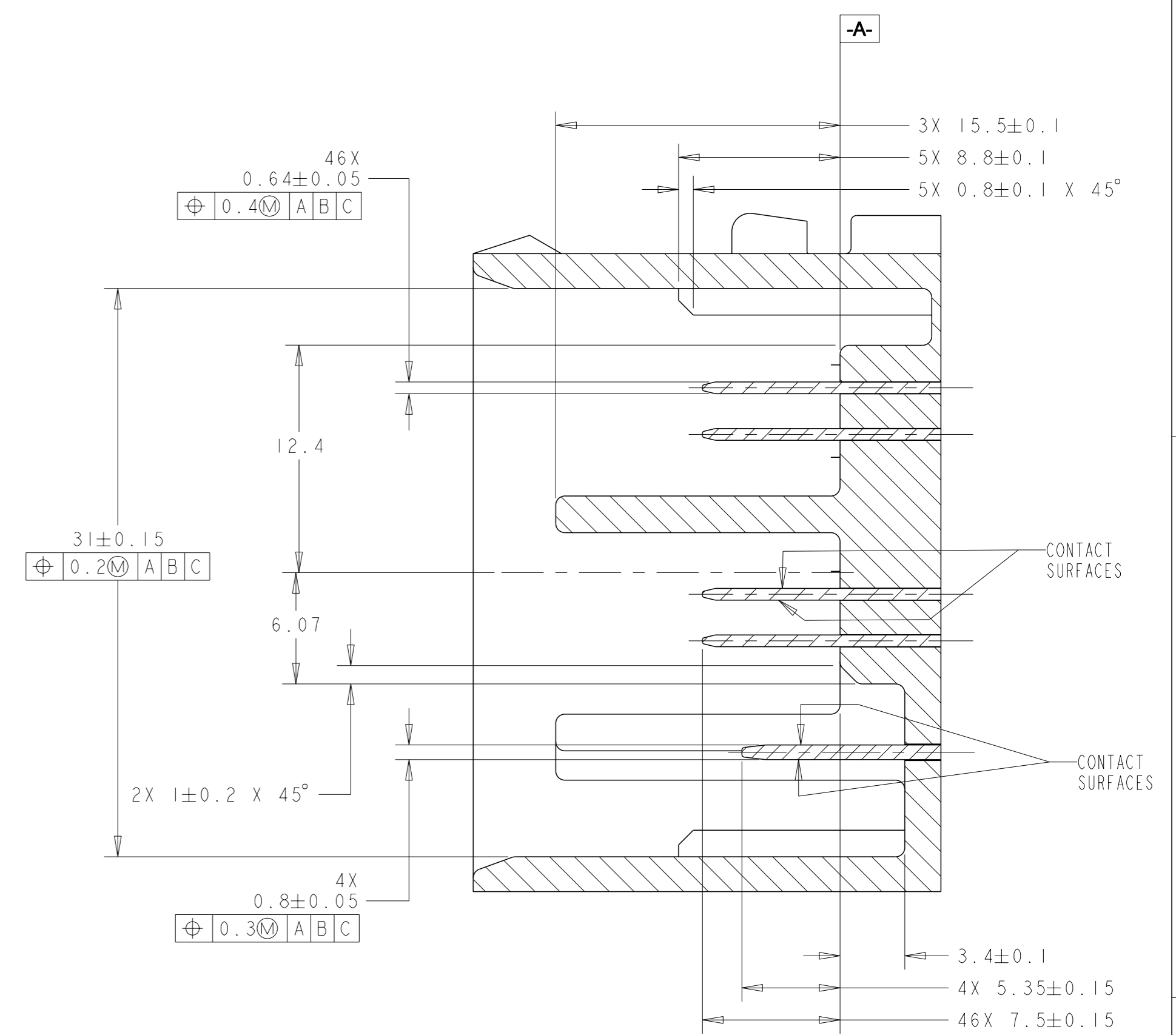
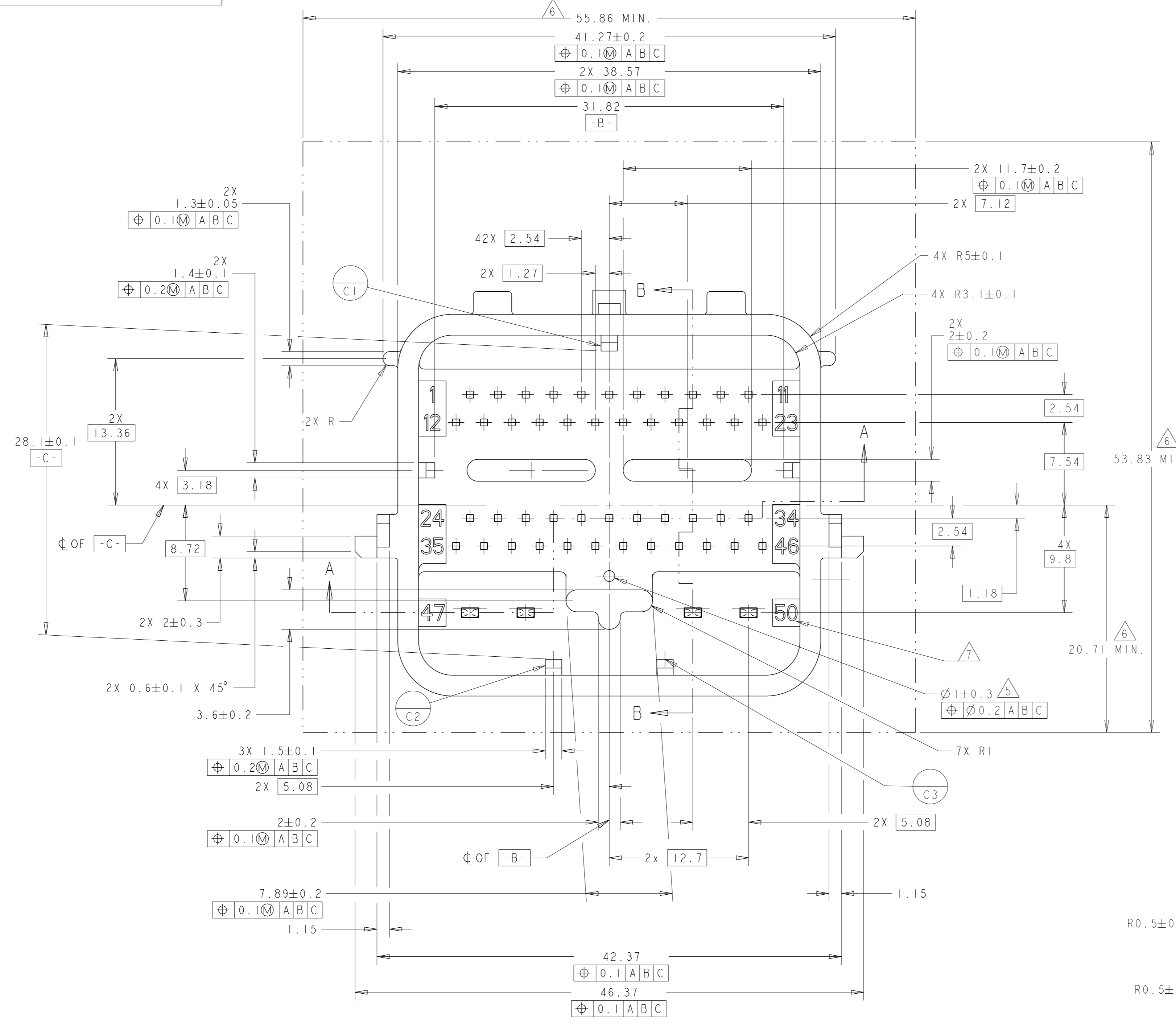

SECTION B-B

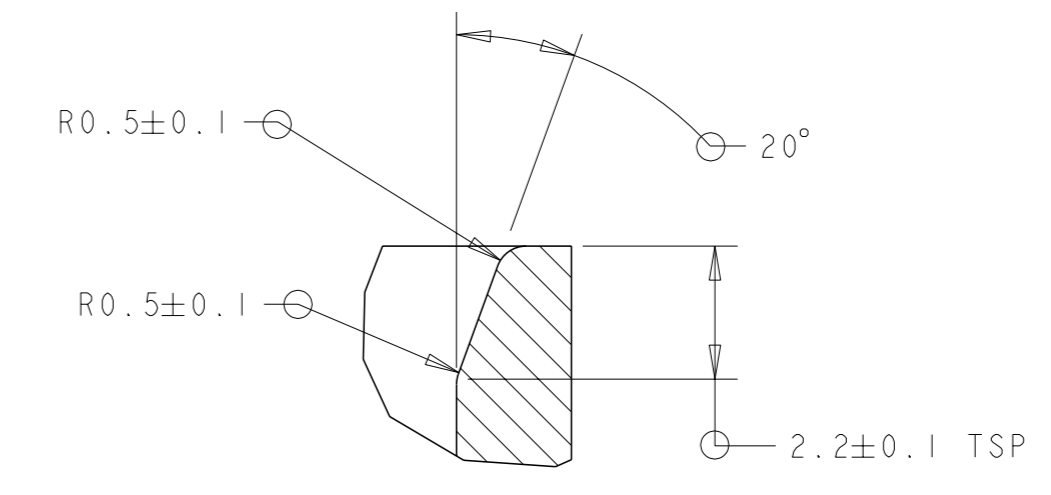

DETAIL E
SCALE 8:1

- NOTES: UNLESS OTHERWISE SPECIFIED
- GENERAL TOLERANCE:
 ±0.3 ALL ONE PLACE DIMENSIONS
 ±0.10 ALL TWO PLACE DIMENSIONS
 ±1°00' ALL ANGULAR DIMENSIONS
 - DRAFT ANGLE PERMISSIBLE ONLY WITHIN DRAWING TOLERANCE.
 - SEALING SURFACE, NO WITNESS LINES OR DAMAGE PERMITTED.
 - ALL UNMARKED RADII TO BE 0.5 MAX., UNLESS OTHERWISE SPECIFIED.
 - VENT HOLE SIZE AND LOCATION IS OPTIONAL.
 - THIS AREA TO REMAIN CLEAR FOR THE HARNESS ASSEMBLY.
 - TERMINAL POSITION IDENTIFICATION.
 - MATES WITH TYCO ELECTRONICS PART NUMBERS 1438129- & 1438950-*

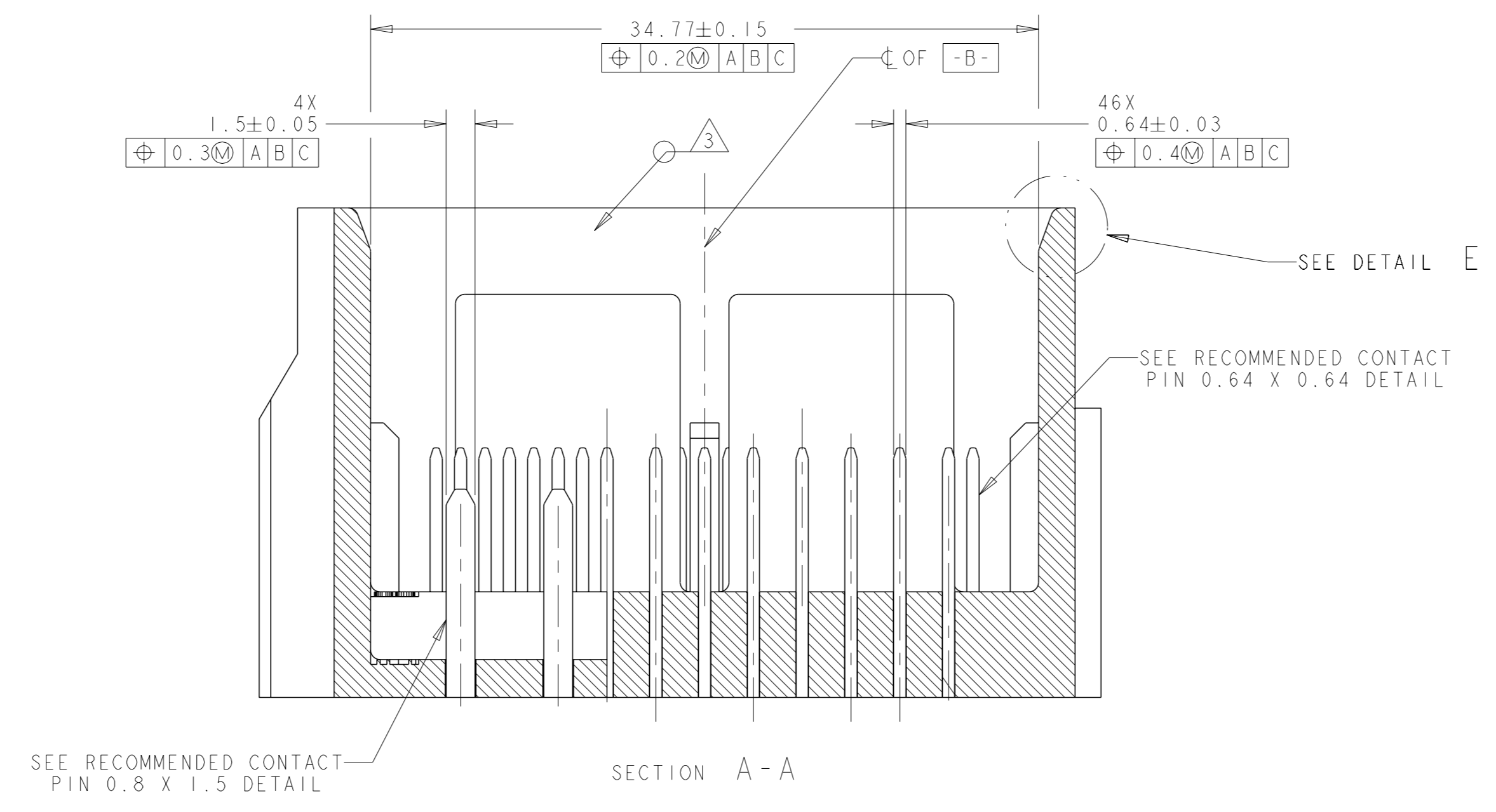

SECTION A-A

| | | | |
|---------------------------------------------------------------------------------|--|----------------------------------------|--------------------------------------------------------------------------------------------------------------------------------------------------|
| THIS DRAWING IS A CONTROLLED DOCUMENT. | | OWN: R. VESTAL 15APR2005 | TE Connectivity NAME: 50-WAY HARNESS ASSEMBLY, PCM PRODUCT SPEC: - APPLICATION SPEC: - WEIGHT: - SCALE: 1:1 SHEET 9 OF 10 REV F37 |
| DIMENSIONS: | | CHK: T. VALASEK 15APR2005 | |
| mm | | APVD: T. VALASEK 15APR2005 | |
| 0 PLC ± 1 PLC ±0.3 2 PLC ±0.10 3 PLC ± 4 PLC ± ANGLES FINISH ±1° | | TOLERANCES UNLESS OTHERWISE SPECIFIED: | |
| MATERIAL: | | SIZE: A100779C=1438129 | RESTRICTED TO: |
| CUSTOMER DRAWING | | SCALE: 1:1 | |

HEADER INTERFACE KEYING OPTIONS

| REVISIONS | | | | |
|-----------|------|-------------|-----|------|
| REV | DATE | DESCRIPTION | OWN | APVD |
| - | - | SEE SHEET 1 | - | - |

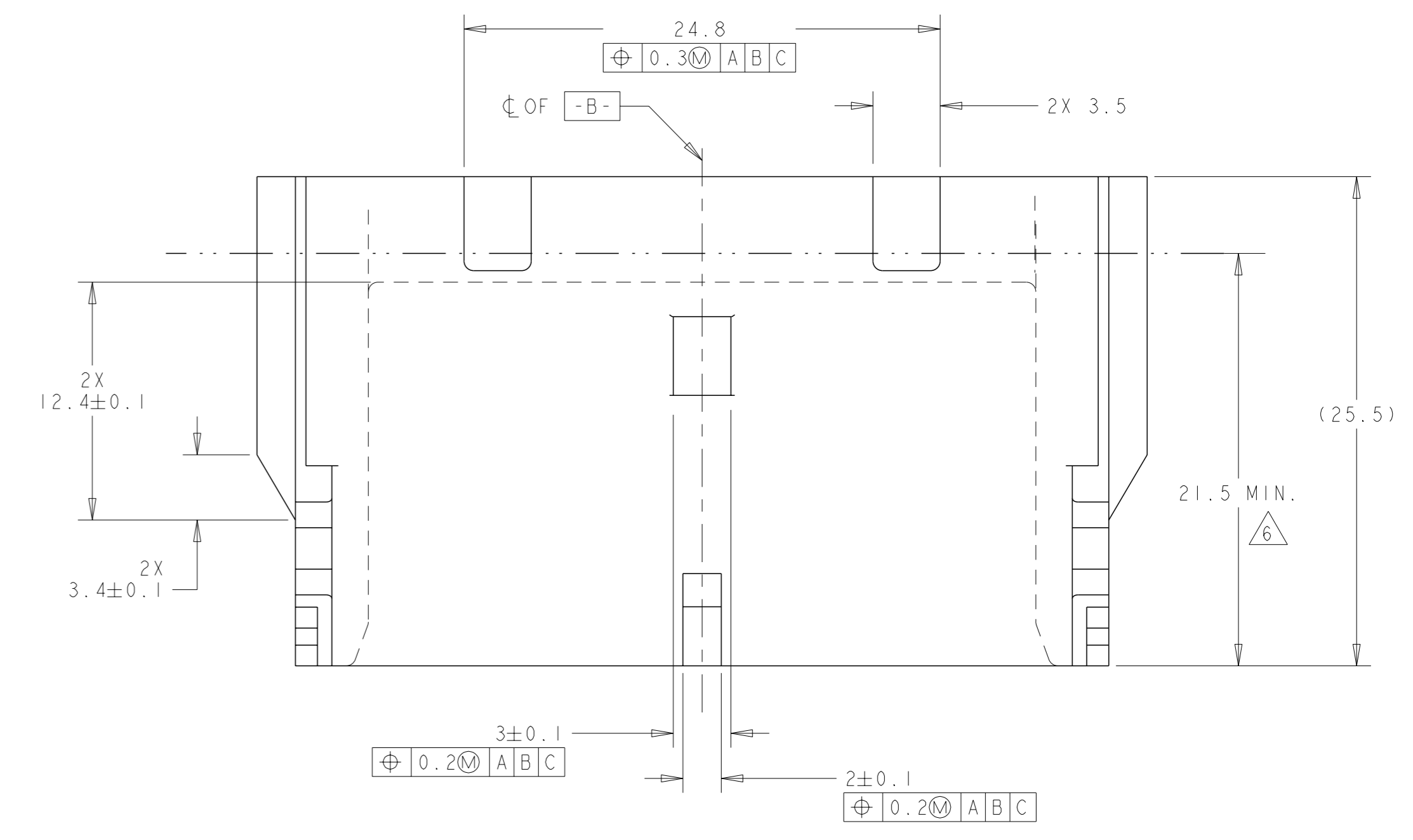
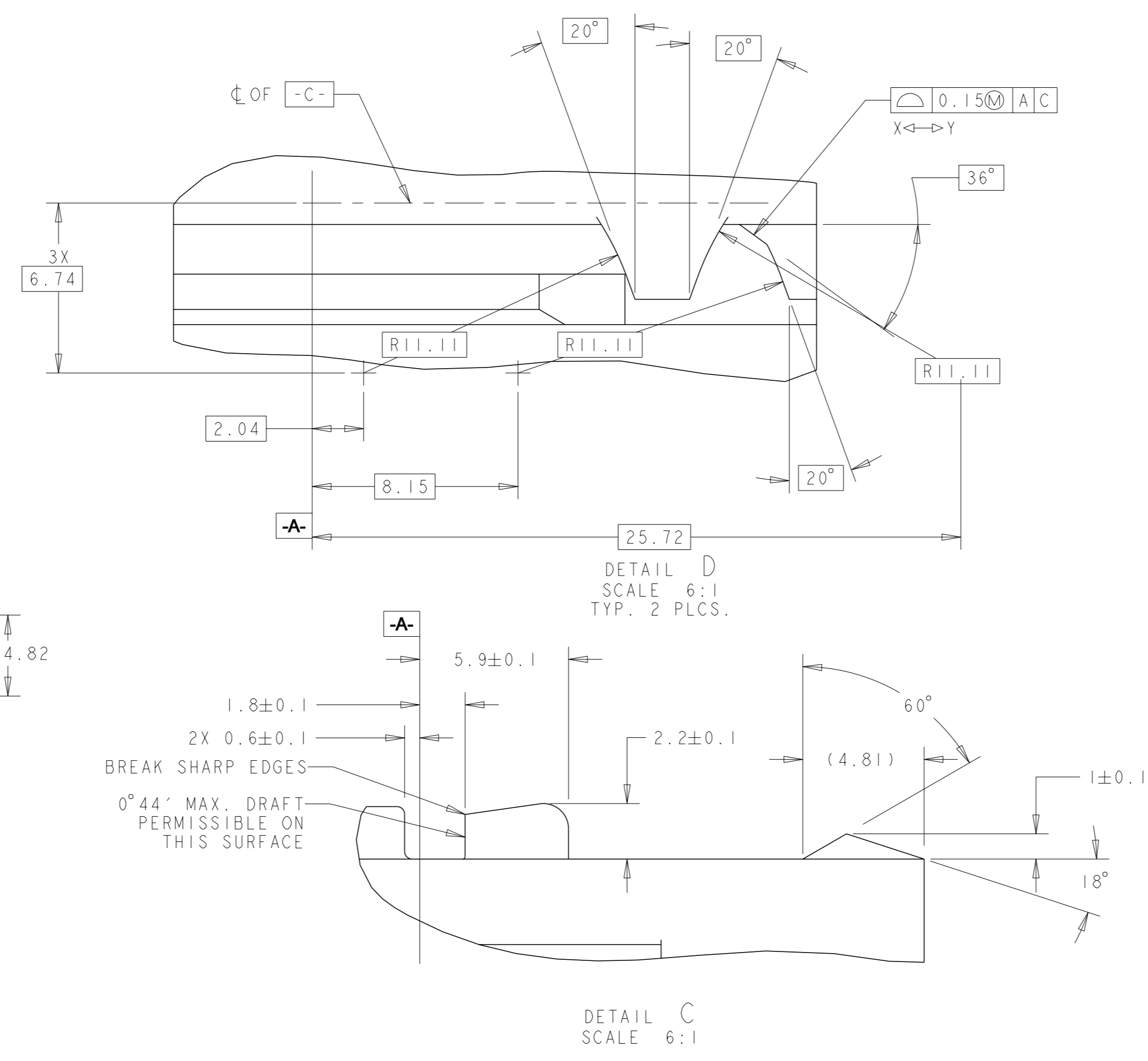
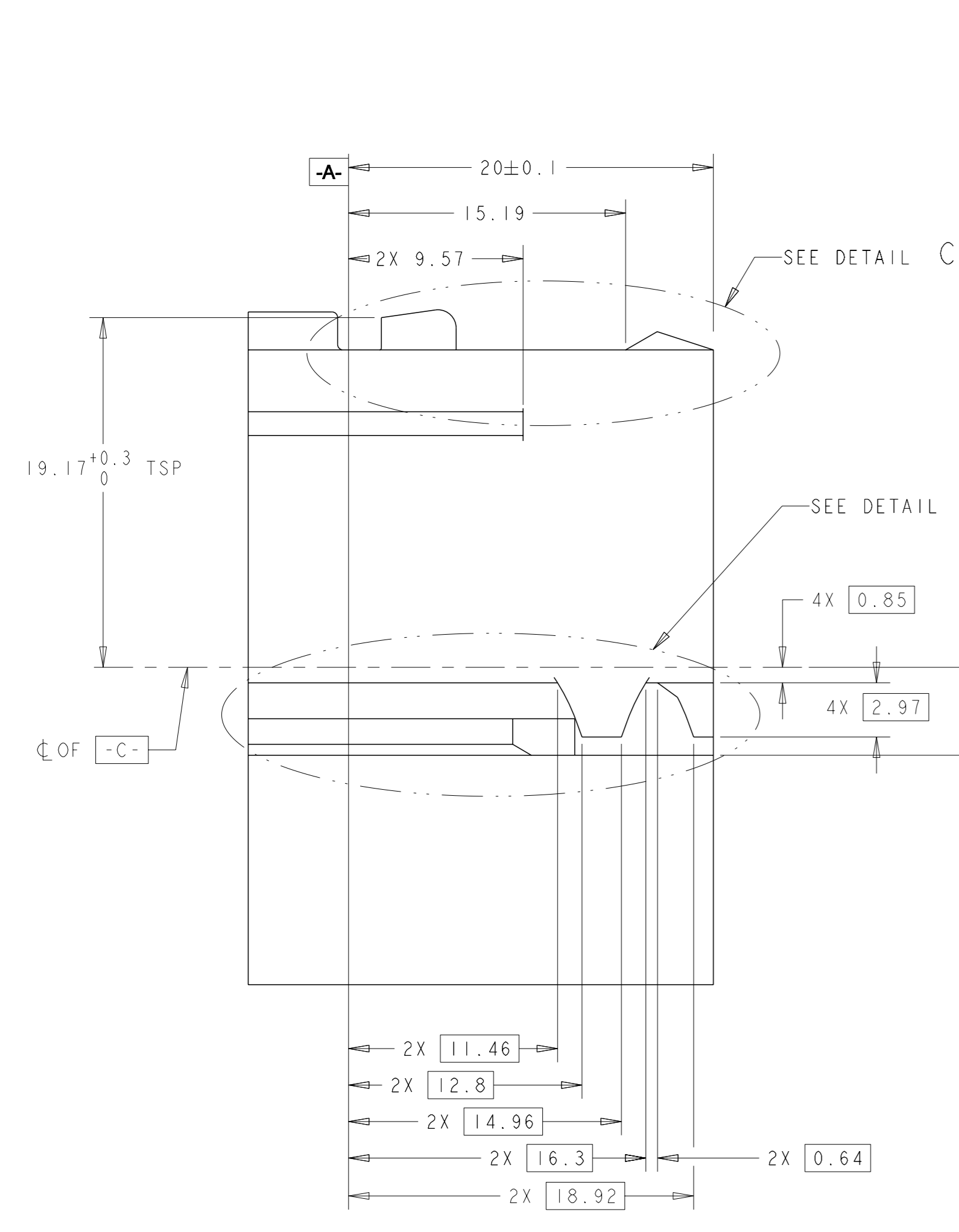
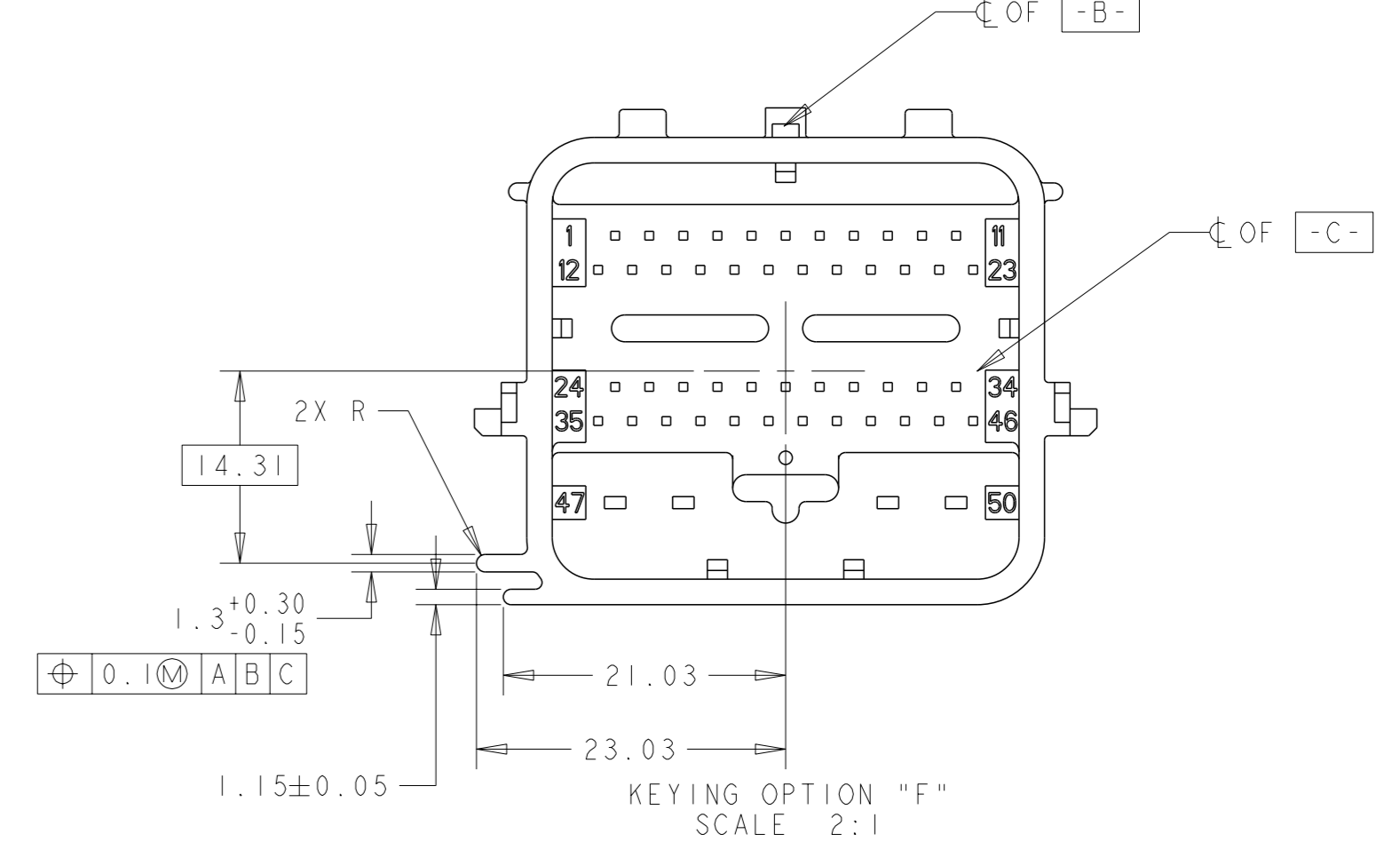
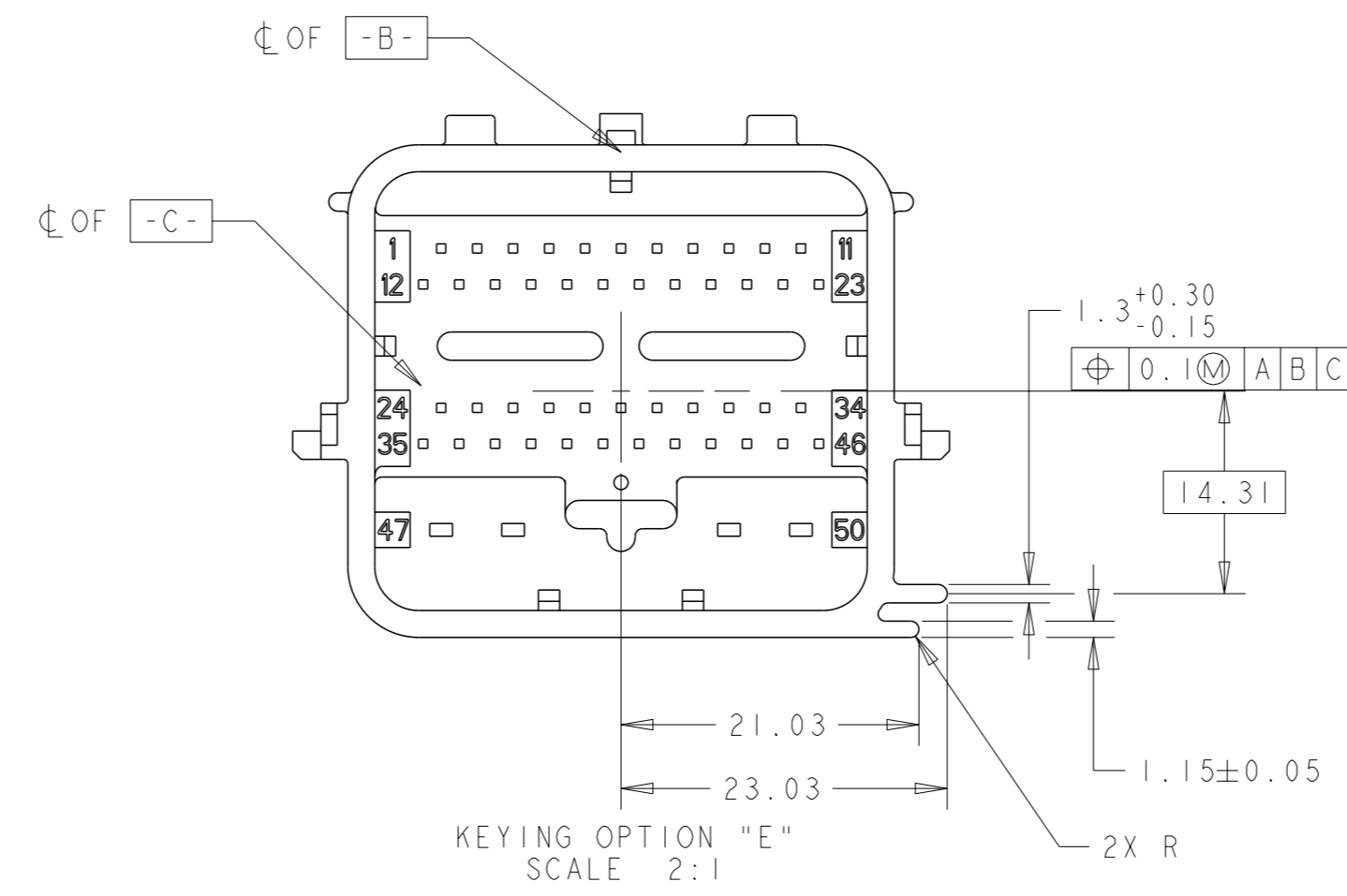
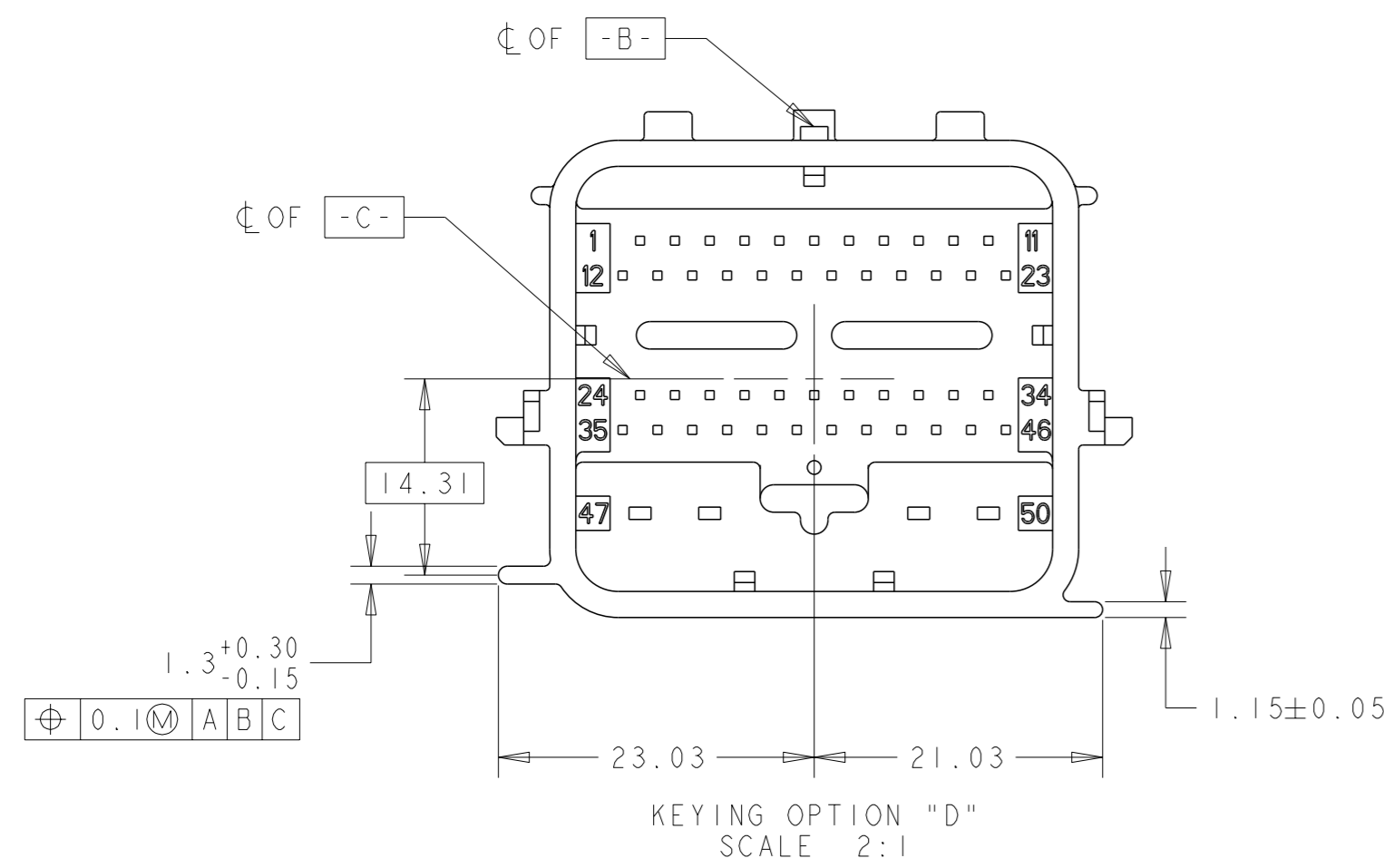
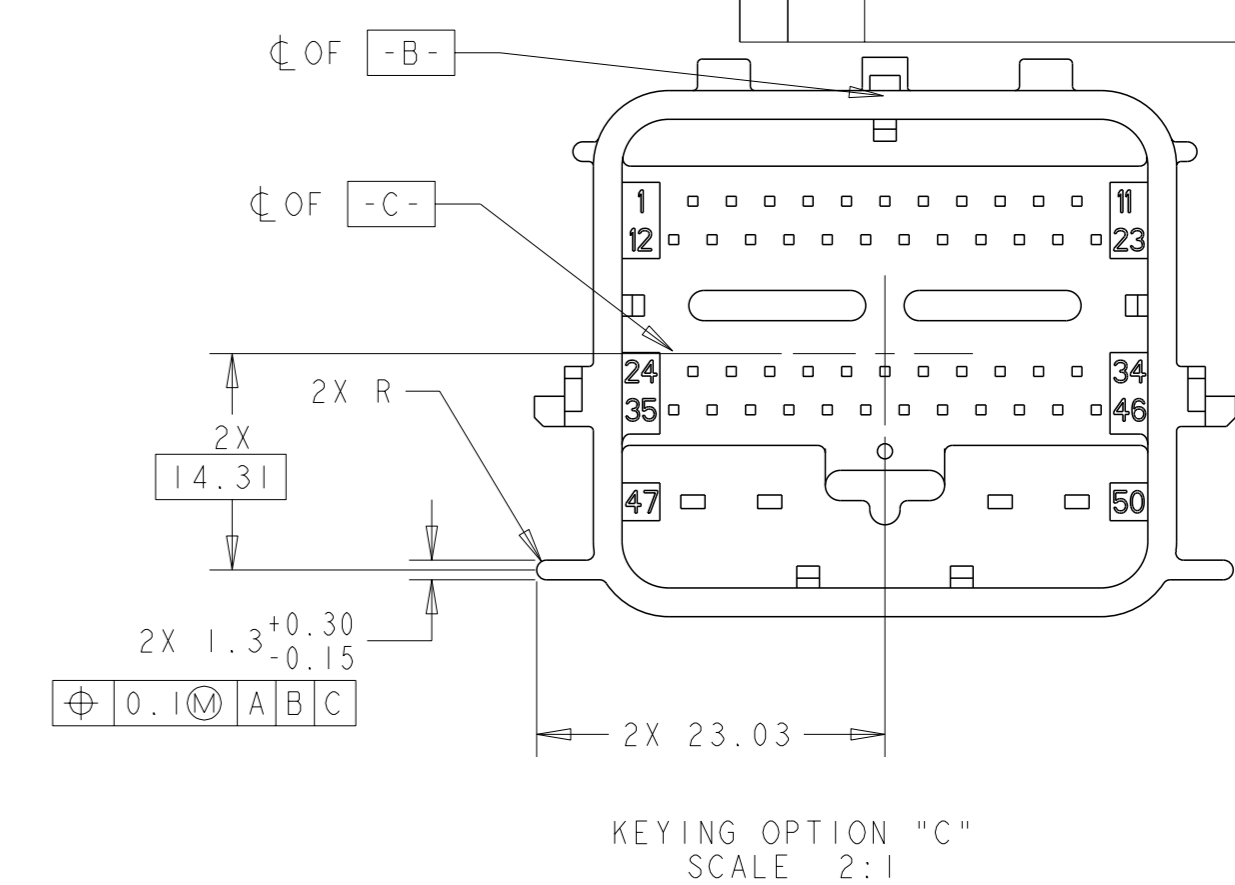
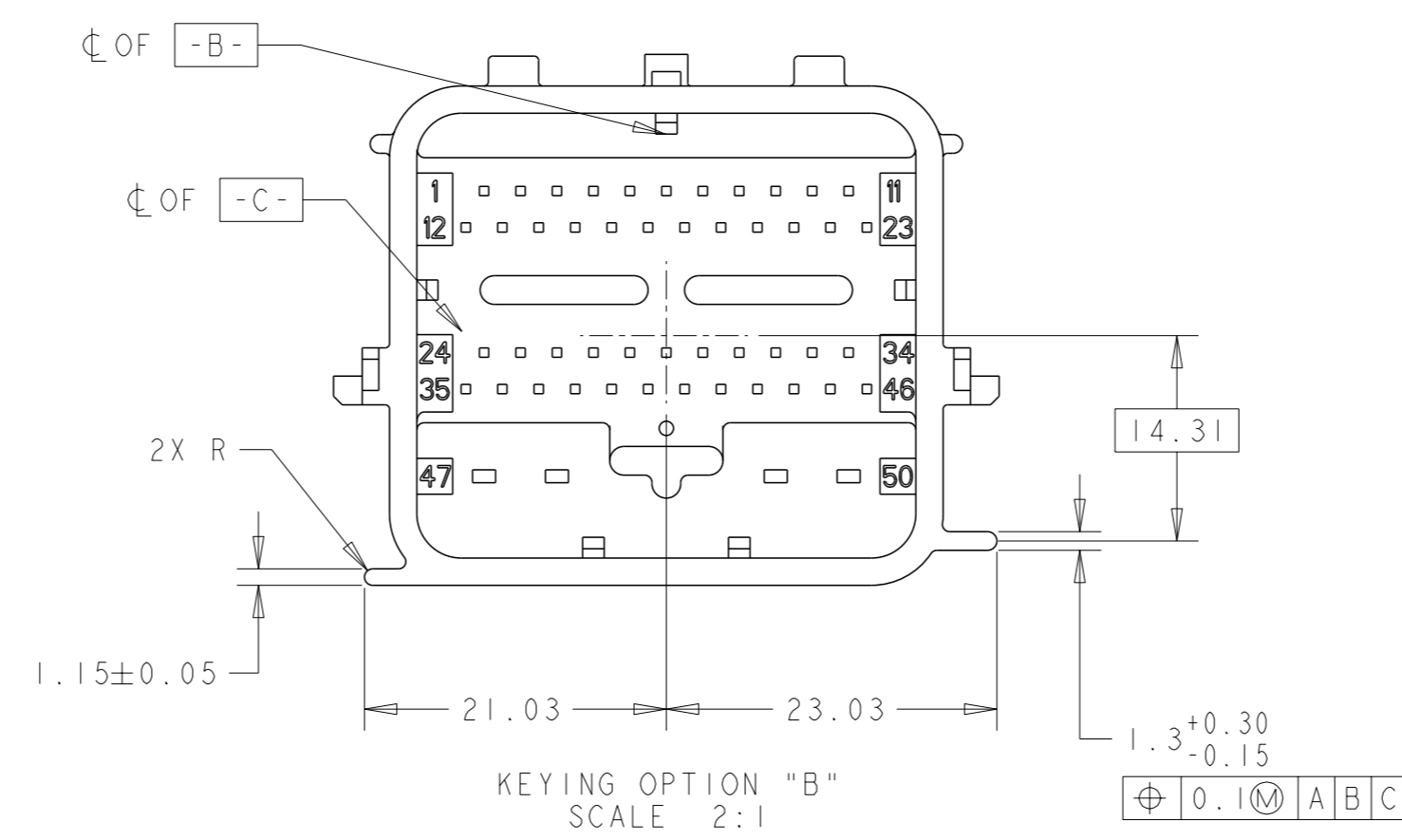
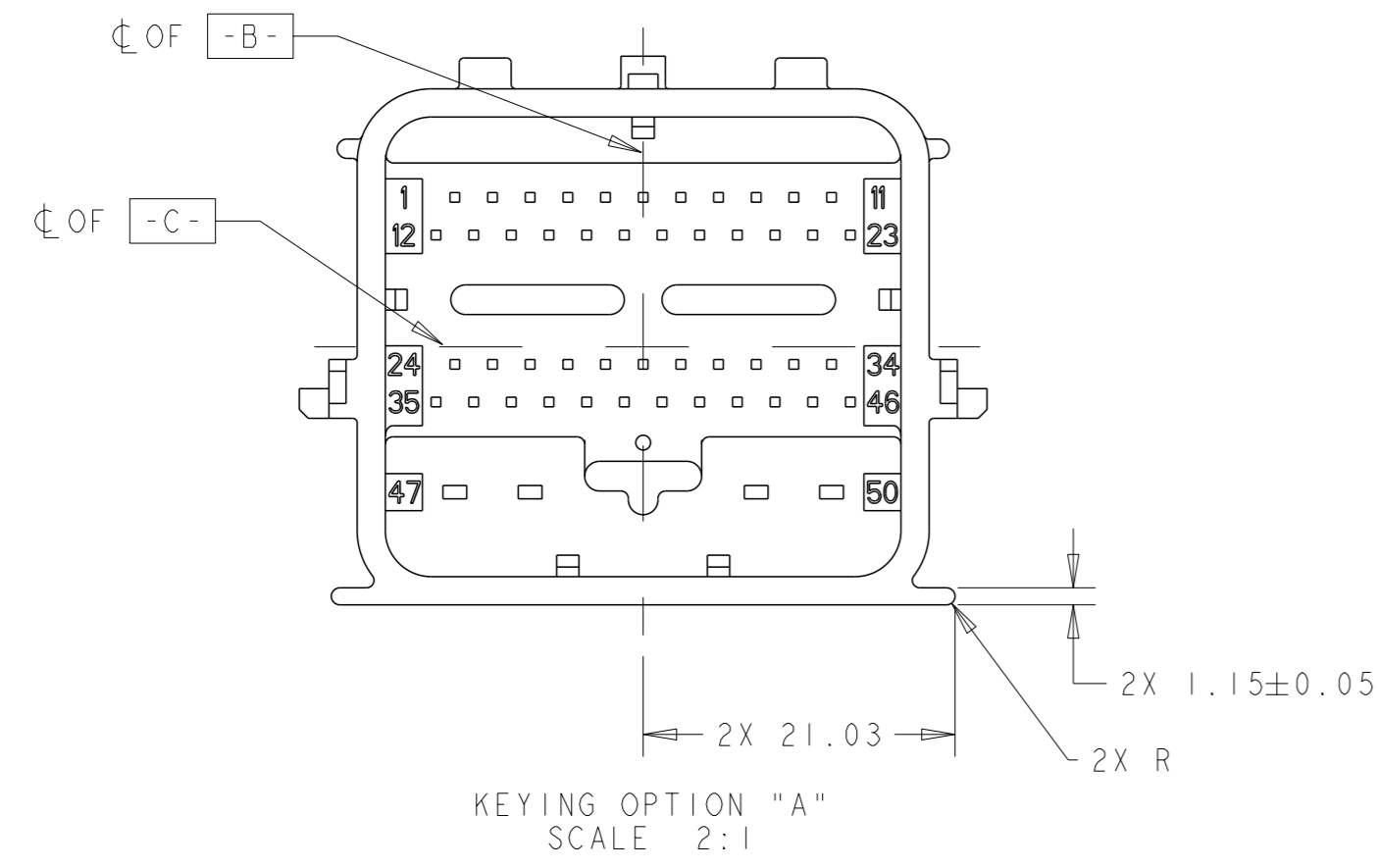

| | | | |
|-------------------------------------------------------------------------------|--|----------------------------|-------------------------------------------|
| THIS DRAWING IS A CONTROLLED DOCUMENT. | | OWN: R. VESTAL 15APR2005 | TE Connectivity |
| DIMENSIONS: mm | | CHK: T. VALASEK 15APR2005 | |
| TOLERANCES UNLESS OTHERWISE SPECIFIED: | | APVD: T. VALASEK 15APR2005 | NAME: 50-WAY HARNESS ASSEMBLY, PCM |
| 0 PLC ± 1 PLC ±0.3 2 PLC ±0.10 3 PLC ± 4 PLC ± ANGLES FINISH * | | PRODUCT SPEC | SIZE: CAGE CODE DRAWING NO. RESTRICTED TO |
| MATERIAL | | WEIGHT | A100779C=1438129 |
| CUSTOMER DRAWING | | SCALE: 1:1 | SHEET 10 OF 10 REV F37 |

Компания «Океан Электроники» предлагает заключение долгосрочных отношений при поставках импортных электронных компонентов на взаимовыгодных условиях!

Наши преимущества:

- Поставка оригинальных импортных электронных компонентов напрямую с производств Америки, Европы и Азии, а так же с крупнейших складов мира;
- Широкая линейка поставок активных и пассивных импортных электронных компонентов (более 30 млн. наименований);
- Поставка сложных, дефицитных, либо снятых с производства позиций;
- Оперативные сроки поставки под заказ (от 5 рабочих дней);
- Экспресс доставка в любую точку России;
- Помощь Конструкторского Отдела и консультации квалифицированных инженеров;
- Техническая поддержка проекта, помощь в подборе аналогов, поставка прототипов;
- Поставка электронных компонентов под контролем ВП;
- Система менеджмента качества сертифицирована по Международному стандарту ISO 9001;
- При необходимости вся продукция военного и аэрокосмического назначения проходит испытания и сертификацию в лаборатории (по согласованию с заказчиком);
- Поставка специализированных компонентов военного и аэрокосмического уровня качества (Xilinx, Altera, Analog Devices, Intersil, Interpoint, Microsemi, Actel, Aeroflex, Peregrine, VPT, Syfer, Eurofarad, Texas Instruments, MS Kennedy, Miteq, Cobham, E2V, MA-COM, Hittite, Mini-Circuits, General Dynamics и др.);

Компания «Океан Электроники» является официальным дистрибьютором и эксклюзивным представителем в России одного из крупнейших производителей разъемов военного и аэрокосмического назначения «JONHON», а так же официальным дистрибьютором и эксклюзивным представителем в России производителя высокотехнологичных и надежных решений для передачи СВЧ сигналов «FORSTAR».



JONHON

«JONHON» (основан в 1970 г.)

Разъемы специального, военного и аэрокосмического назначения:

(Применяются в военной, авиационной, аэрокосмической, морской, железнодорожной, горно- и нефтедобывающей отраслях промышленности)

«FORSTAR» (основан в 1998 г.)

ВЧ соединители, коаксиальные кабели, кабельные сборки и микроволновые компоненты:

(Применяются в телекоммуникациях гражданского и специального назначения, в средствах связи, РЛС, а так же военной, авиационной и аэрокосмической отраслях промышленности).



Телефон: 8 (812) 309-75-97 (многоканальный)

Факс: 8 (812) 320-03-32

Электронная почта: ocean@oceanchips.ru

Web: <http://oceanchips.ru/>

Адрес: 198099, г. Санкт-Петербург, ул. Калинина, д. 2, корп. 4, лит. А